

**DANGER**

A demarcation with this symbol represents the contents assuming imminent danger for death or serious injury when the product is used in any manner different from given instructions.

**WARNING**

A demarcation with this symbol represents the contents assuming possibility for death or serious injury when the product is used in any manner different from given instructions.

**CAUTION**

A demarcation with this symbol represents the contents assuming possibility of causing human injury or material damage only when a product is used in any manner different from given instructions.

- ② In addition to showing the time, this watch has a date indicator and power reserve indicator.
- ③ It comes with a second hand halt mechanism.
- ④ Shock-proof bearings to protect the balance with hairspring from shocks.

- (2) Beat : Hour/Minute/Small second hands, Date and Power reserve indicator.
- (3) Daily accuracy : 21,600 Beat / Hour
- (4) Drive system : +15 Sec to - 5 Sec
- (5) Number of jewels : Mainspring Winding (Hand-winding)
- (6) Running time : 24 jewels
- : At least 50 hours

The stated daily accuracy is in the following conditions:  
※After 24 hours at room temperature with the mainspring wound fully and the dial facing up.  
※Due to the characteristics of the automatic winding watch, the time may deviate from the stated "daily accuracy" depending on the following conditions: amount of time the watch is worn each day, position of the watch, movement of your arm, winding condition of the mainspring.  
※Determine the deviation from not just a day but a period of about a week. Product specifications may change without notice, for improvement.

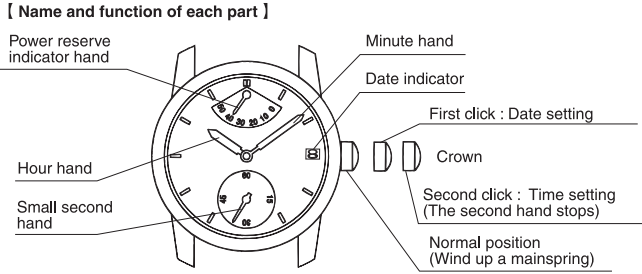

★The position of the crown and the power reserve indicator hand may differ depending on the model.

**[AUTOMATIC AND HAND WINDING MECHANISM]**

- ① This is an automatic winding mechanical watch (with a hand winding mechanism).
- ② The mainspring is wound by natural movements of your arm when wearing the watch on your wrist. In addition, you can also wind the mainspring by turning the crown.
- ③ If your watch stops, either swing the watch back and forth ten or more times or turn the crown to wind the mainspring in order to restart the second hand. After it starts moving, set the calendar and time.
- ④ When winding the mainspring, slowly turn the crown to the right (clockwise) while in its normal position. Turning the crown to the left (counterclockwise) merely turns the crown uselessly and does not wind the mainspring. You can wind the mainspring fully by turning the crown to the right about 30 times from a stopped position. The crown can still be turned after the mainspring is fully wound. Either use the above count or use the markings on the power reserve indicator when winding the watch.
- ⑤ Even if the mainspring is fully wound, it will not be over-wound due to the slip mechanism.
- ⑥ This watch will run approximately 50 hours after it is fully wound. If it is not wound enough, the watch may lose accuracy. In order to maintain the watch's accuracy, we recommend wearing the watch at least 8 hours a day.



**[MODELS WITH SCREWED-DOWN CROWN]**

Depending on the model, you may not be able to pull the crown out without unscrewing it (models with screwed-down crown).

Operate this type of watch as follows:

- Before setting the date and time, first turn the crown counterclockwise to loosen the screw lock.
- After setting the date and time, turn the crown clockwise while pressing in, until it stops turning to securely tighten the screw.

**[How to set the time]**

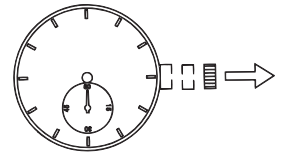

- ① Pull out the crown to the second click when the second hand reaches the 12 o'clock position. (The second hand stops.)



- ② Turn the crown counterclockwise and set the current time.  
※ Turn the crown in the hand advance direction (clockwise) until the today's date is displayed. It change to display [A.M.] when the date change. And set the hands further forward to adjust to the current time.  
※For the watch with a calendar, make sure that you set either a.m. or p.m. without fail. The date changes at [twelve o'clock midnight].

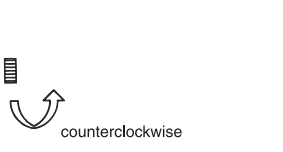

- ③ Press the crown in to the normal position.

**[How to set the date]**

**CAUTION**

Avoid setting the date between **8:00 p.m. and 2:00 a.m.** since the calendar changes during this time. If the date is set during this time period, the date may not change or the watch may malfunction. Be sure to move the hour and minute hands away from this time period when setting the date.

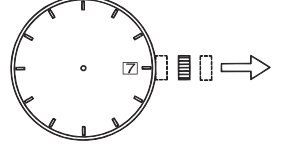

- ① Pull the crown out to the first click.  
※The crown on this watch can be pulled out to either of two clicks.

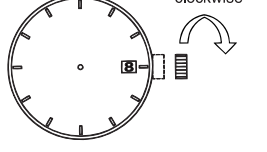

- ② Turn the crown clockwise, and set the date to that for the current day.

**◆ Power reserve indicator**

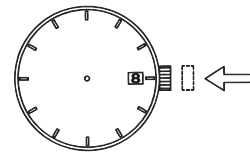

**Correcting the date at the end of the month**

The date will have to be corrected for months that have 30 days, or those that have less than 30 days. After the date switches over to the first day of the succeeding month, set the date to the [First (1)].

The power reserve indicator shows how much the watch is wound, allowing you to see how much longer the watch will run at a glance. The time pointed to by the power reserve hand is the remaining time. When the power reserve hand indicates the 50 or F mark, the mainspring is fully wound. \* The remaining time shown is only an approximation. The time shown may be different from actual remaining time. This product is also equipped with an automatic winding function. When it is worn on the wrist, the movement of the arm will wind the mainspring. The amount that the mainspring is wound will depend on the movement of the arm. If you do not wind, the power reserve hand will move toward zero as time passes.

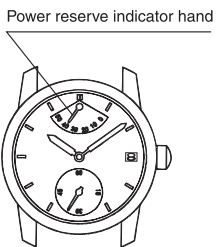

Power reserve indicator hand

**◆Using the rotating indicator ring**

Please notice that some models come with a rotating indicator ring, which should be used properly. Turn the ring by pointing the ∇ mark to the minute-hand. While certain time goes by, you can measure the elapsed time from the distance between minute-hand and figures on the rotating indicator ring. You can also set the ∇ mark as a desired time to remind you how long time is still remain for an appointment. You cannot turn the ring reversely since it comes with a protection mechanism for preventing wrong operation by force or shock. Figures on the ring could also help you to read the current time easily.

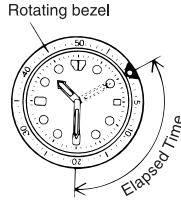

※Depending on design, anti-reversely and 1 minute "click" sound mechanism on rotating indicator ring does not apply to some models.

**◆ How to use the internal rotating indicator ring**

Please notice that some models come with an internal rotating indicator ring, which should be used properly. Turn the crown for the internal rotating indicator ring to set the ∇ mark to the position of the minute hand. The position of the internal rotating indicator ring to which the minute hand is pointing after some time has elapsed indicates the elapsed time. Setting the mark to the desired time also allows you to know the remaining time.

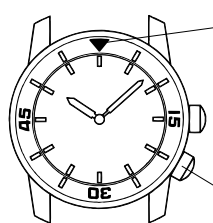

Mark  
Crown for the internal rotating indicator

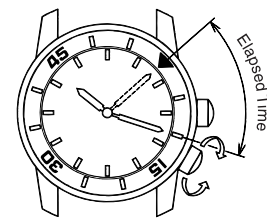

The above figure shows that 10 minutes have elapsed since 10:08.  
※The positions of the crown and the appearance of the internal rotating indicator ring may differ depending on the model.

**◆In Handling the watch**

**(1) Water-proof performance**

**WARNING**

- ① The watch, a water resistant for daily use (3 atm.), is available for face-washing etc, but avoid putting it in the water.
- ② The watch, an enhanced water resistant for daily use I (5 atm.), is available for swimming, etc., but do not put it on all diving that include skin diving.
- ③ The watch, an enhanced water resistant for daily use II (10 or 20 atm.), is available for skin diving, but not for scuba diving using an air cylinder and saturation diving using helium gas.

Type	Condition of use		Under water operation of crown and operation of crown with drops of water on it	Exposure to small amounts of water (facewashing, rain, etc.)	Swimming, work involving water, strong flow of water from the faucet etc.	'Skin diving (air tanks are not used)'	'Scuba diving (air tanks are used)'	Mixed-gas diving (using helium Gas)
	Non water resistant	Displays (Dials or Case back)						
Water resistant watches	Water resistant for daily use	Without WATER RESISTANT (WATER RESIST.)	×	×	×	×	×	×
	Enhanced water resistant for daily use I	WATER RESIST.(ANT) 5bar	×	○	×	×	×	×
	Enhanced water resistant for daily use II	WATER RESIST.(ANT) 10bar/20bar	×	○	○	×	×	×
Diver's watches	Water resistant for air diving I	AIR DIVERS 100m/150m/200m	×	○	○	○	○	×
	Water resistant for mixed-gas diving II	HE-GAS DIVERS 200m/300m/...	×	○	○	○	○	○

On some models WATER RESIST.(ANT)\*\*bar is shown as W.R.\*\*bar.  
※Confirm an inscription of water-proof level on the dial or the case back of the watch, and use correctly according to the above-mentioned scopes of availability.

**CAUTION**

- ④ Make sure the crown is pushed in (normal position) when using the watch. If your watch is the screw-lock type crown and the button, make sure the crown and button is securely tightened.
- ⑤ Do not turn or pull out the crown and the button under the water or in the wet condition. Water may enter inside the watch and degrade water-proof capability.
- ⑥ For a non-water resistant for daily use watch, pay attention to temporary splashed waterdrops (water splash at facewashing, rain, etc.) and sweat. If the watch becomes wet from water or sweat, wipe it off with dry soft cloth.
- ⑦ Even if you are wearing a watch that is a water resistant for daily use, do not expose it directly to the powerful flow of water running from a water tap. The water pressure exceeding waterproofing performance can be encountered and may deteriorate water-proofness.
- ⑧ If your watch is water resistant for daily use, rinse the case with fresh water thoroughly when it is dipped in seawater. Then wipe the watch dry to prevent rust.
- ⑨ If the leather band is dipped in the water, it may lose its durability and be discolored or unglued. When using the watch in the water, replace the band with other material (metal or rubber) in advance.
- ⑩ There are slightly humidity inside the watch. If outer temperature is lower than inside the watch, the glass surface may become cloudy. If the cloudy of moisture is only temporary, the internal mechanism will not be damaged. However, if it remains cloudy for a long time, or if there is moisture inside the watch, consult your purchase shop or the Customer Service.

**(2) Shock**

- ① Be sure not to carry the watch when you engage in strenuous sports, whereas playing such light sports as golf, etc., will not adversely influence the watch.
- ② Avoid a violent shock such as dropping the watch on the floor.



**(3) Magnetic field**

- ① The watch is not influenced by the electromagnetic fields produced by home electric appliances.

**CAUTION**

- ② Keep the watch away from the magnets, magnetic health aids (gadgets for relieving stiff shoulders, bracelets, etc.) , electric mah-jong tables, etc, which produce the strong magnetism.
- ③ If "ANTIMAG. I" or "ANTIMAG. II" is inscribed on the watch, it means that your watch has been made further resistant to the magnetism. Refer to the following for the strength of the display and the magnetic field which can be borne.  
●ANTIMAG. I ...It can withstand a magnetic field up to 4,800A/m(60 gauss)  
●ANTIMAG. II ...It can withstand a magnetic field up to 16,000A/m(2000 gauss)
- ④ If the watch is left in a strong magnetic field for along time, its part will become magnetized and result in a malfunction.
- ⑤ The watch that is damaged by strong magnetic fields may gain or lose time for a while. However if it is moved away from the magnetic field it will regain its original accuracy. In this case, correct the time.

**◆Allergic reactions**

**◆About "luminous light"**

**◆ Water resistant watchband**

**◆Silver items**

Some watch have luminous light on the hands and dial. The luminous light is a safe paint that stores sunlight and artificial light without using any radioactive material, and emits that light in a dark setting. As the paint discharges the stored light, it will become dimmer over time. The amount of light emitted and the time that light is emitted depends on various factors when the light is stored, such as the shape of the glass, the thickness of the paint, surrounding brightness level, the distance from the watch to the light source, and the light absorption level. Please note that when not enough light energy is stored, the watch may emit weak light or emit light for only a short time.

Some watch uses the nylon band or the leather band, carried out special processing which is hard to absorb even if it touches sweat and water. Since an effect deteriorates according to usable years and operating condition, please understand the water resistance of this band.

Some of our products have a silver or silver-plated case and band. Due to the properties of silver, oxides and sulfides (prevalent in the air and around the body in the form of waste substances sloughed off by the body) will react with the silver become discolor the surface to black. If this case, wipe the surfaces with the cloth for silverware. The original coloring will then be restored.

**CAUTION**

If you develop a skin rash or your skin becomes abnormally irritated due to contact with the watch or strap, stop wearing the watch immediately and consult a doctor.

**(8) Use at high temperature**

**CAUTION**

Do not use the watch at high temperatures, such as in a sauna. You may be burned when the watch heats up.

**(7) About accessory parts**

**CAUTION**

- ① Do not attempt to disassemble or modify this product.

**WARNING**

- ② Store the bracelet/strap pin and other small parts out of the reach of children. If any small parts are swallowed, immediately contact a doctor.

**(4) Vibration**

The watch may lose precision if subjected to strong vibrations such as from riding motorcycles, using jackhammers, chain saws, etc.

**(5) Temperature**

In environments below and above normal temperatures (5°C-35°C), the watch may malfunction and stop.

Do not use the watch at high temperatures, such as in a sauna. The watch may heat and cause burns.

**(6) Chemicals, gasses, etc.**

Utmost caution must be exercised when coming into contact with gases, mercury, chemicals (paint thinner, gasoline, various solvents, detergents containing such components, adhesives, paint, drugs, perfumes, cosmetics, etc.), and so forth. Such may cause discoloration of the watchcase, watchband, and dial face. Discoloration, deformation, and damage to various resin-based component parts may also occur.

**◆For extended use**

**CAUTION**

- (1) Maintenance of the case and band**
- ① Dirt and moisture on the case and band may interfere with the watch functions, cause skin rashes to person with susceptible skin, or soil the cuffs of clothing. Use a soft cloth to wipe off dirt and moisture and keep the watch clean. Especially the band makes direct contact with the skin, remove dirt periodically.
- [Case]**
- Keep the moisture and dirt, then it case corrode or rust. It will be lower non water-proof too. Wipe off dirt, using a soft cloth, etc. Do not use any chemical which may discolor in the case.
- [Metal band]**
- Keep the moisture and dirt, then it case corrode or rust. And the bands will be lower the durability, the strength. It soil the cuffs of clothing too. Use a soft dry cloth. Do not rub the leather because this may cause the color to fade. It cause to discolor when lights the strong light and ultraviolet rays.
- [Soft plastic band]**
- It is not necessary to take special care of urethane or nylon band. However, since some kind of dirt may

- irritate the skin, wash the band with fresh or soapy water occasionally. Do not use chemicals that might deteriorate the band, break and crack. Depending on usable years, the material may harden, crack or break. In this case, replace it with a new band.
- ② Be careful not to bring the case and the band into contact with the mercury (found inside a thermometer) or other chemicals, cosmetics, because they may discolor.
- ③ Tighten the band so that you can just slip one finger between the band and your wrist, in order to allow air to circulate. Do not store the leather band in high temperature or high humidity conditions.
- ④ Be careful the case and the band may comes off, drops when the pin used for the joint part of the case, the band and the joint parts pieces of the metallic band rusts. In rare case, you might also be injured.
- ⑤ Please stop wearing, in case the case and the band corrodes become sharp or the band pin jump up. And please consult your purchase shop or the Customer Service.

**(2) Treatment of the rotating bezel**

Your watch has the rotation bezel, that become damaged the watch function in the case, when stock dirt etc. under the rotation bezel. Brush off dirt using a soft toothbrush and keep it clean.

**(3) Recommended Overhaul**

- ① We recommend an overhaul which the mechanical watches every two to three years and the analog quartz oscillation watches is every three to four years. It can hold the movement lubrication or liquid leak, dry prevention, abnormal abrasion of the part. It keeps the daily accuracy too. And it can hold the waterproofness when the debased packing replaces, sweat and moisture don't enter the watch.
- ② When do your watch overhaul, contact to your purchase shop or the Repair Service Center. Please specify "genuine parts" and we also recommend replace the packing and spring bar too.

**◆ Warranty and service**

**※ Make sure to read the warranty card.**

**1. Warranty**

If the watch fails to operate under normal operation conditions within the warranty period, bring it to you r purchase shop or the Repair Service Center, along with its warranty card. We will repair or adjust your watch while it is under warranty free. Please read the warranty card well, the terms of the warranty are described.

**2. Possession periods of parts for repair**

Normally the repair parts for this watch will be available for seven years after production of the watch is discontinued.

**※Repair parts**

It is the part of the machine body (movement) for time functions of the product (watch) inside.

Other external parts not directly related to the function, such as the case, crystal, dial, hand, or crown, are not considered repair parts covered under the warranty. Replacement of these non repair parts may use parts different to the originals.

**3. Repair period**

As a rule, your watch repair is possible for the holding period if normal to use. However, the period during which repairs can be made will vary, depending on the operating conditions and environment in which the watch used. In some case, the precision cannot be restored by the watch condition. Therefore, bring your watch and make sure consult to your purchase shop to determine, when you repairs.

**4. Moving and gift item**

If you cannot go to your purchase shop since you moving or present from someone, contact the Customer Service for repairs.

**5. Inquiry about our product**

Please refer to 'Customer Service' for the inquiry about our products.

**6. Other inquiries**

If there are any other questions concerning warranty and service, contact the Customer Service.

**< Inquiry by Telephone >**

**●Customer Service**

Telephone: +81-42-847-3380  
09:30-17:00 Mon.-Fri.(except on holidays and company-designated holidays).

**< Reception of Items for Repair >**

**●Watches - Wearables Products Repair Center**

Address: Seiko Epson Corporation 421-8, Hino, Hino-shi, Tokyo 191-8501 Japan  
Telephone: +81-42-847-3378 Facsimile: +81-42-847-3381  
09:30~17:00 Mon.-Fri. (except on holidays and company-designated holidays).

**< Selling Agency >**

**EPSON SALES JAPAN CORPORATION**

Head Office: JR Shinjuku Miraina Tower, 4-1-6 Shinjuku, Shinjuku-ku, Tokyo 160-8801 Japan  
Telephone: +81 3-5919-5211

**< Manufacturer >**

**SEIKO EPSON CORPORATION**

Head Office: 3-3-5 Owa, Suwa-Shi, Nagano 392-8502 Japan  
Telephone: +81 266-52-3131