

comfee'



Instruction Manual

Model: MB-M25



Please read the manual before operating your kettle. Retain it for future reference.

Specifications

Product : RICE COOKER

Model : MB-M25

Rated voltage : 120V~

Rated frequency 60Hz

Rated power : 650W

IMPORTANT SAFEGUARDS

Basic safety precautions should always be followed when using electrical appliances, including the following:

- 1. Important: Read all instructions carefully before first use.**
2. Do not touch hot surfaces. Use the handles or knobs.
3. Use only on a level, dry and heat-resistant surface.
4. To protect against fire, electric shock and injury to persons, do not immerse cord, plug or the appliance in water or any other liquid. See instructions for cleaning.
5. Close supervision is necessary when the appliance is used by or near children.
6. Unplug from outlet when not in use and before cleaning. Allow unit to cool before putting on or taking off parts and before cleaning the appliance.
7. Do not operate any appliance with a damaged cord or plug or after the appliance malfunctions or has been damaged in any manner. Contact **Midea** customer service for examination, repair or adjustment.
8. The use of accessory attachments not recommended by **Midea** Housewares may result in fire, electrical shock or injury.
9. Do not use outdoors.
10. Do not let cord touch hot surfaces or hang over the edge of a counter or table.
11. Do not place on or near a hot gas or electric burner or in a heated oven.
12. Do not use the appliance for other than its intended use.
13. Extreme caution must be used when moving the appliance containing rice, hot oil or other liquids.
14. Do not touch, cover or obstruct the steam vent on the top of the rice cooker as it is extremely hot and may cause scalding.
15. Use only with a 120V AC power outlet.
16. Always unplug from the base of the wall outlet. Never pull on the cord.
17. The rice cooker should be operated on a separate electrical circuit from other operating appliances. If the electrical circuit is overloaded with other appliances, the appliance may not operate properly.

18. Always make sure the outside of the inner cooking pot is dry prior to use. If the inner pot is returned to the cooker when wet, it may damage or cause the product to malfunction.
19. Use extreme caution when opening the lid during or after cooking. Hot steam will escape and may cause scalding.
20. Rice should not be left in the inner cooking pot with the Keep-Warm function on for more than 12 hours.
21. To prevent damage or deformation, do not use the inner cooking pot on a stovetop or burner.
22. To disconnect, turn any control to OFF, then remove the plug from the wall outlet.
23. **CAUTION:** To reduce the risk of electrical shock, cook only in the removable inner cooking pot provided.
24. **Intended for countertop use only.**
25. **WARNING:** Spilled food can cause serious burns. Keep appliance and cord away from children. Never drape cord over edge of counter, never use outlet below counter, and never use with an extension cord.

SAVE THESE INSTRUCTIONS

Short Cord Instructions

1. A short power-supply cord is provided to reduce the risks resulting from becoming entangled in or tripping over a longer cord.



Polarized Plug

This appliance has a polarized plug (one blade is wider than the other); follow the instructions below:

To reduce the risk of electric shock, this plug is intended to fit into a polarized outlet only one way. If the plug does not fit fully into the outlet, reverse the plug. If it still does not fit, contact a qualified electrician. Do not attempt to modify the plug in any way.

If the supply cord is damaged, it must be replaced by the manufacturer, its service agent or a similarly qualified person in order to avoid a hazard.

THIS APPLIANCE IS FOR HOUSEHOLD USE ONLY.

PARTS IDENTIFICATION

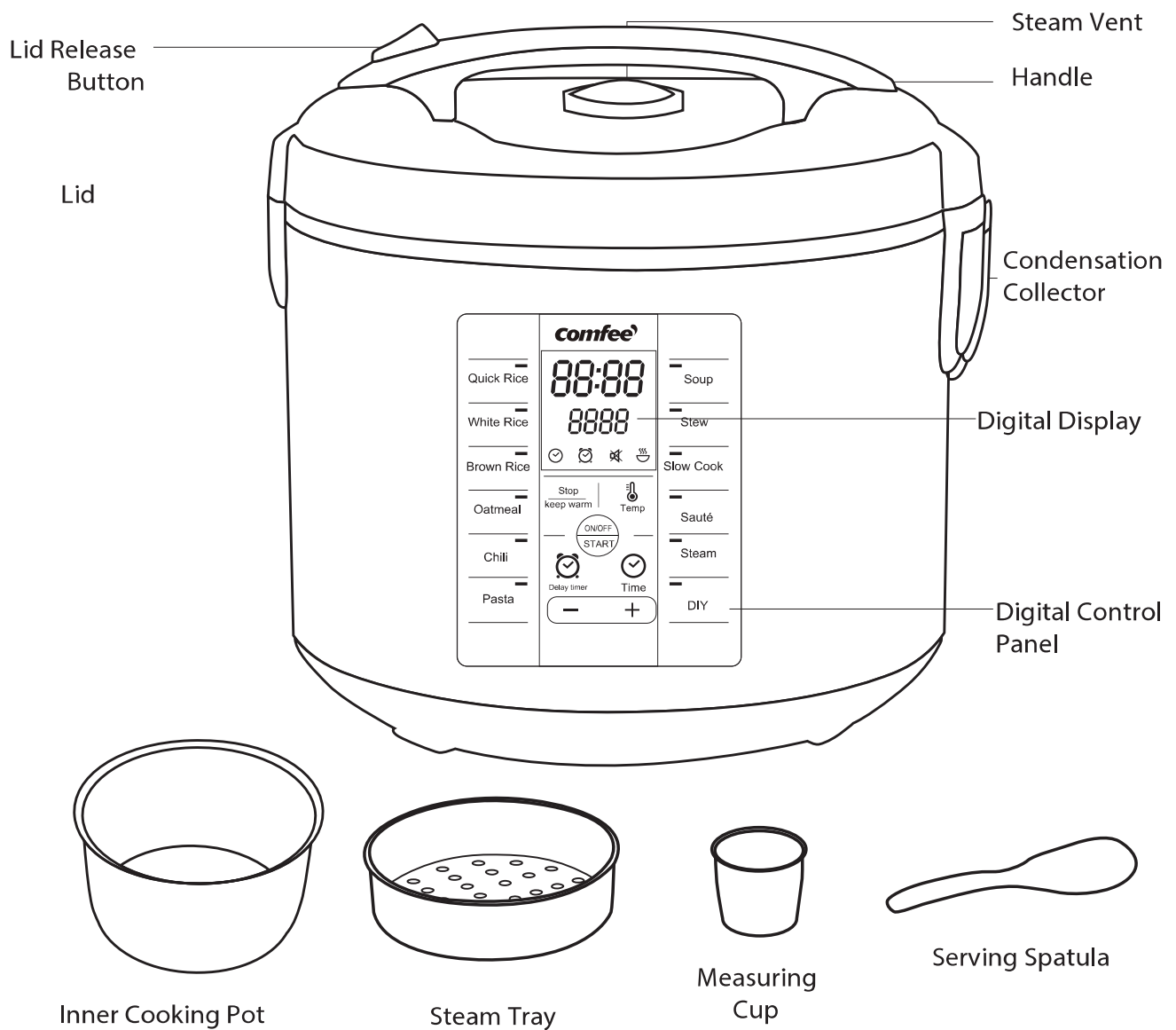

Digital Controls



Power Button/Keep-Warm

The POWER/KEEP-WARM button turns the rice cooker on and off and is perfect for keeping food warm and ready to serve.



Delay Timer

The DELAY TIMER button allows for rice to be ready when it's needed. Come home to delicious rice ready to eat!



White Rice

The WHITE RICE button cooks restaurant-quality rice automatically.



Brown Rice

The BROWN RICE button is ideal for cooking brown rice and other tough-to-cook whole grains to perfection.



Quick Rice

The QUICK RICE button is a great time-saving option for rice in a pinch.



Slow Cook

The SLOW COOK button sets for 2-10 hours for perfectly cooked soups and stews.



Sauté-Then-Simmer™

Aroma's patent-pending Sauté-Then-Simmer™ **Technology** will sauté foods at a high heat and automatically switch over to its simmer mode once liquid is added.



Steam

The STEAM button is perfect for healthy sides and main courses. Set the time food needs to steam and it will shut off once time has elapsed.

BEFORE FIRST USE

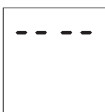
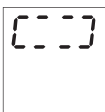

1. Read all instructions and important safeguards.
2. Remove all packaging materials and check that all items have been received in good condition.
3. Tear up all plastic bags as they can pose a risk to children.
4. Wash steam vent and all other accessories in warm, soapy water. Rinse and dry thoroughly.
5. Remove the inner cooking pot from rice cooker and clean with warm, soapy water. Rinse and dry thoroughly before returning to cooker.
6. Wipe body clean with a damp cloth.

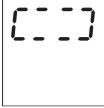
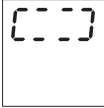
Function	Icon	Operation instructions
Standby		<ul style="list-style-type: none"> After switch-on, it is in standby state by default, "----" displaying on the digital screen.
Quick Rice		<ul style="list-style-type: none"> Normal Cooking: In standby state, after the "Quick Rice" button is pressed, the "Quick Rice" indicator is bright, and "□" is displayed on the digital screen; after the "START" button is pressed, "Quick Rice" cooking starts, and "----" scrolls on the digital screen. Preset Cooking: In standby state, after the "Quick Rice" button is pressed, and then "Delay timer" is pressed, preset time adjustment starts, the previous two digits of the nixie tube begin flashing, and hours are adjusted by pressure of "+" "-" buttons; after the "Time" button is pressed, the previous two digits of the nixie tube stop flashing, the last two digits start flashing, and minutes are adjusted by pressure of "+" "-" buttons. After completion of the setting, "START" button is pressed, "Quick Rice" preset cooking starts, the digital screen displays the end time of cooking and starts countdown. Exit of Working State: "Stop/Keep Warm" button is pressed to quit the current working state.

Function	Icon	Operation instructions
White Rice		<ul style="list-style-type: none"> ● Normal Cooking: In standby state, after the "White Rice" button is pressed, the "White Rice" indicator is bright, and "W" is displayed on the digital screen; after the "START" button is pressed, "White Rice" cooking starts, and "W" scrolls on the digital screen. ● Preset Cooking: In standby state, after the "White Rice" button is pressed, and then "Delay timer" is pressed, preset time adjustment starts, the previous two digits of the nixie tube begin flashing, and hours are adjusted by pressure of "+" "-" buttons; after the "Time" button is pressed, the previous two digits of the nixie tube stop flashing, the last two digits start flashing, and minutes are adjusted by pressure of "+" "-" buttons. After completion of the setting, "START" button is pressed, "White Rice" preset cooking starts, the digital screen displays the end time of cooking and starts countdown. ● Exit of Working State: "Stop/Keep Warm" button is pressed to quit the current working state.
Function	Icon	Operation instructions
Brown Rice		<ul style="list-style-type: none"> ● Normal Cooking: In standby state, after the "Brown Rice" button is pressed, the "Brown Rice" indicator is bright, and "B" is displayed on the digital screen; after the "START" button is pressed, "Brown Rice" cooking starts, and "B" scrolls on the digital screen. ● Preset Cooking: In standby state, after the "Brown Rice" button is pressed, and then "Delay timer" is pressed, preset time adjustment starts, the previous two digits of the nixie tube begin flashing, and hours are adjusted by pressure of "+" "-" buttons; after the "Time" button is pressed, the previous two digits of the nixie tube stop flashing, the last two digits start flashing, and minutes are adjusted by pressure of "+" "-" buttons. After completion of the setting, "START" button is pressed, "Brown Rice" preset cooking starts, the digital screen displays the end time of cooking and starts countdown. ● Exit of Working State: "Stop/Keep Warm" button is pressed to quit the current working state.





Function	Icon	Operation instructions
Oatmeal		<ul style="list-style-type: none"> ● Normal Cooking: In standby state, after the "Oatmeal" button is pressed, the "Oatmeal" indicator is bright, and "H00" is displayed on the digital screen; after the "START" button is pressed, "Oatmeal" cooking starts, the digital screen displays the end time of cooking and starts countdown. ● Preset Cooking: In standby state, after the "Oatmeal" button is pressed, and then "Delay timer" is pressed, preset time adjustment starts, the previous two digits of the nixie tube begin flashing, and hours are adjusted by pressure of "+" "-" buttons; after the "Time" button is pressed, the previous two digits of the nixie tube stop flashing, the last two digits start flashing, and minutes are adjusted by pressure of "+" "-" buttons. After completion of the setting, "START" button is pressed, "Oatmeal" preset cooking starts, the digital screen displays the end time of cooking and starts countdown. ● Setting of cooking time: In standby state, after the "Oatmeal" button is pressed, and then "Time" button is pressed, cooking time adjustment starts, the previous two digits of the nixie tube begin flashing, and hours are adjusted by pressure of "+" "-" buttons; after the "Time" button is pressed, the previous two digits of the nixie tube stop flashing, the last two digits start flashing, and minutes are adjusted by pressure of "+" "-" buttons. After completion of the setting, "START" button is pressed, "Oatmeal" cooking starts, the digital screen displays the end time of cooking and starts countdown. ● Exit of Working State: "Stop/Keep Warm" button is pressed to quit the current working state.

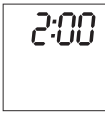

Function	Icon	Operation instructions
Chili		<ul style="list-style-type: none"> ● Normal Cooking: In standby state, after the "Chili" button is pressed, the "Chili" indicator is bright, and " :30 " is displayed on the digital screen; after the "START" button is pressed, "Chili" cooking starts, the digital screen displays the end time of cooking and starts countdown. ● Preset Cooking: In standby state, after the "Chili" button is pressed, and then "Delay timer" is pressed, preset time adjustment starts, the previous two digits of the nixie tube begin flashing, and hours are adjusted by pressure of "+" "-" buttons; after the "Time" button is pressed, the previous two digits of the nixie tube stop flashing, the last two digits start flashing, and minutes are adjusted by pressure of "+" "-" buttons. After completion of the setting, "START" button is pressed, "Chili" preset cooking starts, the digital screen displays the end time of cooking and starts countdown. ● Setting of cooking time: In standby state, after the "Chili" button is pressed, and then "Time" button is pressed, cooking time adjustment starts, the previous two digits of the nixie tube begin flashing, and hours are adjusted by pressure of "+" "-" buttons; after the "Time" button is pressed, the previous two digits of the nixie tube stop flashing, the last two digits start flashing, and minutes are adjusted by pressure of "+" "-" buttons. After completion of the setting, "START" button is pressed, "Chili" cooking starts, the digital screen displays the end time of cooking and starts countdown. ● Exit of Working State: "Stop/Keep Warm" button is pressed to quit the current working state.

Function	Icon	Operation instructions
Pasta		<ul style="list-style-type: none"> ● Normal Cooking: In standby state, after the "Pasta" button is pressed, the "Pasta" indicator is bright, and "0:20" is displayed on the digital screen; after the "START" button is pressed, "Pasta" cooking starts, the digital screen displays the end time of cooking and starts countdown. ● Setting of cooking time: In standby state, after the "Pasta" button is pressed, and then "Time" button is pressed, cooking time adjustment starts, the previous two digits of the nixie tube begin flashing, and hours are adjusted by pressure of "+" "-" buttons; after the "Time" button is pressed, the previous two digits of the nixie tube stop flashing, the last two digits start flashing, and minutes are adjusted by pressure of "+" "-" buttons. After completion of the setting, "START" button is pressed, "Pasta" cooking starts, the digital screen displays the end time of cooking and starts countdown. ● Exit of Working State: "Stop/Keep Warm" button is pressed to quit the current working state.
Function	Icon	Operation instructions
Soup		<ul style="list-style-type: none"> ● Normal Cooking: In standby state, after the "Soup" button is pressed, the "Soup" indicator is bright, and "2:00" is displayed on the digital screen; after the "START" button is pressed, "Soup" cooking starts, the digital screen displays the end time of cooking and starts countdown. ● Preset Cooking: In standby state, after the "Soup" button is pressed, and then "Delay timer" is pressed, preset time adjustment starts, the previous two digits of the nixie tube begin flashing, and hours are adjusted by pressure of "+" "-" buttons; after the "Time" button is pressed, the previous two digits of the nixie tube stop flashing, the last two digits start flashing, and minutes are adjusted by pressure of "+" "-" buttons. After completion of the setting, "START" button is pressed, "Soup" preset cooking starts, the digital screen displays the end time of cooking and starts countdown. ● Setting of cooking time: In standby state, after the "Soup" button is pressed, and then "Time" button is pressed, cooking time adjustment starts, the previous two digits of the nixie tube begin flashing, and hours are adjusted by pressure of "+" "-" buttons; after the "Time" button is pressed, the previous two digits of the nixie tube stop flashing, the last two digits start flashing, and minutes are adjusted by pressure of "+" "-" buttons. After completion of the setting, "START" button is pressed, "Soup" cooking starts, the digital screen displays the end time of cooking and starts countdown. ● Exit of Working State: "Stop/Keep Warm" button is pressed to quit the current working state.

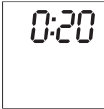
Function	Icon	Operation instructions
Stew		<ul style="list-style-type: none"> ● Normal Cooking: In standby state, after the "Stew" button is pressed, the "Stew" indicator is bright, and "1:00" is displayed on the digital screen; after the "START" button is pressed, "Stew" cooking starts, the digital screen displays the end time of cooking and starts countdown. ● Preset Cooking: In standby state, after the "Stew" button is pressed, and then "Delay timer" is pressed, preset time adjustment starts, the previous two digits of the nixie tube begin flashing, and hours are adjusted by pressure of "+" "-" buttons; after the "Time" button is pressed, the previous two digits of the nixie tube stop flashing, the last two digits start flashing, and minutes are adjusted by pressure of "+" "-" buttons. After completion of the setting, "START" button is pressed, "Stew" preset cooking starts, the digital screen displays the end time of cooking and starts countdown. ● Setting of cooking time: In standby state, after the "Stew" button is pressed, and then "Time" button is pressed, cooking time adjustment starts, the previous two digits of the nixie tube begin flashing, and hours are adjusted by pressure of "+" "-" buttons; after the "Time" button is pressed, the previous two digits of the nixie tube stop flashing, the last two digits start flashing, and minutes are adjusted by pressure of "+" "-" buttons. After completion of the setting, "START" button is pressed, "Stew" cooking starts, the digital screen displays the end time of cooking and starts countdown. ● Exit of Working State: "Stop/Keep Warm" button is pressed to quit the current working state.

Function	Icon	Operation instructions
Slow Cook		<ul style="list-style-type: none"> ● Normal Cooking: In standby state, after the "Slow Cook" button is pressed, the "Slow Cook" indicator is bright, and "2:00" is displayed on the digital screen; after the "START" button is pressed, "Slow Cook" cooking starts, the digital screen displays the end time of cooking and starts countdown. ● Preset Cooking: In standby state, after the "Slow Cook" button is pressed, and then "Delay timer" is pressed, preset time adjustment starts, the previous two digits of the nixie tube begin flashing, and hours are adjusted by pressure of "+" "-" buttons; after the "Time" button is pressed, the previous two digits of the nixie tube stop flashing, the last two digits start flashing, and minutes are adjusted by pressure of "+" "-" buttons. After completion of the setting, "START" button is pressed, "Slow Cook" preset cooking starts, the digital screen displays the end time of cooking and starts countdown. ● Setting of cooking time: In standby state, after the "Slow Cook" button is pressed, and then "Time" button is pressed, cooking time adjustment starts, the previous two digits of the nixie tube begin flashing, and hours are adjusted by pressure of "+" "-" buttons; after the "Time" button is pressed, the previous two digits of the nixie tube stop flashing, the last two digits start flashing, and minutes are adjusted by pressure of "+" "-" buttons. After completion of the setting, "START" button is pressed, "Slow Cook" cooking starts, the digital screen displays the end time of cooking and starts countdown. ● Exit of Working State: "Stop/Keep Warm" button is pressed to quit the current working state.

Function	Icon	Operation instructions
Saute		<ul style="list-style-type: none"> ● Normal Cooking: In standby state, after the "Saute" button is pressed, the "Saute" indicator is bright, and "  " is displayed on the digital screen; after the "START" button is pressed, "Saute" cooking starts, the digital screen displays temperature and the end time of cooking and starts countdown. ● Setting of cooking time: In standby state, after the "Saute" button is pressed, and then "Time" button is pressed, cooking time adjustment starts, the previous two digits of the nixie tube begin flashing, and hours are adjusted by pressure of "+" "-" buttons; after the "Time" button is pressed, the previous two digits of the nixie tube stop flashing, the last two digits start flashing, and minutes are adjusted by pressure of "+" "-" buttons. After completion of the setting, "START" button is pressed, "Saute" cooking starts, the digital screen displays temperature and the end time of cooking and starts countdown. ● Exit of Working State: "Stop/Keep Warm" button is pressed to quit the current working state.
Function	Icon	Operation instructions
Steam		<ul style="list-style-type: none"> ● Normal Cooking: In standby state, after the "Steam" button is pressed, the "Steam" indicator is bright, and "  " is displayed on the digital screen; after the "START" button is pressed, "Steam" cooking starts, the digital screen displays the end time of cooking and starts countdown. ● Preset Cooking: In standby state, after the "Steam" button is pressed, and then "Delay timer" is pressed, preset time adjustment starts, the previous two digits of the nixie tube begin flashing, and hours are adjusted by pressure of "+" "-" buttons; after the "Time" button is pressed, the previous two digits of the nixie tube stop flashing, the last two digits start flashing, and minutes are adjusted by pressure of "+" "-" buttons. After completion of the setting, "START" button is pressed, "Steam" preset cooking starts, the digital screen displays the end time of cooking and starts countdown. ● Setting of cooking time: In standby state, after the "Steam" button is pressed, and then "Time" button is pressed, cooking time adjustment starts, the previous two digits of the nixie tube begin flashing, and hours are adjusted by pressure of "+" "-" buttons; after the "Time" button is pressed, the previous two digits of the nixie tube stop flashing, the last two digits start flashing, and minutes are adjusted by pressure of "+" "-" buttons. After completion of the setting, "START" button is pressed, "Steam" cooking starts, the digital screen displays the end time of cooking and starts countdown. ● Exit of Working State: "Stop/Keep Warm" button is pressed to quit the current working state.

Function	Icon	Operation instructions
DIY		<ul style="list-style-type: none"> ● Cooking by default time and temperature: Cooking: In standby state, after the "DIY" button is pressed, the "DIY" indicator is bright, and "  " is displayed on the digital screen; after the "START" button is pressed, "DIY" cooking starts, the digital screen displays temperature and the end time of cooking and starts countdown. ● DIY Cooking: In standby state, after the "DIY" button is pressed, and then "Timer" is pressed, the hour indicator of the nixie tube begin flashing, and hours are adjusted by pressure of "+" "-" buttons; after the "Time" button is pressed, the minute indicator of the nixie tube begin flashing, and minutes are adjusted by pressure of "+" "-" buttons, and then "Temp" is pressed, the temperature number of the nixie tube begin flashing, and temperatures are adjusted by pressure of "+" "-" buttons; After completion of the setting, "START" button is pressed, "DIY" cooking starts, the digital screen displays temperature and the end time of cooking and starts countdown. ● Exit of Working State: "Stop/Keep Warm" button is pressed to quit the current working state.

TO CLEAN

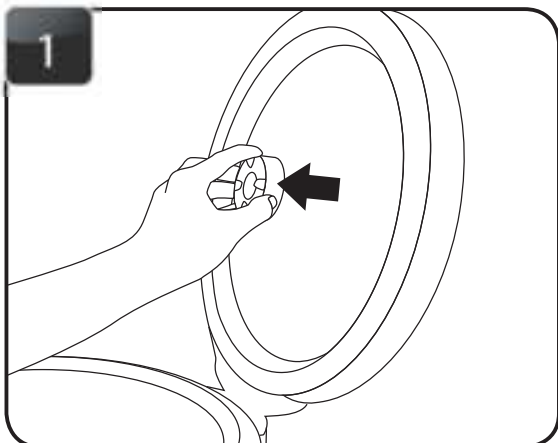

Remove the steam vent.

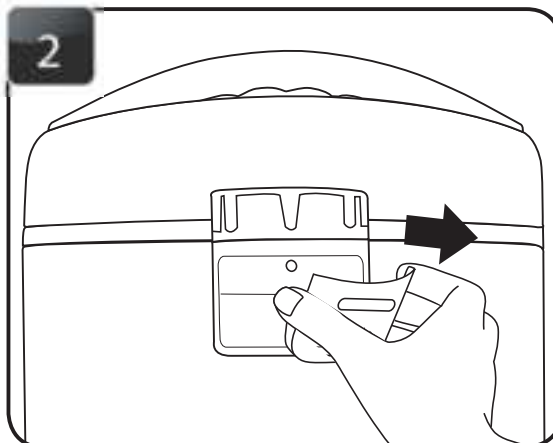

Remove the condensation collector.

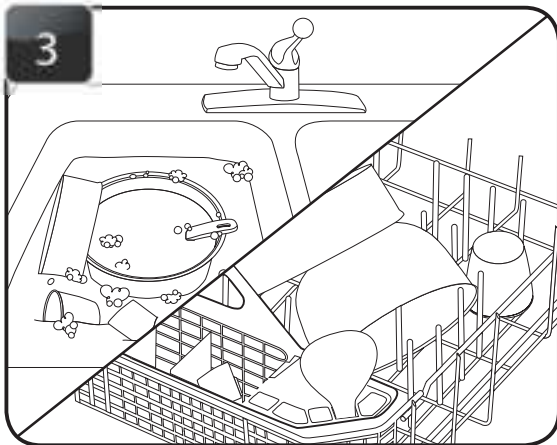

Handwash the inner cooking pot and all accessories or wash them in the dishwasher.

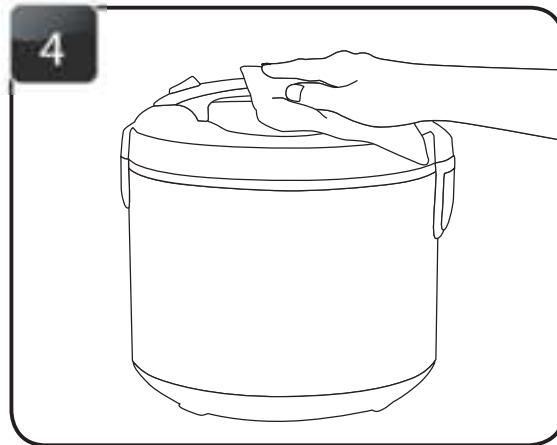

Wipe rice cooker body clean with a damp cloth.

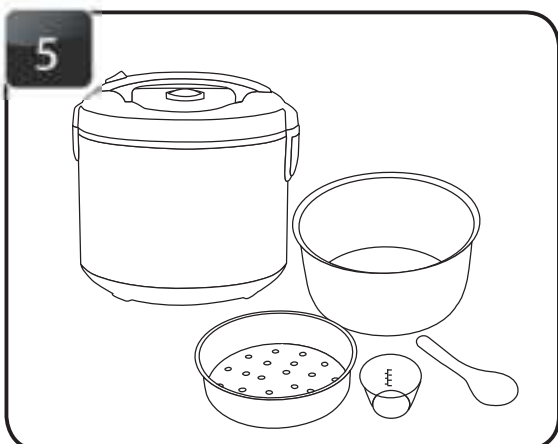

Thoroughly dry rice cooker body and all accessories.

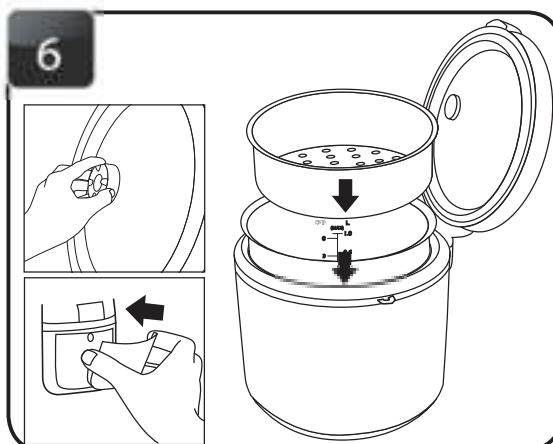

Reassemble for next use.

TROUBLESHOOTING

Because rice varieties may vary in their make-up, results may differ. Below are some troubleshooting tips to help you achieve the desired consistency.

Rice is too dry/hard after cooking.	If your rice is dry or hard/chewy when the rice cooker switches to Keep-Warm, additional water and cooking time will soften the rice. Depending on how dry your rice is, add ½ to 1 cup of water and stir through. Close the lid and press the QUICK RICE button. When rice cooker switches to Keep-Warm, open the lid and stir the rice to check the consistency. Repeat as necessary until rice is soft and moist.
Rice is too moist/soggy after cooking.	If your rice is still too moist or soggy when the rice cooker switches to Keep-Warm, use the serving spatula to stir the rice. This will redistribute the bottom (moistest) part of the rice as well as release excess moisture. Close the lid and allow to remain on Keep-Warm for 10-30 minutes as needed, opening the lid and stirring periodically to release excess moisture.
The bottom layer of rice is browned/caramelized.	The bottom layer of cooked rice may become slightly browned and/or caramelized during cooking. To reduce browning, rice should be rinsed before cooking to remove any excess starch. Stirring rice once it switches to Keep-Warm will also help to reduce browning/caramelizing.