

Quick Start Guide

S501



EN

DE

JA



English

1. Product Description

1.1 Packing List

Cutting Machine



Cutting Machine



Fine-point Blade

! A built-in 45° blade in the machine

Accessory Kit

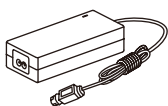

Power Adapter (01)



Power Cord (02)

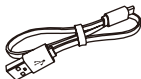

Type-C Cable (03)



Weeder (04)



Pen (05)

Materials Set

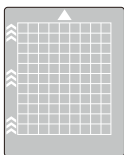

Cutting Mat (06)



Quick Start Guide

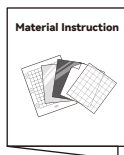

Material Instruction

! 4.5*6.5 in
11.43*16.51cm

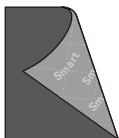

Smart Adhesive Vinyl (07)

! Works without the cutting mat

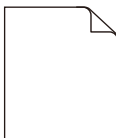

Vinyl (08)

! Works with the cutting mat

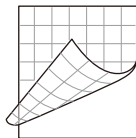

Transfer Tape (09)

! Helps transfer the design to the surface

! For more information on products please visit: www.likcut.com

1.2 Cutting Machine Parts

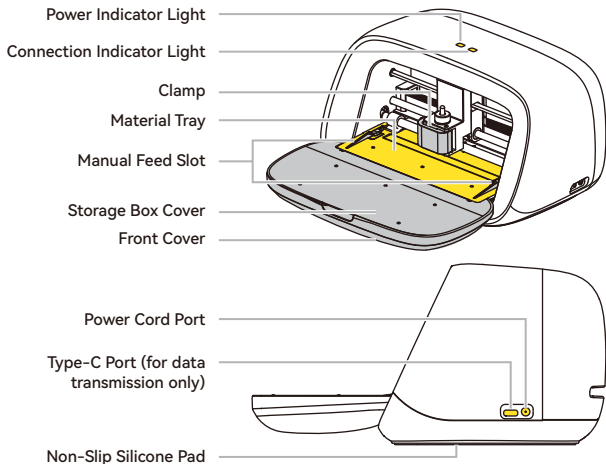

2. Preparation Before Use

2.1 Machine Inspection

Place the cutting machine on a flat, dry surface and leave a minimum of 20cm of space behind the machine for proper operation.

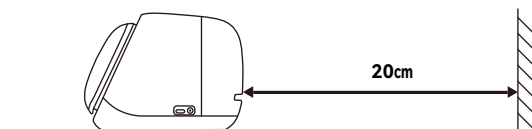

2.2 Blade Inspection

01 Open the front cover of the cutting machine.



02 Make sure the blade inside the clamp is correctly installed.

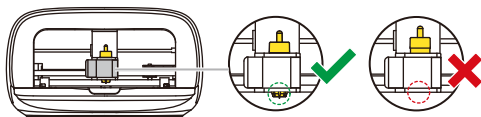

ⓘ The blade has been pre-installed properly upon delivery and is ready to use.

2.3 Power Supply Connection

01 Insert the power cord (02) into the power adapter (01).

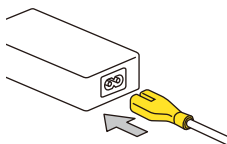

02 Insert the round end of the power adapter (01) into the power port of the machine.

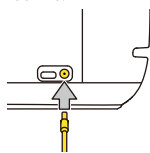

03 Insert the power cord (02) into an electrical outlet.

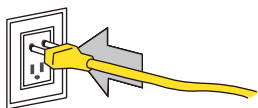

04 If the power indicator light on the top of the machine stays green, the machine is on.

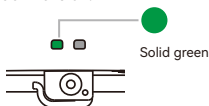

ⓘ If the connection indicator light flashes blue, the machine is ready for connection.

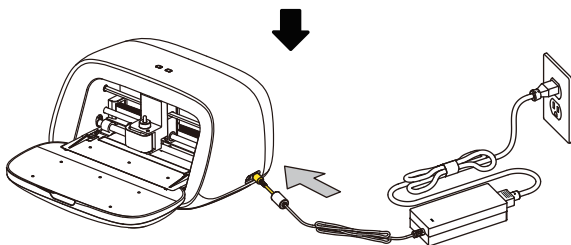

3. Software Download

3.1 Download the Mobile App

Method 1:

Search for the "Likcut" app on the App Store® or Google Play™ to download and install.



Method 2:

Scan the QR code to download the app. You can scan the QR code with your phone's camera, a code scanner built in the browser, or a code scanner app.



⚠ The Safari on Apple devices does not support code scanning. Please use the built-in code scanner of your device instead.

3.2 Download the Desktop App

Visit support.likcut.com to download and install the app.

⚠ Choose the installer package supported by your operating system.

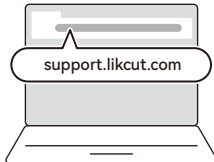

4. Quick Start Guide

4.1 For the Mobile App

01 Open the "Likcut" app.



02 Select or search for a design on the homepage and import it to the canvas.



! Please refer to the actual software version.

03 Adjust the design on the canvas to your preferred size, click [Make].

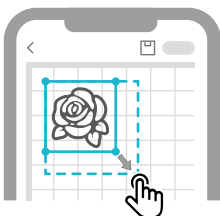

04 Please grant permissions and follow the instructions to connect the cutting machine.

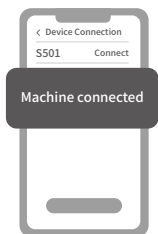
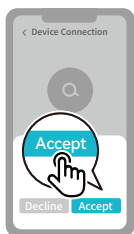

! Your phone will request necessary permissions for the connection.

05 Select the size of the cutting mat (06) and the corresponding material.



- 06** Feed the material, click [Start] once the detection is completed.

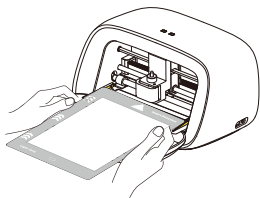

- 07** Take out the mat after the cutting is completed.

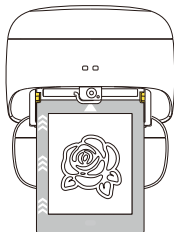

- 08** Use the weeder (04) on the mat to remove the excess parts of the design.

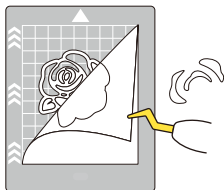

- 09** The weeding is completed.

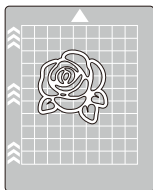

- 10** Remove the grid transfer tape (09), attach the adhesive side of transfer tape (09) to the design.

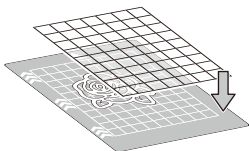

- 11** Use your hand or a tool to press the transfer tape (09) and then peel it away from the bottom.

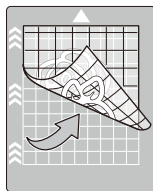

❗ If the design is not successfully transferred, please press more firmly on the design area of the tape.

- 12** Attach the design to a clean, flat and dry surface and press the design area tightly with your hands.



- 13** Remove the transfer tape (09).

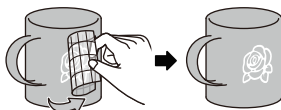

❗ If the design stays on the tape, it is recommended to press more firmly on the design area.

4.2 For the Desktop App

4.2.1 Wired Connection

- 01** Insert the Type-A (wider end) of the data cable (03) into the computer port.

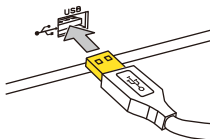

- 02** Insert the Type-C (narrow end) of the cable (03) into the cutting machine port.

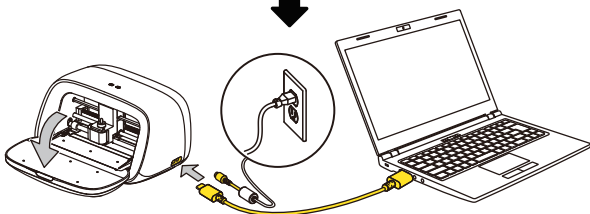
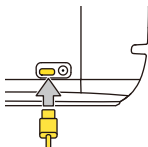

- 03** Open the desktop app.

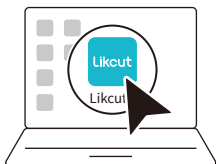

- 04** Select or search for a design on the homepage and import it to the canvas.

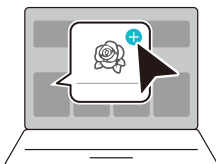

- 05** Adjust the design on the canvas to your preferred size, click [Make].

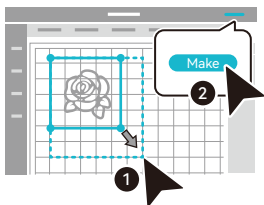

- 06** Select and connect your machine.

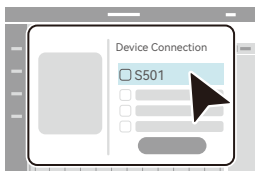

4.2.2 Wireless Connection

- 01** Turn on the settings on the computer as shown in the figure.

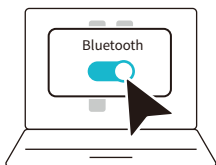

- 02** Open the desktop app.

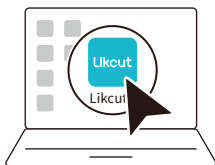

- 03** Select or search for a design on the homepage and import it to the canvas.

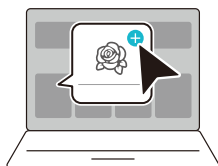

- 04** Adjust the design on the canvas to your preferred size, click [Make].

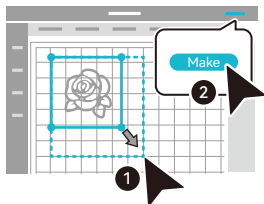

- 05** Select and connect your machine.

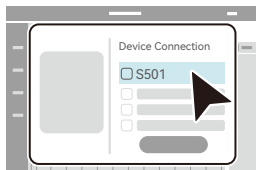

4.2.3 Guide After Connection

- 01** Select the size of the cutting mat (06) and the corresponding material.

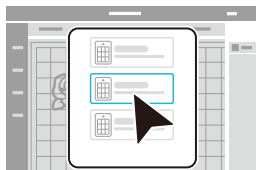



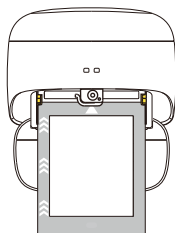



- 02** For mat loading and subsequent operations, please refer to Section 4.1 For the Mobile App Steps 6-13 in this guide.



5. Other Instructions

5.1 Indicator Light Instructions

Indicator Light Type	Status	Status Description
 Power Indicator Light	 Solid green	1. Power on; 2. The material detection is completed.
	 Flashing green	1. The material is under detection; 2. Cutting/Making
	 Flashing red	Malfunction
 Connection Indicator Light	 Solid blue	The cutting machine is connected.
	 Flashing blue	The cutting machine is ready for connection.

5.2 Safety Instructions

- 01** The weeder is sharp. Please use it carefully and keep it away from children.



- 02** To avoid any damage to the cutting machine, DO NOT insert the Cutting Mat or other materials from the back of the machine.

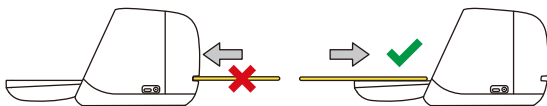

- 03** To avoid pinching, DO NOT touch inside of the cutting machine when it is running.



⚠ Make sure children DO NOT put their hands inside of the cutting machine.

- 04** The blade is sharp. Please use it carefully.



⚠ Please keep the blade away from children.

6. More Tutorials and Video Guides

Get more tutorials, video guides, and FAQs available via any of the following methods.

Method 1: Visit support.likcut.com.

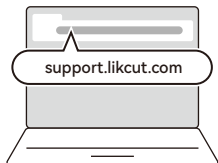

Method 2: Visit www.youtube.com/@Likcut_official.

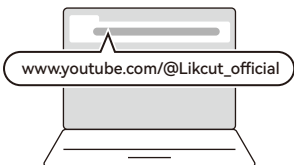

Method 3: Refer to the tutorials section in the "Likcut" app.

Mobile App

Go to [Profile] and click [Help & Feedback].



Desktop App

Go to [Profile] and click [Help & Feedback].



7. Information to User

7.1 FCC INFORMATION (U.S.A.)

FCC Compliance Statement :

This device complies with Part 15 of the FCC Rules. Operation is subject to the following two conditions: (1) This device may not cause harmful interference, and (2) this device must accept any interference received, including interference that may cause undesired operation.

FCC WARNING:

This equipment has been tested and found to comply with the limits for a Class B digital device, pursuant to Part 15 of the FCC Rules. These limits are designed to provide reasonable protection against harmful interference in a residential installation. This equipment generates, uses and can radiate radio frequency energy and, if not installed and used in accordance with the instructions, may cause harmful interference to radio communications. However, there is no guarantee that interference will not occur in a particular installation. If this equipment does cause harmful interference to radio or television reception, which can be determined by turning the equipment off and on, the user is encouraged to try to correct the interference by one of the following measures:

- Reorienting or relocating the receiving antenna.
- Increasing the separation between the equipment and receiver.
- Connecting the equipment to an outlet that is on a different circuit than the radio or TV.
- Consulting the dealer or an experienced radio/TV technician for help.

FCC Caution:

- Any changes or modifications not expressly approved by the party responsible for compliance could void the user's authority to operate this equipment.
- This product satisfies FCC regulations when shielded cables and connectors are used to connect the unit to other equipment. To prevent electromagnetic interference with electric appliances, such as radios and televisions, use shielded cables and connectors for connections.

FCC Radiation Exposure Statement:

This equipment complies with FCC radiation exposure limits set forth for an uncontrolled environment. This equipment should be installed and operated so there is at least 8 inches (20cm) between the radiator and your body. This device and its antenna(s) must not be co-located or operated in conjunction with any other antenna or transmitter.

7.2 ISED NOTICE (Canada)

This device contains licence-exempt transmitter(s)/receiver(s) that comply with Innovation, Science and Economic Development Canada's licence-exempt RSS(s). Operation is subject to the following two conditions: 1. This device may not cause interference. 2. This device must accept any interference, including interference that may cause undesired operation of the device.

This equipment complies with ISED radiation exposure limits set forth for an uncontrolled environment and meets RSS-102 of the ISED radio frequency (RF) Exposure rules. This equipment should be installed and operated keeping the radiator at least 20cm or more away from person's body.

7.3 AVS ISDE(Canada)

Cet appareil contient un émetteur (S)/ récepteur (S) exempté (S) de licence qui est conforme aux RSS(S) exemptés (S) de licence d'innovation, Science et développement économique Canada. Le fonctionnement est soumis aux deux conditions suivantes: 1. Cet appareil ne peut pas causer d'interférences. 2. Cet appareil doit accepter toute interférence, y compris les interférences qui peuvent causer un fonctionnement indésirable de l'appareil.

Cet équipement est conforme aux limites d'exposition aux rayonnements ionisants fixées pour un environnement non contrôlé et répond à RSS-102 des règles d'exposition aux rayonnements ionisants (RF). Cet équipement devrait être installé et utilisé en gardant le radiateur au moins 20cm ou plus loin du corps de la personne.

7.4 European Union

Information for users on collection and disposal of old equipment:



These symbols on the products, packaging, and/or accompanying documents mean that used electrical and electronic products should not be mixed with general household waste.

These symbols are only valid in the European Union. If you wish to discard these items, please contact your local authorities or dealer and ask for the correct method of disposal.

For more information about collection and recycling of old products, please contact your local municipality, your waste disposal service or the point of sale where you purchased the items.

Type of wireless	Radio Frequency	Maximum Output Power (EIRP)
Bluetooth	2400 ~ 2483.5 MHz	6 dBm

SIMPLIFIED EU DECLARATION OF CONFORMITY



Hereby, Changsha Benlei Technology Co., Ltd. declares that this product is in compliance with Radio Equipment Directive 2014/53/EU. The full texts of the EU declaration of conformity is available at the following internet address:
<https://www.Likcut.com>