



KOGAN 9.66" MIRROR DUAL DASH CAMERA

FRONT AND REAR

KADCAML101A

SAFETY & WARNINGS

Read all instructions and warnings in this user guide prior to first use. Retain this user guide for future reference.

- Do not operate the dash camera while driving to avoid possible accidents due to distracted attention.
- If the dash camera needs cleaning, use a soft cloth to gently wipe the product. Do not use any chemical agents to clean the dash camera.
- Do not store or use the dash camera in a humid environment or where there are inflammable, explosive or corrosive gases or liquids.
- Do not remove or insert the SD card when the dash camera is recording.
- Do not disassemble or repair the dash camera yourself. If the dash camera is damaged, stop use immediately and contact **help.Kogan.com** for assistance.
- This dash camera is intended for use in a motor vehicle only. Do not install the camera where it might block the driver's view of the road (including the mirrors) or the deployment of the airbag.
- Insert the SD card before using the dash camera.
- This dash camera has a small built-in battery used only for saving footage after the external power supply is cut off.
- Ensure there are no obstructions covering the camera lens.
- Do not leave the camera in direct sunlight for a long period of time or where the temperature could go above 75°C (including the car).

COMPONENTS

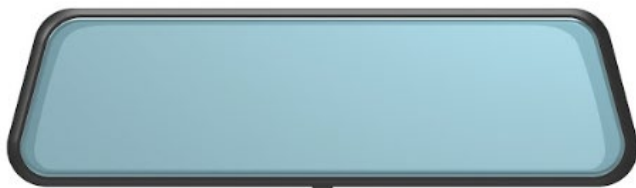

Dash camera



Hardware kit



Car charger



Rear camera



Rear camera cable



User guide

OVERVIEW



	Function	Description
1	Power	Press and hold for 3 seconds to manually turn the dash camera on/off.
		Press to turn the backlight on/off (this does not impact video recording).
2	Reset	Use a pin to press the reset button to reset and power off the dash camera.
3	Charging port	DC 5V.
4	Rear camera port	Connect the rear camera.
5	SD card slot	Insert an SD card (not provided). A 16GB or 32GB SD card with high speed (class 10 or above) is recommended.

INSTALLATION

Install the dash camera

Option 1: Car charger

1. Mount the dash camera over the original rearview mirror. When the camera is in place, fasten to the mirror using the included rubber rings.
2. Adjust the mirror angle according to your driving position to ensure you have a clear view.
3. Adjust the angle of the camera lens to ensure you get the best coverage over the bonnet and the road ahead.
4. Connect the camera to the cigarette lighter using the car charger.
5. Hide the rest of the cord in the gap of the interior trim board.

Option 2: hardware kit

For a more integrated option, install the dash camera using the included hardware kit.



Step 1: Open the fuse box. The location of the fuse box will differ depending on the car.



Step 2: Locate the ACC+ and BAT+ fuse slots.



Step 3: Connect the red wire to the ACC+ fuse slot. For 24 hour surveillance, connect the yellow wire to the BAT+ fuse slot. To only record when the car is on, connect the yellow wire to the ACC+ fuse slot.



Step 4: Connect the black wire to a ground.



Step 5: Test the camera.



Step 6: Route the camera cable through the trim board.

Note:

The hardware kit must be installed by a licensed auto electrician.

Install the rear camera

1. Install the rear camera above the number plate with the bracket facing upward.

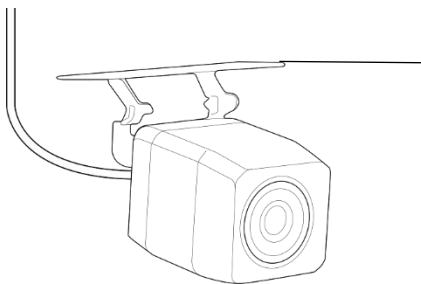

2. Connect the red wire to the positive reverse signal wire.
3. Route the camera cable to the front of the car.
4. Connect the black wire from the rear camera into the AV-IN port on the mirror.

Note:

The rear camera must be installed by a licensed auto electrician.

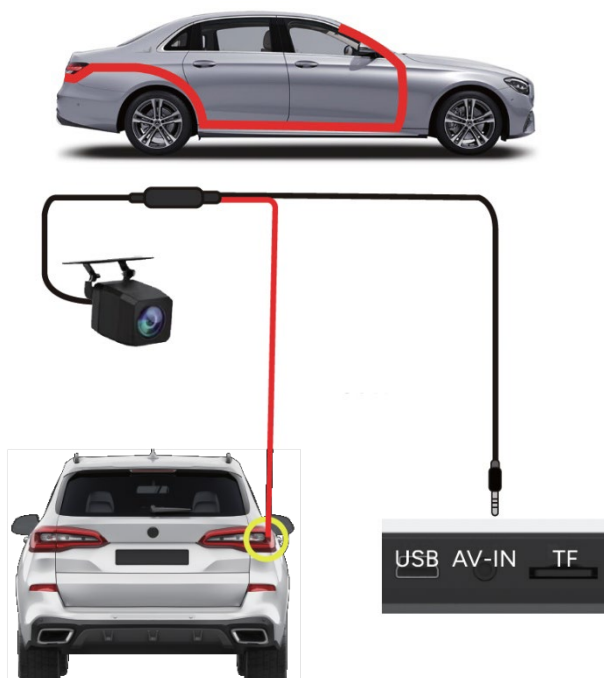

OPERATION

Main menu

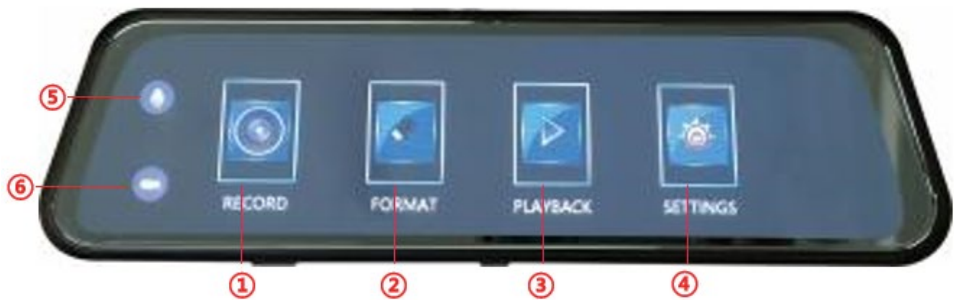

1	Record	Enter the camera menu.
2	Format	Format the SD card.
3	Playback	<ul style="list-style-type: none">• Playback videos and photos.• Unlock or delete recorded files.
4	Settings	Enter the settings menu.
5	Record video shortcut	Tap to begin recording.
6	Record audio/mute shortcut	Tap to record audio or mute.

Camera menu



1	Home	Tap to enter the main menu.
2	Audio	Tap to mute.
3	Lock	Lock the video while recording. Note: a locked video cannot be overridden. It must be deleted manually.
4	Video	Tap to start/stop recording footage.
5	Photo	<ul style="list-style-type: none">• When recording, tap to take a photo.• When in standby, tap to enter the photo menu and access photo settings.
6	Settings	Enter the video settings menu.
7	Lens display	Tap to display: <ul style="list-style-type: none">• Front camera full screen.• Rear camera full screen.• Split screen.
8	Lens adjusting key	Adjust the lens angle up/down when in full screen display.
9	Screen brightness	Adjust the screen brightness.

Video recording



Resolution	Choose between 1440P, 1296P and 1080P.
Display mode	Display front camera, rear camera, or split screen (front and back cameras displayed at the same time).
Loop recording	<ul style="list-style-type: none">• On: Continuously loop over old videos to prevent the SD card from getting full.• Off: Old videos will not be looped over, and no new footage will be captured. The SD card will need to be replaced to begin capturing footage again.
Exposure	Adjust the exposure.
Motion detection	The camera will start recording when motion is detected and will automatically turn off after 30 seconds. Note: If loop recording is disabled and motion detection is enabled, the SD card will fill up quickly.
G-sensor	When enabled, the current video will automatically lock during impact.
Format	Format the SD card.
Parking monitor	When activated, the dash camera will continue to record video footage when the vehicle is parked, and the engine is off. It uses the motion detection function to trigger recording.
Watermark	Display a watermark over the video.

Recording settings



Auto screen off	When the selected duration is reached without the camera being operated, the screen will automatically turn off. The camera will continue to record as normal.
Frequency	50Hz/60Hz.
Key sound	Turn the key sound on/off.
Language	Change the language. English is the default.
Date & time settings	Adjust the date and time.
Format	The SD card will be formatted and the files inside the card will be cleared.
Default	Restore to factory settings.
Version	Version number.

Photos



Photo quality	Adjust the photo quality to suit the photo size.
Take photo	Take a normal or timer photo.
Continuous shooting	When enabled, photos will be taken in bursts of 3.
Watermark	A 'Day-Month-Year' watermark will display on the photo.

Playback

Edit, delete or lock the videos/pictures.



SPECIFICATIONS

Display	9.66 inch HD screen
Lens	Full glass and grade high resolution multi-layer filter and wide-angle lens.
Front camera resolution	2304x1296P
Rear camera resolution	1280x720P
Lens perspective	170 degrees
Languages	English
Storage	SD card up to 64GB (not included)
Photo resolution	12M/8M/5M/2MHD 1.3M/VGA
Video format	MOV
Photo format	JPG
Storage temperature	-30°-70°C
Battery	Built-in lithium polymer
Power	5V 2A

TROUBLESHOOTING

Problem	Possible Cause	Solution
The dash camera automatically stops when recording.	The SD card is full.	<ul style="list-style-type: none">• Replace the SD card.• Enable the loop recording function.
	The SD card is incompatible.	Ensure the SD card is high speed (above C10).
	There may be too many locked videos on the SD card, which can prevent loop recording.	Delete locked videos.
The recoded footage is not fluent or is jammed.	The SD card is incompatible.	<ul style="list-style-type: none">• Format the SD card in the camera.• Use a high-quality SD card.
There are stripes over the footage or photo.	The frequency is incorrect.	Adjust the frequency to 50HZ or 60HZ.
The footage pauses automatically when viewing it on a computer.	The SD card is incompatible.	<ul style="list-style-type: none">• Use a compatible SD card.
	The computer is incompatible.	<ul style="list-style-type: none">• Use a different media player.
The camera battery only lasts for a short time.	The built-in battery is very small for safety reasons and is not designed to work alone.	Keep the camera connected to an external power supply.

Need more information?

We hope that this user guide has given you the assistance needed for a simple set-up.

For the most up-to-date guide for your product, as well as any additional assistance you may require, head online to **help.kogan.com**

kogan.com