

Birdfy

Birdfy Camera User Manual

EN

ES

Warning

Note: This equipment has been tested and found to comply with the limits for a Class B digital device, pursuant to part 15 of the FCC Rules. These limits are designed to provide reasonable protection against harmful interference in a residential installation. This equipment generates, uses and can radiate radio frequency energy and, if not installed and used in accordance with the instructions, may cause harmful interference to radio communications. However, there is no guarantee that interference will not occur in a particular installation. If this equipment does cause harmful interference to radio or television reception, which can be determined by turning the equipment off and on, the user is encouraged to try to correct the interference by one or more of the following measures:

- Reorient or relocate the receiving antenna.
- Increase the separation between the equipment and receiver.
- Connect the equipment into an outlet on a circuit different from that to which the receiver is connected.
- Consult the dealer or an experienced radio/TV technician for help.

This device complies with part 15 of the FCC Rules. Operation is subject to the following two conditions: (1) This device may not cause harmful interference, and (2) this device must accept any interference received, including interference that may cause undesired operation.

Any changes or modifications made without explicit approval from the responsible party in compliance may result in the user being unauthorized to operate the device.

This device meets the FCC radiation exposure limits for uncontrolled environments. To ensure safe installation and operation, maintain a minimum distance of 20cm between the radiator and your body.

FCC ID: 2AO8RNI-8202W

CE Statement

The information provided on the packaging is allowed to identify geographical areas within the member states where restrictions on use or requirements for authorized use exist, if applicable.

The structure of the product allows it to be used in at least one member state without violating applicable requirements for the use of radio spectrum.

Manufacturer information:

Netvue Technologies Co.,Ltd.

Room A502, Shenzhen International Technology Innovation Academy, 10th Kejinan Road, Shenzhen Science Park, Nanshan District, Shenzhen, P.R.China, 518000

V-Birdfy Camera-A5-20230829

Catalog

1. What's in the Box	1
2. Inserting MicroSD Card	5
3. Camera Charging	7
4. How to Turn on & off the Camera	8
5. Read Before Installing	9
6. AI Bird Identification	10

Catálogo

1. Qué hay en la caja	15
2. Cómo insertar una tarjeta MicroSD	19
3. Carga de la cámara	21
4. Cómo encender y apagar la cámara	22
5. Leer antes de instalar	23
6. Identificación de aves mediante IA	24

What's in the Box

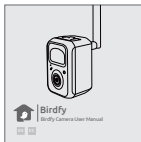

User Manual



Quick Guide

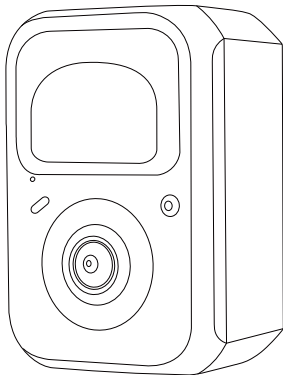

Birdfy Camera



Antenna



Ejector Pin

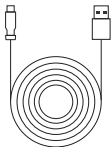

Charging cable

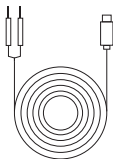

Connection cable
for solar panel

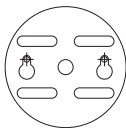

Drilling template

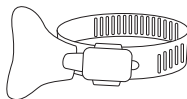

X 2

Hose clips



X 3

Anchors



X 3

Screws



Mounting arm



Mounting bracket



Nut



X 2

Spacer ring

Inserting MicroSD Card

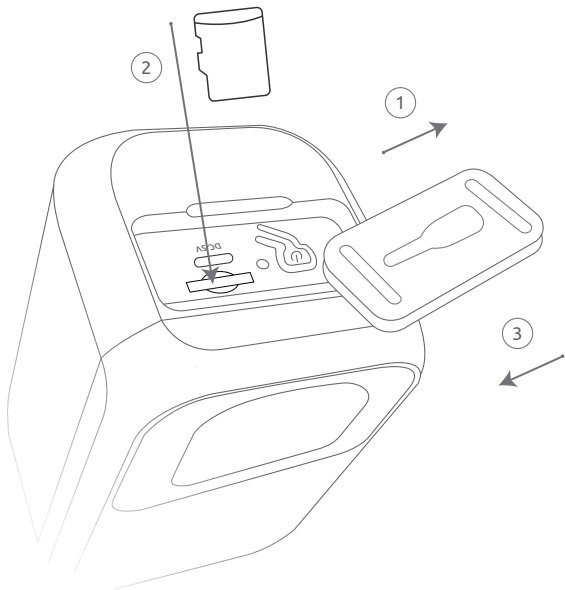

Birdfy Camera comes with a built-in card slot which supports Class 10 microSD cards with capacities of up to 128GB.

Step 1: Open the silicone cover.

Step 2: Insert the microSD card. Make sure it is properly positioned with the label facing upward.

Step 3: Put back the silicone cover.

Camera Charging

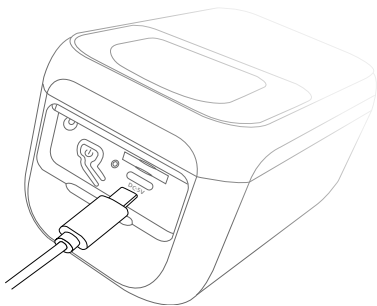

The camera does not come fully charged due to safety regulations. Before using it for the first time, please charge it for 14 hours with the charging cable inside the box (DC5V / 1A).

Status light is solid yellow: charging

Status light is solid green: fully charged

How to Turn on & off the Camera

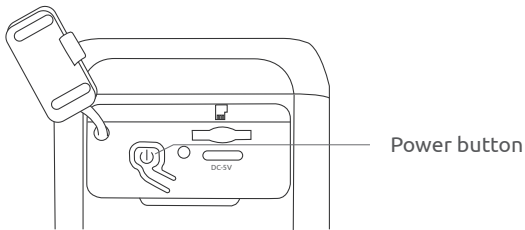

Turn on&off the camera:

Long press the power button at the top of the camera.

Read Before Installing

1. Keep Birdfy Camera and all accessories out of the reach of children and pets.
2. Make sure the camera is fully charged (DC5V / 1A).
3. Working temperature: -10°C to 50°C (14°F to 122°F)
Working relative humidity: 0-95%
4. Please avoid exposing the camera lens to direct sunlight.
5. The camera has an IP65 waterproof rating, which allows it to function properly in rainy or snowy conditions. However, it should not be submerged in water.

Note:

1. Birdfy Camera only works with 2.4GHz Wi-Fi.
2. Strong light may interfere with the device's ability to scan QR codes.
3. Avoid placing the device behind furniture or near a microwave oven. Please try to keep it in the range of your Wi-Fi signal.

AI Bird Identification

With AI Bird Identification, you can find out in real-time which bird species are visiting your feeder. A subscription is required to access this feature.



Learn more on
my.birdfy.com



Scan the QR code to access
the FAQ for the product.