

尺寸: 75*75mm

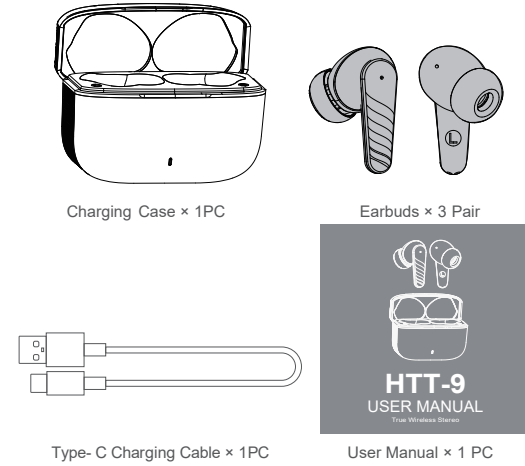

Package Contents



Product Overview

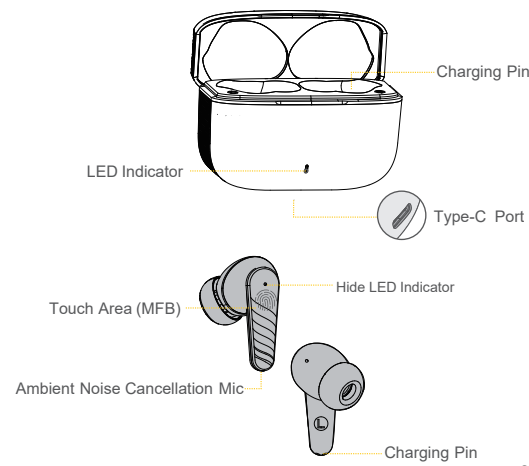

Touch Control Diagram

The touch area (MFB Touch Panel) is located in the upper part of earbuds handle.

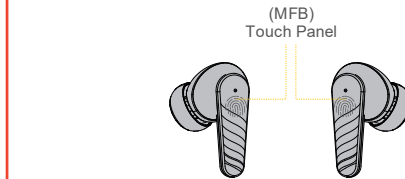

Wearing Earbuds

Note: The left earbud marked with L is worn in the left ear, and the right earbud marked with R is worn in the right ear.

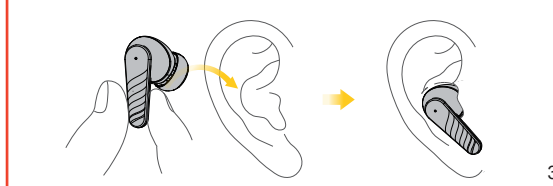

Power ON/ OFF

Power on
Auto: Open the charging case and take out the earbuds to power on
Manually: Press and hold the MFB for 2s.

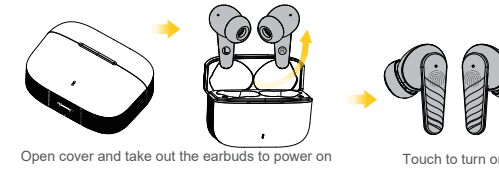

Power off
Auto: Place both Earbud in your charging case, Close the lid.
Manually: Press and hold the MFB for 5s.

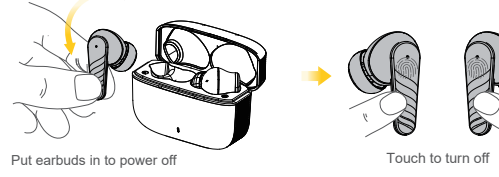

Pairing

1. Open the charging case, and take out the earbuds, earbud will pair automatically, One of the earbuds flashes blue and red, the another earbud light goes out.
2. Activate Bluetooth on the device, turn on Bluetooth, search for pairing name "HTT-9" and click on it.

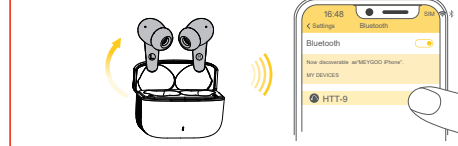

Tips: Next use, Open the charging case, earbuds auto connect phone.

Single Mode

When on dual mode, put one earbud into the charging case. Only take one earbud out of the charging case and connect it.



Bluetooth Lost

1. Turn off mobile phone's Bluetooth, earbuds will enter the pairing mode and can pair with other devices.
2. If the connection range is exceeded, the earbuds will enter the back connection mode. No connection within 5 minutes, the earbuds will turn off

Notes For Signal Transmission Distance (as illustrate)

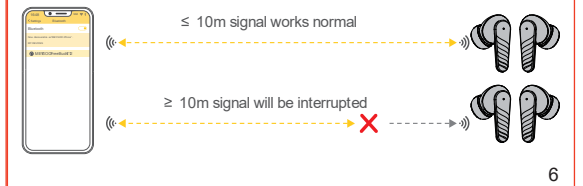

Reset

If your earbuds accidentally only get one earbud to work, or fail to pair, please reset the earphone.

- Delete all "HTT-9" Bluetooth records on the phone, and turn off Bluetooth
- Put earbuds into charging case, and then take out to pairing modes, tap L & R MFB 5 times simultaneously, hear "DU" prompt voice to clear all pairing.
- Put earbuds into charging case.

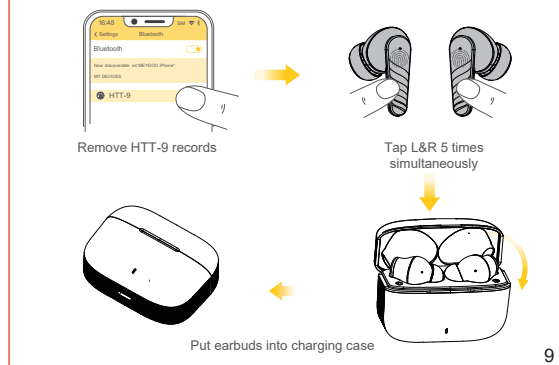

Touch Operation

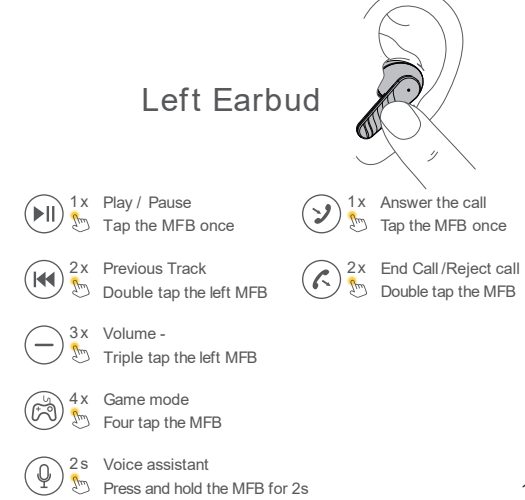

Touch Operation

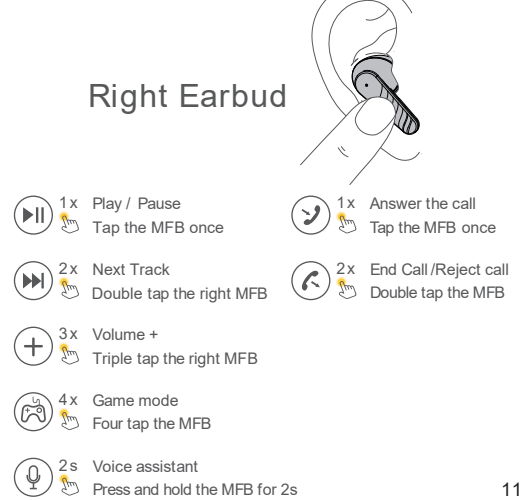

Earbuds low battery alarm

When the battery power is low, every 1 minute voice reminder "Lower battery" and Red light double flashing, until the battery power is run out and turn off.



Charge your earbuds

Place your earbuds the charging case and close the lid, earbuds automatically complete charge.

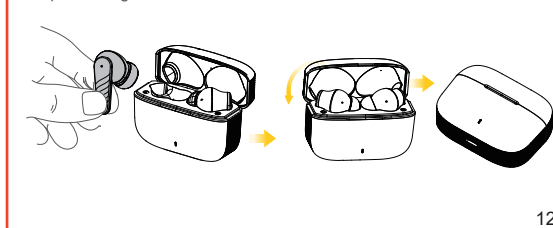

Product Parameter

Earbud(each)	
Model Name:	HTT-9
Bluetooth Version:	V5.4
Speaker:	Φ13mm
Bluetooth Range:	10m/ 33ft(with out obstacles)
Technology:	HSP/ HFP/ A2DP/ AVRCP
Frequency Range:	20Hz~20KHz
Weight:	3.5g
Size:	33*18*19mm
Charging Time:	0.5H
Battery Capacity:	40mAh
Play Music Time:	6H
Input:	DC 5V == 0.08A
Charging Case	
Weight:	33g
Size:	62*46*26mm
Charging Time:	2H
Battery Capacity:	400mAh
Input:	DC 5V == 0.3A

Earbuds Warning

- Please do not place the product in an environment where the temperature is too low(above 45°C or below 0°C).
- Do not dismantle or repair the earbuds under any circumstances, if necessary, please send the product to the seller for repair.
- Do not throw and drop the earbuds to avoid damage.
- The earbuds and the BT devices will be disconnected if the distance between them is more than 10 meters.
- Keep the device and accessories away from children and pets.
- Do not put the earbuds into the washing machine.

Battery Warning

- The battery in the product may cause fire disaster or risk of chemical burning if mishandled.
- Please charge with a rated voltage charger.
- The discard of battery should obey local law, if possible please recycle it. Do not dispose it as household garbage, because it may cause a explosion.
- Users are not allowed to take out or replace battery in the product unless there is a stipulation on user manual. It is very hazardous to do this, may cause a damage to product.



NOTE: This equipment has been tested and found to comply with the limits for a Class B digital device, pursuant to part 15 of the FCC Rules. These limits are designed to provide reasonable protection against harmful interference in a residential installation. This equipment generates, uses and can radiate radio frequency energy and, if not installed and used in accordance with the instructions, may cause harmful interference to radio communications. However, there is no guarantee that interference will not occur in a particular installation. If this equipment does cause harmful interference to radio or television reception, which can be determined by turning the equipment off and on, the user is encouraged to try to correct the interference by one or more of the following measures:

- Reorient or relocate the receiving antenna.
- Increase the separation between the equipment and receiver.
- Connect the equipment into an outlet on a circuit different from that to which the receiver is connected.
- Consult the dealer or an experienced radio/TV technician for help.

Changes or modifications not expressly approved by the party responsible for compliance could void the user's authority to operate the equipment.

This device complies with Part 15 of the FCC Rules. Operation is subject to the following two conditions:
(1) this device may not cause harmful interference, and (2) this device must accept any interference received, including interference that may cause undesired operation.

FCC ID: 2BONF-HTT-9