



HyperX Clutch



| Part Numbers |
|--------------|
| 516L8AA |

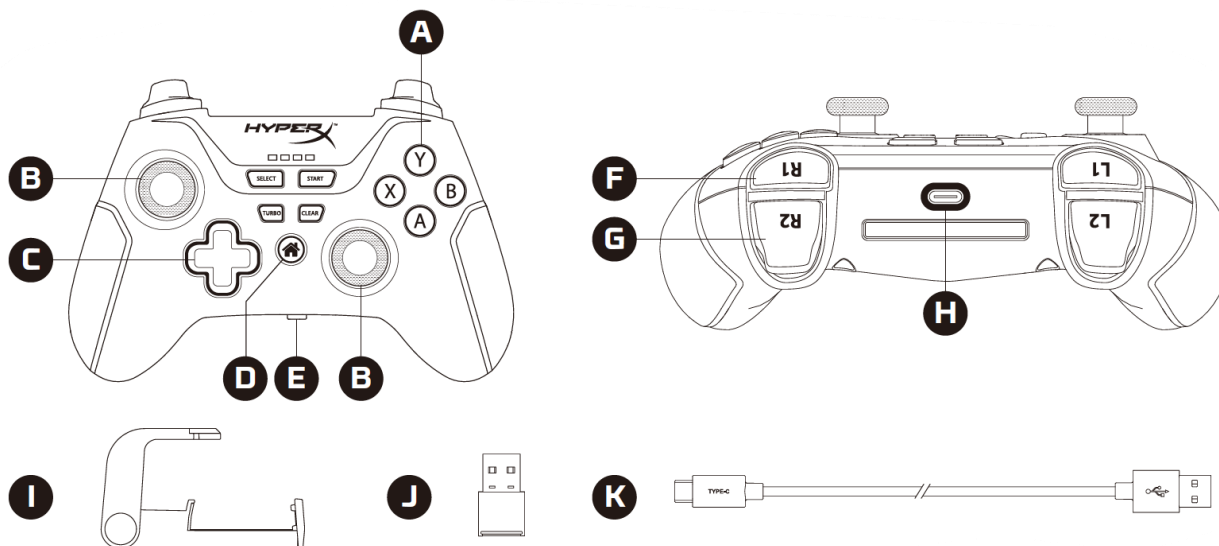

TABLE OF CONTENTS

| | |
|----------------------------------|---|
| Overview..... | 3 |
| Specifications | 4 |
| Setup..... | 5 |
| Charging | 5 |
| Mode Selection | 5 |
| Pairing and Connecting | 6 |
| Usage..... | 7 |
| Calibration..... | 8 |
| Reset..... | 8 |
| X-Input & DirectInput..... | 9 |
| Questions or Setup Issues? | 9 |



Overview



A. Action buttons

D. Home button

G. Triggers
(L2 / R2)

J. 2.4GHz
wireless adapter

B. Analog sticks

E. Mode selection
switch

H. USB-C port

K. USB-C to
USB-A cable

C. D-Pad

F. Bumpers
(L1 / R1)

I. Convertible
mobile clip



Specifications

Controller Specifications

| | |
|-----------------|-------------------------------------|
| Connection type | 2.4GHz Wireless / Bluetooth / Wired |
| Compatibility | Android, PC |

Battery Specifications

| | |
|------------------|-----------------|
| Battery life | Up to 19 hours* |
| Battery capacity | 600mAh |

Physical Specifications

| | |
|------------------------|-------------------------------|
| Length | 110.3mm** |
| Height | 75.1mm** |
| Width | 155.6mm |
| Mobile clip dimensions | 41mm – 86mm |
| Weight (without cable) | 270g** |
| Cable type and length | Detachable USB-C cable, 2.95m |

*Battery life varies based on usage

**With phone clip installed



Setup

Charging

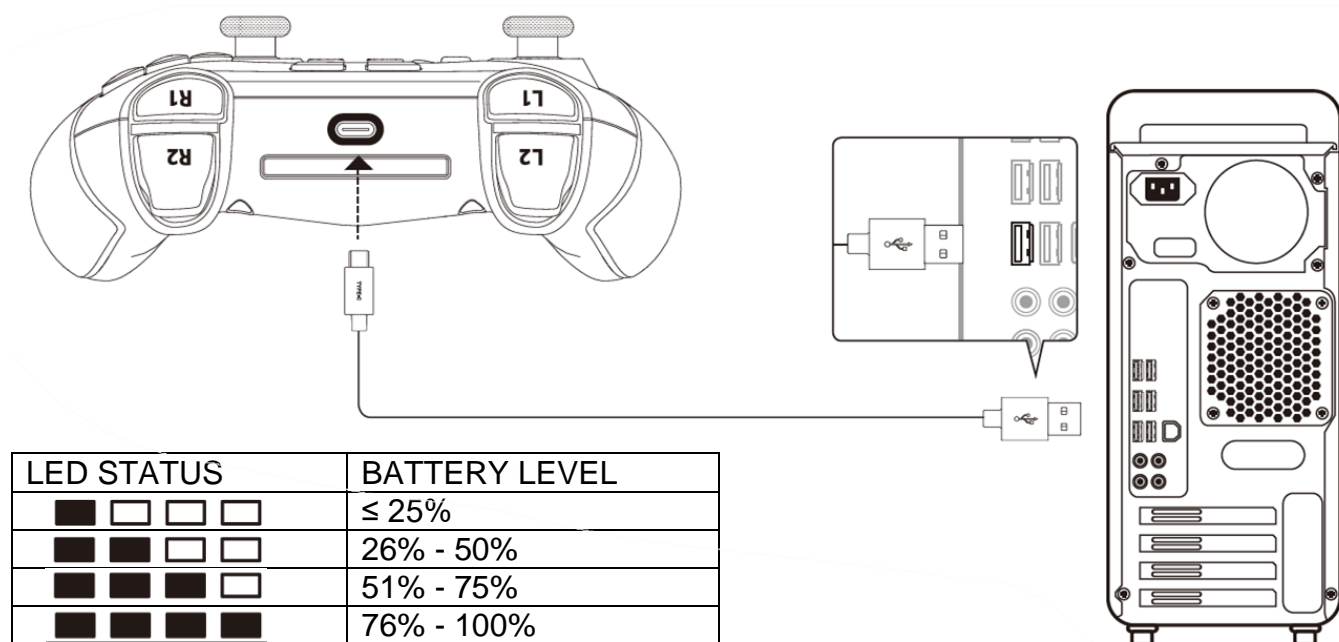

It is recommended to fully charge the controller before first use.

Mode Selection

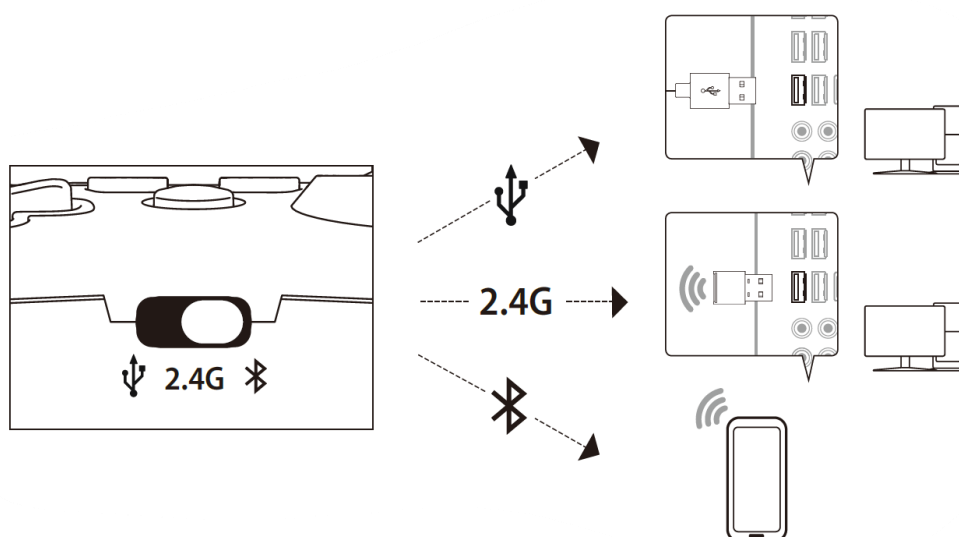



Pairing and Connecting

The controller must be powered off before attempting to enter pairing mode.

2.4G

1. Set the mode selection switch to 2.4G.
2. Connect the 2.4GHz wireless adapter to the PC.
3. Tap the *Home* button. The controller will power on and attempt to connect to the 2.4GHz wireless adapter.
 - If the controller has lost its pairing with the dongle, repeat steps 1-2 then press and hold the *Home* button for 6 seconds until the LEDs animate to indicate pairing mode.
 - Bring the controller within range of the dongle to complete pairing.

Bluetooth

1. Set the mode selection switch to Bluetooth.
2. Press and hold the *Home* button for 6 seconds until the LEDs animate to indicate pairing mode.
3. On your Bluetooth-enabled device, search and connect to “HyperX Clutch.”

USB

1. Set the mode selection switch to USB.
2. Plug in the USB-C cable into the controller.
3. Plug in the USB-A cable into your PC
4. Windows will recognize the controller as “HyperX Clutch”

Usage

Power On – 2.4G or Bluetooth Mode

Press and release the Home Button to power the controller. The controller will attempt to connect to the previously paired device.

Power Off

The controller will automatically shut off after 5 minutes of inactivity. The Clutch can also be manually shut off by toggling the mode selector switch.

Handheld Mode

Attach the mobile clip and insert mobile device

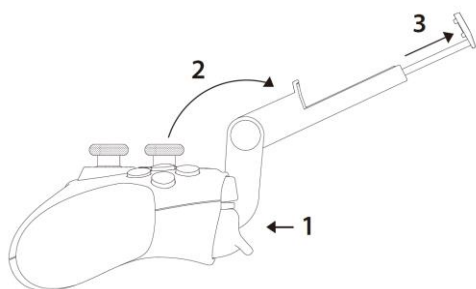



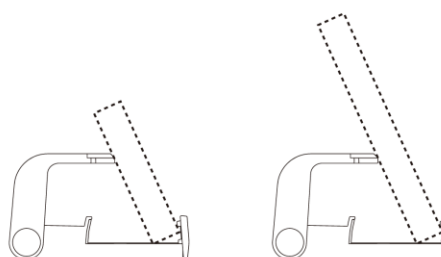

Tabletop Mode

Fold the clip to use as a phone or tablet stand



Turbo

Turbo can be assigned to individual buttons to emulate repeated button presses. After setting Turbo, press and hold the desired button. Turbo can only be assigned to *L3*, *R3*, *A*, *B*, *X*, *Y*, *LT*, *RT*, *LB*, *RB* and *D-Pad*.

| Button Combination | Function |
|---|--------------------------------------|
|  + <i>Button</i> | Programs Turbo to the desired button |
|  + <i>Button</i> | Clears Turbo from the desired button |
|  +  Hold for 5 seconds | Clears all Turbo assignments |



Calibration

Calibration can address issues related to the analog sticks and triggers.

1. Set the mode selection switch to USB.
2. Press and hold the *SELECT* and *START* buttons while connecting the controller to a PC using the included USB-C cable.
3. Continue to hold *SELECT* and *START* until the LED indicators flash (approximately 4 seconds).
4. Conduct calibration
 - Rotate the left and right analog sticks three times each and allow to return to neutral position.
 - Press and release the left and right triggers and allow to return to neutral position
5. Press *Y* + *D-Pad DOWN* to save and exit calibration mode.

Reset

The controller can be manually power cycled by pressing the pin hole button on the rear of the controller.

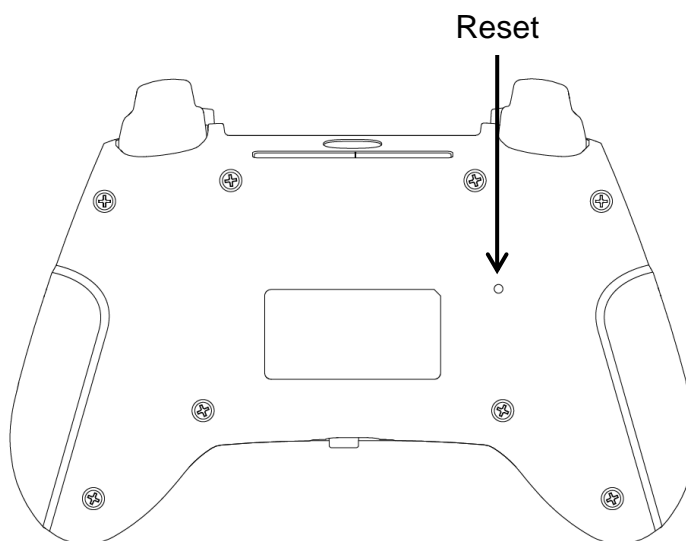



X-Input & DirectInput

On PC, the controller supports both X-Input and DirectInput functionality. By factory default, the controller is in X-Input Mode and will save the last Input Mode selected.

Switch between X-Input and DirectInput

1. Place the controller in 2.4G or USB mode.
2. Turn on and connect the controller. The LED indicators should be showing the controller's battery level.
3. Hold the Home Button for 3 seconds until the LED indicators flash.

When LED 1 & 3 flash twice and return to normal, the controller is in X-Input Mode.



When LED 2 & 4 flash twice and return to normal, the controller is in DirectInput Mode.



While in Bluetooth mode, the controller will operate in DirectInput mode and switching between X-Input and DirectInput Mode is disabled.

Questions or Setup Issues?

Contact the HyperX support team at: hyperx.gg/support