

# Triple+CLM™

## Water Leak Mitigation System Self Installation Guide



Thank you for purchasing  
the Triple+ CLM™ Mitigation system.

### IN THE KIT

1 x HUB



**Box Contains:**

- Power adapter
- 2 X AA Backup batteries

3 x Flood  
Detector



**Box Contains:**

- 2 X AAA batteries

1 x Rope  
Detector



**Box Contains:**

- 2 X AAA batteries

1 x Actuator



**Box Contains:**

- 4 X CR123A batt.

1 x 1"  
Valve Ball



1 x 1"  
Flow Sensor



# Before you start

Search and download the Triple+  
CLM APP available online or scan  
the QR code



Must have 2.4GHz  
WiFi for Hub 2.0



Insert the supplied 2 AA backup  
batteries to the HUB -> HUB LED  
should flash Blue

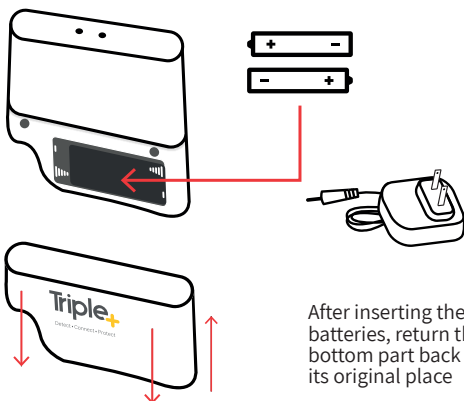

After inserting the  
batteries, return the  
bottom part back in  
its original place

# Before you start

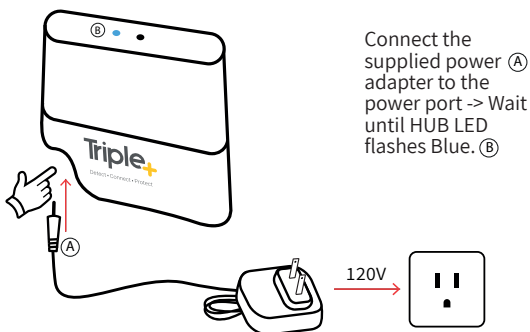

Insert the 2 AAA batteries (included) into the Flood Detectors. Flood Detector LED should flash Red and beep.

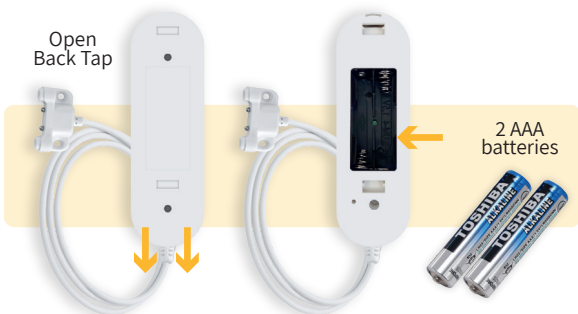

## Shutoff Assembly

- A** 1 x Flow sensor (1")
- B** 1 x Actuator (1")
- C** 1 x Shutoff Unit
- D** 1 x "Neck" base connection
- E** 1 x Plastic cylinder "grips the tap hinge"
- F** 2 x Hexagon head bolts (8 mm)
- G** 2 x Threaded nuts (8 mm)
- H** 2 x Lock washers
- I** 4 x Batteries CR123A
- J** 1 x Emergency key



## Tools required to install the system

- 1** Wrench (8 mm)
- 2** Phillips screwdriver (1-80)

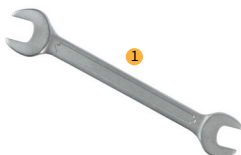

# System installation instructions

## Close the designated water line

The system should be installed downstream and as near as possible to the water meter **W** in order to detect abnormal water consumption for the entire property.

Important: Install the flow sensor **A** paying attention to the flow direction. The flow direction is indicated on the flow sensor. Then install the ball valve **C**

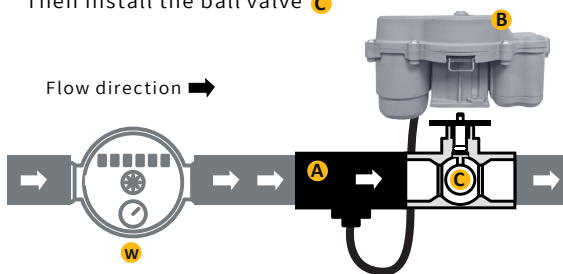

**After installing the flow sensor and the shutoff valve open the water line and check that there is no leakage in the connections!**

1

### The locking axis of the ball valve

At the top of the ball valve is the closing stem the faucet; adjust the hinge groove in the same direction of water flow with a 10 mm wrench.

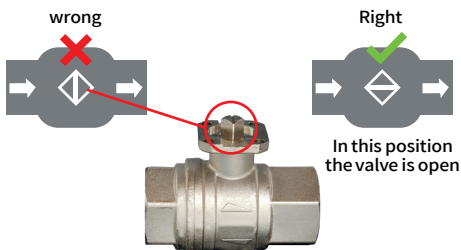

2

On the valve closing axis, install the plastic cylinder "gripping the faucet axis" with a star shape **L** at the lower end, and a groove in the upper part **K**. Make sure the direction is the same as the direction of the faucet axis.

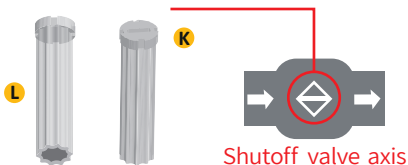

3

Install the neck **D** Above **L** "grips the tap hinge". Its base will be adjusted to the base of the ball faucet with the help of 2 screws, a locking disc and the nut.

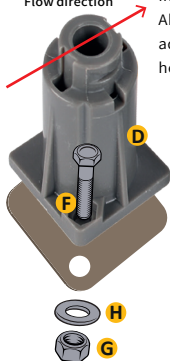

**R**

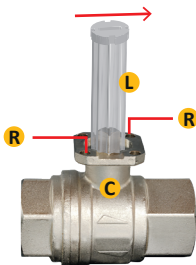

The screw heads are invested in the frame **R**, place the locking discs **H** at the bottom of the screw and close the nuts with an 8mm wrench until tight.

4

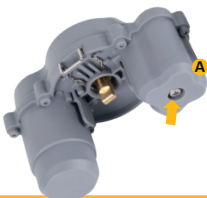

#### Inserting batteries in the Actuator

Remove the plastic wrap from the batteries **N**. Using a Phillips screwdriver, open the battery compartment located on the bottom of the Actuator **A**. Note the correct direction for their insertion to the cell; all should be facing the same direction. Close the compartment again with the Phillips screwdriver.

6

5

Battery compartment cover the screw, will activate the actuator- a green light will start flashing and the central axis will start rotating until it stops in the direction of water flow in the open position.

6

### Connecting a Flow Sensor to the Actuator

Unscrew the black cap **V** and secure the flow sensor connector **S** in place. Tighten the connector tightly.



**We are ready to install the Actuator on the neck**

7



#### The Actuator assembly

Release the safety catch **Y** with small move back. Position the actuator on the neck and trigger. Close the guard **Y** by clicking inside. Make sure that the guard enters the entire move in place and the Actuator locks on the neck **D**. Once locked, the Actuator cannot be removed.

7

## Re-open the designated water line

8

### Opening and closing of the Actuator

The battery-powered actuator is installed on a ISO5211 ball valve on the water line.

The actuator can also be closed and opened manually by pressing the orange button **1** on the top for 4 seconds.

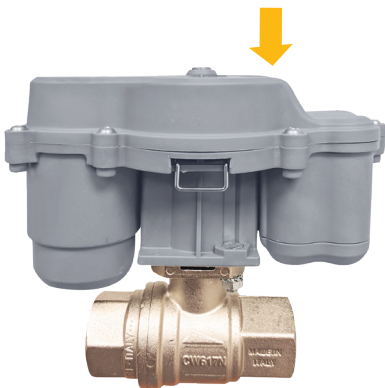

8



## Actuator opening and closing

In cases where manual operation of the faucet is required, the emergency key can be used. **J**

In order to do this we must first release the security pin **Y** that locks the actuator to the neck and then remove it, while carefully pulling upwards to expose the neck. The emergency key will be inserted in the upper part of the neck, and will penetrate into the open slot designed for this purpose. When the key is in the right place we can close or open the tap by turning it.

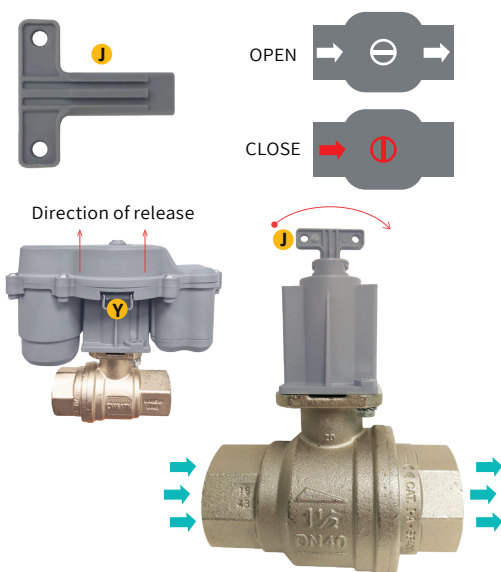

**Triple+**

For more information or technical support visit our website  
[www.tripleplus.io](http://www.tripleplus.io)

# Triple+ CLM™ Hub V2.0 Wi-Fi

## Installation Instructions

1

Download the free Triple+ CLM™ APP for your smart phone from Google Play or the AppStore. The entire installation is managed via your smartphone



2

You will be registering the Triple+ CLM™ Hub V2.0 to your designated Wi-Fi network; please make sure that your mobile phone is connected to that same

**Note:** Our network requirements are Wi-Fi 2.4GHz only (not 5GHz).

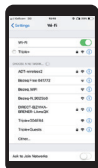

3

Read the terms and conditions, scrolling all the way down, then tap the “I Agree button” at the bottom if you approve

4

Tap the Login button

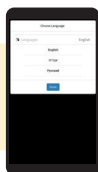

Select your language

5

Tap the Create New Account button

Fill out the required fields and tap the Accept button

**Note:** Ensure the complete accuracy of the email address and password requirements before accepting.



6

Tap the OK button

Tap the Add System button

**Note:** If you tapped the back arrow, tap on the 3 lines on the top left corner (Main Menu) -> Settings -> Add System

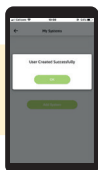

Scan the Kit installation QR code on the OUTSIDE of the main kit box delivered

7

**Note:** DO NOT scan the Triple+ CLM™ Hub V2.0 QR Codes or any individual devices) All devices in your Kit are associated to your Hub prior to delivery, and are embedded in the QR Code on the main box shipped to you.

8

Then tap the Add System Name button and create your System- using your address is preferred, as it is unique. Then choose Region and tap the Create button.



# Triple CLM™

9

Follow the instructions on the APP to initiate the installation sequence. When requested to unplug the power from the Hub, please disconnect AC power first, then remove AA batteries, and reinsert AA batteries before plugging AC Power back in, then tap the "OK" button

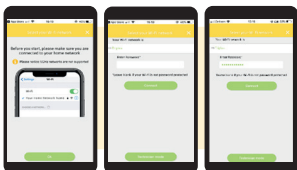

Insert batteries back in the hub and plug in the AC power, please check to ensure that you are connected to your selected WiFi network

10

Note: If you do not see your network in "Your Wi-Fi network is:" -> verify that you are connected to the required network -> tap on the "X" -> Accept to cancel the installation -> connect your mobile phone to the required network -> and restart the installation. If the HUB can't connect to the Wi-Fi please refer to Technician Mode and follow the instructions.

11

After the Hub connects to the Wi-Fi the installation will start automatically

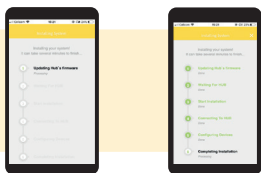

12

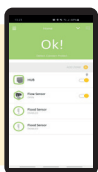

Locate the devices in their intended, permanent location and verify that all the devices communicate with the Triple+ CLM™ Hub V2.0 by verifying that all displaying in green. You can now secure the devices in those locations with the two-sided tape or screws.

Flood detectors must be located where water leaks can occur



Sink



Water Heater



Water Tank



Toilet



Water Cooler



Dishwasher



Washing Machine



Basement

# Optional Technician Mode Installation Procedure

1

Whenever the Triple+ CLM™ Hub V2.0 cannot connect to the desired Wi-Fi network, please follow the following steps: A) Make sure that the Wi-Fi that you want to work with supports 2.4GHz. B) Tap on the "Technician mode" button.



2



Follow the instructions on the APP to initiate the installation sequence. When requested to unplug the power from the Hub, please disconnect AC power first, then remove AA batteries, and reinsert AA batteries before plugging AC Power back in, then tap the "OK" button.

3

Go to the Wi-Fi network selector on your mobile phone and connect to the Triple+ WiFi network. The WiFi name will start with "Triple+" and six characters - no password is required.

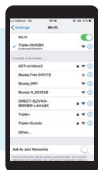

4

Return to the Triple+ App and wait for the "Successfully connected to Triple+ HUB" pop up. Tap on "Continue" and select your designated Wi-Fi network from the list. Enter password if necessary and wait for the application to give further instructions.

5

After the hub connects to the Wi-Fi the installation will start automatically

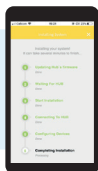
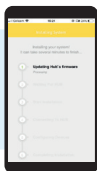

6

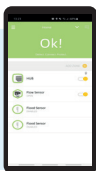

Locate the devices in their intended, permanent location and verify that all the devices communicate with the Triple+ CLM™ Hub V2.0 by verifying that all displaying in green. You can now secure the devices in those locations with the two-sided tape or screws.

## Triple+

For more support information visit our website at:  
[www.tripleplus.io](http://www.tripleplus.io)