



Installing Instructions for Tension Clips

Finish the installation of the fixed frame before completing this step. When ready, attach the tension clips to the back of your screen as shown in the picture below:



FIGURE 2-1



FIGURE 2-2

SpectraProjection.com
ONLINE INSTRUCTIONS >



Method 1. Fasten one end of the tension clip on the internal frame with one hand and hold it steady. With the second hand, pull the other end of the tension clip while using the first hand to help push and clip to the outer frame.

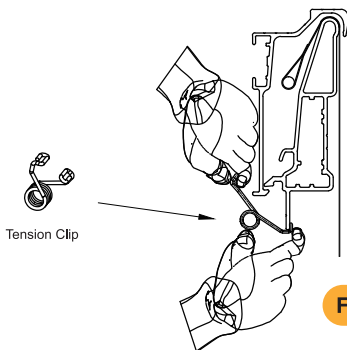

FIGURE 2-3

Method 2. Fasten one end of the tension clip on the internal frame with one hand and hold it steady. Using your second hand, pull the other end of the tension clip with the hook and fasten it to the outer frame. Remove the hook when complete.

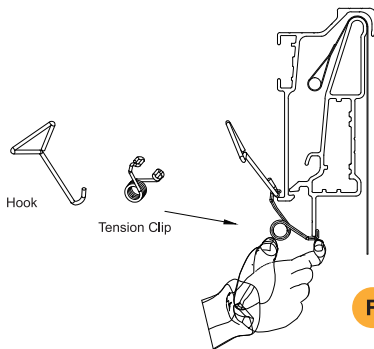

FIGURE 2-4