

Step 2. Check the Soundbar's status

The blue LED should not be blinking once the Bluetooth connection is complete.

NOTES

- If asked for a PIN code when connecting a Bluetooth device, enter 0000.
- The Soundbar automatically turns on within 15 minutes in the Ready state.
- The Soundbar may not perform Bluetooth search or connection normally under the following circumstances:
 - If there is strong electrical interference from the Soundbar.
 - If several Bluetooth devices are simultaneously paired with the Soundbar.
 - If the Bluetooth device is turned off, not in pairing mode, or not in range.
- If the sound device is not paired or not in range, devices that can connect to the Soundbar will be displayed on the Soundbar's screen. Press the [Back] button to return to the Bluetooth search screen.

06 CONNECTING AN EXTERNAL DEVICE

Connect to an external device via an optical cable or analog cable to play the external device's sound through the Soundbar.

Connecting using an Optical Cable

Step 1. Connect using an Optical Cable

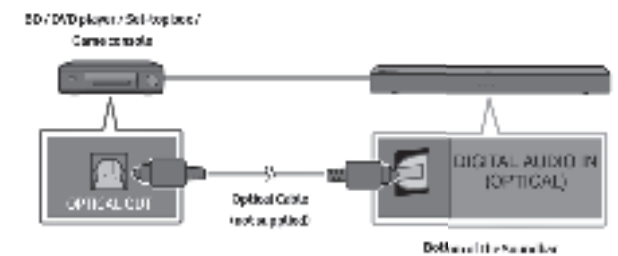

Step 2. Change the Soundbar's mode to D.IN



Connecting using an Analog Audio (AUX) Cable

Step 1. Connect using an Analog Audio (AUX) Cable

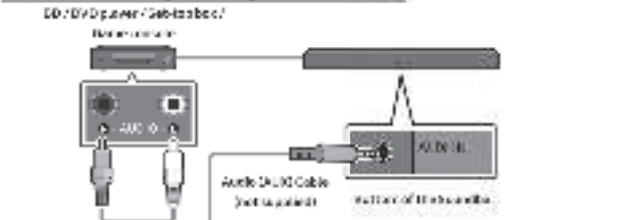

Step 2. Change the Soundbar's mode to AUX



07 CONNECTING A USB STORAGE DEVICE

Step 1. Connect a USB Drive



NOTE

- The Soundbar cannot play if the power is off. If you do not connect a USB device to the Soundbar within 15 minutes,

Step 2. Change the Soundbar's mode to USB



Setting Repeat Play Options

Repeat play

When the Soundbar is in USB mode, each time you press the [Repeat] button, the USB mode changes from 'Repeat' to 'All songs', 'Repeat', 'All songs', 'Repeat', 'All songs', and so on.

Mode	Remote control button	LED indicator
Repeat-All	[Repeat]	[LED indicator]
Repeat-1 song	[Repeat]	[LED indicator]
Repeat-All songs	[Repeat]	[LED indicator]

Repeat play at Random

When the Soundbar is in USB mode, each time you press the [Repeat] button, the USB mode changes from 'Repeat' to 'Repeat-All songs', 'Repeat-1 song', 'Repeat-All songs', and so on.

Mode	Remote control button	LED indicator
Repeat-1 song	[Repeat]	[LED indicator]

Software Update

Samsung may offer updates for the Soundbar's system firmware in the future. If an update is offered, you can update the firmware by connecting a USB device with the firmware update store on it to the USB port on your soundbar. For more information about how to download update files, go to the Samsung Electronics website at (www.samsung.com - support).

Then, enter or select the model number of your Soundbar, select the Software & Apps option, and then Downloads. Note that the option names can vary.

08 SYSTEM INITIALIZE



With the Soundbar on a surface, press the [System Initialize] button on the bottom of the Soundbar.

CAUTION

- All the settings of the Soundbar are initialized. Be sure to perform this only when it is required.

09 INSTALLING THE WALL MOUNT (Wall mount kit not supplied)

Installation Precautions

- Install on a wall with a flat surface.
- Do not install in a place with high temperature or humidity.
- Do not touch the wall directly when you install the product. It may damage the wall or the product.
- Do not use a wall mount that is not recommended for the product. It may damage the product.
- Do not use a wall mount that is not recommended for the product. It may damage the product.
- Do not use a wall mount that is not recommended for the product. It may damage the product.

Wall mount Components

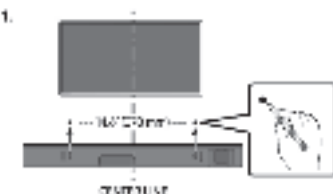
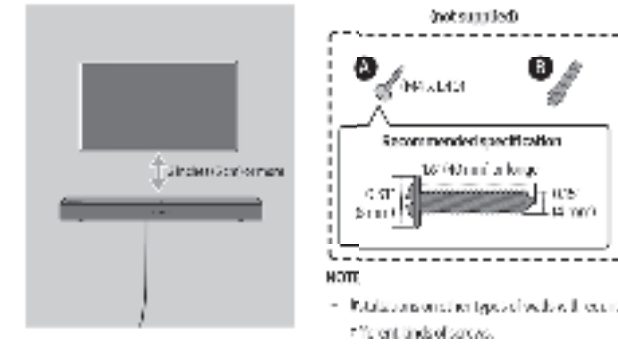

NOTES

- If your TV is installed on the wall, install the Soundbar below the TV. Use a pencil to mark the hole position.

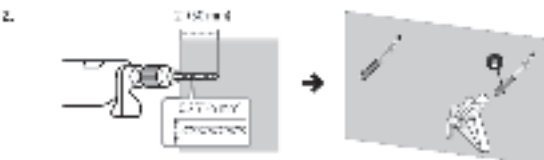

IMPORTANT NOTE

- The installation method shown here is for CONCRETE walls. Installation method will vary depending on the wall type. For installation on drywall, use a drywall anchor and a screw. Use a pencil to mark the hole position.

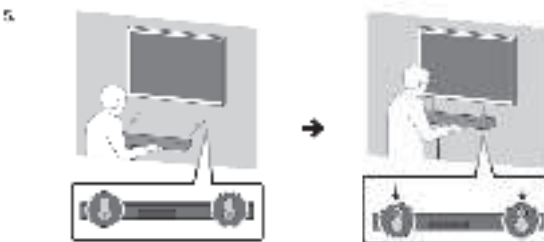
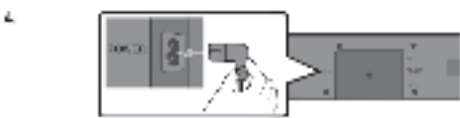
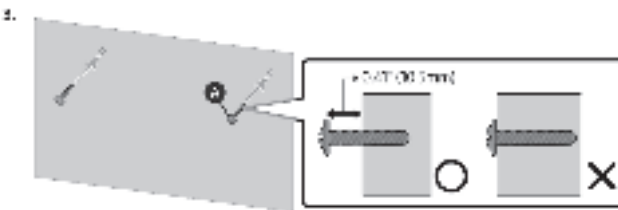

NOTE

- If the Soundbar is not installed on the wall, it may be damaged.

CAUTION

- Do not touch the Soundbar with sufficient force. If the Soundbar is not firmly fixed to the wall, it may be damaged.
- Do not touch the Soundbar with sufficient force. If the Soundbar is not firmly fixed to the wall, it may be damaged.

The cables mentioned in this guide is not supplied with your unit.

Note: The image shown here is for illustrative purposes only and may be subject to change. The actual number of ports and their locations may vary depending on the model.

10 TROUBLESHOOTING

Refer to the table below. If the problem does not solve, please refer to the Troubleshooting section of the user manual.

The unit will not turn on.
Is the power cord firmly plugged into the wall outlet? → Plug the power cord into the wall outlet or the power cord into the power cord.
When the power is on, the unit does not work.
Is there static electricity in the air? → Remove the power plug from the wall outlet.
Sound drops out or cuts in Bluetooth mode.
Is the Bluetooth device in range? → In Bluetooth connection mode, the Bluetooth connection will be lost if the distance between the Soundbar and the Bluetooth device exceeds 10m (33ft).
Soundbar not produced.
Is the Mute function on? → Press the [Mute] button to cancel the function.
Is the volume set to minimum? → Adjust the volume.
The remote control does not work.
Is the battery drained? → Replace the battery with a new one.
Is the remote control not working properly? → Move the remote control closer to the Soundbar.

11 LICENSE



Manufactured under license from Dolby Laboratories, Dolby Digital, and the Dolby Digital and Dolby Digital Plus logos.



The DTS logo is a registered trademark of DTS Licensing Limited. DTS, the DTS logo, and the DTS logo are trademarks of DTS Licensing Limited.



The Bluetooth logo is a registered trademark of Bluetooth SIG, Inc. The Bluetooth logo is a registered trademark of Bluetooth SIG, Inc.

12 OPEN SOURCE LICENSE NOTICE

For more information, please refer to the Open Source License Notice section of the user manual.

13 IMPORTANT NOTES ABOUT SERVICE

- Refer to the user manual for the correct use of the product.
- Do not use the product in a place with high temperature or humidity.
- Do not use the product in a place with high temperature or humidity.
- Do not use the product in a place with high temperature or humidity.
- Do not use the product in a place with high temperature or humidity.

14 SPECIFICATIONS AND GUIDE

Specifications

Model Name	HWT400
USB	5V/0.5A
Weight	4.7 lb (2.1 kg)
Dimensions (W x H x D)	35.2 x 2.5 x 4.2 inches (897.6 x 63.5 x 106.7 mm)
Operating Temperature Range	+41°F to +86°F (5°C to +30°C)
Storage Temperature Range	+10°F to +140°F (-13°C to +60°C)
Power Consumption	10W (Typical)
Power Consumption (Standby)	0.5W (Typical)

NOTES

- Specifications are subject to change without notice.
- Weight and dimensions are approximate.

