

# User Guide

## Electronic Drum Set with Bluetooth KD19



**Please read this user guide first before operating the unit and save it for future reference.**

Congratulations on your purchase of this Roll-up Drum kit. To get the most from you purchase, please take a few minutes to read these instructions.

### 1.Safety instructions

- This product should not be exposed to water by dripping or splashing and no objects filled with liquids, such as vases. Do not place the unit on a wet surface.
- Do not expose the product to temperatures above 35°C and keep it out of direct sunlight.
- This product has no user-serviceable parts. Do not attempt to repair this product yourself. Only qualified service personnel should perform servicing.
- Do not subject the plastic part of the product to harsh impacts. Do not drop the product as this may result in damage.
- Disconnect the product from the power source before cleaning. Never handle the USB cable with wet hands as this could cause electric shock. Unplug the product when it will be unused for long periods of time.
- This product is designed for indoor use only.
- If the USB cable needs to be replaced, ensure that the replacement complies with the manufacturer's specifications.

### 2.Preparation for use

Unpack the drum kit carefully. we recommend that you save the box and packing materials in case you wish to store the drum kit. Before setting up the unit, verify that the following accessories are present:

#### CONTENTS:

- 1 × KD19 Drum kit
- 2 × Pedals
- 2 × Drum sticks
- 1 × USB data cable
- 1 × 3.5mm AUX input cable
- 1 × Printed User guide
- 1 × Wipe cloth

### 3.Power source

Unwind the USB power cable to its full length; connect one end to the USB/DC 5V input on the rear of the drum kit.

Connect the other end to the USB power adapter. Plug in the USB power adapter to a 110 - 240V power socket and switch on. Alternatively, the drum kit can be powered from a computer USB port using the USB power cable supplied

### 4.Location of controls and indicators

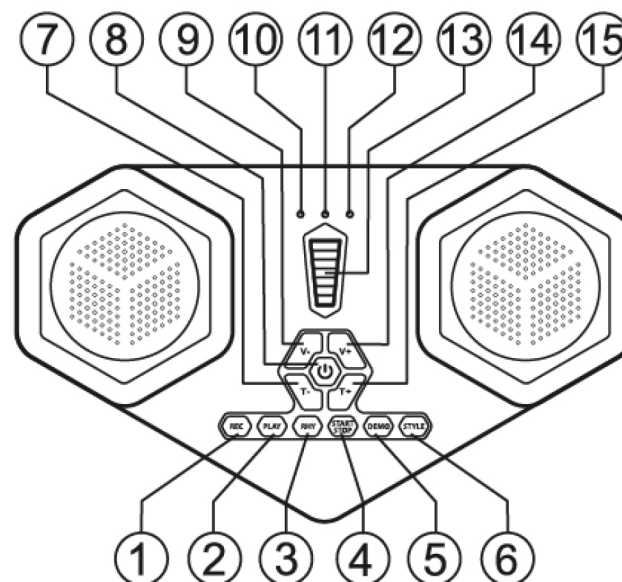

<b>1 - REC:</b> Press to start the record function. The green light indicates recording in progress. Up to 800 beats will be recorded.	<b>9 - V-:</b> Press to reduce the output volume.
<b>2 - PLAY:</b> Press to play back the recorded beats. the green recording light will turn off during playback	<b>10 - Red Light:</b> Charging indicator. When the drum kit is plugged in for charge, the red light will remain on until unplugged.
<b>3 - RHY:</b> Press to cycle between the 6 available rhythms.	<b>11 - Green Light:</b> The green light indicates recording in progress.
<b>4 - START/STOP:</b> Press to start playback of the selected demo. Press to stop playback of the rhythm or demo song that is playing.	<b>12 - Blue Light:</b> Blue light will flash to indicate Bluetooth pairing. The light will stop flashing when a device is successfully connected.
<b>5 - DEMO:</b> Press to cycle between the 10 demo songs available.	<b>13 - Audio Frequency:</b> Light will change according to the audio frequency output.
<b>6 - STYLE:</b> Press to cycle between the 7 different drum styles.	<b>14 - V+:</b> Press to increase the output volume.
<b>7 - T-:</b> Press to lower the tempo of the selected rhythm or demo song	<b>15 - T+:</b> Press to raise the tempo of the selected rhythm or demo song.
<b>8 - POWER:</b> Press to switch the drum kit on or off.	

5. Rear panel switches and connections

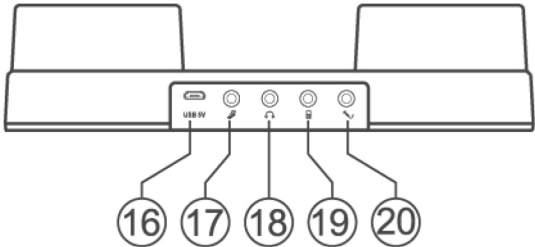

Make connections to the rear of the drum kit as follows before switching on:

<b>16 -</b> Use the USB power cable supplied to power from USB power supply (not include).	<b>19 -</b> Auxiliary input for iPod, iPhone, Smartphone or MP3 player. Use the 3.5mm cable supplied to connect the external device.
<b>17 -</b> Pedals for Bass Drum and Hi-hat.	<b>20 -</b> Microphone port for a wired electret or condenser microphone.
<b>18 -</b> Connect Headphones, Earphones or to amplified speakers.	

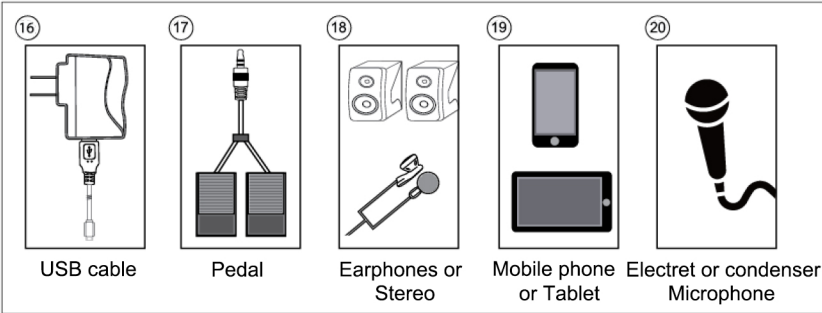

6.Drum pad layout

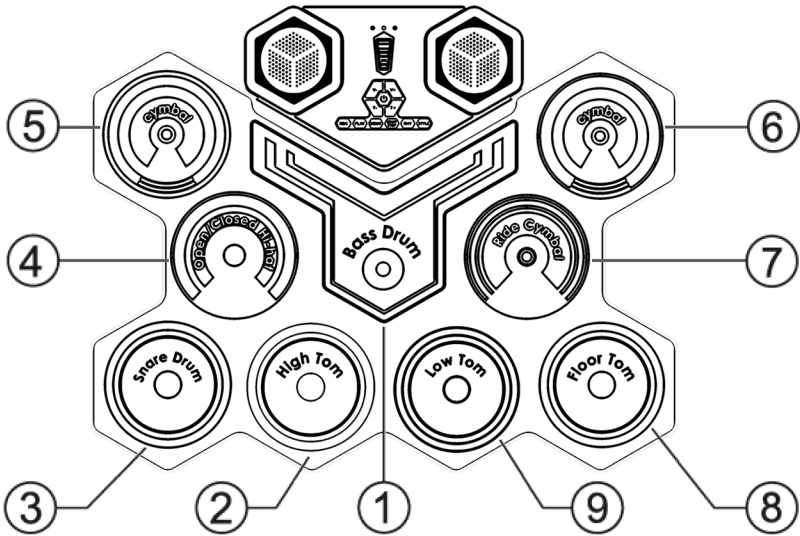

1 - Bass Drum	6 - Crash 2
2 - Tom 1	7 - Ride Cymbal
3 - Snare	8 - Floor Tom
4 - Open/Close Hi-hat	9 - Tom 2
5 - Crash 1	

7.Operation

Switching the unit on

Press the power button lacated in the middle of the control unit to switch on. The audio frequency lights will turn on.

Volume control

Press the VOL- / VOL+ buttons to adjust the volume of the drum sounds, demo songs and rythms. There are 9 volume setting available plus and off setting. The default setting at power up is level 6.

Drum kit selection

Press the STYLE button to cycle through the 7 different drum kit sounds. Hit the drums to test out the sounds available until you find the one that you like. The default setting at power up is STYLE 1.

Pedal operation

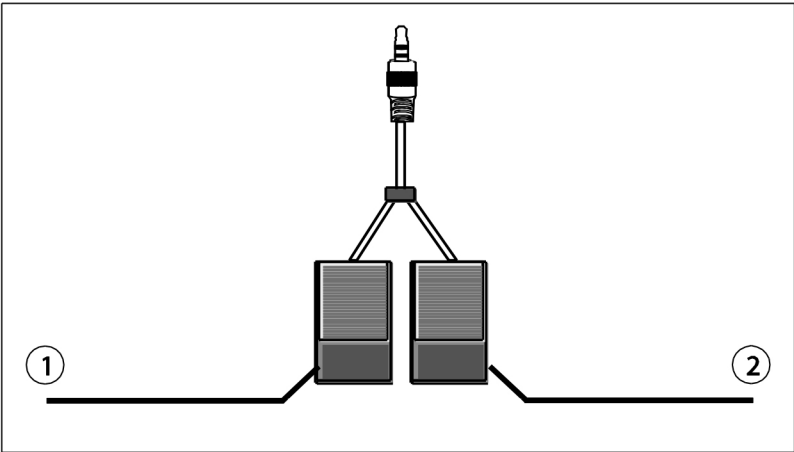

Press the pedals 1 and 2 for Bass drum and Open / Close Hi-hat

Hi-hat function - Without pedal plugged in - OPEN Hi-hat

Hi-hat function - With pedal pressed - CLOSED Hi-hat

Hi-hat function - With pedal not pressed - OPEN Hi-hat

Demo songs

Press the DEMO button repeatedly to select the demo song required. There are 10 diffierent demo songs to choose from. The default setting at power up is Demo song 1.

Rhythm selection

Press the RHY button repeatedly to select the rhythm required. There are 6 different rhythms to choose from. The default setting at power up is Rhytm 1.

Tempo control

The T+ and T- buttons can be pressed to adjust the playback tempo of the rhythms and demo songs. There are 16 Tempo setting available and the default setting at power up is setting 9.

Recording and Playback

Press the REC button to enter the recording mode; the REC LED will light green. Play the drums normally and up to 800 beats will be recorded. Press the PLAY button at any time to play back the recorded beats. The recorded beats cannot be deleted except by switching off the power but can be overwritten by pressing the REC button again.The playback of the recorded beats is not affected by the tempo setting.

Switching the unit off

Pressthe power button located inthe middle of the control unit to switch off. The audio frequency lights will go out.

8.Playing along to your iPhone,iPod, MP3 player etc.

Bluetooth

After switching on the drum kit, you can connect your Bluetooth device. The blue light will flash when the drum kit is ready to pair. From your mobile device search for "G6008" and connect. When your device is successfully connected the flashing, blue light will change to solid blue.

Aux Input

You can also listen to the sound of a connected external audio device such as aniPhone, iPod orMP3 player through your drum kit. Connect one end of the3.5 mm jack cable supplied to the AUXinputsocket (labelled 19)located on the rear panel ofthe drum kit, and the other end to your audio equipment (iPhone, iPod, MP3, PC, CD player, etc.). This feature is great for practice and allows you to playalong to a favourite music track.

NOTE:For Bluetooth and Aux Input,use the volume control of the connected device to adjust the playback volume of the music track. The music volume cannot be adjusted by the VOL-and VOL+ keys of the drum kit.

9.Connecting headphones or external speakers

Headphone, Earphones or external amplified speakers can be connected to the Headphone socket on the rear of the drum kit; this is great for private practice.

**WARNING!**The headphone output can be very loud. When using headphones please lower the volume to minimum before striking the drum pads and then adjust to a suitable level.

10.Trouble shooting and Support

If a problem occurs please check the following table before returning the unit. Ifthe problem cannot be solved with the following information then please return the item to the store where it was purchased from.

Problem	Remedy
Charging The red charge light does not turn on.	-Make sure the power adapter USB cable is connected properly at both ends. -Make sure the power switch on the drum kit is set to on. -Make sure that the power outlet is switched on.
Abnormal sound Drum sounds are heard when the pedals are plugged and unplugged	-This is not a fault. -To avoid the issue please insert the pedals before switching on.
No sound In normal use  When using headphones	-Make sure the volume has not been set to minimum (Off position).  -Make sure that the headphones are plugged in fully and that the volume is not set to minimum (Off position).
iPod/iPhone/Smartphone/MP3 playback The volume of the music cannot be adjusted with the VOL-and VOL+ buttons	-This is not a fault. -Adjust the volume on the audio device.
Unresponsive The drum kit buttons do not respond to presses/ The audio frequency lights do not turn on.	-This is not a fault. -The drum kit may be out of charge. Connect the drum kit to a power source. The red charge light should appear when charging. Charge for a minimum of 3 hours.

11.Product Specifications

DC Power:	DC 5V @ 2000mA from USB Power adapter (not include)
Rechargeable Lithium Battery:	1200 mAh
Dimensions:	43.8(L) x 35(W) x 5.7(H) cm
Functions:	9 Drum pads, 7Drum styles, 6Rhythms,10Demo songs, Record (800 Beat), MIDI out, AUXinput, Audio output, Bluetooth
Weight:	780 g
Material:	Silicone

12.Product disposal instructions

The symbol shown here and on the product means that the product is classed as Electrical or Electronic Equipment and should not be disposed with other household or commercial waste at the end of its working life.  
The Waste Electrical and Electronic Equipment (WEEE) Directive (2012/19/EU) has been put in place to encourage the recycling of products using best available recovery and recycling techniques to minimise the impact on the environment, treat any hazardous substances and avoid the increase of landfill.  
When you have no further use for this product, please dispose of it using your local authority's recycling processes. For more information, please contact your local authority or the retailer where the product was purchased.



13.FCC Compliance Statement

FCC Class B Part 15

This device complies with Part 15 of the Federal Communications Commission (FCC) Rules. Operation is subject to the following two conditions:

This device may not cause harmful interference.  
This device must accept any interference received, including interference that may cause undesired operation.

CAUTION:  
Changes or modifications to this unit not expressly approved by the party responsible for compliance could void the user's authority to operate this equipment.

This equipment has been tested and found to comply with the limits for a Class B digital device, pursuant to Part 15 of the FCC Rules. These limits are designed to provide reasonable protection against harmful interference in a residential installation. This equipment generates, uses, and can radiate radio frequency energy and, if not installed and used in accordance with the manufacturer's instructions, may cause interference harmful to radio communications.

There is no guarantee, however, that interference will not occur in a particular installation. If this equipment does cause harmful interference to radio or television reception, which can be determined by turning the equipment off and on, the user is encouraged to try to correct the interference by one or more of the following measures:

- Reorient or relocate the receiving antenna.
- Increase the separation between the equipment and receiver.
- Connect the equipment to an outlet on a circuit different from that to which the receiver is connected.
- Consult the dealer or an experienced radio or TV technician for help.