



47986707

# 7847

# VON DUPRIN®

Concealed Vertical Rod Exit Device  
Metal Door Applications

Installation Instructions

### Devices covered by these instructions:

7847/48 Concealed Vertical Rod Exit Device

7847-F/48-F (Fire) Concealed Vertical Rod Exit Device

CD7847/48 (Cylinder Dogging) Concealed Vertical Rod Exit Device

QEL7847/48/-F (Electric Latch Retraction) Concealed Vertical Rod Exit Device

HH/HW7847/47-F (Hurricane) Concealed Vertical Rod Exit Device

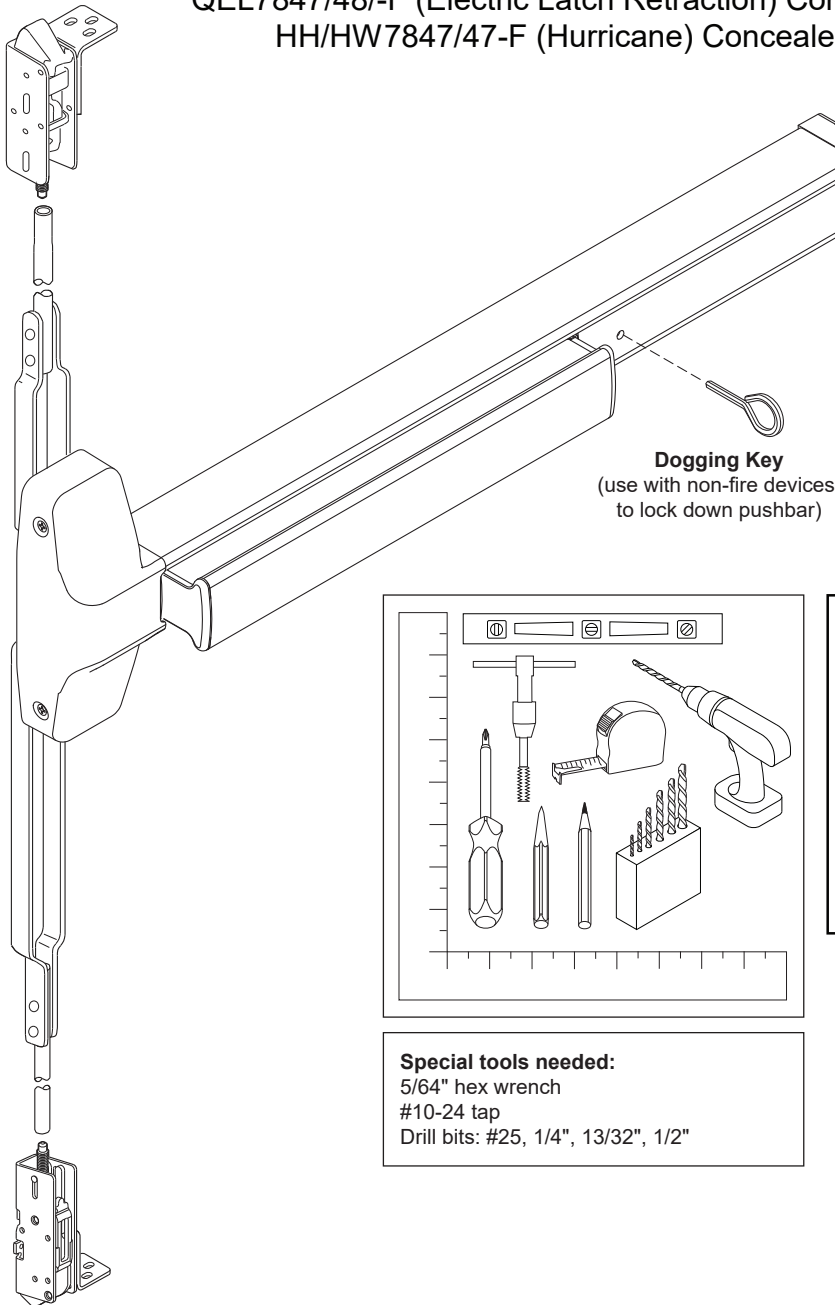

**Dogging Key**  
(use with non-fire devices  
to lock down pushbar)

### Index:

- Screw chart ..... 2
- Door preparation chart ..... 3
- Device installation ..... 4-6
- Adjust rods ..... 7
- Frame preparation chart ..... 7
- Optional equipment ..... 8
- Cut device ..... 8

### Special tools needed:

5/64" hex wrench  
#10-24 tap  
Drill bits: #25, 1/4", 13/32", 1/2"

For hurricane rated device requirements, see page 4.



### Customer Service

1-877-671-7011    [www.allegion.com/us](http://www.allegion.com/us)

© Allegion 2024  
Printed in U.S.A.  
47986707 Rev. 08/24-b

# SCREW CHART

**A**

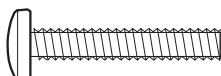
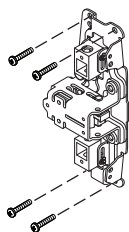

#10-24 x 1"

Surface mount or  
Sex bolts (1-3/4" door)

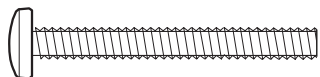

#10-24 x 1-1/2"

Sex bolts (2-1/4" door)

- Packaged with trim -

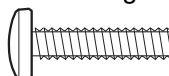

#10-24 x 3/4"

785 trims (1-3/4" door)

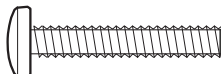

#10-24 x 1"

785 trims (2-1/4" door)

**B**

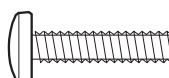
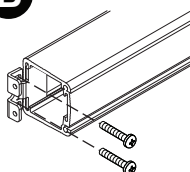

#10-24 x 3/4"

Surface mount or  
Sex bolts (1-3/4" door)

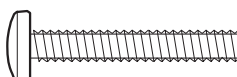

#10-24 x 1-1/8"

Sex bolts (2-1/4" door)

**C**



#10-16 X 3/8" Thread cutting

Endcap

**D**

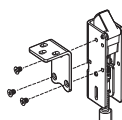

#10-32 X 1/4"

Bracket to latch

**E**

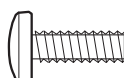
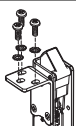

#10-24 X 1/2"

Bracket to door

**F**

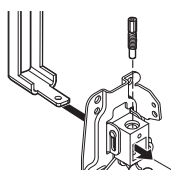

Rod adjusting screw

Retaining clip

**G**

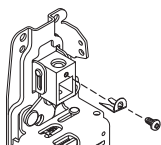

#8-32 X 5/16"

Retaining clip

**H**

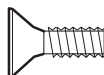

#10-24 X 1/2"

338 strike

**I**

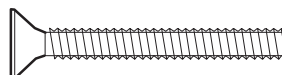

#10-24 X 1-1/2"

Ratchet release

**J**



#8-18 x 3/8" Thread cutting

Center case cover

# DOOR PREPARATION CHART

Go to instructions on next page before using preparation chart

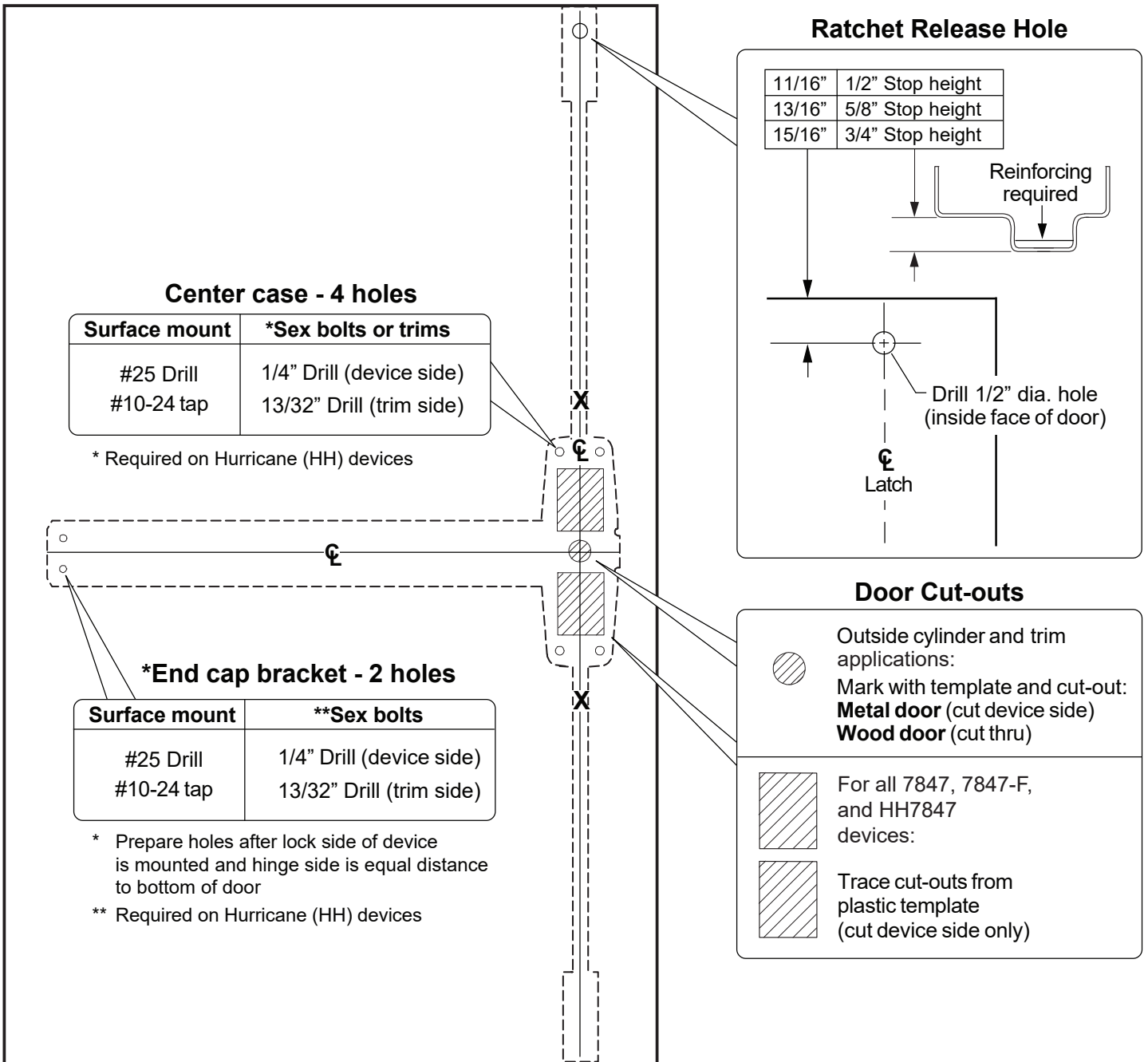

## Latch Cases

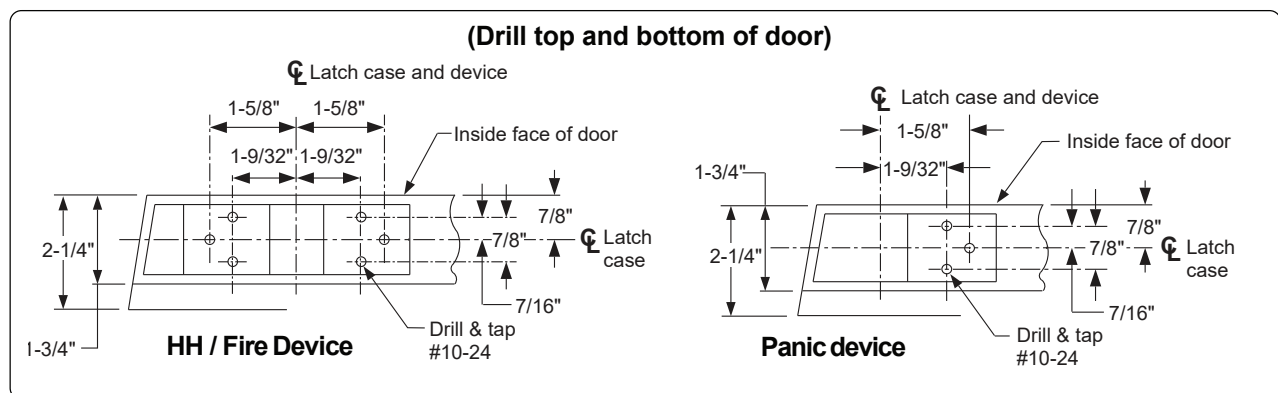

HURRICANE RATED DEVICE REQUIREMENTS

Hurricane rated exit device requirements (when used with approved Allegion door applications)

<b>Sexbolts</b>		When installing a Wind and Impact-rated hurricane device (HH), sex bolts must be used. Sex bolts are noted throughout the instructions where applicable. If through-bolting trims are used, these trims are equivalent in function and are used in place of sex bolts.		
<b>Application</b>		<b>Single door standard strike</b>	<b>Mullion</b>	<b>Double door standard strike</b>
HH (Wind and Impact rated) or HW (Wind Only)	HH7847, 7847	Top: 338 Bottom: 304L	—	Top: 338 Bottom: 304L
	7847-F	—	—	

1 Draw Horizontal Device Center Line (☿)

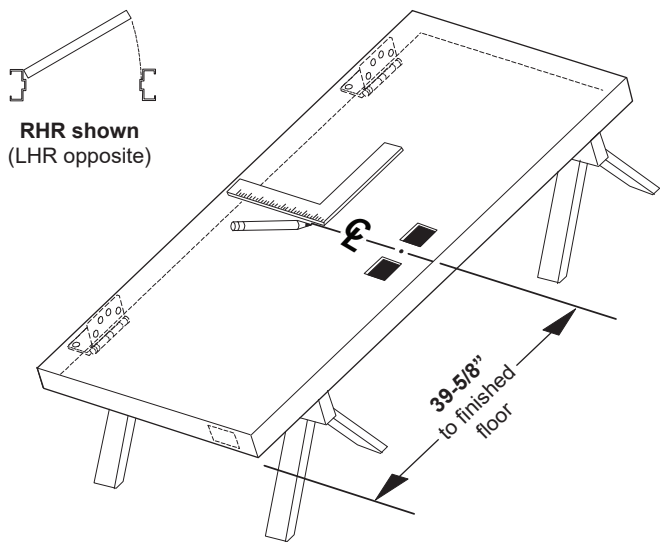

2 Determine Correct Backset, then Mark 4 Holes for Device Center Case Using Template

Mark centerline using measuring tape. Place template on centerline mark.

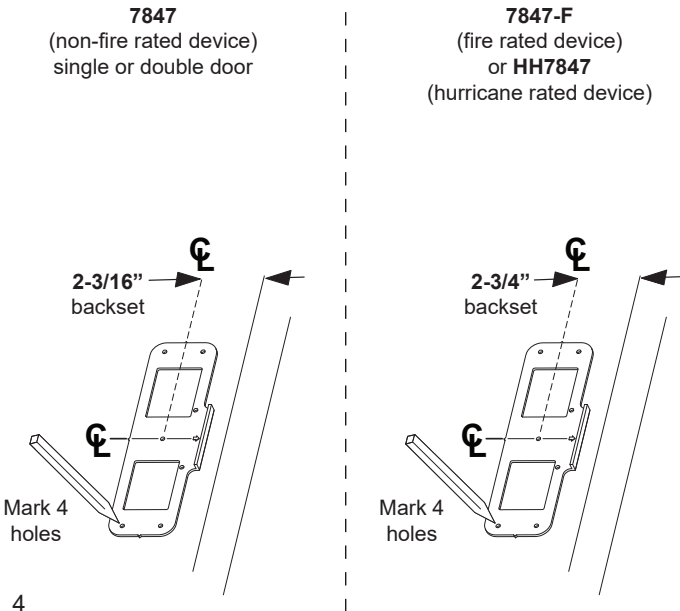

3 Prepare Door per Preparation Chart on Page 3

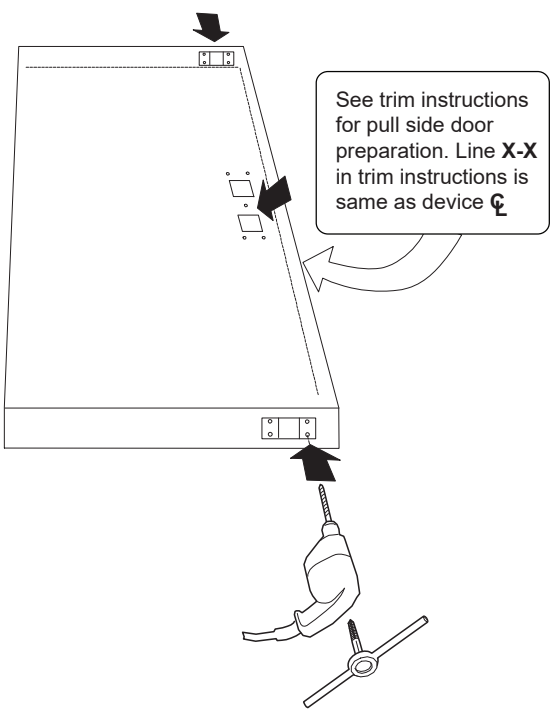

4 Adjust Tailpiece if Needed

Make sure tailpiece is installed at correct length for 1-3/4 inch thick or 2-1/4 inch thick door. If necessary, remove pine tree clip, rotate tailpiece, and reinstall pine tree clip.

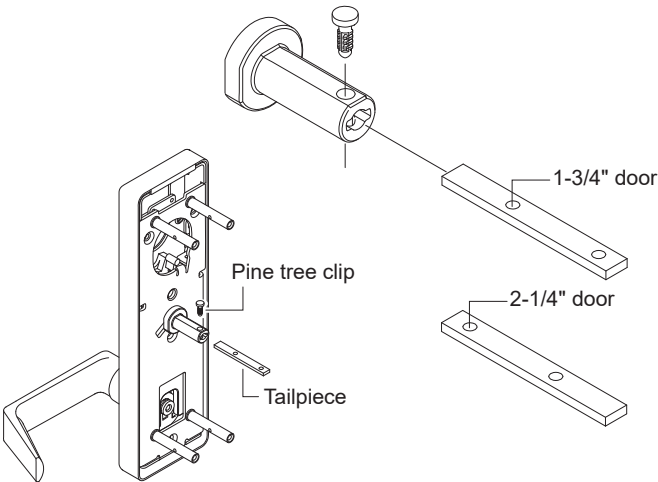

## 5 If Using a Cylinder, Remove Cam and Rotate 180°

Cam must be in position shown **with key removed**. If necessary, remove cam screws, place cam in correct position, and reinstall cam screws.

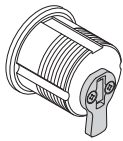

Standard Orientation with key removed.

Rotate cam if necessary as shown here.

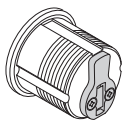
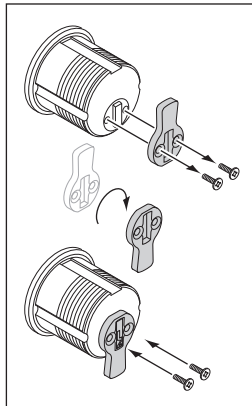

For NL and E-trims, use this orientation.

## 6 If Necessary, Install Cylinder.

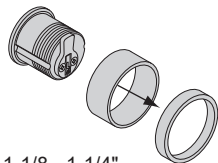

1-1/8 - 1-1/4"  
(29-32 mm)

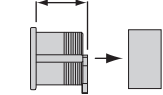

1-3/8 - 1-1/2"  
(35-38 mm)

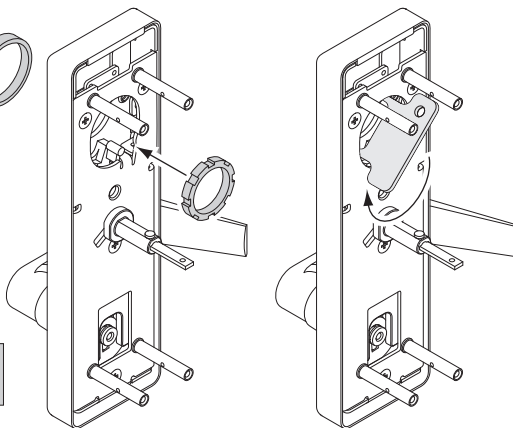
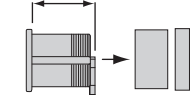

## 7 If Using a Cylinder with a Tailpiece, Prepare Device and Cylinder

a. Install tailpiece guide.

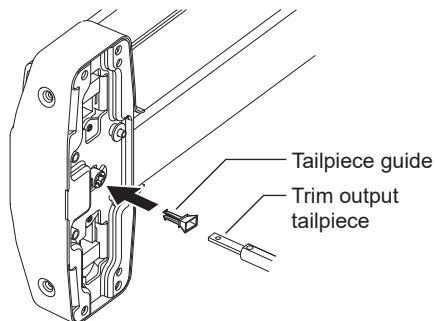

## 8 Assemble Rods and Latches and Adjust Length for Proper Door Height

Follow red and blue instruction cards on rods to set initial rod length

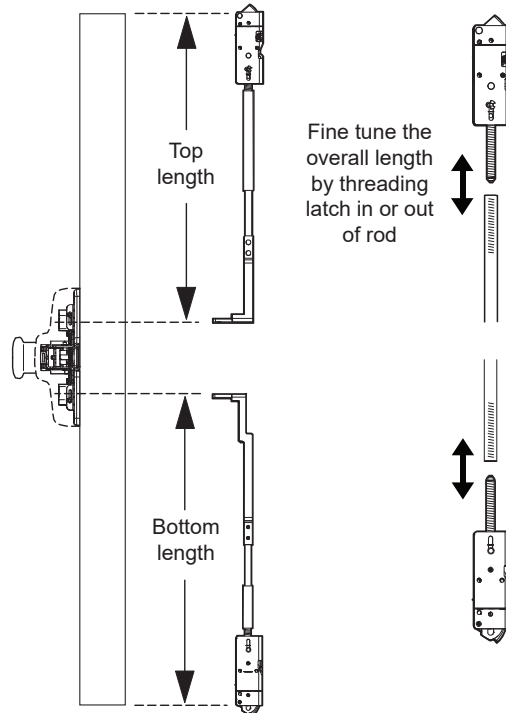

Fine tune the overall length by threading latch in or out of rod

## 9 Install Rods and Latches as Shown

Note: Fire / HH devices use brackets on both sides of latches

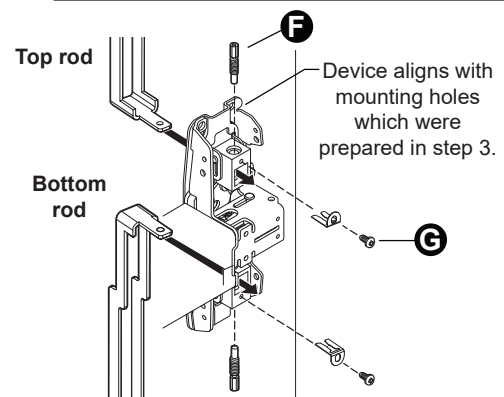
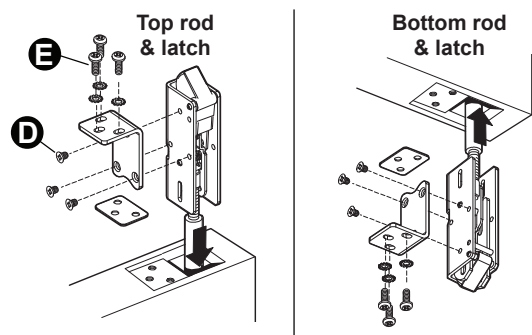

## 10 Secure Device to Door as Shown, then Hang Door on Frame

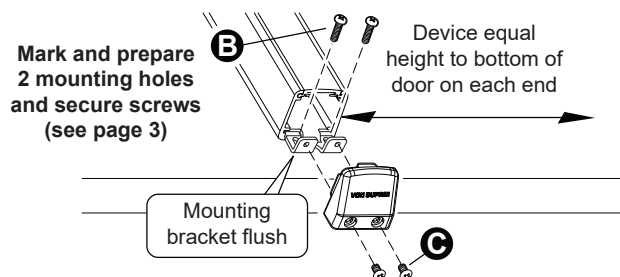
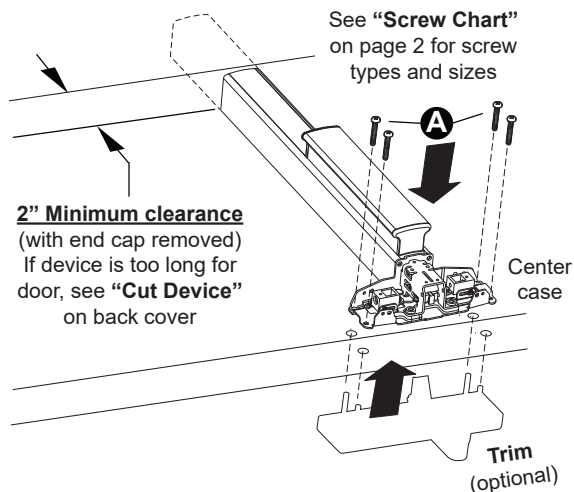

## 11 Install Top Strike and Ratchet Release

### 338 Top strike

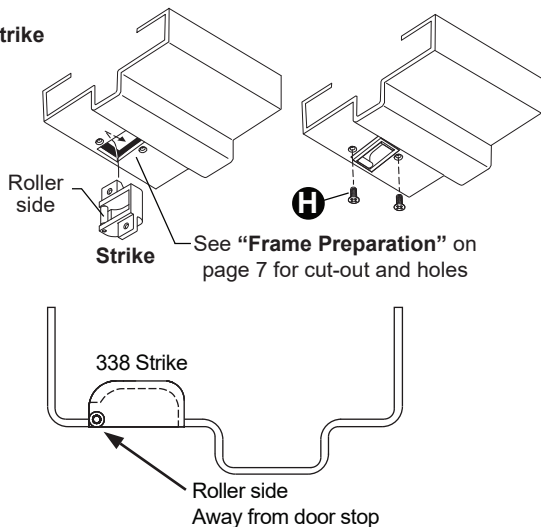

### Ratchet release

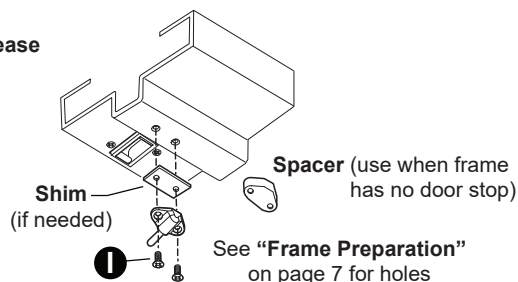

## 12 Install Bottom Strike or Prepare Threshold

### 385-A bottom strike

1/4" undercut for 7847

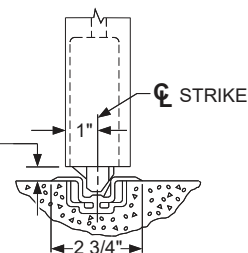

### Threshold application

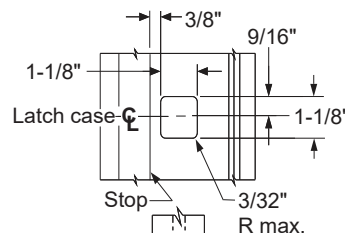

### Flat threshold application

Remove material as necessary to accommodate 5/8" latch bolt throw

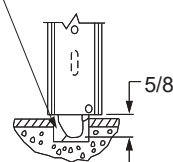

### 304L strike

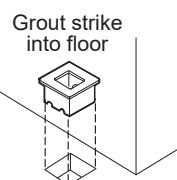

### Hurricane applications use threshold with 304L bottom strike

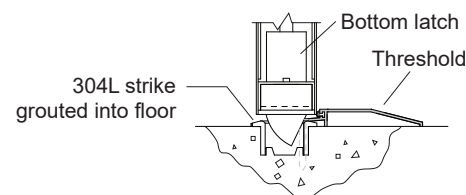

## 13 Adjust Rods and Install Center Case Cover

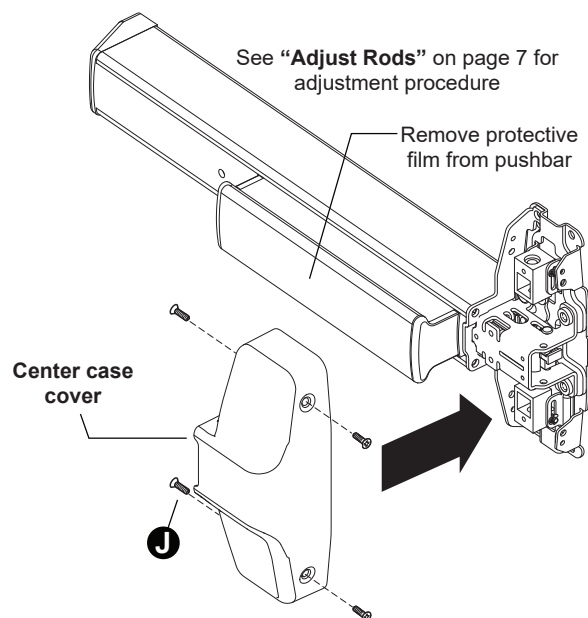

## ADJUST RODS

- 7.** Turn top locking screw in. Do not over-tighten

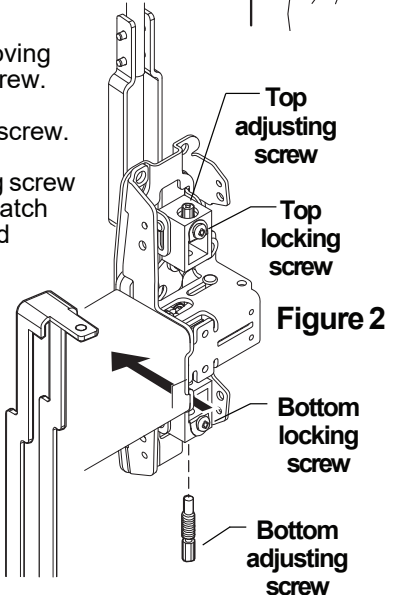

- 11.** With top latch bolt still retracted, adjust bottom rod so latch bolt clears floor and bottom strike.

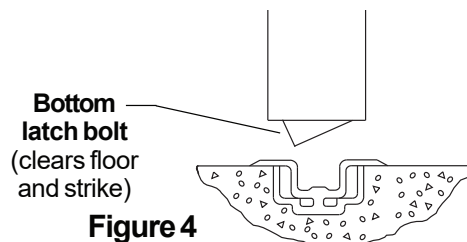

12. Turn bottom locking screw in. Do not over-tighten.
13. Check device operation by opening and closing door several times from the outside.

- Top latchbolt is not held retracted
- Bottom latchbolt does not clear floor and bottom strike

## FRAME PREPARATION

## TOP STRIKE

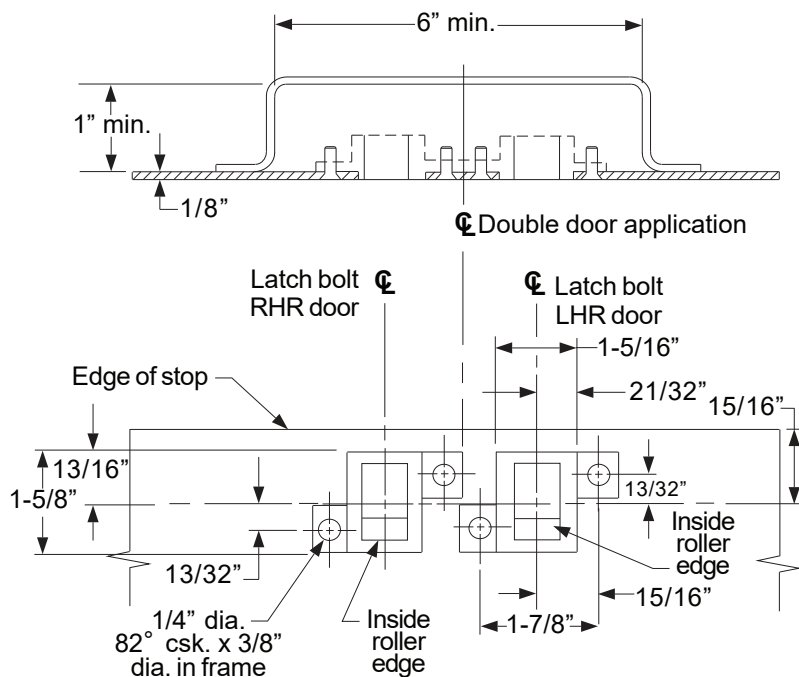

**RATCHET RELEASE**

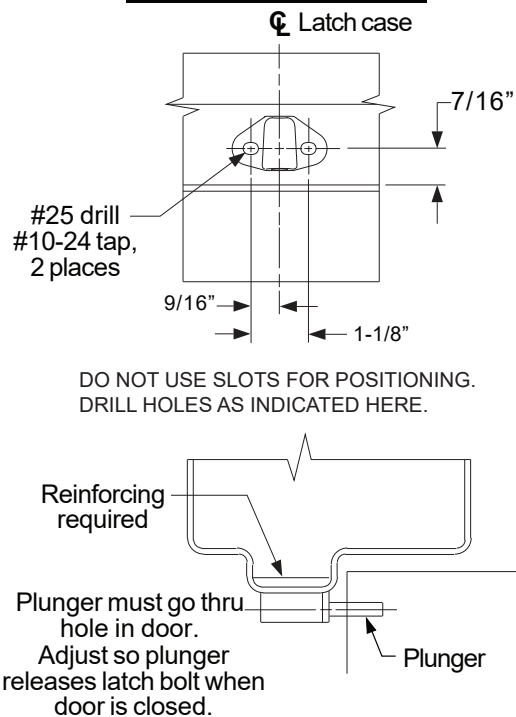



## OPTIONAL EQUIPMENT - CONTINUED

### CD (CYLINDER DOGGING)

1. Remove mortise cylinder cam and reinstall in reverse (Figure 6).
2. Insert key and rotate cam to install the cylinder to the cover plate (Figure 7).
3. Remove key to slide cover plate in position in the mechanism case.

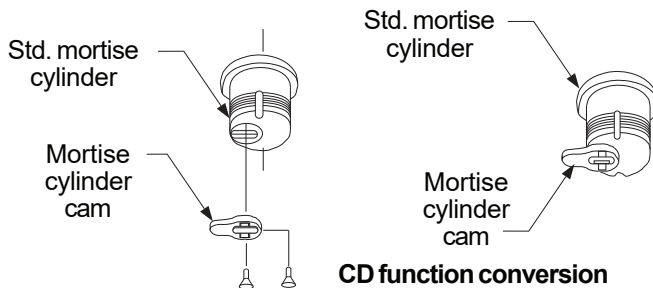

**Figure 6**

#### Dogging procedure

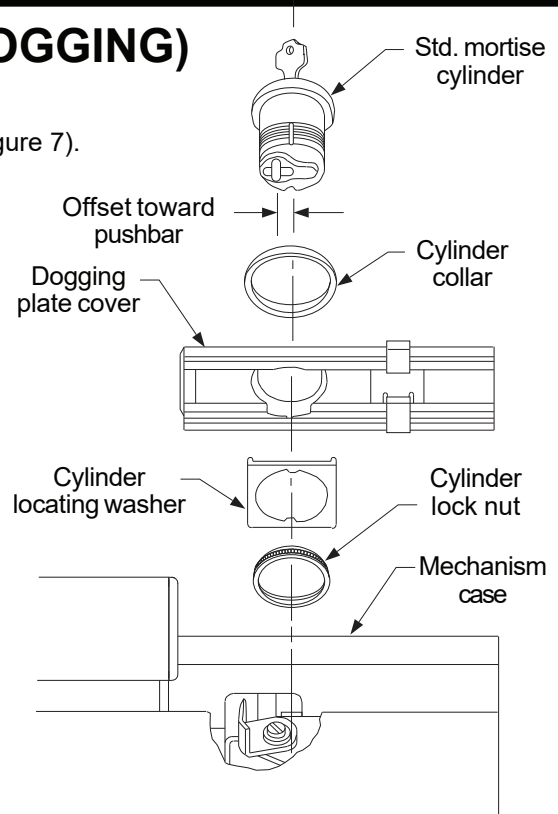
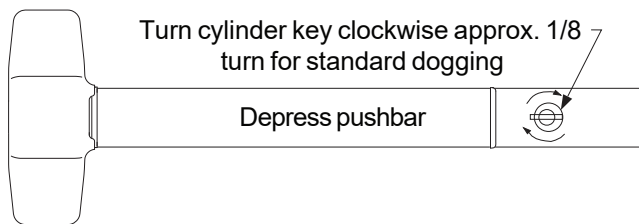

**Figure 7**

## CUT DEVICE

### 1 Measure amount to cut off device.

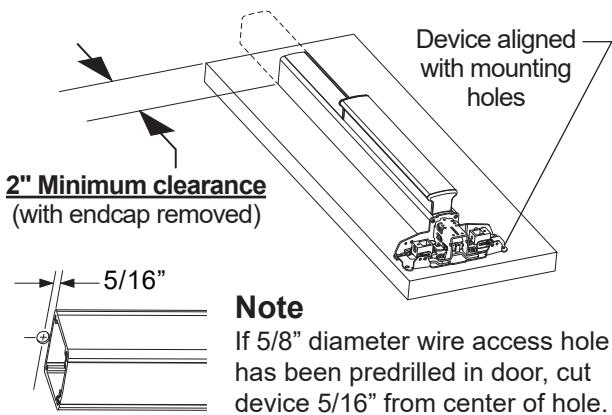

### 2 Tape and mark area being cut.

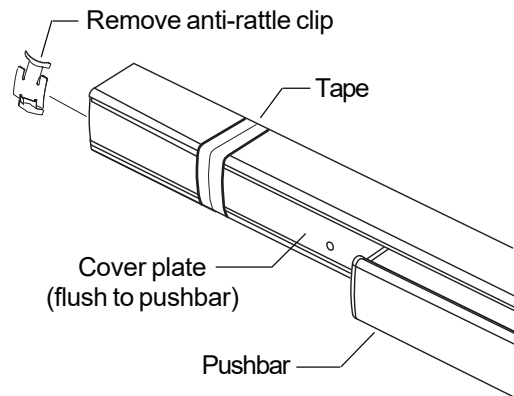

### 3 Cut device square.

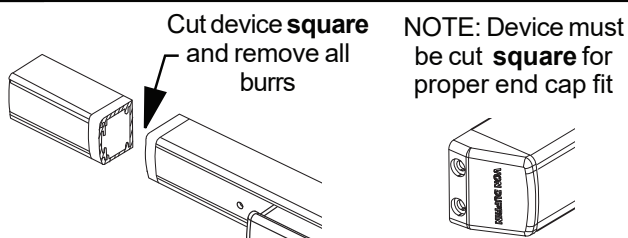

### 4 Slide anti-rattle clip into device.

