



ONECONTROL<sup>®</sup>  
UNITY BOARD<sup>™</sup> M Series  
Rev. P  
OWNER'S MANUAL



Scan for product support

# TABLE OF CONTENTS

<b>Introduction</b>	<b>2</b>
<b>Safety</b>	<b>2</b>
<b>Operation</b>	<b>3</b>
Awning	3
Bed Lifts	3
Fans	4
Generator	4
HVAC (Heating, Ventilation, Air Conditioning)	5
Lighting	7
Monitor Panel	7
Slides	7
Stabilizers	7
Bluetooth Connection	8
<b>Lockout</b>	<b>9</b>
<b>Troubleshooting</b>	<b>9</b>

## Introduction

The OneControl® Touch Panel is a touchscreen device that provides system controls and monitoring software for recreational vehicles. The OneControl Unity Board™ is an electronic control system that provides direct power, control, monitoring and diagnostics for coach functions, including awnings, lighting, fans, HVAC, generators, water tanks, water pumps, tank heaters and battery levels. Each slide-out is controlled by its own module that is linked to the system via CAN network. Powering up the coach will also turn on the OneControl Touch Panel and the various controllers throughout the coach.

Additional information about this product can be obtained from [lci1.com/support](https://support.lci1.com/support) or by downloading the free LippertNOW app. The app is available on Apple App Store® for iPhone® and iPad® and also on Google Play™ for Android™ users.

Apple App Store®, iPhone®, and iPad® are registered trademarks of Apple Inc.

Google Play™ and Android™ are trademarks of Google Inc.

For additional support on this product, please visit:

<https://support.lci1.com/onecontrol-wireless-formerly-myrv>.

**NOTE:** Images used in this document are for reference only when assembling, installing and/or operating this product. Actual appearance of provided and/or purchased parts and assemblies may differ.

## Safety

Read and understand all instructions before installing or operating this product. Adhere to all safety labels.

This manual provides general instructions. Many variables can change the circumstances of the instructions, i.e., the degree of difficulty, operation and ability of the individual performing the instructions. This manual cannot begin to plot out instructions for every possibility, but provides the general instructions, as necessary, for effectively interfacing with the device, product or system. Failure to correctly follow the provided instructions may result in death, serious personal injury, severe product and/or property damage, including voiding of the Lippert limited warranty.

## ⚠ WARNING

The "WARNING" symbol above is a sign that an installation procedure has a safety risk involved and may cause death, serious personal injury or severe product or property damage if not performed safely and within the parameters set forth in this manual.

## ⚠ CAUTION

The "CAUTION" symbol above is a sign that a procedure has a risk involved that may cause personal injury and/or product damage if not performed safely and within the parameters set forth within this manual.

## ⚠ CAUTION

Moving parts can pinch, crush or cut. Keep clear and use caution.

## Operation

The OneControl Touch Panel will be launched upon startup of the coach. The home screen will appear on startup (Fig. 1) with icons representing systems controlled by the Unity Board.

The device can be powered on or off using the power button (Fig. 1A) on the front of the touch panel.

**NOTE:** Stabilizers are optional equipment on some models/floor plans. The Stabilizers icon will only populate if that feature is available.

To operate a system, press the icon representing that system. After accessing and adjusting a system via a touchscreen icon, push the system Home icon in the center of the bottom row to return to the OneControl home screen.

Fig. 1

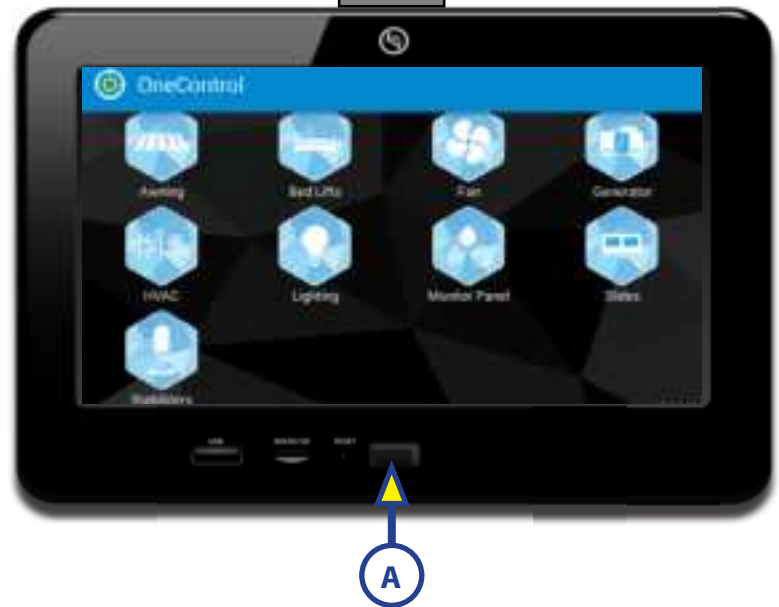

## Awning

1. Press the Awning icon.
2. Press the EXTEND (+) button (Fig. 2A) to extend the awning and press the RETRACT (-) button (Fig. 2B) to retract the awning.

Fig. 2

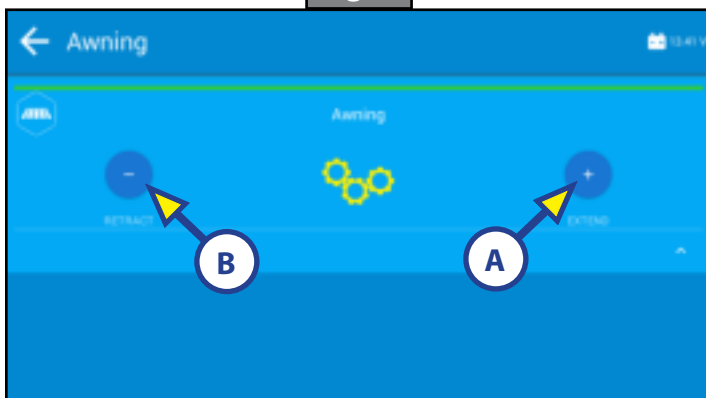

## Bed Lifts

1. Press the Bed Lifts icon to access the Bed Lift screen.
2. Press RAISE (Fig. 3A) to raise the bed and press LOWER (Fig. 3B) to lower the bed.

Fig. 3

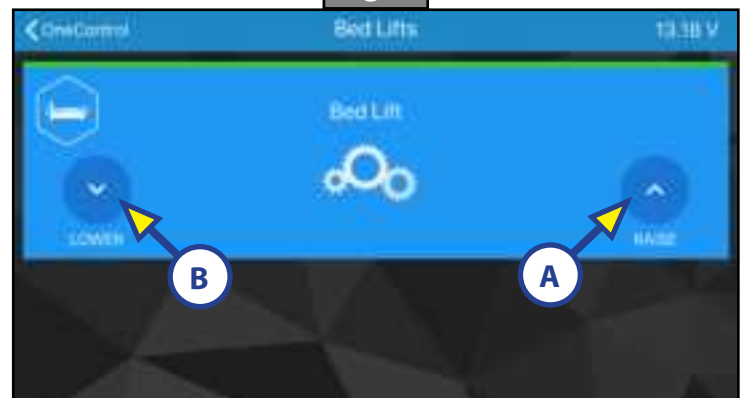

**Fig. 4**

## Fans

1. Press the Fan icon to access the Fan screen.
2. Select a fan and then press the button to turn on the fan (Fig. 4). Press again to turn the fan off.

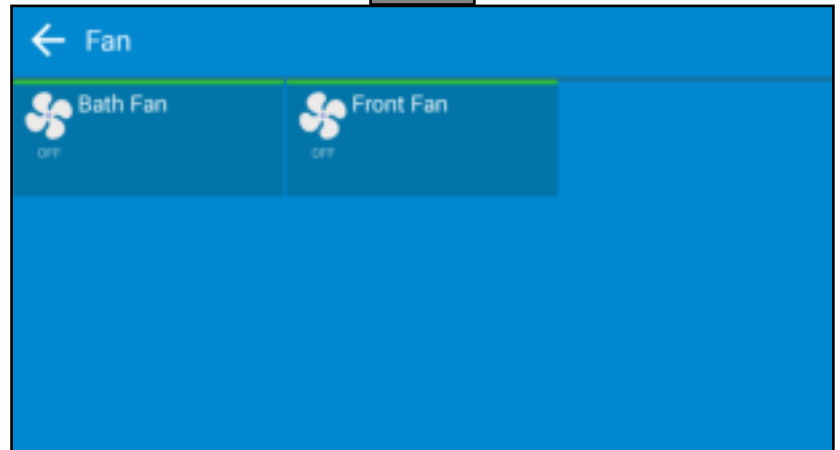

## Generator

1. Press the Generator icon to access the Generator screen (Fig. 5).
2. Locate and press the three vertical dots (Fig. 5A) to open the general settings.
3. Adjust the generator according to user preference (Fig. 6).
4. Press the START/STOP icon (Fig. 5B) on the right side of the screen to run or stop the generator.

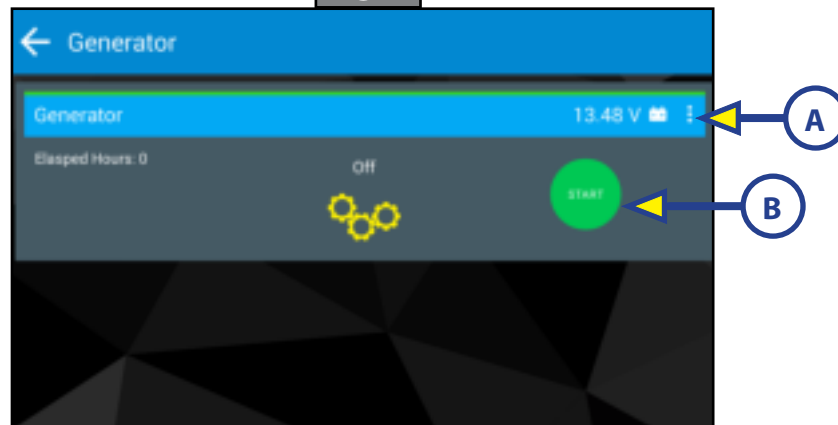
**Fig. 5****Fig. 6**

## HVAC (Heating, Ventilation, Air Conditioning)

1. Press the HVAC icon.
  2. Press the Climate zone displayed (Fig. 7).
  3. There are two boxes on the left side of the screen (Fig. 8). The top box (Fig. 8A) controls the heating/cooling mode. The bottom box (Fig. 8B) controls the fan. Press the top box to choose the HVAC mode. A large box will populate with available options for that climate zone (Fig. 8).
    - A. Heat/Cool: This mode provides High and Low set points. The HVAC system will operate to keep the temperature between these two set points. Refer to step 5C.
    - B. Heat (Fig. 8C): This mode has a single set point and the furnace or heat pump will operate to keep the temperature at that set point.
    - C. Cool (Fig. 9A): This mode has a single set point and the air conditioning will operate to maintain the temperature at this point.
    - D. Off (Fig. 9B): Pressing this button turns off the HVAC system.
- NOTE:** If equipped with a heat pump, users will be prompted to choose a heat source (Fig. 8D). The options are Gas or Heat Pump.
- C. Cool (Fig. 9A): This mode has a single set point and the air conditioning will operate to maintain the temperature at this point.
  - D. Off (Fig. 9B): Pressing this button turns off the HVAC system.
  - E. Once the desired mode is selected, press the CLOSE button (Fig. 9C) on the right.

Fig. 7

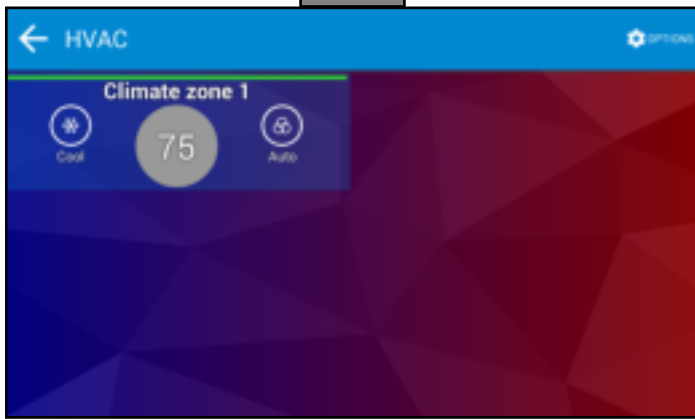

Fig. 8



4. Press the bottom of the two boxes on the left (Fig. 8B) to choose the FAN mode. A large box will populate with available fan settings (Fig. 10).
  - A. High (Fig. 10A): The fan will run continuously on high until another setting is chosen.
  - B. Low (Fig. 10B): The fan will run continuously on low until another setting is chosen.
  - C. Auto (Fig. 10C): The fan will run when the HVAC system calls for heating or cooling, then shuts off after the set point is reached.

**NOTE:** The fan will continue to run for two minutes after the set point has been reached in order to cool the compressor or furnace.

- D. Once the desired fan setting has been selected, press the CLOSE button (Fig. 10D) on the right.

Fig. 9

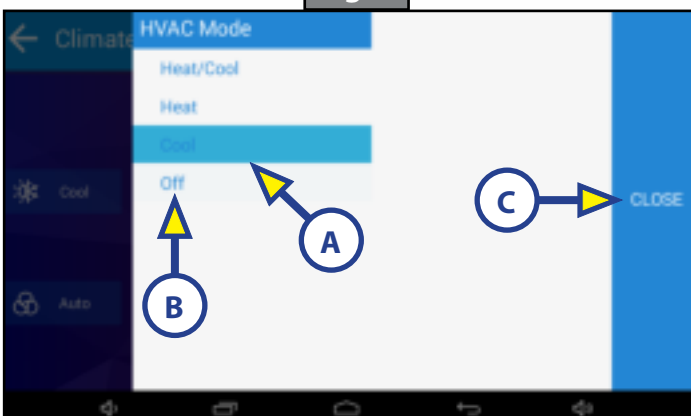
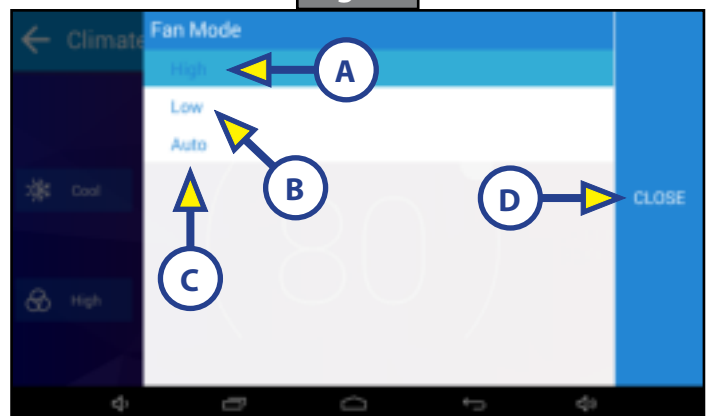

Fig. 10



5. Adjust the set points for the climate zone by updating the display.

**NOTE:** The adjusted temperature for the climate zone will be displayed inside a radius with a white dot on it (Figs. 11 and 12).

- A. Press and hold the white dot, then drag it around the radius (Figs. 11 and 12) to set the climate zone's temperature set point.
- I. Dragging the dot counterclockwise will lower (cooler) (Fig. 11) the set temperature.
  - II. Dragging the dot clockwise around the radius will raise (hotter) (Fig. 12) the set temperature.
- B. Once the desired set point is reached, release pressure on the white dot.

Fig. 11



Fig. 12

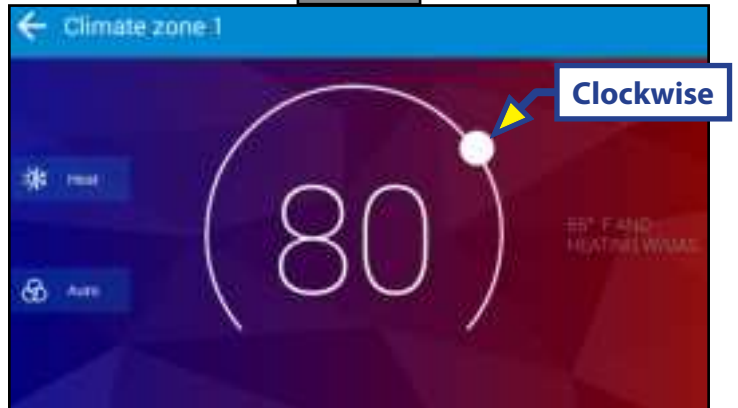

- C. Two white dots will appear (Fig. 13) when in Heat/Cool mode (Fig. 13A).
- I. Set the low end (cool) of the temperature range by moving the left dot counterclockwise.
  - II. Set the high end (heat) of the temperature range by moving the right dot clockwise.

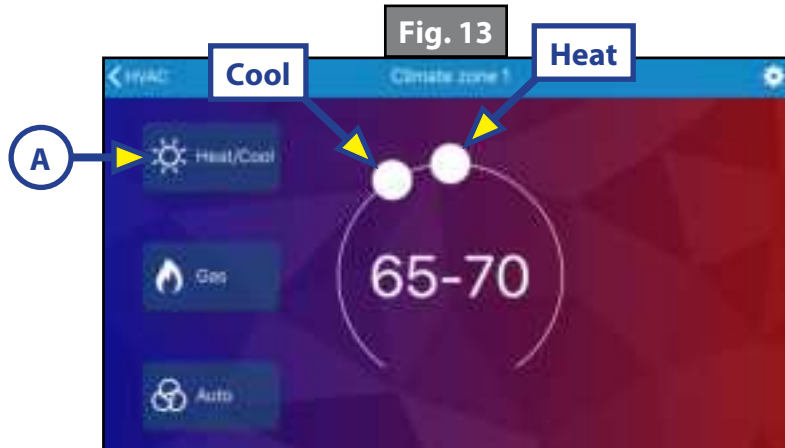

## Lighting

1. Press the Lighting icon to access the Lighting screen (Fig. 14).
- NOTE:** Individual light status is displayed by a light bulb to the left of the light's name (Fig. 14A). The light icon will display a lit bulb if the light is on or a dim bulb if the light is off.
2. Pressing the ON or OFF light bulb icon on individual light buttons will turn that light on or off.
3. Pressing the highlighted ALL ON or ALL OFF icons (Fig. 14B) will turn all lights on or off.

A

Fig. 14



## Monitor Panel

1. Press the Monitor Panel icon to access the Tank Monitor screen (Fig. 15).
2. The monitored systems (Fig. 15A) will display the status of the various tanks.
3. Press the buttons on the right to turn on or off a specific component (Fig. 15B).

**NOTE:** The icons will light up when the corresponding device is in use.

A

Fig. 15

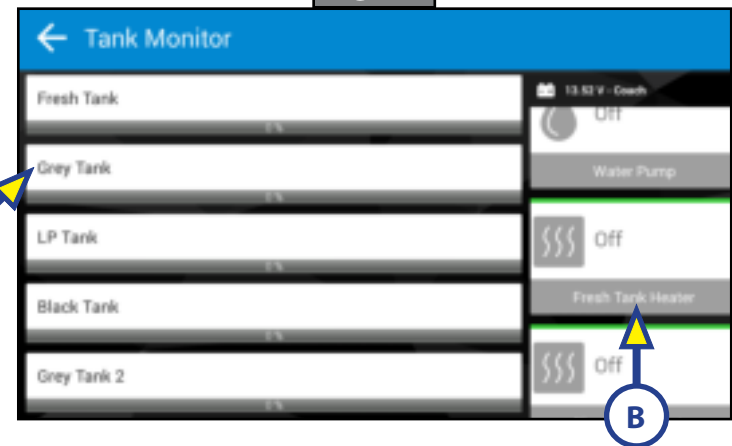

## Slides

1. Press the Slides icon to access the Slides screen (Fig. 16).
2. Select a slide-out to operate.
  - A. Press the OUT (+) button to extend the slide-out.
  - B. Press the IN (-) button to retract the slide-out.

Fig. 16



## Stabilizers

1. Press the Stabilizers icon to access the Stabilizers screen (Fig. 17).
2. Select a stabilizer to operate.
  - A. Press EXTEND (+) to extend the stabilizer.
  - B. Press RETRACT (-) to retract the stabilizer.

Fig. 17

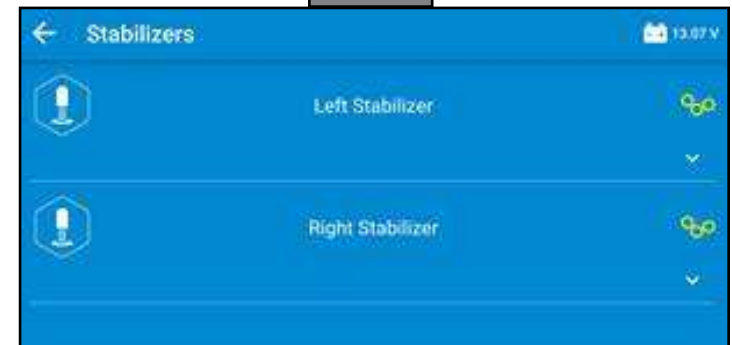



## Bluetooth Connection

After installing the Lippert OneControl app from the Apple app store or the Google Play store, open OneControl to start the procedure to connect a smart device to Bluetooth.

**NOTE:** The minimum requirements for the smart device are iOS 9.0 or Android 5.0 with Bluetooth 4.0.

1. Press the I ACCEPT button (Fig. 18A) on the EULA view.
2. Press the GET STARTED button (Fig. 19A) on the Welcome screen.
3. Select BLUETOOTH (Fig. 20A) when prompted.
4. Find the system name (Fig. 21A) that matches the ID supplied on the OneControl Bluetooth system.
5. Enter the password (Fig. 22A) included on the OneControl wireless system.
6. Type in a PIN number (Fig. 23) to prevent unintended access to the coach.
7. After OneControl has successfully connected, press the CONTINUE button to finish the setup.

Fig. 18

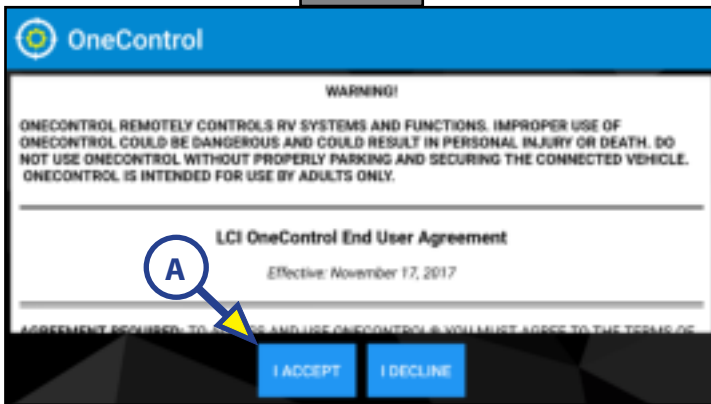

Fig. 19

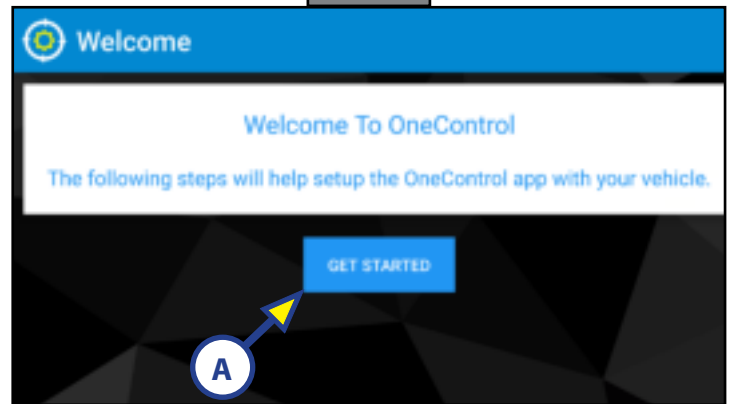

Fig. 20

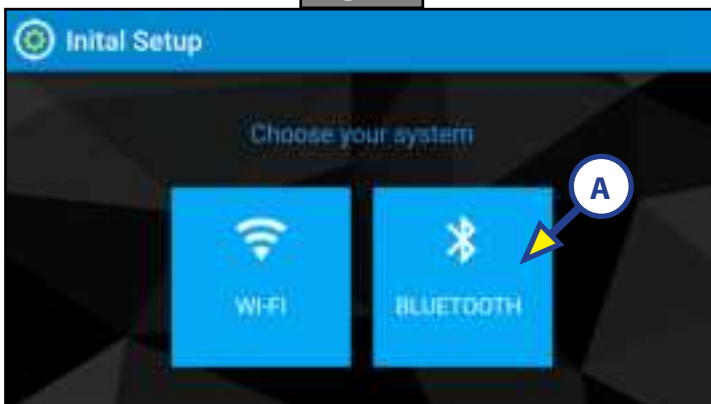

Fig. 21

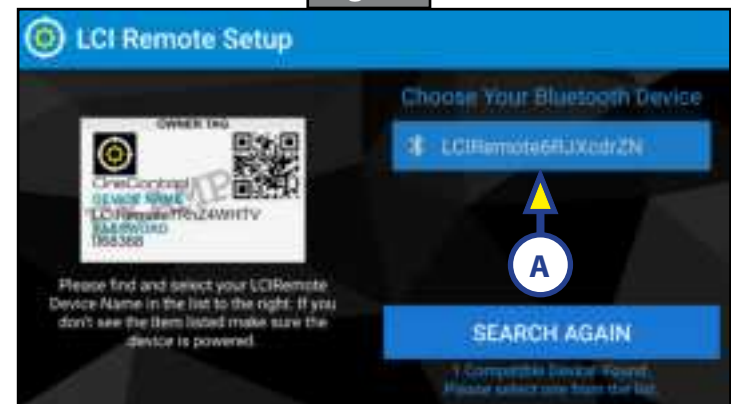

Fig. 22

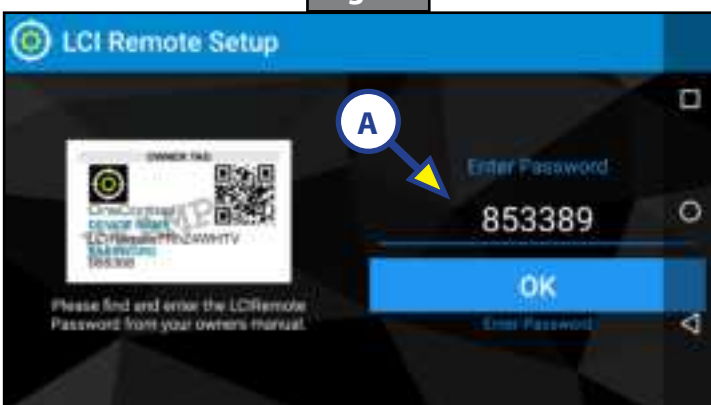
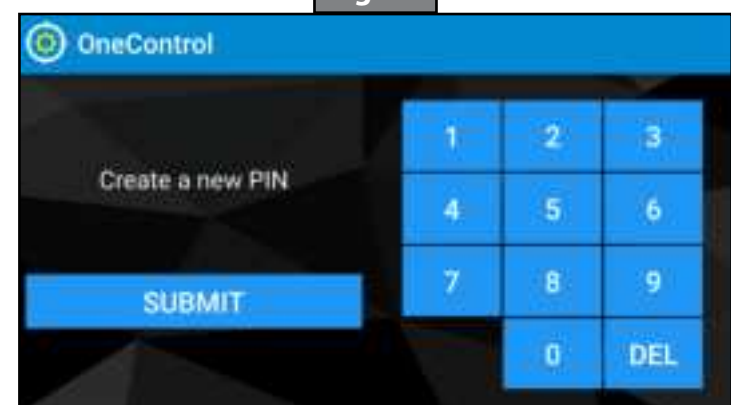

Fig. 23





## Lockout

There may be lockout capability from a motorized ignition if the brake system is wired into the controller. If a signal is received, the Unity Board will lock out several functions to prevent operation of the devices during transit.

If this occurs, there will be a padlock displayed at the top right-hand corner of the home screen (Fig. 24A) and a padlock will also be shown to the right of the functions that are locked (Fig. 25A).

Fig. 24

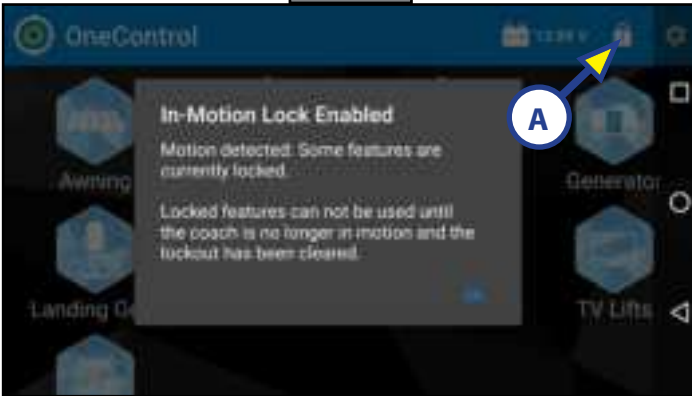
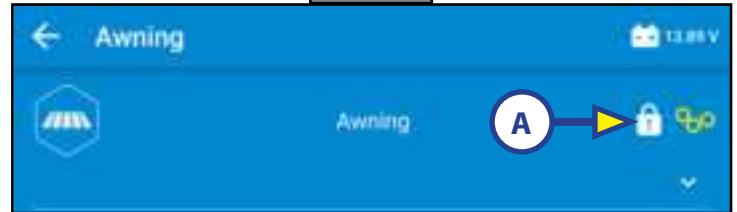

Fig. 25



## Troubleshooting

What Is Happening?	Why?	What Should Be Done?
Missing icons	Power disconnected	Verify adequate 12V power and ground to the appropriate module.
	Loose CAN harness connections	Verify the CAN data harnesses are connected. Remove the data harnesses and re-seat them. Make sure connector pins are not loose.
Missing slide icon	Bad or disconnected controller	Verify all slide controllers are connected and functional. Replace bad controller.
Selected function does not operate	Function is locked out	If the icon is present, but will not operate on the touchscreen, it may be locked out because the ignition is on. Turn ignition off.
	Function already open	If icon is present, but grayed out, the function could be open on a smart device connected to the OneControl app. Close function on smart device.
	Wrong fuse setting	In the configurator, verify the fuse has been set to the appropriate setting for that function.
On/Off feature turns on, but immediately turns off	Wrong fuse value	In the configurator, make sure the proper fuse value has been set for that output.
Touch panel will not power up	No fuse	Make sure the 5A fuse in the power center is present and intact.
	Loose fuse	Re-seat loose fuse.
	Blown fuse	Replace fuse.
Heat pump will not operate and switches to gas heat	Defaults to gas heat because certain conditions are not met	The outside temperature must be above 47 degrees.
		The set point cannot be more than 8 degrees above the current zone temperature; e.g., climate zone temperature is 68 degrees, then the set point cannot exceed 76 degrees.



The contents of this manual are proprietary and copyright protected by Lippert. Lippert prohibits the copying or dissemination of portions of this manual unless prior written consent from an authorized Lippert representative has been provided. Any unauthorized use shall void any applicable warranty. The information contained in this manual is subject to change without notice and at the sole discretion of Lippert. Revised editions are available for free download from [lippert.com](http://lippert.com).

Please recycle all obsolete materials.

For all concerns or questions, please contact Lippert  
Ph: 432-LIPPERT (432-547-7378) | Web: [lippert.com](http://lippert.com) | Email: [customerservice@lci1.com](mailto:customerservice@lci1.com)