



The Calculite 2" family features downlight, accent adjustable, and lensed wall wash serving as a complete recessed offering to accommodate all recessed application needs. The 50° light cut off and multiple adjustable beam angles provide quality light in a miniature aperture.

Project: \_\_\_\_\_

Location: \_\_\_\_\_



Cat.No: \_\_\_\_\_

Type: \_\_\_\_\_

Lamps: \_\_\_\_\_ Qty: \_\_\_\_\_

Notes: \_\_\_\_\_

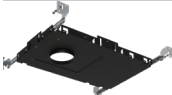
Follow the ordering guidelines below. Each step is a separate order line.

|  |  |                                   |  |
|--|--|-----------------------------------|--|
| <b>Step 1</b>  | Frame: Optional accessories available. Ordered & shipped separately. |                                   |  |
|  | Frame  | Example: 2RN                      |  |
|  | <div>C2</div>  |                                   |  |
| <b>Step 2</b>  | Engine & Trim: Ordered & shipped as a single product.                |                                   |  |
|  | Engine   | Example: C2RLW06927FLUPZU-C2RLWWT |  |
|  | <div>C2</div>  |                                   |  |
| <b>Step 3 (optional)</b>   | Accessories: Ordered & shipped separately.                           |                                   |  |

### Engine

example: C2RLW06927FLUPZU

| Series <sup>1</sup>            | Style                      | Lumens                        | CRI            | CCT                                | Beam            | Dimming / Voltage   | Flange   |
|--------------------------------|----------------------------|-------------------------------|----------------|------------------------------------|-----------------|---|--|
|                                | <b>LW</b>                  |                               | <b>9</b>       |                                    |                 |   |  |
| <b>C2R</b> Calculite 2" round  | <b>LW</b> Lensed Wall Wash | <b>06</b> 600lm               | <b>9</b> 90CRI | <b>27</b> 2700K                    | <b>FL</b> Flood | <b>UPZU</b> 0-10V 1%, ELV 3%, Triac 3%<br>Unv (120V/277V) | - Flanged<br>(leave blank)<br><b>F</b> Flangeless <sup>3</sup> |
| <b>C2S</b> Calculite 2" round  |                            | <b>09</b> 900lm               |                | <b>30</b> 3000K                    |                 |   |  |
| <b>C2S</b> Calculite 2" square |                            | <b>15</b> 1500lm <sup>2</sup> |                | <b>35</b> 3500K<br><b>40</b> 4000K |                 | <b>LU</b> Lutron PEQ, 100% - 0.1%<br>Unv (120V/277V)      |  |

### Trim

example: C2RLWWT

| Series                         | Style                      | Finish   | Flange   |
|--------------------------------|----------------------------|--|--|
|                                | <b>LW</b>                  |  |  |
| <b>C2R</b> Calculite 2" round  | <b>LW</b> Lensed Wall Wash | <b>WT</b> Textured white   | - White<br><b>F</b> Flangeless <sup>3</sup>  |
| <b>C2S</b> Calculite 2" square |                            | <b>WH</b> White (matte)<br><b>BK</b> Black (painted matte)<br><b>BT</b> Textured black<br><b>BZ</b> Bronze<br><b>D</b> Aluminum diffuse<br><b>CD</b> Clear diffuse (applied finish)<br><br>Special painted finishes available with RAL number. | - White (matte)<br><b>P</b> Matching reflector<br><b>F</b> Flangeless <sup>2</sup> |

### Accessories (order & install separately)

#### Accessories

|               |  |
|---------------|--|
| <b>SWCS</b>   | New or remodel construction, integral RADIO or remote (recessed or surface) sensing with 0-10v luminaires. See page 5 for more details. <sup>4</sup> |
| <b>CA2RFT</b> | Round 2" Mud-in Kit <sup>5</sup>   |
| <b>CA2SFT</b> | Square 2x2 Mud-in Kit <sup>5</sup>   |

- Standard light engine may be used as a remodeler. Optional traditional frame-in kits are available.
- The 1500lm (15) lumen option is available for non-IC only.
- Flangeless option code must be ordered for both light engine and trim. Mud-in ring is integral with the light engine.
- Requires IRT9015 IR remote & Interact Pro App for commissioning.
- Mud-in kits provided as standard with engines but are available as accessories as needed to support construction.

# C2LW Calculite 2"

## Round and Square Lensed Wall Wash

### Applications

- Ideal for use in retail, restaurants, residential, and office spaces to accentuate the space and provide tactical or ambience lighting from a minimalistic aperture
- The light engine is designed to be installed as a retrofit without need for a frame. Frames are optional to accommodate ceiling construction.
- Driver pod is tethered electrically to light engine.
- All components are designed to accommodate below ceiling accessibility through the aperture without need for tools.

### Dimensions

- **Max Ceiling Thickness:** 1.50"
- **Ceiling Cutout:** 3"

### Frame-in-kits (optional)

- Light engines are designed to be installed as a retrofit without need for a separate frame
- Die formed steel construction with 1/2" collar for ease of cutting the hole in ceiling.
- Optional new construction frames are available to support rough-in wiring in advance of finishing section.
- Rough-in wiring is done on the light engine driver pod.
- Four models offered:
  - **2RN:** 2" Round New Construction, Non-IC
  - **2SN:** 2" Square New Construction, Non-IC
  - **2RA:** 2" Round New Const., IC, AirSeal, CCEA\*
  - **2SA:** 2" Square New Const., IC, AirSeal, CCEA\*
- \* 900lm maximum for IC applications.

### Optical systems

- **TIR** optics precisely control the beam pattern. Optics are field changeable.
- **PET** film provides a clean beam with mitigated spill and precise color mixing. Specially designed upper optic optimizes light distribution on the wall.
- **COB** (chip on board) provides long useful life with precise color control over time.
- Finishing section trims are durable die cast aluminum with precision painted finish. May be easily repainted in the field to match desired aesthetic appeal.
- 50° cutoff angle.

### Dimming

- UPZ option is universal 0-10v (1%), electronic low voltage (3%), and triac (3%) in a single driver
- Lutron PEQ (L) dimming to 0.1%

### MesoOptics optical diffusion film

- **PET** film containing surface relieved, microscopic light diffusing structures/elements.
- Provides a clean beam with mitigated spill at articulated angles.
- Optimizes luminaire efficacy via high optical transmission.
- Homogenizes light engine luminance providing smooth gradients of white light.
- Uniformly lit optical aperture creates a balance of beam precision coupled with smooth gradients of pure white light.

### Light engine

- Die cast heat sinks provide optimized passive thermal management to maximize LED lumen maintenance.
- Precision spun lower collar mechanically attaches to heat sink assembly tool-free via springs. Integral leaf springs for flanged configurations allow easy installation into the ceiling or on optional frame-in kits.
- For flangeless applications, mesh mud-in ring is integral to the lower collar eliminating the need to handle/order an accessory. Must specify flangeless light engine and trim. Separate mud-in rings are available as accessories to support construction (CA2RFT, CA2SFT).
- Predicted 70% lumen maintenance to >70,000 hours.
- 32°-86°F ambient operating range (0°-30°C).

### Labels and listings

- cULus listed for damp locations
- CEC Title 24 JA8 certified (full list pending)
- CCEA listing on 2RA/2SA frames
- Red List Declare label certified, ID SIG-0018 ([View full Declare label](#))

### Warranty



5 year limited warranty  
Visit [Signify.com/warranties](https://Signify.com/warranties) for more information on Signify's standard 5-year limited warranty on complete luminaire systems.

# Declare.

### Lightolier Calculite 2" Genlyte Solutions by Signify

**Final Assembly:** Apodaca, Nuevo León, México  
**Life Expectancy:** 10+ Year(s), Warranty 5 Year(s)  
**End of Life Options:** Recyclable (90%), Landfill (10%)

#### Ingredients:

Aluminum; Small Electrical Components - RoHS Compliant<sup>1</sup>; Iron; Siloxanes and Silicones; Fatty acids, castor-oil, caustic-oxidized, distn. residues, esters with 1,3-butanediol; Carbonic acid, polymer with 4,4'-(1-methylethylidene)bis[phenol]; Steel; Barium sulfate; Silicon; Titanium dioxide; Copper; Magnesium; Poly[imino(1,6-dioxo-1,6-hexanedyl)imino-1,6-hexanedyl]; Zinc; Polyethylene Terephthalate/Polybutylene Terephthalate; Polyvinyl chloride; Polyethylene Terephthalate; Manganese; 1,3,5-Triglycidyl-s-triazinetriene; Amorphous silica; Tris(2-ethylhexyl) trimellitate; Urethane (Ethyl carbamate); Pulp, cellulose; Chromium, metallic; Polyethylene; Titanium; Silicone; Graphite; Tin; Organic; Nickel (Metallic); Talc; Graphite; Carbon black; Antimony oxide (Antimony trioxide); Carbon black; Polytetrafluoroethylene; 2-Propenoic acid, 2-methyl-, methyl ester, polymer with ethyl 2-propenoate; Kaolin, calcined; Calcium Carbonate; Melamine cyanurate; Phosphorus; 1,3,5-Triazine-2,4,6-triamine, phosphate (1:1); Quartz; Zinc oxide; Sulfur, Elemental

<sup>1</sup>LBC Temp Exception RL-002 - Small Electrical Components

#### Living Building Challenge Criteria:

##### I-13 Red List:

- ☐ LBC Red List Free
- ☐ LBC Red List Approved
- ☒ Declared

% Disclosed: 100% at 100ppm  
VOC Content: Not Applicable

I-10 Interior Performance: Not Applicable  
I-14 Responsible Sourcing: Not Applicable

SIG-0018  
EXP. 01 JUN 2026  
Original Issue Date: 2025

FOR FULL PRODUCT INFORMATION, VISIT: [living-future.org/declare](https://living-future.org/declare)

### 0-10v/ELV/Triac Electrical Tables

| Light Engine | Input volts | Input current | Drive current | Input power |
|--------------|-------------|---------------|---------------|-------------|
| C2_06_UPZU   | 120V        | 0.08A         | 250mA         | 9.8W        |
|              | 277V        | 0.04A         | —             | —           |
| C2_09_UPZU   | 120V        | 0.11A         | 350mA         | 13.4W       |
|              | 277V        | 0.05A         | —             | —           |
| C2_15_UPZU   | 120V        | 0.19A         | 600mA         | 23.3W       |
|              | 277V        | 0.08A         | —             | —           |

### Lutron Electrical Tables

| Light Engine | Input volts | Input current | Drive current | Input power |
|--------------|-------------|---------------|---------------|-------------|
| C2_06_LU     | 120V        | 0.08A         | 250mA         | 9.7W        |
|              | 277V        | 0.04A         | —             | —           |
| C2_09_LU     | 120V        | 0.11A         | 350mA         | 13.6W       |
|              | 277V        | 0.05A         | —             | —           |
| C2_15_LU     | 120V        | 0.19A         | 600mA         | 23.3W       |
|              | 277V        | 0.08A         | —             | —           |

# C2LW Calculite 2"

## Round and Square Lensed Wall Wash

# interact

|   | Gateway Connected |          |          |
|---|-------------------|----------|----------|
|   | Standalone        | Option 1 | Option 2 |
| Dimming, grouping, and zoning                       | ✓                 | ✓        | ✓        |
| Bluetooth and ZigBee enabled                        | ✓                 | ✓        | ✓        |
| Motion sensing and daylight harvesting              | ✓                 | ✓        | ✓        |
| Integration with 0-10V and phase dimming fixtures   | ✓                 | ✓        | ✓        |
| Code compliance                                     | ✓                 | ✓        | ✓        |
| Granular dimming and dwell time                     | ✓                 | ✓        | ✓        |
| Correlated color temperature (CCT) tuning by switch | New               | ✓        | ✓        |
| Support for sensor-based Tunable White luminaires   | New               | ✓        | ✓        |
| Energy reporting and monitoring                     |                   | ✓        | ✓        |
| Scheduling  |                   | ✓        | ✓        |
| Demand response                                     |                   | ✓        | ✓        |
| BMS integration (BACnet)                            |                   |          | ✓        |
| Floor plan visualization                            |                   |          | ✓        |
| IoT sensors for wellness                            |                   |          | ✓        |
| IoT Apps for productivity                           |                   |          | ✓        |

### Currently supported maximum system size

To be able to design the lighting system correctly for the customer, it is important to know the prime characteristics of the system, its possibilities and limitations.

| System level                                       |                  |
|--|------------------|
| Total number of gateways                           | Unlimited        |
| Total number of devices                            | 200 per network  |
| • Luminaires with integrated sensors               | 150              |
| • Smart TLEDs                                      | 150              |
| • Zones + groups                                   | 64               |
| Total number of ZGP devices (sensors and switches) | 50               |
| • Sensors  | 30               |
| • Switches   | 50               |
| Group level  |                  |
| Recommended number of lights                       | 40 (maximum 150) |
| Number of ZGP devices                              | 5                |
| Number of scenes                                   | 16               |

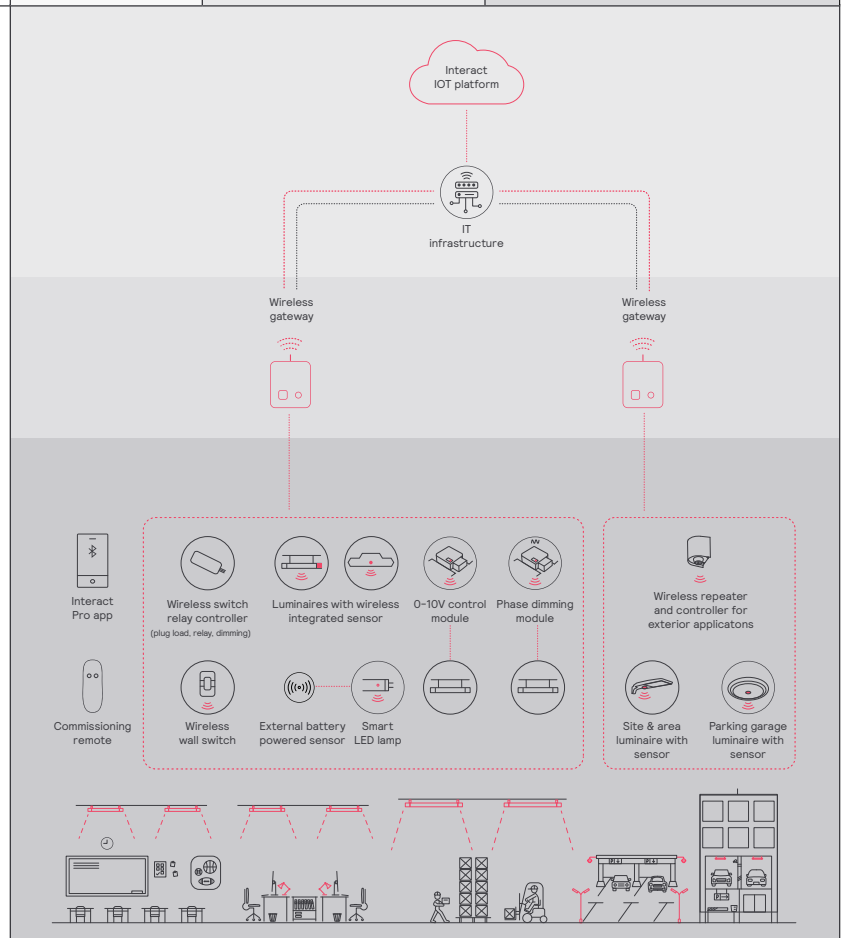

# C2LW Calculite 2"

## Round and Square Lensed Wall Wash

### Wireless controls options

#### Interact

- SWZCS is a connected sensor with integral occupancy and daylight sensing and supports wireless mesh connectivity.
- The sensor works in the standalone mode (similar to SpaceWise) when configured without a gateway or in a cloud connected mode if a compatible gateway is used.
- Interact includes an App, a portal and a broad portfolio of wireless luminaires, lamps and retrofit kits all working on the same system.
- Startup is implemented via Interact Pro App (Android or iPhone) & Bluetooth connectivity. The App provides flexibility to choose between a gateway or non gateway mode for setup.
- Setup with the gateway requires wired internet access to the gateway. It is possible to add a gateway at a later point.
- Prepare project configuration steps remotely and use IRT9015 remote on-site to identify and group devices together.

#### Compatible with:

- SWS200 & UID8465 wireless scene switch
- Battery powered IP42 presence sensor OCC sensor IA CM WH 10/1
- Battery powered IP42 presence & daylight sensor OCC-DL sensor IA CM IP42 WH
- LCN3110: battery powered IP65 presence sensor, OCC sensor IA CM IP65W
- LCN3120: battery powered IP65 presence & daylight sensor, OCC-DL sensor IA CM IP65 WH
- For more information on Interact visit: [interact-lighting.com/interactproscalablesystem](https://www.interact-lighting.com/interactproscalablesystem)

#### Radio only sensor (RA or RADIO)

- Integral RA or RADIO only sensor simply enables wireless mesh connectivity to the luminaire without any occupancy or daylight sensing.
- Ideal for applications where sensing functionality is managed by other Interact devices and the luminaire only needs to have wireless connectivity.
- Interact includes an App, a portal and a broad portfolio of wireless luminaires, lamps and retrofit kits all working on the same system.
- Startup is implemented via Interact Pro App (Android or iPhone) & Bluetooth connectivity. The App provides flexibility to choose between a gateway or non-gateway mode for setup.
- Setup with the gateway requires wired internet access to the gateway. It is possible to add a gateway at a later point.
- Prepare project configuration steps remotely, identify and group devices together onsite.
- Compatible with SWS200 and UID8465 wireless scene switch, wireless Occ sensor (OCC SENSOR IA CM IP42 WH 10/1) and wireless Day/Occ sensor (OCC MULTI SENSOR IA CM WH 10/1).
- For more information on Interact visit: [interact-lighting.com/interactproscalablesystem](https://www.interact-lighting.com/interactproscalablesystem)

#### SWCS Accessory

- Recessed Interact accessory for use in new construction or remodel construction for use with 0-10v luminaires. Available for integral RADIO, or remote sensing in either recessed or surface mounting. Refer to spec sheet for more details. [https://www.usa.lighting.philips.com/api/assets/v1/file/Signify/content/SWCS-ESS/SWCS\\_Specification\\_Sheet.pdf](https://www.usa.lighting.philips.com/api/assets/v1/file/Signify/content/SWCS-ESS/SWCS_Specification_Sheet.pdf)

#### Sensor bundle (IAOSB or SB)

- A wireless IoT connected lighting solution for large enterprises that span across multiple floors, buildings and require multiple gateways.
- View all your projects under one dashboard and easily compare insights from multiple projects in one view.
- Compatible with SWS200 wireless scene switch, wireless Occ sensor (OCC SENSOR IA CM IP42 WH 10/1) and wireless Day/Occ sensor (OCC MULTI SENSOR IA CM WH 10/1) and wireless Occupancy or Daylight & Occupancy sensors available. Use Interact software and insights to increase building efficiency, achieve building wide integration and optimize space through occupancy analytics.
- IAOSB or SB option in addition to occupancy and daylights sensing supports advanced IoT capabilities, such as people estimation analysis, desk level temperature & humidity sensing, noise classification, and BLE beacon.
- Requires compatible Gateway and internet connectivity for commissioning.
- For more information, visit: [interact-lighting.com/interactproscalablesystem](https://www.interact-lighting.com/interactproscalablesystem)

#### Emergency Options (ER100)

- **Power Sensing** (factory default) – Recommended UL924 option requires unswitched power sense line, absence of voltage on the normal circuit triggers luminaire to 100% output.
- **Power Interruption Detection** (field option) – Detects AC power interruption >30ms triggers 90 minute emergency mode with luminaire at 100% output.

### Interact supported sensor option codes across Genlyte product lines

|   | Evokit | Day-Brite | Ledalite | Lightolier               |
|---|--------|-----------|----------|--------------------------|
| ZigBee + Bluetooth + Sensing                      | SWZCS  | SWZCS     | CS       | SBA accessory (external) |
| ZigBee + Bluetooth                                | RADIO  | RADIO     | RA       | RA                       |
| ZigBee + Bluetooth + Sensing + Environmental data | IAOSB  | IAOSB     | SB       | SB                       |
| ZigBee + Highbay + Sensing                        | -      | SWZCSH    | -        | -                        |

# C2LW Calculite 2"

## Round and Square Lensed Wall Wash

### Round Engine

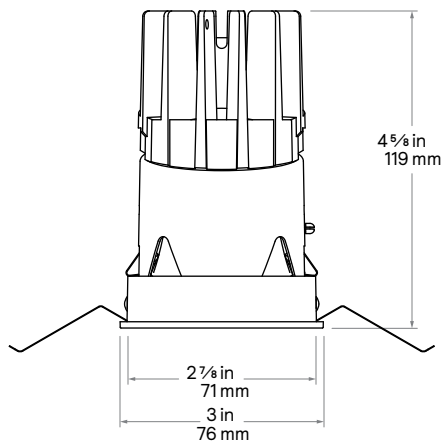

### Round Trim

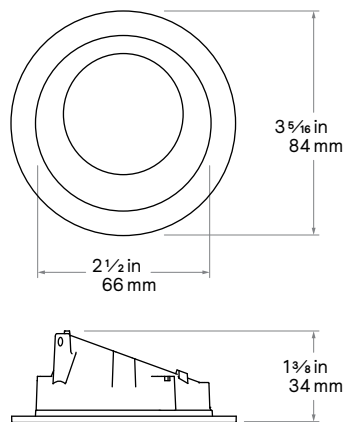

### Round Mud-in ring

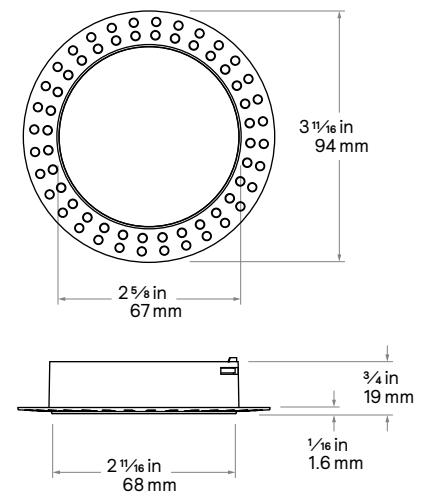

\* Mud-in rings are integral to the light engine.  
Must order flangeless light engine and trim  
with (F) option code.

### Square Engine

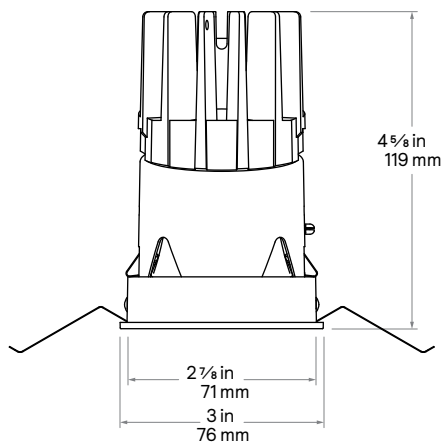

### Square Trim

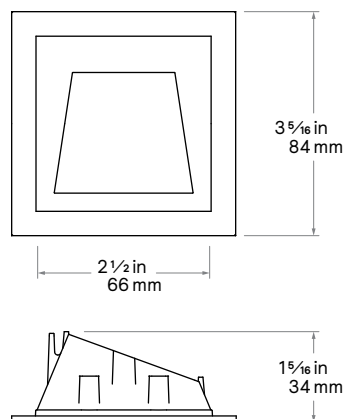

### Square Mud-in ring

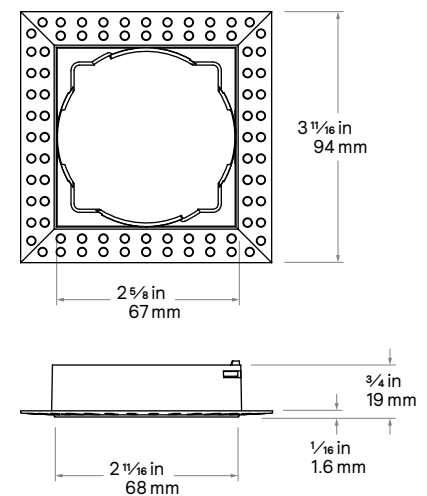

\* Mud-in rings are integral to the light engine.  
Must order flangeless light engine and trim  
with (F) option code.

# C2LW    Calculite 2"

## Round and Square Lensed Wall Wash

### Frames

The standard C2R/C2S light engines may be installed non-IC as a remodeler with no additional frame-in kit required. Optional frames below are available to facilitate ceiling construction

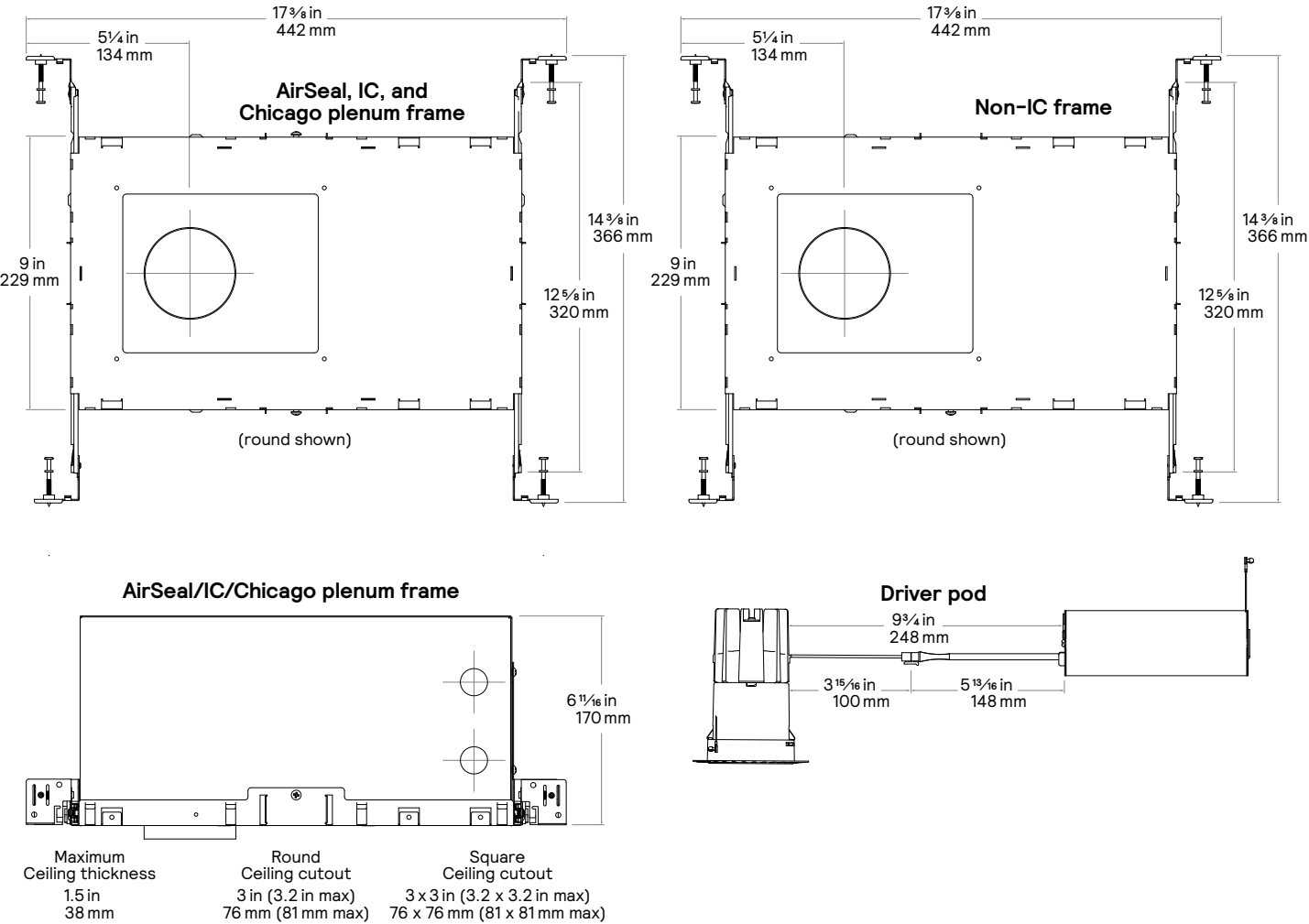

# C2LW Calculite 2"

## Round and Square Lensed Wall Wash

**Finishes** Shown as round reflectors but represent the finish of Calculite square reflectors.



Matched Reflector



Flangeless

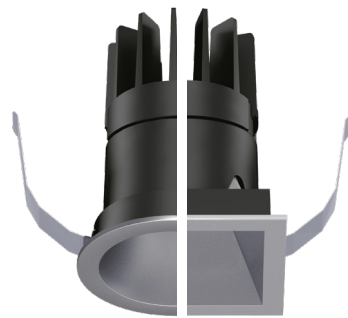

Matched Reflector



Flangeless

**Clear diffuse (CD):** Diffused painted finish with a hint of sparkle where a refined finish is desired.

**Aluminum diffuse (D):** Semi-specular finish that softens the light at the source of the reflector and creates a subtle, even luminance from the reflector cone.



Matched Reflector



Flangeless

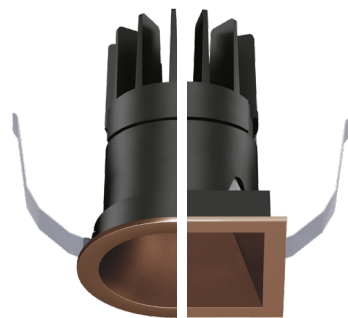

Matched Reflector



Flangeless

**Black Textured (BT):** Textured Matte finish that provides the lowest aperture brightness possible and significantly reduces source identification in a ceiling.

**Bronze (BZ):** Matte finish that provides the lowest aperture brightness possible and significantly reduces source identification in a ceiling.



Matched Reflector



Flangeless



Matched Reflector

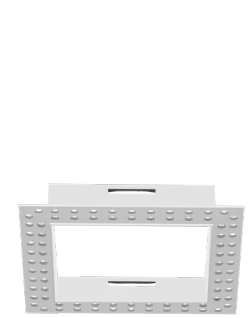

Flangeless

**White Textured (WT):** Textured finish that provides the brightest illuminated aperture and provides the smoothest transition to most ceilings when off (white is only available with a white flange).

**Mud-in ring (WH):** Low profile, machined aluminum mud-in ring provides a raised rib to plaster up to and a 3/16" flange thickness. The ring is attached to the ceiling material directly via flat head screws (contractor supplied).

# C2LW Calculite 2"

## Round and Square Lensed Wall Wash

### Round

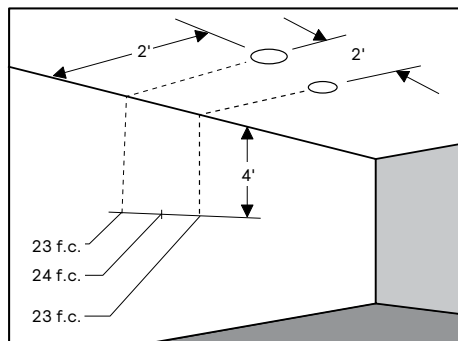

### Square

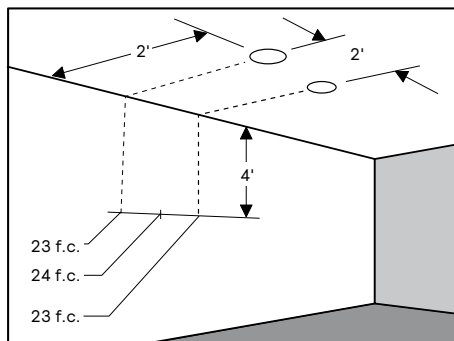

#### Adjustment Factors

| Finish    | CCT (90CRI)  | Lumens        |
|-----------|--------------|---------------|
| WT = 100% | 4000K = 107% | 1500lm = 167% |
| BT = 97%  | 3500K = 100% | 600lm = 66%   |
| BZ = 97%  | 3000K = 93%  |               |
| D = 101%  | 2700K = 93%  |               |
| CD = 102% |              |               |

### Round, Wall Wash, 900lm engine, 69 lm/W at 14W

#### Candela Curve

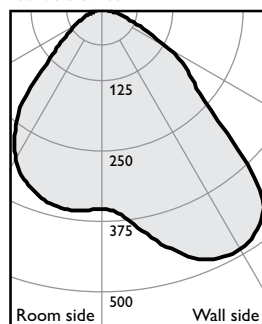

Engine: C2RLW09935FLUPZU  
Trim: C2RLWWT

Output lumens: 799 lms  
Input watts: 14 W  
CRI: 90 min  
CCT: 3500K

Efficacy: 69.0 lm/w  
Report: STMR-3201

#### Multiple unit data Footcandles on wall

|                               | 2' from wall |    |    |
|-------------------------------|--------------|----|----|
|                               | 2' on ctr.   |    |    |
| Distance from ceiling in feet | 1            | 2  | 3  |
| 1                             | 21           | 23 | 21 |
| 2                             | 47           | 51 | 47 |
| 3                             | 55           | 59 | 55 |
| 4                             | 45           | 49 | 45 |
| 5                             | 32           | 35 | 32 |
| 6                             | 23           | 24 | 23 |
| 7                             | 16           | 17 | 16 |
| 8                             | 13           | 13 | 13 |
| 9                             | 9            | 9  | 9  |
| 10                            | 7            | 7  | 7  |
| 11                            | 6            | 6  | 6  |
| 12                            | 5            | 5  | 5  |

#### Multiple unit data Footcandles on wall

|                               | 2' from wall |    |    |
|-------------------------------|--------------|----|----|
|                               | 3' on ctr.   |    |    |
| Distance from ceiling in feet | 1            | 2  | 3  |
| 1                             | 10           | 8  | 10 |
| 2                             | 21           | 17 | 21 |
| 3                             | 24           | 22 | 24 |
| 4                             | 20           | 20 | 20 |
| 5                             | 15           | 16 | 15 |
| 6                             | 12           | 12 | 12 |
| 7                             | 9            | 9  | 9  |
| 8                             | 7            | 7  | 7  |
| 9                             | 5            | 6  | 5  |
| 10                            | 4            | 5  | 4  |
| 11                            | 4            | 4  | 4  |
| 12                            | 3            | 3  | 3  |

#### Multiple unit data Footcandles on wall

|                               | 3' from wall |    |    |
|-------------------------------|--------------|----|----|
|                               | 3' on ctr.   |    |    |
| Distance from ceiling in feet | 1            | 2  | 3  |
| 1                             | 4            | 4  | 4  |
| 2                             | 8            | 8  | 8  |
| 3                             | 13           | 13 | 13 |
| 4                             | 15           | 15 | 15 |
| 5                             | 15           | 15 | 15 |
| 6                             | 13           | 13 | 13 |
| 7                             | 11           | 11 | 11 |
| 8                             | 9            | 9  | 9  |
| 9                             | 7            | 7  | 7  |
| 10                            | 6            | 6  | 6  |
| 11                            | 5            | 5  | 5  |
| 12                            | 4            | 4  | 4  |

### Square, Wall Wash, 900lm engine, 69 lm/W at 14W

#### Candela Curve

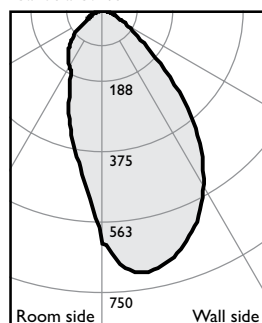

Engine: C2SLW09935FLUPZU  
Trim: C2SLWWT

Output lumens: 827 lms  
Input watts: 14 W  
CRI: 90 min  
CCT: 3500K

Efficacy: 59.0 lm/w  
Report: STMR-3202

#### Multiple unit data Footcandles on wall

|                               | 2' from wall |    |    |
|-------------------------------|--------------|----|----|
|                               | 2' on ctr.   |    |    |
| Distance from ceiling in feet | 1            | 2  | 3  |
| 1                             | 33           | 35 | 33 |
| 2                             | 65           | 70 | 65 |
| 3                             | 62           | 67 | 62 |
| 4                             | 42           | 45 | 42 |
| 5                             | 26           | 28 | 26 |
| 6                             | 17           | 18 | 17 |
| 7                             | 11           | 12 | 11 |
| 8                             | 8            | 8  | 8  |
| 9                             | 6            | 6  | 6  |
| 10                            | 5            | 5  | 5  |
| 11                            | 4            | 4  | 4  |
| 12                            | 3            | 3  | 3  |

#### Multiple unit data Footcandles on wall

|                               | 2' from wall |    |    |
|-------------------------------|--------------|----|----|
|                               | 3' on ctr.   |    |    |
| Distance from ceiling in feet | 1            | 2  | 3  |
| 1                             | 15           | 12 | 15 |
| 2                             | 28           | 24 | 28 |
| 3                             | 27           | 25 | 27 |
| 4                             | 19           | 20 | 19 |
| 5                             | 13           | 13 | 13 |
| 6                             | 9            | 9  | 9  |
| 7                             | 7            | 7  | 7  |
| 8                             | 5            | 5  | 5  |
| 9                             | 4            | 4  | 4  |
| 10                            | 3            | 3  | 3  |
| 11                            | 3            | 3  | 3  |
| 12                            | 2            | 2  | 2  |

#### Multiple unit data Footcandles on wall

|                               | 3' from wall |    |    |
|-------------------------------|--------------|----|----|
|                               | 3' on ctr.   |    |    |
| Distance from ceiling in feet | 1            | 2  | 3  |
| 1                             | 6            | 5  | 6  |
| 2                             | 13           | 12 | 13 |
| 3                             | 18           | 18 | 18 |
| 4                             | 18           | 19 | 18 |
| 5                             | 15           | 16 | 15 |
| 6                             | 12           | 12 | 12 |
| 7                             | 9            | 9  | 9  |
| 8                             | 7            | 7  | 7  |
| 9                             | 6            | 6  | 6  |
| 10                            | 4            | 4  | 4  |
| 11                            | 4            | 4  | 4  |
| 12                            | 3            | 3  | 3  |

1. Correlated Color Temperature within specs as defined in ANSI\_NEMA\_ANSLG C78.377-2008: Specifications for the Chromaticity of Solid State Lighting Products.
2. Tested using absolute photometry as specified in LM79: IESNA Approved Method for the Electrical and Photometric Measurements of Solid-State Lighting Products.