

WORKPRO

ORIGINAL OPERATING INSTRUCTIONS

CORDLESS ELECTRIC STAPLER

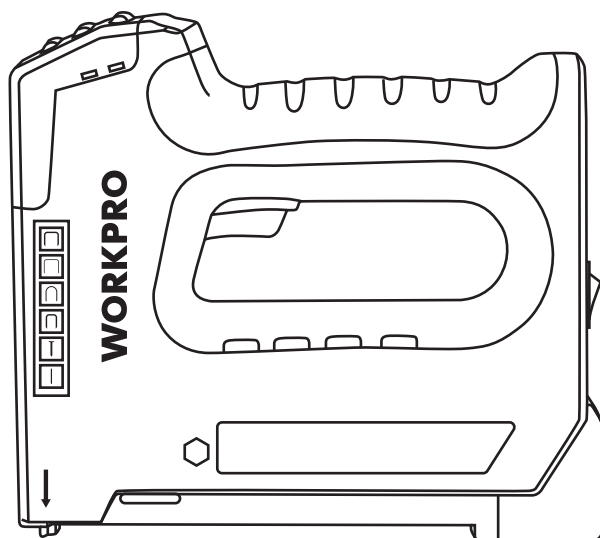

Thank you for buying a WORKPRO cordless electric stapler. Your new stapler has been engineered and manufactured to WORKPRO's high standard for dependability, ease of operation, and operator safety. Properly cared for, it will give you years of rugged, trouble-free performance.



WARNING: To reduce the risk of injury, the user must read and understand the operator's manual.

SAVE THIS MANUAL FOR FUTURE REFERENCE



Distributed by :
Hangzhou GreatStar Industrial Co.,Ltd.
No.35 Jiuhuan Road, Jiubao Town,
Hangzhou 310019, China
www.greatstartools.com

Fig.1

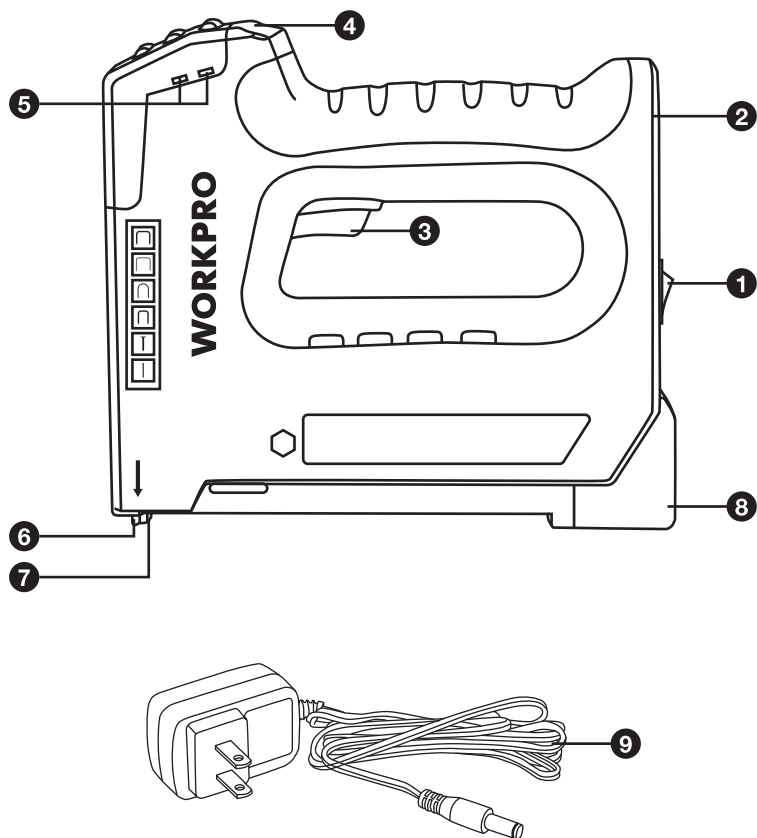
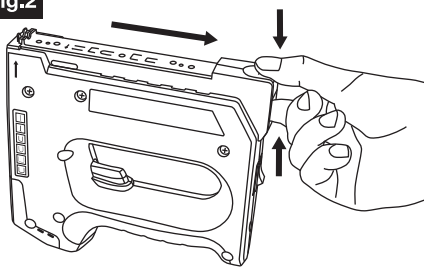
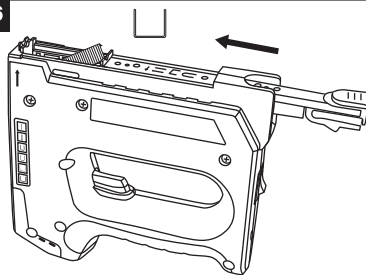

Fig.2



Squeeze the magazine end and slide it out.

Fig.6



Close the magazine until it locks into position.

Fig.3

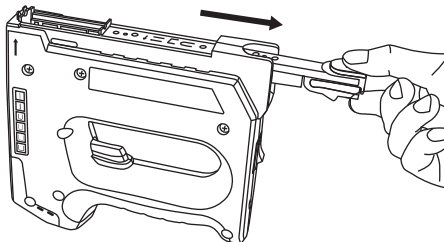
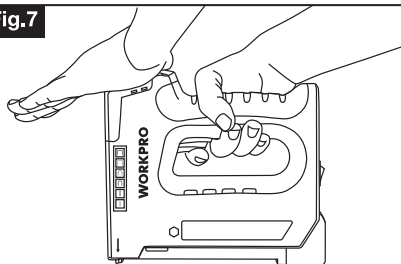
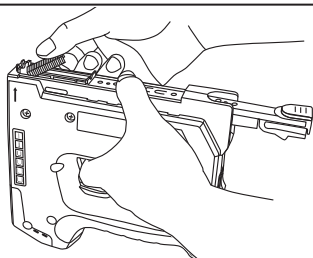

Fig.7



Two-handed operation will assist in better penetration.

Fig.4



Place staples with the sharp edge pointing upwards.

Fig.8

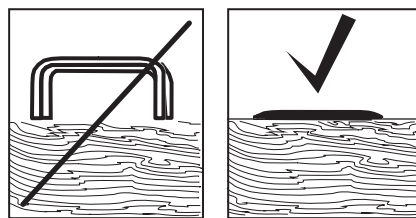

a

b

Fig.5

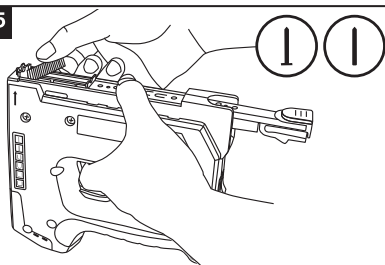

Place nails on the left side of the magazine with the sharp edge pointing upwards.

Fig.9

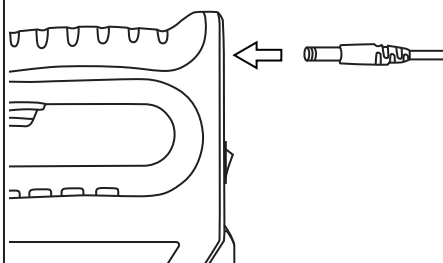



To avoid injury and misuse, please read the instruction manual before operation.



To avoid loss of hearing, always wear ear protection when operating the tool.



To avoid eye injury always wear safety glasses when operating the tool.



Obey all safety messages that follow this symbol to avoid possible injury or death.

TABLE OF CONTENTS

General Power Tool Safety Warnings	5-6
Specific Warnings & Safety Rules.....	6
Layout And Items Supplied	6
Technical Data.....	6-7
Operation	7
About Your Battery And Charging The Tool	8
Cleaning And Maintenance	8
Storage.....	8
Disposal And Recycling.....	8

1. GENERAL POWER TOOL SAFETY WARNINGS

⚠ WARNING: Read all safety warnings and all instructions. Failure to follow the warnings and instructions may result in electric shock, fire and/or serious injury.

Save all warnings and instructions for future reference.

The term "power tool" in the warnings refers to your battery operated (cordless) power tool.

1.1 WORK AREA SAFETY

- a) **Keep work area clean and well lit.** Cluttered or dark areas invite accidents.
- b) **Do not operate power tools in explosive atmospheres, such as in the presence of flammable liquids, gases or dust.** Power tools create sparks, which may ignite the dust or fumes.
- c) **Keep children and bystanders away while operating a power tool.** Distractions can cause you to lose control.

1.2 ELECTRICAL SAFETY

- a) **Power tool plugs must match the outlet. Never modify the plug in any way. Do not use any adapter plugs with earthed (grounded) power tools.** Modifying plug and failure to use proper outlet increases risk of electrical shock.
- b) **Avoid body contact with earthed or grounded surfaces such as pipes, radiators, ranges and refrigerators.** There is an increased risk of electric shock if your body is earthed or grounded.
- c) **Do not expose power tools to rain or wet conditions.** Water entering a power tool will increase the risk of electric shock.
- d) **If operating a power tool in a damp location is unavoidable, use a residual current device (RCD) protected supply.** Use of an RCD reduces the risk of electric shock.
- e) **Keep charger cord intact. Do not abuse charger cord. Never use the charger cord for carrying, pulling or unplugging the power tool from electric outlet. Keep charger cord away from heat, oil, sharp edges or moving parts.** Damaged or entangled cords increase the risk of electric shock.

1.3 PERSONAL SAFETY

- a) **Stay alert, watch what you are doing and use common sense when operating a power tool. Do not use a power tool while you are tired or under the influence of drugs, alcohol or medication.** A moment of inattention while operating power tools may result in serious personal injury.
- b) **Use personal protective equipment. Always wear eye protection with side shields and ear protection.** Protective equipment such as dust masks, non-skid safety shoes, hard hats, or hearing protection used for appropriate conditions will reduce chance of personal injury.
- c) **Prevent unintentional starting. Ensure the switch is in the off position before connecting to the power source and/or battery charger, picking up,**

or carrying the tool. Do not power tools with your finger on the switch or energizing power tools that have the switch on because such action invites accidents.

- d) **Do not overreach. Keep proper footing and balance at all times.** This enables better control of the power tool in unexpected situations.
- e) **Dress properly. Do not wear loose clothing, accessories or jewelry. Keep your hair, clothing and gloves away from moving parts.** Loose clothes, accessories, jewelry or long hair can be caught in moving parts.

1.4 POWER TOOL USE AND CARE

- a) **Do not force the power tool. Use the correct power tool for your application.** The correct power tool will do the job better and safer at the rate for which it was designed.
- b) **Do not use the power tool if the switch does not turn it on and off.** Any power tool that cannot be controlled with the switch is dangerous and must be repaired.
- c) **Ensure power switch is in off position and disconnected from the charger power source before making any adjustments, changing accessories, or storing power tools.** Such preventive safety measures reduce the risk of starting the power tool accidentally.
- d) **Store idle power tools out of the reach of children, and do not allow persons unfamiliar with the power tool or these instructions to operate the power tool.** Power tools are dangerous in the hands of untrained users.
- e) **Maintain power tools. Check for misalignment or binding of moving parts, breakage of parts and any other condition that may affect the power tool's operation. If damaged, have the power tool repaired before use.** Accidents may be caused by poorly maintained power tools.
- f) **Use the power tool and accessories in accordance with these instructions and in the manner intended for the particular type of power tool, taking into account the working conditions and the work to be performed.** Use of the power tool for operations different from those intended could result in a hazardous situation.

1.5 BATTERY TOOL USE AND CARE

- a) **Recharge the power tool only with the charger specified by the manufacturer.** A charger that is suitable for one type of power tool may create a risk of fire when used with another power tool.
- b) **Under abusive conditions and extreme temperature, liquid may be ejected from the battery; avoid contact.** If contact accidentally occurs, flush with water. If liquid contacts eyes, seek medical help. Liquid ejected from the battery may cause irritation or burns.
- c) **Do not store tool in locations where the temperature may reach or exceed 104°F (40°C).** Extended periods of extreme heat may cause damage to the battery and possible fire.

- d) **Do not dispose of the tool by incineration.** The batteries may explode in fire.

1.6 MAINTENANCE

- a) **Have your power tool serviced by a qualified repair person using only identical replacement parts.** This will ensure that the safety of the power tool is maintained.

2. SPECIFIC WARNINGS & SAFETY RULES

2.1 ADDITIONAL SAFETY WARNINGS

Always assume that the tool contains fasteners. Careless handling of the tool can result in unexpected firing of fasteners and personal injury.

Do not point the tool towards yourself or anyone nearby. Unexpected triggering will discharge the fastener and can cause an injury.

Do not actuate the tool unless the tool is placed firmly against the workpiece. If the tool is not in contact with the workpiece, the fastener may be deflected away from your target.

Ensure power switch is in off position and keep tool disconnected from the power source when the fastener jams in the tool. While removing a jammed fastener, the tool may be accidentally activated if it is charged and in the on position or plugged in and connected to its charger.

Use caution while removing a jammed fastener. Point the tool away from self or others. The mechanism may be under compression and the fastener may be forcefully discharged while attempting to free a jammed condition.

Do not use this tool for fastening high voltage (>50V) electrical cables. It is not designed for electric cable installation and may damage the insulation of electric cables, thereby causing electric shock or fire hazards.

2.2 SPECIFIC SAFETY RULES

- 1. Hold tool by insulated gripping surfaces when performing an operation where the tool may contact hidden wiring or its own cord.** Contact with a "live" wire will also make exposed metal parts of the tool "live" and can shock the operator.
- 2. Know your power tool.** Read operator's manual carefully. Learn its applications and limitations, as well as the specific potential hazards related to this tool. Following this rule may reduce the risk of electric shock, fire, or serious injury.
- 3. Always wear safety glasses with side shields.** Everyday glasses have only impact resistant lenses. They are NOT safety glasses. Following this rule may reduce the risk of eye injury.
- 4. Protect your hearing.** Wear hearing protection during extended periods of operation. Following this rule may reduce the risk of serious personal injury.
- 5. Protect your lungs. Wear a face or dust mask if the operation is dusty.** Following this rule may reduce the risk of serious personal injury.

- 6. Do not abuse charger cord.** Never carry tool by charger cord. Never yank cord to disconnect it from receptacle. Keep charger cord away from heat, oil and sharp edges, and moving parts.
- 7. Do not attempt to alter the tool.** Your WORKPRO cordless electric stapler has a tested cycling time. It is designed to perform adequately at this rate. Any unauthorized alteration and/or use could result in a hazardous condition causing possible serious personal injury. Unauthorized parts and/or tool modification automatically voids warranty.
- 8. Use proper charging device.** While charging, the tool should always be supplied via a residual current device with a rated residual current of 20 mA or less.

3. LAYOUT AND ITEMS SUPPLIED

3.1 Layout (Fig. 1)

- 1.ON/OFF Switch
- 2.Charge port
- 3.Trigger
- 4.Battery status indicator
- 5.Air vents
- 6.Contact safety
- 7.Staple exit
- 8.Quick release magazine
- 9.Charger

3.2 Items supplied

CARTON CONTENTS

- Cordless Electric Stapler
- Charger
- Original safety and operating instructions

1. Carefully check to see that all of the above items are supplied.
2. Inspect the product carefully to make sure no breakage or damage occurred during shipping. If you find damaged or missing parts, please contact us at the first time.

NOTE: Do not discard the shipping carton and packaging material until you are ready to use your new cordless electric stapler. The packaging is made of recyclable materials. Properly dispose of these materials in accordance with local regulations.

IMPORTANT! The equipment and packaging material are not toys. Do not let children play with plastic bags, foils or small parts. These items can be swallowed and pose a suffocation risk!

4. TECHNICAL DATA

Power supply: 3,6 V DC
Battery capacity:2,0 Ah
Battery type: Lithium-ion
Weight:1.1 kg
Charger for the product
Battery charge voltage: 5 V DC
Battery charge current:1 A
Charging unit
supply voltage..... 100-240V~ 50/60 Hz
Charging time:2 hours

STAPLE LENGTH GUIDELINES	
1/4" 6mm	Can be used on window screens & shades, light draperies, shelf papers, closet lining, etc.
5/16" 8mm	Can be used on light upholstery and other relatively thin materials.
3/8" 10mm	Can be used on insulation, weather stripping, wire mesh, carpet pads, canvas and other materials of moderate strength where material thickness is up to about 3/16" maximum.
1/2" 12mm 9/16" 14mm	Can be used where thickness of material being stapled is substantial, for example, foam insulation board or heavy folded draperies (about 1/4" (6.3mm) to (9.5mm) thick). (For cable 6mm max wire dia 50 V max voltage)

STAPLER: APPLICATIONS	
Low Voltage Cabling (for cables less than 6mm Dia and 50V Max) <ul style="list-style-type: none"> • Holiday Light • Antenna wiring • Telephone Wiring • Alarm system wire • Cable TV • Audio System 	
CANVAS/SCREEN APPLICATIONS	
<ul style="list-style-type: none"> • Upholstering • Decor • Wire 	<ul style="list-style-type: none"> • Stretching Canvas-Art • Mesh/Screening • Framing • Framing Fabric • Needlepoint

BRAD AND PIN LENGTH GUIDELINES	
LEG LENGTH	RECOMMENDED USES
5/8" (15mm)	Picture framing, small molding

5. OPERATION

⚠ WARNING: Make sure you have read all safety instructions. This tool comes completely assembled. There is no assembly required. **Make sure tool is powered off before any of operations.**

5.1 Operation

1. **Make sure tool is powered off.**
2. The staple gun has a bottom load staple magazine. Turn tool upside down and squeeze pusher assembly (Fig 2).
3. Pull pusher assembly out until it stops to reveal the staple magazine (Fig 3).
4. Place stick of staples in bottom channel so legs are pointing up (Fig 4).
For narrow flat crown, cable, brads and pin, place only on left side. Push slide closed, making sure that latch engages.
5. For brads, Be sure nail heads are pointing down. For pin, be sure the flat end are pointing down, and the sharp tip are pointing up. Push slide closed, making sure that latch engages. (Fig 5).

STAPLES: Place staples into magazine with the points facing up and out of the tool (Fig 6). Never attempt to completely remove pusher assembly as this may damage the tool and void the warranty.

Close pusher assembly until it snaps into place. On very hard surfaces, firing recoil may interfere with nail/staple penetration. Enhance driving power by firmly placing one hand on top of cap. (Fig 7).

5.2 Firing your tool

1. To fire your tool, **make sure tool is powered on.** place down on your workpiece depressing the contact safety on the front of the tool. Once the contact safety is depressed, push the trigger to fire your staple. You must pick up the front of the tool and reactivate the contact safety for each shot. The tool will operate in low temperatures down to 32°F (0°C) and in higher temperatures up to 104°F (40°C).

5.3 How to determine proper staple leg size

In choosing the proper staple leg length for a job, there are two basic things to consider:

1. Thickness of material to be stapled.
2. Hardness of the wood. As a general rule, in hardwood, approximately 3/16" to 1/4" penetration into the wood is sufficient...and for softwood, up to approximately 3/8" should be sufficient. The staple should be flush with the underlying surface, as shown in (Fig 8b). However, if the staple used is not flush with the underlying surface, as shown in (Fig 8a)– this means that too long a leg length has been used. In that case, we recommend the next shorter leg length for desired results.

6. ABOUT YOUR BATTERY AND CHARGING THE TOOL

NOTE Make sure your battery is fully charged. The tool comes equipped with charger and built-in battery so there is no need to ever remove or replace the battery. The 3.6V Lithium-ion battery is equipped to provide up to **1100** shots on a single charge.

6.1 CHARGING PROCEDURE:

1. Plug the charger into the back of the tool (Fig 9).
2. Plug the charger into the wall outlet.
3. Charging may take up to 2 hours.

6.2 IMPORTANT CHARGING NOTES:

1. Only use the provided charger
2. Charge Indicator Light Status
 - a) While the charger is unplugged:
 - Green** = good charge
 - Red flash** = low battery
 - Green flash** = good battery, tool in power saving mode.
 - Red & Green alternately flash** = Some errors have happened during you firing the tool, need to check the staples and restart the tool to continue to operate.
 - b) While the charger is plugged in:
 - Red flash** = charging
 - Green** = full charged
 - Yellow flash** = The tool battery will not be charged, as battery temperature may be outside of operating range, cool down the battery temperature to between 40°F(0 °C) and 104°F(40 °C).
 - Tool will not fire staples while charger is plugged in. Disconnect the charger from the tool when charging is complete.**
3. Longest life and best performance can be obtained if the tool battery is charged when the air temperature is between 65°F and 75°F (18°-24°C). **DO NOT** charge the tool battery in an air temperature below +40°F(0 °C), or above +104°F(40 °C). This will prevent serious damage to the battery.
4. It is recommended to wait 15 minutes after charging before using the tool to avoid the possibility of the tool overheating and damaging the battery.
5. If the battery does not charge properly:
 - a) Check current at receptacle by plugging in a lamp or other appliance.
 - b) Check to see if receptacle is connected to a light switch which turns power off when you turn out the lights.
 - c) When charging the tool, move to a location where the surrounding air temperature is approximately 65°F - 75°F (18°C - 24°C).
 - d) If charging problems persist, connect our online service.
6. The power tool should be recharged when it fails to produce sufficient power on jobs which were easily done previously. **DO NOT CONTINUE** to use the tool under these conditions in order to prevent damage to the battery. Follow the charging procedure. You may also charge a partially charged tool whenever you desire with no adverse effect on the battery or battery memory.

7. Under certain conditions, with the charger plugged into the power supply, the exposed charging contacts inside the charger can be shorted by foreign material. Foreign materials of a conductive nature such as, but not limited to, steel wool, aluminum foil, or any buildup of metallic particles should be kept away from charger cavities. Unplug charger before attempting to clean tool.

8. Do not freeze or immerse charger in water or any other liquid.

7. CLEANING AND MAINTENANCE

The tool is virtually maintenance free. Keep tool clean and free of dust. Wipe clean with a dry cloth; do not use harsh chemicals to clean.

There are no parts inside the equipment which require additional maintenance.

8. STORAGE

Store the equipment and accessories in a dark and dry place at above freezing temperature. The ideal storage temperature is between 41°F(5 °C) and 86°F(30 °C). Store the electric tool in its original packaging.

9. DISPOSAL AND RECYCLING

The equipment is supplied in packaging to prevent it from being damaged in transit. The raw materials in this packaging can be reused or recycled. The equipment and its accessories are made of various types of material, such as metal and plastic. Never place defective equipment in your household refuse. The equipment should be taken to a suitable collection center for proper disposal. If you do not know the whereabouts of such a collection point, you should ask in your local council offices.



This product has been marked with a symbol relating to removing electric and electronic waste. This means that this product shall not be discarded with household waste but that it shall be returned to a collection system. It will then be recycled or dismantled in order to reduce the impact on the environment. Electric and electronic equipment can be hazardous for the environment and for human health since they contain hazardous substances.

DISPOSAL OF AN EXHAUSTED BATTERY PACK



To preserve natural resources, please recycle or dispose of the battery pack properly. This battery pack contains Li-ion batteries. Consult your local waste authority for information regarding available recycling and/or disposal options. Discharge your battery pack by operating your tool, then remove the battery pack from the tool housing and cover the battery pack connections with heavy-duty adhesive tape to prevent short circuit and energy discharge. Do not attempt to open or remove any of the components.