

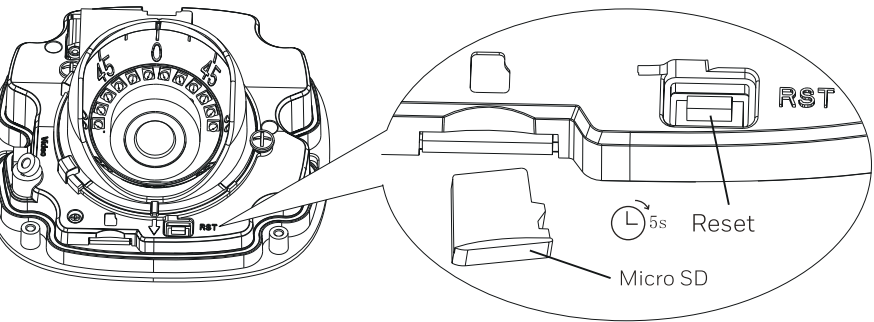

IR Fixed Micro Dome Camera HDMI  
HC35W25R3-H

Quick Installation Guide

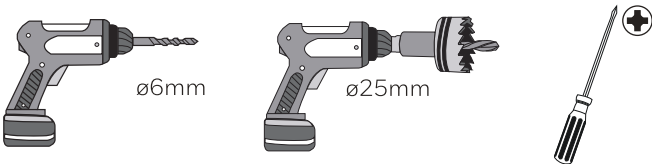
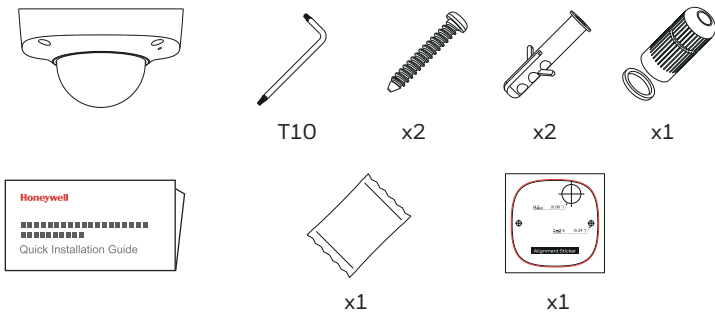

1

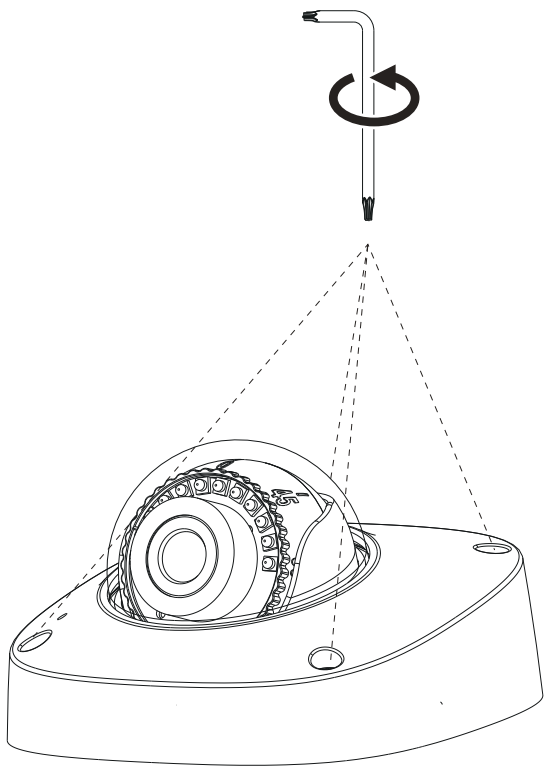

2

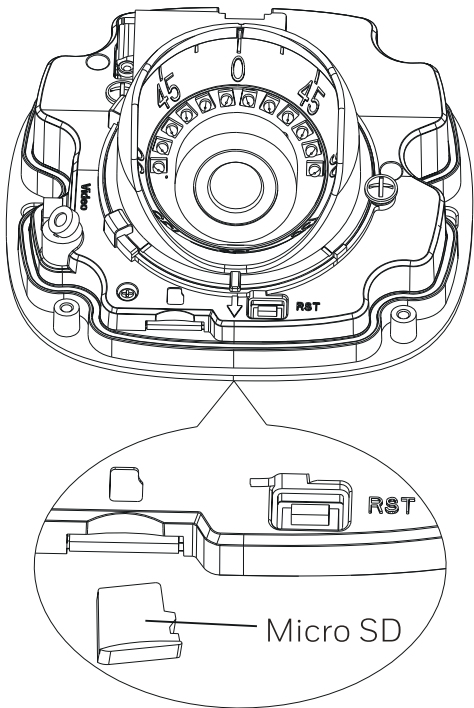

3

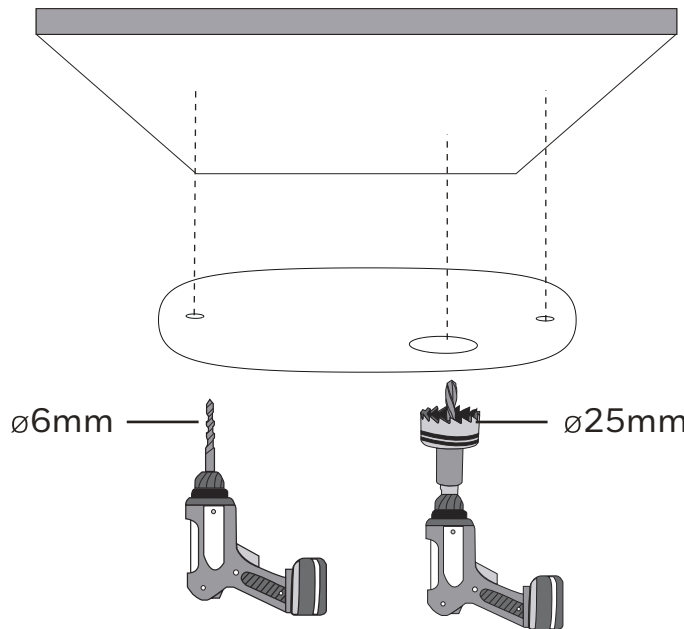

OR

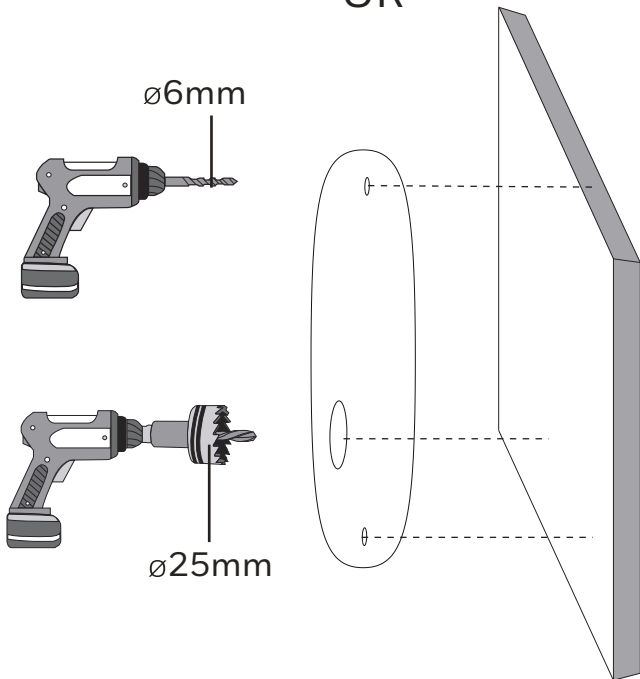

4

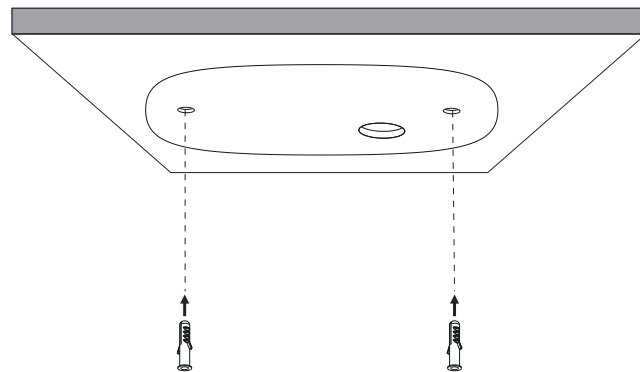

5

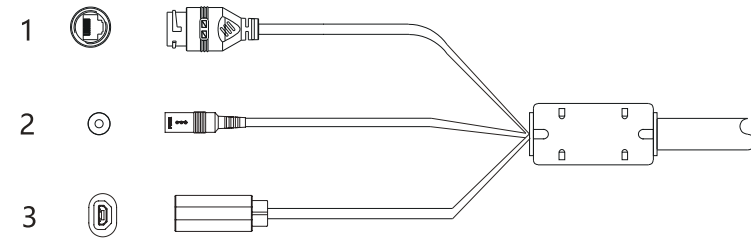
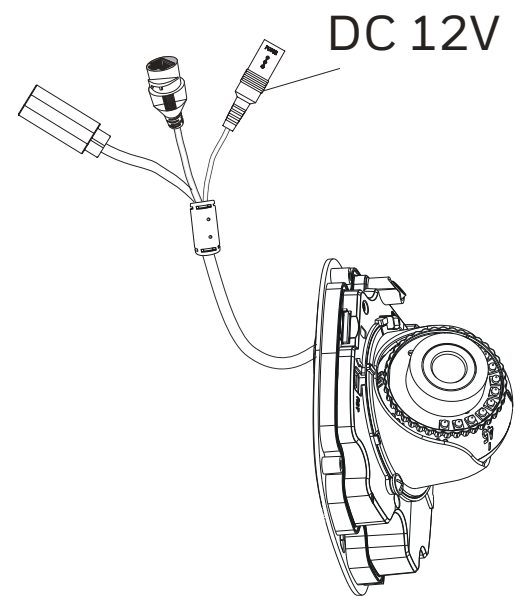
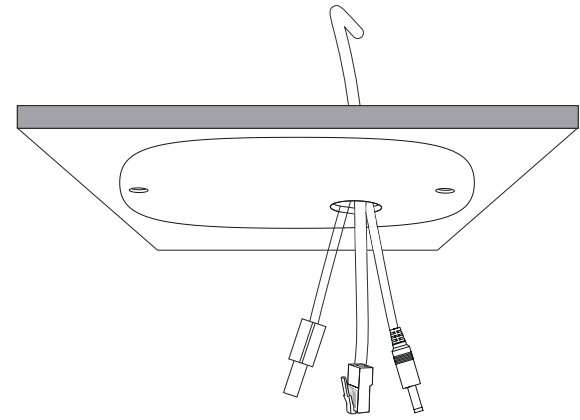

1	Network	RJ45
2	Power	DC12V
3	Micro HDMI Female	

6

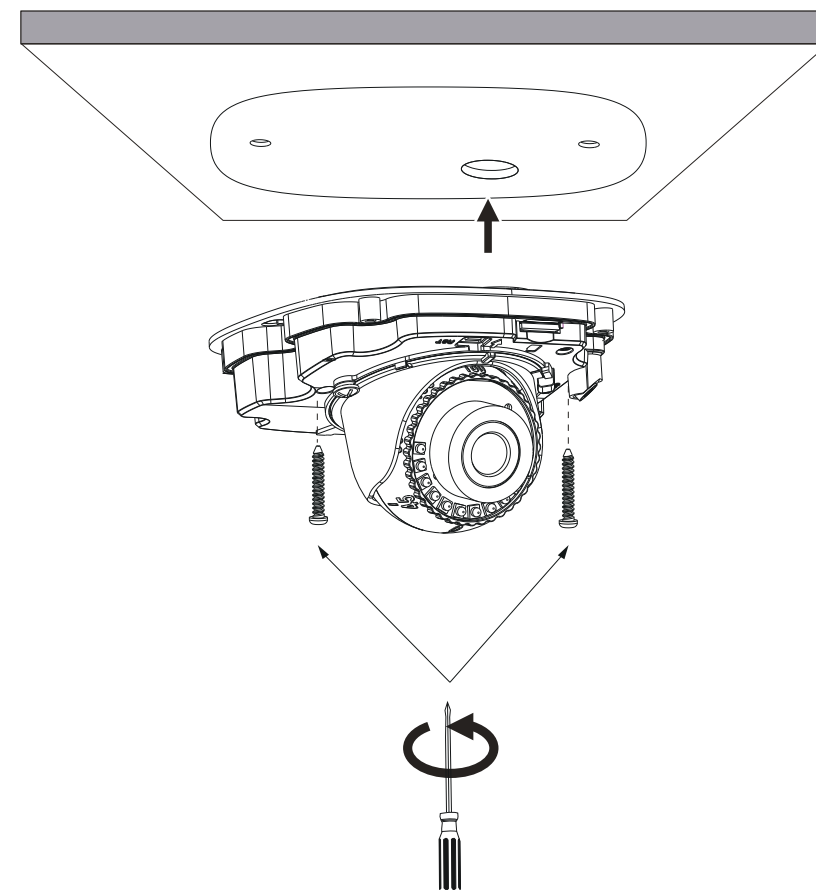

7

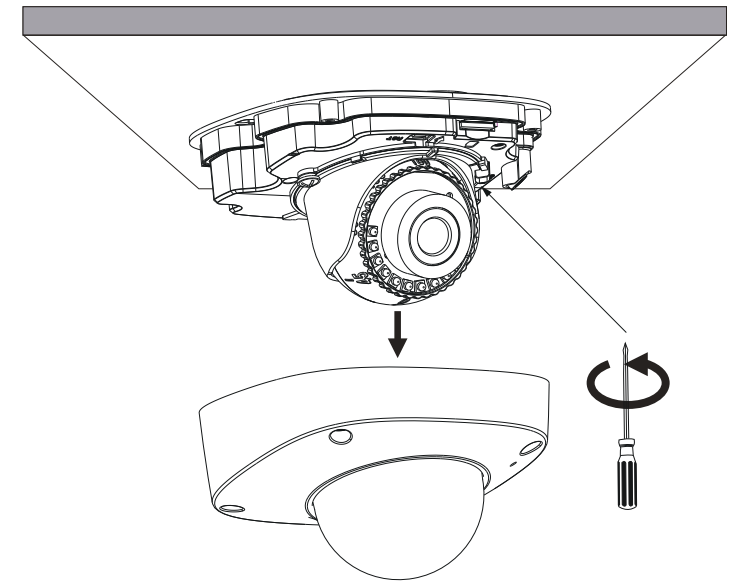

8

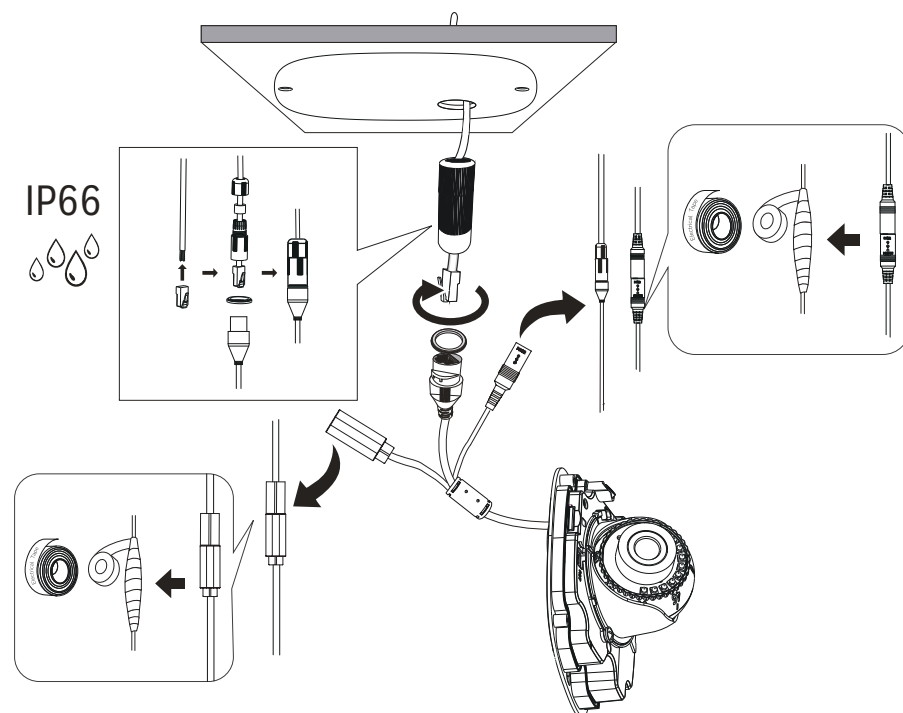
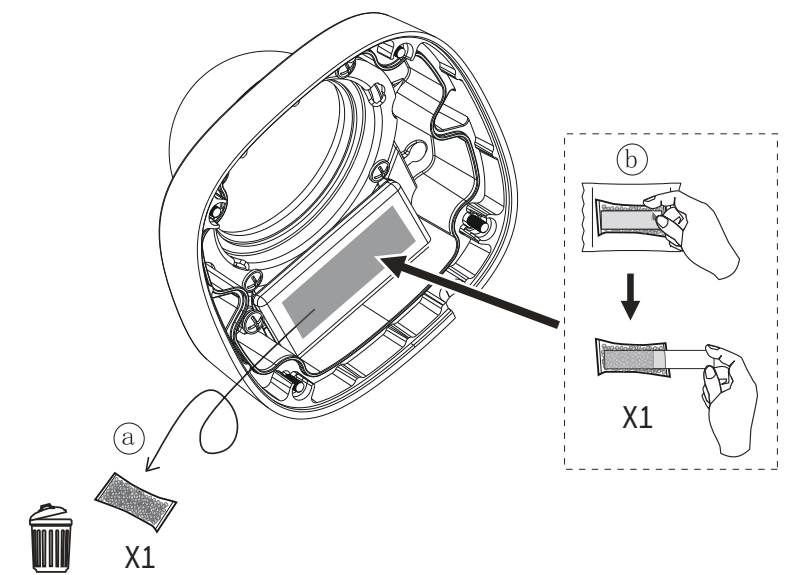

9



Compatible Accessories Installation:  
Please purchase accessories according to your needs,  
And please use the screws in the accessories box.

**HA35CLM01 + HA35CLM02+HA35PCM04B+Camera**

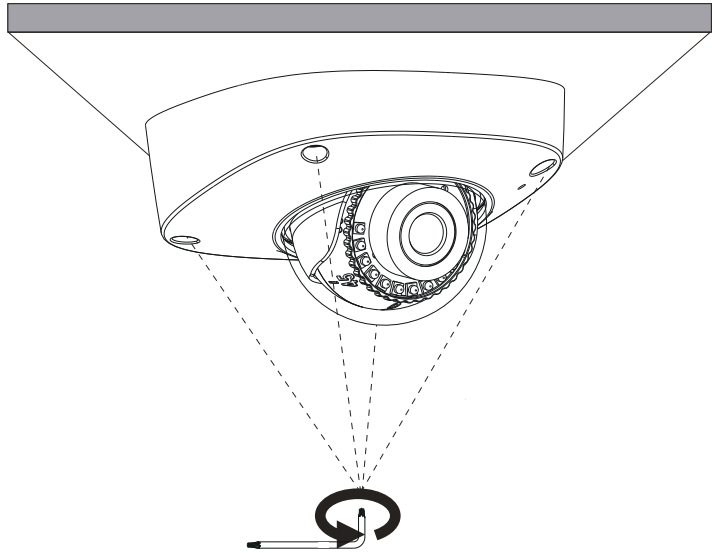

**HA35PLM01 or HA35CNM01+HA35JCBM01+Camera**

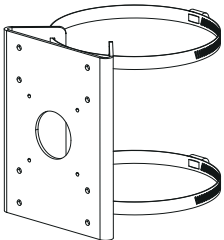

HA35PLM01

OR

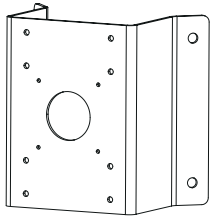

HA35CNM01

+

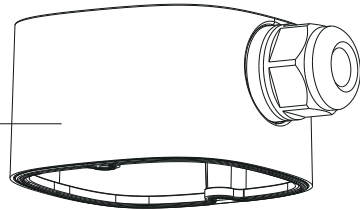

HA35JCBM01

+

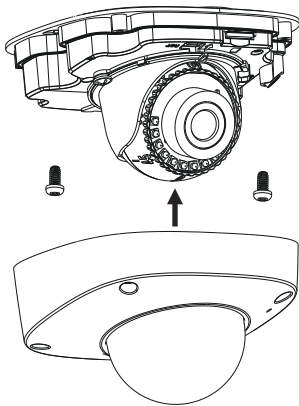

10

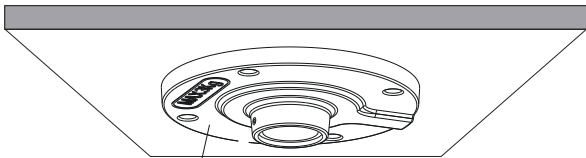
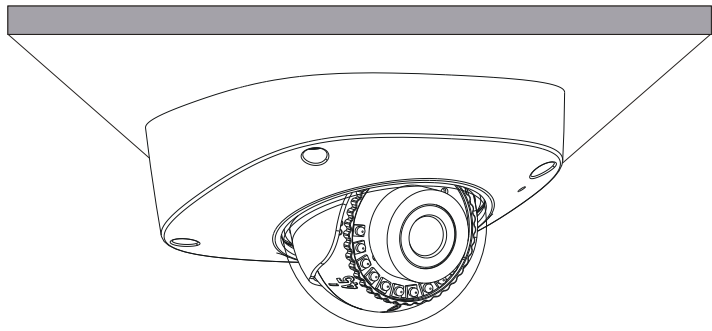

HA35CLM01



HA35CLM02

+

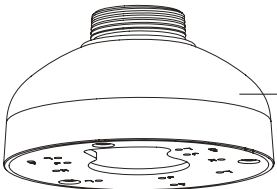

HA35PCM04B

+

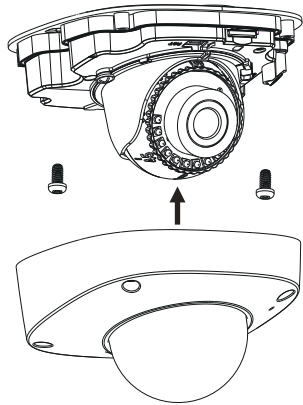

HA35PLM01 or HA35CNM01+HA60WLMB1+HA35PCMO4B  
+Camera

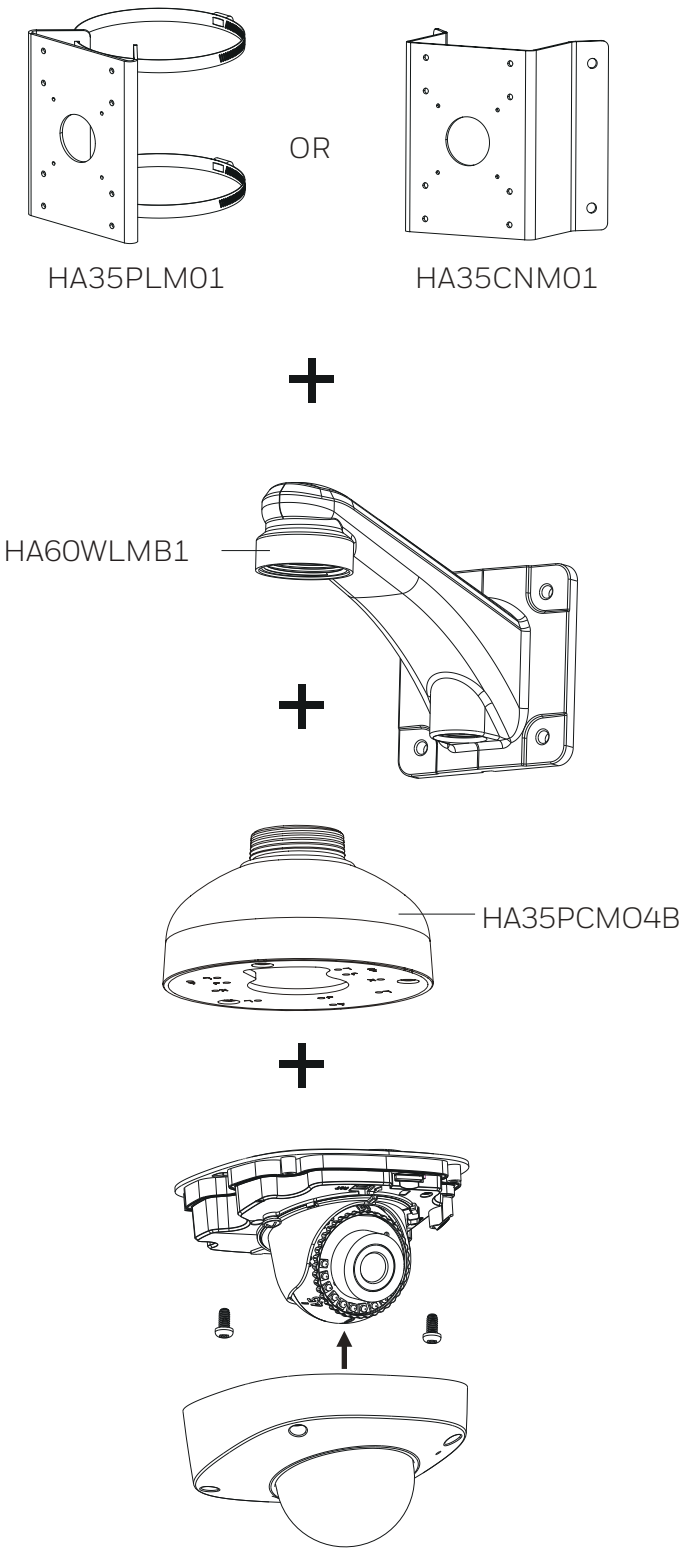

1

Web site: <https://myhoneywellbuildingsuniversity.com>  
Select: Download Center  
Download: Unified Tool

2



3

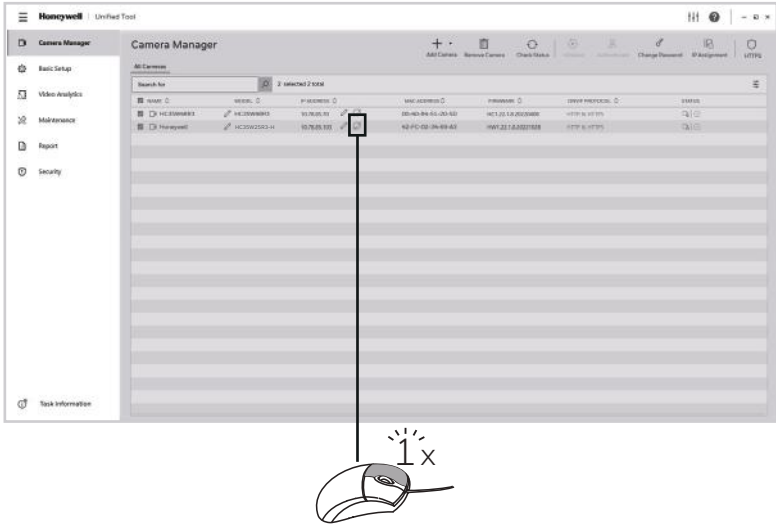

4

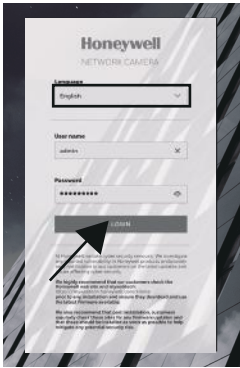

or



**Note** • Chrome 91 (or later) is supported.  
• The camera comes with the IP address set as DHCP/APIPA by default. It is not required to switch to a static IP address. Users may choose to keep the default DHCP/APIPA assigned IP address.

Connecting to Legacy NVR which doesn't Support HTTPS

Please change the camera to HTTP & HTTPS mode if you connect it to legacy NVR which doesn't support HTTPS mode.

**Scenario A** : Devices are in factory default mode. Please follow the 1a~5a steps below.

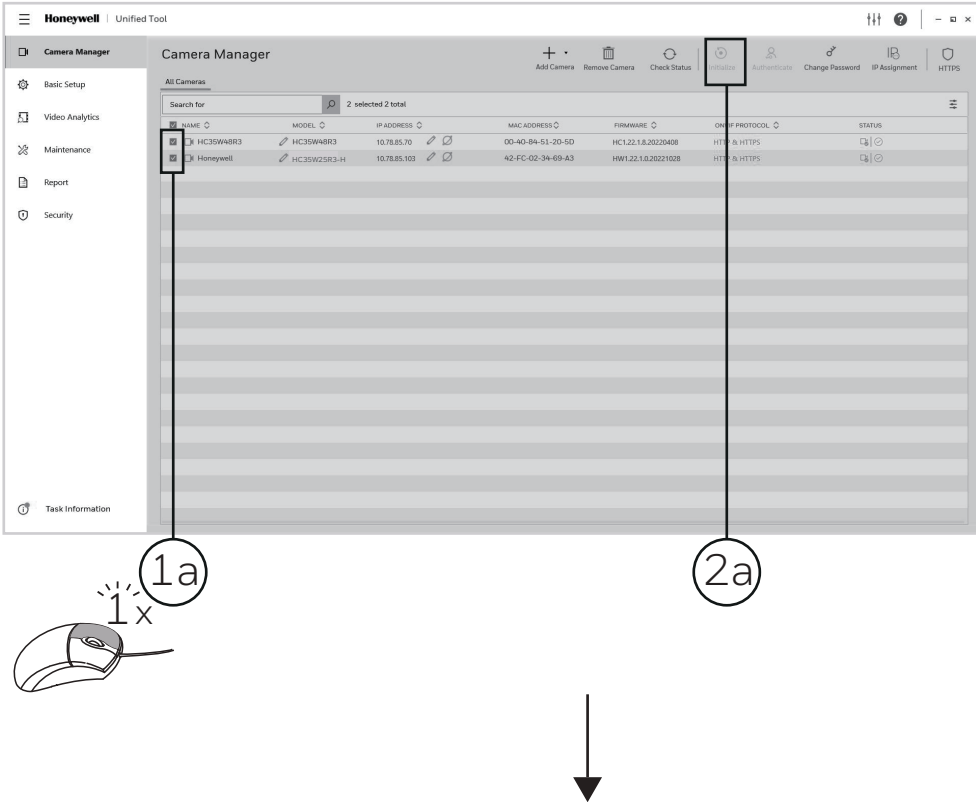



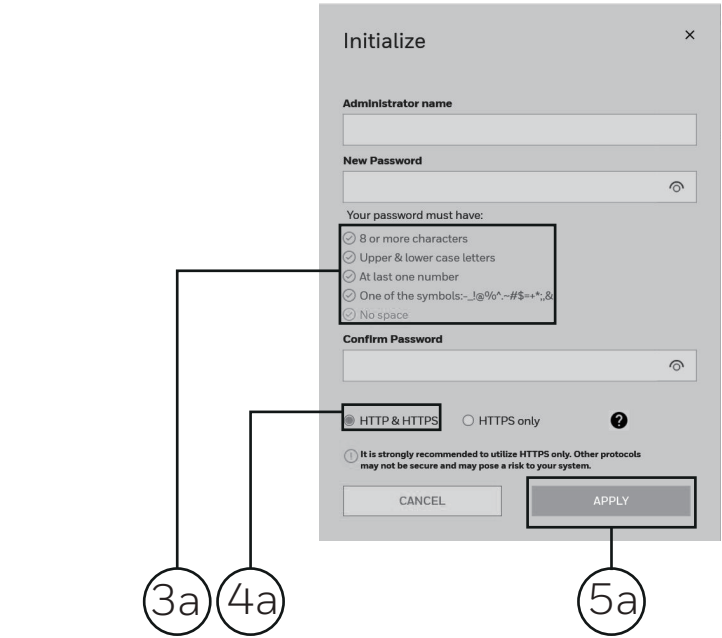

**Scenario B :** Devices are already been initialized. Please follow the 1b~5b steps below.

**Note :** Please make sure the selected devices are authenticated.

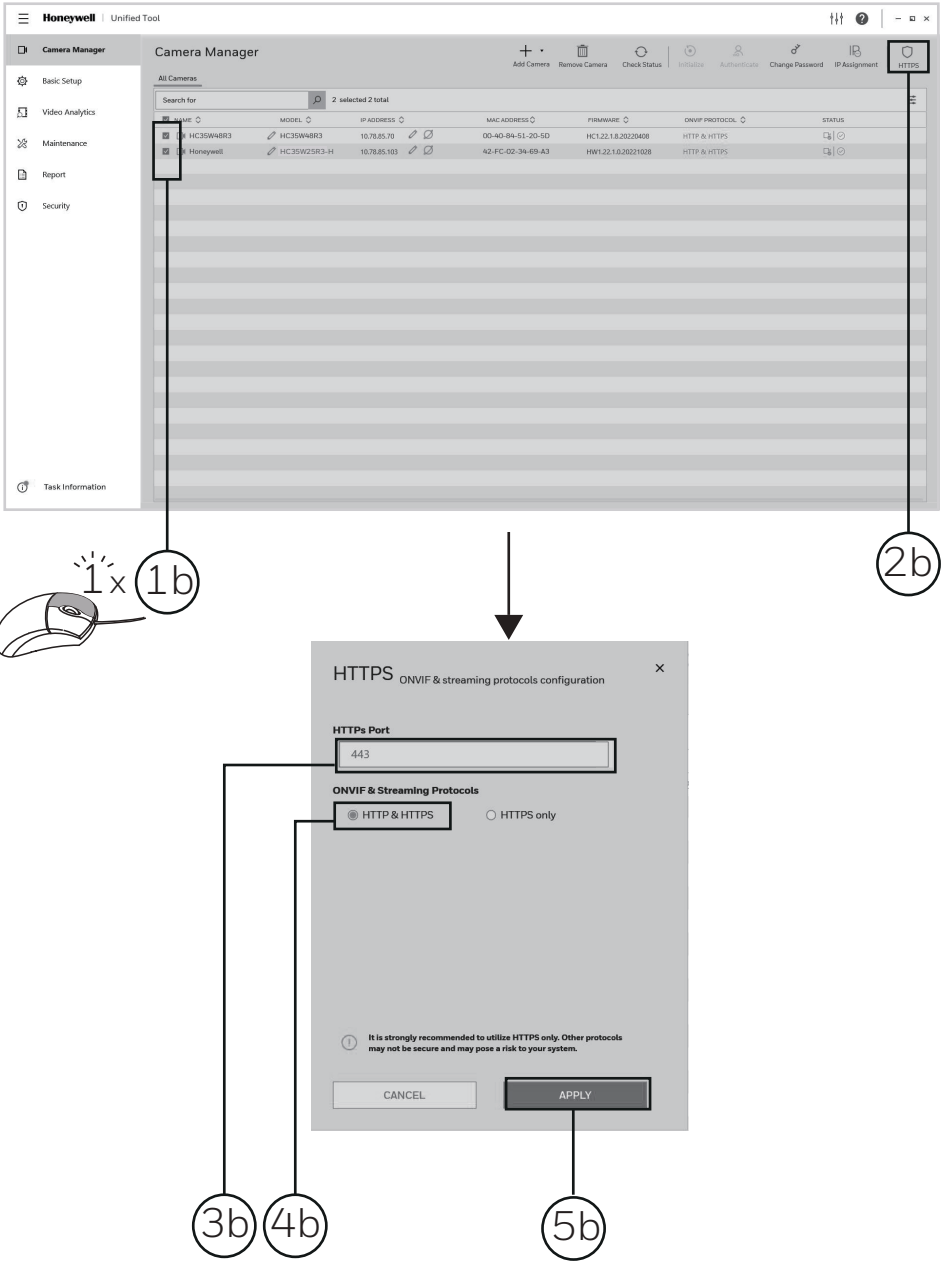

## Cautions and Warnings

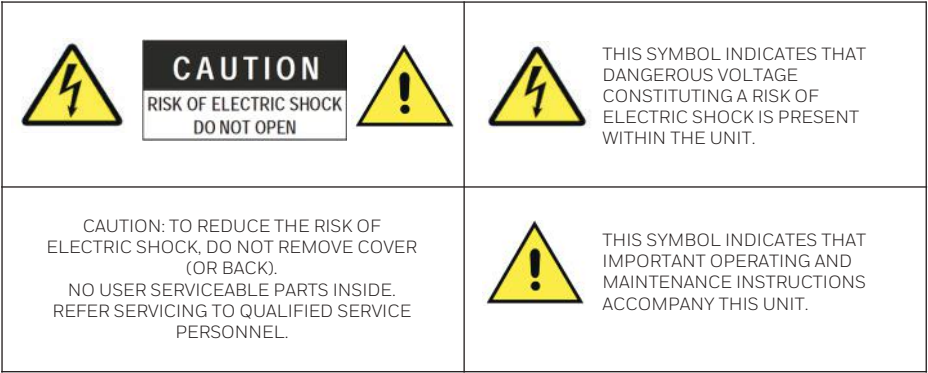

### WARNING

To ensure compliance with electrical safety standards, Local Certified / CSA Certified / UL Listed LPS or Class 2 power adapters are required. Power over Ethernet (PoE) shall be provided by listed Information Technology Equipment meeting the IEEE 802.3af PoE standard. The PoE is not intended to be connected to exposed (outside plant) networks. Consult Honeywell for the recommended adapter.

### CAUTION

Invisible LED radiation (850 nm). Avoid exposure to beam.

## Important Safeguards

- Read and keep these instructions.
- Please ensure that your installation area can safely support the weight of the camera.
- Do not aim the camera toward a bright light source for extended periods to prevent damage to the imager. Avoid operating the unit under or close to unstable light sources (may cause flickering), or close to fluorescent lamps or objects reflecting light.
- Do not touch the camera lens.
- Do not drop the camera or subject it to physical shock.
- Do not use a strong or abrasive detergent when cleaning the camera.
- Avoid operating or storing the unit in extremely humid, dusty, hot/cold environments, where the operating temperature is outside the recommended range of -40°F to 140°F (-40°C to 60°C).
- Avoid operating the unit close to sources of powerful electromagnetic radiation, such as radio or TV transmitters.
- The product is only to be connected to PoE network without routing to outside plant.
- If powered by a power adapter, the adapter should be properly grounded. (Consult Honeywell for the recommended adapter).
- Installation and dismantling should be performed only by qualified and experienced technicians.
- Make sure the power is cut off before the product is being repaired or installed.

- The product can be ceiling or wall mounted. When wall mounted, the Cable Gland will face down and make sure the height of the product is above 3 meters.
- Please contact the authorized distributor of Honeywell for related accessories (Cable Gland, Cable, etc.) for purchase and installation.
- The camera should be installed at least 10 centimeters away from the eave of a building.
- If a Class I adapter or switch is used to provided power, be sure that the power cord is firmly plugged into the socket and confirm the main earth connection.

## Manufacturer's Declaration of Conformance

### Europe

The manufacturer declares that the equipment supplied with this guide is compliant with the European Parliament and Council Directive on the Restrictions of the use of certain hazardous substances in electrical and electronic equipment (2011/65/EU) as Amended by RoHS 3 (2015/863), and the essential requirements of the EMC Directive (2014/30/EU), conforming to the requirements of standards EN 55032 for emissions, EN 50130-4 for immunity, and EN 62368-1 for electrical equipment safety.

## Waste Electrical and Electronic Equipment (WEEE)

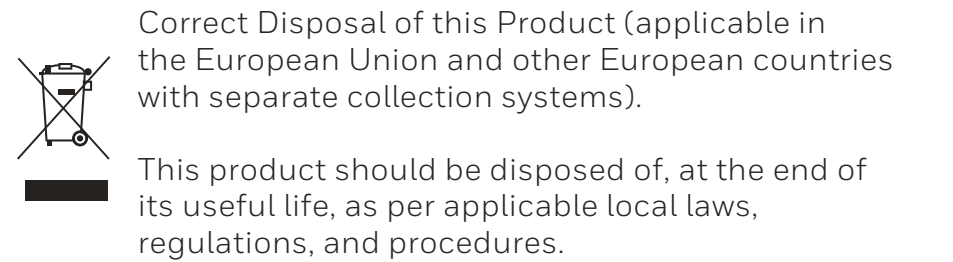

## Check Local Waste Guidelines

Components of this product require separate waste collection. Check local waste guidelines for sorting rules.



Covered by one or more claims of the patents listed at patentlist.  
hevcadvance.com  
Please be aware that this product can store personal data.  
Personal data is protected by the General Data Protection  
Regulation (2016/679) in Europe and therefore the owners  
of personal data have obtained certain rights thanks  
to this regulation.  
We strongly advise you to be fully aware of these owner  
("data subjects") rights as well as which limitations you have  
to obey regarding the use and distribution of this data.  
Further details can be found on the GDPR website of the EU

**Honeywell**

buildings.honeywell.com/security  
+1 800 323 4576 (North America only)