

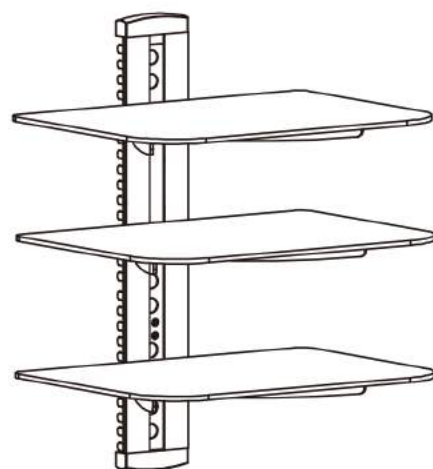

INSTALLATION MANUAL

support@walielectric.com

CS303



DVD WALL MOUNT
17.6 lbs.(8 kg) including

What is your wall made of?

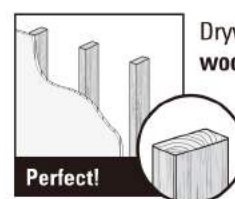

Drywall with
wood studs?

- Do not begin the installation of the product before you have read and understood the instructions and warnings contained in this installation sheet. If you have any question regarding any of the instruction or warning, please contact your local distributor
- Please refer to installation guide recommendation for required distance from wall to avoid risk of property damage.
- This product should only be installed by someone of good mechanical aptitude, with experience and basic building, and fully understands.
- Make sure that the supporting surface will safely support the combined load of the equipment and all attached hardware and components.
- If mounting to wood wall studs, make sure that mounting screws are anchored into the center of the studs. Use of an "edge to edge" stud finder is highly recommended.
- Never exceed the maximum load capacity.
- Always use an assistant or mechanical lifting equipment to safely lift and position equipment.
- Tighten screws firmly, but do not over tighten. Over tightening can damage the items, greatly reducing their holding power.
- This product intended for indoor use only. Using this product outdoors could lead to product failure and personal injury.

IMPORTANT:

Ensure you have received all parts against the component checklist prior to installing. If any parts are missing or faulty, call the franchiser for a replacement.

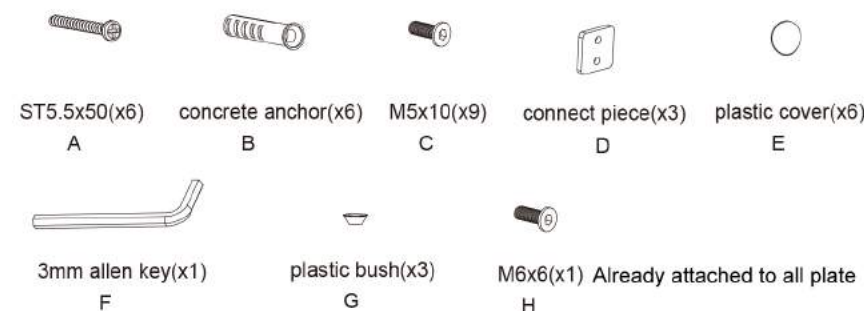
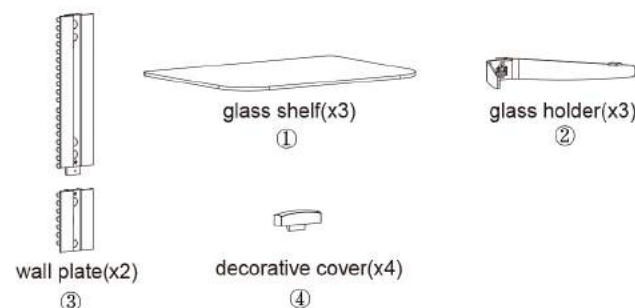

Tools required

- Phillips Head Screw driver (200mm length exclude the handle)
- Electric drill and 8mm masonry bit for concrete wall installation
- Marking Pen
- Hammer

STEP 1A WOOD STUD WALL MOUNTING:

- Use a stud finder to locate the edges of the studs. Use of an edge-to-edge stud finder is highly recommended. Based on their edges, draw a vertical line down each stud's center.



- Place wall plate on wall as a template. And mark the center of the four mounting holes. Make sure that the mounting holes are on the centerline of stud.

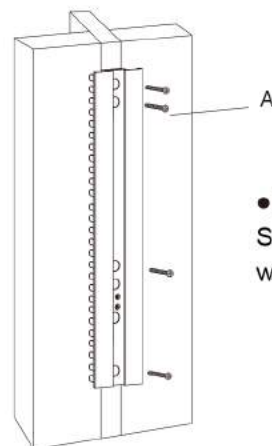
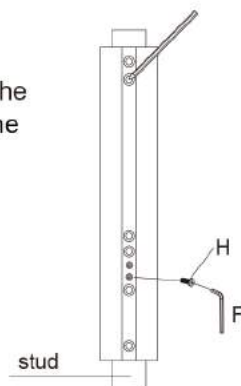

- Drill four 1/8"(3mm) dia. Holes 1.2"(30mm) deep. Secure it using four screws(A), make sure that the wall plate is level as shown in fig.1.1.

Fig.1.1

STEP 1B SOLID BRICK AND CONCRETE BLOCK MOUNTING:

- Use the wall plate as a template to mark four holes locations on the wall.

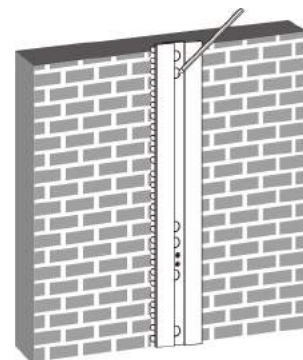

- Pre-drill these holes with a 8mm masonry bit and depth is at least 50mm. Insert a Concrete Anchor(B) into each of these holes. Attach the wall plate to the wall using four screws(A), make sure that the wall plate is level as shown in fig.1.2.

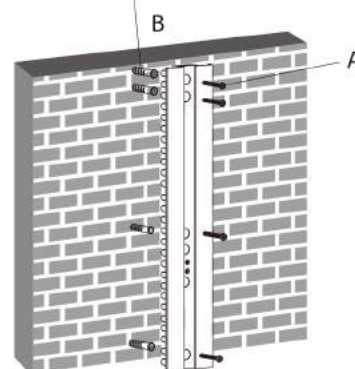

Fig.1.2

STEP 2 ASSEMBLING THE GLASS HOLDER

- Attach the connect piece to the glass holder using two screws and space reserved 3mm as shown in fig.2.1.

- Use the same method to assemble the other glass holder.

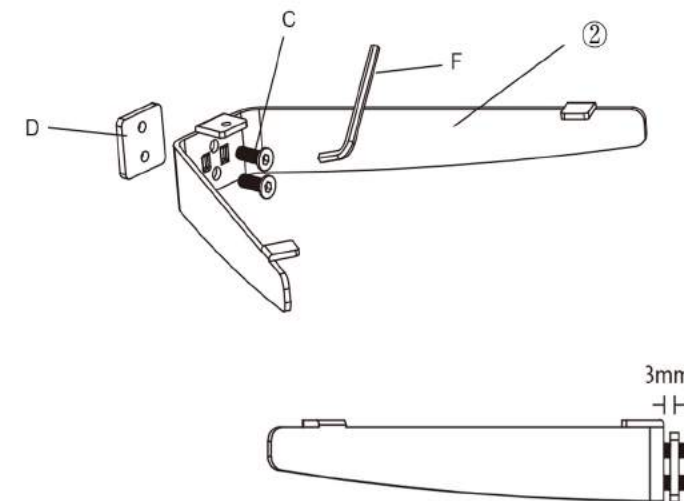
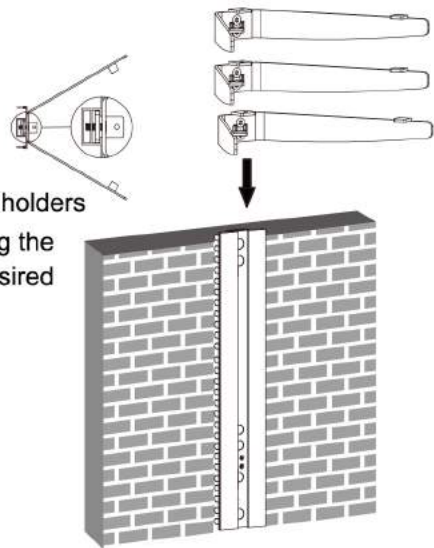

Fig.1.3

STEP 3 INSTALLING THE GLASS HOLDER

- Insert the three glass holders into the wall plate along the wall plate rail at the desired height respectively.



- Then tighten screws with a 3mm Allen key as shown in fig.3.1 to avoid wobbly situation.

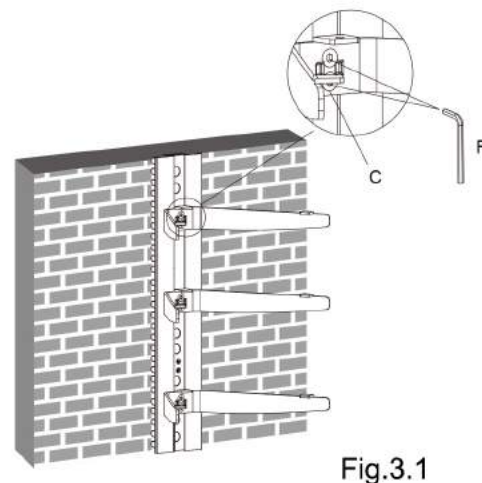
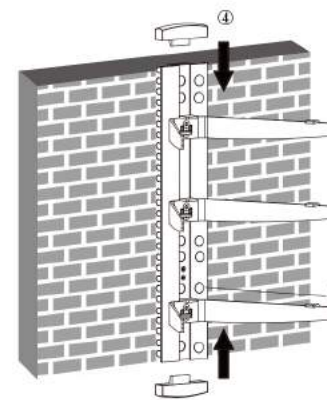

Fig.3.1

- Insert decorative covers to the top and bottom of wall plate respectively and install plastic covers.



- You can adjust the height of the glass holders as needed. Loosen the screws with 3mm Allen key (but not remove), to adjust the glass holders at the desired height and then tighten screws with a 3mm Allen key as shown in fig.3.2.

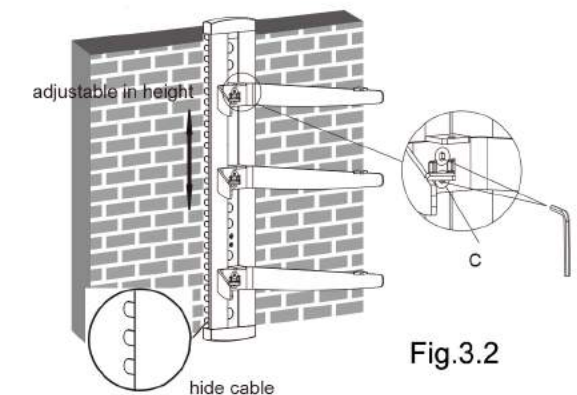

Fig.3.2

STEP 4 INSTALLING THE GLASS SHELF

- Place the three glass shelf gently on the three glass holders respectively. Attach the glass shelves to the glass holders using screws and plastic bushes, tighten screws with a 3mm Allen key but not tighten completely at this time. Center the glass shelves over holes, securely tighten screws with a 3mm Allen key as shown in fig.4.1.

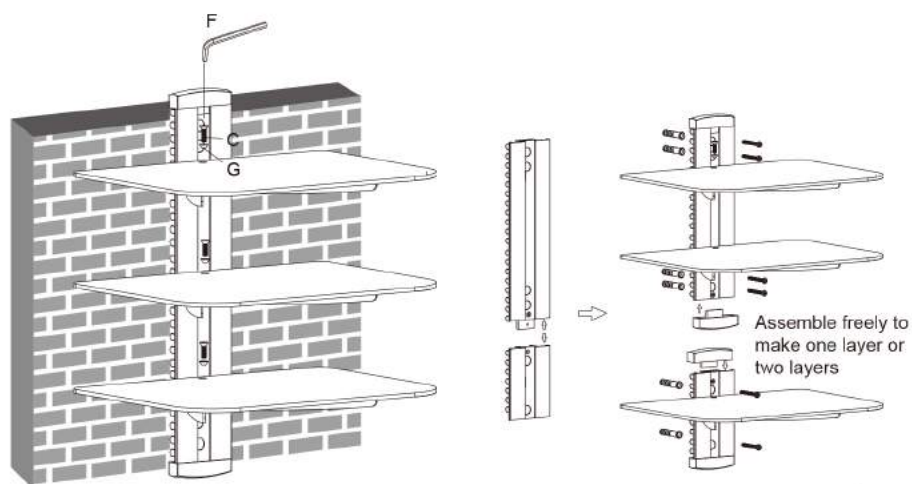

Fig.4.1

STEP 5 CABLE MANAGEMENT

- After installing the DVD wall mount, place DVD gently on the mounted glass shelves. Pull out the cable clip, insert the cable into any of the opening of the clip, with one head of the cable inserted in the clip, insert the clip into the main pole, take out the other head of the cable from another opening of the clip, then push the clip until the end of the main pole.

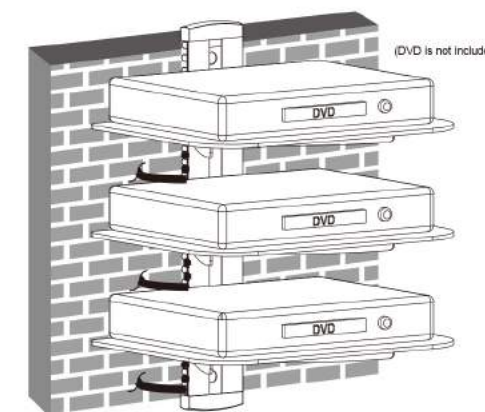

Fig.5.1

Maintenance

- Once you have mounted the DVD bracket, Check that they are sufficiently secured and safety to use. You should check whether screws are fixed well every two months.
- If you have any doubts regarding the installation, please contact us at suport@walielectric.com for details.