

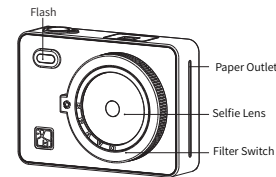

Z5S

Product Introduction

Front View:



Top View:

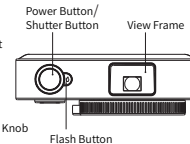

Rear View:

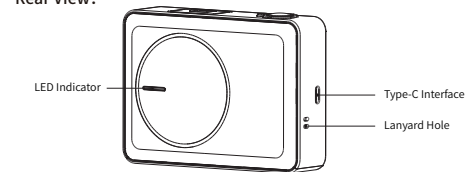

Accessories



* Note: The items in the package are actually based on the order .

Product Introduction

Bottom View:

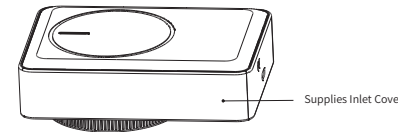

Inner:

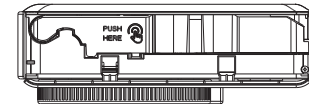

Product Parameters

Product Name	Portable Photo Printer
Printer Model	HCP-2TS25F
Dimensions	120*88*40mm
Weight	Bare Printer 280g
Print Method	Thermal Dye Sublimation
Print Size	54*72mm
Print Resolution	300dpi
Battery Capacity	800mA
Charging Interface	5V / 2A, Type-C Interface
Operating Temperature	5°C~35°C

Consumable Installation Instructions

01

Open the supplies inlet cover.
As shown, open the cover.

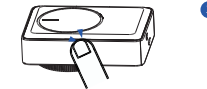

02

Take out a consumable, put it into the compartment according to the direction shown below, place your finger in the "PUSH HERE" position and press it into place until it makes a "click" sound.

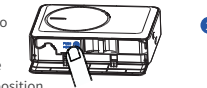

03

Close the supplies inlet cover.

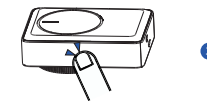

- 1. The photo paper is susceptible to moisture, please use it as soon as possible after opening.
- 2. This device only supports official photo paper that comes with the ribbon, please do not replace it by yourself.
- 3. Avoid excessive direct sunlight and low temperature.
- 4. If the ink cassette is damaged or deformed by external force, please do not insert it into the device by force.

Printing Instructions

1 Power-on

Long press the power button until the LED indicator is lit and when it is released, the device is turned on.

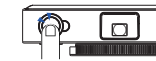

2 Adjust filter

Rotate the filter switch knob to change the current gear and select different filter effects.

3 Turn on the flash

- Short press the flash button to turn on/off the flash.
- When the flash is turned off, the normal usage state of the device is blue light.
- After the flash is turned on, the normal usage status of the device is green light.

4 Take pictures and print

Short press the power/shutter button to activate the shutter function, After short pressing the view frame button, the printer immediately prints the current shooting content.

APP Print

- Scan the QR code to download the "HeyPhoto" APP
1. Open the APP and click "Add device";
 2. Search "Z5S-XXXX" and click to connect.



1

In the app, select the photos you want to print.
You can also edit the photos as needed before printing.



2

- 1. After the first connection, you just need to click the print icon for subsequent use, the printer will be automatically connected and print.
- 2. Do not exit the APP during the printing process, this may cause printing failure.
- 3. APP page may change with the version, please refer to the actual interface.

Manufacturer: Xiamen Hanin Co.,Ltd.
Factory Address: No.96, RongYuan Road,
Tong'an District, Xiamen City, Fujian Province, P.R. China
E-mail: support@hpert.com
Web: www.hpert.com

Function Button Operation Instructions

Icon	Function Button	State
	Power Button/ Shutter Button	• Long press to turn on the printer • Short press to take a photo
	Flash Button	Short press to turn on/off flash
	Filter Switch knob	Rotate to switch filter effects
	Power-off Button	After closing the viewfinder for one second, the indicator light will be off.
	Force Power-off	Press and hold the flash button first, then press the power button, after the indicator light goes out the printer will be forced to shut down.

1 Error Status

Status	LED Indicator
Out-of-paper/lack of ink/ lack of ink cassette	Orange LED indicator is lighting
Abnormal ink cassette/ ink cassette not recognized	Orange LED indicator flashes slowly
Paper jam/ink cassette jam	Red LED indicator is lighting
Low power	Red LED indicator flashes slowly
Device is over temperature/ device abnormality	Red LED indicator flashes quickly

2 Printer Status

Status	LED Indicator
Ready to use normally	Blue LED indicator is lighting (Green LED indicator remains on when flash is activated)
Printing/Bluetooth data distribution in progress	Blue LED indicator flashes slowly
Device startuiping	Blue LED indicator flashes quickly

3 Charging status

Status	LED Indicator
Battery Charging in Progress (Power On/Off)	Green LED indicator flashes slowly
Fully charged while powered on	Blue LED indicator is lighting (Green LED indicator remains on when flash is activated)
Fully charge in power-off state	Green light remains on the indicator turns off after unplugging the USB cable.

⚠ The red indicator light flashes slowly during charging, indicating that the in which the printer is located cannot meet normal charging requirements, suggested charging temperature 0°C~45°C.

Filter Operation Instructions

Rotate the knob to select the filter effect for photo printing.

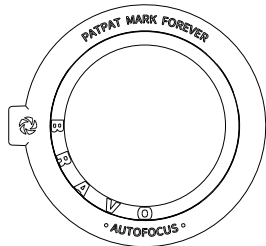

- B Blue
- R Red
- A Art
- V Vivid
- O Original

⚠ Note: Each filter is designed for specific scenarios; in certain situations, an incorrect filter choice may result in suboptimal shooting and printing outcomes.

Precautions

- The best working temperature of the printer is 5°C~35°C.
If the ambient temperature is too high, the printing quality may be affected;
- Please use official ribbon and photo paper to ensure print quality;
- Avoid disassembling the ribbon and photo paper by yourself.
If the glossy surface of the photo paper is contaminated, the print quality will be affected;
- Do not pull out the consumable forcibly during printing, this may damage the printer;
- When not in use for a long time, close the consumable compartment to keep things like dust out;
- After printing multiple photos in a row, the device may activate overtemperature protection, which is normal, and the current task will continue to be printed after cooling;
- Do not perform any operations while the device is turning on.

Operating Environment

- Place the printer on a desktop or other flat, stable surface;
- Please make sure that there is more than 10cm space in the paper outlet of the printer.

Battery Charging

- When the battery power is low, please charge it by the equipped USB cable in time. If you continue printing, it may power off automatically.
- Plug one end of the USB cable into the printer's port, and connect the other end to the power adapter. After connecting, the printer enters a charging state, at which point printing will interrupt the charging state.
- The charging time is approximately 90 to 120 minutes. You can check the charging status by lighting up the screen.

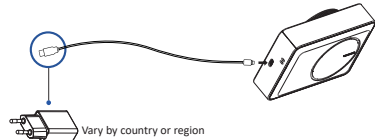

Charge via Adapter

- ⚠ 1. The printer can be charged via a computer or an adapter using a USB cable. Please note that the adapter is not equipped with the printer. Users who use power adapters for charging should purchase and use power adapters that are certified for safety and meet the requirements of the standard.

2. Users are prohibited from disassembling the machine themselves. Replacing the battery with the wrong model may result in an explosion. Please be sure to dispose of the used battery according to the instructions.

3. When the printer is low on power, charge it for a while before use to prevent printing interruptions.

WARNING: Operating this device may cause radio interference in a residential environment.

FCC WARNING

This equipment has been tested and found to comply with the limits for a Class B digital device, pursuant to part 15 of the FCC Rules. These limits are designed to provide reasonable protection against harmful interference in a residential installation. This equipment generates, uses and can radiate radio frequency energy and, if not installed and used in accordance with the instructions, may cause harmful interference to radio communications. However, there is no guarantee that interference will not occur in a particular installation. If this equipment does cause harmful interference to radio or television reception, which can be determined by turning the equipment off and on, the user is encouraged to try to correct the interference by one or more of the following measures:

- Reorient or relocate the receiving antenna.
- Increase the separation between the equipment and receiver.
- Connect the equipment into an outlet on a circuit different from that to which the receiver is connected.
- Consult the dealer or an experienced radio/TV technician for help.

This device complies with Part 15 of the FCC Rules. Operation is subject to the following two conditions:

- (1) this device may not cause harmful interference, and
- (2) this device must accept any interference received, including interference that may cause undesired operation.

This equipment complies with the FCC radiation exposure limits set forth for an uncontrolled environment. This transmitter must not be co-located or operating in conjunction with any other antenna or transmitter.

NOTE 2: Any changes or modifications to this unit not expressly approved by the party responsible for compliance could void the user's authority to operate the equipment.

FCC ID: 2AUTE-2TS25F



HANIN INSTANT CAMERA

iPhone 16 Pro Max, iPhone 16 Pro, iPhone 16 Plus, iPhone 16, iPhone 15 Pro Max, iPhone 15 Pro, iPhone 15 Plus, iPhone 15, iPhone 14 Pro Max, iPhone 14 Pro, iPhone 14 Plus, iPhone 14, iPhone SE (3rd generation), iPhone 13 Pro Max, iPhone 13 Pro, iPhone 13, iPhone 13 mini, iPhone 12 Pro Max, iPhone 12 Pro, iPhone 12, iPhone 12 mini, iPhone SE (2nd generation), iPhone 11 Pro Max, iPhone 11 Pro, iPhone 11, iPhone XS Max, iPhone XS, iPhone XR, iPhone X, iPhone 8 Plus, iPhone 8, iPhone 7 Plus, iPhone 7, iPhone SE, iPhone 6s Plus, iPhone 6s, iPhone 6 Plus, iPhone 6, iPhone 5s, iPad Pro 13-inch (M4), iPad Pro 11-inch (M4), iPad Air 13-inch (M2), iPad Air 11-inch (M2), iPad Pro 12.9-inch (6th generation), iPad Pro 11-inch (4th generation), iPad (10th generation), iPad Air (5th generation), iPad (9th generation), iPad mini (6th generation), iPad Pro 12.9-inch (5th generation), iPad Pro 11-inch (3rd generation), iPad (8th generation), iPad Air (4th generation), iPad Pro 11-inch (2nd generation), iPad Pro 12.9-inch (4th generation), iPad Pro 11-inch, iPad Pro 12.9-inch (3rd generation), iPad Pro 10.5-inch, iPad Pro 12.9-inch (2nd generation), iPad Pro 9.7-inch, iPad Pro 12.9-inch (1st generation), iPad Air (3rd generation), iPad Air 2, iPad Air, iPad mini (5th generation), iPad mini 4, iPad mini 3, iPad mini 2, iPad (7th generation), iPad (6th generation), iPad (5th generation), iPod touch (7th generation), iPod touch (6th generation)

Use of the Made for Apple badge means that an accessory has been designed to connect specifically to the Apple product(s) identified in the badge, and has been certified by the developer to meet Apple performance standards. Apple is not responsible for the operation of this device or its compliance with safety and regulatory standards.

Apple, iPad, iPad Air, iPad Pro and iPhone are trademarks of Apple Inc., registered in the U.S. and other countries and regions.

Apple, iPad, iPad Air, iPad Pro and iPhone are trademarks of Apple Inc., registered in the U.S. and other countries and regions. The trademark "iPhone" is used in Japan with a license from Aiphone K.K.

