



ORA4

kanto 

kanto

ORA4

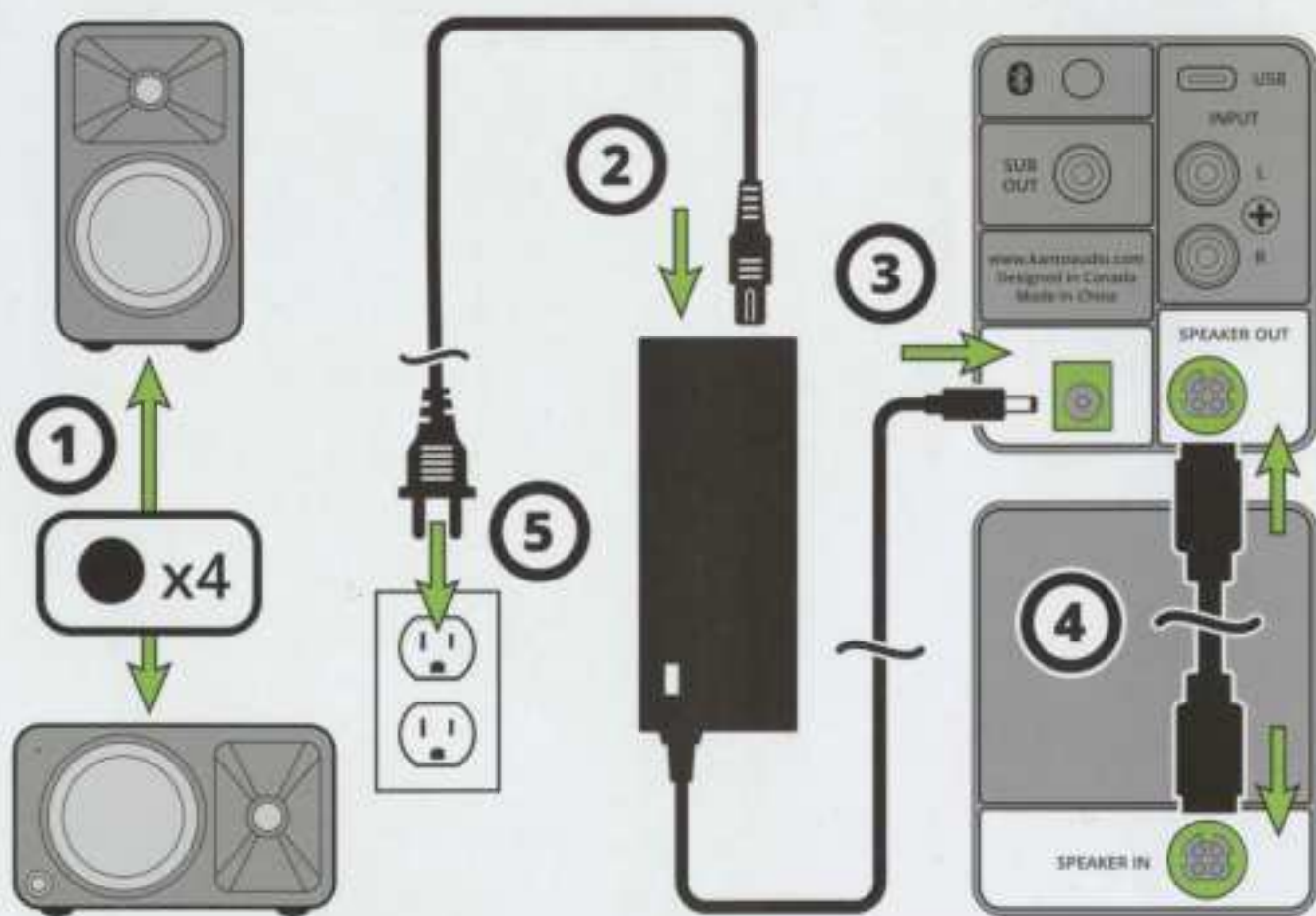

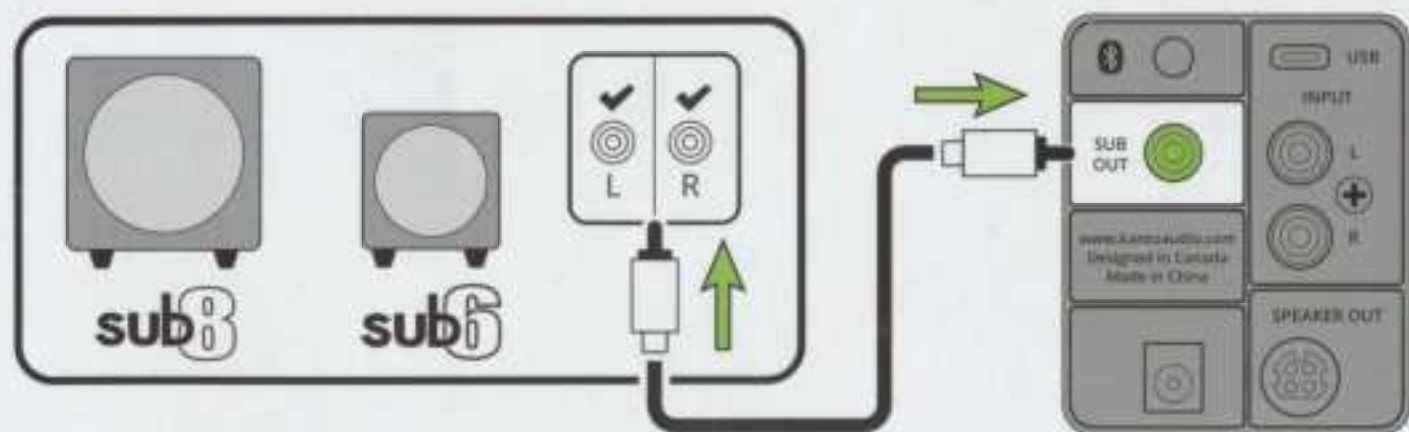
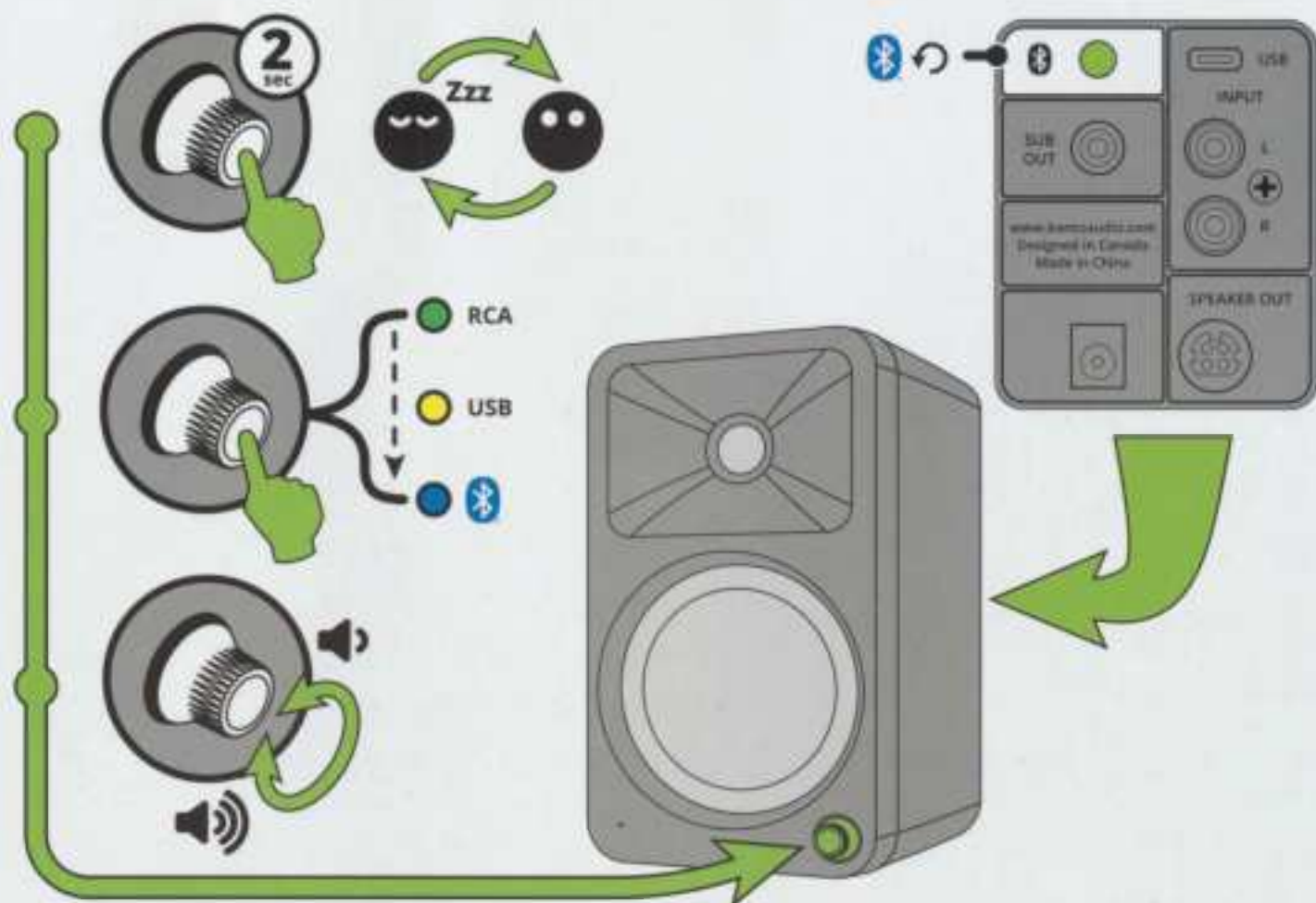

 www.kantoaudio.com

 1-888-848-2643

 support@kantoliving.com

kanto 



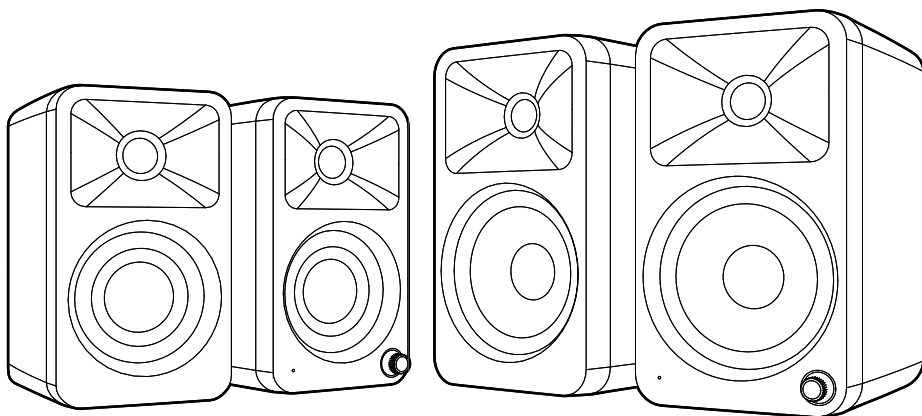

ORA

REFERENCE DESKTOP SPEAKERS

ORA4

POWERED REFERENCE SPEAKERS

Important Safety Precautions



ATTENTION

The exclamation point within an equilateral triangle is intended to alert the user of the presence of important operating and maintenance (servicing) instructions in the literature accompanying the apparatus.



CAUTION: TO REDUCE THE RISK OF ELECTRIC SHOCK, DO NOT REMOVE BACK PANEL. NO USER SERVICEABLE PARTS INSIDE. REFER SERVICING TO QUALIFIED SERVICE PERSONNEL.



DANGEROUS VOLTAGE

The lightning flash with arrowhead, within an equilateral triangle, is intended to alert the user of the presence of non-insulated "dangerous voltage" within the product's enclosure that may be of sufficient magnitude to constitute a risk of electric shock to persons.

- Read these instructions.
- Keep these instructions.
- Heed all warnings.
- Follow all instructions.
- Do not use this apparatus near water.
- Clean only with a dry cloth.
- Do not block any openings. Install in accordance with the manufacturer's instructions.
- Do not install near any heat sources such as radiators, heat registers, stoves, or other apparatus (including amplifiers) that produce heat.
- Protect the power-supply cord from being walked on or pinched, particularly at plugs, convenience receptacles and the point where they exit from the apparatus.
- When a stand is used, use caution when moving the stand/apparatus combination to avoid injury from tip-over.
- Unplug this apparatus during lightning storms or when unused for long periods of time.
- Refer all servicing to qualified service personnel. Servicing is required when the apparatus has been damaged in any way, such as power-supply cord or plug is damaged, liquid has been spilled or objects have fallen into the apparatus, the apparatus has been exposed to rain or moisture, the apparatus does not operate normally, or the apparatus has been dropped.
- Apparatus shall be connected to a MAINS socket outlet with a protective earthing connection.
- An appliance input coupler is used as the disconnect device - the disconnect device shall remain readily operable.

FCC Warnings

This device complies with part 15 of the FCC Rules. Operation is subject to the following two conditions: (1) This device may not cause harmful interference, and (2) this device must accept any interference received, including interference that may cause undesired operation.

Any Changes or modifications not expressly approved by the party responsible for compliance could void the user's authority to operate the equipment.

Note: This equipment has been tested and found to comply with the limits for a Class B digital device, pursuant to part 15 of the FCC Rules. These limits are designed to provide reasonable protection against harmful interference in a residential installation. This equipment generates uses and can radiate radio frequency energy and, if not installed and used in accordance with the instructions, may cause harmful interference to radio communications. However, there is no guarantee that interference will not occur in a particular installation. If this equipment does cause harmful interference to radio or television reception, which can be determined by turning the equipment off and on, the user is encouraged to try to correct the interference by one or more of the following measures:

- Reorient or relocate the receiving antenna.
- Increase the separation between the equipment and receiver.
- Connect the equipment into an outlet on a circuit different from that to which the receiver is connected.
- Consult the dealer or an experienced radio/TV technician for help. This equipment complies with FCC radiation exposure limits set forth for an uncontrolled environment. This equipment should be installed and operated with minimum distance 20cm between the radiator & your body.

IC WARNING

This radio transmitter has been approved by Industry Canada.

This Class B digital apparatus complies with Canadian standard ICES-003. This device complies with Industry Canada License exempt RSS standard(s). Operation is subject to the following two conditions.

(1) This device may not cause interference, and (2) this device must accept any interference, including interference that may cause undesired operation of the device.

This equipment complies with ISED radiation exposure limits set forth for an uncontrolled environment. This equipment should be installed and operated with minimum distance 20cm between the radiator & your body.

Introduction

Thank you for choosing ORA/ORA4, designed by Kanto in Canada. These powered speakers were carefully tested and inspected during production, and before packaging and shipping. After unpacking, please check for any damage. It is rare that a unit is damaged during shipping, but if this happens contact your retailer immediately.

You can also call Kanto directly at 1-888-848-2643 or email support@kantoliving.com.

What's In the Box?

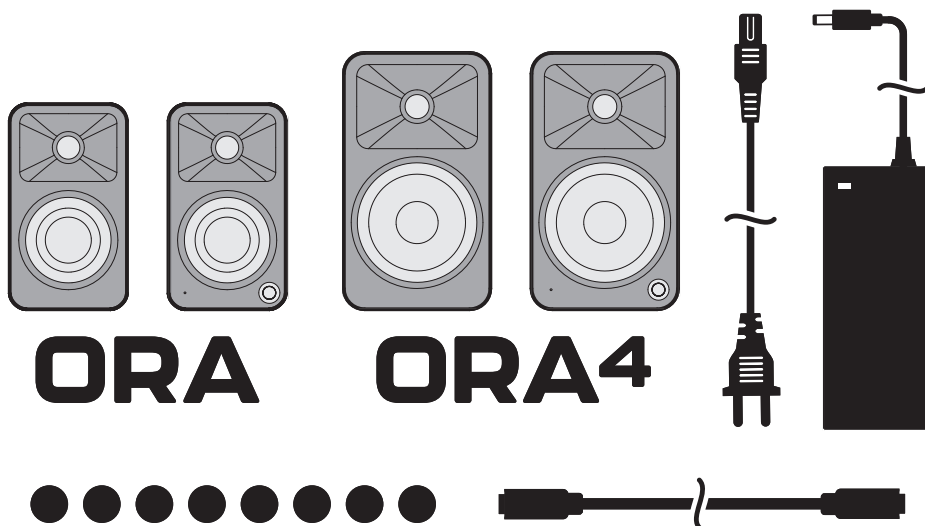

Front & Rear Panels

FRONT PANEL

- 1 3/4" silk dome tweeter
- 2 **ORA** - 3" paper cone woofer (magnetically shielded)
ORA4 - 4" aluminum concave cone woofer (magnetically shielded)
- 3 LED
 - Green - RCA
 - Yellow - USB
 - Blue - Bluetooth® Pairing (flashing)
 - Bluetooth® Paired (solid)
- 4 Volume / Input Select / On / Off

REAR PANEL

- 5 Bass Reflex Port
- 6 1/4"-20 Mounting Hole
- 7 Bluetooth® Pairing Button
- 8 USB Audio Input
- 9 Subwoofer Output
- 10 RCA Input
- 11 DC Input Connection
- 12 Speaker Out

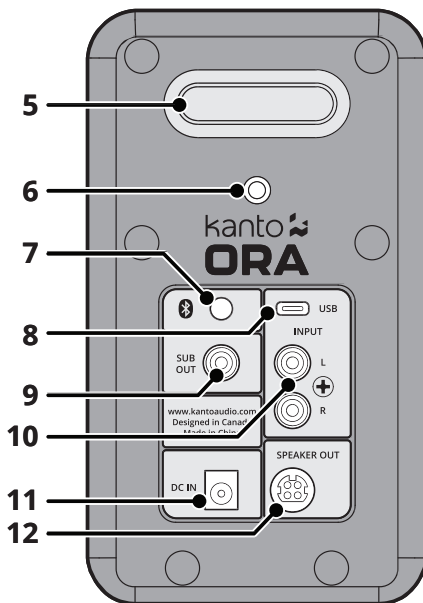
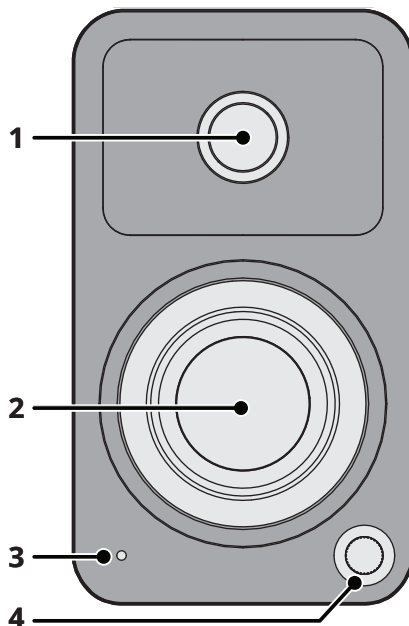

Setting Up Your Speakers

ORA/ORA4 is designed for desktop use to enhance your listening in a near-field environment. However, ORA/ORA4 can also be used as a stand-alone stereo speaker system mated with a multitude of audio sources. In either setup, the space between the two speakers and the distance from the rear wall is important. If the speakers are positioned too close or too far apart, stereo imaging will not be fully developed.

ORA/ORA4 is designed to perform optimally positioned at least 20cm to 25cm from the rear wall for best bass response. Regardless of the setup you choose, keep in mind that rooms vary in shape, size, and furnishing; a certain amount of experimentation may be necessary to determine the most suitable position that delivers the most satisfying sound performance.

ORA/ORA4 can be placed sideways below a monitor for space saving measures but will sound best when upright. To avoid early reflections from the desktop surface, which can degrade audio performance, it is advised to angle ORA/ORA4 towards your listening position. Kanto has several desktop speaker stand options to suit your needs.

Connect the two speakers together as shown below using the supplied speaker cable. Connect the Speaker Out from the active speaker (right) to the corresponding Speaker In on the passive speaker (left). Connect the AC/DC power supply from ORA/ORA4's active speaker to your wall outlet. Press the volume control knob to turn it on. Press the knob to select an input source. It cycles through the following inputs depending on what input source was last used.

RCA → USB → BLUETOOTH® → REPEAT

Press and hold to turn off. Press to turn on.

Follow the instructions on the ensuing pages to connect your audio sources to ORA/ORA4. The examples in the following pages are not meant to be exhaustive - just examples.

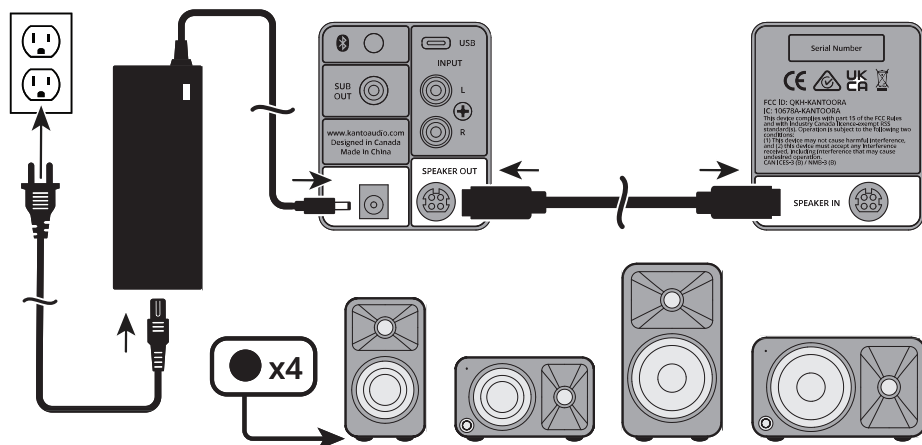

ATTENTION

After connecting all cables, the unit can be turned ON.

When the volume is high, this system can produce noise levels that could permanently damage your hearing. ORA/ORA4 is a self-powered speaker system. Do not connect the speaker terminals to the speaker outputs of a stereo amplifier. Damage may occur. Use only the power supply provided with the speakers.

Connecting Audio Sources

Use the appropriate audio cable to connect your audio source components to your speakers.

- Stereo RCA to Stereo RCA cable
- Stereo RCA to 3.5 mm stereo mini-jack AUX cable
- USB-C to USB-C
- USB-C to USB-C w/ USB-A adapter
- USB-C to USB-A

The ORA/ORA4 features a high-quality USB input that supports data streams up to 24 bit/96 kHz resolution. When connecting your computer via USB connection, you bypass the noisy built-in DAC of the computer, and audio signals are instead decoded by ORA/ORA4.

To connect using USB, cycle input to USB, and select 'ORA/ORA4 by Kanto' as your audio playback device.

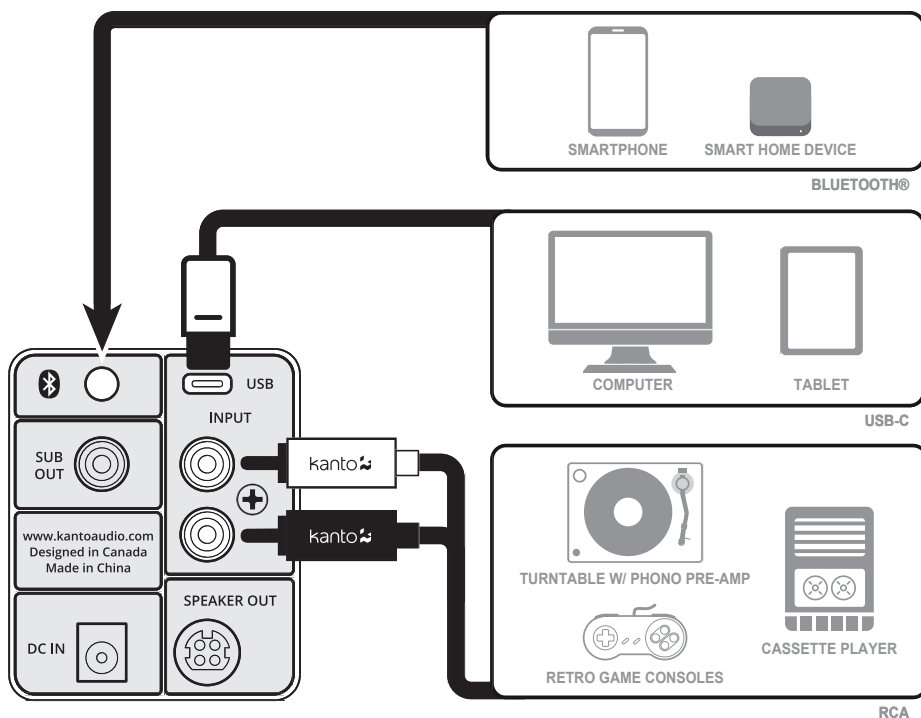

⚠ ATTENTION Some models of turntables include a built-in Phono Pre-Amp.

Connecting Bluetooth®



Bluetooth® Pairing

ORA/ORA4 features Bluetooth® 5.0 and can be paired with many devices for wireless audio playback from your phone, smart home device or tablet. Pairing is easy.

1. Press the volume knob and cycle through the inputs until the status light is blue. The Bluetooth® LED (blue) will flash to indicate that ORA/ORA4 is in pairing mode. If the light is solid, then the ORA/ORA4 is already connected to a device. If you wish to connect to another device, press the Bluetooth® pairing button (ⓑ) on the back of the ORA/ORA4 to put it in pairing mode.
2. Enable your Bluetooth® device to search for a new device to pair with. Select 'ORA/ORA4 by Kanto' from the list of Bluetooth® devices available for pairing.

Bluetooth® Operation

1. We recommend keeping a maximum distance of 10 meters between the speaker and your device. The best signal fidelity is within this range.
2. Take note of the following behavior and functionality during Bluetooth® operation. When you are successfully connected, the Blue LED will be lit solid, and your device will show as connected to 'ORA/ORA4 by Kanto'.
 - The connection does not remain active while in other inputs.
3. ORA/ORA4 speakers feature a Bluetooth® Pairing button on the back of the active speaker (right) to quickly disconnect a paired device and allow a second device to pair with the speaker.
 - Press the Bluetooth® Pairing button to disconnect a paired device.
 - Follow the pairing instructions to pair another device.

Connecting a Subwoofer

ORA/ORA4 is equipped with an RCA connector to provide output signal to a powered subwoofer. Simply connect a single RCA subwoofer cable from the SUB OUT connection on ORA/ORA4 to the AUDIO INPUT on your subwoofer. If your sub-woofer has a stereo L/R RCA input, either left or right inputs will work.

We recommend the Kanto sub8 powered subwoofer with crossover and volume controls. Most quality subwoofers offer these controls, which allow you to customize the amount of bass you will experience.

Look for details on the Kanto website at: www.kantospeakers.com

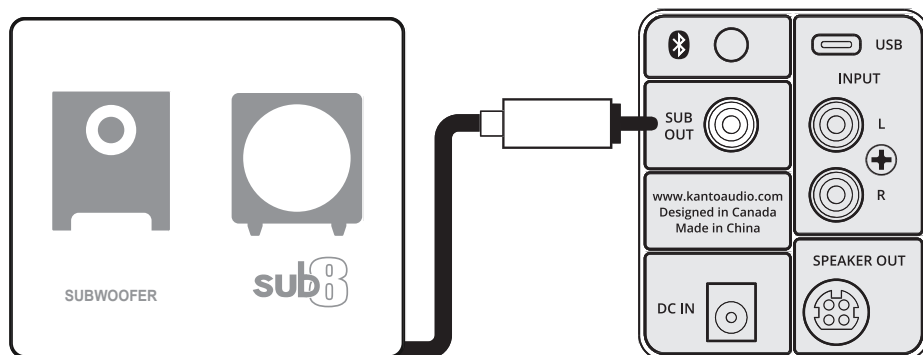

Active Crossover

ORA/ORA4 is equipped with an automatic active crossover filter at 100 Hz/80 Hz to allow for advanced setup with subwoofers. This crossover will reduce the bass extension of the main speakers, allowing them to focus on the mid and high frequencies, while reducing the high-frequency output of the SUB OUT port. If your sub has an adjustable bandwidth or crossover frequency setting, it can be adjusted to the highest or most open setting. The active crossover is enabled automatically when a subwoofer cable is plugged into ORA/ORA4's SUB OUT port.

Audio Troubleshooting Guide

Frequently asked questions about Kanto's ORA/ORA4 speakers.

- 1. None of the lights on the front panel are illuminated.**
 - Make sure the power supply is connected to the speaker and power outlet.
 - Ensure that the power outlet is providing power.
- 2. The light on the front panel is illuminated but there's no audio playing.**
 - Set the volume of the source to its highest level. Ensure audio source is playing audio.
 - Check that the audio cable connected to and from the source is firmly connected. Test another audio cable if available.
 - Verify that the volume of the speaker is not at its minimum level. Turn the volume up using the knob on the front of the speakers.
 - Make sure the correct input is selected. Press the knob on the front of the speakers to cycle through the different inputs to select the correct input.
- 3. Audio is only playing through one speaker.**
 - Reconnect the 4-pin connector between the active speaker and passive speaker.
 - Check that the audio cable connected to and from the source is firmly seated. Try a different cable or source to isolate the issue.
 - Ensure that the balance setting on the source is centered. Some sources may not have an adjustable balance setting.
- 4. You are experiencing poor audio quality.**
 - Set the volume of the source to its highest level. Low source volume can negatively affect dynamic range.
 - Ensure that the rear of the speaker is spaced away from the wall by at least 20 cm, allowing the rear port function to be left unimpeded.
 - Test a different song or source to isolate the issue.
- 5. The source will not connect to Bluetooth®.**
 - Ensure the speakers are in Bluetooth® mode by cycling through the inputs. Press the knob on the front of the speakers until the blue light on the front panel of the speakers is visible.
 - Make sure the blue light on the front panel of the speakers is flashing, indicating speakers are in pairing mode. If the blue light is not flashing press the Bluetooth® pairing button on the back of the right speaker. Blue light will flash indicating pairing mode.
 - Turn the device you are trying to pair on and off.
- 6. You are experiencing buzzing, hissing or distortion.**
 - Verify if the noise is coming from the source by removing all sources from the speakers.
 - Make sure it is not a power issue by trying a power outlet that is on a different circuit.
 - Check that the audio cable connected to and from the source is firmly seated. Try a different cable or source to isolate the issue.
 - If using USB, set the source's sample rate to 96 kHz or lower.
- 7. There's no audio coming from an attached subwoofer.**
 - Check that the RCA cable connected to and from the subwoofer is firmly seated. Try a different cable or source to isolate the issue.
 - Make sure the subwoofer is connected to a power outlet and is set to "On" or "Auto".
 - Increase the volume of the subwoofer.
 - Increase the cutoff frequency of the subwoofer to its highest position.

Specifications

ORA REFERENCE DESKTOP SPEAKERS

	ORA	ORA4
Tweeter	3/4" silk dome	3/4" silk dome
Woofer	3" paper cone (magnetically shielded)	4" aluminum concave cone (magnetically shielded)
Amplifier Type	Class D bi-amplified	Class D bi-amplified
Power Output	100 W peak power (50 W total RMS)	140 W peak power (70 W total RMS)
Power Output (per tweeter)	9 W RMS	12 W RMS
Power Output (per woofer)	16 W RMS	23 W RMS
Frequency Response	70 Hz - 22 kHz	60 Hz - 22 kHz
High/Low-Pass Filter	100 Hz (automatic)	80 Hz (automatic)
Inputs	1 x RCA line-level 1 x USB-C (24 bit/96 kHz) 1 x Bluetooth® 5.0	1 x RCA line-level 1 x USB-C (24 bit/96 kHz) 1 x Bluetooth® 5.0
Outputs	1 x sub-out	1 x sub-out
Speaker Terminals	4-pin connector	4-pin connector
Rear Mounting Hole	1/4"-20	1/4"-20
Input Voltage / Frequency	AC 100 V - 240 V 50/60 Hz	AC 100 V - 240 V 50/60 Hz
Standby Power Consumption	< 0.5 W	< 0.5 W
Dimensions (each speaker)	3.9" W x 5.6" D x 6.9" H (10 x 14.1 x 17.5 cm)	4.5" W x 6.7" D x 8.1" H (11.4 x 16.9 x 20.7 cm)
Net Weight (active)	2.2 lb (1 kg)	4.3 lb (2 kg)
Net Weight (passive)	2.2 lb (1 kg)	4 lb (1.8 kg)
Shipping Box Dimensions	8.9" W x 15.1" D x 10" H (22.7 x 38.3 x 25.4 cm)	16.9" W x 11.4" D x 11.2" H (43.0 x 29.0 x 28.4 cm)



NOTICE: This appliance is labeled in accordance with European Directive 2002/96/EC concerning waste electrical and electronic equipment (WEEE). This label indicates that this product should not be disposed of with household waste. It should be deposited at an appropriate facility to enable recovery and recycling.

MANUFACTURER AND IMPORTER:
Kanto Living Inc., 9136 196A Street, Langley, BC, Canada V1M 3B4

Limited Warranty

Kanto Living Inc. (Kanto) warrants the equipment it manufactures to be free from defects in material or workmanship for the limited warranty period of 2 years. This warranty is valid in the country of purchase.

If equipment fails and Kanto is notified within 24 months from the date of purchase with proof of original receipt from an authorized reseller, Kanto will, at its option, provide replacement parts, repair the original equipment, or replace the equipment, and be responsible for return shipping to the customer, provided that the equipment has not been subjected to mechanical, electrical, or other abuse or modifications. Any replacement parts repaired or replaced equipment are covered by the full warranty of the original purchase. The maximum liability of Kanto shall not exceed the actual purchase price paid by the original purchaser for the product.

If you purchased a Kanto product second-hand the limited warranty is fully transferable provided that you can furnish a copy of the original receipt to establish purchase date and the serial number on the product is intact.

Customers will be responsible for obtaining a Return Authorization Number through Customer Support and are responsible for return shipping costs to a Kanto location or authorized depot unless otherwise prohibited. Please keep the original packaging to prevent damage to the product during shipping. Kanto recommends insuring your shipment.

Customer Support: support@kantoliving.com

The information in the manual has been carefully checked and is believed to be accurate. However, Kanto assumes no responsibility for any inaccuracies that may be contained in the manual. In no event will Kanto be liable for direct, indirect, special, incidental, or consequential damages resulting from any defect in the equipment, even if advised of the possibility of such damages. This warranty is in lieu of all other warranties expressed or implied, including without limitation, any implied warranty, including any warranty of merchantability and fitness for any particular purpose, all of which are expressly disclaimed.

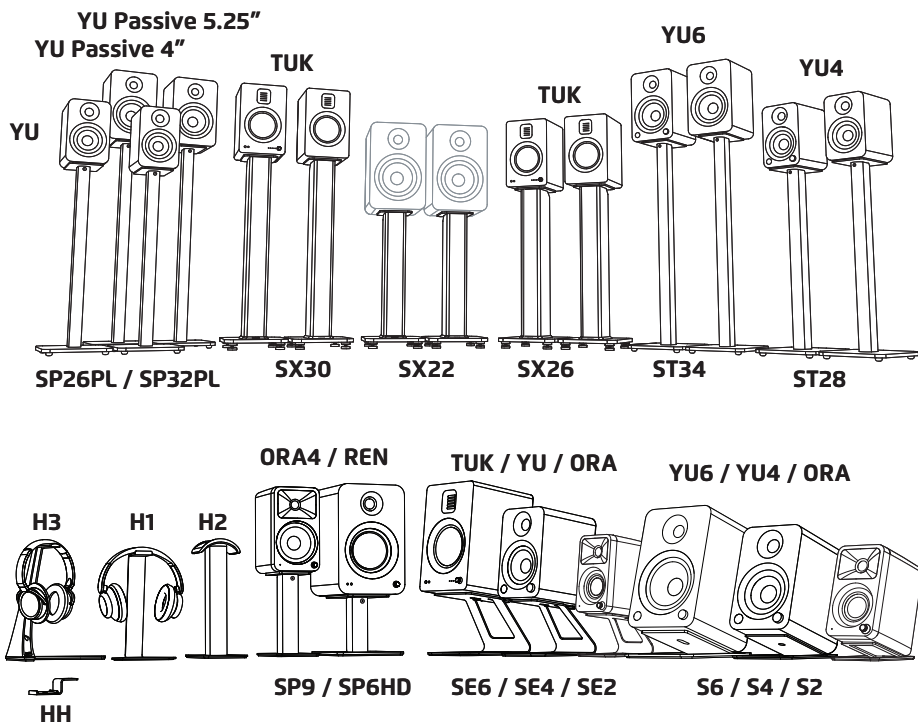

kantoaudio.com



Kanto Audio



kantoaudio



Kanto Solutions



Kanto Living



24-G
www.kantoliving.com | support@kantoliving.com
Toll Free: 1-888-848-2643



ORA

USB INFORMATION

ORA utilizes a USB-C connector for its USB input. You can use USB even if your PC doesn't have a USB-C port.

Use one of the following cables to connect ORA to a PC depending on the USB ports that are available to you.

- USB-C to USB-C
- USB-C to USB-C w/ USB-A adapter
- USB-C to USB-A

Please contact support@kantoliving.com if you are unsure of what ports your PC has or need help selecting a cable.

kanto 

INFORMATIONS USB

L'entrée USB de ORA est un connecteur USB-C. Vous pouvez utiliser l'USB même si votre ordinateur ne dispose pas d'un port USB-C.

Utilisez l'un des câbles suivants pour connecter ORA à un ordinateur, en fonction des ports USB disponibles.

- USB-C à USB-C
- USB-C à USB-C w/ USB-A adapter
- USB-C à USB-A

Veuillez contacter support@kantoliving.com si vous n'êtes pas certain des ports dont dispose votre ordinateur ou si vous avez besoin d'aide pour sélectionner un câble.

INFORMACIÓN USB

ORA utiliza un conector USB-C para su entrada USB. Puede usar USB incluso si su PC no tiene un puerto USB-C.

Utilice uno de los siguientes cables para conectar ORA a una PC según los puertos USB que tenga disponibles.

- USB-C a USB-C
- USB-C a USB-C con adaptador USB-A
- USB-C a USB-A

Póngase en contacto con support@kantoliving.com si no está seguro de qué puertos tiene su PC o si necesita ayuda para seleccionar un cable.

ORA4

Limited Warranty · Garantie limitée · Garantía limitada ·
Beschränkte Garantie · 제한 보증

kanto 

Limited Warranty

Kanto Living Inc. (Kanto) warrants the equipment it manufactures to be free from defects in material or workmanship for the limited warranty period of 2 years. This warranty is valid in the country of purchase.

If equipment fails and Kanto is notified within 24 months from the date of purchase with proof of original receipt from an authorized reseller, Kanto will, at its option, provide replacement parts, repair the original equipment, or replace the equipment, and be responsible for return shipping to the customer, provided that the equipment has not been subjected to mechanical, electrical, or other abuse or modifications. Any replacement parts, repaired or replaced equipment are covered by the full warranty of the original purchase. The maximum liability of Kanto shall not exceed the actual purchase price paid by the original purchaser for the product.

If you purchased a Kanto product second-hand the limited warranty is fully transferable provided that you can furnish a copy of the original receipt to establish purchase date and the serial number on the product is intact.

Customers will be responsible for obtaining a Return Authorization Number through Customer Support and are responsible for return shipping costs to a Kanto location or authorized depot unless otherwise prohibited. Please keep the original packaging to prevent damage to the product during shipping. Kanto recommends insuring your shipment.

Customer Support: support@kantoliving.com

For full manual please see: www.kantoaudio.com/powerd-speakers/ren/?manual=ren

The information in the manual has been carefully checked and is believed to be accurate. However, Kanto assumes no responsibility for any inaccuracies that may be contained in the manual. In no event will Kanto be liable for direct, indirect, special, incidental, or consequential damages resulting from any defect in the equipment, even if advised of the possibility of such damages. This warranty is in lieu of all other warranties expressed or implied, including without limitation, any implied warranty, including any warranty of merchantability and fitness for any particular purpose, all of which are expressly disclaimed.

Garantie limitée

Kanto Living Inc. (Kanto) garantit ses équipements contre tout défaut de matériel ou de fabrication pendant une période limitée de 2 ans. Cette garantie est valable dans le pays d'achat.

Si l'équipement tombe en panne et Kanto en est informé dans les 24 mois suivant la date d'achat avec la facture d'origine d'un revendeur agréé, Kanto offrira, à sa discrétion, des pièces de rechange, la réparation de l'équipement d'origine ou le remplacement de l'équipement, et prendra en charge les frais de retour au client, à condition que l'équipement n'ait pas été soumis à des abus mécaniques, électriques ou autres ou à des modifications. Toutes les pièces de rechange, ainsi que tout équipement réparé ou remplacé, sont couverts par la garantie complète de l'achat d'origine. La responsabilité maximale de Kanto ne dépassera pas le prix d'achat réel payé par l'acheteur d'origine du produit.

Si vous avez acheté un produit Kanto usagé, la garantie limitée est entièrement transférable à condition que vous puissiez fournir une copie de la facture originale établissant la date d'achat et que le numéro de série du produit soit intact.

Les consommateurs sont tenus d'obtenir un numéro d'autorisation de retour auprès de l'assistance à la clientèle et de prendre en charge les frais d'expédition vers un site Kanto ou un dépôt agréé, sauf interdiction contraire. Veuillez conserver l'emballage d'origine pour éviter d'endommager le produit pendant le transport. Kanto vous recommande d'assurer votre colis.

Assistance à la clientèle: support@kantoliving.com

Le manuel complet est disponible sur: www.kantoaudio.com/powerd-speakers/ren/?manual=ren

Les renseignements du manuel ont été soigneusement contrôlés et sont considérés comme exacts. Kanto décline toutefois toute responsabilité pour toute erreur contenue dans le manuel. Kanto ne pourra en aucun cas être tenu responsable de tout dommage direct, indirect, spécial, accidentel ou consécutif résultant d'un défaut quelconque de l'équipement, même si l'éventualité de tels dommages a été prévenu. Cette garantie remplace toutes les autres garanties explicites ou implicites, y compris, sans limitation, toute garantie implicite, y compris toute garantie de qualité marchande et d'adéquation à un usage particulier, toutes expressément exclues.

Garantía limitada

Kanto Living Inc. (Kanto) garantiza que el equipo que fabrica está libre de defectos de material o mano de obra durante el periodo de garantía limitada de 2 años. Esta garantía es válida en el país de compra.

Si el equipo falla y se notifica a Kanto dentro de los 24 meses a partir de la fecha de compra con un comprobante de recibo original de un revendedor autorizado, Kanto, a su elección, proporcionará piezas de repuesto, reparará el equipo original o reemplazará el equipo y será responsable de envío de devolución al cliente, siempre que el equipo no haya sido sometido a modificaciones o abusos mecánicos, eléctricos o de otro tipo. Cualquier pieza de repuesto, equipo reparado o reemplazado está cubierto por la garantía total de la compra original. La responsabilidad máxima de Kanto no excederá el precio de compra real pagado por el comprador original del producto. Si ha adquirido un producto Kanto de segunda mano, la garantía limitada es totalmente transferible siempre que pueda aportar una copia del recibo original que establezca la fecha de compra y el número de serie del producto esté intacto.

Los clientes serán responsables de obtener un número de autorización de devolución a través del servicio de atención al cliente y serán responsables de los costos de envío de la devolución a una ubicación de Kanto o a un depósito autorizado, a menos que se prohíba lo contrario. Conserve el empaque original para evitar daños al producto durante el envío. Kanto recomienda asegurar su envío.

Atención al cliente: support@kantoliving.com

Para obtener el manual completo, consulte: www.kantoaudio.com/powerd-speakers/ren/?manual=ren

La información contenida en el manual se ha comprobado cuidadosamente y se considera exacta. Sin embargo, Kanto no asume ninguna responsabilidad por cualquier inexactitud que pueda contener el manual. En ningún caso Kanto será responsable de los daños directos, indirectos, especiales, incidentales o consecuentes resultantes de cualquier defecto en el equipo, incluso si se advirtiera de la posibilidad de tales daños. Esta garantía sustituye a todas las demás garantías expresas o implícitas, entre las que se incluyen las garantías implícitas de comerciabilidad e idoneidad para un fin determinado, todas las cuales quedan expresamente excluidas.

Important Safety Precautions



ATTENTION The exclamation point within an equilateral triangle is intended to alert the user of the presence of important operating and maintenance (servicing) instructions in the literature accompanying the apparatus.
ATTENTION Le point d'exclamation dans un triangle équilatéral est destiné à avertir l'utilisateur de la présence d'informations de maintenance importantes contenues dans la documentation accompagnant l'appareil.

CAUTION

RISK OF ELECTRIC SHOCK. DO NOT OPEN.
CAUTION: TO REDUCE THE RISK OF ELECTRIC SHOCK, DO NOT REMOVE BACK PANEL. NO USER SERVICEABLE PARTS INSIDE. REFER SERVICING TO QUALIFIED SERVICE PERSONNEL.

ATTENTION

RISQUE D'ÉLECTROCUTION. N'OUVREZ PAS.
ATTENTION: POUR RÉDUIRE LES RISQUES D'ÉLECTROCUTION, NE RETIREZ PAS LE PANNEAU ARRIÈRE. AUCUNE PIÈCE FAIT L'UTILISATEUR À L'INTÉRIEUR. FAITES APPEL À UN TECHNICIEN QUALIFIÉ.



DANGEROUS VOLTAGE The lightning flash with arrowhead, within an equilateral triangle, is intended to alert the user of the presence of non-insulated "dangerous voltage" within the product's enclosure that may be of sufficient magnitude to constitute a risk of electric shock to persons.
TENSION DANGEREUSE L'icône foudre dans un triangle équilatéral est destinée à avertir l'utilisateur de la présence de "tension dangereuse" non isolée à l'intérieur de l'enceinte du produit qui peut être de magnitude suffisante pour constituer un risque de choc électrique pour les personnes.

Read these instructions.
Keep these instructions.
Heed all warnings.
Follow all instructions.
Do not use this apparatus near water.
Clean only with a dry cloth.
Do not block any ventilation openings. Install in accordance with the manufacturer's instructions.
Do not install near any heat sources such as radiators, heat registers, stoves, or other apparatus (including amplifiers) that produce heat.
Protect the power-supply cord from being walked on or pinched, particularly at plugs, convenience receptacles and the point where they exit from the apparatus.
Only use attachments / accessories specified by the manufacturer.
Use only with the cart, stand, tripod, bracket, or table specified by the manufacturer, or sold with the apparatus. When a cart is used, use caution when moving the cart / apparatus combination to avoid injury from tip-over.
Unplug this apparatus during lightning storms or when unused for long periods of time.
Refer all servicing to qualified service personnel. Servicing is required when the apparatus has been damaged in any way, such as power-supply cord or plug is damaged, liquid has been spilled or objects have fallen into the apparatus, the apparatus has been exposed to rain or moisture, the apparatus does not operate normally, or the apparatus has been dropped.
Apparatus shall be connected to a MAINS socket outlet with a protective earthing connection.
An appliance input coupler is used as the disconnect device - the disconnect device shall remain readily operable.
Batteries or battery packs shall not be exposed to excessive heat such as sunshine, fire or the like.

FCC Notice:

This device complies with part 15 of the FCC Rules. Operation is subject to the following two conditions: (1) this device may not cause harmful interference, and (2) this device must accept any interference received, including interference that may cause undesired operation.

This equipment complies with FCC radiation exposure limits set forth for an uncontrolled environment. This equipment should be installed and operated with minimum distance 20cm between the radiator and your body.

NOTE 1:

This equipment has been tested and found to comply with the limits for a Class B digital device, pursuant to part 15 of the FCC rules. These limits are designed to provide reasonable protection against harmful interference in a residential installation. This equipment generates, uses and can radiate radio frequency energy and, if not installed and used in accordance with the instructions, may cause harmful interference to radio communications. However there is no guarantee that interference will not occur in a particular installation. If this equipment does cause harmful interference to radio or television reception, which can be determined by turning the equipment off and on, the user is encouraged to try to correct the interference by one or more of the following measures:

- Reorient or relocate the receiving antenna
- Increase the separation between the equipment and receiver
- Connect the equipment into an outlet on a circuit different from that to which the receiver is connected
- Consult the dealer or an experienced radio / TV technician for help

NOTE 2:

Any changes or modifications to this unit not expressly approved by the party responsible for compliance could void the user's authority to operate the equipment.

Industry Canada Notice:

This radio transmitter has been approved by Industry Canada. This Class B digital apparatus complies with the Canadian standard ICES-003. This device complies with Industry Canada License exempt RSS standard(s). Operation is subject to the following two conditions: (1) this device may not cause interference and (2) this device must accept any interference, including interference that may cause undesired operation of the device. The device has been evaluated to meet general RF exposure requirement.

Avis d'Industrie Canada:

Cet émetteur radio a été approuvé par Industrie Canada. Cet appareil numérique de classe B est conforme à la norme canadienne ICES-003. Cet appareil est conforme aux normes RSS exemptes de licence d'Industrie Canada. Son utilisation est soumise aux deux conditions suivantes: (1) cet appareil ne doit pas causer d'interférences et (2) cet appareil doit accepter toute interférence, y compris les interférences pouvant entraîner un fonctionnement non souhaité de l'appareil. L'appareil a été évalué comme étant conforme à l'exposition générale aux RF exigence.

NOTICE: The Bluetooth® word mark and logos are registered trademarks owned by Bluetooth SIG, Inc. and any use of such marks by Kanto Distribution Inc. is under license.

NOTICE: The terms HDMI®, HDMI High-Definition Multimedia Interface, HDMI Trade dress and the HDMI Logos are trademarks or registered trademarks of HDMI Licensing Administrator, Inc.