

骑行支架音箱

使用说明书 MZ-629



安全须知

- 阅读所有说明，并保存起来以备日后参考。
- 请勿将其放置在热源附近。避免使用散热器，火炉和其他会发热的设备。避免长期暴露在阳光和高温下。
- 请注意：当蓝牙断开10分钟后，音箱将进入休眠关机。要重新启动音箱，请按电源开关按钮。

包装内容

- 主机 X1
- 充电线 X1
- 支架 X1
- 说明书 X1

产品参数

- 工作时长：4-6hr
- 信噪比：≥95dB
- 蓝牙范围：≤10m
- 频率响应：200Hz-20KHz
- 蓝牙版本：V5.4
- 电池容量：500mAh
- 充电时长：1-2hr
- 工作电压：DC 3.7V
- 额定功率：5W
- 防水等级：IP67

产品描述

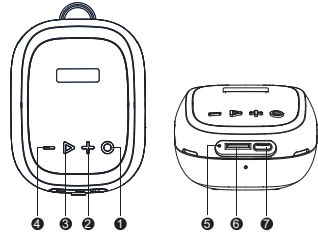

- ① 电源开关：长按3秒为开/关机；
长按10秒复位，复位后自动开机
- ② 增加音量/下一曲：短按按钮下一首；
长按按钮音量加
- ③ 播放/暂停/配对：
短按：音乐播放/音乐暂停/通话接听
双击：进入TWS功能
长按：强制断开当前蓝牙连接/通话拒接
- ④ 减小音量/上一曲：短按按钮上一首；
长按按钮音量减
- ⑤ 工作/充电指示灯(蓝/红灯)
- ⑥ TF卡接口
- ⑦ 电源接口：DC 5V

操作指令

- 步骤1
• 长按电源按钮“○” 3秒，有开机提示音，进入蓝牙模式，蓝色指示灯进入闪烁状态，音箱进入与手机蓝牙搜索配对状态。



- 步骤2
• 打开手机或其他蓝牙设备上的蓝牙功能，然后搜索名为MZ-629的音箱。与音箱连接。

- 步骤3
• 配对成功后，会有提示音，蓝色指示灯将常亮。

- 步骤4
• 在手机上播放音乐。播放音乐时，蓝色指示灯将闪亮。



步骤5

- 如何将音箱与新设备连接：
将音箱与设备连接时，您可以长按播放/暂停/配对按钮“▶” 3秒以切断当前连接并进入配对状态。蓝色指示灯将慢闪，音箱就可以与新设备连接，蓝牙状态开机自动回连上次连接的设备，无连接10分钟关机。



支架安装指南

步骤1

- 将车架A推到车架B卡紧。

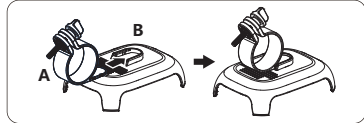

步骤2

- 从支架上拧下螺钉。

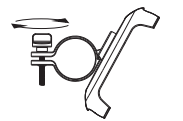

步骤3

- 将防滑垫放入支架的环中，将支架通过环固定到自行车上，然后用在步骤2中取出的螺钉拧紧支架。

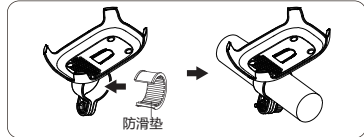

步骤4

- 安装支架后，您可以将音箱推入支架。听到咔哒声后，音箱就安装好了。

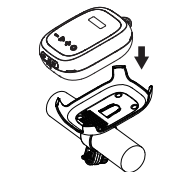

步骤5

- 如需要将音箱取出来，按下支架的凸起部分即可取出。

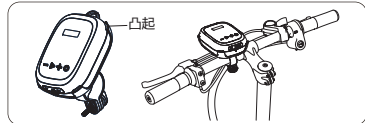

连接记忆功能

- 如果设备蓝牙功能开启，打开音箱后，音箱将自动连接到最后一个配对设备。

充电提示

- 低电量时音箱会发出提示音报警，需对音箱进行充电。
- 充电时红色指示灯常亮，充满电后红色指示灯熄灭。
- 建议对带锂电池产品如不使用时每三个月充一次电。

通话功能

- 接听电话：当音箱与手机连接时，如果有来电，您可以短按播放/暂停按钮“▶”即可接听。
- 拒绝通话：当音箱与手机连接时，如果有来电，您可以通过长按播放/暂停按钮“▶”来拒绝来电。

TF卡模式

- 插入TF卡后，音箱将进入TF卡模式，您可以短按电源按钮“○”进入模式切换。



- 在TF卡模式下，当播放音乐时，蓝色指示灯闪亮。

TWS 配对

- 两个未配对过TWS的音箱分别开机，蓝色指示灯闪烁。
- 双击任一音箱的播放/暂停/配对按钮“▶”，即可进入TWS配对状态。
- 配对成功后，主音箱蓝色指示灯连接手机时常亮，断开连接时闪烁，副音箱蓝色指示灯常亮，发起TWS配对的音箱为主音箱。

注意：
已配对成功的两个音箱，再次短按两次主音箱的播放/暂停/配对按钮“▶”，可断开TWS连接。

保修卡

| | |
|------|------|
| 产品型号 | 购买日期 |
| 经销商 | 用户姓名 |
| 联系电话 | 电子邮件 |
| 用户地址 | |

保修记录

| 用户姓名 | 故障描述 | 维修日期 | 维修员签字 |
|------|------|------|-------|
| | | | |
| | | | |
| | | | |

合格证

日期：_____
检验员：_____

Riding Speaker With Bracket

User's Manual MZ-629

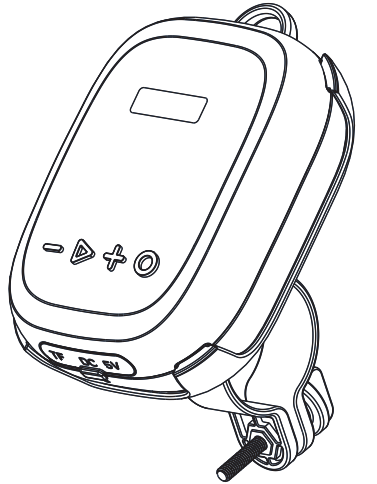

Safety Instructions

- Read all instructions and save them for future reference.
- Do not place it near a heat source. Avoid using radiators, stoves, and other equipment that can generate heat. Avoid long-term exposure to sunlight and high temperatures.
- Please note that when Bluetooth is disconnected for 10 minutes, the speaker will enter sleep mode and shut down. To restart the speaker, press the power switch button.

Packaging Content

- Speaker x1
- Charging cable x1
- Bracket x1
- User manual x1

Product Parameters

- Working hours: 4-6hours
- SNR: ≥95dB
- Wireless distance: ≤10m
- Frequency: 200Hz-20KHz
- Bluetooth version: V5.4
- Battery capacity: 500mAh
- Charging time: 1-2hours
- Working voltage: DC 3.7V
- Rated power: 5W
- Waterproof grade: IP67

Product Description

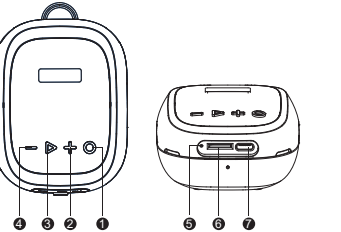

- 1. Power Switch: Press and hold for 3 seconds to turn on/off the device. Press and hold for 10 seconds to reset. After resetting, the device will automatically turn on.
- 2. Volume up key: Single press for the next song. Long press for volume up.
- 3. Play/Pause/Pair: Short press: Play music/Pause music/Answering a phone call. Double press: Enter TWS mode. Long press: Force disconnect the current Bluetooth connection/Reject a call.

- 4. Volume down key: Single press for the previous song. Long press for volume down.
- 5. Work/Charging indicator light (blue/red light)
- 6. TF card interface
- 7. Power interface: DC 5V

Operation Instructions

- Step 1 Press and hold the power button "O" for 3 seconds to activate Bluetooth mode. The blue light will flash, indicating the speaker is ready to pair with your mobile device.



- Step 2 Turn on the Bluetooth function on your phone or other Bluetooth device, and then search for a speaker named MZ-629. Connect to the speaker.

- Step 3 After successful pairing, there will be a prompt sound and the blue indicator light will remain on.

- Step 4 Play music on the phone. When playing music, the blue indicator light will flash.



- Step 5 To connect the speaker to a new device: When connecting the speaker to a device, you can press and hold the Play/Pause/Pairing button "▷" for 3 seconds to disconnect the current connection and enter pairing mode. The blue indicator light will flash slowly. The speaker can then be connected to a new device. In Bluetooth mode, it will automatically reconnect to the last connected device upon power-on and will turn off after 10 minutes of no connection.



Support Bracket Installation Guide

- Step 1 Push frame A firmly against frame B to secure them together.

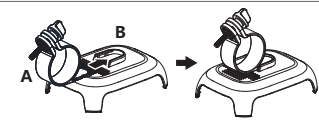

- Step 2 Unscrew the screws from the bracket.



- Step 3 Place the anti-slip pad into the ring of the bracket. Secure the bracket to the bicycle by passing it through the ring. Then use the screws taken out in Step 2 to tighten the bracket.



- Step 4 After installing the bracket, you can push the speaker into the bracket. Once you hear a click sound, the speaker is properly installed.

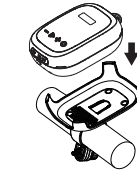

- Step 5 If you need to remove the speaker, simply press the raised part of the bracket to release and remove it.

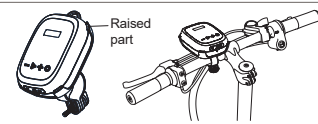

Connection Memory Function

- If the device's Bluetooth feature is enabled, the speaker will automatically connect to the last paired device upon powering on.

Charging Tips

- When the battery is low, the speaker will sound a warning sound and need to be charged.
- The red indicator light remains on during charging, but goes off when fully charged.
- It is recommended to charge products with lithium batteries every three months when not in use.

Call Function

- Answering Calls: When the speaker is connected to your phone, if there is an incoming call, you can simply press the play/pause button "▷" to answer the call.
- Rejecting Calls: When the speaker is connected to your phone, if there is an incoming call, you can reject the call by long-pressing the play/pause button "▷" .

TF Card Mode

- After inserting the TF card, the speaker will enter TF card mode. You can switch modes by briefly pressing the power button "O" .
- In TF card mode, the blue indicator light will flash when playing music.

TWS Pairing

- Two TWS speakers that have not been paired before are powered on separately, and the blue indicator lights are flashing.
- Double click the play/pause/pair button "▷" on any speaker to enter TWS pairing mode.
- After successful pairing, the blue indicator light of the main speaker remains on when connected to the phone, flashes when disconnected, and the blue indicator light of the secondary speaker remains on. The speaker initiating TWS pairing is the main speaker.

Note:
For the two successfully paired speakers, you can disconnect the TWS connection by double-clicking the play/pause/pairing button "▷" on the primary speaker.

Warranty Card

| | |
|-------------|------------------|
| Model | Date of purchase |
| Distributor | Name |
| TEL | E-mail |
| ADD | |

Warranty Records

| Name | Fault description | Repair date | Maintainer |
|------|-------------------|-------------|------------|
| | | | |
| | | | |
| | | | |

CERTIFICATE

DATE: _____
QC: _____