



KOGAN SMARTERHOME™ 2.6KW PORTABLE AIR CONDITIONER

(9,000 BTU, COOLING ONLY)

KAWFPAC09YA

Safety & Warnings	3
Overview	8
Read Before Use	12
Installation	18
Operation	23
Connect to SmarterHome™ App	26
Google Home Control	29
Amazon Alexa Control	32
Cleaning & Care	35
Specifications	37
Troubleshooting	38

SAFETY & WARNINGS

Note:

Handle with care and inspect regularly to ensure product is in good working order. If this product, power supply cord or plug shows any signs of damage: stop use, unplug the product and contact Kogan.com support.

Before Initiation

1. To avoid damage, place the unit in an upright position for at least 24 hours before initiation.
2. Make sure that the air outlet and air inlet are never blocked.
3. Only operate the unit on a horizontal surface to ensure no water leaks out.

Warnings

- Any person who is involved with working on or breaking into a refrigerant circuit should hold a current valid certificate from an industry-accredited assessment authority which authorises their competence to handle refrigerants safely in accordance with an industry recognised assessment specification.
- When disposing of either the appliance or its packaging, do so only in an environmentally conscious manner. Refer to local guidelines for more information.
- The appliance shall be stored in a well-ventilated area where the size corresponds to the room area as specified for operation.
- For optimal performance this appliance is best suited for rooms larger than 9.4m².
- The appliance shall be stored in a manner preventing mechanical damage from occurring.
- Ensure the following regarding the refrigerant pipes:
 - The installation of pipework shall be kept to a minimum.
 - The pipework shall be protected from physical damage and, in the case of flammable refrigerants, shall not be installed in an unventilated space.
 - Compliance with national gas regulations shall be observed.
 - The mechanical connections shall be accessible for maintenance purposes.
 - For appliances containing flammable refrigerants, the minimum floor area of the room shall be mentioned in the form of a table or a single figure without reference to a formula.

- Keep any required ventilation openings clear of obstruction.
- Servicing shall be performed only as recommended by the Kogan.
- Ensure ducts connected to the appliance does not contain a potential ignition source.
- When the portable air conditioner or dehumidifier is turned on, the fan can work continuously under normal conditions to provide the minimum air volume of 100m³/h even when the compressor is closed due to the temperature controller.
- Do not pierce or burn the appliance.
- Never store the appliance in a room in which there are permanent sources of ignition (e.g. open flames, a switched-on gas appliance or a switched-on electric heater).
- Do not perforate any of the components in the refrigerant circuit. Refrigerant gas may be odourless.
- Maintenance and repairs requiring the assistance of other qualified personnel must be carried out under the supervision of specialists in the use of inflammable refrigerants.
- All repairs must be carried out in accordance with the Kogan's recommendations.
- Maintenance and repairs requiring the assistance of other qualified personnel must be carried out under the supervision of specialists in the use of inflammable refrigerants.
- Do not perforate any of the components in the refrigerant circuit. Refrigerant gas may be odourless.

Appliance with R290 Refrigerant Gas



Caution: Risk of fire

- **DANGER:** It is hazardous for anyone other than an authorised service person to service this appliance. In Queensland, the authorised service person **MUST** hold a Gas Work Authorisation for hydrocarbon refrigerants to carry out servicing or repairs which involve the removal of covers.
- This appliance contains approximately 210g of R290 refrigerant gas.

Notes on Refrigerant R290

- The air conditioning system must be kept and transported upright. Otherwise, irreparable compressor damage may occur. Leave the unit for at least 24 hours before putting it into operation.
- Switch off the device and disconnect it from the power supply before cleaning.
- Make sure that the product creates a steady stream of air. Ensure the air inlets and outlets are not blocked.
- To prevent leaks, operate this unit on a horizontal surface.
- Any person performing work on a refrigerant circuit should have a current certificate from an industry-accredited assessment body. This ensures competence for the safe handling of refrigerants according to an industry-recognised assessment specification.
- If the device stops working, dispose of it properly and with regard for the environment.
- Store the device in a well-ventilated place when not in use.
- Store the device so that it is not damaged.
- Repairs may only be carried out by the manufacturer or an authorised specialist company.
- Do not damage any components of the refrigerant circuit. Escaping refrigerant may not be noticed because it is odourless.
- Maintenance and repairs must be carried out under the supervision of specialists in the use of flammable refrigerants.

General safety instructions

- Check the voltage specification on the rating plate before use. Connect the appliance only to sockets that correspond to the voltage of the appliance.
- The appliance is intended for household use only. Use the appliance only indoors and in a dry environment.
- Do not use the product if it needs to be repaired or if it has not been installed properly.
- Do not place heavy objects on the power cord, as damage to the cord may cause an electric shock.
- Do not operate the appliance with wet hands or touch the plug and cable with wet hands.
- Do not use the product in the following areas:
 - Near heat sources;
 - In areas where oil can splash;
 - In areas exposed to direct sunlight;
 - In areas where splash water can occur;
 - Near bathtubs, in washrooms, near showers or swimming pools.

- Never insert your fingers or other objects into the ventilation openings. Ensure children are explicitly warned to not do this.
- Ensure that the appliance is positioned upright (vertically) during both transport and storage so that the compressor is correctly positioned.
- Always turn off the appliance before cleaning and unplug it from the wall outlet.
- Switch off the appliance before moving it and unplug it from the wall outlet. Move the appliance slowly and carefully.
- To avoid the risk of fire, do not cover the appliance.
- Do not overload the power outlet by operating the appliance simultaneously with too many powerful electrical appliances.
- All fan connections must comply with local electrical safety regulations. If necessary, refer to these regulations.
- If the power cord or plug is damaged, cease use immediately and contact help.Kogan.com for support.
- Children over the age of 8 and persons with reduced physical, sensory or mental capabilities or those with a lack of experience and knowledge may only use the appliance if they are instructed on how to do so by a person responsible for their safety or if they are supervised and understand the hazards associated with the use of the appliance. Children may not clean or carry out user maintenance without supervision. Supervise children so that they do not play with the unit.
- Never drink condensation water that leaks from the appliance.
- The appliance must be installed in accordance with national wiring regulations.
- Do not pull the power cord, deform or modify it or immerse it in water. Incorrect handling of the power cord may result in damage to the equipment and/or electric shock.
- National gas regulations must be observed. If gas leakage should happen, open the window for ventilation before running the appliance.
- Do not block the ventilation openings.
- Do not operate the appliance solely by inserting or removing the power plug, as this may result in electric shock or fire due to heat.
- Immediately unplug the appliance from the wall outlet if it emits strange noises, odours or smoke.

Instructions for handling damage

- In case of damage to the device, cease use immediately, turn off the power, unplug the power cord, and contact help.kogan.com for support.
- Do not use again until it has been approved by a representative of Kogan.
- The power cord must be securely earthed.
- If the power cord is damaged, cease use immediately, turn off the power, unplug the power cord, and contact help.kogan.com for support.
- The replacement power cord must be arranged by Kogan. Do not repair yourself.

WARNING: Risk of injury! Repairs to the coolant circuit may only be carried out by trained specialist personnel. Never attempt to repair the unit yourself!

Information for rooms with refrigerant pipes

- Limit the piping to a minimum.
- Be careful not to damage the piping.
- Appliances with flammable refrigerants may only be installed in a well-ventilated rooms.
- Comply with national gas regulations.
- All mechanical connections must be freely accessible for maintenance purposes.

WARNING: Risk of fire! This device contains the flammable refrigerant R290. If the refrigerant escapes and is exposed to an external ignition source, there is a risk of fire.

OVERVIEW

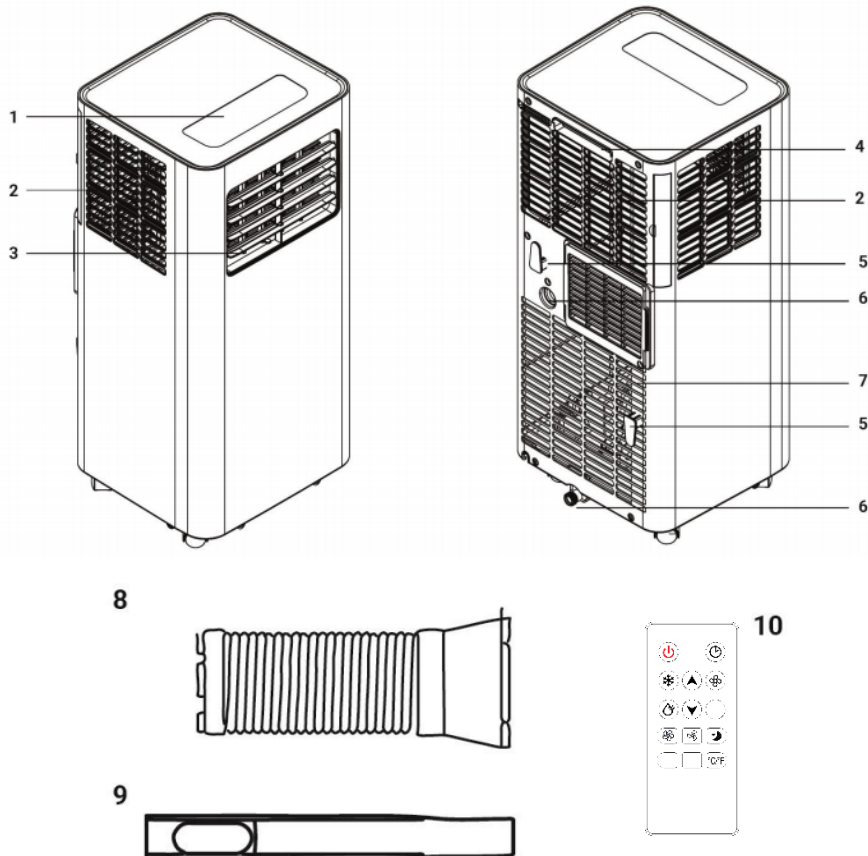

- | | |
|----------------------------|----------------------------|
| 1 Control panel | 6 Drainage Nozzle |
| 2 Air inlet grille (Upper) | 7 Air inlet grille (Lower) |
| 3 Wind guide bar | 8 Duct Assembly |
| 4 Handle | 9 Window Kit |
| 5 Cord Storage | 10 Remote Control |

Control and Operational Panel

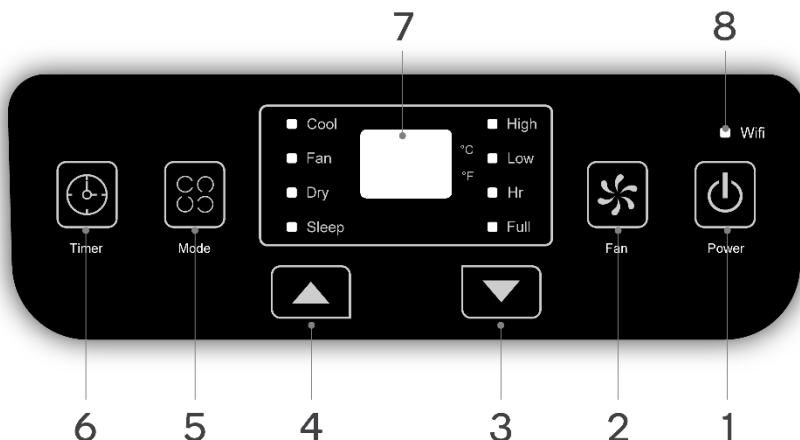

1. **On/Off Button:** To turn the device on or off
2. **Fan Button:** Press this button to select the air speed. A light will indicate whether you have selected high or low speed. Hold the Fan button down for 3 seconds to enter Wi-Fi pairing mode for Kogan SmarterHome connection.
3. **Down Button:** Press this button in cool mode to decrease the temperature; press the button in timer mode to decrease the time.
4. **Up Button:** Press this button in cool mode to increase the temperature; press the button in timer mode to increase the time.
5. **Mode Button:** Press this button to select between the following modes, a light will indicate which mode you have selected:
 - Cold Mode
 - Fan Mode
 - Dehumidifier/Dry Mode
6. **Timer Button:** Press this button when the device is stopped to set when you want it to turn on. Press the button again to set the off time.
7. **Display Screen:** The display will show the set temperature.
8. **Wi-Fi Indicator:** Indicator will flash when in Wi-Fi pairing mode, and remain solid when connected.

Note:

To change from Celsius (°C) to Fahrenheit (°F), press the down and up buttons simultaneously.

Remote Control

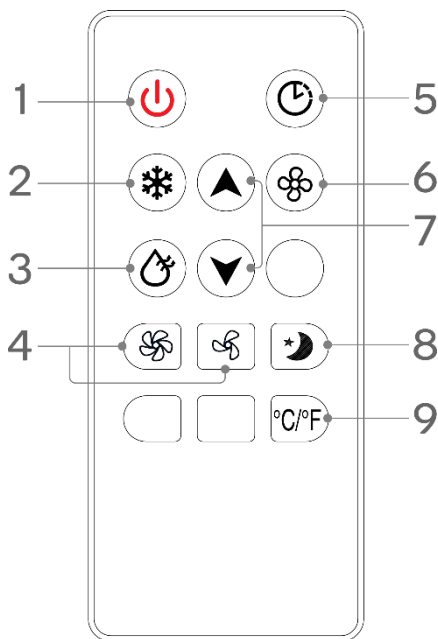

1. **On/Off Button:** To turn the device on or off.
2. **Cold Mode Button:** Press this button to select the Cold mode.
3. **Dehumidifier/Dry Mode Button:** Press this button to select the Dehumidifier/Dry mode.
4. **High/Low Buttons:** Press these buttons to select high speed or low speed.
5. **Timer Button:** Press this button when the device is stopped to set when you want it to turn on. Press the button again to set the off time.
6. **Fan Mode Button:** Press this button to select the Fan mode.
7. **Up/Down Buttons:** Press these buttons in cool mode to raise or lower the temperature; press the buttons if you have selected the timer to increase or decrease the time.
8. **Night Button:** Press to select sleep mode when the device is running cold.
9. **°C/°F Button:** Used to change from Celsius (°C) to Fahrenheit (°F).

Remote Control batteries:

Insert the batteries correctly before using the remote control.

- Slide the battery cover on the back of the remote control.
- Insert the x2 supplied AAA (DC 1.5 V) batteries, ensuring the polarity (+/-) is correct. Check the markings on both the batteries and the remote before installing.
- Slide the battery cover back into place.

Note: Only AAA (DC 1.5 V) type batteries may be used. Do not use rechargeable batteries or other types of batteries.

Always replace both batteries simultaneously. Do not mix old and new batteries.

If the remote control is not used for a long time, the batteries must be removed.

WARNING: Risk of injury! Do not use batteries that leak. Chemicals in batteries can cause burns or other health hazards. If battery fluid splashes on skin or clothing, wash it off immediately with clean water. If batteries are accidentally swallowed, immediately rinse your mouth with clean water and then contact a hospital for a medical examination.

READ BEFORE USE

Instruction, Repairing Appliances Containing R290

1. Checks to the area

Prior to beginning work on systems containing flammable refrigerants, safety checks are necessary to ensure that the risk of ignition is minimised. For repair to the refrigerating system, the following precaution shall be completed prior to conducting work on the system.

2. Work procedure

Work shall be undertaken under a controlled procedure to minimise the risk of a flammable gas or vapour being present while the work is being performed.

3. General work area

All maintenance staff and others working in the local area shall be instructed on the nature of work being carried out. Work in confined spaces shall be avoided.

4. Checking for presence of refrigerant

The area shall be checked with an appropriate refrigerant detector prior to and during work, to ensure the technician is aware of potentially toxic or flammable atmospheres. Ensure that the leak detection equipment being used is suitable for use with all applicable refrigerants, i.e. non-sparking, adequately sealed or intrinsically safe.

5. Presence of fire extinguisher

If any hot work is to be conducted on the refrigerating equipment or any associated parts, appropriate fire extinguishing equipment shall be available to hand. Have a dry powder or CO₂ fire extinguisher adjacent to the charging area.

6. No ignition sources

No person carrying out work in relation to a refrigerating system which involves exposing any pipe work shall use any sources of ignition in such a manner that it may lead to the risk of fire or explosion. All possible ignition sources, including cigarette smoking, should be kept sufficiently far away from the site of installation, repairing, removing and disposal, during which refrigerant can possibly be released to the surrounding space. Prior to work taking place, the area around the equipment is to be surveyed to make sure that there are no flammable hazards or ignition risks. "No Smoking" signs shall be displayed.

7. Ventilated area

Ensure that the area is in the open or that it is adequately ventilated before breaking into the system or conducting any hot work. A degree of ventilation shall continue during the period that the work is carried out. The ventilation should safely disperse any released refrigerant and preferably expel it externally into the atmosphere.

8. Checks to the refrigerating equipment

Where electrical components are being changed, they shall be fit for the purpose and to the correct specification. At all times, the manufacturer's maintenance and service guidelines shall be followed. If in doubt, consult the manufacturer's technical department for assistance.

The following checks shall be applied to installations using flammable refrigerants:

- The actual refrigerant charge is in accordance with the room size within which the refrigerant containing parts are installed.
- The ventilation machinery and outlets are operating adequately and are not obstructed.
- If an indirect refrigerating circuit is being used, the secondary circuit shall be checked for the presence of refrigerant.
- Marking to the equipment continues to be visible and legible. Markings and signs that are illegible shall be corrected.
- Refrigerating pipe or components are installed in a position where they are unlikely to be exposed to any substance which may corrode refrigerant containing components, unless the components are constructed of materials which are inherently resistant to being corroded or are suitably protected against being so corroded.

9. Checks to electrical devices

Repair and maintenance to electrical components shall include initial safety checks and component inspection procedures. If a fault exists that could compromise safety, then no electrical supply shall be connected to the circuit until it is satisfactorily dealt with. If the fault cannot be corrected immediately but it is necessary to continue operation, an adequate temporary solution shall be used. This shall be reported to the owner of the equipment, so all parties are advised.

Initial safety checks shall include:

- That capacitor is discharged: this shall be done safely to avoid the possibility of sparking,
- That no live electrical components and wiring are exposed while charging, recovering, or purging the system,
- That there is continuity of earth bonding.

10. Repairs to sealed components

During repairs to sealed components, all electrical supplies shall be disconnected from the equipment being worked upon before any removal of sealed covers, etc. If it is necessary to have an electrical supply to equipment during servicing, then a permanently operating form of leak detection shall be located at the most critical point to warn of a potentially hazardous situation.

Particular attention shall be paid to the following to ensure that by working on electrical components, the casing is not altered in such a way that the level of protection is affected. This shall include damage to cables, an excessive number of connections, terminals not made to original specification, damage to seals, incorrect fitting of glands, etc.

Ensure that the apparatus is mounted securely.

Ensure that seals or sealing materials have not degraded to the point that they no longer serve the purpose of preventing the ingress of flammable atmospheres. Replacement parts shall be by the manufacturer's specifications.

11. Repair to intrinsically safe components

Do not apply any permanent inductive or capacitance loads to the circuit without ensuring that this will not exceed the permissible voltage and current permitted for the equipment in use.

Intrinsically safe components are the only types that can be worked on while living in the presence of a flammable atmosphere. The test apparatus shall be at the correct rating.

Replace components only with parts specified by the manufacturer. Other parts may result in the ignition of refrigerant in the atmosphere from a leak.

12. Cabling

Check that cabling will not be subject to wear, corrosion, excessive pressure, vibration, sharp edges, or any other adverse environmental effects. The check shall also consider the effects of ageing or continual vibration from sources such as compressors or fans.

13. Detection of flammable refrigerants

Under no circumstances shall potential sources of ignition be used in the searching for or detection of refrigerant leaks. A halide torch (or any other detector using a naked flame) shall not be used.

14. Removal and evacuation

When breaking into the refrigerant circuit to make repairs – or for any other purpose – conventional procedures shall be used. However, for flammable refrigerants, best practice must be followed since flammability is a consideration. The following procedure shall be adhered to:

- Remove refrigerant
- Purge the circuit with inert gas
- Evacuate
- Purge with inert gas
- Open the circuit by cutting or brazing.

The refrigerant charge shall be recovered into the correct recovery cylinders. For appliances containing flammable refrigerants, the system shall be purged with oxygen-free nitrogen to render the appliance safe for flammable refrigerants. This process may need to be repeated several times. Compressed air or oxygen shall not be used for purging refrigerant systems.

For appliances containing flammable refrigerants, refrigerants purging shall be achieved by breaking the vacuum in the system with oxygen-free nitrogen and continuing to fill until the working pressure is achieved, then venting to atmosphere and finally pulling down to a vacuum. This process shall be repeated until no refrigerant is within the system. When the final oxygen-free nitrogen charge is used, the system shall be vented down to atmospheric pressure to enable work to take place. This operation is vital if brazing operations on the pipework are to take place.

Ensure that the outlet for the vacuum pump is not close to any potential ignition sources and that ventilation is available.

15. Charging procedures

In addition to conventional charging procedures, the following requirements shall be followed.

- Ensure that contamination of different refrigerants does not occur when using charging equipment. Hoses or lines shall be as short as possible to minimise the amount of refrigerant contained in them.
- Cylinders shall be kept in an appropriate position according to the instructions.
- Ensure that the refrigerating system is earthed before charging the system with refrigerant.
- Label the system when charging is complete (if not already).
- Extreme care shall be taken not to overfill the refrigerating system.

Before recharging the system, it shall be pressure-tested with the appropriate purging gas. The system shall be leak-tested on completion of charging but before commissioning. A follow-up leak test shall be carried out before leaving the site.

16. Decommissioning

Before carrying out this procedure, the technician must be completely familiar with the equipment and all its detail. It is recommended good practice that all refrigerants are recovered safely. Before the task being carried out, an oil and refrigerant sample shall be taken in case analysis is required before re-use of recovered refrigerant. Electrical power must be available before the task is commenced.

- a. Become familiar with the equipment and its operation.
- b. Isolate the system electrically.
- c. Before attempting the procedure, ensure that:
 - o Mechanical handling equipment is available, if required, for handling refrigerant cylinders.
 - o All personal protective equipment is available and being used correctly.
 - o The recovery process is always supervised by a competent person.
 - o Recovery equipment and cylinders conform to the appropriate standards.
- d. Pump down the refrigerant system, if possible.
- e. If a vacuum is not possible, make a manifold so that refrigerant can be removed from various parts of the system.
- f. Make sure that the cylinder is situated on the scales before recovery takes place.
- g. Start the recovery machine and operate by instructions.
- h. Do not overfill cylinders (no more than 80% volume liquid charge).
- i. Do not exceed the maximum working pressure of the cylinder, even temporarily.
- j. When the cylinders have been filled correctly and the process completed, make sure that the cylinders and the equipment are removed from the site promptly and all isolation valves on the equipment are closed off.
- k. Recovered refrigerant shall not be charged into another refrigerating system unless it has been cleaned and checked.

17. Labelling

Equipment shall be labelled stating that it has been de-commissioned and emptied of refrigerant. The label shall be dated and signed. For appliances containing flammable refrigerants, ensure that there are labels on the equipment stating the equipment contains flammable refrigerant.

18. Recovery

When removing refrigerant from a system, either for servicing or decommissioning, it is recommended good practice that all refrigerants are removed safely.

When transferring refrigerant into cylinders, ensure that only appropriate refrigerant recovery cylinders are employed. Ensure that the correct number of cylinders for holding the total system charge is available. All cylinders to be used are designated for the recovered refrigerant and labelled for that refrigerant (i.e. special cylinders for the recovery of refrigerant). Cylinders shall be complete with a pressure-relief valve and associated shut-off valves in good working order. Empty recovery cylinders are evacuated and, if possible, cooled before recovery occurs.

The recovery equipment shall be in good working order with a set of instructions concerning the equipment that is at hand and shall be suitable for the recovery of all appropriate refrigerants including, when applicable, flammable refrigerants. Also, a set of calibrated weighing scales shall be available and in good working order. Hoses shall be complete with leak-free disconnect couplings and in good condition. Before using the recovery machine, check that it is in satisfactory working order, has been properly maintained and that any associated electrical components are sealed to prevent ignition in the event of a refrigerant release. Consult the manufacturer if in doubt.

The recovered refrigerant shall be returned to the refrigerant supplier in the correct recovery cylinder and the relevant waste transfer note arranged. Do not mix refrigerants in recovery units and especially not in cylinders.

If compressors or compressor oils are to be removed, ensure that they have been evacuated to an acceptable level to make certain that flammable refrigerant does not remain within the lubricant. The evacuation process shall be carried out before returning the compressor to the suppliers. Only electric heating to the compressor body shall be employed to accelerate this process. When the oil is drained from a system, it shall be carried out safely.

INSTALLATION

Installation position

- Place the appliance on a level surface near a window.
- For adequate air circulation and optimum performance, the appliance should be placed at least 50 cm away from walls and objects.

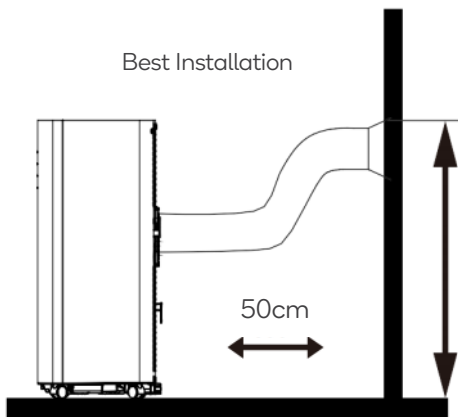

- Turn the drainage tube at the air outlet behind the panel (counter- clockwise).

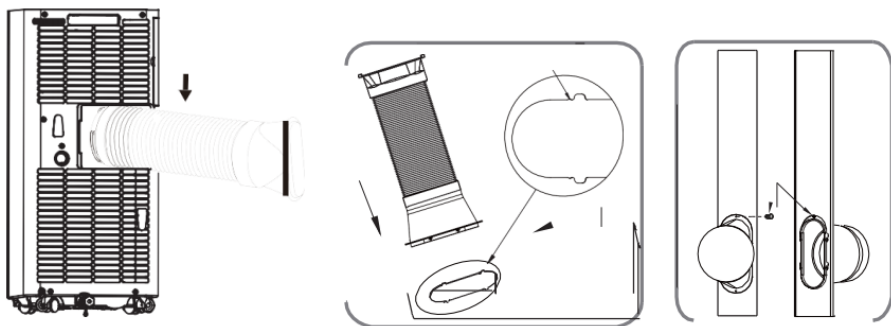

- Screw the drainage tube into the air outlet behind the panel (counter-clockwise).
- Insert the air release hose into the window sealing plate, adjust the width of the window opening so that the window can be matched to the sealing plate correctly; the length of the sealing plate is adjustable; and screw it on.

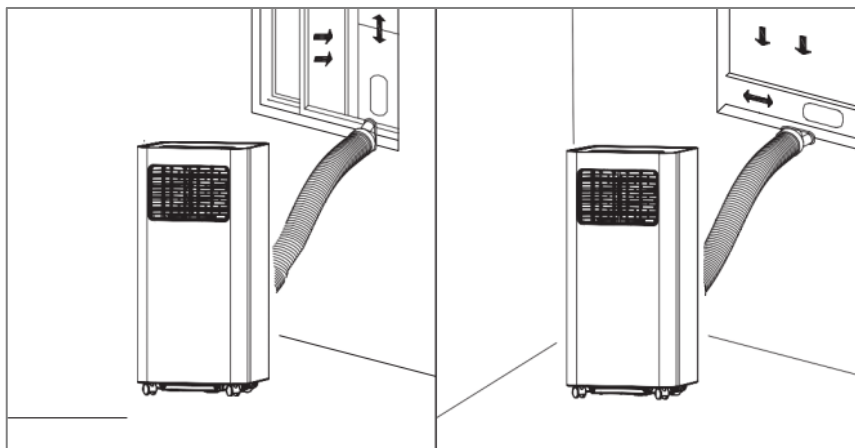

Incorrect installation

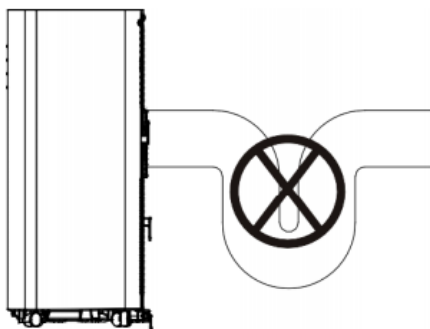

- It is important to keep the duct unblocked. An incorrect installation will impact the performance of your appliance.
- Avoid the duct bending at any point.
- Ensure the air is flowing correctly.

Window Kit Installation

Exhaust air duct assembly:

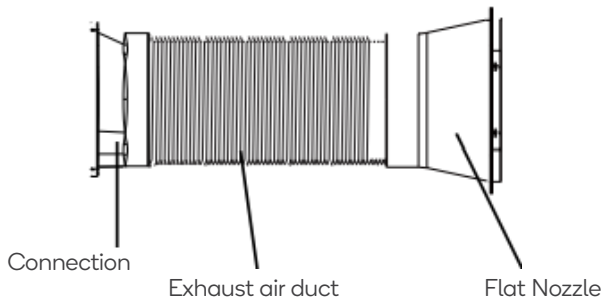

Window Kit Installation:

Your window kit has been designed to fit most standard "vertical" and "horizontal" window applications. However, it may be necessary for you to improvise/modify some aspects of the installation procedures for certain types of windows.

See the figure below:

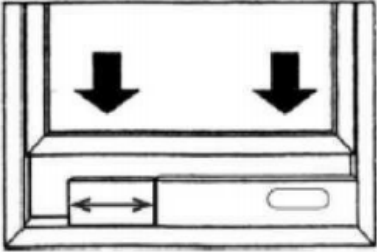
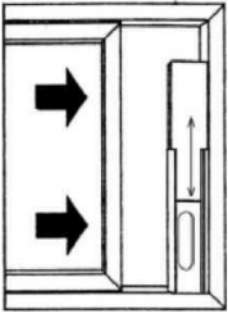
	
<p>Horizontal window Window kit Min: 27-1/ 2" (70 cm) Max: 48 (122 cm)</p>	<p>Vertical window Window kit Min: 27-1/ 2" (70 cm) Max: 48 (122 cm)</p>

Depending on your portable AC model, the window kit could be fixed to the window by screws or by a clip, as it is shown in the picture below:

Screw-fixture Type

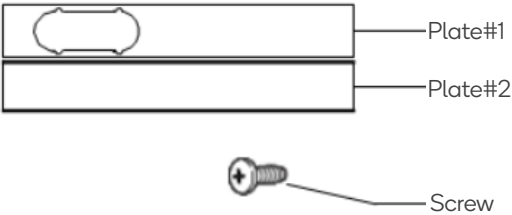

Clip-fixture Type

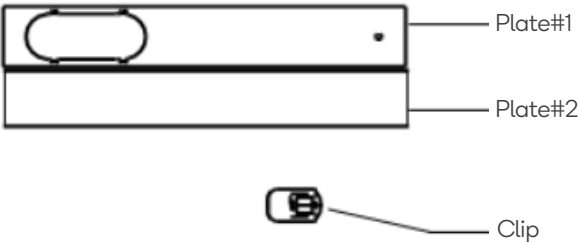

If your kit includes screws:

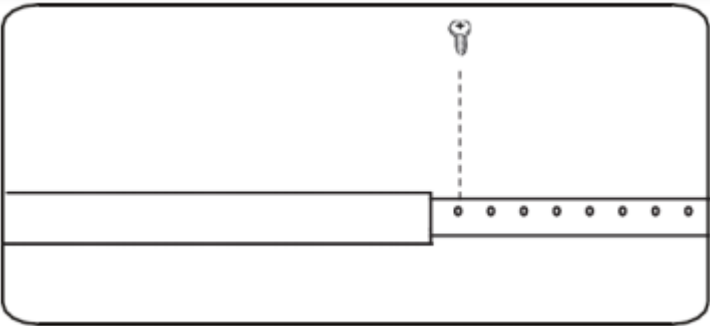

1. Measure the window dimensions
2. Adjust the plate's length according to the window's length
3. Secure the plate with the screw
4. Fasten the screw firmly

If your kit includes clips:

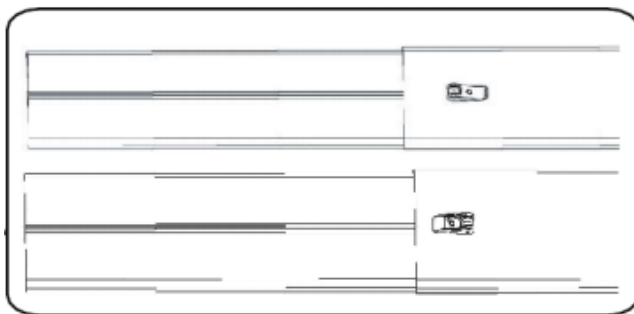

1. Measure the window dimensions
2. Adjust the plate's length according to the window's length
3. Secure the plate using the clip on the plate

Then, fix the plate to the window

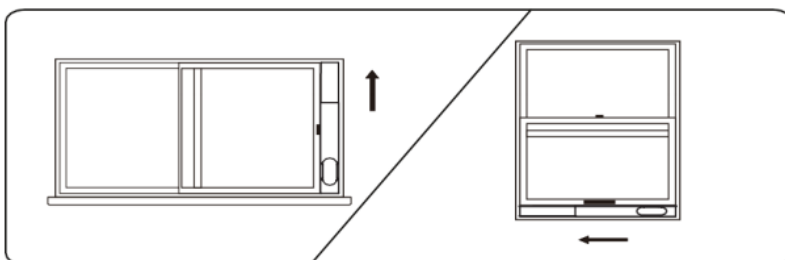

Note:

Casement Windows kit:

If you have a casement window, please note that the window kit included with this appliance is not compatible.

Warning:

The exhaust pipe is designed especially for this model. Do not replace or lengthen it, otherwise a failure will occur. The exhaust air duct can be stretched up to 1500mm. To avoid bending, stretch as short as possible.

OPERATION

Before Operation

- Ensure the air inlets and outlets of the unit aren't blocked.
- Check that the partition plate stop and the base stop are installed correctly.
- Before turning the unit on, make sure the air filter is in the correct position. If the equipment is operated without the air filter, dust and other objects will cause the air conditioning to malfunction.

If not using the appliance for an extended period:

- Turn off the air conditioner and disconnect it from the power supply.
- Maintain the air filter and other parts correctly.
- Open the partition plate stop and the base stop for draining water from the partition plate and the base. Then run the unit in fan mode for half an hour to ensure that the divider plate and base are dry.
- Use a plastic sheet to cover the unit to prevent dust or dirt from entering the unit.

Cooling mode

- When the device is switched on, this mode will automatically be selected, but it can also be selected on the control panel. The indicator light in this mode will light up.
- In this case, the device will expel cold air and will operate in the air conditioning mode.
- Press the corresponding buttons to increase/decrease the temperature (from 16° to 30°).
- Press the speed key to select the appropriate speed.

Fan mode

- Select this mode via the device's control panel or with the remote control, the indicator light in this mode will light up.
- In this case the device will only expel air and will operate in the fan mode.
- Select the desired speed (High/Low).
- The temperature cannot be selected in this mode.

Dry Mode/Dehumidification mode

- Select this mode via the control panel on the device or with the remote control, the indicator light in this mode will light
- This mode will regulate the temperature of the room automatically and acting as a dehumidifier.
- Remove the water plug (see right), insert one end of the pipe into the drain hole and the other end into the water tank.
- If the temperature is equal to or greater than 17°C (or 62°F), the compressor turns on. Thereafter, it is controlled according to the following rules: the compressor is turned off when $T_a < 15^\circ\text{C}$ (or 59°F) and restarted when the temperature rises to $T_a > 17^\circ\text{C}$. **Note:** T_a = ambient temperature
- In this case, the speed cannot be adjusted and it always works at low speed by default.
- The temperature cannot be selected in this mode either.

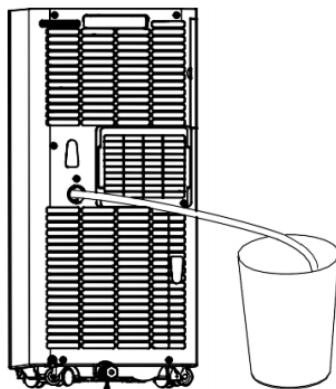

Timer Mode

- When the device is on standby, press the timer key to set the power on time. Press the Up and Down keys to set the power on time (0 ~ 24 H).
- The timer indicator light will light up when this option is in use.
- At any time when the device is in operation, press the timer key to remove the timer function. Use the up and down arrows to set the timer to 0. If you want to set the shut-off time, press this button while the device is in operation and set the shut-off time.

Note:

The timer is set based on the current time. Therefore, you must set the current time correctly.

Sleep Mode

- In cold mode, press "SLEEP" on the remote control; or press Timer and the down button on the control panel simultaneously;
- The speed in this case cannot be adjusted manually. In this mode, the fan will be forced to work at low voltage.
- The low speed indicator light will come on.
- If you want to cancel, press the SLEEP button on the remote control or the Timer and the down buttons on the control panel again.

Remote Control

Method of Transmission

- Point the remote controller at the air conditioner and press the button on the controller. The instruction signal will be transmitted to the air conditioner.
- Upon receiving the signal from the remote controller, the air conditioner unit will utter a "dee-" sound for acknowledgment.

Points of attention in using the remote controller:

- Do not place the remote control near high temperatures, such as heaters, radiators or electric blankets or pillows.
- Do not place the remote control in direct sunlight or strong light.
- Avoid accidental dropping of the remote control, as this could cause damage to the remote control.
- Do not place any blocking objects between the air conditioner and the control unit.
- Do not splash the remote control with water or other liquids.
- Do not place heavy objects on the controller.
- If the remote control does not work, replace the batteries and try again.

Replacement of Batteries

When the signal is transmitted but the air conditioner does not give a confirmation signal, it means that the batteries are dead and need to be replaced.

- Remove the battery cover by sliding the cover in the direction of the arrow and remove the used batteries.
- Replace the batteries with new ones, paying attention to the "+" and "-" polarity.
- Close the rear cover.

CONNECT TO SMARTERHOME™ APP

Install App

Download the “Kogan SmarterHome” app from the Play Store (Android) or App Store (iOS).



Play Store (Android)



App Store (iOS)



To register:

1. If you already have a SmarterHome account, select ‘Log In’. To register a new account, select ‘Sign Up’.
2. The system will automatically recognise your country. If needed, you can manually select your country from the drop-down box. Enter your email address and tap ‘Get Verification Code’ to continue.
3. A 6-digit code will be sent to the submitted email address. Enter this code before the one-minute timer expires.
4. Continue to the next page and complete your SmarterHome profile.

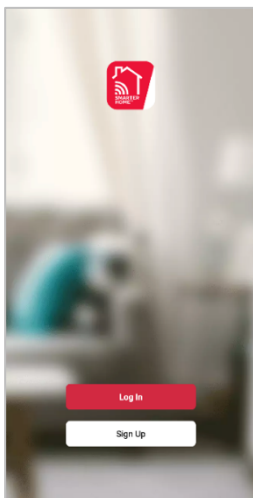

Register

Australia

Email Address

Get Verification Code

Enter Verification Code

1

A verification code has been sent to your email

[Didn't get a code?](#)

Set device in pairing mode

When the air conditioner is first turned on, it may automatically enter pairing mode (the Wi-Fi light will be flashing rapidly).

If not automatically in pairing mode when powered on, you can manually set the air conditioner in pairing mode by unplugging it or turning off power at the wall, then plugging in or turning on power again. Don't press any buttons once power is reconnected – the air conditioner will then enter standby mode. Once in standby, press and hold the fan button on the control panel for 3 seconds until the Wi-Fi indicator light begins flashing rapidly.

Add device through network

1. Once registered, tap **"Add Device"** on the app's home page, or the **"+"** in the upper right corner, to add a new device through the network.
2. Select the product type from the list of options in the app (Heating & Cooling > Air Conditioner).
3. Enter your Wi-Fi details. It is important that your SmarterHome™ device and the app are connected to the same Wi-Fi network during setup.

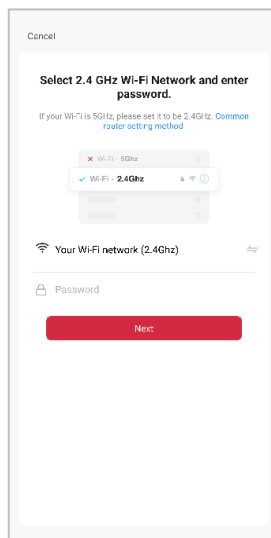
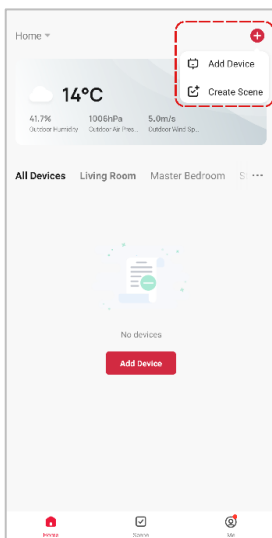

Notes:

- The device and the app have to use the same Wi-Fi network.
- The device is only compatible with 2.4Ghz networks.
- Depending on the product, Steps 3 and 4 may be in opposite order.

4. Ensure that the device is in pairing mode, with the Wi-Fi indicator light flashing rapidly, and tap “Confirm light is rapidly flashing”.
5. The device will commence the pairing process and connect to the app. Ensure your Wi-Fi router, mobile phone, and the SmarterHome™ device are kept close until connection is complete.
6. After successfully being added, you will have the option to rename the device and assign it to a location. It will now be listed on the app’s home page. Tap the device listing to enter its control page.

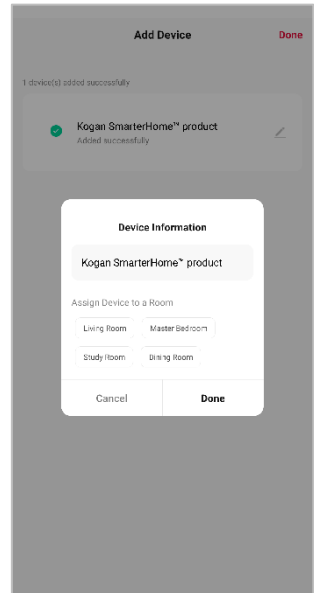
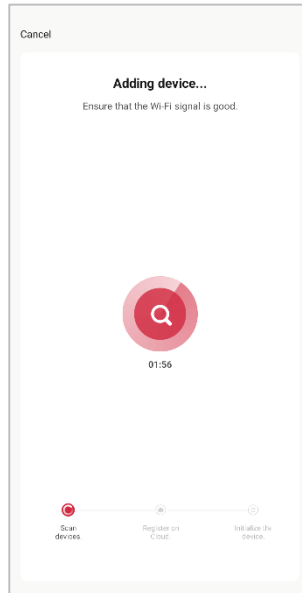
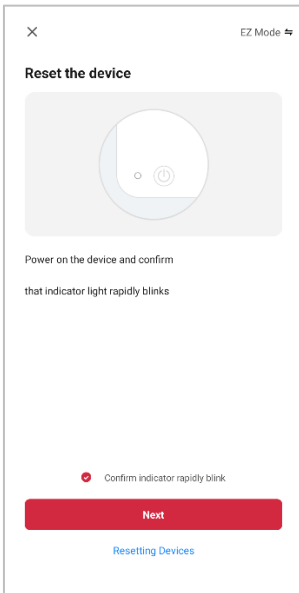

Note:

Once connected, you can select Create Scene from the “+” in the upper right corner (or from the Scene tab) to group connected SmarterHome™ products and automate their functions.

GOOGLE HOME CONTROL

Note:

You will need to have set up a Google Home account prior to linking your Kogan SmarterHome™ device.

Adding “SmarterHome” to the Google Home app

1. From the home page of the Google Home app, select the “+” icon (top left corner, see arrow in the below screenshot) to access the ‘Add and manage’ page.
2. Select ‘Set up device’, then select the ‘Works with Google’ option.

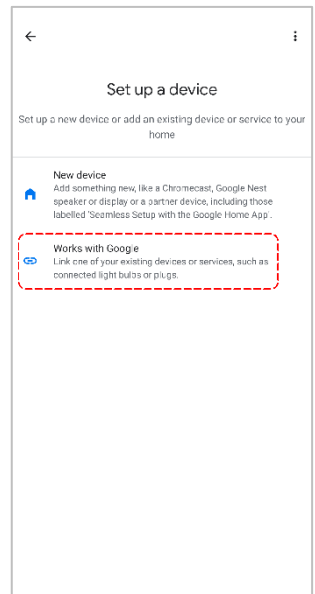
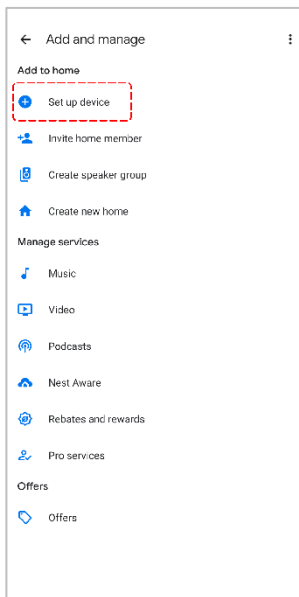

3. Select the search bar and type 'Smarter Home' to locate the Kogan SmarterHome™ service.
4. From here, you will be prompted to sign into your SmarterHome™ account using either your email or mobile phone number, depending on which method you used to register your account.
5. Select "Kogan SmarterHome™" from the app options.

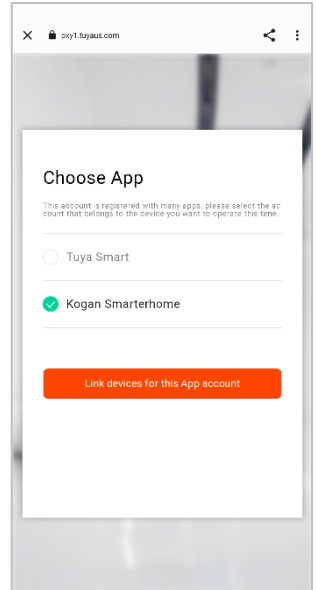
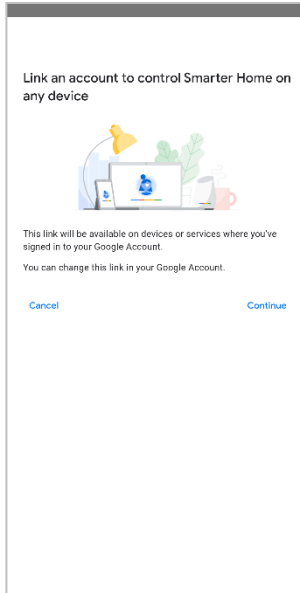
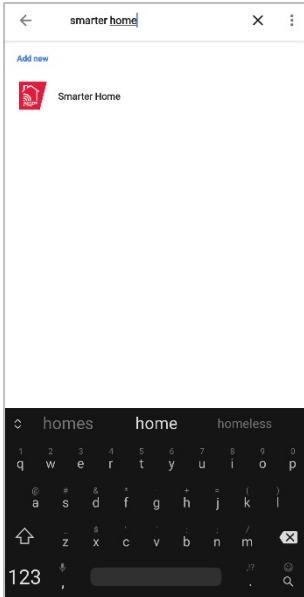

6. Tap 'Authorise' to grant Google permission to access the SmarterHome™ app and your devices.
7. Once connected, the app will display any compatible devices linked to your SmarterHome™ account. From here you can assign them to rooms and set up any routines. Tap on any of the devices to view a list of available commands.

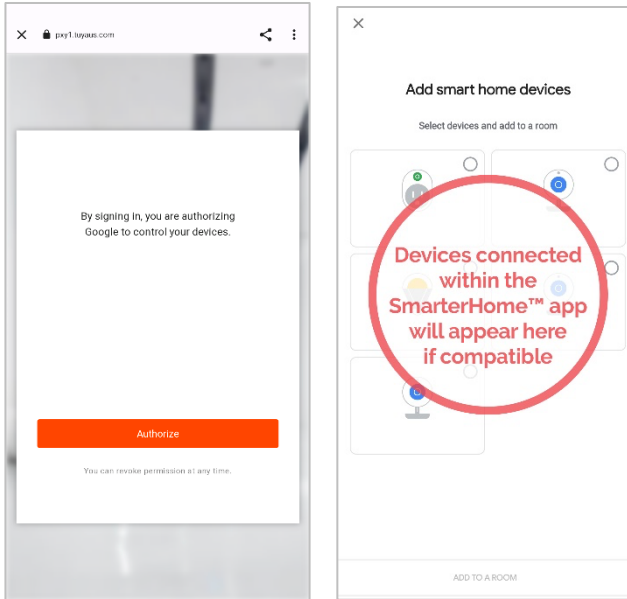

Note:

Please note that Google Home can only control the base/core functions of any compatible SmarterHome™ devices. To make full use of this product's smart functionality, please use the Kogan SmarterHome™ app.

AMAZON ALEXA CONTROL

Note:

You will need to have set up an Alexa account prior to linking your Kogan SmarterHome™ device.

Adding “SmarterHome” to the Alexa app

1. From the home page of the Alexa app, select the “☰” icon in the bottom-right and select “Skills & Games” from the sidebar.
2. Select the search bar and type ‘Smarter Home’ to locate the Kogan SmarterHome™ skill.

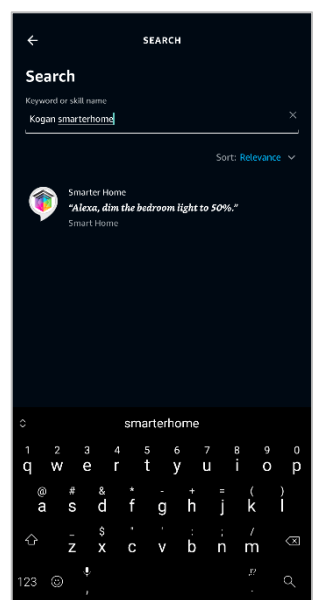
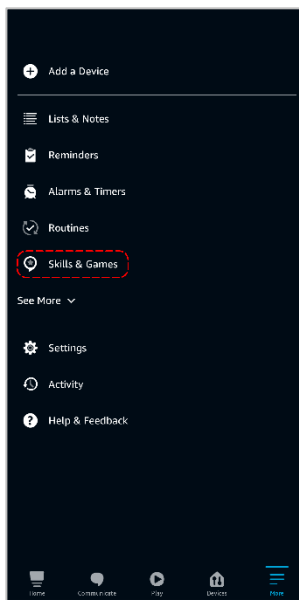
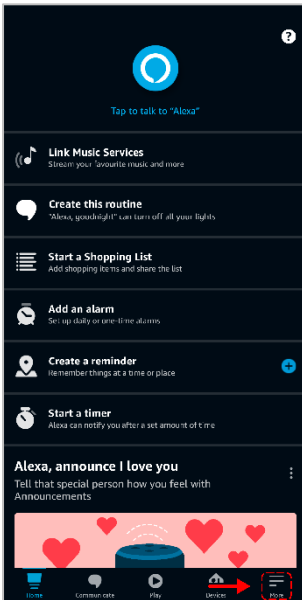

- 3. Tap 'Enable to Use' to add the Kogan SmarterHome™ skill to Alexa.
- 4. From here, you will be prompted to sign into your SmarterHome™ account using either your email or mobile phone number, depending on which method you used to register your account.
- 5. Select “Kogan SmarterHome™” from the app options.

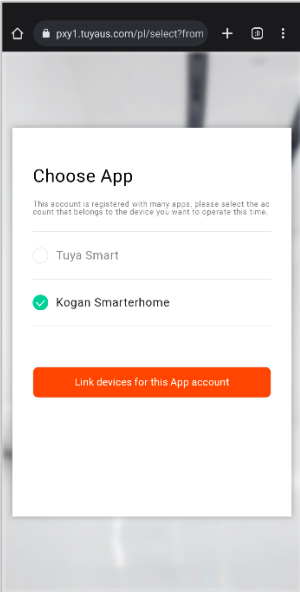
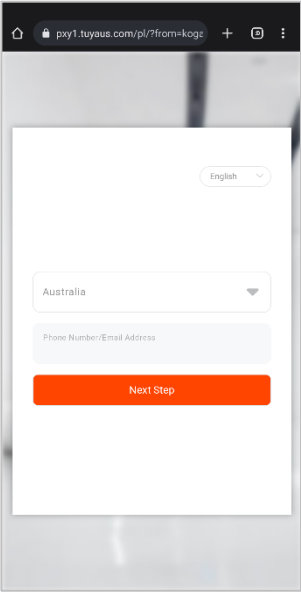
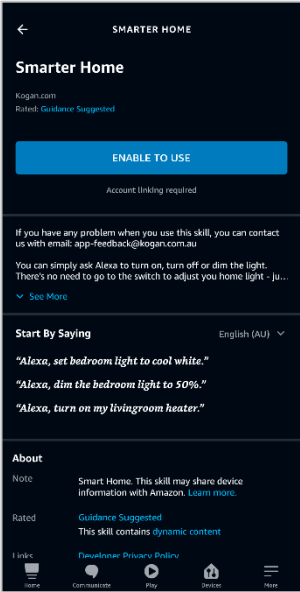

6. Tap 'Authorise' to grant Alexa permission to access the SmarterHome™ app and your devices.
7. Once connected, the app will perform a search and display the devices linked to your SmarterHome™ account. When your devices have successfully connected to the Alexa app, you will be able to control your Kogan SmarterHome™ devices via Alexa's voice commands.

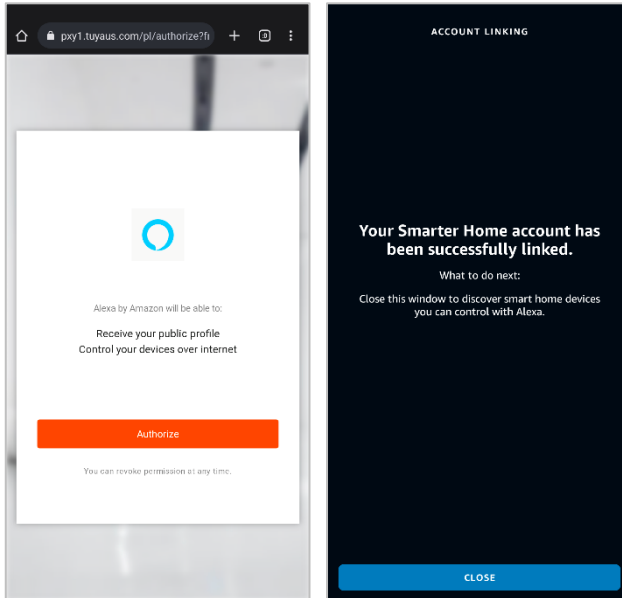

Note:

Please note that Alexa can only control the base/core functions of any compatible SmarterHome™ devices. To make full use of this product's smart functionality, please use the Kogan SmarterHome™ app.

CLEANING & CARE

WARNING: Risk of electric shock! Turn the appliance off and unplug the power cord before cleaning, servicing or repairing the appliance.

Water Drainage

The air conditioner evaporates condensed water and discharges the moisture through the hot air outlet.

However, in some cases, the unit will not condense all the water. This left-over water will fill the water tank. Once the internal water tank is full, the FULL lamp will illuminate and the unit will stop running.

Follow the steps to drain the water:

- Unplug the air conditioner, disconnect the exhaust hose from the back, and move the conditioner to a suitable drain location or outdoors.
- Remove the base stopper from the base water outlet to drain water.
- Once the internal water tank is drained, reinstall the base stopper, ensuring it is on securely.
- Place the air conditioner back in the desired location, reconnect the exhaust hose, and plug in the air conditioner. The unit will operate normally.

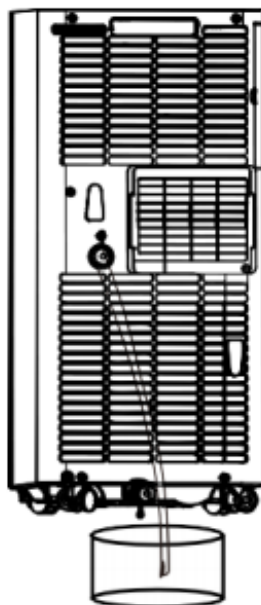

WARNING: To avoid accidents caused by electric shock, make sure that no power is supplied to the unit before starting maintenance or repair.

Air Filter Cleaning

If the air filter is blocked by the accumulation of a large amount of dust, the volume of the air flow will be reduced. Clean the filter at least once every two weeks.

Open and clean the air filter:

- Directly fasten the hook at the bottom to remove the air filters in the direction of the arrow.
- Carefully wash the air filters by immersing them in hot water (about 40°C or 104°F) with a neutral detergent.
- Rinse the filter detergent and let it dry completely in a shaded area.
- Put the air filter back in its original place.

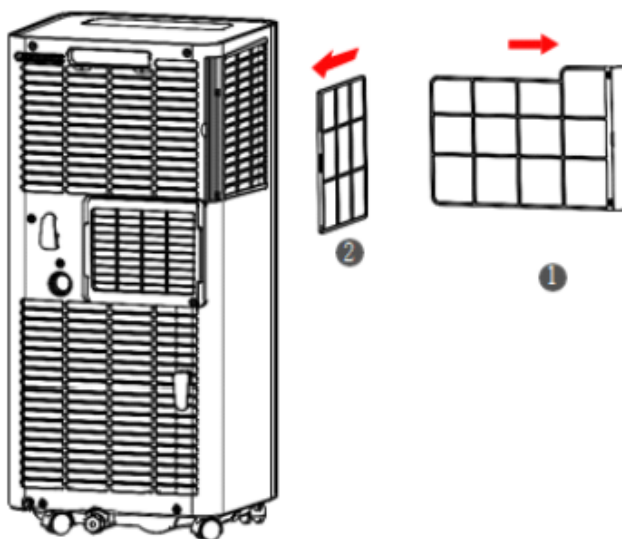

Air Conditioning Cleaning

Clean the surface of the unit with a damp cloth. Then dry with a cloth or similar.

WARNING: Do not use chemical solvents (such as benzene or alcohol) to clean the surface of the unit; doing so will scratch, damage, and even deform the entire case.

SPECIFICATIONS

Weight	24 kg
Product Dimension (L x W x H)	325 x 295 x 702 mm
Cooling Capacity	2640W
Current	5.0A
Power Input	1050W
Indoor Air Volume	360m ³ /h
Max pressure	Discharge 3.8MPa
	Suction 1.3MPa
Sound Power	Inside 65dB(A)
	Outside -
Rated Voltage	220-240V ~
Rated Frequency	50 Hz
Refrigerant/Charge	R290/210g

Disposal

	This marking indicates that this appliance should not be disposed with other house-hold wastes. To prevent possible harm to the environment or human health from uncontrolled waste disposal, recycle it responsibly to promote the sustainable reuse of material resources.
---	--

TROUBLESHOOTING

Error Messages

E1	Coil temperature sensor error
E2	Indoor temperature sensor error
E4	Frost protection function: If the coil temperature is too low, the appliance is switched off. If the temperature rises above 8 °C, the protection is released and the previous operating state is restored.

Problem	Check	Possible solution
The appliance does not respond.	Is it switched on?	Push the plug into the wall outlet.
	Is the fuse or switch circuit breaker off?	Change the fuse or turn on the device.
	The "FULL" light is on.	Discharge the water condensed from the base of water outlet.
Cooling efficiency is not good	Is the air inlet/air outlet blocked?	Remove the object or blockage.
	Are the air filters dirty?	Clean the air filters.
	Is the fan speed too low?	Adjust the fan speed.
	Is there any other source of heat in the room?	Remove the heat source or find a more suitable location for the air conditioner.
Too much noise and Vibrations	The liquid (refrigerant) is circulating on the inside.	This is normal.
	Is it level?	Place it on a level surface.

The appliance starts frequently.	Direct sunlight	Close the curtains.
	Doors and windows are open or there are too many people or heat sources in the room.	Close doors and windows and remove heat sources.
	The filters are very dirty.	Clean or replace the filters.
	Air inlet or air outlet openings are blocked.	Remove the dirt.
Condensed water comes out when the unit is moved	Is the base tank almost full?	Drain the condensed water from the water outlet base.

Need more information?

We hope that this user guide has given you the assistance needed for a simple set-up.

For the most up-to-date guide for your product, as well as any additional assistance you may require, head online to **help.kogan.com**

kogan.com