

Aurora Industrial Laundry Dispenser

Single Air Pump Version

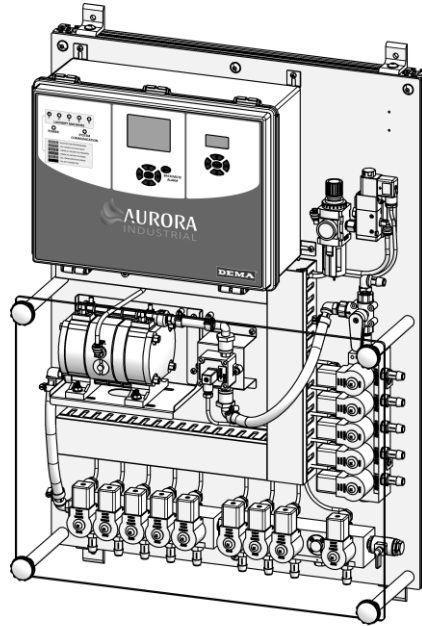

Overview

The Aurora Industrial Laundry Dispenser is designed to automatically dispense chemicals to a commercial laundry machine. The system can support up to 8 chemicals and 5 laundry machines. The system is powered with the proven Aurora electronics platform.

Warnings



All installations must conform to local plumbing codes and use approved backflow prevention devices. A pressure indicating tee is to be installed with existing faucets according to local plumbing codes in the state of Wisconsin and any other state that requires the use of a pressure indicating tee.



ALWAYS WEAR PROTECTIVE CLOTHING AND EYEWEAR WHEN WORKING WITH CHEMICAL PRODUCTS.



Installation of DEMA products must meet all applicable electrical codes and regulations established by national, city, county, parish, provincial or other agencies. It is possible that electrical codes and regulations require that a certified electrical contractor or engineer perform the electrical installation. For questions, contact a certified electrician.

Operational Requirements

- Main Power: 115/230VAC 50/60Hz
- Trigger Signal: 20-250VAC
- Solenoid valve operating voltage: 24VDC
- Incoming Air Pressure Range: 75-125 psi

Overall Size and Mounting Dimensions

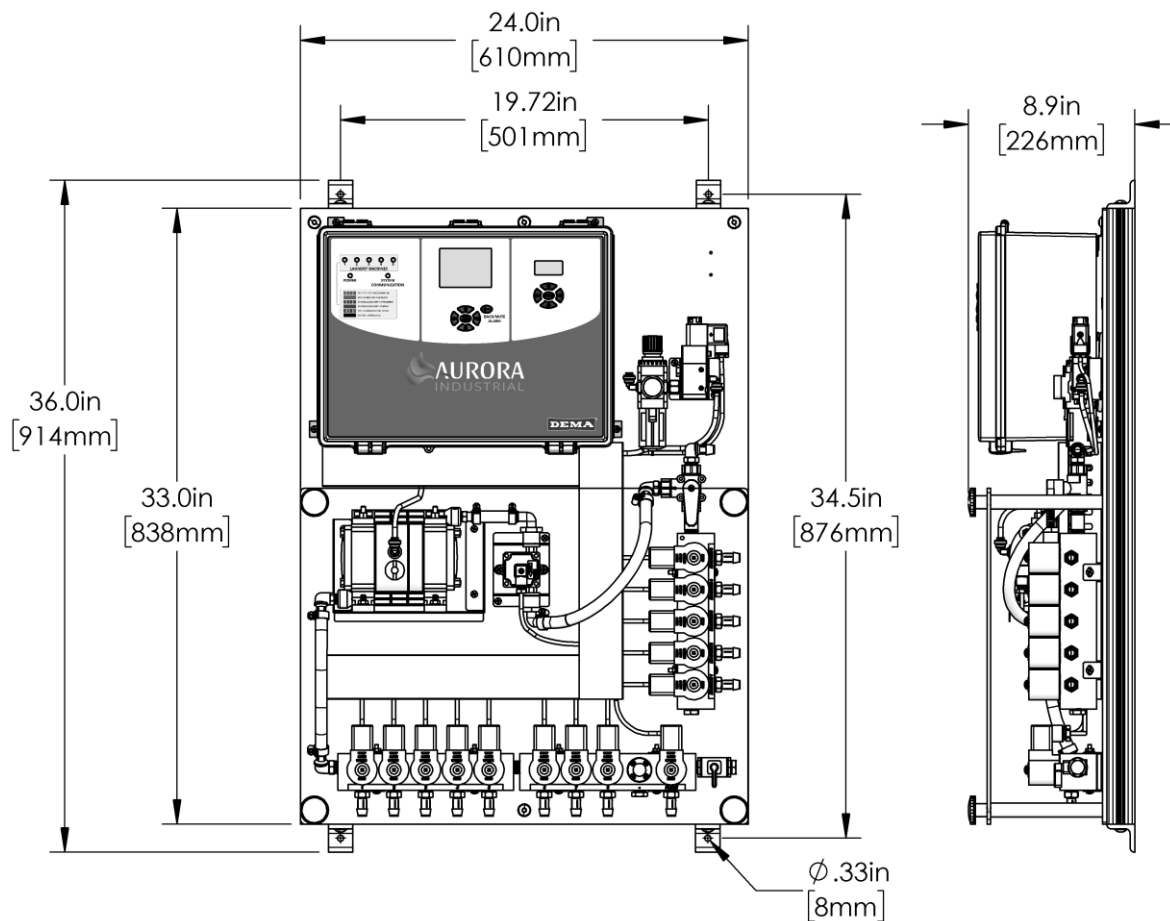

Installation

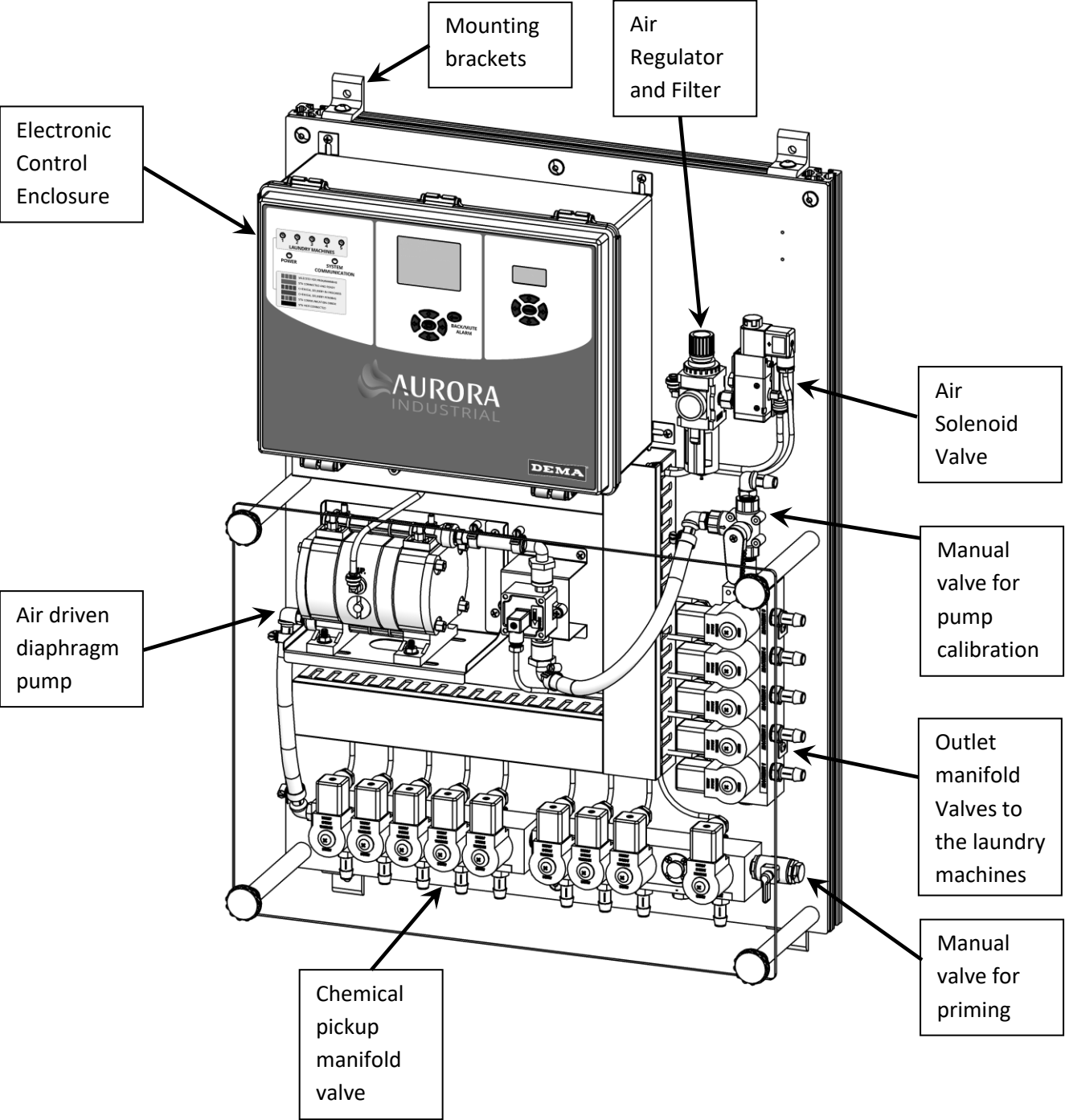

1. Survey the application site and determine the best location for the Aurora Industrial Laundry Dispenser to be mounted. Consider the following:
 - a. Wall or mounting surface should be clear of pipes and other hardware to accommodate the system.
 - b. Wall outlet for main power - The system is set up to be plugged into a 120VAC wall outlet.
 - c. Proximity to chemical containers - The system should be relatively close to the chemicals that will be pumped and delivered to the laundry machines, the closer the better. It is recommended that the chemical pickup tubing does not exceed 25 feet.
 - d. Proximity to laundry machines - The discharge tubing distance should not exceed 150 feet.
 - e. Proximity to compressed air line - The system requires a minimum of 75 psi compressed air to provide reliable operation.
2. Mount the Aurora Industrial to a wall or secured vertical surface. There are four mounting brackets that are used to mount to wall.
 - a. The center line dimensions for the brackets are shown on page 2.
 - b. Use appropriate screws for the wall substrate material. Anchors may be required.
3. Connect main power.
 - a. Connect power cord to the main power socket on the side of the control enclosure of the Aurora Industrial.
 - b. Connect the 120VAC plug into a 120VAC power outlet.
4. Connect the compressed air using ¼" OD LDPE tubing.
 - a. Supplied air pressure should be 75-125 psi.
 - b. Air regulator is preset at 50 psi.
5. Install a water reservoir that will be used for flushing the chemicals to the laundry machine.
 - a. Water reservoir will need a float valve to maintain water level.
 - b. Water reservoir should have a capacity of 10 gallons.
 - c. There is a solenoid valve on with the chemical pickup valves that is used for picking up the flush water.
 - d. The tubing connection is a ½" barb suitable for ½" ID tubing.
6. Connect and run tubing from the outlet valves to each laundry machine.
 - a. There are 5 valves for 5 laundry machines.
 - b. Each valve uses a ½" barb connection for ½" ID tubing.
7. Connect the chemical pickup tubes to each chemical valve.
 - a. There are 8 chemical valves, allowing for up to 8 different chemicals.
 - b. Pickup tubes will run from chemical container to the ½" barb on the chemical pickup manifold valve.
8. Calibrate the chemical pump for each chemical.
 - a. A graduated cylinder that can hold up to 2000 ml and a 4 foot piece of ½" ID tubing will be needed.
 - b. Connect a piece of ½" ID tubing to the manual valve for pump calibration. The tube should be long enough to point towards a drain and also to fill a graduated cylinder.
 - c. Turn on the power to the Aurora Industrial.
 - d. Using the Pro Access, go into programming and run the calibration procedure. There will be step by step prompts for the complete procedure.
9. See the Pro Access Module instruction sheet (I-1226) for additional programming.

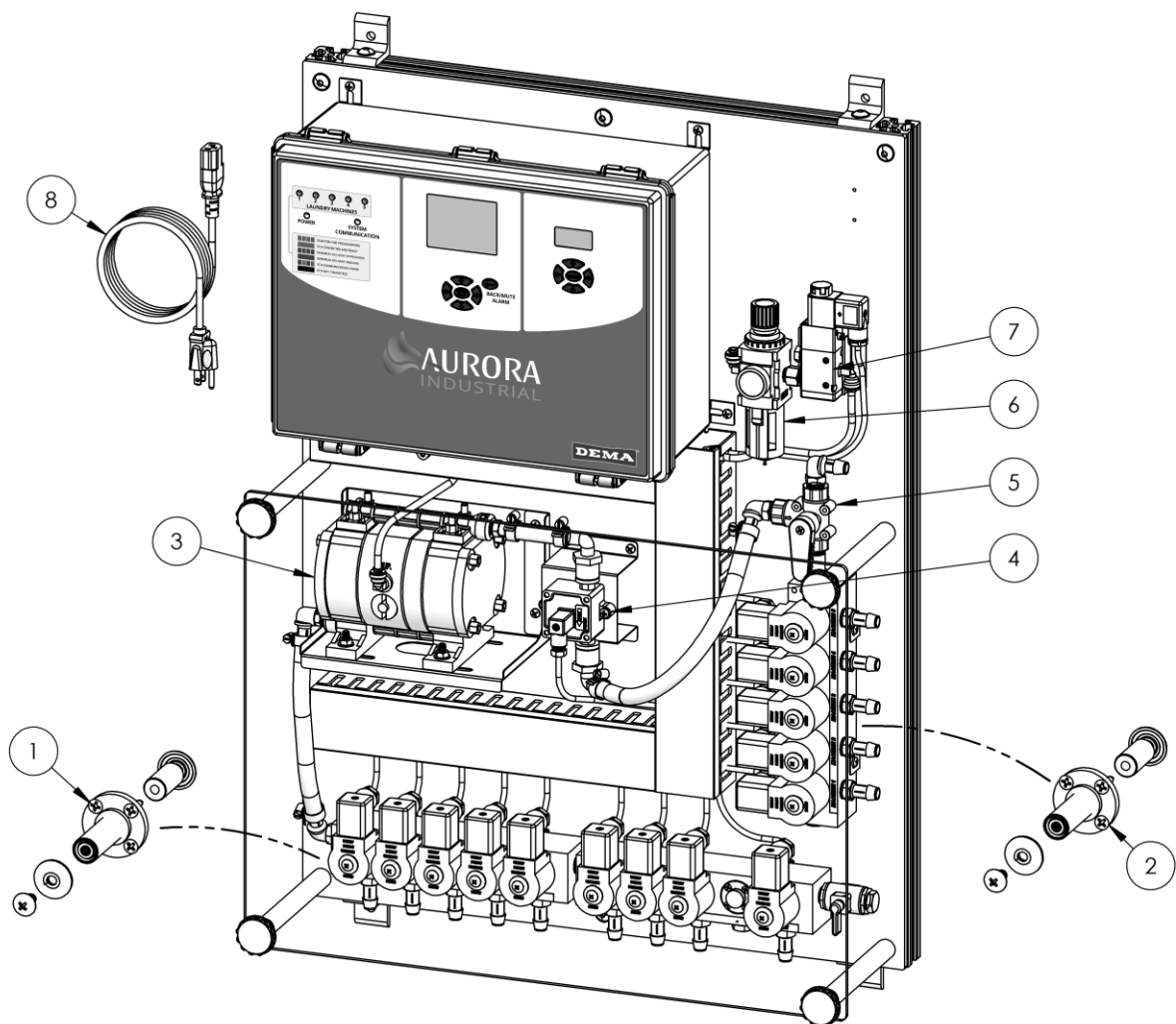

Replacement Parts		
Item No.	DEMA Part Number	Description
1	86.100.59	Valve Operator Kit - Chemical Inlet
2	86.100.60	Valve Operator Kit - Machine Outlet
3	86.100.61	Air Diaphragm Pump Kit - Iwaki
4	86.100.62	Flow Meter Kit
5	86.100.63	3 Way Manual Priming Valve
6	86.100.64	Air Regulator and Filter Kit
7	86.100.65	Air Solenoid Valve Kit
8	84.440.3	Power Cord

Service Kits & Replacement Parts

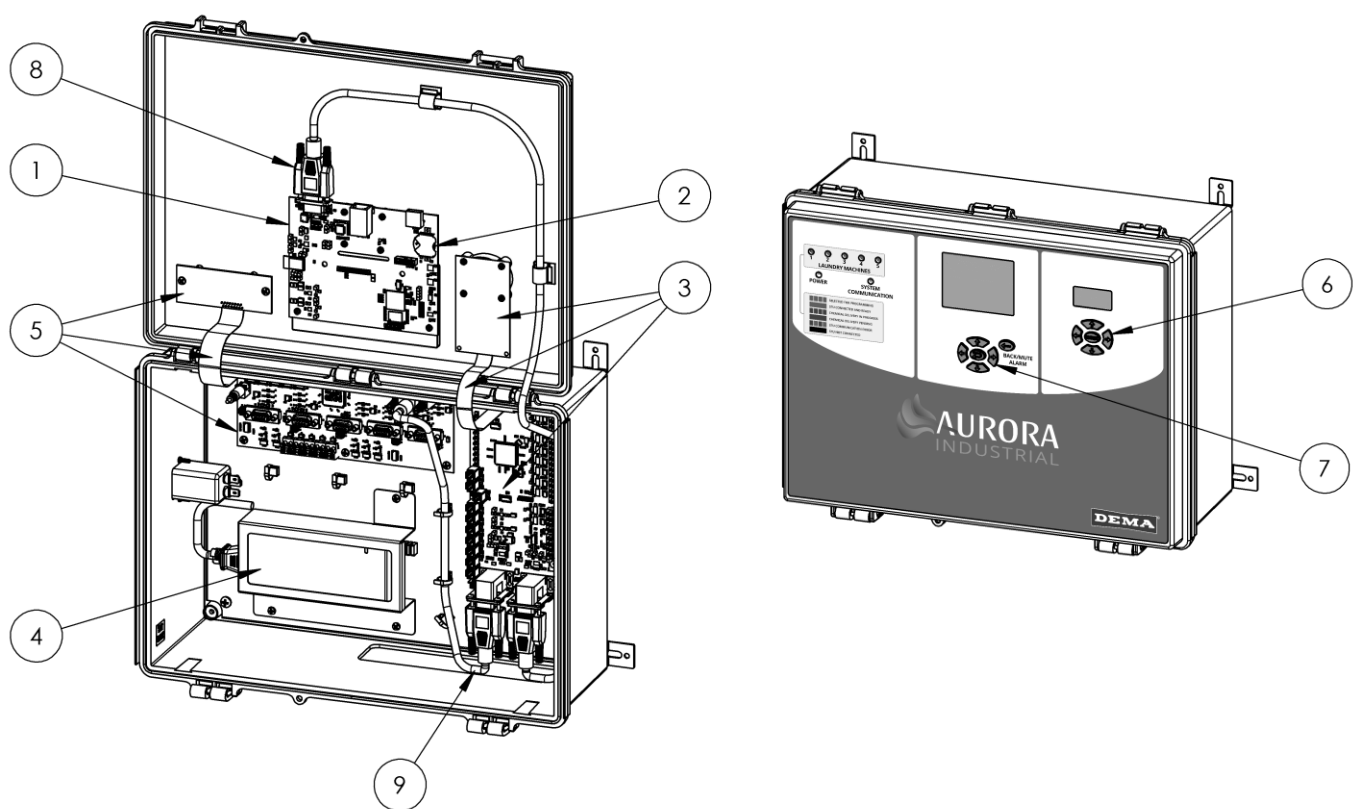

Replacement Parts		
Item No.	DEMA Part Number	Description
1	86.100.66	Pro Access Control Board Kit w/Display
2	80.99	CR2032 Coin Cell Battery
3	86.100.67	Aurora Pump Driver Board Kit
4	86.100.14	Power Supply Kit
5	86.100.68	Aurora Multi Machine Control Board Kit
6	81.147.1	Aurora Keypad
7	84.423.1	Pro Access Keypad
8	84.412.6	DB9 Serial Cable F-F
9	84.411.6	DB9 Serial Cable M-M

Wire Diagram

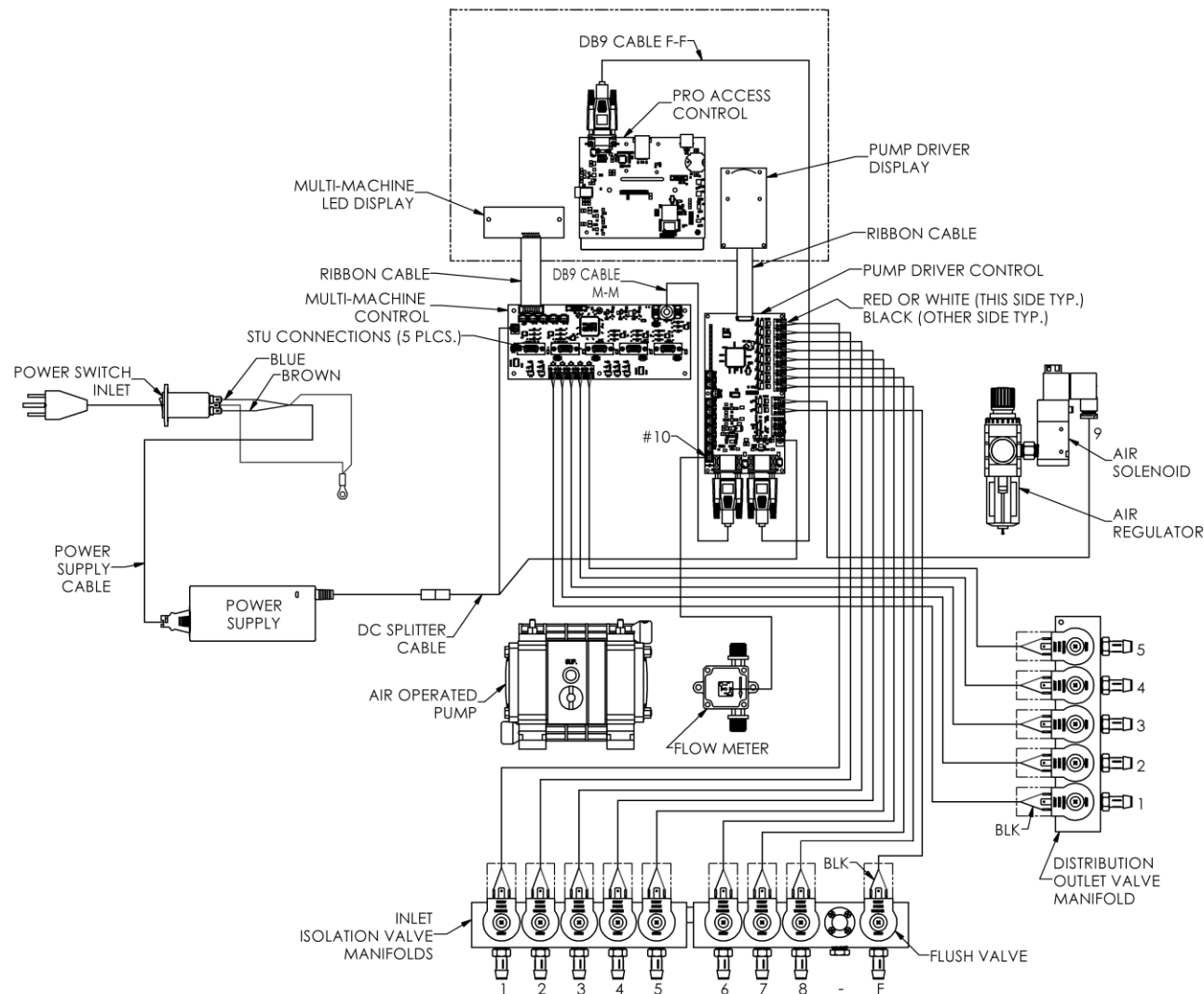

Warranty

Merchandise Returns

No merchandise will be returned for credit without DEMA'S written permission. Returned merchandise authorization number is required in advance of return.

Product Warranty

DEMA products are warranted against defective material and workmanship under normal use and service for one year from the date of manufacture. This limited warranty does not apply to any products that have a normal life shorter than one year or failure and damage caused by chemicals, corrosion, physical abuse, or misapplication. Rubber and synthetic rubber parts such as "O"-rings, diaphragms, PVC tubing, and gaskets are considered expendable and are not covered under warranty. This warranty is extended only to the original buyer of DEMA products. If products are altered or repaired without prior approval of DEMA, this warranty is void. Defective units or parts should be returned to the factory with transportation prepaid. If inspection shows them to be defective, they will be repaired or replaced without charge, F.O.B. factory. DEMA assumes no liability for damages. Return merchandise authorization number must be granted in advance of returned units for repair or replacement. (See "Merchandise Returns" above).