



# BARISTA <sup>TS</sup> <sup>T</sup> SMART <sup>®</sup>

Bedienungsanleitung / Operating Instructions / Mode d'emploi  
Gebruiksaanwijzing / Istruzioni per l'uso / Manual de instrucciones  
Betjeningsvejledning / Bruksanvisning / Bruksanvisning  
Руководство по эксплуатации / Instrukcja obsługi  
Naudojimo instrukcija

 **Bluetooth<sup>®</sup>**



DE

GB

FR

NL

IT

ES

DK

SE

NO

RU

PL

LT





## Table of contents

|          |   |           |
|----------|---|-----------|
| <b>1</b> | <b>Overview of the appliance .....</b>                        | <b>37</b> |
| 1.1      | The appliance at a glance.....                                | 37        |
| 1.2      | The control panel at a glance.....                            | 38        |
| <b>2</b> | <b>For your safety.....</b>                                   | <b>39</b> |
| 2.1      | Proper use.....   | 39        |
| 2.2      | Danger from electric current.....                             | 39        |
| 2.3      | Risk of burns and scalds.....                                 | 40        |
| 2.4      | General safety.....   | 40        |
| <b>3</b> | <b>First steps.....</b>                                       | <b>40</b> |
| 3.1      | Unpacking the appliance.....                                  | 40        |
| 3.2      | Checking the delivery contents.....                           | 41        |
| 3.3      | Installing the appliance.....                                 | 41        |
| 3.4      | Connecting the appliance.....                                 | 41        |
| 3.5      | Switching on the appliance for the first time.....            | 41        |
| 3.6      | Installing the <i>Melitta-Connect-App</i> .....               | 42        |
| <b>4</b> | <b>Basic operation .....</b>                                  | <b>42</b> |
| 4.1      | Switching the appliance on and off .....                      | 42        |
| 4.2      | Using the control panel .....                                 | 43        |
| 4.3      | Navigating in the menu .....                                  | 43        |
| 4.4      | Establishing the Bluetooth connection .....                   | 44        |
| 4.5      | Filling with coffee beans and using Bean Select.....          | 45        |
| 4.6      | Using ground coffee.....                                      | 46        |
| 4.7      | Filling with water.....                                       | 46        |
| 4.8      | Adjusting the outlet .....                                    | 47        |
| 4.9      | Using milk .....  | 47        |
| 4.10     | Emptying the drip tray and coffee grounds container .....     | 47        |
| <b>5</b> | <b>Preparing beverages .....</b>                              | <b>48</b> |
| 5.1      | Preparing espresso and café crème.....                        | 48        |
| 5.2      | Preparing cappuccino and latte macchiato.....                 | 48        |
| 5.3      | Preparing milk froth and warm milk .....                      | 49        |
| 5.4      | Preparing hot water .....                                     | 49        |
| 5.5      | Preparing beverages with recipes (BARISTA TS model only)..... | 49        |
| 5.6      | Changing beverage settings before and during preparation..... | 49        |
| 5.7      | Stopping beverage preparation .....                           | 50        |
| 5.8      | Preparing two beverages simultaneously.....                   | 50        |



|            |   |           |
|------------|---|-----------|
| <b>6</b>   | <b>Permanently changing beverage settings .....</b>                           | <b>50</b> |
| 6.1        | Selecting recipes .....   | 50        |
| 6.2        | Changing default settings.....  | 51        |
| <b>7</b>   | <b>Personal settings – "My Coffee" .....</b>                                  | <b>51</b> |
| 7.1        | Editing personal user profiles .....  | 51        |
| 7.2        | Selecting/changing personal settings.....                                     | 52        |
| 7.3        | Preparing beverages with personal settings.....                               | 52        |
| <b>8</b>   | <b>Changing basic settings .....</b>  | <b>53</b> |
| 8.1        | Setting the language .....  | 53        |
| 8.2        | Setting the time .....  | 53        |
| 8.3        | Activating/deactivating Auto Bean Select (BARISTA TS model only) ..           | 53        |
| 8.4        | Setting energy save mode .....  | 53        |
| 8.5        | Setting Auto OFF .....  | 54        |
| 8.6        | Activating/deactivating rinsing .....   | 54        |
| 8.7        | Resetting the appliance to the factory settings .....                         | 55        |
| <b>8.8</b> | <b>Statistics and System menu.....</b>  | <b>55</b> |
| 8.9        | Setting the grinding fineness .....   | 55        |
| 8.10       | Converting the connection for the milk hose<br>(depending on the model) ..... | 56        |
| <b>9</b>   | <b>Care and maintenance .....</b>   | <b>56</b> |
| 9.1        | General cleaning.....   | 56        |
| 9.2        | Rinsing the coffee system .....   | 56        |
| 9.3        | Cleaning the brewing unit .....   | 57        |
| 9.4        | "Easy Cleaning" programme .....   | 57        |
| 9.5        | "Cleaning milk system" programme.....   | 58        |
| 9.6        | "Cleaning coffee system" programme.....                                       | 59        |
| 9.7        | "Descaling" programme.....  | 59        |
| 9.8        | Setting the water hardness.....   | 60        |
| 9.9        | Using a water filter .....  | 60        |
| <b>10</b>  | <b>Transport, storage and disposal .....</b>                                  | <b>62</b> |
| 10.1       | Venting the appliance .....   | 62        |
| 10.2       | Transporting the appliance .....  | 62        |
| 10.3       | Disposing of the appliance .....  | 62        |
| <b>11</b>  | <b>Technical data.....</b>  | <b>62</b> |
| <b>12</b>  | <b>Troubleshooting.....</b>   | <b>63</b> |



## 1 Overview of the appliance

### 1.1 The appliance at a glance

GB

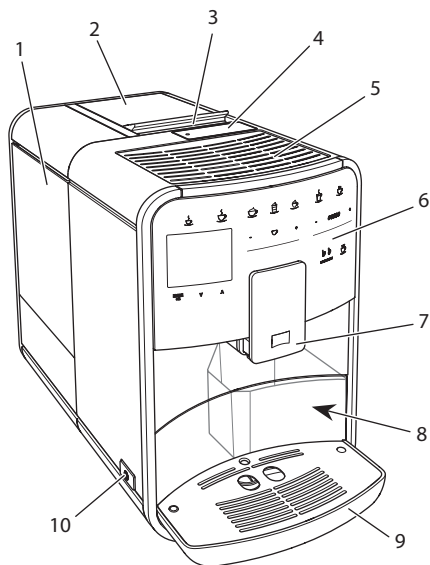

Fig. 1: Front left of the appliance

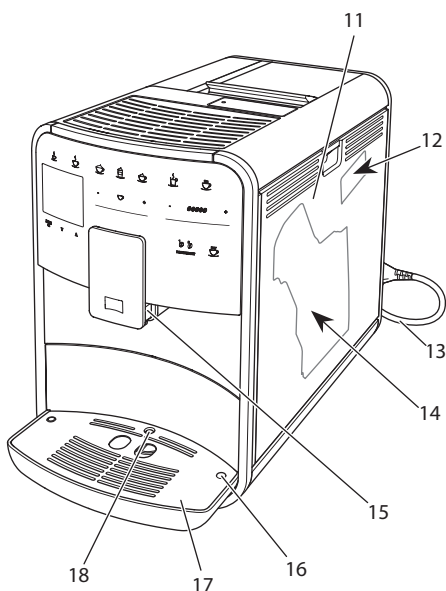

Fig. 2: Front right of the appliance

- 1 Water tank
- 2 2-chamber bean container
- 3 "BEAN SELECT" slider  
(BARISTA T model only)  
For "BEAN SELECT" in BARISTA TS,  
see item number 30.
- 4 Ground coffee chute
- 5 Cup tray with stainless steel plate  
(depending on the model)
- 6 Control panel
- 7 Height-adjustable outlet with 2 coffee  
nozzles, 2 milk nozzles,  
1 hot water nozzle, cup illumination  
(in BARISTA TS model only)
- 8 Coffee grounds container (inner)
- 9 Drip tray
- 10 ON/OFF button
- 11 Cover
- 12 "Grinding fineness adjustment" lever  
(behind the cover)
- 13 Power cable with cable insert compart-  
ment
- 14 Brewing unit (behind the cover)
- 15 Milk hose connection at the outlet
- 16 Milk hose connection to the drip tray
- 17 Cup plate
- 18 Float



## 1.2 The control panel at a glance

GB

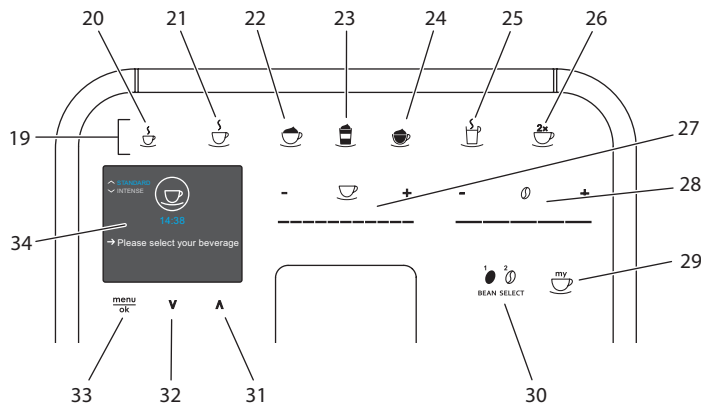

Fig. 3: Control panel

| Item | Designation                       | Function  |
|------|-----------------------------------|---|
| 19   | Direct keys                       | Preparing beverages   |
| 20   | Espresso                          | Preparing espresso  |
| 21   | Café crème                        | Preparing café crème  |
| 22   | Cappuccino                        | Preparing cappuccino  |
| 23   | Latte macchiato                   | Preparing latte macchiato   |
| 24   | Milk froth/Warm milk              | Preparing milk froth or warm milk   |
| 25   | Hot water                         | Preparing hot water   |
| 26   | 2 cups                            | Two-cup dispensing  |
| 27   | Beverage quantity slider          | Setting the beverage quantity   |
| 28   | Coffee strength slider            | Setting the coffee strength   |
| 29   | My Coffee/Recipes (in BARISTA TS) | Selecting personal settings for beverages or preparing beverages with recipes.                      |
|      | My Coffee (in BARISTA T)          | Selecting personal settings for beverages.  |
| 30   | BEAN SELECT                       | Selecting the bean type (BARISTA TS model only). For "BEAN SELECT" in BARISTA T, see item number 3. |
| 31   | Up arrow button                   | Navigating up in the menu or set the <i>STANDARD</i> coffee flavour                                 |
| 32   | Down arrow button                 | Navigating down in the menu or set the <i>INTENSE</i> coffee flavour                                |
| 33   | menu/ok                           | Calling up the menu or confirming inputs  |
| 34   | Display                           | Display of current menus and messages<br>Example: Ready symbol                                      |





## Dear Customer,

Thank you for purchasing the BARISTA Smart® fully automatic coffee maker.

The operating instructions will help you discover the diverse options offered by the appliance and enjoy your coffee to the full.

Read through the operating instructions carefully. This helps avoid personal injury and material damage. Store the operating instructions carefully. If you pass on the appliance, include the operating instructions with it.

Melitta accepts no liability for damage caused by failure to observe the operating instructions.

If you require further information or have any questions on the appliance, contact Melitta or visit our website at: [www.international.melitta.de](http://www.international.melitta.de)

We hope you enjoy using your appliance.

## 2 For your safety

**C** The appliance conforms to the relevant European directives and has been built using the latest technology. Nevertheless, some residual dangers remain.

Observe the safety instructions to avoid dangers. Melitta accepts no liability for damage caused by failure to observe the safety instructions.

### 2.1 Proper use

The appliance is used to prepare coffee beverages made from coffee beans or ground coffee, and to heat milk and water.

The appliance is intended for use in private households.

Any other use is regarded as improper and may lead to personal injury and material damage. Melitta accepts no liability for damage that arises due to improper use of the appliance.

### 2.2 Danger from electric current

If the appliance or the power cable is damaged, there is a risk of fatal electric shock.

Observe the following safety instructions to avoid danger from electric current:

- Do not use a damaged power cable.
- A damaged power cable may only be replaced by the manufacturer or its customer service or service partner.
- Do not open any covers firmly screwed onto the appliance housing.
- Only use the appliance when it is in a technically flawless condition.
- A defective appliance may only be repaired by an authorised workshop. Do not repair the appliance yourself.
- Do not make any changes to the appliance, its components or its accessories.
- Do not immerse the appliance in water.
- Do not let the power cable come into contact with water.



## 2.3 Risk of burns and scalds

Escaping fluids and steam may be very hot. Parts of the appliance can also become very hot. Observe the following safety instructions to avoid scalds and burns:

- Avoid escaping fluids and steam coming into contact with the skin.
- Do not touch any nozzles on the outlet during operation.

## 2.4 General safety

Observe the following safety instructions to avoid personal injury and material damage:

- Do not operate the appliance in a cabinet or similar.
- Do not reach into the interior of the appliance during operation.
- Keep the appliance and its power cable out of the reach of children under 8 years of age.
- This appliance may be used by children over 8 years of age and by persons with reduced physical, sensory or mental capabilities or a lack of experience and knowledge if they are supervised or have been instructed in using the appliance safely and understand the resulting risks.

- Children must not play with the appliance. Cleaning and maintenance must not be undertaken by children younger than 8 years of age. Children over 8 years of age must be supervised during cleaning and maintenance.
- If the appliance is remotely controlled by a mobile terminal, make sure there are no children in the immediate vicinity of the appliance and that a cup has been placed underneath.
- Disconnect the appliance from the power supply when left unsupervised for a long time.
- The appliance must not be operated at altitudes over 2,000 m.
- Please observe the instructions in the corresponding section when cleaning the appliance and its components („Care and maintenance“ on page 56).

## 3 First steps

This chapter describes how to prepare your appliance for use.

### 3.1 Unpacking the appliance

#### **CAUTION**

**Contact with cleaning agents can lead to eye and skin irritation.**

- Keep the supplied cleaning agents out of the reach of children.
- Unpack the appliance. Remove the packaging material, the adhesive



strips and the protective films from the appliance.

- Keep the packaging material for transport and any return shipments.

#### Information

The appliance may contain traces of coffee and water. The appliance has been tested in the factory to ensure that it functions perfectly.

## 3.2 Checking the delivery contents

Check the completeness of delivery using the following list. If parts are missing, contact your retailer.

- Coffee spoon with screw-in aid for the water filter
- Plastic milk container or thermal milk container each with milk hose or just the milk hose (depending on the model)
- Stainless steel plate for cup tray (depending on the model)
- Coffee system cleaning agent
- Milk system cleaning agent
- Water filter
- Test strip for determining the water hardness.

## 3.3 Installing the appliance

Observe the following instructions:

- Do not install the appliance in damp rooms.
- Install the appliance on a stable, flat and dry surface.
- Do not install the appliance in the vicinity of sinks or the like.
- Do not install the appliance on hot surfaces.
- Install the appliance at a sufficient distance (approx. 10 cm) from the wall and other objects. The space above the appliance should be at least 20 cm.
- Route the power cable so it cannot be damaged by edges or hot surfaces.

## 3.4 Connecting the appliance

Observe the following instructions:

- Check that the supply voltage matches the operating voltage specified in the technical data (see the , page 62 table).
- Only connect the appliance to a properly installed earthing contact socket. If in doubt, consult a specialist electrician.
- The socket must have a fuse of at least 10 A.

## 3.5 Switching on the appliance for the first time

During initial start-up, the language, the time and the water hardness can be set. The settings can be changed at a later point in time (see chapter 8, page 53 and section 9.8, page 60).

Use the enclosed test strip to determine the water hardness. Observe the instructions on the test strip packaging and in the table *Item*, page 38.

#### Information

We recommend pouring away the first two cups of coffee after initial start-up.

**Requirement:** The appliance has been installed and connected.

1. Place a vessel beneath the outlet.
2. Press the ON/OFF button.
  - » The welcome display appears on the appliance.
  - » The request to carry out the setup appears on the display: *Please set up the machine.*
  - » The "menu/ok" button flashes.
3. Confirm with "menu/ok".
  - » The *Language* menu appears.
4. Select your language with the arrow buttons. Confirm with "menu/ok".
  - » The *Clock* menu appears.
5. Select the hour and the minutes with the arrow buttons. Confirm each setting with "menu/ok".
  - » The *Water hardness* menu appears.



6. Select the determined water hardness range with the arrow buttons or confirm the default value with "menu/ok".
  - » The request *Please refill and insert water tank* appears.
7. Remove the water tank. Rinse out the water tank with clean water. Insert the new water filter (see section „Inserting the water filter“ on page 61). Fill the water tank with fresh water and insert it.
  - » The appliance heats up and performs automatic rinsing.
  - » The ready symbol and the request *Fill beans* appear on the display.
8. Fill coffee beans into the bean container. To do this, read section *Filling with coffee beans and using Bean Select*, page 45.

### 3.6 Installing the Melitta-Connect-App

The appliance can be operated with suitable mobile iOS devices via Bluetooth or with android devices that support Bluetooth. You need the *Melitta-Connect-App* for this. Detailed information at [www.melitta.de](http://www.melitta.de).

The App provides simplified operation of the appliance, convenient management of settings and user profiles, as well as other functions and access to the Smart Service (Service Hotline, appliance data, etc.). The term Smartphone is used to represent Smartphones and Tablets in these operating instructions.

#### Downloading the App

1. Search in the App Store of your Smartphone for the *Melitta-Connect-App*.
2. Install the App on your Smartphone.

## 4 Basic operation

This chapter describes basic operating steps for using the appliance on a daily basis.

### 4.1 Switching the appliance on and off

Before switching on after starting up the appliance for the first time, read section 3.5, page 41.

#### Information

- When switched on and off, the appliance performs automatic rinsing.
- During rinsing, rinsing water is also conducted into the drip tray.
- The automatic switch-off rinsing can be switched on or off in the *Settings* menu.

#### Switching on the appliance

1. Place a vessel beneath the outlet.
2. Press the ON/OFF button.
  - » The welcome display appears on the appliance.
  - » The appliance heats up and performs automatic rinsing.
  - » The appliance is ready for operation.

#### Switching off the appliance

1. Place a vessel beneath the outlet.
2. Press the ON/OFF button.
  - » The appliance performs automatic rinsing.
  - » The appliance switches off.

#### Information

- The appliance switches off automatically when it is not operated for a long time. Automatic rinsing is also carried out in this case.
- The off time can be set in the *Auto OFF* menu, see section 8.5, page 54.
- If no beverage has been prepared since switching on or if the water tank is empty, no rinsing takes place.



## 4.2 Using the control panel

The essential functions can be accessed using the control panel.

Press the button with a fingertip. The control panel does not react when touched with a pen or other objects.

Only those buttons that can be used in the appliance's current status light up.

Use the following actions to operate the control panel:



### Brief press

Briefly press a button to select a function.



### Long press

Press a button for longer than 2 seconds to select a second function that may be available.



### Pressing "+" or "-"

Press "+" or "-" to increase or reduce the current value. Hold a button down to change the value continuously.



### Pressing the slider

Press the slider to select a value.



### Pulling the slider

Press and pull the slider to increase or reduce the current value.

## 4.3 Navigating in the menu

To set individual beverages and for maintenance and care, you must call up the menu on the display and navigate in the menu.

Observe the instructions on the display.



Fig. 6: Example: Display with buttons

Use the following options to navigate in the menu:

### Calling up the menu and confirming the selection



Press the "menu/ok" button for longer than 2 seconds to call up the menu.

Press the "menu/ok" button briefly to confirm your selection.

### Navigating in the menu



Press the arrow buttons to navigate down or up in the menu. Hold down an arrow button to quickly switch to the menu options.

### Exiting a menu



Select the *Exit* command with the arrow buttons and confirm with "menu/ok" to exit a menu. Exit sub-menus, which only display information and in which you do not carry out any settings, with "menu/ok".

### Calling up submenus

Some of the appliance's functions are reached by calling up several submenus in succession.

Submenus are always called up in a similar way. Navigation to the *Descaling* programme is described here as an example.

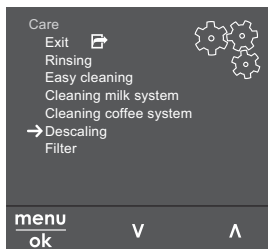

Fig. 7: Navigating to the *Descaling* programme

1. Press the "menu/ok" button for 2 seconds.  
» The menu appears on the display.
2. Use the arrow buttons to select *Care* and confirm with "menu/ok".
3. Use the arrow buttons to select *Descaling* and confirm with "menu/ok".

The selection of functions is always shown in shortened form in these operating instructions:

- Navigate to the *Care > Descaling* menu.

## 4.4 Establishing the Bluetooth connection

Bluetooth connection is required to operate the appliance by means of a Smartphone.

### Connecting the appliance for the first time

#### Requirements:

- The appliance is switched on.
- The *Melitta-Connect-App* is installed and open on the Smartphone (see section *Installing the Melitta-Connect-App*, page 42).
- The Smartphone is in the reception range (max. 5 - 10 m away) of the appliance.
- The Smartphone supports Bluetooth.

- The Bluetooth function is activated on the Smartphone.
- The appliance is not connected to any other Smartphone via Bluetooth.
- The appliance is displayed on the Smartphone.

1. Press the "menu/ok" button for 2 seconds on the appliance.  
» The menu appears on the display.
2. Use the arrow buttons to select *Bluetooth* and confirm with "menu/ok".
3. Select *Connect* on the appliance.
4. Select *Connect on the Smartphone* and follow the instructions of the App.  
» The appliance is connected to the Smartphone.
5. Select the *Exit* command to exit the menu.

#### Information

- If a connection between the appliance and the Smartphone is not established within 1 minute, the appliance switches to the ready to operate display.
- Only one user can be connected to the appliance via Bluetooth. If there is a change of user, the previous user must disconnect the Bluetooth connection by closing the App. Only then can the new user connect to the appliance.
- Resetting the appliance to the factory settings deletes all Bluetooth connections.

### Re-connecting the appliance to the Smartphone

#### Requirements:

- The appliance is switched on.
  - The appliance has already been connected to the Smartphone.
  - No other user is currently connected to the appliance.
1. Open the App on the Smartphone.  
» The appliance automatically connects to the Smartphone via Bluetooth.



## 4.5 Filling with coffee beans and using Bean Select

Roasted coffee beans lose their aroma. Only fill the bean container with as many coffee beans as will be consumed over the next 3–4 days.

The 2-chamber bean container enables the use of two different types of coffee for different coffee specialities. For example, fill one chamber with espresso beans and the other with café crème beans.

### ATTENTION

**The use of unsuitable types of coffee can lead to clogging of the grinder.**

- Do not use freeze-dried or caramelised coffee beans.
- Do not pour ground coffee into the bean container.

### Auto Bean Select, BARISTA TS model

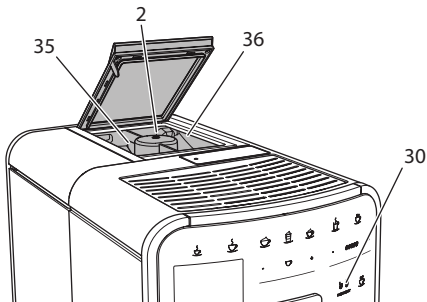

Fig. 8: BARISTA TS 2-chamber bean container

Auto Bean Select ensures that the best coffee beans are automatically selected for various coffee specialities. Espresso-based beverages take their coffee beans from left bean chamber 1 (35), Café Crème-based beverages take them from right bean chamber 2 (36).

The following table shows the assignment of the bean chambers to the coffee beverages. These settings can be changed (see section 6.2, page 51).

| Bean chamber | Coffee beverage                       |
|--------------|---------------------------------------|
| 1 (35)       | Espresso, cappuccino, latte macchiato |
| 2 (36)       | Café crème                            |

### Information

- The grinder is emptied during each grinding process. Nevertheless, minimal coffee type mixing may occur.
- Grinding when empty causes a different type of noise and is normal.

### Manual Bean Select, BARISTA T

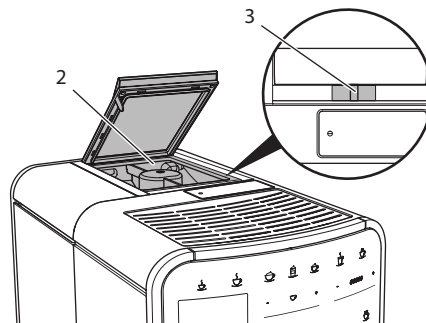

Fig. 9: BARISTA T 2-chamber bean container

Using the "BEAN SELECT" slider (3), you can switch between the bean chambers (2).

### CAUTION

**When switching bean chambers in the BARISTA T, a residual amount of coffee beans remains in the grinder. The first two coffee beverages after switching to decaffeinated beans may still contain caffeinated coffee. This may affect the health of people with caffeine intolerance.**

- Persons with caffeine intolerance should only consume the third coffee beverage after switching over.

### Information

- When the slider is in the centre position, no coffee beans enter the grinder.



### Filling with coffee beans

1. Open the lid of the 2-chamber bean container (2).
2. Fill coffee beans into the bean chambers.
3. Close the lid of the 2-chamber bean container.

The "BEAN SELECT" button (30) (BARISTA TS model) or the "Bean Select" slider (3) (BARISTA T model) can be used to select a bean type prior to preparation (see section 5.6, page 49).

### 4.6 Using ground coffee

Ground coffee may also be used to prepare coffee beverages.

#### ATTENTION

**The use of unsuitable types of coffee can lead to clogging of the brewing unit.**

- Do not use any instant products.
- Fill a maximum of one coffee spoon of ground coffee into the ground coffee chute.

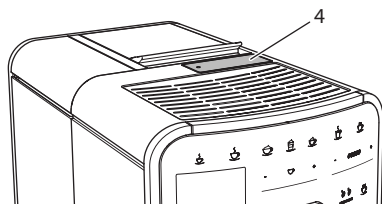

Fig. 10: Ground coffee chute

1. Open the lid of the ground coffee chute (4).
2. Use the enclosed coffee spoon for dosing.  
Fill a maximum of one coffee spoon of ground coffee into the ground coffee chute.
3. Close the lid of the ground coffee chute.
4. Proceed as described in sections 5 to 7.

#### Information

- Two-cup dispensing is not possible when using ground coffee.
- If no coffee is prepared within 3 minutes of opening the ground coffee chute, the appliance switches to operation with coffee beans and the ground coffee is discharged into the coffee grounds container.

### 4.7 Filling with water

Only use fresh, cold water without carbon dioxide for optimum coffee enjoyment. Change the water daily.

#### Information

The quality of the water largely determines the flavour of the coffee. Therefore, use a water filter (see section 9.8, page 60 and section 9.9, page 60).

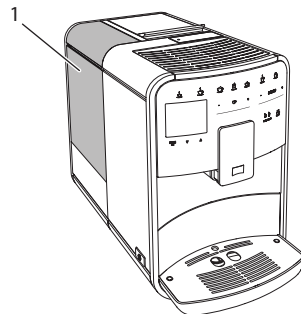

Fig. 11: Water tank

1. Open the lid of the water tank and pull the water tank (1) upwards out of the appliance by the handle.
2. Fill the water tank with water.  
Note the maximum capacity of 1.8 litres.
3. Insert the water tank into the appliance from above and close the lid.



## 4.8 Adjusting the outlet

The outlet (7) is height-adjustable. Set the greatest possible distance between the outlet and the vessel. Depending on the vessel, push the outlet up or down.

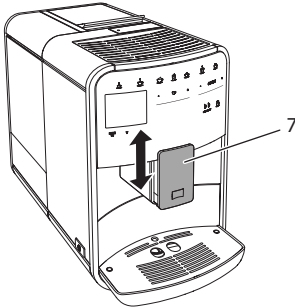

Fig. 12: Height-adjustable outlet

## 4.9 Using milk

Use cooled milk for optimum coffee enjoyment.

Depending on the model, the enclosed milk container or the milk hose and conventional milk packs can be used.

### Connecting the milk container (depending on the model)

Only fill as much milk into the milk container as will be used immediately.

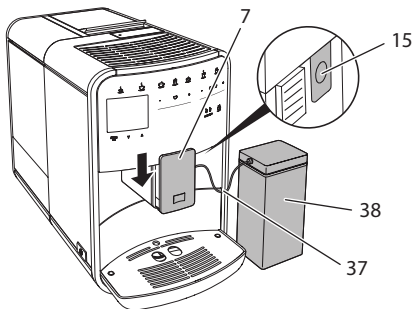

Fig. 13: Connecting the milk container to the appliance (figure can vary)

1. Fill the desired amount of milk into the milk container (38).
2. Push down the outlet (7).
3. Connect the milk hose (37) to the milk container and the connection (15) at the outlet.

### Information

Store the filled milk container in the refrigerator.

### Connecting the milk hose (depending on the model)

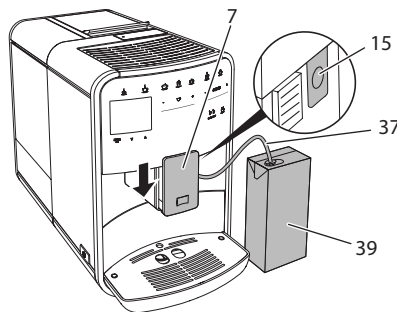

Fig. 14: Connecting the milk hose to the appliance

1. Push down the outlet (7).
2. Connect the milk hose (37) to the connection at the outlet (15).
3. Insert the milk hose into a conventional milk pack (39).

## 4.10 Emptying the drip tray and coffee grounds container

When the drip tray (9) and the coffee grounds container (8) are full, the appliance requests you to empty them. The projecting float (18) also indicates that the drip tray is full. Always empty both containers.



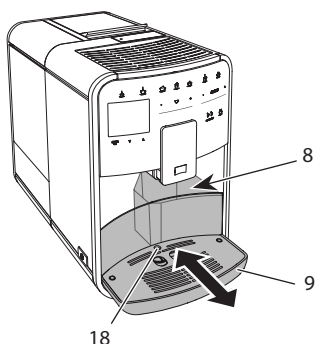

Fig. 15: Drip tray, coffee grounds container and float

1. Pull the drip tray (9) forwards out of the appliance.
2. Remove the coffee grounds container (8) and empty it.
3. Empty the drip tray.
4. Insert the coffee grounds container.
5. Push the drip tray into the appliance up to the stop.

#### Information

The appliance requests you to empty the drip tray and the coffee grounds container after a defined number of beverages have been dispensed. If the containers are emptied while the appliance is switched off, it does not register this process. Therefore, it is possible that you are requested to empty the containers although the drip tray and the coffee grounds container are not yet full.

## 5 Preparing beverages

There are three options for preparing beverages:

- Standard dispensing with direct keys and recipes (BARISTA TS model),
- Preparation with modified beverage settings (see chapter 6, page 50)
- Use of personal settings with the "My Coffee" function (see chapter 7, page 51)

Standard dispensing is described in this section.

Please note:

- The storage containers should contain sufficient amounts of coffee and water. Otherwise the appliance requests you to refill it.
- The appliance does not indicate a lack of milk.
- When selecting a beverage with milk, connect the milk container or a commercially available milk pack.
- The vessels for the beverages should be sufficiently large.
- For beverage preparation, the display must show the ready for use display.
- Beverage dispensing is ended automatically.
- After a beverage preparation with milk, the appliance automatically prompts for the Easy Cleaning programme.

### 5.1 Preparing espresso and café crème



1. Place a vessel beneath the outlet.
2. Press the "Espresso" or "Café Crème" button.
  - » The beverage is prepared.
3. Remove the vessel.

### 5.2 Preparing cappuccino and latte macchiato



**Requirement:** Milk is connected.

1. Place a vessel beneath the outlet.
2. Press the "Cappuccino" or "Latte Macchiato" button.
  - » The beverage is prepared.
  - » The display shows: *Easy Cleaning?* (OK for start).
3. Remove the vessel.
4. Run the Easy Cleaning programme or prepare another beverage and then carry it out, see section 9.4, page 57.





### 5.3 Preparing milk froth and warm milk

The preparation of milk froth and warm milk is similar.



**Requirement:** Milk is connected.

1. Place a vessel beneath the outlet.
2. Press the "Milk froth/milk" button.
  - a) Milk froth = briefly press button
  - b) Warm milk = press the button for longer (2 seconds)
    - » Milk dispensing begins.
    - » The display shows: *Easy Cleaning?* (OK for start).
3. Remove the vessel.
4. Run the Easy Cleaning programme or prepare another beverage and then carry it out, see section 9.4, page 57.

### 5.4 Preparing hot water



1. Place a vessel beneath the outlet.
2. Press the "Hot water" button.
  - » Hot water dispensing begins.
3. Remove the vessel.

### 5.5 Preparing beverages with recipes (BARISTA TS model only)

#### Information

When selecting a recipe with milk, connect the milk container or a commercially available milk pack.

The direct starting of recipes is similar for all beverages. The selection of a lungo is described as an example here.



**Requirement:** The appliance is ready for operation.

1. Place a vessel beneath the outlet.
2. Press the "My Coffee/Recipes" button until the *Recipes* profile appears and confirm with "menu/ok".

- » The recipe selection appears on the display.

Alternatively, you can also press the "My Coffee/Recipes" button for 2 seconds to access the recipe selection directly.

3. Use the arrow buttons to select *Lungo* and confirm with "menu/ok".
4. Remove the vessel.

### 5.6 Changing beverage settings before and during preparation

Beverage settings can be changed before and during beverage preparation.

#### Information

These settings only apply to current beverage preparation.

#### Changing beverage settings before preparation

The bean type, the total beverage quantity, the coffee strength and the coffee flavour can be changed before selecting a beverage.

#### Information

The coffee flavour is set with the Intense aroma function. *STANDARD* and *INTENSE* are available for selection. In the *INTENSE* setting, the brewing time is longer and the coffee has a more intense aroma.

- Select a bean type with the "BEAN Select" button (BARISTA TS model) or with the "Bean Select" slider (BARISTA T model).



- Before selecting a beverage, use the "Beverage quantity" slider to set a beverage quantity.

- Before selecting a beverage, use the "Coffee strength" slider to set the coffee strength.
- Set the coffee flavour with the "arrow buttons".

#### Information

- When preparing latte macchiato and cappuccino, the total beverage quantity is subdivided into a coffee and a milk amount according to a specified ratio.
- If a beverage is not prepared within 1 minute, the appliance switches to the default settings.

### Changing beverage settings during preparation

The beverage quantity and the coffee strength can be changed during beverage preparation.



- During beverage dispensing (coffee or milk), use the "Beverage quantity" slider to set the relevant beverage amount.
- During the grinding process, use the "Coffee strength" slider to set the coffee strength.

## 5.7 Stopping beverage preparation

To stop beverage preparation prematurely, press the selected direct key again.

## 5.8 Preparing two beverages simultaneously



The "2 cups" button is used to prepare two beverages simultaneously. Two-cup dispensing is not possible for the beverages americano, long black, hot water, milk and milk froth. For two-cup dispensing, the appliance carries out two grinding processes.

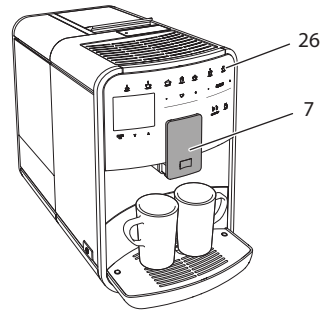

Fig. 16: Two-cup dispensing

1. Place two vessels beneath the outlet (7).
2. Press the "2 cups" button (26).
3. Continue as described for the relevant beverage preparation.

#### Information

- This setting only applies to the next beverage preparation.
- If a beverage is not prepared within 1 minute, the appliance switches to single-cup dispensing.

## 6 Permanently changing beverage settings

The appliance offers further options for preparing coffee specialities. Default recipes can be used or the beverage settings can be permanently changed.

### 6.1 Selecting recipes

Direct keys can be assigned with stored recipes. Pressing the corresponding direct key now uses the recipe.

The following recipes are available:

- **Espresso:** Espresso (standard), ristretto, lungo, espresso doppio, ristretto doppio.
- **Café crème:** Café crème (standard), café crème doppio, americano, americano extra shot, long black, Red Eye\*, Black Eye\*, Dead Eye.\*



- **Cappuccino:** Cappuccino (standard), espresso macchiato, café latte, café au lait, flat white.
- **Latte Macchiato:** Latte macchiato (standard), latte macchiato extra shot, latte macchiato triple shot.

The recipes marked with a \* are only available in the BARISTA TS.

Recipe selection is similar for all beverages. The selection of a ristretto is described as an example here.

**Requirement:** The appliance is ready for operation.

1. Press the "menu/ok" button for 2 seconds.
  - » The menu appears on the display.
2. Navigate to the *Direct keys* > *Espresso* > *Recipes* menu.
3. Use the arrow buttons to select *Ristretto* and confirm with "menu/ok".
4. Repeatedly select the *Exit* command to exit the menu.
  - » The appliance is ready for operation.
  - » The next time an espresso is prepared, the ristretto recipe will be used.

#### Information

- The recipe selection remains valid until it is changed again.
- In the Barista TS, recipes can also be selected directly with the "My Coffee/Recipes" button (see section 5.5, page 49).

## 6.2 Changing default settings

Depending on the beverage, the following default settings can be changed: Coffee amount, amount of froth, milk amount, hot water amount, temperature, beans (BARISTA TS model only), coffee strength and coffee flavour.

Changing the beverage settings is similar for all beverages. Changing the coffee strength for an Espresso is described here as an example.

**Requirement:** The appliance is ready for operation.

1. Press the "menu/ok" button for 2 seconds.
  - » The menu appears on the display.
2. Navigate to the *Direct keys* > *Espresso* > *Coffee strength* menu.
3. Use the arrow buttons to select the desired coffee strength and confirm with "menu/ok".
4. Repeatedly select the *Exit* command to exit the menu.
  - » The appliance is ready for operation.
  - » The selected coffee strength is used the next time an espresso is prepared.

#### Information

The default settings remain valid until they are changed again.

## 7 Personal settings – "My Coffee"

The "My Coffee" function lets you to save personal beverage settings and assign them to a user.

### 7.1 Editing personal user profiles

Up to four user profiles can be used in the BARISTA T and up to eight in the BARISTA TS.

#### Changing the name of a user profile

The names of the user profiles can be changed.

**Requirement:** The appliance is ready for operation.

1. Press the "menu/ok" button for 2 seconds.
  - » The menu appears on the display.
2. Navigate to the *My Coffee* menu.
3. Use the arrow buttons to select a user and confirm with "menu/ok".
4. Use the arrow buttons to select *Change name* and confirm with "menu/ok".

- » The menu for selecting individual characters appears.
- 5. Use the arrow buttons to select individual characters and confirm each with "menu/ok".
- 6. Repeatedly select the *Exit* command to exit the menu.
- » The appliance is ready for operation.

### Activating/deactivating a user profile

Only users whose profile is activated can be used.

**Requirement:** The appliance is ready for operation.

1. Press the "menu/ok" button for 2 seconds.
  - » The menu appears on the display.
2. Navigate to the *My Coffee* menu.
3. Use the arrow buttons to select a user and confirm with "menu/ok".
4. Use the arrow buttons to select *Enabled/disabled* and confirm with "menu/ok".
5. Use the arrow buttons to select *Enabled* or *Disabled* and confirm with "menu/ok".
6. Repeatedly select the *Exit* command to exit the menu.
- » The appliance is ready for operation.

## 7.2 Selecting/changing personal settings

Depending on the beverage, the following settings can be assigned to a user: Recipes, coffee amount, amount of froth, milk amount, hot water amount, temperature, beans (BARISTA TS model only), coffee strength and coffee flavour.

The assignment of personal settings to a user is always similar. Setting the coffee amount for a Cappuccino is described here as an example.

**Requirement:** The appliance is ready for operation.

1. Press the "menu/ok" button for 2 seconds.

2. The menu appears on the display.
2. Navigate to the *My Coffee* menu.
3. Use the arrow buttons to select a user and confirm with "menu/ok".
4. Navigate to the *Cappuccino > Coffee amount* menu.
5. Use the arrow buttons to select an amount and confirm with "menu/ok".
6. Repeatedly select the *Exit* command to exit the menu.
- » The appliance is ready for operation.
- » The next time a cappuccino is prepared by the user, the selected amount of coffee is used.

## 7.3 Preparing beverages with personal settings



BARISTA TS model.



BARISTA T model.

The preparation of beverages using the "My Coffee" function is similar for all beverages. The preparation of a cappuccino is described here as an example.

**Requirement:** The ready symbol appears on the display and milk is connected.

1. Place a vessel beneath the outlet.
2. Press the "My Coffee" button until the desired user is shown on the display.
3. Press the "Cappuccino" button.
  - » Beverage dispensing starts and ends automatically.
4. Remove the vessel.
  - » The display shows: *Easy Cleaning? (OK for start)*.
5. You can execute the Easy Cleaning programme or prepare further beverages.
  - a) Execute the Easy Cleaning programme. To do so, follow the instructions on the display, see section 9.4, page 57.
  - b) Prepare further beverages and execute the Easy Cleaning programme later.
- » The appliance is ready for operation.

**i Information**

- To exit the "My Coffee" function, press the "My Coffee" button until the ready symbol appears.
- If a beverage is not prepared within 3 minutes, the appliance automatically switches to the ready symbol.

**i Information**

To prevent the time being shown on the display, set the time to 00:00.

GB

## 8 Changing basic settings

Operating steps that change the appliance's basic settings are described in this chapter.

### 8.1 Setting the language

The display text language can be set.

**Requirement:** The appliance is ready for operation.

1. Press the "menu/ok" button for 2 seconds.
  - » The menu appears on the display.
2. Navigate to the *Settings > Language* menu.
3. Use the arrow buttons to select a language and confirm with "menu/ok".
4. Exit the menu with the *Exit* command.
  - » The appliance is ready for operation.

### 8.2 Setting the time

The time shown on the display can be set.

**Requirement:** The appliance is ready for operation.

1. Press the "menu/ok" button for 2 seconds.
  - » The menu appears on the display.
2. Navigate to the *Settings > Clock* menu.
3. Use the arrow buttons to select the hours and minutes. Confirm each setting with "menu/ok".
4. Exit the menu with the *Exit* command.
  - » The appliance is ready for operation.

### 8.3 Activating/deactivating Auto Bean Select (BARISTA TS model only)

Automatic selection of a bean type can be activated or deactivated.

**Requirement:** The appliance is ready for operation.

1. Press the "menu/ok" button for 2 seconds.
  - » The menu appears on the display.
2. Navigate to the *Settings > Auto Bean Select* menu.
3. Use the arrow buttons to select *Enabled* or *Disabled* and confirm with "menu/ok".
4. Repeatedly select the *Exit* command to exit the menu.
  - » The appliance is ready for operation.

### 8.4 Setting energy save mode

Energy save mode lowers the heating temperature and switches off the illumination on the control panel. The "menu/ok" button remains lit.

If the appliance is not operated for a long time, it automatically switches to energy save mode after a specified time. The period of time until energy save mode is activated is set in the *Energy save mode* menu.

**Requirement:** The appliance is ready for operation.

1. Press the "menu/ok" button for 2 seconds.
  - » The menu appears on the display.
2. Navigate to the *Energy save mode* menu.
3. Use the arrow buttons to select a period of time and confirm with "menu/ok".
4. Exit the menu with the *Exit* command.
  - » The appliance is ready for operation.

#### Information

- Energy save mode is ended by pressing the "menu/ok" button.
- Energy save mode cannot be deactivated completely. After 4 hours without being operated at the latest, the appliance switches to energy save mode.

## 8.5 Setting Auto OFF

If the appliance is not operated for a long time, it switches off automatically after a specified time. Set the duration until the appliance switches off in the *Auto OFF* menu. A specific point in time can also be defined.

#### Information

If the duration and point in time are activated simultaneously, the appliance switches off after the event that occurs first.

#### Setting the duration for Auto OFF

**Requirement:** The appliance is ready for operation.

1. Press the "menu/ok" button for 2 seconds.
  - » The menu appears on the display.
2. Navigate to the *Auto OFF > OFF after...* menu.

3. Use the arrow buttons to select a time and confirm with "menu/ok".
4. Repeatedly select the *Exit* command to exit the menu.
  - » The appliance is ready for operation.

#### Setting the point in time for Auto OFF

The OFF time point is deactivated as default in the factory.

**Requirement:** The appliance is ready for operation.

1. Press the "menu/ok" button for 2 seconds.
  - » The menu appears on the display.
2. Navigate to the *Auto OFF > OFF at...* menu.
3. Use the arrow buttons to select the hours and minutes. Confirm each setting with "menu/ok".
4. Repeatedly select the *Exit* command to exit the menu.
  - » The appliance is ready for operation.

#### Information

To deactivate the Off time, set the off time to 00:00.

## 8.6 Activating/deactivating rinsing

Rinsing is always carried out immediately after switching on the coffee system. Only the Off rinsing can be activated/deactivated. If this is activated, rinsing is carried out after switching off the coffee system.

Permanent deactivation is not recommended.



### Activating/deactivating switch-off rinsing

**Requirement:** The appliance is ready for operation.

1. Press the "menu/ok" button for 2 seconds.
  - » The menu appears on the display.
2. Navigate to the *Settings* > *Switch-off rinsing* menu.
3. Use the arrow buttons to select *Enabled* or *Disabled* and confirm with "menu/ok".
4. Repeatedly select the *Exit* command to exit the menu.
  - » The appliance is ready for operation.

## 8.7 Resetting the appliance to the factory settings

The appliance can be reset to the factory settings.

### Information

If the appliance is reset to the factory settings, all personal settings are lost, including the settings in the *My Coffee* menu.

**Requirement:** The appliance is ready for operation.

1. Press the "menu/ok" button for 2 seconds.
  - » The menu appears on the display.
2. Navigate to the *Settings* > *Factory settings* menu.
3. Use the arrow buttons to select *Reset* and confirm with "menu/ok".
4. Repeatedly select the *Exit* command to exit the menu.
  - » The appliance is ready for operation.

## 8.8 Statistics and System menu

### Statistics

The *Statistics* menu provides information on the number of beverages dispensed and for maintenance.

### System

The *System* menu provides information on the *software version* and access to the *Venting* function, see „10.1 Venting the appliance“ on page 62.

## 8.9 Setting the grinding fineness

The grinding fineness of the coffee beans influences the flavour of the coffee. The grinding fineness has been optimally set prior to delivery.

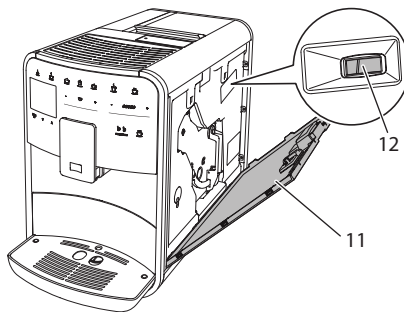

Fig. 17: Setting the grinding fineness

1. Open the cover (11). To do this, reach into the recess on the right of the appliance and pull the cover off upwards.
2. Move the lever (12) forwards or backwards.
  - Backwards = grinding fineness coarser
  - Forwards = grinding fineness finer
3. Close the cover. To do this, insert the bottom of the cover into the appliance and swing it up until it engages.



**Information**

- If the grinding fineness is set finer, the coffee flavour is stronger.
- The grinding fineness is optimally set when the coffee flows evenly out of the outlet and a fine, dense crema appears.

## 8.10 Converting the connection for the milk hose (depending on the model)

Optionally, the milk hose can be connected on the left or right side of the spout.

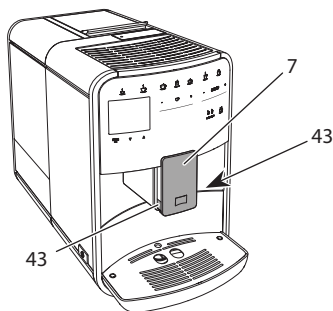

Fig. 18: Turn the inlet, 1

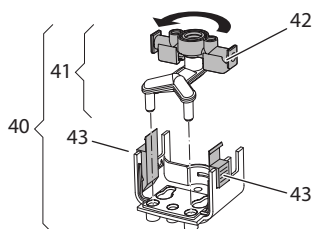

Fig. 19: Turn the inlet, 2

1. Pull the milk hose off the appliance.
2. Push the outlet (7) down as far as it will go.
3. Press the locking mechanism (43) of the milk unit (40) together using two fingers and pull the milk unit downwards off the outlet.
4. Pull the milk distributor (41) upwards out of the milk unit.
5. Turn the inlet (42) by 180°.

Installation is carried out as described in reverse order.

**Information**

To install, push the milk unit (41) onto the outlet (7) using both hands. Make sure that the locking mechanism (43) audibly engages on both sides.

## 9 Care and maintenance

Regular cleaning and maintenance ensure the consistent high quality of your beverages.

### 9.1 General cleaning

Clean the appliance regularly. Immediately remove external soiling caused by milk and coffee.

**ATTENTION**

**The use of unsuitable cleaning agents can lead to scratched surfaces.**

- Do not use any abrasive cloths, sponges or cleaning agents.

**Requirement:** The appliance is switched off.

- Clean the outside of the appliance with a soft, damp cloth and normal washing-up liquid.
- Rinse the drip tray and the coffee grounds container with a soft, damp cloth and normal washing-up liquid.
- Clean the bean container with a soft, dry cloth.

### 9.2 Rinsing the coffee system

During rinsing, the nozzles at the outlet and the internal parts of the coffee system are rinsed. As a result, rinsing water from the interior enters the drip tray.

If switch-off rinsing is not deactivated, the appliance rinses the coffee system when switching on and off.

Rinsing can also be carried out manually.

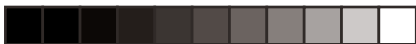

**Requirement:** The appliance is ready for operation.

1. Place a vessel beneath the outlet.
2. Press the "menu/ok" button for 2 seconds.
  - » The menu appears on the display.
3. Navigate to the *Care > Rinsing* menu.
4. Use the arrow buttons to select *Start* and confirm with "menu/ok".
  - » The coffee system is rinsed.
  - » The appliance is ready for operation.

### 9.3 Cleaning the brewing unit

To avoid damage to the appliance, we recommend cleaning the brewing unit once a week.

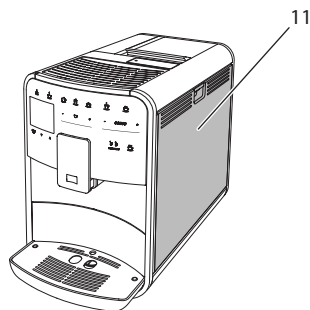

Fig. 20: Removing the brewing unit, 1

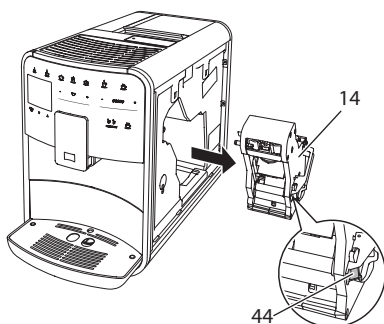

Fig. 21: Removing the brewing unit, 2

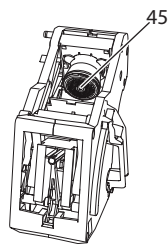

Fig. 22: Cleaning the brewing unit

**Requirement:** The appliance is switched off.

1. Open the cover (11). To do this, reach into the recess on the right of the appliance and pull the cover off upwards.
2. Press and hold the red lever (44) on the brewing unit handle (14) and turn the handle clockwise until it engages at the stop.
3. Pull the brewing unit out of the appliance by the handle.
4. Rinse the entire brewing unit thoroughly from all sides under running water. In particular, make sure that coffee residues are removed from the sieve (45).
5. Allow the brewing unit to drip dry.
6. Use a soft, dry cloth to remove coffee residues from the surfaces inside the appliance.
7. Insert the brewing unit into the appliance. Press and hold the red lever on the handle of the brewing unit and turn the handle counter clockwise until it engages at the stop.
8. Close the cover. To do this, insert the bottom of the cover into the appliance and swing it up until it engages.

### 9.4 "Easy Cleaning" programme

The milk system is rinsed using the "Easy Cleaning" programme.

Each time after a beverage has been prepared with milk, the appliance requests you to execute the "Easy Cleaning" programme.



The "Easy Cleaning" programme can also be run manually.

**Requirement:** The appliance is ready for operation.

1. Place a vessel beneath the outlet.
2. Press the "menu/ok" button for 2 seconds.
  - » The menu appears on the display.
3. Navigate to the *Care > Easy Cleaning* menu.
4. Use the arrow buttons to select *Start* and confirm with "menu/ok".
5. Follow the further instructions on the display up to the end of the "Easy Cleaning" programme.
  - » The appliance is ready for operation.

## 9.5 "Cleaning milk system" programme

This programme is used to clean the milk system with the aid of a milk system cleaning agent.

To maintain hygiene and avoid damage to the appliance, we recommend carrying out the cleaning programme once a week.

The cleaning programme takes approximately 3 minutes and should not be interrupted.

### ATTENTION

**The use of unsuitable milk system cleaning agents can damage the appliance.**

- Only use Melitta® PERFECT CLEAN milk system cleaning agent for fully automatic coffee makers.
- Observe the processing instructions on the packaging of the milk system cleaning agent.

**Requirement:** The appliance is ready for operation.

1. Place a vessel with a capacity of at least 0.7 litres beneath the outlet (e.g. the coffee grounds container).
2. Press the "menu/ok" button for 2 seconds.
  - » The menu appears on the display.
3. Navigate to the *Care > Cleaning milk system* menu.
4. Use the arrow buttons to select *Start* and confirm with "menu/ok".
5. Follow the further instructions on the display up to the end of the milk system cleaning programme.
  - » The appliance is ready for operation.

## Cleaning the milk unit

In addition, we recommend cleaning the milk unit, the milk hose and the milk container regularly.

### Information

- The plastic milk container (depending on the model), without lid and riser pipe, is dishwasher-safe.
- The thermal milk container (depending on the model) and its individual parts must not be cleaned in the dishwasher.

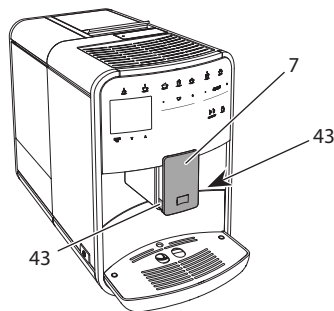

Fig. 23: Removing the milk unit, 1

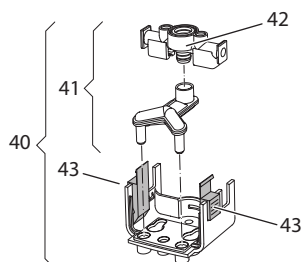

Fig. 24: Removing the milk unit, 2

1. Pull the milk hose off the appliance.
2. Push the outlet (7) down as far as it will go.
3. Press the locking mechanism (43) of the milk unit (40) together using two fingers and pull the milk unit downwards off the outlet.
4. Pull the milk distributor (41) upwards out of the milk unit.
5. Pull the inlet (42) out upwards.
6. Clean the individual parts with warm water. Use a soft, damp cloth and normal washing-up liquid.

Installation is carried out as described in reverse order.

#### Information

To install, push the milk unit (40) onto the outlet (7) using both hands. Make sure that the locking mechanism (43) audibly engages on both sides.

## 9.6 "Cleaning coffee system" programme

This cleaning programme is used to remove residues and coffee oil residues with the aid of coffee machine cleaning agents.

To avoid damage to the appliance, we recommend carrying out the cleaning programme every 2 months or as requested by the appliance.

Before starting the cleaning programme, clean the brewing unit and the interior (see section 9.3, page 57).

The cleaning programme takes approximately 15 minutes and should not be interrupted.

#### CAUTION

**Contact with coffee machine cleaning agent may lead to eye and skin irritation.**

- Observe the processing instructions on the packaging of the coffee machine cleaning agent.

#### ATTENTION

**The use of unsuitable coffee machine cleaning agents can damage the appliance.**

- Only use Melitta® PERFECT CLEAN cleaning tabs for fully automatic coffee makers.

**Requirement:** The appliance is ready for operation.

1. Press the "menu/ok" button for 2 seconds.
  - » The menu appears on the display.
2. Navigate to the *Care > Cleaning coffee system* menu.
3. Use the arrow buttons to select *Start* and confirm with "menu/ok".
4. Follow the further instructions on the display up to the end of the cleaning programme.
  - » The appliance is ready for operation.

## 9.7 "Descaling" programme

The descaling programme is used to remove limescale deposits in the interior of the appliance with coffee machine descaling agents.

To avoid damage to the appliance, we recommend carrying out the descaling programme every 3 months or as requested by the appliance.

With consistent use of a Melitta water filter, carry out the descaling program at least once a year.

The descaling programme takes approximately 25 minutes and should not be interrupted.

#### ⚠ CAUTION

**Contact with descaling agent may lead to eye and skin irritation.**

- Observe the processing instructions on the packaging of the descaling agent.

#### ATTENTION

**Use of unsuitable descaling agent may damage the appliance.**

- Only use Melitta® ANTI CALC liquid descaling agent for fully automatic coffee makers.
- Observe the processing instructions on the packaging of the descaling agent.

#### ATTENTION

**A water filter may be damaged if it is screwed in during the descaling programme.**

- Remove the water filter when the appliance requests you to do so (see Fig. 25, page 61).
- Place the water filter into a vessel filled with tap water during the descaling programme.
- The water filter can be reinserted and reused when the descaling programme is complete.

**Requirement:** The appliance is ready for operation.

1. Press the "menu/ok" button for 2 seconds.
  - » The menu appears on the display.
2. Navigate to the *Care > Descaling* menu.
3. Use the arrow buttons to select *Start* and confirm with "menu/ok".
4. Follow the further instructions on the display up to the end of the descaling programme.
  - » The appliance is ready for operation.

## 9.8 Setting the water hardness

The set water hardness influences the frequency of descaling. The harder the water, the more frequently the appliance has to be descaled.

#### ℹ Information

The water hardness cannot be set if you use a water filter (see section 9.9, page 60).

Determine the water hardness with the enclosed test strip. Observe the instructions on the test strip packaging and in the table *Water hardness range*, page 62.

**Requirement:** The appliance is ready for operation.

1. Press the "menu/ok" button for 2 seconds.
  - » The menu appears on the display.
2. Navigate to the *Settings > Water hardness* menu.
3. Use the arrow buttons to select the water hardness range and confirm with "menu/ok".
4. Exit the menu with the *Exit* command.
  - » The appliance is ready for operation.

## 9.9 Using a water filter

The use of a water filter extends the service life of the appliance and the appliance has to be descaled less frequently. The water filter contained in the scope of delivery filters calcium and other pollutants out of the water.

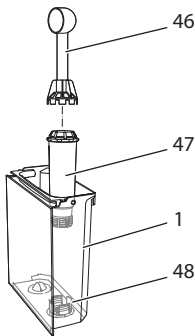

Fig. 25: Screwing/unscrewing the water filter

The water filter (47) is screwed into and unscrewed from the thread (46) on the base of the water tank (48) using the screwing aid at the end of the enclosed coffee spoon (1).

### Inserting the water filter

#### Information

Place the water filter into a vessel filled with fresh tap water for a few minutes before inserting it.

**Requirement:** The appliance is ready for operation.

1. Press the "menu/ok" button for 2 seconds.
  - » The menu appears on the display.
2. Navigate to the *Care > Filter > Insert filter* menu.
3. Use the arrow buttons to select *Start* and confirm with "menu/ok".
4. Follow the further instructions on the display.
  - » The water hardness is automatically adjusted on the water filter by the appliance.
  - » The appliance is ready for operation.

### Changing the water filter

Change the water filter when the appliance requests you to do so.

**Requirement:** The appliance is ready for operation.

1. Press the "menu/ok" button for 2 seconds.
  - » The menu appears on the display.
2. Navigate to the *Care > Filter > Change filter* menu.
3. Use the arrow buttons to select *Start* and confirm with "menu/ok".
4. Follow the further instructions on the display.
  - » The appliance is ready for operation.

### Removing the water filter

The water filter should not be left standing dry for a long period of time. When it is not used for a long time, we recommend storing the water filter in a vessel filled with tap water in the refrigerator.

**Requirement:** The appliance is ready for operation.

1. Press the "menu/ok" button for 2 seconds.
  - » The menu appears on the display.
2. Navigate to the *Care > Filter > Remove filter* menu.
3. Use the arrow buttons to select *Start* and confirm with "menu/ok".
4. Follow the further instructions on the display.
  - » The water hardness is automatically reset to the previous setting.
  - » The appliance is ready for operation.



## 10 Transport, storage and disposal

### 10.1 Venting the appliance

We recommend venting the appliance when it is not used for a long period, prior to transport and when there is a risk of frost.

During venting, residual water is removed from the appliance.

**Requirement:** The appliance is ready for operation.

1. Place a vessel beneath the outlet.
2. Press the "menu/ok" button for 2 seconds.
  - » The menu appears on the display.
3. Navigate to the *System* > *Venting* menu.
4. Select *Start* using the arrow buttons and confirm with "menu/ok".
5. Follow the further instructions on the display.
  - » The appliance switches off.

### 10.2 Transporting the appliance

#### ATTENTION

**Freezing residual water can damage the appliance.**

- Prevent the appliance from being exposed to temperatures below 0 °C.

#### Information

Transport the appliance in the original packaging. This avoids damage in transit.

Before transporting the appliance, carry out the following activities:

1. Vent the appliance (see section 10.1, page 62).
2. Empty the drip tray and the coffee grounds container.
3. Empty the water tank.
4. Empty the bean container.
5. Clean the appliance (see section 9.1, page 56).

6. Secure loose parts (cup plate, etc.) with suitable adhesive tape.
7. Package the appliance.

### 10.3 Disposing of the appliance



Appliances marked with this symbol are subject to the European Directive 2002/96/EC for WEEE (Waste Electrical and Electronic Equipment).

Electrical appliances do not belong in domestic waste.

- Dispose of the appliance in an environmentally friendly manner via suitable collection systems.

## 11 Technical data

| Technical data     |   |
|--------------------|---|
| Operating voltage  | 220 V to 240 V, 50 Hz                       |
| Power consumption  | Max. 1450 W                                 |
| Pump pressure      | Static, max. 15 bar                         |
| Dimensions         |   |
| Width              | 255 mm                                      |
| Height             | 365 mm                                      |
| Depth              | 465 mm                                      |
| Capacity           |   |
| Bean container     | 2 × 135 g                                   |
| Water tank         | 1.8 l                                       |
| Weight (empty)     | 10.6 kg (Barista TS)<br>10.4 kg (Barista T) |
| Ambient conditions |   |
| Temperature        | 10 °C to 32 °C                              |
| Relative humidity  | 30 % to 80 %<br>(non-condensing)            |
| Bluetooth          | Bluetooth Smart (low energy),<br>BTLE 4.0   |

| Water hardness range | °dH      | °e       | °fH      |
|----------------------|----------|----------|----------|
| Soft                 | 0 to 10  | 0 to 13  | 0 to 18  |
| Medium               | 10 to 15 | 13 to 19 | 18 to 27 |
| Hard                 | 15 to 20 | 19 to 25 | 27 to 36 |
| Very hard            | > 20     | > 25     | > 36     |





## 12 Troubleshooting

If the actions listed below fail to rectify the problems or other problems not listed here occur, contact our hotline (local rate).

The service number can be found on the lid of the water tank or in the Service area of our website.

GB

| Problem   | Cause   | Action   |
|---|---|--|
| Coffee only emerges from the outlet in drips.                                 | Grinding fineness too fine.   | <ul style="list-style-type: none"><li>Set a coarser grinding fineness (see section 8.9 on page 55).</li></ul>  |
|   | Appliance soiled.   | <ul style="list-style-type: none"><li>Clean the brewing unit (see section 9.3 on page 57).</li><li>Run the cleaning programme (see section 9.6 on page 59).</li></ul>  |
|   | Appliance is covered inside with limescale.   | <ul style="list-style-type: none"><li>Descale the appliance (see section 9.7 on page 59).</li></ul>  |
| Coffee does not flow.   | Water tank not filled or inserted incorrectly.  | <ul style="list-style-type: none"><li>Fill the water tank and ensure it is positioned correctly (see section 4.7 on page 46).</li></ul>  |
|   | Brewing unit clogged.   | <ul style="list-style-type: none"><li>Clean the brewing unit (see section 9.3 on page 57).</li></ul>   |
| <i>Fill beans</i> appears on the display although the bean container is full. | Beans do not drop into the grinder.   | <ul style="list-style-type: none"><li>Tap lightly on the bean container.</li><li>Clean the bean container.</li><li>Coffee beans too oily. Use different coffee beans.</li></ul>  |
| Loud grinder noise.   | Foreign object in the grinder.  | <ul style="list-style-type: none"><li>Contact the hotline.</li></ul>   |
| Brewing unit cannot be inserted after removing.                               | Brewing unit is not correctly locked.   | <ul style="list-style-type: none"><li>Check that the handle for the brewing unit locking mechanism is correctly engaged (see section 9.3 on page 57).</li></ul>  |
|   | Drive is not in the correct position.   | <ul style="list-style-type: none"><li>Press and hold the "My Coffee/Recipes" button. Also press the ON/OFF button. The appliance initialises. Release the buttons again.</li></ul>   |
| System error appears on the display.  | Software problem.   | <ul style="list-style-type: none"><li>Switch the appliance off and on again (see section 4.1 on page 42).</li><li>Contact the hotline.</li></ul>   |
| The appliance can be operated using the <i>Melitta-Connect-App</i> .          | <ul style="list-style-type: none"><li>No Bluetooth connection.</li></ul>                                  | <ul style="list-style-type: none"><li>Establish the Bluetooth connection for the first time (see section 4.4 on page 44)</li><li>The Smartphone does not support the Bluetooth function.</li><li>Bluetooth connection not activated on the Smartphone.</li></ul> |
|   | <ul style="list-style-type: none"><li>Appliance reset to its factory settings.</li></ul>                  | <ul style="list-style-type: none"><li>Re-connect the appliance with the Smartphone for the first time (see chapter 4.4 on page 44).</li></ul>  |
|   | <ul style="list-style-type: none"><li>The Smartphone is outside the reception range.</li></ul>            | <ul style="list-style-type: none"><li>Bring the Smartphone into the reception range (max. 5 - 10 m).</li></ul>   |
|   | <ul style="list-style-type: none"><li>Another Smartphone is already connected to the appliance.</li></ul> | <ul style="list-style-type: none"><li>Close the App on the connected Smartphone.</li></ul>   |



