

AVIOT

TE-U1

True Wireless Earphones

Startup Guide

Important Safety Instructions

Before using the product, read through the instruction manual to ensure that you will use the product correctly.

DANGER

- Do NOT place the product into contact with fire.
- Keep the earbuds and accessories out of the reach of children and pets. Otherwise, it may lead to accidental swallowing or malfunction.
- Do NOT disassemble the product.

WARNING

- Use the earbuds in an environment in which you can ensure the safety of your surroundings because warning sounds and other sounds in your surroundings will be hard to hear.
- Do NOT use, store, or leave the product in an environment with excessive humidity, dust, oil fumes, or steam, or in a high-temperature environment near a source of fire, in direct sunlight, or inside a vehicle.
- Do NOT use the earbuds when operating a motor vehicle, motorcycle, watercraft, or bicycle. Be aware of the surrounding environment when wearing the earbuds.
- Do NOT allow water or foreign matter to get inside the product. Otherwise, this may result in a fire or electric shock. If water or foreign matter accidentally gets inside the product, stop using it immediately and contact your distributor.
- Do NOT use the earbuds under a blanket or the like.
- Do NOT insert the USB connector when the earbuds or USB cable is wet. Inserting a USB connector in a wet state may cause the earbuds to short circuit due to contact with the liquid (tap water, seawater, cold drinks, etc.), and foreign matter entering into the earbuds may result in abnormal heat generation or product failure.
- Stop using the earbuds if there is battery leakage or a peculiar smell, and keep the product away from flames.
- Use the included USB charging cable to charge your earbuds.

NOTE

- Do NOT use it for a long time at high volume. Otherwise, your hearing might be damaged. To protect your ears, be careful NOT to turn up the volume too high. In addition, regardless of the volume, extended use will place a burden on your ears. Please rest your ears every hour.
- Do NOT use the product near medical equipment. Electromagnetic waves may have an impact on pacemakers and medical electronic devices.
- Do NOT use them if the earbuds cause any abnormal sensation against your skin. If your skin condition does not return to normal soon, seek medical attention.
- Do NOT touch the earbuds for an extended period during charging. Otherwise, it may result in a low-temperature burn.
- Please follow the instructions of the flight attendant when using the product onboard an aircraft. Electromagnetic waves may cause the device to malfunction, resulting in an accident.

- Discarding rechargeable batteries**  
The built-in rechargeable battery this device is equipped with is a renewable resource. Dispose of the product according to local standards and regulations. Do NOT disassemble the product.

For customers in the USA

FCC Notice

You are cautioned that any changes or modifications not expressly approved in this manual could void your authority to operate this equipment.

This device complies with Part 15 of the FCC Rules. Operation is subject to the following two conditions: (1) This device may not cause harmful interference, and (2) this device must accept any interference received, including interference that may cause undesired operation.

Note:

This equipment has been tested and found to comply with the limits for a Class B digital device, pursuant to Part 15 of the FCC Rules. These limits are designed to provide reasonable protection against harmful interference in a residential installation. This equipment generates, uses and can radiate radio frequency energy and, if not installed and used in accordance with the instructions, may cause harmful interference to radio communications. However, there is no guarantee that interference will not occur in a particular installation. If this equipment does cause harmful interference to radio or television reception, which can be determined by turning the equipment off and on, the user is encouraged to try to correct the interference by one or more of the following measures:

- Reorient or relocate the receiving antenna.
- Increase the separation between the equipment and receiver.
- Connect the equipment into an outlet on a circuit different from that to which the receiver is connected.
- Consult the dealer or an experienced radio/TV technician for help.

This transmitter must not be co-located or operated in conjunction with any other antenna or transmitter.

This equipment complies with FCC radiation exposure limits set forth for an uncontrolled environment and meets the FCC radio frequency (RF) Exposure Guidelines. This equipment has very low levels of RF energy that is deemed to comply without testing of specific absorption rate (SAR).

FCC ID: Z96B6TE-U1

Radio interference of Bluetooth® products

- Interference from electromagnetic radiation in the surrounding environment, such as that from wireless LAN equipment, microwave ovens, and other electromagnetic cooking appliances may result in noise, loss of sound, or communication being disconnected.
- The effective communication range of Bluetooth® may vary greatly due to the influence of shields (the human body, metal, walls, etc.) and the state of electromagnetic radiation in your surroundings.
- The electromagnetic radiation generated by Bluetooth® devices may affect the operation of other electronic devices. There is a risk of an accident occurring as a result in some cases, so turn off the power of the earbuds and other Bluetooth® devices when in the following places:
  - Hospitals / near the priority seating on the subway / in the vicinity of gas stations and other places where combustible gas is generated / near fire alarms

For long-lasting use

- Beware of over-discharge  
If the rechargeable battery is not charged for a long time, it may lead to over-discharge and deterioration. If storing for a long time, recharge the battery once a month to prevent over-discharge.



- Beware of deformation, damage, and impacts  
The earbuds and their accessories, such as earpieces, may be deformed or damaged if they are subject to stress for a long time. Please exercise care when storing them. In addition, avoid dropping the product or subjecting it to strong impacts, as it contains precise electronic components.
- Splash-proof specification  
The earbuds adopt a splash-proof design but are not completely waterproof. Do NOT intentionally wet the earbuds or put them in a pocket soaked with sweat or rain, otherwise, it may lead to product failure. Wipe off stains containing water or moisture using a soft dry cloth as soon as possible, and use the product in as dry a state as possible. Note that the charging case is not splash-proof.
- Cleaning  
Do NOT use chemicals such as benzene, thinner, or alcohol when cleaning the earbuds. Otherwise, the earbuds may be deformed or damaged.

Battery Charging (Please charge it first before use for the first time)

Charging the charging case

Insert the USB Type-C® connector of the USB charging cable into the charging port for charging. It takes about 1 hour and 30 minutes to go from 0% to fully charged.

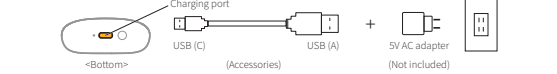

- The color of the battery indicator changes to white (70-100%), orange (30-69%), or red (0-29%) depending on the remaining battery capacity.
- Charging may not be possible if the voltage becomes higher or lower than the specified voltage.
- If a charger other than a 5V AC adapter is used, the charging may be stopped by the protection function.
- If charging is not successful, confirm that the USB Type-C® cable is in a normal state and try to recharge it again with a 5V AC adapter.
- Please charge the charging case regularly. (Recommended frequency: at least once a month)

Charging the earbuds

Put the earbuds back in the charging case and they will start charging automatically. It takes about 1 hour and 30 minutes to go from 0% to fully charged.



- If the charging case has no remaining charge level, the earbuds will not be charged.
- When there is no remaining charge level in the charging case, the power supply to the earbuds will stop, at this time the earbuds may turn on while in the charging case and connect to your device, but this is not a malfunction. You simply have to charge the charging case.
- Please charge the earbuds regularly. (Recommended frequency: at least once a month)

Wireless charging

Wireless charging is also supported by using a commercially available wireless charger.

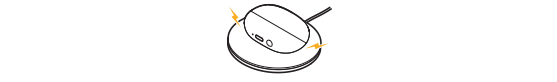

- The time it takes to complete charging is longer than the time it takes when using the USB cable, and this charging time may vary depending on the wireless charger.
- Charging may be stopped by the protection function depending on the wireless charger or the environment.

Turning the Power ON/OFF

Power ON : The power can be turned on by removing the earbuds from the charging case  
Power OFF: The power can be turned off by putting the earbuds into the charging case

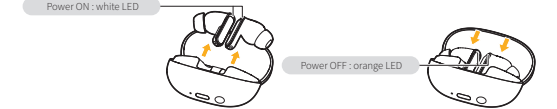

When storing the earbuds in the charging case, be sure that the orange LED is lit before closing the case.

- If there is no charge remaining in the charging case, the earbud's power will not be turned off.
- If not connected for 5 minutes, the earbuds will automatically turn off.
- The power can be turned ON/OFF also by pressing and holding the touch sensors. Please refer to the list of operation methods for details.

Pairing (during initial setup)

- Take the earbuds out of the charging case and turn on the power, then confirm that the earbuds are in pairing mode.

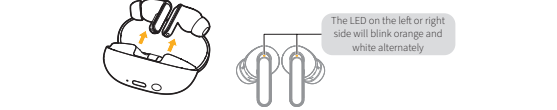

- Connect to "AVIOT TE-U1" from the Bluetooth settings screen of the device to be connected.

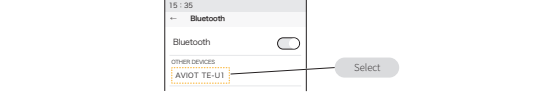

The illustration shows an example of the settings screen on a device to be connected. For details, please refer to the instruction manual of the device to be connected.

- If pairing fails, please try the reset operation.

Resetting (in case of operation failure)

- Delete the Bluetooth settings of the connected device.



- Set both earbuds in the charging case with the case cover open, then press and hold the physical button on the bottom of the case for 10 seconds.



- When the reset is completed, the LEDs on the case and earbuds will blink white, and the earbuds will enter pairing mode.

List of Operation Methods

		L	R
⏻	Power ON	Press and hold for 3 seconds	Press and hold for 3 seconds
	Power OFF*1	Press and hold for 7 seconds	Press and hold for 7 seconds
⏮	Play	Tap 1 time	Tap 1 time
	Stop	Tap 1 time	Tap 1 time
	Next	—	Tap 2 times
	Previous	—	Tap 3 times
🔊	Volume up	Tap 3 times	—
	Volume down	Tap 2 times	—
📞	Receive call	Tap 1 time when there is an incoming call	Tap 1 time when there is an incoming call
	End call	Tap 1 time during a call	Tap 1 time during a call
🔊	ANC*2	Press and hold for 1.5 seconds to switch between the tuned modes	
🔊	Ambient sound	—	
Switch tuned mode		—	Press and hold for 1.5 seconds to switch between the tuned modes (MUSIC / MOVIE / POWERFUL)

\*1 You will hear the voice prompt "ANC Mode / Ambient Sound Mode" or "Switch Tuned Mode" during operation.  
\*2 ANC = Active Noise Canceling

Wearing the Earbuds

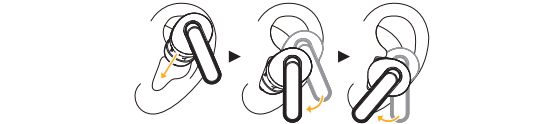

If the earbuds do not fit your ears, please replace the earpieces with included earpieces of a different size. Turning the earpiece inside out stabilizes the axis, making it easy to replace. Turning the microphone part of the earbud toward your face stabilizes the earbud.

Warranty

This product will be repaired or replaced free of charge for spontaneous failure that occurs during normal use. When you contact us, have ready at hand the documentation proving the date of purchase, such as the receipt, delivery slip, or electronic data from the store you purchased the product.

- Before using this product, be sure to read the instruction manual to ensure proper use.
  - The warranty is valid for 12 months, starting from the date of purchase.
  - This warranty is valid only in country or region of purchase.
  - Only the earbuds and the charging case are covered by the warranty.
  - Damage to accessories and outer packaging boxes during verification and replacement is not within the scope of the warranty.
  - The warranty period of products replaced free of charge or with charge is also 12 months from the original date of purchase. The warranty period will not be extended accordingly after replacement.
- This product is subject to change for improvement and the like, without notice.
- This warranty does not apply to the following situations.
  - The product has not been registered on the company's dedicated registration platform.
  - If you do not have the documentation or electronic data serving as proof of purchase, such as a receipt or delivery slip from the distributor.
  - The product has been repaired or modified outside of our service center.
  - The product has fallen into a state of disrepair or been damaged due to misuse (including damage and burnout caused by excessive input), dropping, shock, or other accidents caused by the customer's carelessness or improper storage, etc. Even though the symptoms occurred within the warranty period, if the issue with the product is deemed due to misuse.
  - The product was used with a nonstandard power supply or voltage.
  - The failure is related to consumables.
  - The cause of the failure is another device other than this product, such as a mobile device.
  - Damage to the exterior of the product, such as scratches on the main unit or the plug (which occurred after purchase).
  - Even though the fault or defect occurred within the warranty period, the date of consultation exceeded the warranty period.
- We do not offer warranties for products from other companies.
- We will not lend out alternative devices during the repair or replacement period.
- If the issue with the product is deemed not to be covered by the warranty, we may request that you reimburse us for the round-trip shipping fee.
- The earbuds come as a set of left and right earbuds, so replacement of only one side is not available. Depending on production, inventory, or other circumstances, it may not be possible to provide replacements for the same product.

Disclaimers

We do not guarantee connectivity or operability with all Bluetooth®-enabled devices and applications. We shall not be responsible for any malfunction, problems, loss of data, or damage to other devices caused by the use of this product. We shall not bear any responsibility for damage caused by malfunctions, problems, or loss of data in computers, operating systems, other software, or devices. Thank you for your understanding.

FAQ / Inquiries

Please check the support page.



About Trademarks

- The term **Bluetooth®** and its logo are registered trademarks that belong to Bluetooth SIG, Inc. Preseed Japan Corporation is using these trademarks and logos with authorization.
- USB Type-C® and USB-C® are registered trademarks of USB Implementers Forum.
- Other trademarks and registered trademarks are trademarks and registered trademarks belonging to their respective holders.

