



DROP IN REPLACEMENT GUIDE

VS PUMPS



Why Jandy®?

Why settle for sufficient when you can get superior...

With Jandy equipment, you're getting a product that's easy to install on most pool pads, compatible with most existing setups and provides unparalleled performance and efficiency.

TRADE SERIES
EXCLUSIVE

Protecting Your Bottom Line

We've got your back. Our equipment is **NOT** available for purchase on the internet. Only through you.



Drops In with Ease

Jandy equipment is engineered to easily replace most existing equipment on the pool pad with little to no plumbing adjustments. Jandy is a trade-up, not just a trade out.



Built to Last

Our equipment is designed for durability so you can get the job done and can trust that it will perform for the long haul.



Support You Can Count On

With our superior customer service and dedicated training team available to you when you need it most, you'll never be caught off-guard on-site.

Why Jandy® VS FloPro™ is the First Choice When Replacing a Pump



The Right Dimensions

Jandy VS FloPro pumps include an adjustable base so you can be certain the plumbing lines up to the Pentair® or Hayward® pump you're replacing.



Small for Service

No need to make more room. At just 24.5" long, Jandy VS FloPro pumps take up less space in your truck and on the equipment pad.



Everything You Need

VS FloPro pumps include 2" unionized fittings or utilize the 2" internal threads. Using the unionized fittings is recommended as they allow for micro adjustments for the perfect drop in fit and make future maintenance easier.

115V



230V

The Power Play

Whether the pre-existing pump is wired for 230V or 115V, it doesn't matter with Jandy "Dual Voltage" Series VS FloPro pumps. They feature an autosensing, dual-voltage design that allows them to work with both — without having to rewire.

VS FloPro™ Dual-Voltage, 2-AUX Relay Pump Models



Standout Features

- 1.85 And 2.7 HP Models
- SpeedSet VS Controller Preinstalled
- 2" Unionized Fittings + 2" Internal Threads
- 115V/230V Autosensing Operation
- Two Programmable Auxiliary Relays
- 4-Speed Dry Contact Relay Control
- Zero-Clearance TEFC Motor Design

VS FloPro™ 1.85 HP Pump Curves

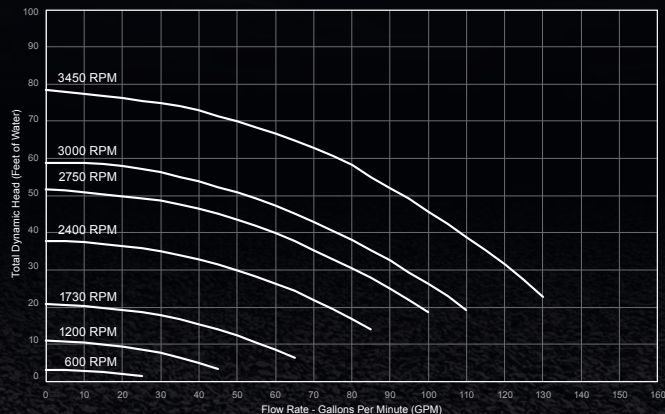

VS FloPro 2.7 HP Pump Curves

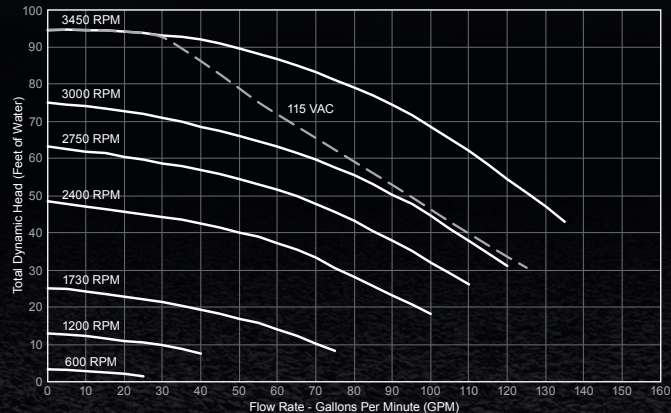

Specifications	THP	WEF	Voltage	Max Watts	Amps
VSFHP185DV2AS	1.85	8.5	230V 115V	1,700W 1,800W	7.5 15.5
VSFHP270DV2AS	2.7	7.3 8.7	230V 115V	2,550W 1,840W	10.5 16.0

Using the Adjustable Base with Spacers

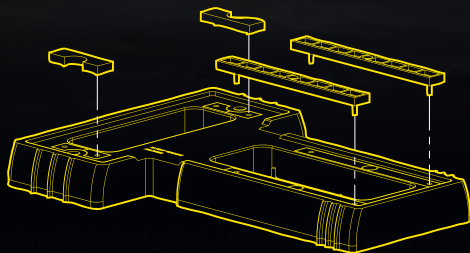

The small base + spacers are used when replacing a Pentair® WhisperFlo, IntelliFlo VSF, or Sta-Rite® Dyna-Glas pump.

1. Use a cutting tool to remove the spacers from the base.
2. Insert the pins on the spacers into the holes on the base as shown above.



When Replacing...

Hayward® Super Pump®

Pentair® SuperFlo®

Sta-Rite® SuperMax®

No Base Required



Hayward Super II®

Jandy® PlusHP

Jandy Max® HP



Small Base



Pentair WhisperFlo®

Pentair IntelliFlo VSF®

Sta-Rite Dyna-Glas®



Small Base with Spacers



Sta-Rite® Max-E-Pro®

Sta-Rite Dura-Glas®

Sta-Rite Dura-Glas II®

Sta-Rite Max-E-Glas®



Small Base + Large Base*



*Large Base R-kit part number R0546400 is sold separately. Small base with spacers included with every VS FloPro pump.

Dimension Comparison: VS FloPro and WhisperFlo

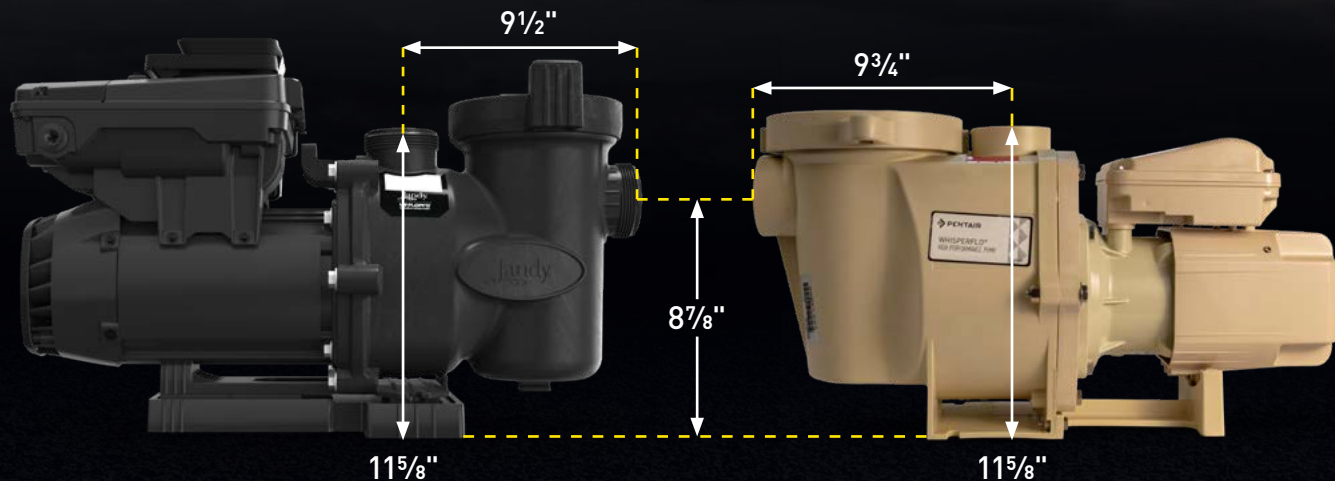

Jandy® VS FloPro™
w/ Small Base + Spacers

Pentair® WhisperFlo®

Pentair® WhisperFlo® Pump Models and Recommended VS FloPro™ Replacement Models

Pentair® Item Number	WhisperFlo Model	HP	SF	THP	Power	Length	Jandy® VS FloPro Equivalent Model
011511	WFE-2	0.50	1.90	0.95	115V/230V	24.5"	VSFHP185DV2AS
011578	WF-2	0.50	1.90	0.95	115V/230V	24.5"	
011771	WF-23	0.75	1.25	0.95	115V/230V	24.5"	
011512	WFE-3	0.75	1.67	1.25	115V/230V	24.5"	
011517	WFE-24	0.75	1.25	1.25	115V/230V	24.5"	
011579	WF-3	0.75	1.67	1.25	115V/230V	24.5"	
011772	WF-24	1	1.25	1.25	115V/230V	24.5"	
012530	WFDS-3	0.75	1.67	1.25	115V	24.5"	
012485	WFDS-24	1	1.25	1.25	115V	24.5"	
011513	WFE-4	1	1	1.65	115V/230V	24.7"	VSFHP270DV2AS
011518	WFE-26	1.5	1.1	1.65	115V/230V	24.7"	
011580	WF-4	1	1.65	1.65	115V/230V	24.7"	
011773	WF-26	1.5	1.1	1.65	115V/230V	24.7"	
011641	WFK-4	1	1.65	1.65	230V/460V	24.7"	
011486	WFDS-4	1.5	1.47	2.2	230V	24.7"	
012518	WFDS-26	1.5	1.65	1.65	230V	24.7"	
011514	WFE-6	1.5	1.47	2.2	230V	25.2"	
011519	WFE-28	2	1.1	2.2	230V	25.2"	
011581	WF-6	1.5	1.5	2.2	115V/230V	25.2"	
011774	WF-28	2	1.1	2.2	115V/230V	25.2"	
011642	WFK-6	1.5	1.47	2.2	230V/460V	25.2"	
011522	WFDS-6	1.5	1.47	2.2	230V	25.2"	
011524	WFDS-28	2	1.1	2.2	230V	25.2"	
011515	WFE-8	2	1.3	2.6	230V	25.7"	
011520	WFE-30	2.5	1.04	2.6	230V	25.7"	
011582	WF-8	2	1.3	2.6	230V	25.7"	
011775	WF-30	2.5	1.04	2.6	230V	25.7"	
011643	WFK-8	2	1.3	2.6	230V/460V	25.7"	
011523	WFDS-8	2	1.3	2.6	230V	25.7"	
011525	WFDS-30	2.5	1.04	2.6	230V	25.7"	

Dimension Comparison: VS FloPro and Super Pump

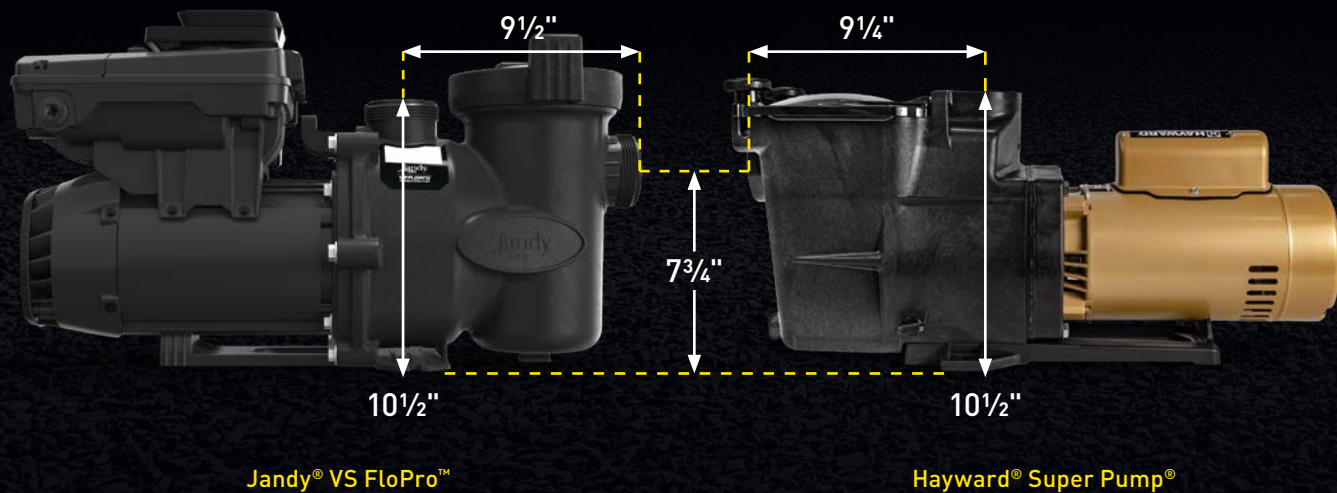

Hayward® Super Pump® Models and Recommended VS FloPro™ Replacement Models

Super Pump Model (Single-Speed)	HP	SF	THP	Power	Port Size	Length	Jandy® VS FloPro Equivalent Model
SP2600X5	0.50	1.20	0.60	115V	1.5"	23"	VSFHP185DV2AS
SP2605X7	0.75	1.00	0.75	115V/230V	1.5"	23.75"	
SP2607X10	1.00	1.10	1.10	115V/230V	1.5"	24"	
SP2670007X10	1.00	1.10	1.10	115V/230V	1.5"	24"	
SP2610X15	1.50	1.00	1.50	115V/230V	1.5"	25.25"	
SP2670010X15	1.50	1.00	1.50	115V/230V	1.5"	25.25"	
SP2621X25	2.50	1.00	2.50	230V	2"	26.25"	
SP2615X20	2.00	1.00	2.00	115V/230V	2"	25.75"	VSFHP270DV2AS
Super Pump Model (2-Speed)	HP	SF	THP	Power	Port Size	Length	Jandy VS FloPro Equivalent Model
SP2607X102S	1.00	1.00	1.00	230V	1.5"	22.75"	VSFHP185DV2AS
SP2610X152S	1.50	1.00	1.50	230V	1.5"	23.5"	
SP2615X202S	2.00	1.00	2.00	230V	2"	24"	VSFHP270DV2AS

Most Super Pump models utilize 1.5" threaded ports.
Use 2" to 1.5" slip reducers to utilize the Jandy 2" unionized fittings for perfect micro adjustments on existing plumbing.

SERVICEPRO[™]

WITH THE
**RIGHT
TOOLS**

YOU WON'T LEAVE
MONEY ON THE TABLE

Fluidra's ServicePro Rewards Program is designed specifically for pool service companies and gives you access to the right tools, including marketing services, software, training and valuable consumer incentives — everything you need to grow your business.



SIGN UP NOW AND UNLOCK OVER **\$5,000 IN VALUE** INCLUDING:



\$50 Sign-Up Bonus



\$200 Off Your First
5 Automation Purchases



5% Off First \$5K



Plus **Many More**
Exclusive Benefits



\$200 Off Your First
5 VS Pump Purchases



Sign up today!
FluidraRewards.com/Sign-Up

#DropInAJandy

A Fluidra Brand | Jandy.com | 1.800.822.7933

©2023 Zodiac Pool Systems LLC. All rights reserved. ZODIAC® is a registered trademark of Zodiac International S.A.S.U., used under license. All other trademarks are the property of their respective owners. 39406_SA



DROP IN REPLACEMENT GUIDE

GAS HEATERS



Why Jandy®?

Why settle for sufficient when you can get superior...

With Jandy equipment, you're getting a product that's easy to install in most pool pads, compatible with most existing setups and provides unparalleled performance and efficiency.



Protecting Your Bottom Line

We've got your back. Our equipment is **NOT** available for purchase on the internet. Only through you.



Drops In with Ease

Jandy equipment is engineered to easily replace any existing equipment in the pool pad with minimal plumbing adjustments. Jandy is a trade-up, not just a trade out.



Built to Last

Our equipment is designed for durability so you can get the job done and can trust that it will perform for the long haul.



Support You Can Count On

With our superior customer service and dedicated training team available to you when you need it most, you'll never be caught off-guard on-site.

Jandy
JMF
POOL & SPA HEATER

Why JXi™ is the First Choice When Replacing a Heater



Best Retrofit Option

3-port header for easy plumbing
and drop-in replacement of
Pentair® MasterTemp®.

Heater Shown with Optional VersaFlo Integrated Bypass
(Not Available with ASME® Compliant Models)

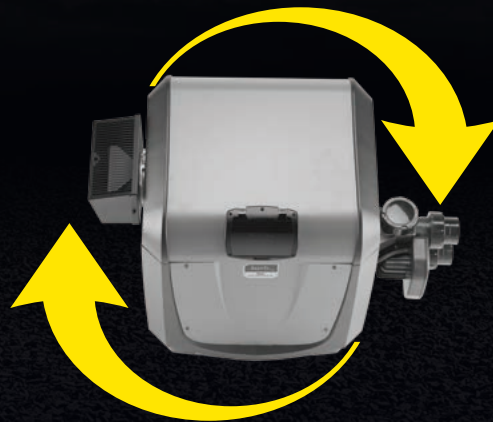

Flexible Installation

Top can be easily removed for increased
accessibility and rotated 180 degrees
so you never need to rotate headers.

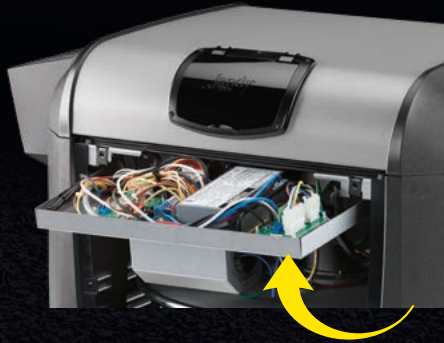

Easy to Service

Includes a flip up electrical panel for convenient setup and service.



Keeps Critters Out

The JXi is made with a fully encased shell to protect against rodent intrusion and damage.

Suggested Tools

- Pipe Wrench
- Channel Locks
- Phillips Screwdriver
- PVC Pipe Cutter
- Multimeter
- Monometer
- Impact Drill with Proper Bit
- Wire Cutter/Strippers



NOTE: Fluidra equipment must be installed and serviced by qualified or licensed pool professionals. Please see the installation manual for complete step-by-step instructions.



INSTALL CAP

**ATTACH PLUMBING WITH
INCLUDED JANDY® UNIONS**

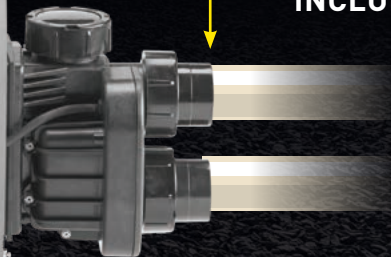

MasterTemp to JXi™ Comparisons

Polymer Header - Copper Tubes

Pentair® MasterTemp®	BTU Input	Jandy® JXi™	BTU Input
200	199,000	JXi200N/ JXi200P	199,000
250	250,000	JXi260N/ JXi260P	260,000
300	300,000	JXi260N*/ JXi260P*	260,000
400	399,000	JXi400N/ JXi400P	399,000

*If the current gas supply can handle the extra gas volume a JXi 400 can be used.

ASME Compliant Bronze Header - Copper Tubes

Pentair® MasterTemp®	BTU Input	Jandy® JXi™	BTU Input
200	199,000	Currently N/A	-
250	250,000	JXi260NC/ JXi260PC	260,000
400	399,000	JXi400NC/ JXi400PC	399,000

Polymer Header - CuproNickel Tubes

Pentair® MasterTemp®	BTU Input	Jandy® JXi™	BTU Input
250	250,000	Currently N/A	-
400	399,000	JXi400NN/ JXi400PN	399,000

ASME Compliant Bronze Header - CuproNickel Tubes

Pentair® MasterTemp®	BTU Input	Jandy® JXi™	BTU Input
200	199,000	Currently N/A	-
250	250,000	JXi260NS/ JXi260PS	260,000
400	399,000	JXi400NS/ JXi400PS	399,000

JXi™ Parts

Item #	Description
R0457502	Jandy Igniter Kit, JXi
R0456500	Jandy Temperature Sensor Kit
R0589700	Jandy Thermal Regulator Valve
R0458100	Jandy Power Center PCB
R0592300	Jandy High Limit Temp Sensors
R0593400	Jandy Anchor Brackets
R0456900	Jandy Ignition Control Module
R0589500	Jandy Gasket & Seals Kit (Heater manifold)
R0456301	Jandy Transformer, JXi Replacement Kit
R0719500	Jandy JXi Power Interface Board (PIB), GEN2

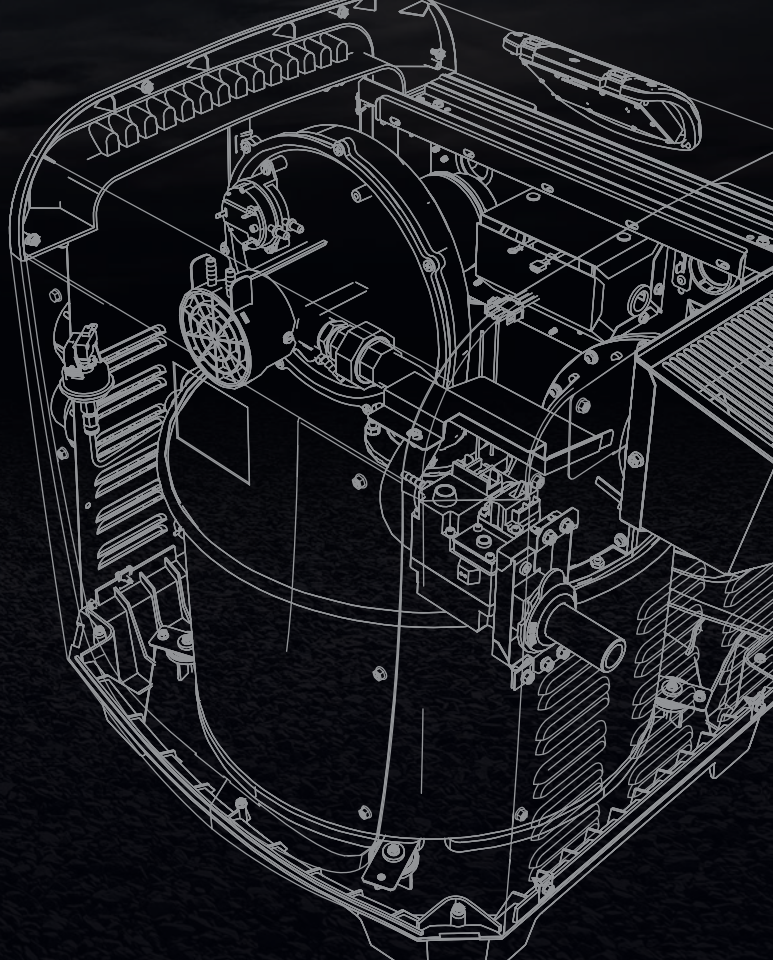

A Footprint That Fits Right In

JANDY® JXi™ DIMENSIONS

INLET SIDE

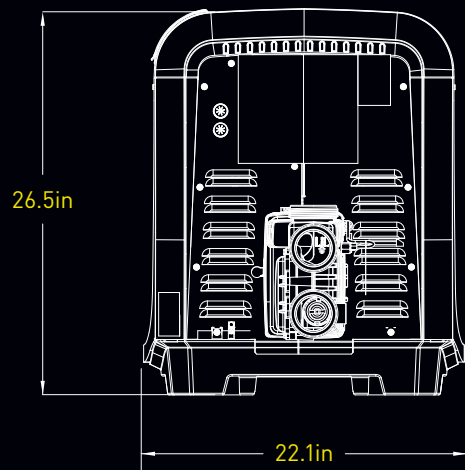

FRONT

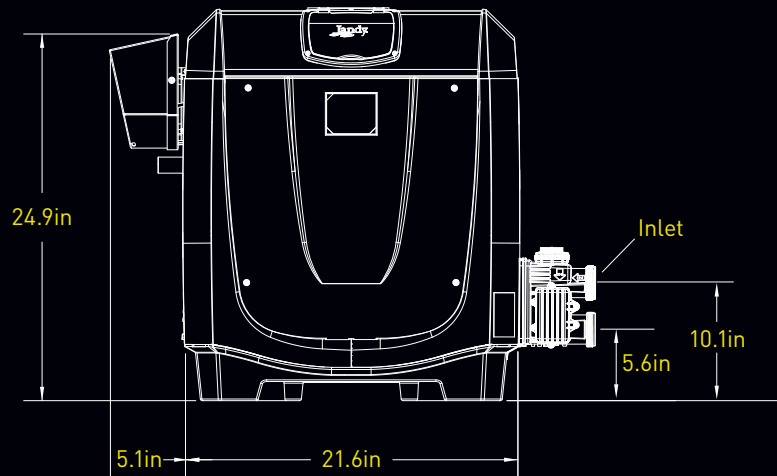

NOTE: Dimensions are identical on all JXi heater models

PENTAIR® MASTERTEMP DIMENSIONS

INLET SIDE

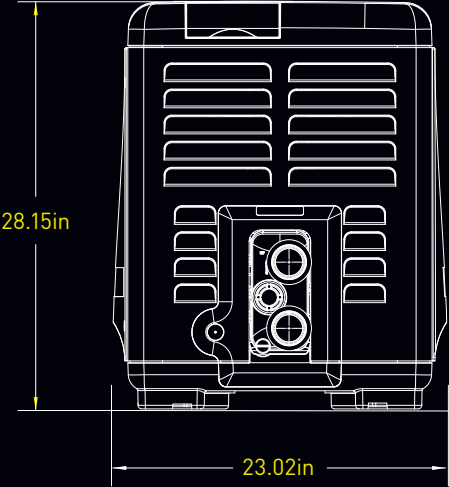

FRONT

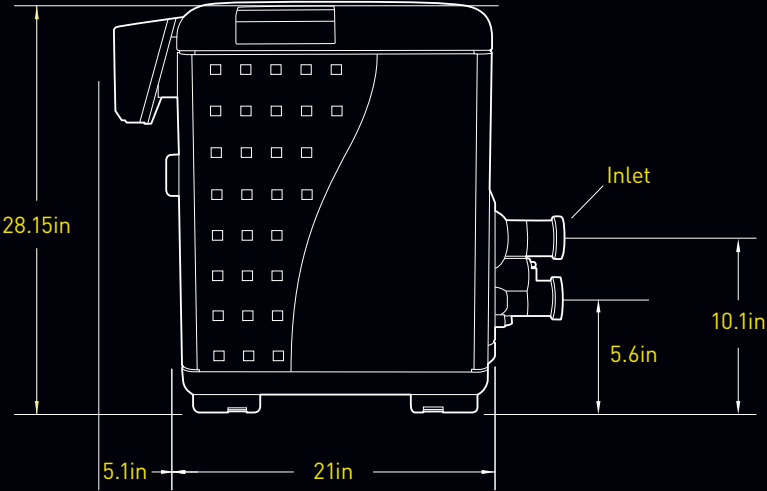

Why Jandy® JXi™ is the Best Gas Heater

VersaFlo™ Integrated Bypass Technology

The JXi with VersaFlo is the first and only swimming pool heater that automatically directs the flow of water through the heat exchanger when heat is needed and around the heater when heating is not needed — allowing you to save money on the filtration pump electric bill.

VersaFlo Integrated bypass is available factory-installed on select models or can easily be added to any JXi on site.

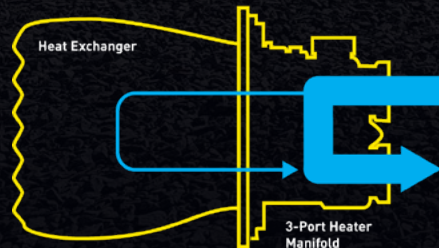
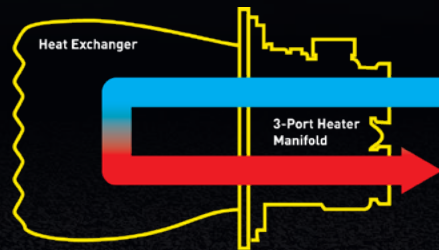



Bypass Mode

VersaFlo integrated bypass diverts water flow around the heat exchanger when not heating water.

Heat Mode

When there is a call for heat, water is automatically directed through the heat exchanger.

SERVICE**PRO**[™]

WITH THE
**RIGHT
TOOLS**

YOU WON'T LEAVE
MONEY ON THE TABLE

Fluidra's ServicePro Rewards Program is designed specifically for pool service companies and gives you access to the right tools, including marketing services, software, training and valuable consumer incentives — everything you need to grow your business.



SIGN UP NOW AND UNLOCK OVER **\$5,000 IN VALUE** INCLUDING:



\$50 Sign-Up Bonus



\$200 Off Your First
5 Automation Purchases



5% Off First \$5K



Plus **Many More**
Exclusive Benefits



\$200 Off Your First
5 VS Pump Purchases



Sign up today!
FluidraRewards.com/Sign-Up



#DropInAJandy

A Fluidra Brand | [Jandy.com](https://www.jandy.com) | 1.800.822.7933

©2023 Zodiac Pool Systems LLC. All rights reserved. ZODIAC™ is a registered trademark of Zodiac International, S.A.S.U., used under license. All other trademarks are the property of their respective owners. 87688_SA