



ITEM #0553449

VENTILATION FAN WITH LIGHT

MODEL #7113-01-L

Français p. 14

Español p. 27

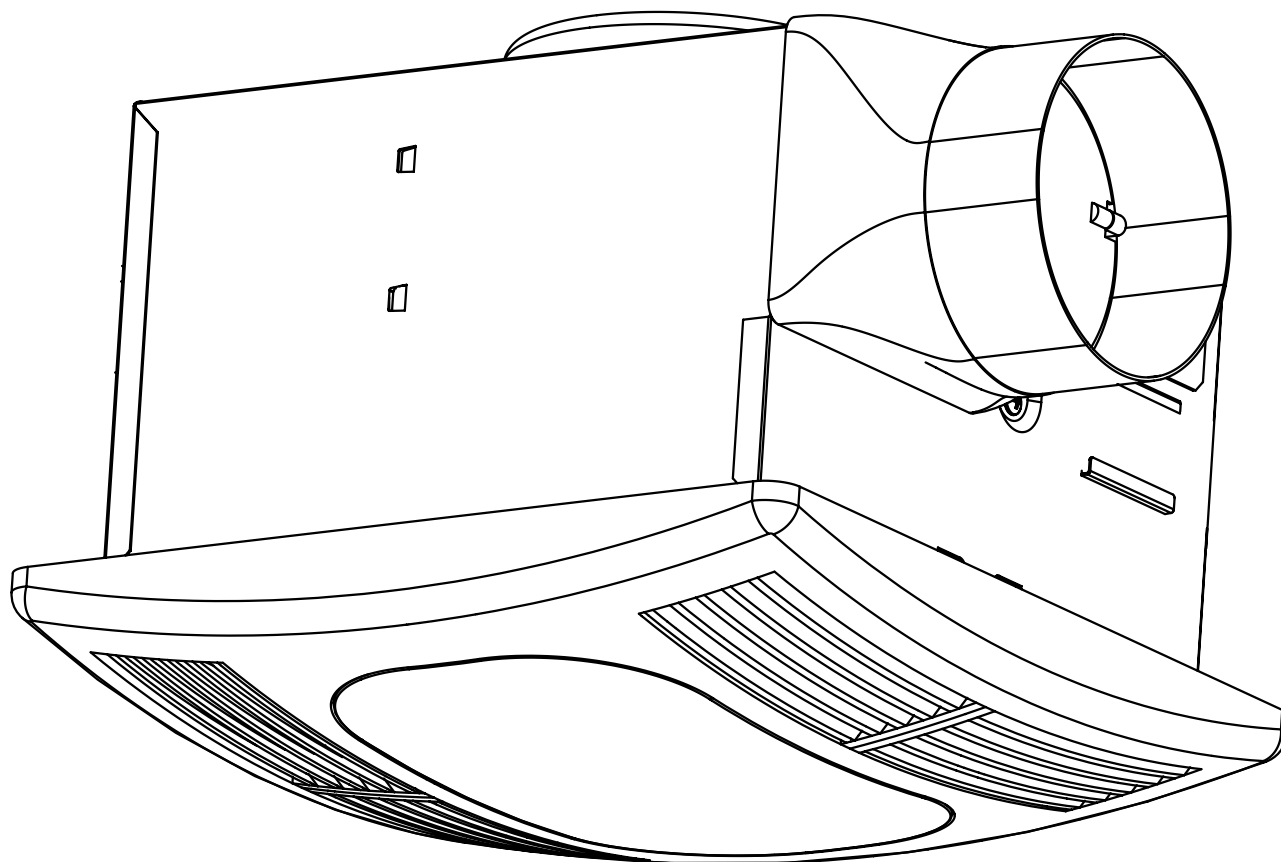

ATTACH YOUR RECEIPT HERE

Serial Number _____ Purchase Date _____



Questions, problems, missing parts? Before returning to your retailer, call our customer service department at 1-866-994-4148, 8 a.m. - 6 p.m., EST, Monday - Thursday, 8 a.m. - 5 p.m., EST, Friday.

TABLE OF CONTENTS

Product Specifications2

Package Contents3

Safety Information4

Preparation5

New Construction Assembly Instructions6

Existing Construction Assembly Instructions 10

Care and Maintenance 11

Troubleshooting 12

Warranty 13

PRODUCT SPECIFICATIONS

SPECIFICATIONS
Airflow: 90 CFM
120 V, 60 Hz
Duct diameter: 4 in.
Sound output: 1.5 Sones

SPECIFICATIONS
Power consumption: 32 W
Exhaust fan speed: 790 RPM
Weight: 12.0 lbs.

TYPICAL INSTALLATION

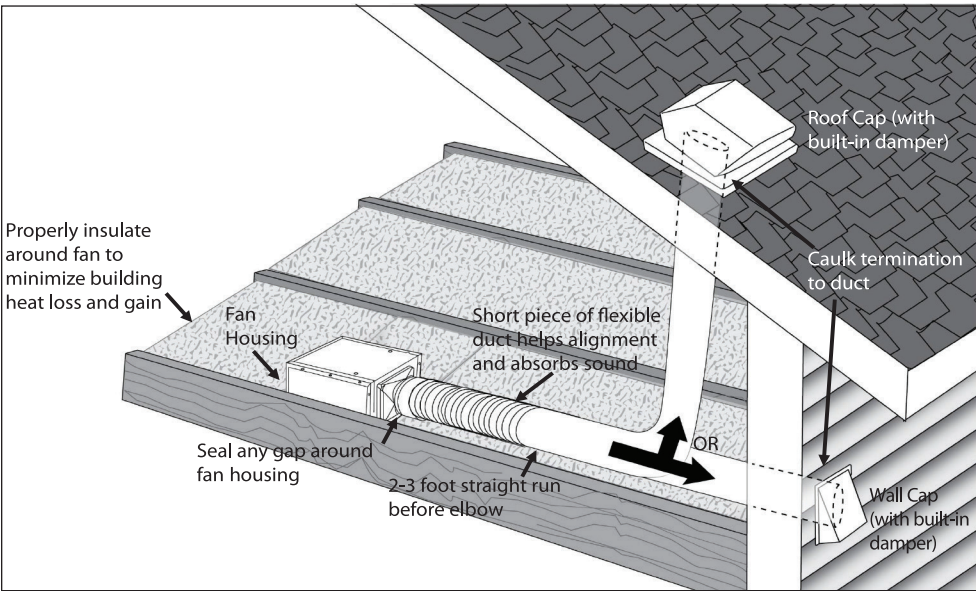

PACKAGE CONTENTS

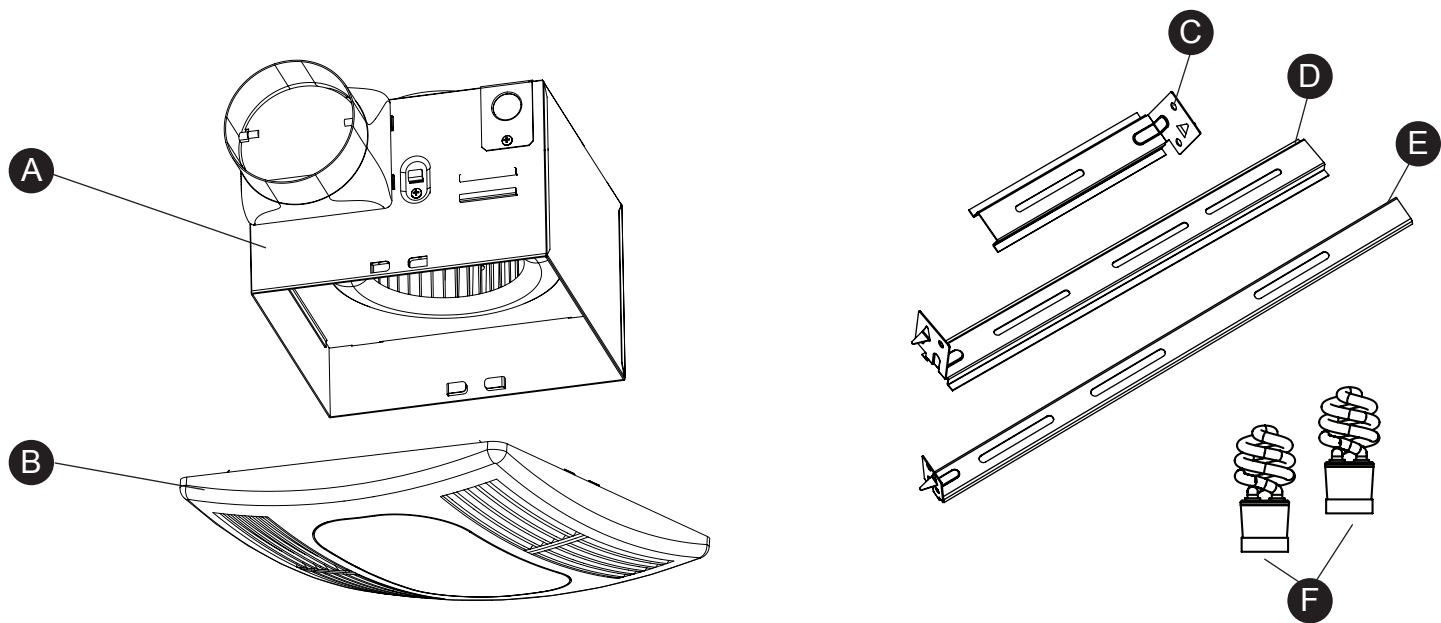

PART	DESCRIPTION	QUANTITY
A	Fan body	1
B	Grille	1
C	Suspension bracket I	1

PART	DESCRIPTION	QUANTITY
D	Suspension bracket II	1
E	Suspension bracket III	1
F	GU24, 13 watt bulb	2

HARDWARE CONTENTS (shown actual size)

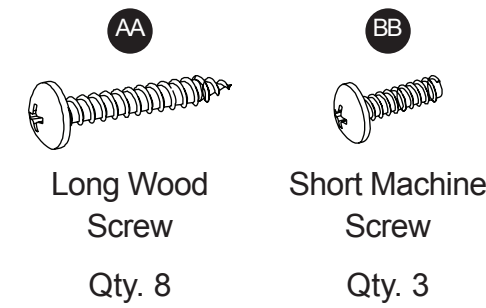



SAFETY INFORMATION

Please read and understand this entire manual before attempting to assemble, operate or install the product.

1. Always disconnect the power supply prior to servicing the fan, motor or junction box.
2. Installation work must be carried out by a qualified person(s) in accordance to all local and safety codes including the rules for fire-rated construction.
3. Follow all local building, safety and electrical codes as well as NEC (National Electrical Code) and OSHA (Occupational Safety and Health Act).
4. Electric Service supply must be 120 volts, 60 hertz.
5. This unit must be properly grounded.
6. Do not bend or kink the power wires.
7. Exercise care to not damage existing wiring when cutting or drilling into walls or ceilings.
8. Sufficient air supply is required for proper combustion and the exhaustion of gases through the chimney (flue) of fuel burning equipment to prevent back-drafting. See the standards of NFPA (National Fire Protection Association) and ASHRAE (American Society for Heating Refrigeration and Air Conditioning Engineers) and the local building code authorities.
9. Do not use this fan with any solid state control device, such as a remote control, dimmer switch, or certain timers. Mechanical timers are not solid state devices.
10. This ventilation fan is approved for use over a bathtub or shower when installed in a GFCI protected circuit. Do not use fans over a bathtub or shower that are not approved for that application and marked accordingly.
11. Do not install in a cooking area.
12. Do not use to exhaust hazardous or explosive vapors.
13. Fans should always be vented to the exterior and in compliance with local codes.
14. Do not install in a ceiling with insulation greater than R42.
15. Duct work should be installed in a straight line with minimal bends.
16. Duct work size must be the same size as the discharge and should not be reduced. Reducing the duct size may increase fan noise.
17. Prior to service or cleaning this unit, shut off power supply at the panel and lock to prevent the power from being turned on. If the panel cannot be locked, clearly mark the panel with a warning tag to prevent the power from being turned on.
18. Use this unit in the manner intended by the manufacturer. If you have any questions. Please call customer service.

PREPARATION

Before beginning assembly of product, make sure all parts are present. Compare parts with package contents list and hardware contents list. If any part is missing or damaged, do not attempt to assemble the product.

Estimated Assembly Time: 60 minutes

PREPARATION

Tools Required for Assembly (not included): Hammer, Drill Bits, Flathead Screwdriver, Wire Nuts, Nails, Duct Tape, Phillips Screwdriver, Utility Knife

Helpful Tools (not included): Electric Drill, Wood Screws

WARNING: Turn off electricity at breaker box before beginning installation.

Carefully remove unit from carton.

Check area above installation location to be sure that wiring can run to the planned location and that duct work can be run and the area is sufficient for proper ventilation.

Inspect duct work and wiring before proceeding with installation.

Before installation, provide inspection and future maintenance access at a location that will not interfere with installation work.

You may need the help of a second person to install this fan; one person on the attic side and one on the room side.

Note: Installations may vary depending on how the previous bath fan was installed. Supplies necessary for the installation of your bath fan are not all included; however, most are available at your local home improvement or hardware store.

DIMENSION REQUIREMENTS

Ceiling Opening (L)	Ceiling Opening (W)	Ceiling Opening (H)
9.4 in.	9.4 in.	7.4 in.

WIRING DIAGRAM

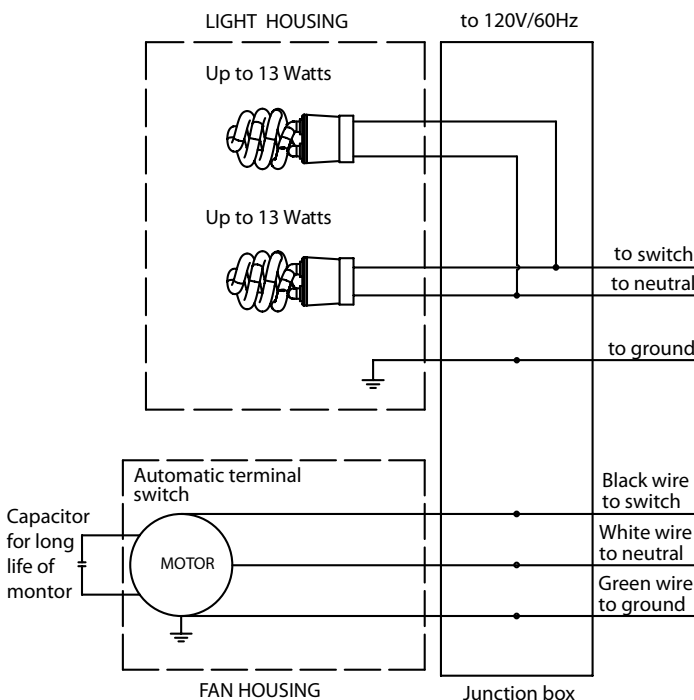

QUICK CONNECTOR INSTRUCTIONS

To be sold only with installation instructions.

WARNING: Wiring must comply with all applicable electrical codes. Turn OFF power before removing or installing connectors.

WARNING: COPPER TO COPPER ONLY. Do not use Aluminum wire.

CAUTION: Accessory part (quick connector) should meet installation instructions below.

NOTE: The connector is reusable on solid wires of the same wire gage or smaller. Do not reuse the connector on stranded wires.

- Strip wires 3/8"-1/2"
- Grip the wire firmly and push the stripped end of the wire into the open port of the connector. Use only one conductor per port.
- Verify the stripped end of the wires is fully inserted to the back of the connector.

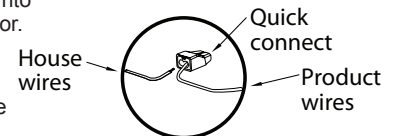

NOTE: Important wire information. Maximum temperature rating 105°C (221°F). 600 volts maximum for building wire and 1000 volts maximum for building wire and 1000 volts maximum in signs and lighting fixtures. The acceptable wire range includes: Solid: 12-18 AWG.

NEW CONSTRUCTION ASSEMBLY INSTRUCTIONS

NEW CONSTRUCTION – ATTACHING TO THE JOIST

BEFORE INSTALLATION

Turn off power source. Review all safety precautions.

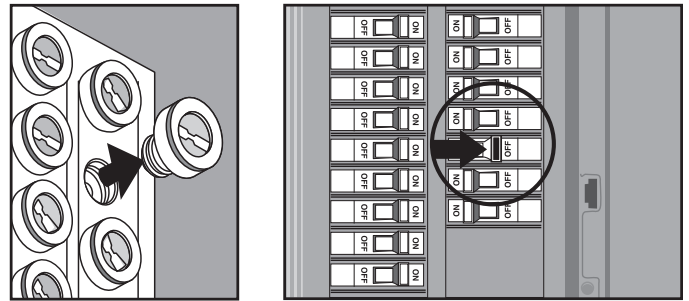

1. Insert the suspension bracket into the fan body. (If spacing between joists is 21-1/4 in. to 23-1/2 in. (540 to 597 mm), connect suspension bracket I and II).

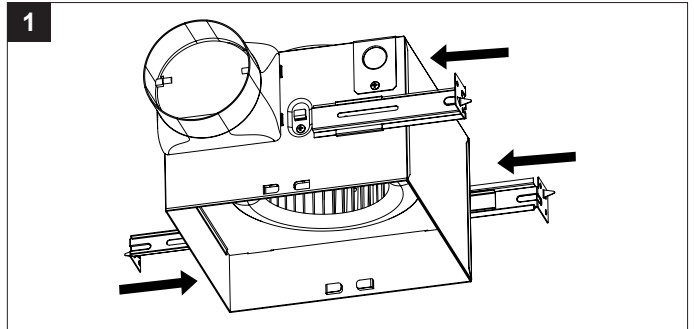

2. Mount the fan body to joist using the suspension brackets and long wood screws.

Hardware Used

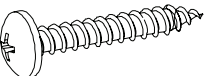
AA Long wood screw  x 2

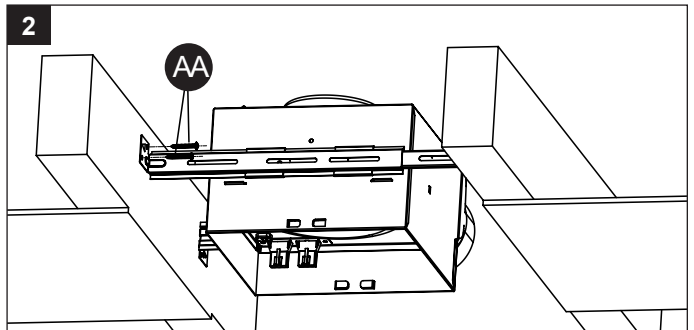

3. **CAUTION:** Dimension “B” should allow for thickness of ceiling board used in your application. **Do not flush mount to joist. Flange should be flush with ceiling board.**

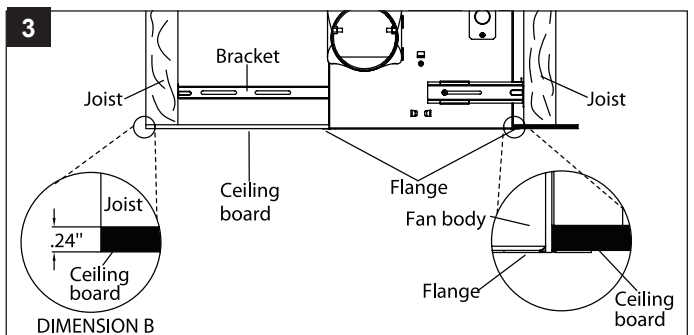

4. Refer to wiring diagram on page 5. Remove the junction box cover. Using quick connectors, connect house wires to ventilating fan wires: black to black; white to white; green to green. Replace the junction box cover.

CAUTION: If your house wires do not match these colors, you must determine what each house wire represents before connecting and you may need to consult an electrical contractor to determine this safely. Mount junction box cover carefully so lead wires are not pinched.

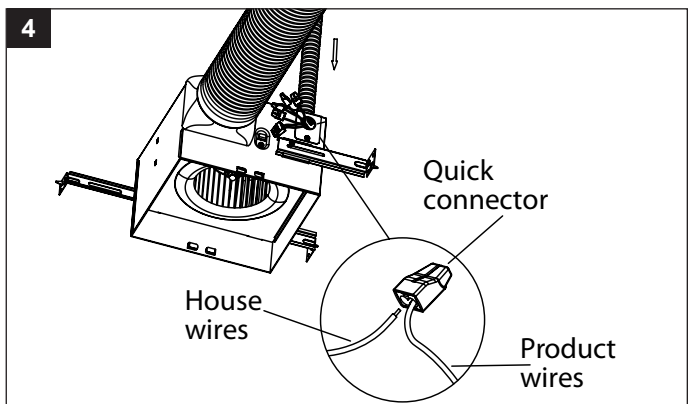

NEW CONSTRUCTION ASSEMBLY INSTRUCTIONS

5. Install a circular duct (not included) and secure it with duct tape or clamps (neither included).

Finish ceiling work. Ceiling hole should be flush with the edge of the flange. **(DO NOT FLUSH MOUNT TO JOIST. Flange should be flush with ceiling board.)** See dimensions for ceiling hole on page 5. If joist is present, insert long wood screws through flange and through ceiling to secure fan to joist.

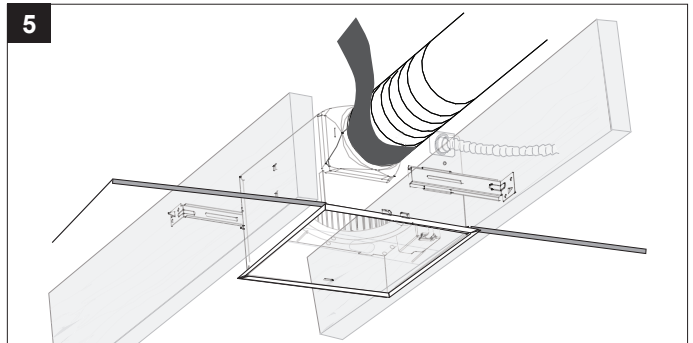

6. Attach plug connector to receptacle.

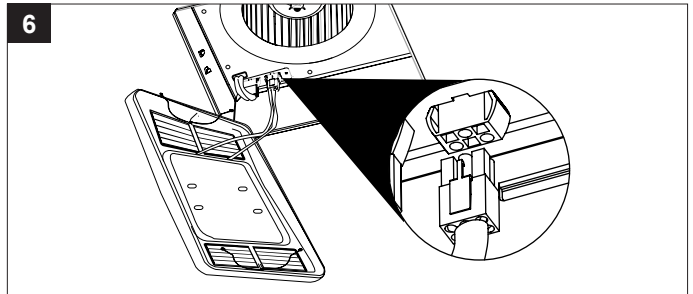

7. Install two (2) GU24, 13 watt bulbs (F).

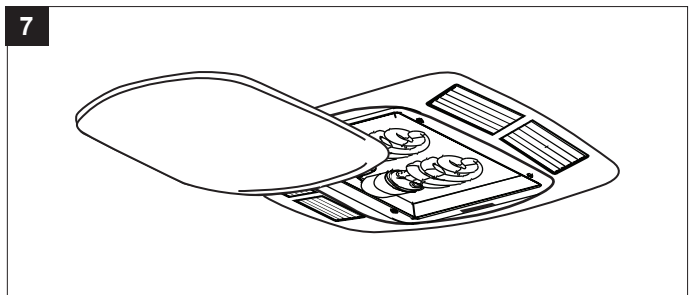

8. Pinch mounting springs on grille (B) and insert into narrow rectangular slots inside the fan housing next to the fan motor.

Turn on electricity at breaker box after finishing installation.

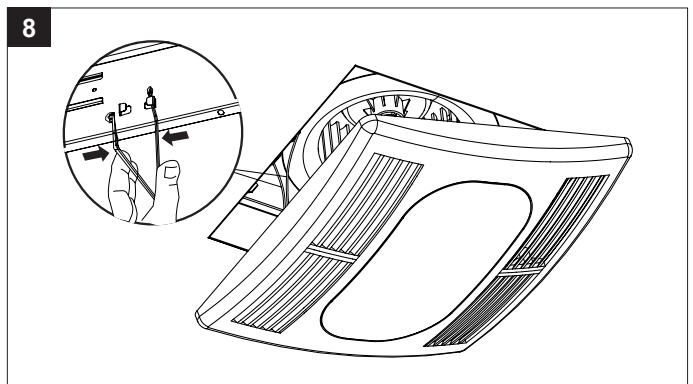

EXISTING CONSTRUCTION ASSEMBLY INSTRUCTIONS

Installing the fan body in an existing building **REQUIRES AN ACCESSIBLE AREA** (attic or crawl space) above the planned installation location and existing duct and wiring.

BEFORE INSTALLATION

Turn off power source. Review all safety precautions.

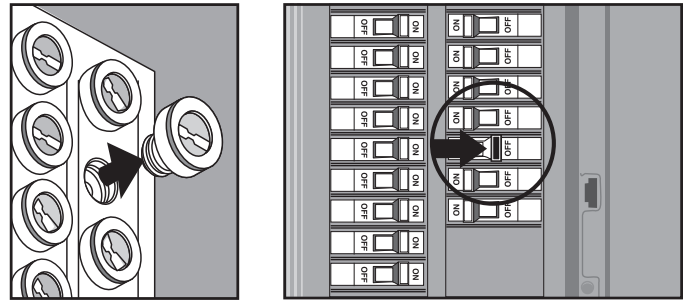

1. Remove existing fan.

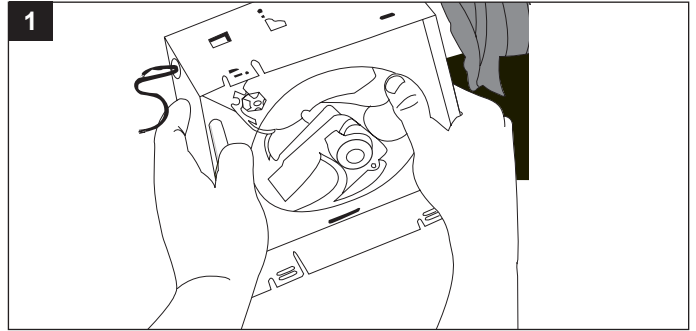

2. Measure the opening to ensure it is large enough to accommodate the new fan body (A) (9.4 in. x 9.4 in.).

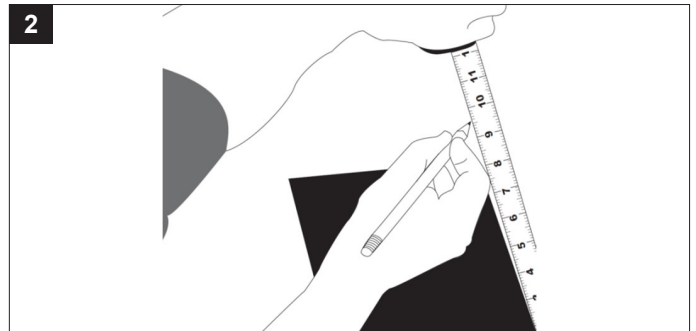

3. If this fan is not replacing an old fan, be sure to cut a 9.4 in. x 9.4 in. opening for the fan body (A).

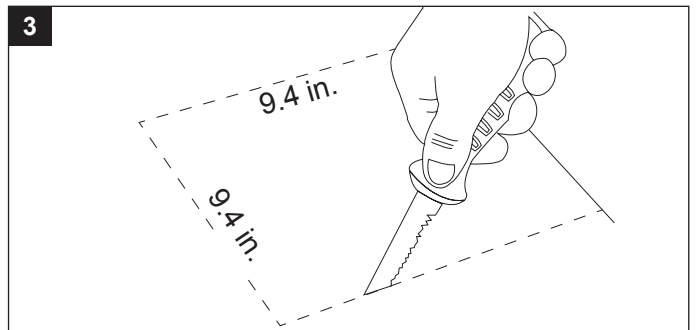

4. Insert the suspension bracket into the fan body. (If spacing between joists is 21-1/4 in. to 23-1/2 in. (540 to 597 mm), connect suspension bracket I and II).

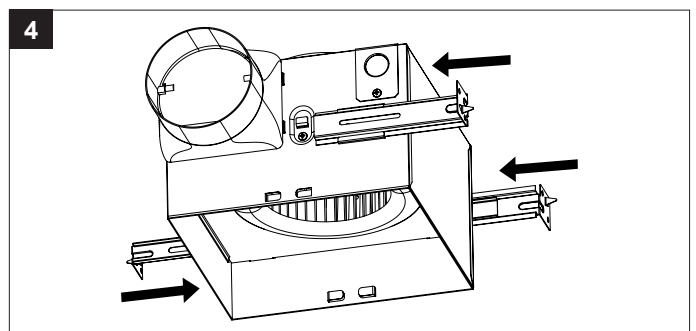

EXISTING CONSTRUCTION ASSEMBLY INSTRUCTIONS

5. Insert fan body (A) into the ceiling cut out making sure to align the duct connector with the fan body (A). Flange should be on the bathroom side of the drywall.

NOTE: Duct/outlet adapter can be removed for easier installation through the ceiling opening.

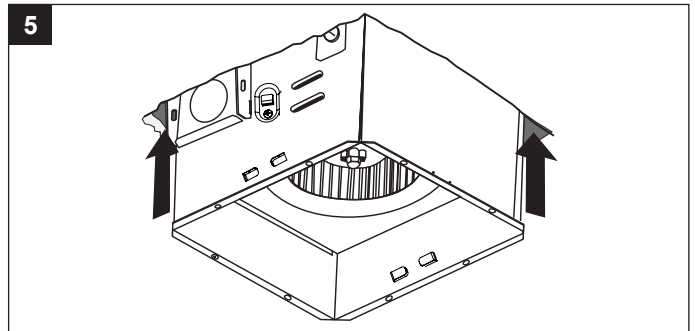

6. Mount the fan body to joist using the suspension brackets and long wood screws.

Hardware Used

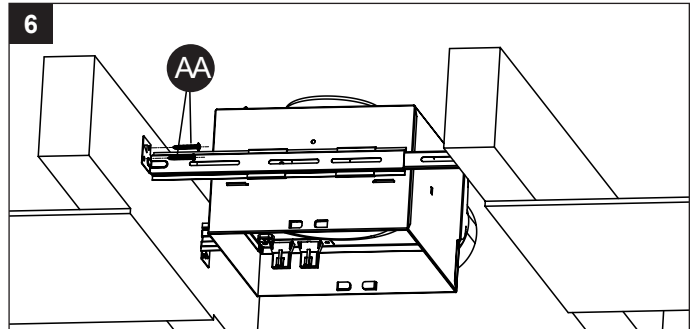
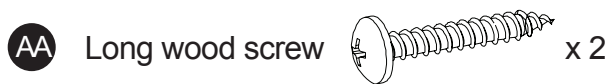

7. **CAUTION:** Dimension "B" should allow for thickness of ceiling board used in your application. Do not flush mount to joist. Flange should be flush with ceiling board.

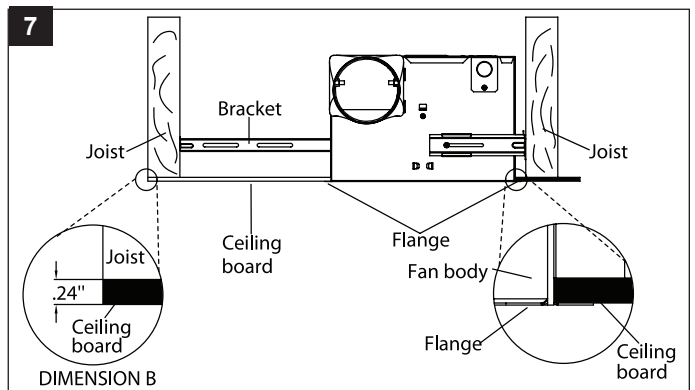

8. Refer to wiring diagram on page 5. Remove the junction box cover. Using quick connectors, connect house wires to ventilating fan wires: black to black; white to white; green to green. Replace the junction box cover.

CAUTION: If your house wires do not match these colors, you must determine what each house wire represents before connecting and you may need to consult an electrical contractor to determine this safely. Mount junction box cover carefully so lead wires are not pinched.

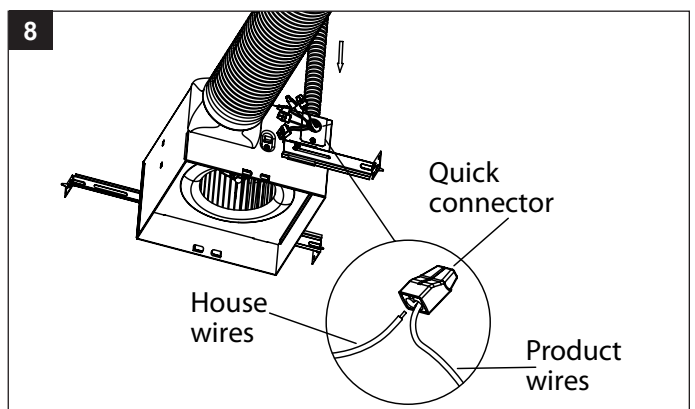

EXISTING CONSTRUCTION ASSEMBLY INSTRUCTIONS

9. Install a circular duct (not included) and secure it with duct tape or clamps (neither included).

Finish ceiling work. Ceiling hole should be flush with the edge of the flange. **(DO NOT FLUSH MOUNT TO JOIST. Flange should be flush with ceiling board.)** See dimensions for ceiling hole on page 5. If joist is present, insert long wood screws through flange and through ceiling to secure fan to joist.

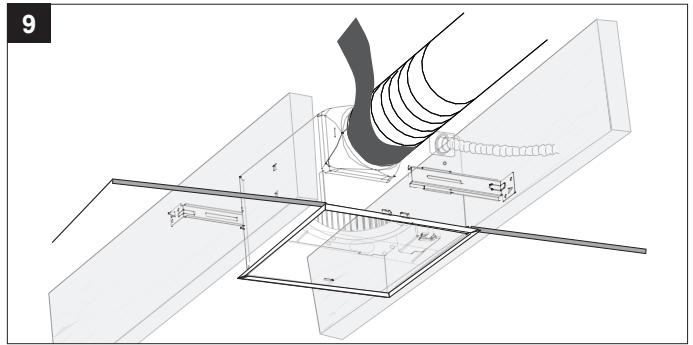

10. Attach plug connector to receptacle.

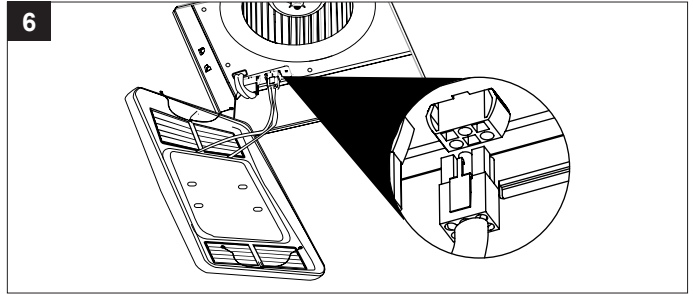

11. Install two (2) GU24, 13 watt bulbs (F).

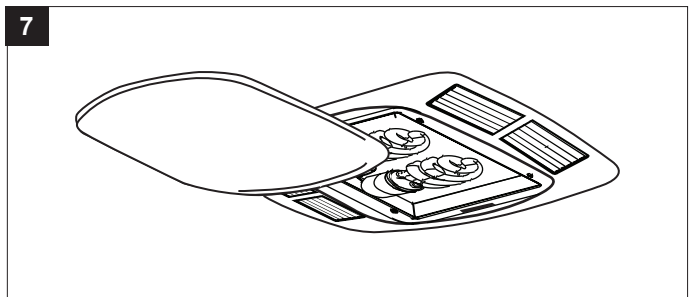

12. Pinch mounting springs on grille (B) and insert into narrow rectangular slots inside the fan housing next to the fan motor.

Turn on electricity at breaker box after finishing installation.

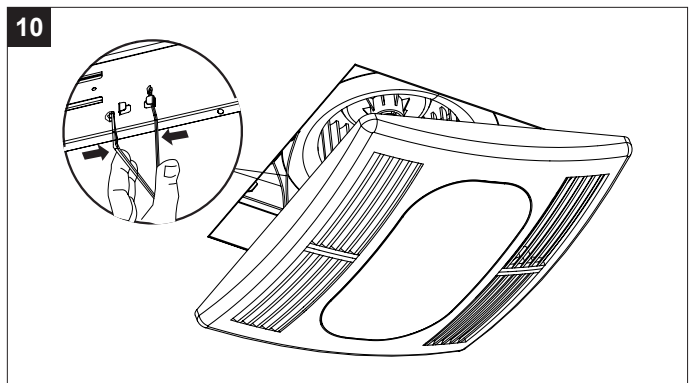

CARE AND MAINTENANCE

WARNING: Disconnect power supply before servicing. See **SAFETY INFORMATION** before proceeding. Routine maintenance should be done at least once a year.

CAUTION

- Never use solvents, thinner or harsh chemicals for cleaning the fan.
- Do not allow water to enter the motor.
- Do not immerse resin parts in water over 140° F.

1. Remove grille by squeezing spring and pull down.

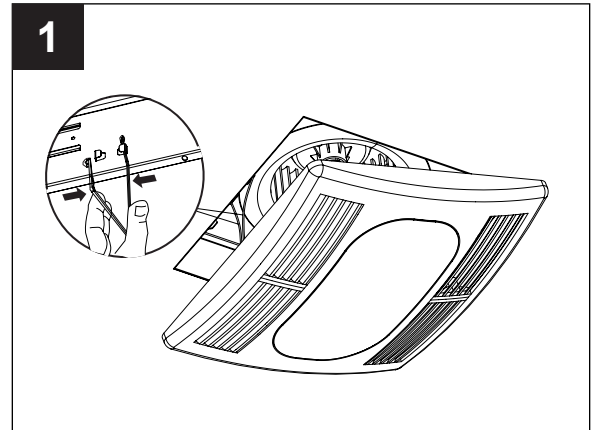

2. Wash and clean the grille in a sink and dry with a cloth.

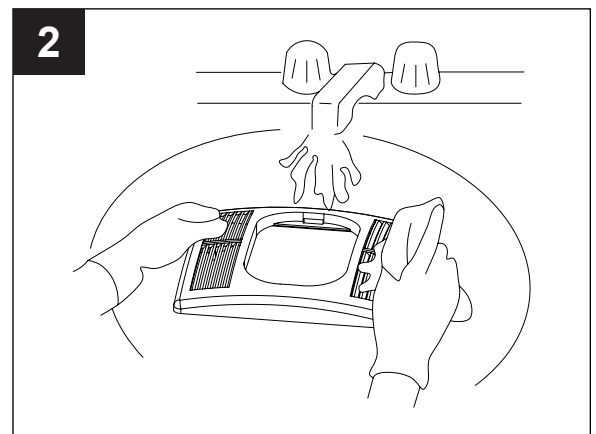

3. Remove dust and dirt from the fan housing with a vacuum cleaner.

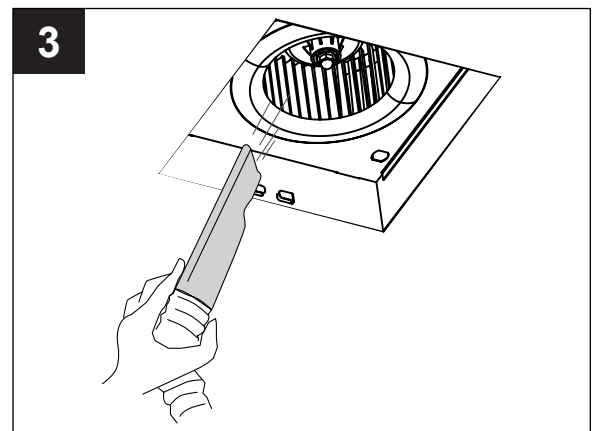

CARE AND MAINTENANCE

4. Dampen cloth with dish detergent, wipe the fan housing and dry with a cloth.

Replace the grille.

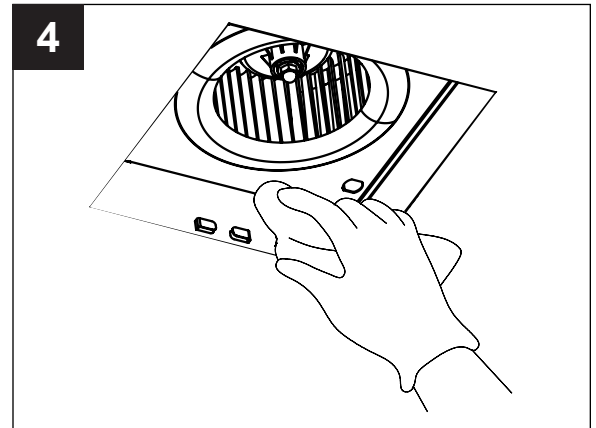

TROUBLESHOOTING

PROBLEM	POSSIBLE CAUSE	CORRECTIVE ACTION
The fan seems louder than it should	CFM too great	Be sure the CFM rating on the fan matches the size of your room
	Damper not working properly or damaged	Check damper to ensure it is opening and closing properly. If the damper has become damaged, please call Customer Service
	Bend in duct too close to fan discharge	Be sure you do not have any sharp bends in duct closer than 18 in. to the fan discharge
	Fan discharge reduced to fit smaller duct	Use recommended size ducting to reduce fan noise
	Fan body not securely attached	Be sure the fan is securely attached to your ceiling joists
The fan is not clearing the room	Insufficient intake airflow within room	Be sure a door or window is slightly ajar or opened to allow airflow. The fan is not able to draw air out of the room without enough airflow to draw from
	Insufficient CFM	Be sure the CFM rating on the fan matches the requirements for your room size NOTE: Using a tissue is not an accurate method for determining if the fan is operating properly. If the fan clears steam from the room within approximately 15 minutes of completing your shower, then the fan is operating properly

LIMITED 5-YEAR WARRANTY

If this product fails due to a defect in materials or workmanship at any time during the first FIVE years of ownership, the manufacturer will replace it free of charge, postage-paid at their option. This warranty does not cover products that have been abused, altered, damaged, misused, cut or worn. This warranty does not cover use in commercial applications. Use only manufacturer-supplied genuine warranty repair replacement parts to repair this fan. Use of non-genuine repair parts will void your warranty. The manufacturer DISCLAIMS all other implied or express warranties including all warranties of merchantability and/or fitness for a particular purpose. As some states do not allow exclusions or limitations on an implied warranty, the above exclusions and limitations may not apply. This warranty gives you specific legal rights, and you may have other rights that vary from state to state.

This warranty is limited to the replacement of defective parts only. Labor charges and/or damage incurred during installation, repair, replacement as well as incidental and consequential damages connected with the above are excluded. Any damage to this product as a result of neglect, misuse, accident, improper installation or use other than the purpose SHALL VOID THIS WARRANTY.

Shipping costs for return product as part of a claim on the warranty must be paid for by the customer.

Inquiries regarding warranty claims can be directed to 1-866-994-4148, 8 a.m. - 6 p.m., EST, Monday - Thursday, 8 a.m. - 5 p.m., EST, Friday.

Printed in China
Utilitech & UT Design® is a registered
trademark of LF, LLC. All rights reserved.