



Affordable. Reliable. Home Improvement.

MANUAL REEL

MODEL:HR-026-1

Technical Support and E-Warranty Certificate

www.vevor.com/support

VEVOR

Affordable. Reliable. Home Improvement.

MANUAL REEL

MODEL:HR-026-1

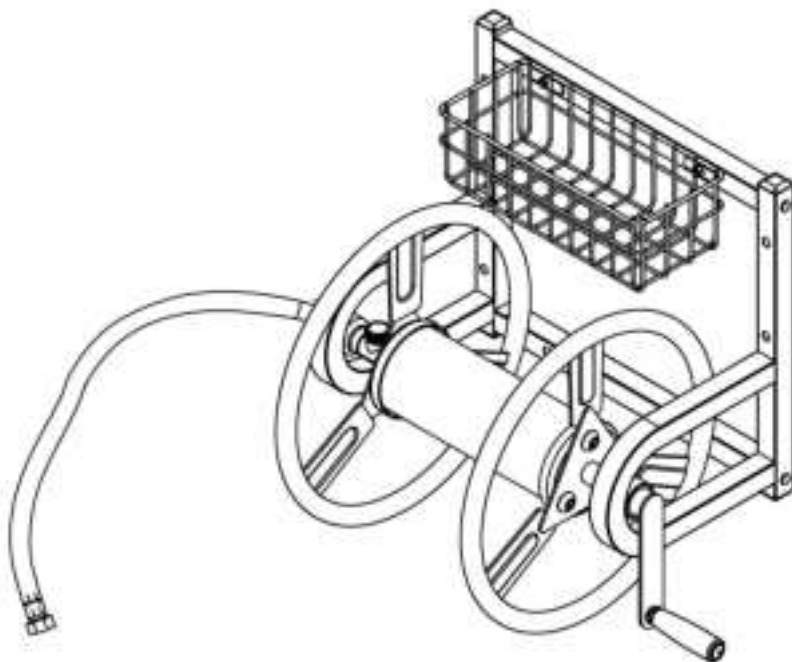

This is the original instruction, please read all manual instructions carefully before operating. VEVOR reserves a clear interpretation of our user manual. The appearance of the product shall be subject to the product you received. Please forgive us that we won't inform you again if there are any technology or software updates on our product.

PARTS LIST



1 SPOOL ENDS (2)



2 SPOOL RODS (1)

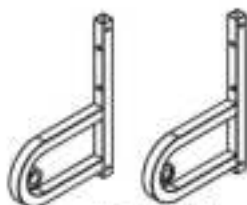

3 FRAME (2)



4 CROSS BAR (2)



5 CRANK HANDLE (1)



6 WIRE BASKET (1)



7 SPRING (1)



8 BRASS SWIVEL 3/4 (1)



9 BRASS TEE 3/4 (1)



10 RUBBER HANDLE W/BOLT (1)



11 SPACER WASHER (3)



12 M8*40mm BOLTS (4)



13 M6*40mm BOLTS (2)



14 M5 LOCK NUTS (2)



15 M8*15mm BOLTS (6)



16 LEADER HOSE (1)



12mm 10mm

17 WRENCH (2)



⊙ Flat Washer (6)

⊙ Lock Washer (6)

⊙ Nuts (6)

18 M8*80mm Masonry Anchor Sleeve (6)

ASSEMBLY STEP

STEP:1

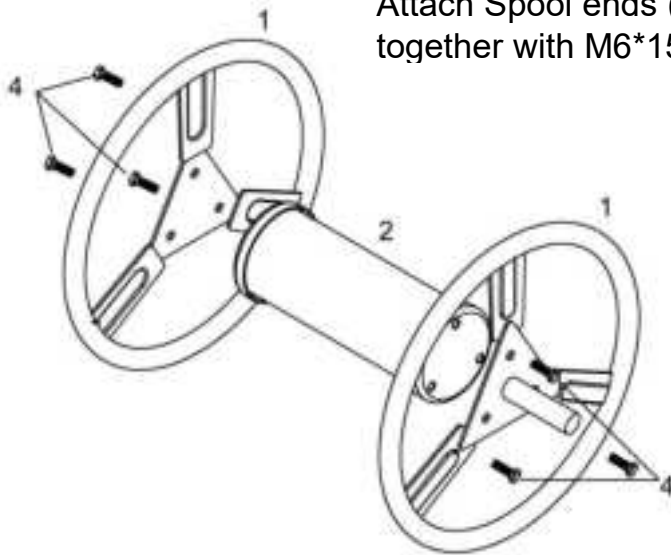

Attach Spool ends (1) and Spool rods (2) together with M6*15mm bolts(15)

STEP:2

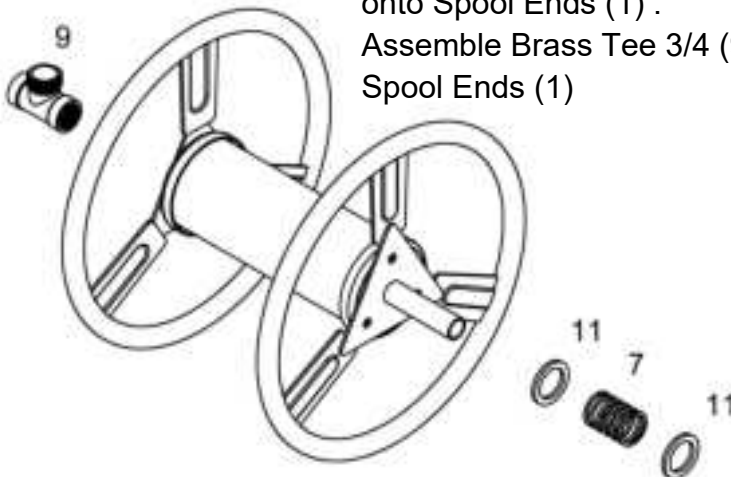

Assemble Spacer Washer(11)and Spring(7) onto Spool Ends (1) .

Assemble Brass Tee 3/4 (9) to the other Spool Ends (1)

STEP:3

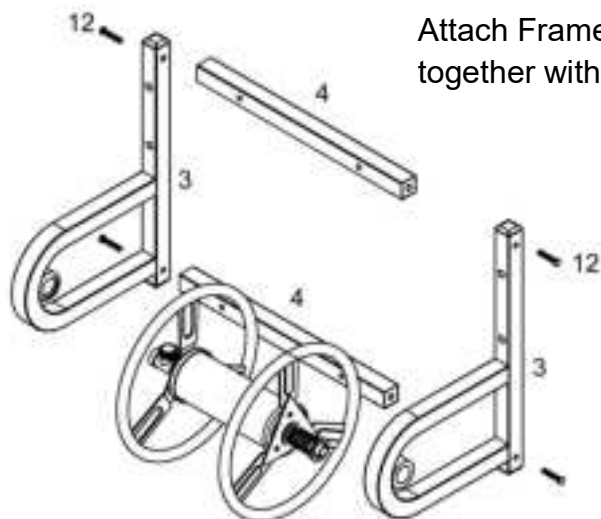

Attach Frame (3) and Cross bar (4) together with M8*40mm bolts(12)

STEP:4

Assemble Spacer Washers (11) and Brass swivel 3/4 (8) and Frame(3) onto Brass Tee (9).

Assemble Crank Handle (5) onto Frame(3).

Attach Rubber Handle W/bolt(10) to Crank handle using handle bolt.

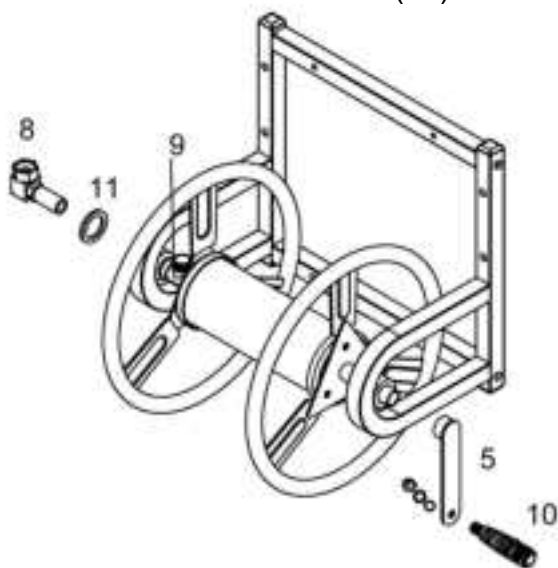

STEP:5

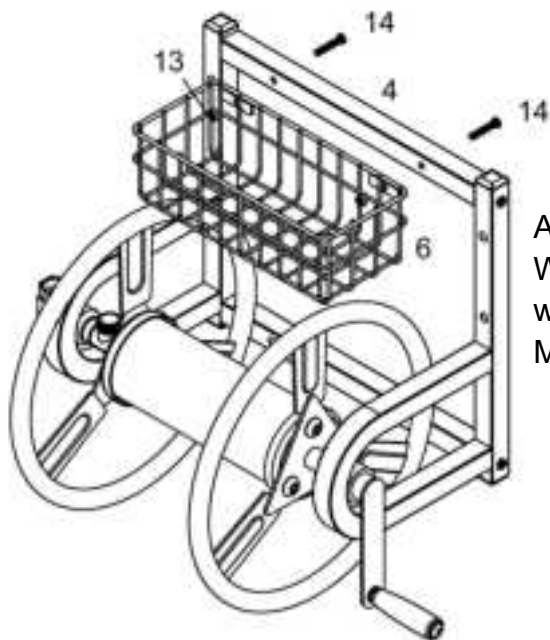

Attach Cross Bar (4) and Wire basket (6) together with M6*40mm bolts (13) and M6 lock nuts (14).

STEP:6

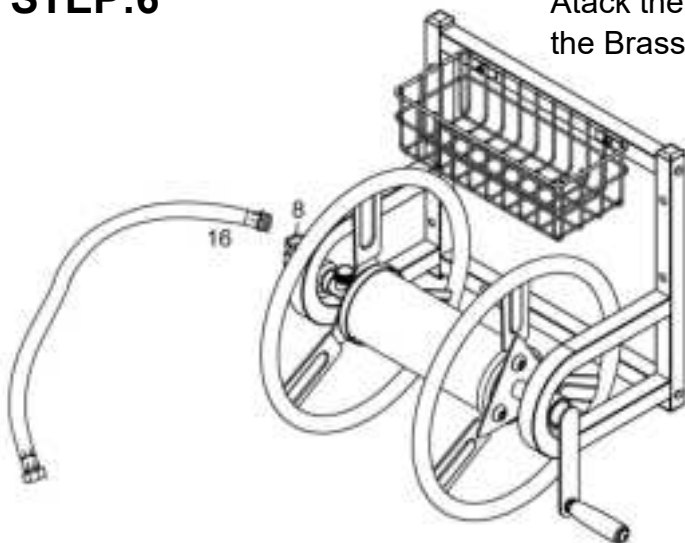

Attach the leader hose (16) to the Brass Swivel 3/4(8)

STEP:7

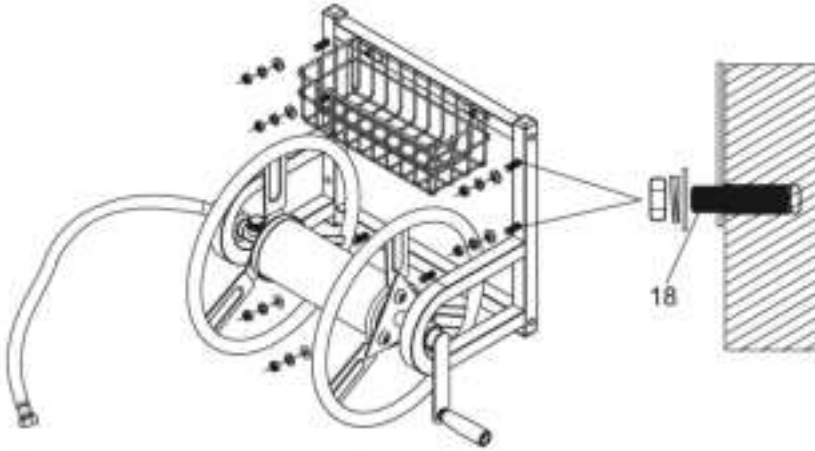

- 1.Position and hold your hose reel against the brick/masonry wall at a convenient height. Mark the position of each suspension hole on the wall. Remove the hose reel.
- 2.Using a hammer drill, drill holes 12.5mm in diameter and at the marked positions on the wall.
- 3.Insert the masonry wall anchors into the anchor sleeve. Next, insert the anchor and sleeve into the drilled holes until the steel sleeve is completely in the wall.
- 4.Place the hose reel on the masonry wall anchors.
- 5.Install a washer, lock washer, and nut over each wall anchor and tighten securely.

Address: Shuangchenglu 803nong11hao1602A-1609shi, baoshanqu, shanghai 200000 CN.

EC REP: E-CrossStu GmbH. Mainzer Landstr.69, 60329 Frankfurt am Main.

UK REP: YH CONSULTING LIMITED. C/O YH Consulting Limited Office 147, Centurion House, London Road, Staines-upon-Thames, Surrey, TW18 4AX
Imported to AUS: SIHAO PTY LTD.

1 ROKEVA STREETEASTWOOD NSW 2122 Australia

Imported to USA: Sanven Technology Ltd.

Suite 250, 9166 Anaheim Place, Rancho Cucamonga, CA 91730



Technical Support and E-Warranty Certificate
www.vevor.com/support