



**Affordable. Reliable. Home Improvement.**

# **PADDLE-BOARD-PUMP**

## **Model: HT-790D**

Technical Support and E-Warranty Certificate  
[www.vevor.com/support](http://www.vevor.com/support)



# VEVOR

Affordable. Reliable. Home Improvement.

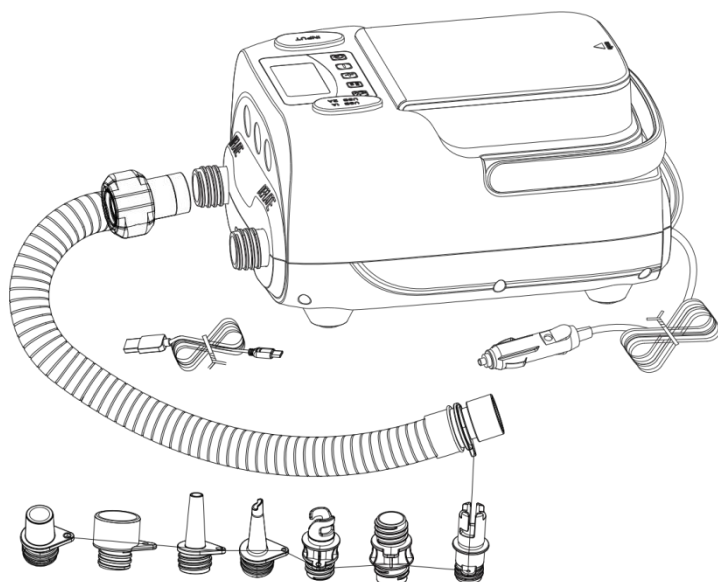
## MODEL:HT-790D



This is the original instruction, please read all manual instructions carefully before operating. VEVOR reserves a clear interpretation of our user manual. The appearance of the product shall be subject to the product you received. Please forgive us that we won't inform you again if there are any technology or software updates on our product.

	<p>Warning-To reduce the risk of injury, user must read instructions manual carefully.</p>
	<p>This device complies with Part 15 of the FCC Rules. Operation is subject to the following two conditions:(1) This device may not cause harmful interference, and (2) this device must accept any interference received, including interference that may cause undesired operation.</p>
	<p>This product is subject to the provision of European Directive 2012/19/EC. The symbol showing a wheeled bin crossed through indicates that the product requires separate refuse collection in the European Union. This applies to the product and all accessories marked with this symbol. Products marked as such may not be discarded with normal domestic waste, but must be taken to a collection point for recycling electrical and electronic devices</p>

## I. Safety Instructions

- \* Warning: Children shall not play with the appliance.
- \* Warning: Cleaning and user maintenance shall not be made by children without supervision.
- \* Warning: Keep the air pump out of reach of children.
- \* Warning: This product shall not be exposed to the rain or immersed in water.
- \* Warning: This appliance can be used by children aged from 8 years and above and persons with reduced physical, sensory or mental capabilities or lack of experience and knowledge if they have been given supervision or instruction concerning use of the appliance in a safe way and understand the hazards involved.
- \* Warning: Please do not bury the wire in the soil, and it shall be place in the safe zone where it won't be damaged by mower or other equipment.

\* Warning: If the power wire is damaged, the power wire must be changed by the manufacturer or its service agent or the similar authorized personnel, in case of any risk.

\* Warning: If you are standing in a place with water or your hands are wet, please don't plug or pull the DC plug.

\* Warning: Before inflating, please pay attention to check the maximum bearable pressure of the inflatable product, because the air bag may be damaged upon exceeding the maximum bearable pressure.

\* Warning: Before using, please check the cigarette lighter socket to make sure that there is no rust or residue inside. The cigarette lighter socket with poor electric conduction may cause overheating of the product or power source, which will damage the product.

\* Warning: It is strictly forbidden to place the product in a high-humidity environment, otherwise the internal circuit of the product might be short-circuited, causing serious damage to the product.

\* Warning: Do not throw this product into fire for fear of explosion, battery leakage or other dangers.

\* Warning: Do not disassemble or break the product randomly for fear of damaging the product.

\* Warning: Avoid keeping or using this product under strong sunlight. Prolonged sun exposure will damage the performance of the product, resulting in overheat and line problems.

\* Warning: Do not use or store this product in an environment where the temperature is too low or too high, which might trigger automatic protection of the product and cut off the charging of the digital product.

\* Warning: Please use this product in a relatively safe environment, and keep it away from flammable/explosive liquids, gases or explosives.

\* Warning: Before charging this product, please verify that the specifications of the adapter match the product. Incompatible adapters might cause damage to the product or cause risky overload.

\* Warning: When the product is not in use, please put it in a dry and ventilated place, and prevent it from colliding with metal objects for fear of short circuit. Please pay attention to heat dissipation and ventilation during use, so as to avoid danger due to excessive temperature.

- \* Warning: If product swelling or leakage is found, please stop using this product.
- \* Warning: Do not disassemble the device without authorization. This product does not contain spare parts that can be disassembled / maintained by the user.
- \* Warning: Do not cover or obstruct the product with paper or other objects for fear of affecting heat dissipation and cooling of the product.
- \* Warning: In order to avoid injury or property damage, unplug the power cord when not using the product.
- \* Warning: If leakage occurs and the liquid splashes into the eyes accidentally, do not rub your eyes but rinse your eyes with clean water immediately instead. If the symptom is serious, please go to hospital.
- \* Warning: The purpose of using this product is limited to the description in the instruction book.

## II. Product Introduction

Thank you for purchasing this product, HT-790D is an intelligent DC electric pump with the preset pressure LCD screen, which can be used for inflatable tent, SUP, etc. Thanks to the intelligent pressure system, for example, if a pressure value is preset, when the pressure reaches the preset pressure value, the pump will automatically stop inflating.



This product also can deflation, and when the inflatable product is not used, you can use the air pump to empty the air inside for folding and storage.

## III. Product Parameters

Pressure	0-20PSI	USB output	5V/2A
Battery	6000mAh	Charging time	
Charging input	USB 5V/2A or 9V/2A	5V/2A	About 8 hours
Input voltage	DC12V	9V/2A	About 5 hours

# VI. List of Accessories

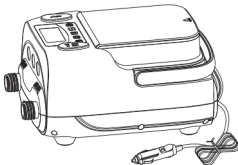
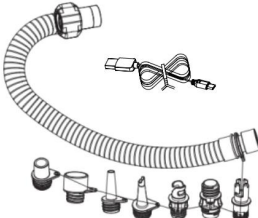
\* Please make sure that the following accessories are in the box before using it, if any missing, please contact with the local service agents

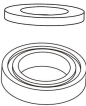
Air pump	Hose Air tap Type-C USB cable	Instruction Book	sealing ring
			

## V. Details of Accessories

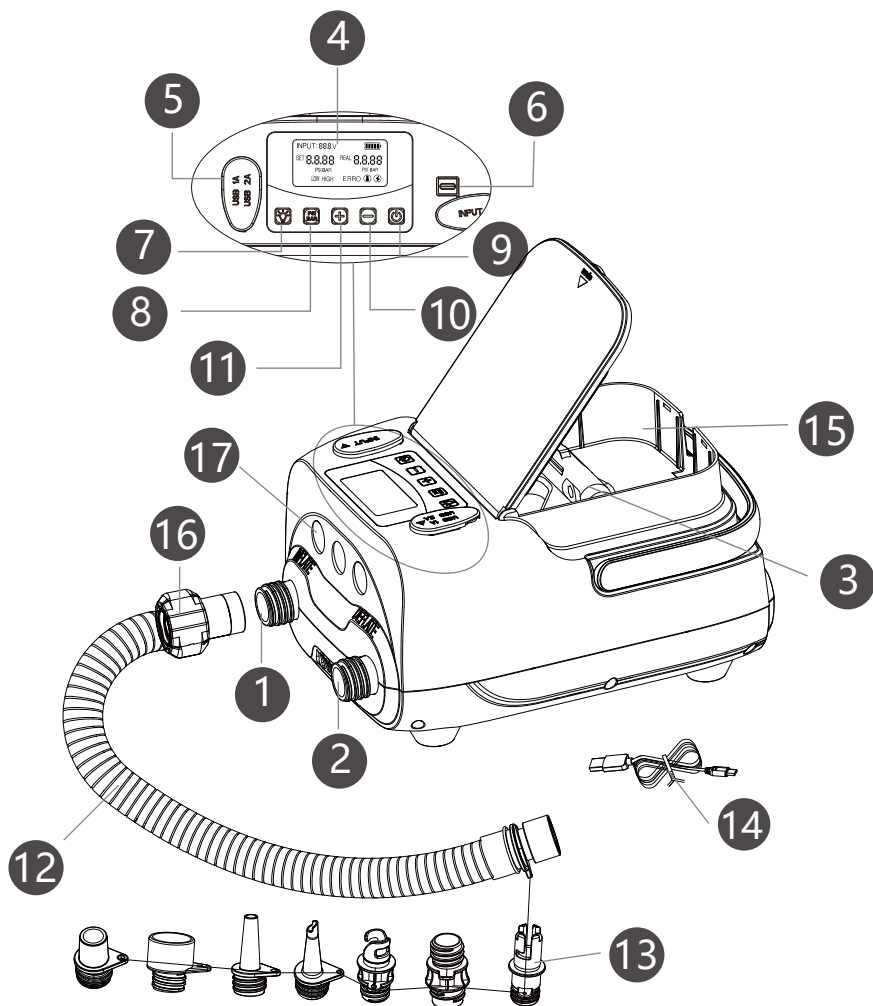

①	Inflation inlet	⑩	Decompressing button
②	Deflation outlet	⑪	Pressurizing button
③	DC plug	⑫	Hose
④	Pressure value LCD screen	⑬	Air tap
⑤	USB 1A, 2A charging output port	⑭	Type-C cable
⑥	Type-C power input interface	⑮	DC plug storage place
⑦	LED light button	⑯	Flexible conduit adaptor
⑧	Pressure unit toggle button	⑰	LED light
⑨	On/off button		

## VI. USB Charging Output Operation

\* In standby or power-on state, connect one end of the USB Cable to the USB/Charger Port on the pump and connect the other end to a USB port on your phone or other digital products .( as Fig 1 )

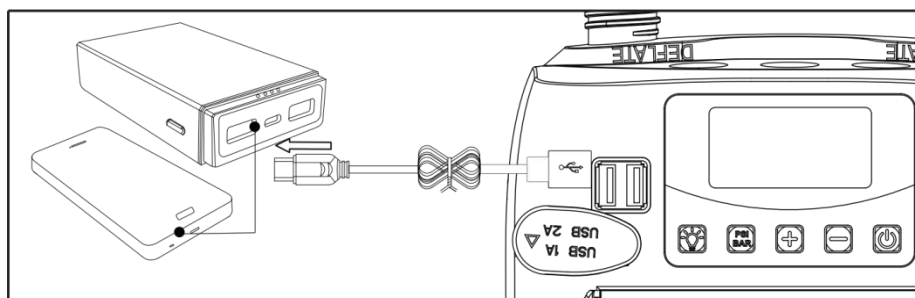



(Fig 1)

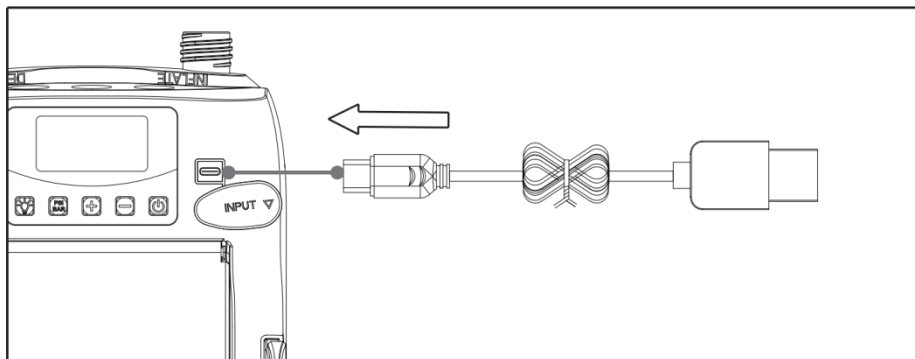



(Fig 2)

## VII. Charging

\* Please use type-C USB cable with this product for charging (When charge “” the indicators will flash during charging, In the fast charging mode, “” the red indicator remains on). Charging voltage is 5V/2A or 9V/2A. Charging voltage will automatically be identified (Fig 2).

\* Make sure the battery is fully discharged before the first charge. After the battery is discharged, the internal temperature is too high. It is recommended to cool it down before charging it. Do not let the electric air pump in a state of no electricity for a long time.

## VIII. Inflation Operation

\* Make a long pressing of the switch for 3 seconds to enter the standby state. Connect the end with flexible conduit adaptor of the hose with the air pump inflation inlet (1), and twist clockwise to tighten it, as Figure 3

\* Connect the other end of the hose with the air nozzle that matches the air bag, and insert the inflation valve of the air bag. Turn it clockwise to fix it as shown in Figure 4.

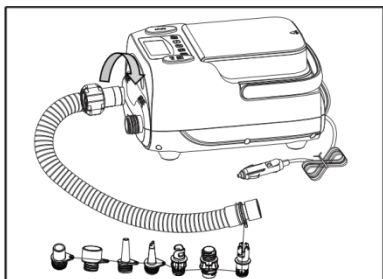

(Fig 3)

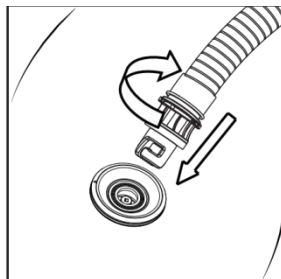

(Fig 4)

- \* Press the pressure unit switching button **PSI/BAR** and select the unit you need.
- \* Press the pressure increase button **+** or decompressing button **-** to set the desired pressure value.
- \* The pressure range is from 0 to 20 PSI (1PSI = 0.0689 bar = 6.89KPA).
- \* Upon the completion of the above steps, press the power on/off button **⏻** to start inflation; or plug the cigarette lighter into the 12V DC socket, the display lights up, press the On/Off button **⏻** to start inflating.
- \* In the process of inflation, you can press the pressure increase button **+** or the pressure reduction button **-** to increase or decrease the pressure value. Press the pressure unit switching button **PSI/BAR** to switch between the units, and press the power on/off button **⏻** to stop.
- \*When the pressure reaches the set value, the air pump will stop working automatically.
- \* Upon the completion of inflation, it will turn off automatically without other operations within 2 minutes.
- \*After pulling out the DC plug, please take down the hose from the air pump and air bag and store it.
- \* Notice: The factory set pressure value of the air pump is 20PSI (1PSI=0.0689BAR), and at the time of the secondary use, the set pressure value for the last time use will be displayed by default.

## IX. Deflation Operation

\* Press the button of the power switch of air pump, and start the deflation until all the gas is discharged, then the power can be turned off to stop the deflation.

\* Press the button of the power switch of air pump, and start the deflation until all the gas is discharged, then the power can be turned off to stop the deflation.

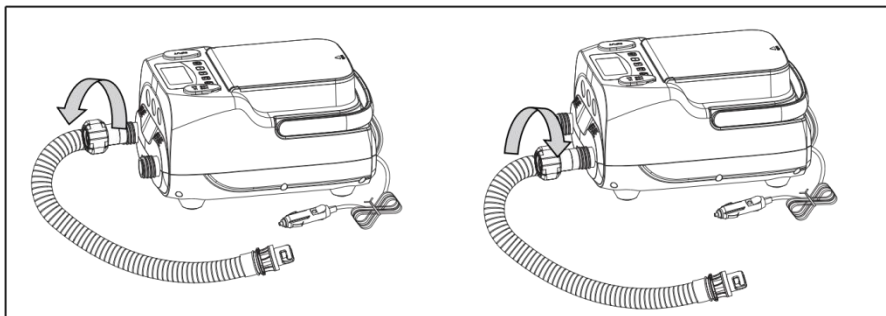

## X. Precautions

\*As this product has a lithium battery, it can work using the battery, or the plug of the product can be inserted into the cigarette lighter socket on the car for use.

\*The applied power source must be the 12V DC power source .

\* Do not block the inflation inlet and Deflation outlet , and ensure that the inflation inlet and Deflation outlet shall remain smooth at all times.

\*Observe the local waste treatment provisions, and it is not allowed to throw the air pump away randomly.

\* Don't use this product when the hose is damaged, and please change the hose immediately.

\*Don't pull out the hose when inflating, because that the high pressure may hurt the physical body.

\* Please don't use this air pump if any part is damaged, and please contact with the professional personnel to repair it.

This product shall not be exposed to the rain or immersed in water.

\* In order to prevent risk, the inflation inlet shall not be forward to face or body.

\* Please don't not leave while inflating.

\* Don't make the air pump work for more than 20 minutes, because that motor overheating may cause internal damage; and the air pump shall be fully cooled for 30 minutes after continuously working up to 20 minutes.

\*  Disposal: Do not dispose of this product as unsorted municipal waste. The waste must be collected

separately for special disposal. The built-in batteries of this product must be removed from the equipment and disposed of properly before being scrapped.

\* Please start the car when using the product, in case of unnecessary damage.



\* Do not charge and discharge when the product in the working state of charging and deflating.

\* Please fully charge the battery once at least per 6 months in order to be normal used of the product.

## XI. Fault Handling

Fault	Inspection	Solution
The air pump cannot be started normally.	1. The power source is not plugged properly. 2. Low battery charge. 3. Overheating or overload causes motor stop.	1. Make sure that the power wire is plugged in the 12V DC socket. 2. Charging. 3. Cool the motor and restart it. 4. If the problem cannot be solved, please contact local service agents or similar authorized personnel to change the product.

Slow or abnormal inflation or deflation.	<ol style="list-style-type: none"> <li>1. Check whether the hose is blocked or cracked.</li> <li>2. The joint between the hose and air pump or air bag is not installed properly.</li> </ol>	<ol style="list-style-type: none"> <li>1. Change the hose or make it unblocked, and check whether the hose is cracked.</li> <li>2. Reinstall the hose.</li> <li>3. If the problem cannot be solved, please contact local service agents or similar authorized personnel to change the product.</li> </ol>
--	--	---

Fault	Inspection	Solution
ERRO+  blinks	Temperature alarm.	Heat dissipation is required.
Input voltage +  +ERRO blinks	The power supply is low or high.	<ol style="list-style-type: none"> <li>1. Power supply voltage is low.</li> <li>2. Power supply is insufficient. And line has limited current.</li> <li>3. Power adapter overcurrent protection shall be used, requiring special adapter (120W without current limit).</li> </ol>
ERRO blinks	Shutdown protection without increasing air pressure.	Check for air leaks.
ERRO+LOW or ERRO+HIG blinks	Motor overcurrent protection.	Check motor for foreign matter stuck or restart air pump, If the problem cannot be solved, Please contact local agents or the similar authorized personnel.
Air pressure does not return to zero	Remove the connecting trachea.	Press and hold the pressure unit toggle button for more than 3 seconds to return to zero.

## **XII. Maintenance and Storage**

- \* Please remove the power plug from the electric outlet after use or before moving, servicing or adjusting the product.
- \* Cool it well and put it in the box when it is not in use.
- \* Please use it indoors, and protect it against direct sun exposure or rain. \* Please store it in a dry and ventilated place.

## **XIII. Suggestions**

\*The warranty period of this product is one year, and it is suggested to use the original accessories. For any fault not caused by using the original accessories, it shall be out of the warranty scope.

Manufacturer: Shanghaimuxinmuyeyouxiangongsi

Address: Shuangchenglu 803nong11hao1602A-1609shi, baoshanqu, shanghai 200000 CN.

Imported to AUS: SIHAO PTY LTD. 1 ROKEVA STREETEASTWOOD NSW 2122 Australia

Imported to USA: Sanven Technology Ltd. Suite 250, 9166 Anaheim Place, Rancho Cucamonga, CA 91730

<b>UK</b>	<b>REP</b>	YH CONSULTING LIMITED. C/O YH Consulting Limited Office 147, Centurion House, London Road, Staines-upon-Thames, Surrey, TW18 4AX
<b>EC</b>	<b>REP</b>	
		E-CrossStu GmbH Mainzer Landstr.69, 60329 Frankfurt am Main.





**Technical Support and E-Warranty Certificate**  
**[www.vevor.com/support](http://www.vevor.com/support)**