

## ORIGINAL OPERATING INSTRUCTIONS ELECTRIC DRYWALL SANDER

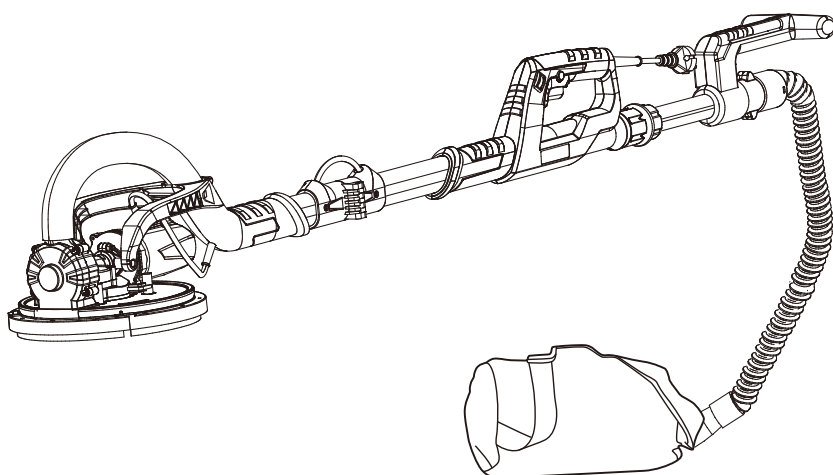

### Model#: DMJ-700C-6GT

Thank you for buying a WORKPRO product. Your ELECTRIC DRYWALL SANDER has been engineered and manufactured to WORKPRO's high standard for dependability, ease of operation, and operator safety. When properly cared for, it will give you years of rugged, trouble-free performance.



**WARNING:** To reduce the risk of injury, the user must read and understand the operator's manual before using this product.

**SAVE THIS MANUAL FOR FUTURE REFERENCE**



Distributed by :  
Hangzhou GreatStar Industrial Co., Ltd.  
No.35 Jiuahuan Road, Jiubao Town,  
Hangzhou 310019, China  
[www.greatstartools.com](http://www.greatstartools.com)

MADE IN CHINA

## TABLE OF CONTENTS

■ Introduction .....	2
■ General Power Tool Safety Warnings .....	3,4
■ Sander Safety Warning.....	4
■ Kickback and Related Warnings .....	5
■ Additional Safety Warning.....	5
■ Warning Symbols.....	6
■ Extension Cords.....	6
■ Know Your Product .....	7
■ Technical Specification.....	7
■ Assembly.....	8,9
■ Operation .....	9,10
■ Maintenance .....	11
■ Trouble Shooting.....	11
■ Disposal and Recycling.....	12

## INTRODUCTION

The machine is intended for dry sanding drywall that has had filler applied, ceilings and walls in indoor and outdoor areas, and for removing coats of paint, adhesive residues and loose plaster.

**⚠ WARNING:** Drilling, sawing, sanding or machining wood products can expose you to wood dust, a substance known to the State of California to cause cancer. Avoid inhaling wood dust or use a dust mask or other safeguards for personal protection. For more information go to [www.P65Warnings.ca.gov/wood](http://www.P65Warnings.ca.gov/wood).

# GENERAL POWER TOOL SAFETY WARNINGS

## **WARNING!**

To reduce the risk of injury, user must read instruction manual.

## **WARNING!**

To reduce the risk of injury, use only accessories rated at least equal to the maximum speed marked on the tool.

 **WARNING!** Read all safety warnings and all instructions. Failure to follow the warnings and instructions may result in electric shock, fire and/or serious injury.

Save all warnings and instructions for future reference

The term "power tool" in the warnings refers to your mains-operated (corded) power tool power tool or battery-operated (cordless) power tool.

## 1. WORK AREA SAFETY

- a. Keep your work area clean and well lit. Cluttered and dark areas invite accidents.
- b. Do not operate power tools in explosive atmospheres, such as in the presence of flammable liquids, gases or dust. Power tools create sparks which may ignite the dust or fumes.
- c. Keep children and bystanders away while operating a power tool. Distractions can cause you to lose control.

## 2. ELECTRICAL SAFETY

- a. Power tool plugs must match the outlet. Never modify the plug in any way. Do not use any adapter plugs with earthed (grounded) power tools. Unmodified plugs and matching outlets will reduce risk of electric shock.
- b. Avoid body contact with earthed or grounded surfaces such as pipes, radiators, ranges and refrigerators. There is an increased risk of electric shock if your body is earthed or grounded.
- c. Do not expose power tools to rain or wet conditions. Water entering a power tool will increase the risk of electric shock.
- d. Do not abuse the cord. Never use the cord for carrying, pulling or unplugging the power tool. Keep cord away from heat, oil, sharp edges or moving parts. Damaged or entangled cords increase the risk of electric shock.
- e. When operating a power tool outdoors, use an extension cord suitable for outdoor use. Use of a cord suitable for outdoor use reduces the risk of electric shock.
- f. If operating a power tool in a damp location is unavoidable, use a residual current device (RCD) protected supply. Use of an RCD reduces the risk of electric shock.

## 3. PERSONAL SAFETY

- a. Stay alert, watch what you are doing and use common sense when operating a power tool. Do not use a power tool while you are tired or under the influence of drugs, alcohol or medication. A moment of inattention while operating power tools may result in serious personal injury.
- b. Use personal protective equipment. Always wear eye protection. Protective equipment such as dust mask, non-skid safety shoes, hard hat, or hearing protection used for appropriate conditions will reduce personal injuries.
- c. Prevent unintentional starting. Ensure the switch is in the off position before connecting to power source and/or battery pack, picking up or carrying the tool. Carrying power tools with your finger on the switch or energising power tools that have the switch on invites accidents.
- d. Remove any adjusting key or wrench before turning the power tool on. A wrench or a key left attached to a rotating part of the power tool may result in personal injury.
- e. Do not overreach. Keep proper footing and balance at all times. This enables better control of the power tool in unexpected situations.
- f. Dress properly. Do not wear loose clothing or jewellery. Keep your hair, clothing and gloves away from moving parts. Loose clothes, jewellery or long hair can be caught in moving parts.
- g. If devices are provided for the connection of dust extraction and collection facilities, ensure these are connected and properly used. Use of dust collection can reduce dust-related hazards.

## 4. POWER TOOL USE AND CARE

- a. Do not force the power tool. Use the correct power tool for your application. The correct power tool will do the job better and safer at the rate for which it was designed.
- b. Do not use the power tool if the switch does not turn it on and off. Any power tool that cannot be controlled with the switch is dangerous and must be repaired.
- c. Disconnect the plug from the power source and/or the battery pack from the power tool before making any adjustments, changing accessories, or storing power tools. Such preventive safety measures reduce the risk of starting the power tool accidentally.
- d. Store idle power tools out of the reach of children and do not allow persons unfamiliar with the power tool or these instructions to operate the power tool. Power tools are dangerous in the hands of untrained users.
- e. Maintain power tools. Check for misalignment or binding of moving parts, breakage of parts and any other condition that may affect the power tools operation. If damaged, have the power tool repaired before use. Many accidents are caused by poorly maintained power tools.
- f. Keep cutting tools sharp and clean. Properly maintained cutting tools with sharp cutting edges are less likely to bind and are easier to control.

# GENERAL POWER TOOL SAFETY WARNINGS

- g. Use the power tool, accessories and tool bits etc. in accordance with these instructions, taking into account the working conditions and the work to be performed. Use of the power tool for operations different from those intended could result in a hazardous situation.

## 5. SERVICE

- a. Have your power tool serviced by a qualified repair person using only identical replacement parts. This will ensure that the safety of the power tool is maintained.

## SANDER SAFETY WARNING

### SAFETY WARNINGS COMMON FOR SANDER:

- a. **This power tool is intended to function as a SANDER.** Read all safety warnings, instructions, illustrations and specifications provided with this power tool. Failure to follow all instructions listed below may result in electric shock, fire and/or serious injury.
- b. **Operations such as sanding are not recommended to be performed with this power tool.** Operations for which the power tool was not designed may create a hazard and cause personal injury.
- c. **Do not use accessories which are not specifically designed and recommended by the tool manufacturer.** Just because the accessory can be attached to your power tool, it does not assure safe operation.
- d. **The RATED SPEED of the accessory must be at least equal to the maximum speed marked on the power tool.** Accessories running faster than their RATED SPEED can break and fly apart.
- e. **The outside diameter and the thickness of your accessory must be within the capacity rating of your power tool.** Incorrectly sized accessories cannot be adequately guarded or controlled.
- f. **Do not use a damaged accessory. Before each use inspect the accessory such tear or excess wear, wire brush for loose or cracked wires.** If power tool or accessory is dropped, inspect for damage or install an undamaged accessory. After inspecting and installing an accessory, position yourself and bystanders away from the plane of the rotating accessory and run the power tool at maximum no-load speed for one minute. Damaged accessories will normally break apart during this test time.
- g. **Wear personal protective equipment. Depending on application, use face shield, safety goggles or safety glasses. As appropriate, wear dust mask, hearing protectors, gloves and workshop apron capable of stopping small abrasive or workpiece fragments.**
- h. **Keep bystanders a safe distance away from work area.** Anyone entering the work area must wear personal protective equipment. Fragments of workpiece or of a broken accessory may fly away and cause injury beyond immediate area of operation.
- i. **Hold the power tool by insulated gripping surfaces only, when performing an operation where the cutting accessory may contact hidden wiring or its own cord.** Cutting accessory contacting a live<sup>2</sup> wire may make exposed metal parts of the power tool live<sup>2</sup> and could give the operator an electric shock.
- j. **Position the cord clear of the spinning accessory.** If you lose control, the cord may be cut or snagged and your hand or arm may be pulled into the spinning accessory.
- k. **Never lay the power tool down until the accessory has come to a complete stop.** The spinning accessory may grab the surface and pull the power tool out of your control.
- l. **Do not run the power tool while carrying it at your side.** Accidental contact with the spinning accessory could snag your clothing, pulling the accessory into your body.
- m. **Regularly clean the power tool's air vents.** The motor's fan will draw the dust inside the housing and excessive accumulation of powdered metal may cause electrical hazards.
- n. **Do not operate the power tool near flammable materials.** Sparks could ignite these materials.
- o. **Do not use accessories that require liquid coolants.** Using water or other liquid coolants may result in electrocution or shock.
- p. **Do not use excessively oversized sanding disc paper.** Follow manufacturers recommendations, when selecting sanding paper. Larger sanding paper extending beyond the sanding pad presents a laceration hazard and may cause snagging, tearing of the disc or kickback.

The eye protection must be capable of stopping flying debris generated by various operations. The dust mask or respirator must be capable of filtering particles generated by your operation. Prolonged exposure to high intensity noise may cause hearing loss.

## KICKBACK AND RELATED WARNINGS

- a. **Maintain a firm grip on the power tool and position your body and arm to allow you to resist kickback forces. Always use auxiliary handle, if provided, for maximum control over kickback or torque reaction during start-up.** The operator can control torque reactions or kickback forces, if proper precautions are taken.
- b. **Never place your hand near the rotating accessory.** Accessory may kickback over your hand.
- c. **Do not position your body in the area where power tool will move if kickback occurs.**
- d. **Use special care when working corners, sharp edges etc.** Avoid bouncing and snagging the accessory. Corners, sharp edges or bouncing have a tendency to snag the rotating accessory and cause loss of control or kickback.
- e. **Do not attach a saw chain woodcarving blade or toothed saw blade.** Such blades create frequent kickback and loss of control.

## ADDITIONAL SAFETY WARNING

- a. Do not use the tool near explosive materials (petrel, dilution).
- b. Do not work with materials containing asbestos.
- c. Prior to every use, check the tool and its cable and plug. Have damages only repaired by specialists. Insert the plug into the socket only when the tool switch is off.
- d. Plug and switch the machine off if it is not under supervision, in case of putting up and stripping down the machine, in case of voltage drop or when fixing or mounting an accessory
- e. Switch the machine off if it stops for whatever reason. You avoid that it starts suddenly and not under supervision.
- f. Before starting your work, check the proper seat of the cutting bit and the individual stars.
- g. Check the milling head before every use. Do not use damaged or sluggishly running milling stars.
- h. Make sure that the tool was mounted properly, and let it run idly in a safe position for 30 seconds. Stop the tool immediately if you found considerable vibrations or other defects.
- i. Don't use the machine if a part of the housing is damaged or in case of damages on the switch, the cable or plug.
- j. Electrical tools have to be inspected visually by a specialist in regular intervals.
- k. After interruption of your work, restart the tool only after having made sure that the milling head and the stars are moving freely.
- l. Do not touch rotating parts.
- m. Persons under 16 years are not supposed to use the tool.
- n. Keep the handles dry, clean and free of oil and grease.

### CAUTION

- a. Attention! The milling head still runs for a little while after the machine was switched off.
- b. When working with the machine, wear ear protectors, dust mask and goggles.
- c. Always hold the machine with both hands.
- d. Consider the tool's reaction torque.
- e. Make sure that persons in the work space are not endangered by particles flying around.
- f. In order to avoid the star holder and the milling stars get damaged, work very carefully on edges, corners or extreme transition.
- g. Do not work on surfaces with steel reinforcements which lie open.

### SAFETY RULES FOR ELECTRIC DRY SANDER

- a. **USE A RESPIRATOR** approved by NIOSH for "Dust and Mist" . Ventilate work area and/or use a dust collector. Continued and prolonged exposure to high concentrations of airborne dust may affect the respiratory system function.
- b. **MAINTAIN FIRM FOOTING AND BALANCE.** Use appropriate scaffolding. Do not overreach.
- c. **SANDING OF LEAD-BASED PAINT IS NOT RECOMMENDED.** Lead-based paint should only be removed by a professional.

## WARNING SYMBOLS



In order to protect the user, take precautions.



Wear ear protectors



Wear goggles



Wear protective gloves



Wear dust mask



Safe work with the machine is only possible if you read this operating instruction and the safety instructions completely and follow the instructions contained strictly. Additionally, the general safety instructions of the leaflet supplied with the tool must be observed. Prior to the first use, the user should absolve a practical training.



Switch the product off and disconnect it from the power supply before assembly, cleaning, adjustments, maintenance, storage and transportation.



The tool must neither be wet nor used in humid environment.

## EXTENSION CORDS

When using an extension cord with your Polisher refer to the following table to determine the required A.W.G. wire size. Before using the Polisher, make sure the power cord and extension cord are in good working condition. Make repairs or replacements before using the Polisher. Only use extension cords that are rated for outdoor use.

	Length of Extension Cord			
110V-120V	25 Feet 7,5 Meters	50 Feet 15,25 Meters	100 Feet 30,5 Meters	150 Feet 45,7 Meters
Amps	A.W.G. Wire Size			
0-6	18	16	16	14
7-10	18	16	14	12
11-12	16	16	14	12
13-16	14	12	Not recommended	

# KNOW YOUR PRODUCT

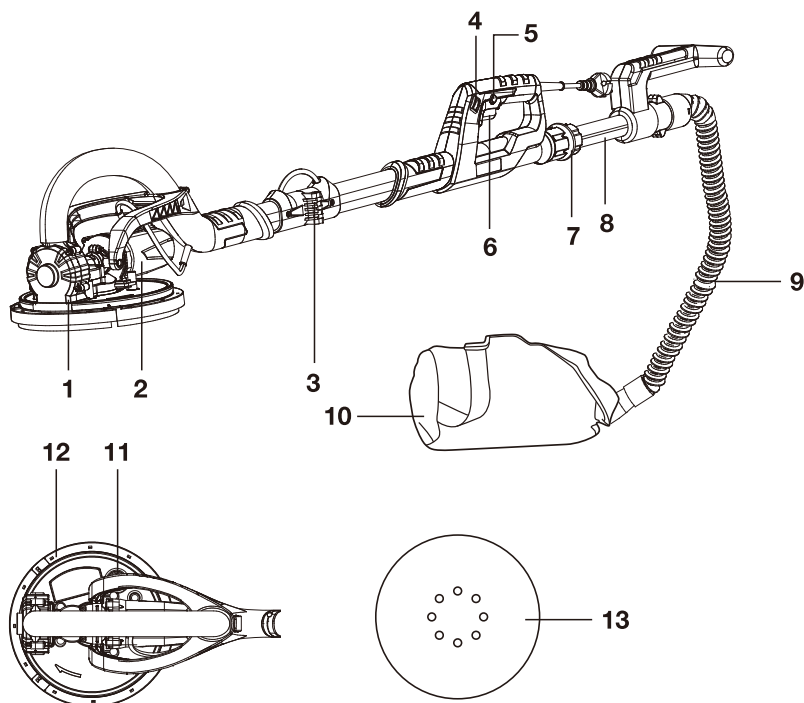

- 1. Sanding head
- 2. Motor
- 3. Locking hook
- 4. Speed controller
- 5. Switch lock button

- 6. On/off switch
- 7. Lock for telescopic extension
- 8. Telescopic extension
- 9. Hose for dust extractor
- 10. Dust collection bag

- 11. Led Light on/off Switch
- 12. Led Light Ring
- 13. Sander Paper

## TECHNICAL SPECIFICATION

Item No.	W125169A
Rated Voltage	120V~
Frequency	60 Hz
Rated Current	6A
Rated speed	1100- 1850rpm
Max capability	225mm (9 inch)
Insulation class	II
Protection class	IPX0
Weight	4.5 kg (9.9 lbs)

# ASSEMBLY



To reduce the risk of injury, turn the unit off and disconnect it from the power source before installing and removing accessories, before adjusting or making repairs. An accidental start-up can cause injury.

## ASSEMBLING THE DRYWALL SANDER (SEE FIGS. 1,2)

Take the drywall sander out of the packaging, unfold it and secure with the locking hook. Make sure that the locking hook engages correctly.

When the machine need to be folded, pull up the locking hook to relax pothook, then the pipe can be folded.

**FIG. 1**

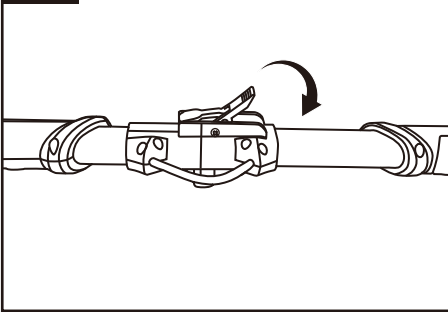

**FIG. 2**

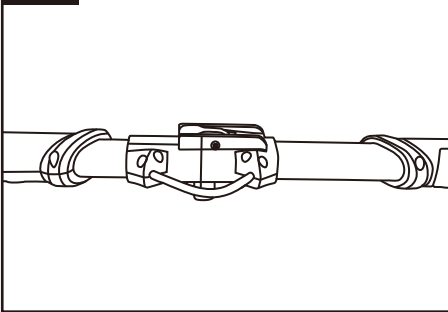

## FITTING THE TELESCOPIC EXTENSION (SEE FIG. 3)

Insert the telescopic extension into the lock for the telescopic extension and lock it by twisting as shown in Fig 3.

According to the needs of different grinding position, can be the length of the machine to adjust between 1200-1800mm.

**FIG. 3**

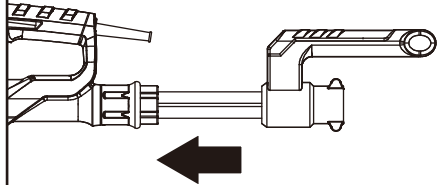

## CONNECTING THE HOSE FOR DUST EXTRACTOR (SEE FIG. 4)

Insert the dust hose connector into the opening of the telescopic extension.

**FIG. 4**

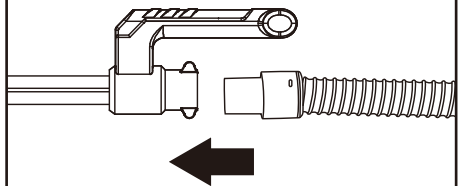

## CONNECTING THE HOSE FOR DUST EXTRACTOR WITH DUST COLLECTION BAG (SEE FIG.5&6)

Lock the hose and dust collection bag by the snap.

**FIG. 5**

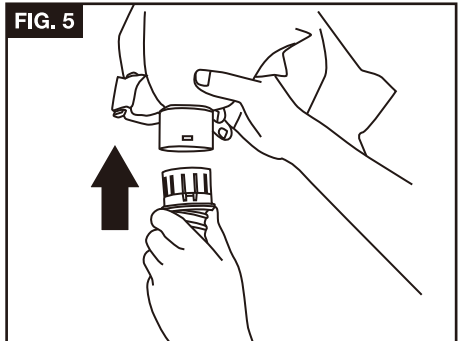



## ASSEMBLY

**FIG. 6**

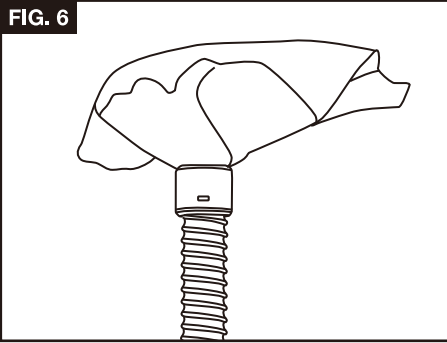

**To seal the dust collection bag so that it is dust-tight, proceed as follows (Fig. 7)**

- Close the dust collection bag and align the sides.
- Sliding clip to close the sides of the pocket.
- To open the dust collection bag, slide away the clip.

**FIG. 7**

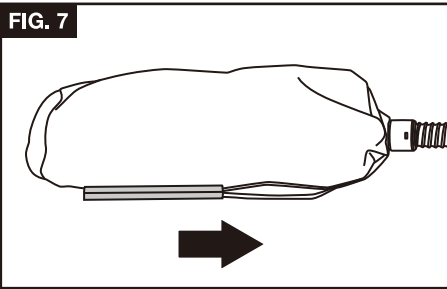

### CAUTION!

For health safety reasons it is imperative that you use a dust extractor.

### FASTENING THE GRINDING/SANDING PAPER (SEE FIG.8)

The hook-and-loop fastener enables easy changing of the abrasive paper. Make sure that the vacuum extraction holes on the abrasive paper and the sanding head are aligned.

**FIG. 8**

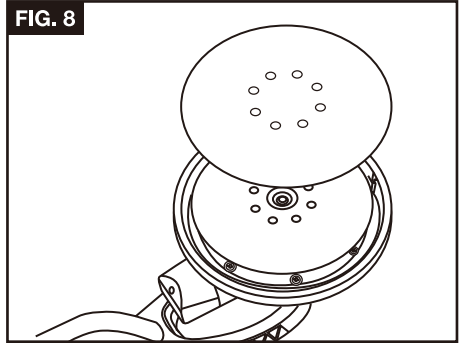

## OPERATION

### ON/OFF SWITCH (SEE FIG. 9)

Switching on: press the On/Off switch.  
Switching off: release the On/Off switch.

**FIG. 9**

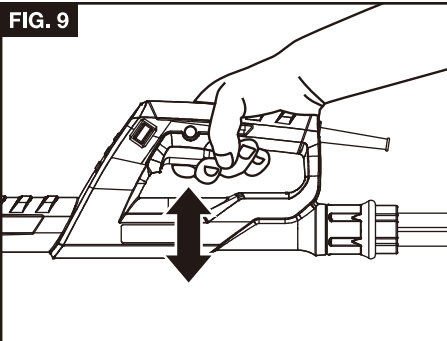

### OPERATING FOR A LONG TIME: (SEE FIG. 10)

Lock-on: press the switch lock button when the On/Off switch is fully depressed.

Release lock: completely squeeze and release the On/Off switch.

**FIG. 10**

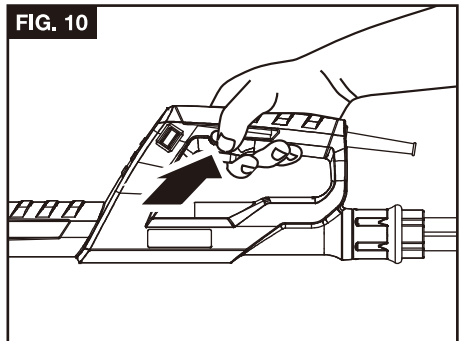

# OPERATION

## SANDING WHEEL SPEED REGULATION (SEE FIG. 11)

The speed is adjusted by turning the control knob. The control knob is numbered "MIN" through "MAX" with "MIN" being the slowest speed (approximately 1100 RPM) and "MAX" being the fastest speed (approximately 1850 RPM).

Use the higher speed settings for fast stock removal. Use the lower speed to reduce removal rate for more precise control.

FIG. 11

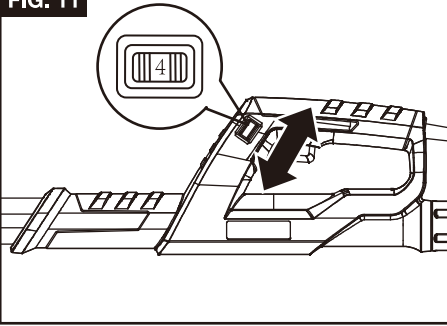

## TURN ON/OFF THE LED LIGHT RING (SEE FIG. 12)

Press the LED light On/off switch to turn on/off the LED light ring against the dark environment

FIG. 12

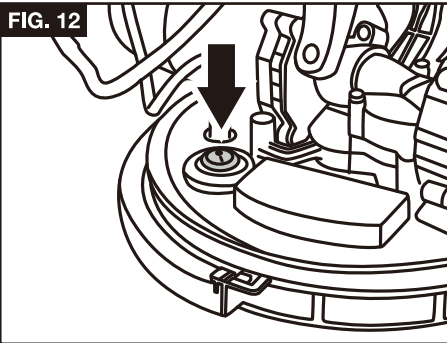

## DETACHABLE PLASTIC GUARD FOR EDGE OF WALL SANDING (SEE FIG. 13&14)

To take off the side guard, first push the lock button (each side) then take it down.

FIG. 13

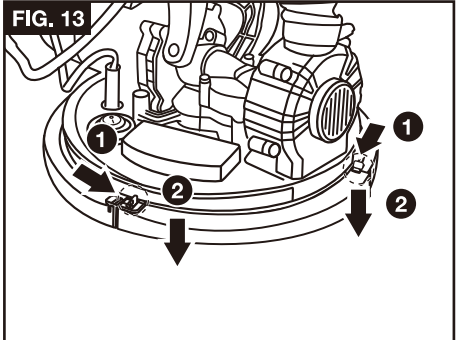
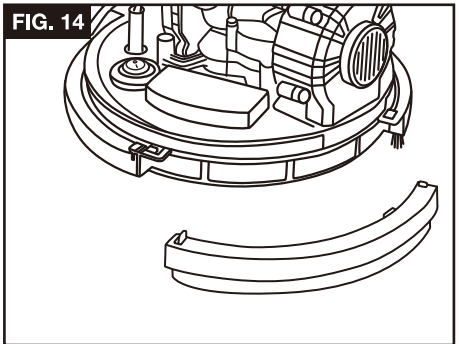

FIG. 14



## REMOVE THE STICKY DISK (SEE FIG. 15)

Insert a hexagon wrench into the inner hexagon hole of the output shaft in the center of the sticky disc and turn it counterclockwise. At the same time, press the grinding stick plate by hand to remove the grinding sticky plate.

FIG. 15

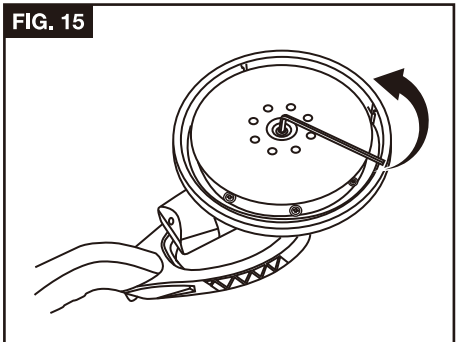

# MAINTENANCE



To reduce the risk of injury, turn the unit off and disconnect it from the power source before installing and removing accessories, before adjusting or making repairs. An accidental start-up can cause injury.

Keep the ventilating holes clean to guarantee the cooling of the machine.

Pull out the power plug of the power socket before maintenance and repair the device.

If the power cord of the device is damaged, it has to be replaced by the manufacturer or his customer service or similar qualified persons, to avoid dangers.

The device is equipped with carbon brushes. The device turns off when abrasion of the carbon brushes reaches a certain limit. Let the carbon brushes change only by qualified customer service.

## CLEANING

- Keep all safety devices, air vents and the motor housing free of dirt and dust as far as possible. Wipe the equipment with a clean cloth or blow it with compressed air at low pressure.
- We recommend that you clean the device immediately each time you have finished using it.
- Clean the equipment regularly with a moist cloth and some soft soap. Do not use cleaning agents or solvents; these could at

tack the plastic parts of the equipment. Ensure that no water can seep into the device. The ingress of water into an electric tool increases the risk of an electric shock.

# TROUBLE SHOOTING

Problem	Possible Causes	Likely Solutions
Tool will not start.	<ol style="list-style-type: none"> <li>1. Cord not connected.</li> <li>2. No power at outlet.</li> <li>3. Internal damage or wear. (Carbon brushes or switch, for example.)</li> </ol>	<ol style="list-style-type: none"> <li>1. Check that cord is plugged in.</li> <li>2. Check power at outlet. If outlet is unpowered, turn off tool and check circuit breaker. If breaker is tripped, make sure circuit is right capacity for tool and circuit has no other loads.</li> <li>3. Replace carbon brushes and/or have technician service tool.</li> </ol>
Performance decreases over time.	Carbon brushes worn or damaged.	Replace brushes.
Excessive noise or rattling.	Internal damage or wear. (Carbon brushes or bearings, for example.)	Have technician service tool.
Overheating.	<ol style="list-style-type: none"> <li>1. Forcing tool to work too fast.</li> <li>2. Blocked motor housing vents.</li> <li>3. Motor being strained by long or small diameter extension cord.</li> </ol>	<ol style="list-style-type: none"> <li>1. Allow tool to work at its own rate.</li> <li>2. Wear ANSI-approved safety goggles and NIOSH-approved dust mask/respirator while blowing dust out of motor using compressed air.</li> <li>3. Eliminate use of extension cord. If an extension cord is needed, use one with the proper diameter for its length and load.</li> </ol>
Tool does not sand.	<ol style="list-style-type: none"> <li>1. Disc accessory may be loose on Spindle.</li> <li>2. Disc accessory may be damaged, worn or wrong type for the material.</li> </ol>	<ol style="list-style-type: none"> <li>1. Be sure disc accessory arbor is correct and outer flange/arbor nut is tight.</li> <li>2. Check condition and type of disc accessory. Use only proper type of disc accessory in good condition.</li> <li>3. Reduce RPM to minimum setting.</li> </ol>



**Follow all safety precautions whenever diagnosing or servicing the tool. Disconnect power supply before service.**

## DISPOSAL AND RECYCLING



### Disposal of the appliance

A crossed-out wheellie bin icon means: Batteries and rechargeable batteries, electrical or electronic devices must not be disposed of with household waste. They may contain substances that are harmful to the environment and human health.

Consumers must dispose of waste electrical devices, spent portable batteries and rechargeable batteries separately from household waste at an official collection point to ensure that these items are processed correctly. Information on returning these items is available from the seller. Sellers are required to accept these items free of charge. Batteries and rechargeable batteries, which are not permanently installed in waste electrical devices, must be removed prior to disposal and must be disposed of separately. Lithium batteries and battery packs in all systems must only be returned to a collection point when discharged. Batteries must always be protected against short circuits by covering the poles with adhesive tape.

All end users are responsible for deleting any personal data stored on waste devices prior to their disposal.



### Disposal of the packaging

The packaging consists of cardboard and correspondingly marked plastics that can be recycled. Make these materials available for recycling.