

EOD 2022+ Polaris RZR Pro R Volt Rear Bumper

RRB610013

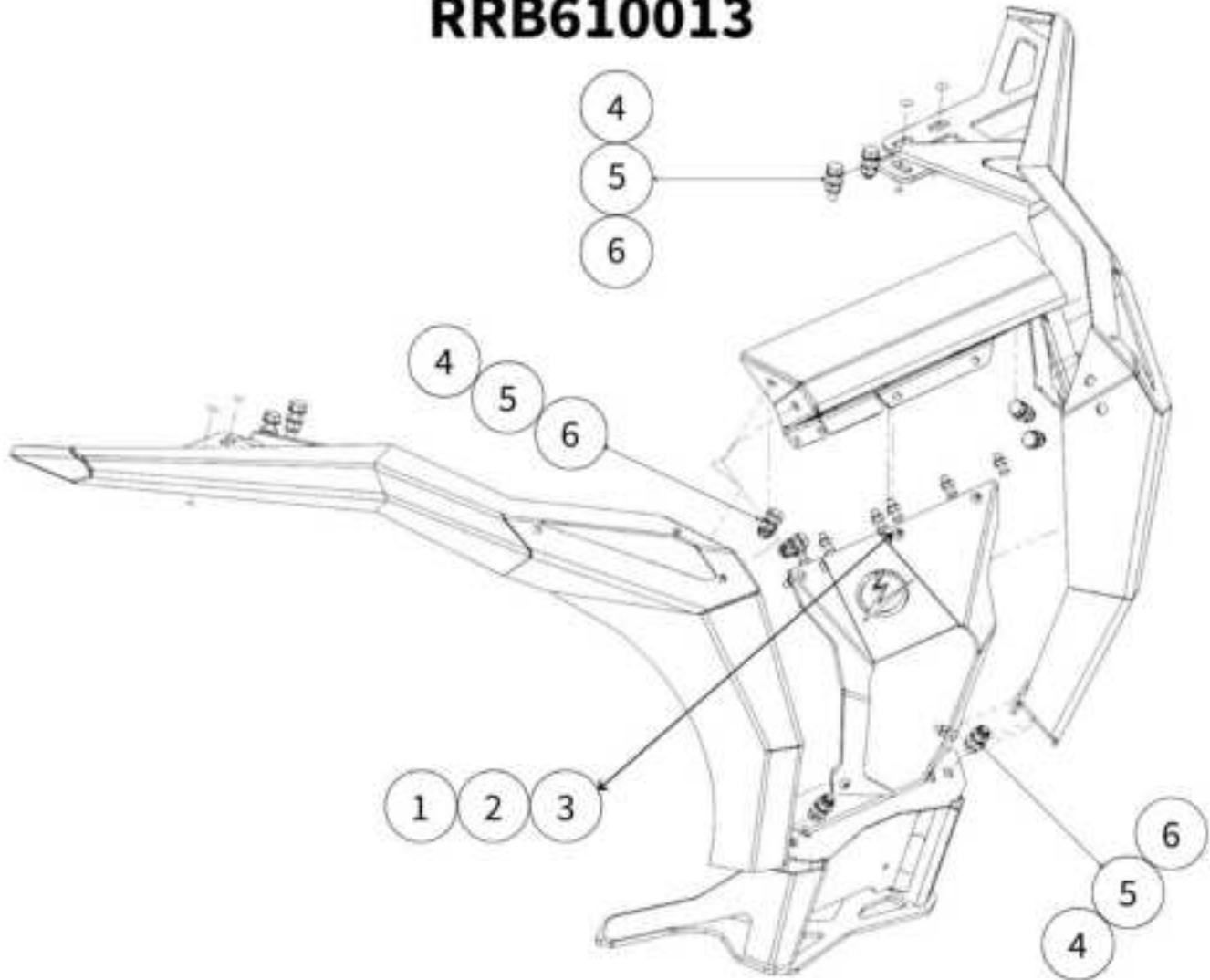

INCLUDED PARTS

ITEM #	DESCRIPTION	QTY
1	M6 X 1.0MM X 20MM BUTON HEAD SCREW	6
2	M6 NYLOCK NUT	6
3	M6 FLAT WASHER	6
4	M10 X 1.25MM X 25MM HEX HEAD SCREW	10
5	M10 NYLOCK NUT	10
6	M10 FLAT WASHER	20

INSTALLATION GUIDE



First start off by locating one side of the bumper assembly and with the included hardware loosely attach the center upper bumper section to the bumper half as shown above. Bolt the other bumper half to the center section and loosely snug down it's hardware as well. Once the main pieces are assembled it will look like the image above and you are now to move on to the next step. All the M10 hardware supplied will get a washer on both sides throughout this build along with the M6 hardware for the center getting washers on the backside only.



Locate the center aluminum section of the bumper and with the supplied hardware loosely mount it to the 3 pieces of the bumper you just assembled, make sure that the plate is sitting on the outside of the mounting tabs of the bumper structure as shown in the image above along with the button heads also being mounted on the outside of the bumper. With the supplied hardware mount the lower bumper section loosely to the main bumper assembly as shown, now that all the pieces are loosely assembled, we can tighten down the lower bumper to side section bolts first while making sure the two pieces are flush and level with each other with no steps or uneven mating surfaces followed by the top center section second. Lastly tighten down the center plate to the bumper assembly to complete the assembly process.



If running a license plate, right now is a good time to install it to the bumper while access to the backside of the hardware is much easier for the installer, next remove the outer two bolts located below the muffler and set aside for now. next remove the two bolts that secure rear section of the cage to the frame and install the supplied plates as shown with the break towards the ground, leave these bolts slightly loose for now to ease getting the other hardware started.



Carefully set the bumper assembly down onto where the lower bolts were removed and the swing the topside into the backside of the vehicle and under the mounting brackets that were just mounted. Install the supplied hardware into the upper mounts and then loosely install the lower factory bolts previously removed. From here we will align the bumper with the vehicle and tighten the upper 3 bolts on each side first followed by the lower bolts last. Torque all factory hardware that was removed to the factory specifications prior to putting the vehicle back into service.



Once the bumper assembly and mounting are completed you will need to wire your license plate light into the vehicles circuit if one was installed. Finally, perform a final check over of all the work performed and enjoy another fine product from Elektric Offroad Designs!