

Quick Installation Guide

Wireless Access Point

Note: AP9650 is used as an example throughout the Guide. Images may differ from your actual product.
©2024 TP-Link 7106511509 REV1.3.0

1 Hardware Overview

Front Panel

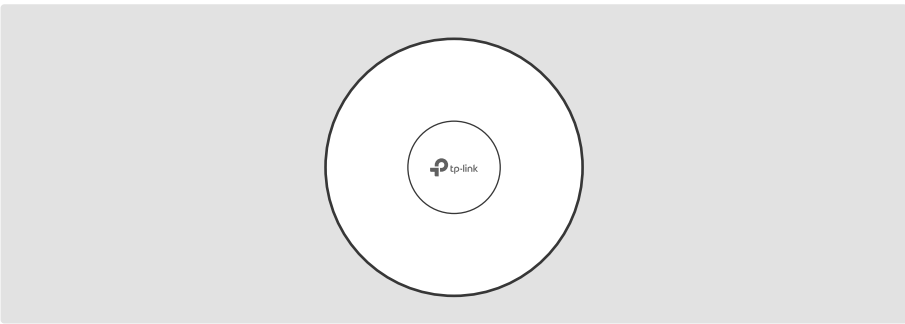

LED Indicator

- Blue On:** Working normally/Initializing. For APs with dual-color LED: Normal power supply
- Orange On:** For APs with dual-color LED: Low power supply
- Off:** Working abnormally/Power off/LED is turned off.
- Flash:**
- **Flash twice:** Initialization is completed.
 - **Flash quickly:** The AP is resetting, or the Controller is locating the device*.
 - **Flash once per second:** The AP is upgrading.
 - **Sustained flash:** The AP is in the isolated state.

* When the Locate feature is activated in the Controller, the LED will flash quickly for 10 minutes to help you locate and identify the device. You can disable this feature manually to stop the device from flashing.

Rear Panel

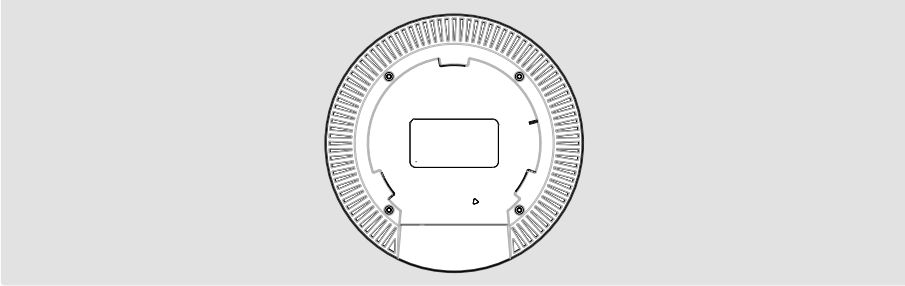

RESET

With the device powered on, press and hold the button for about 5 seconds until the LED flashes quickly, then release the button. The device will restore to factory default settings.

Ethernet Port: ETH (PoE)

The port is used to connect to a gateway/router or a switch to transmit data, or to a PSE (Power Sourcing Equipment), such as a PoE switch, for both data transmission and Power over Ethernet (PoE) through Ethernet cable.

Ethernet Port (for certain models)

The port is used to connect to a wired device.

Power Port

Plug one end of the power adapter to this port and the other end to a standard electrical wall outlet to power the AP.

Note: Power adapter is not included in the package contents of certain models. For details, refer to the product specifications or datasheet. For power supply specifications, refer to the product label.

2 Hardware Installation

The AP can be mounted to the ceiling, the wall, or in a junction box, using the accessories in the package. Choose a mounting option below.

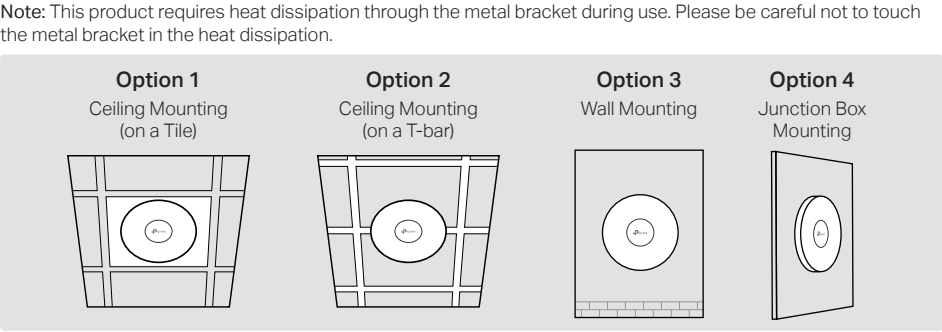

Option 1: Ceiling Mounting (on a Tile)

Note: Make sure that the ceiling tile is larger than the AP.

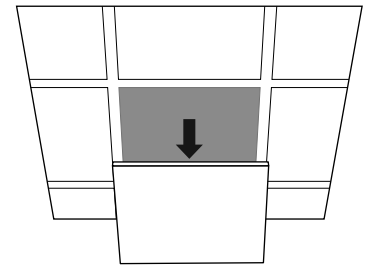
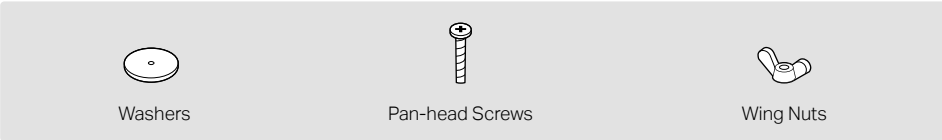

- 1 Remove a ceiling tile.

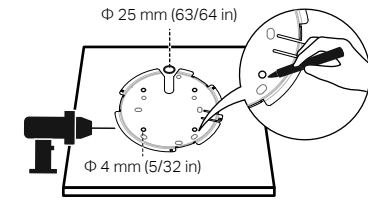

- 2 Place the mounting bracket in the center of the ceiling tile. Mark positions for the screw holes and the Ethernet cable hole, then drill holes at the marked positions.

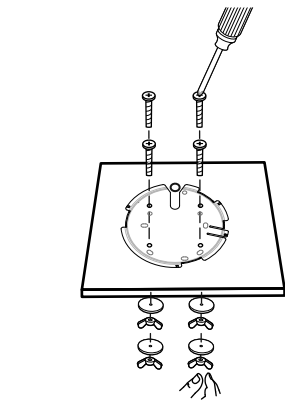

- 3 Secure the mounting bracket to the ceiling tile using pan-head screws, washers, and wing nuts.

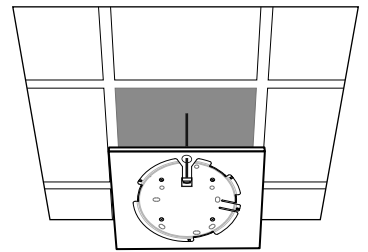

- 4 Feed the Ethernet cable through the hole and set the ceiling tile back into place.

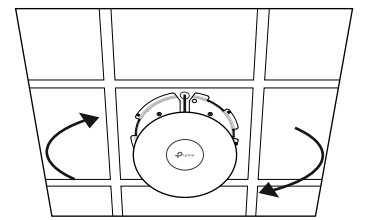

- 5 Connect the Ethernet cable to the Ethernet port on the AP. Attach the AP to the mounting bracket, then rotate it until it locks into place.

Option 2: Ceiling Mounting (on a T-bar)

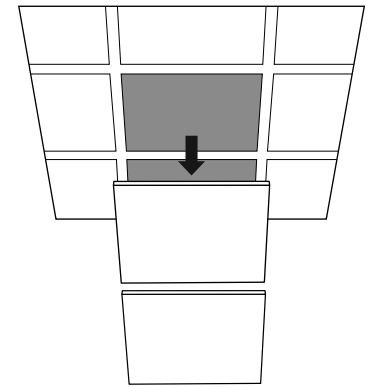

- 1 Remove the ceiling tiles next to a T-bar.

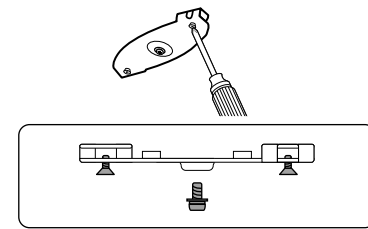

- 2 Detach the mounting screw and loosen the set screws of each T-bar mount.

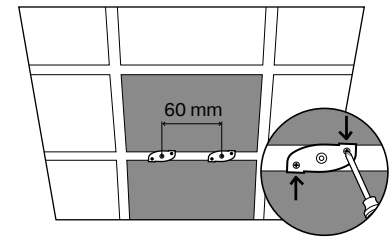

- 3 Place the T-bar mounts against the T-bar and turn clockwise. Tighten the set screws.

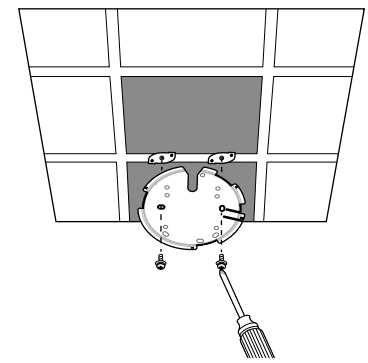

- 4 Secure the mounting bracket to the T-bar mounts using the mounting screws.

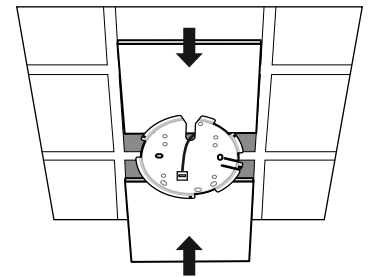

- 5 Route the Ethernet cable through the square cable hole on the mounting bracket. Set the ceiling tiles back into place.

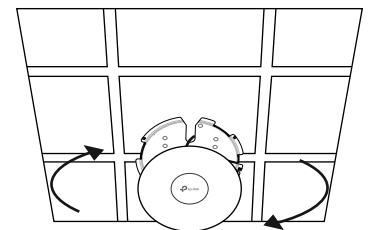

- 6 Connect the Ethernet cable to the Ethernet port on the AP. Attach the AP to the mounting bracket, then rotate it until it locks into place.

Option 3: Wall Mounting

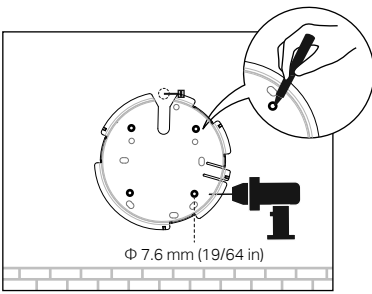
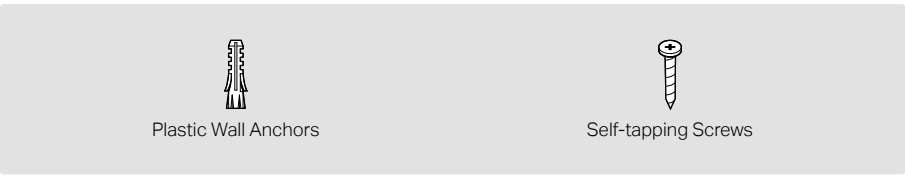

- 1 If your Ethernet cable feeds through the wall, position the mounting bracket below the cable hole. Mark positions for the screw holes, then drill holes at the marked positions.

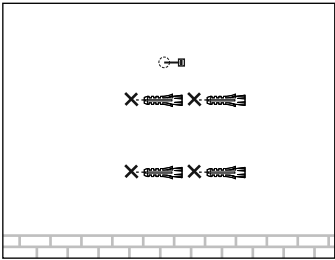

- 2 Insert the plastic wall anchors into the holes.

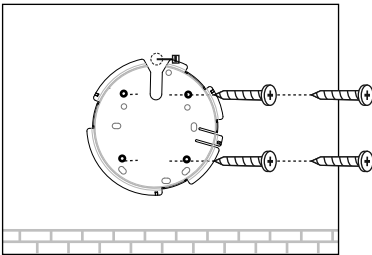

- 3 Secure the mounting bracket to the wall by driving the self-tapping screws into the anchors. Make sure that the shoulders of the mounting bracket are on the outside.

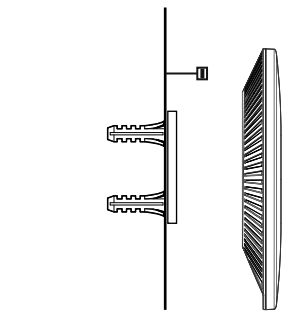

- 4 Connect the Ethernet cable to the Ethernet port on the AP.

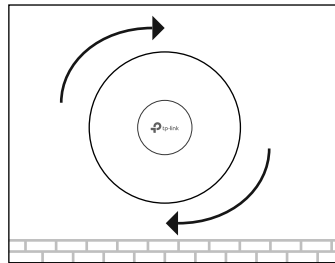

- 5 Attach the AP to the mounting bracket, then rotate it until it locks into place.

Option 4: Junction Box Mounting

Prepare the cables and the junction box in advance. Ensure that the mounting holes align to your junction box.

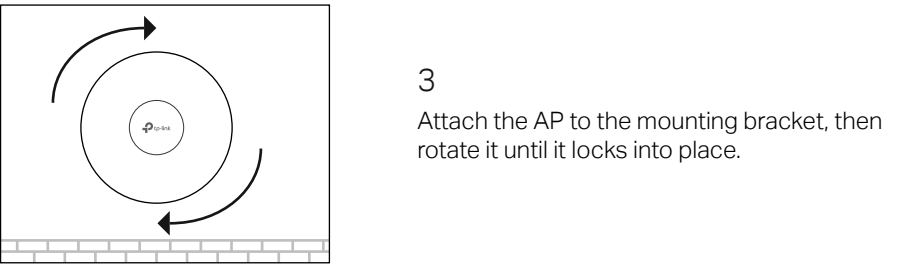
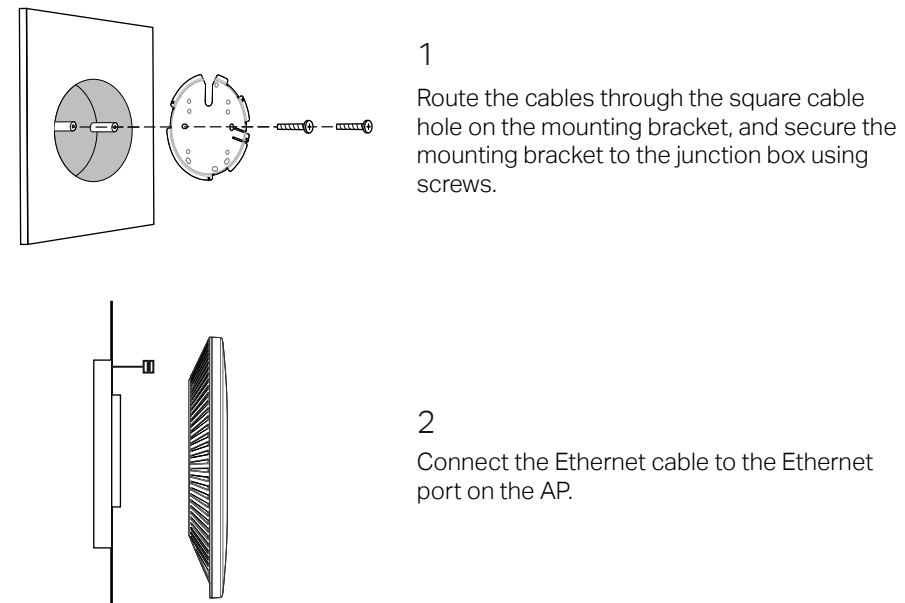
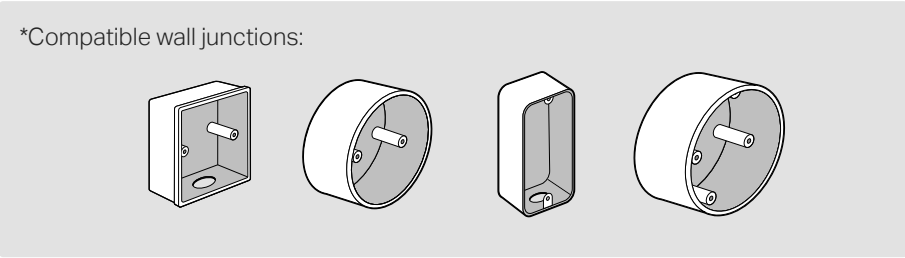

3 Power Supply

The AP can only be powered via a power adapter or a PSE device (such as a PoE switch) which complies with Power Source Class 2 (PS2) or Limited Power Source (LPS) of IEC 62368-1.

Option 1: Via PoE Switch

Connect an Ethernet cable from the PoE switch to the Ethernet port.

Note: For PoE power supply specifications, refer to the product label.

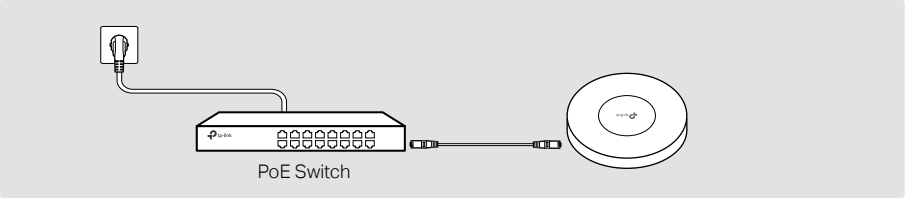

Option 2: Via Power Adapter

Plug one end of the power adapter into the power port of the AP and the other end to a standard electrical wall outlet.

Note: Power adapter is not included in the package contents of certain models. For details, refer to the product specifications or datasheet. For power supply specifications, refer to the product label.

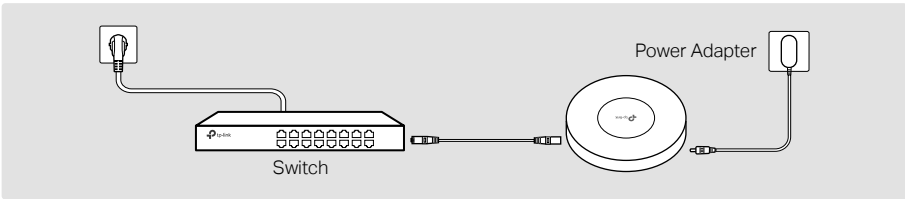

4 Software Configuration

Choose a method to set up your APs:

- **Method 1: Standalone Mode**
Configure and manage APs separately (Convenient for a small network with only a few devices)
- **Method 2: Controller Mode**
Configure and manage APs in batches on a central platform, namely Omada Pro Controller.

Method 1: Standalone Mode

If your network has only a few devices, you can configure and manage APs separately on their web pages.

Note: The AP web page is inaccessible while the AP is managed by a Controller.

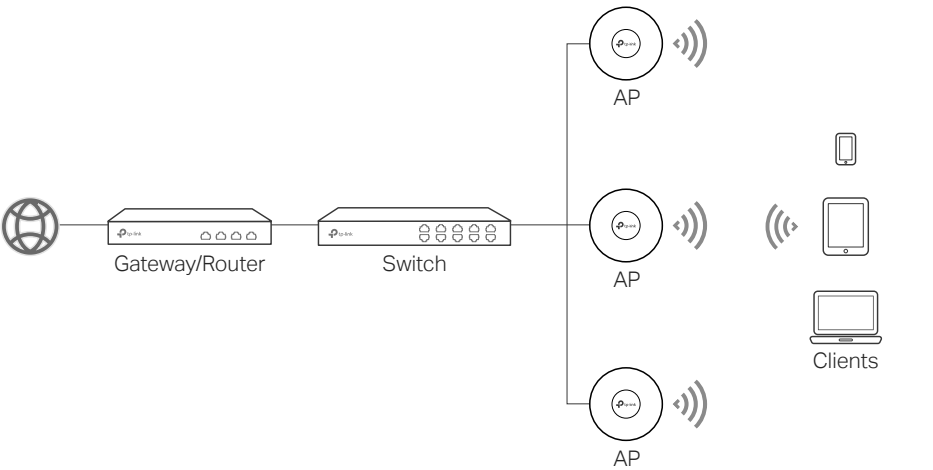

- Notes:
- Before you start, be sure to power up and connect your devices according to the topology figure.
 - A DHCP server (typically a gateway/router with the DHCP function enabled) is required to assign IP addresses to the APs and clients in your local network.

Via Web Browser

1. Connect your device to the AP by using the default SSIDs printed on the label of the product.
2. Launch a web browser and enter <https://tplinkeap.net> in the address bar. Use **admin** for both Username and Password to log in.
3. Set up a new Username and Password for secure management. Then you can configure the AP.

Via Omada App

1. Download and install the TP-Link Omada App from App Store or Google Play.
2. Connect your mobile device to the AP by using the default SSIDs printed on the label of the product.
3. Launch the Omada App, go to the **Standalone Mode > EAPs** page, and wait for the AP to appear. Tap on the AP to configure it.

The Omada App is designed to help you quickly configure common settings. If you want to configure advanced settings, use the web page of your AP.

Method 2: Controller Mode

Omada Pro Controller integrates Omada Pro gateways/routers, switches, access points, and more for centralized management.

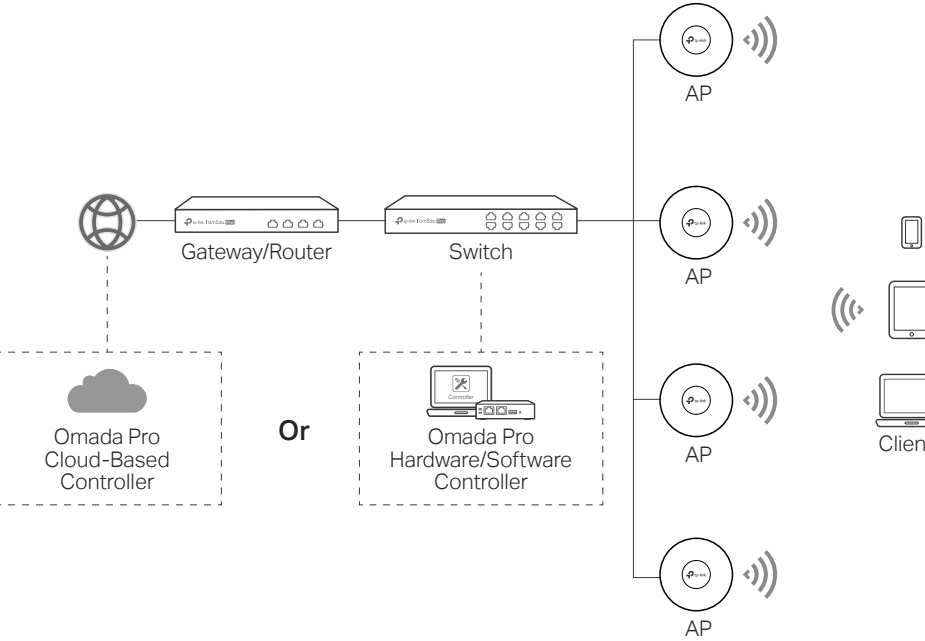

- Notes:
- A DHCP server (typically a gateway/router with the DHCP function enabled) is required to assign IP addresses to the APs and clients in your local network.
 - The Omada Pro Controller must have network access to your Omada Pro devices (the gateways/routers, switches, and APs) in order to find, adopt, and manage them.

Via Web Browser

1. Get an Omada Pro Controller ready.
 - **Option 1: Omada Pro Hardware Controller**
Obtain a Hardware Controller and refer to its Installation Guide to set it up.
 - **Option 2: Omada Pro Software Controller**
Get a PC with Windows or Linux OS, and contact the sales staff to get the installation package of Omada Pro Software Controller. Then run the file and follow the wizard to set up the Controller.

Note: To manage your devices, the Software Controller needs to keep running on your PC.
 - **Option 3: Omada Pro Cloud-Based Controller**
Contact the sales staff to grant the Omada Pro Cloud-Based Controller permission. Go to the Omada Portal (<https://omada.tplinkcloud.com>) and log in with your TP-Link ID. Then click + **Add Controller** to add a Cloud-Based Controller and set it up.
2. Launch the Controller, access your site, and go to the **Devices** page.
3. Now you can adopt and manage the APs.

Tip:
For the Hardware/Software Controller, you are recommended to enable Cloud Access and bind it to your TP-Link ID. This enables you to remotely access and manage the Controller and Omada Pro devices via Omada Portal (<https://omada.tplinkcloud.com>).

For detailed configurations, refer to the User Guide of the Controller at our official website: <https://www.tp-link.com/support/download/?type=smb>

Via Omada App

1. Download and install the TP-Link Omada App from App Store or Google Play.

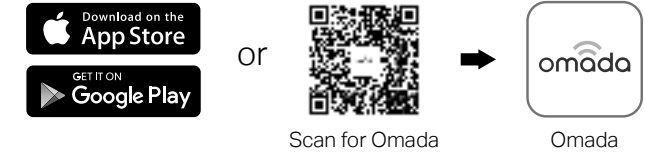

2. Add the Controller with local access or cloud access.
 - **Local Access**
Note: Local access applies to the Hardware Controller and Software Controller only.
 - a. Connect your mobile device to the AP by using the default SSIDs printed on the label of the product.
 - b. Launch the Omada App and go to **Controller - Local Access**. Tap the + button on the upper-right corner to add the Controller.
 - **Cloud Access**
 - a. Launch the Omada App and go to **Controller - Cloud Access**.
 - b. Log in with your TP-Link ID. A list of Controllers that have been bound with your TP-Link ID will appear.
3. Launch the Controller, access your site, and go to the **Devices** page.
4. Now you can adopt and manage the APs.

The Omada App is designed to help you quickly configure common settings. If you want to configure advanced settings, use the web page of your Controller.



Safety Information

- Keep the device away from water, fire, humidity or hot environments.
- Do not attempt to disassemble, repair, or modify the device. If you need service, please contact us.
- Do not use the device where wireless devices are not allowed.
- Do not use damaged charger or USB cable to charge the device.
- Do not use any other chargers than those recommended.
- Adapter shall be installed near the equipment and shall be easily accessible.

EU Declaration of Conformity

For APs with adapters:
TP-Link hereby declares that the device is in compliance with the essential requirements and other relevant provisions of directives 2014/53/EU, 2009/125/EC, 2011 /65/EU and (EU) 2015/863.
The original EU Declaration of Conformity may be found at <https://www.tp-link.com/en/support/ce/>

For APs without adapters:
TP-Link hereby declares that the device is in compliance with the essential requirements and other relevant provisions of directives 2014/53/EU, 2011 /65/EU and (EU) 2015/863.
The original EU Declaration of Conformity may be found at <https://www.tp-link.com/en/support/ce/>

UK Declaration of Conformity

TP-Link hereby declares that the device is in compliance with the essential requirements and other relevant provisions of the Radio Equipment Regulations 2017.
The original UK Declaration of Conformity may be found at <https://www.tp-link.com/support/ukca/>

For detailed configurations, refer to the user guides of the Controller and APs. The guides can be found on the Download Center of our official website: <https://www.tp-link.com/support/download/?type=smb>.

To ask questions, find answers, and communicate with TP-Link users or engineers, please visit <https://community.tp-link.com/business> to join TP-Link Community.

For technical support, the user guide and other information, please visit <https://www.tp-link.com/support/?type=smb>, or simply scan the QR code.

