

11 Spool Holder Installation (skip this step for multicolor printing)

1. Secure the base of the spool holder using the screws from the No. 6 bag.

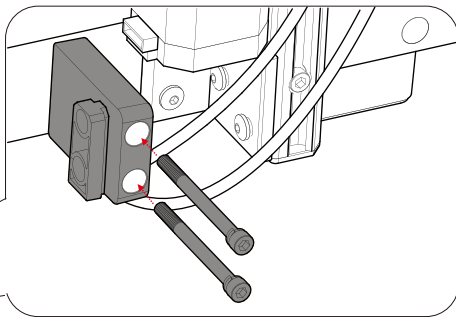
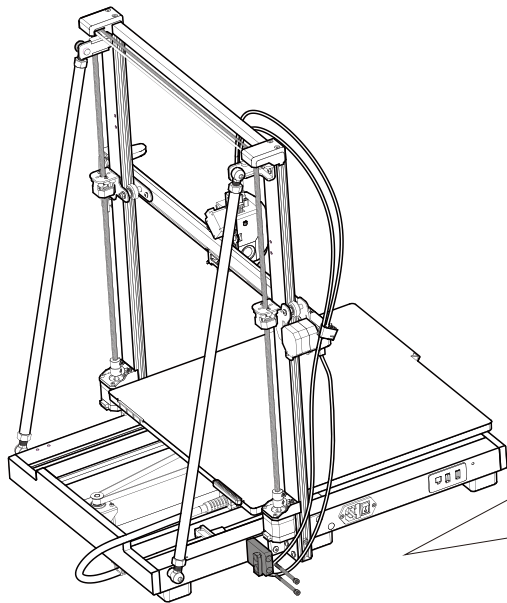
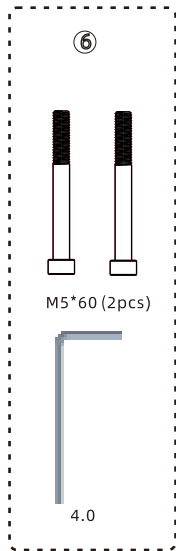

11 Spool Holder Installation (skip this step for multicolor printing)

2. Put the cylindrical handle into the spool holder hole, and then rotate it at a certain angle to fix it.
3. Press the spool holder down and insert it into the groove behind the printer base.

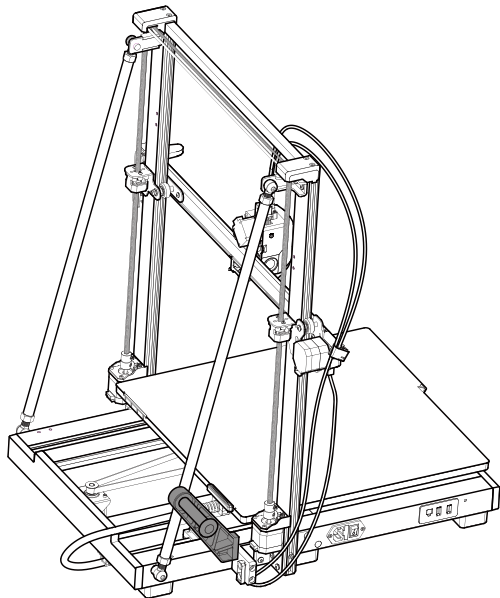
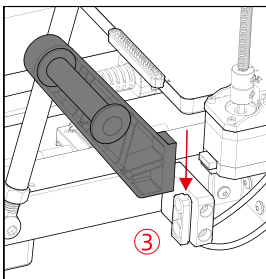
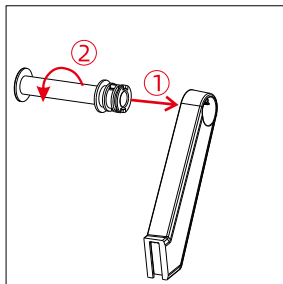

Check Before Use

1. Pulley elastic adjustment

Check if the printhead is firmly installed, and adjust the hexagonal isolation column located underneath the printhead until it slides smoothly without any wobble.

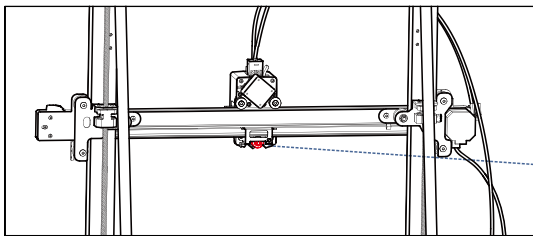

Print head



Adjust the hexagonal spacer behind D-wheel

Check if the hotbed is firmly installed. If it is, adjust the hexagonal isolation column located underneath the hotbed until it slides smoothly without any wobble.

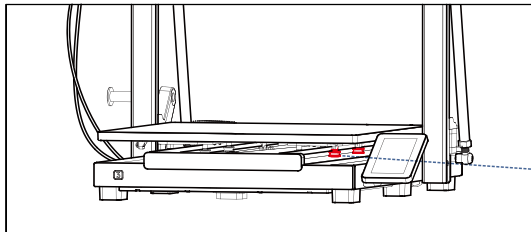

Platform

Adjust the hexagonal spacer on the Y axis

Similarly, the pulleys on both sides of the gantry frame can also be adjusted.



2.Power Connection

Insert the power cable into the printer's power input, then plug the power cable into a power source and power on the printer.

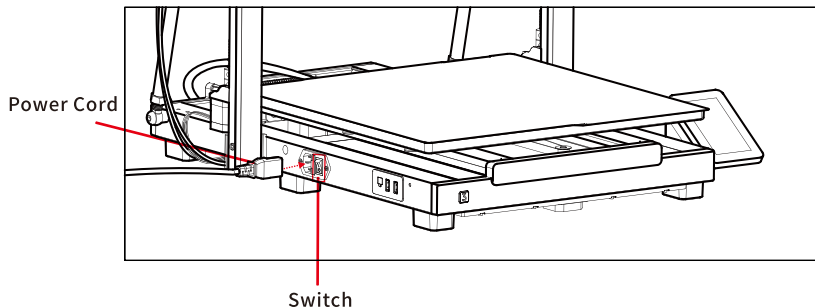

Note:

- 1.When inserting the power cord, please avoid crossing it with the printhead cable to prevent interference.
- 2.Before turning on the power, please check the printer power level matches the local voltage .



Power On

① Language



② Area



③ Network



④ Cloud



⑤ Complete Setup



⑥ Insert U-Disk



⑦ Self Test



⑧ Auto-Level



⑨ Load Filament



⑩ Vibration Compensation ⑪ Print The Model

