

STB204012

nVent HOFFMAN STB Terminal Box Mild Steel IP66 H200 x W400 x D120mm



Component type	Enclosure/cabinet (empty)
Range	STB
Model	N/A
Product status	Existing

The nVent HOFFMAN terminal boxes have high impact and ingress protection to provide a robust, long-lasting solution in various industrial applications. The included mounting plate, together with optional accessories like pre-cut DIN rail, hinges and brackets, allows for fast and easy customisation to suits specific installation requirements.

ELECTRICAL

EMC-version	No
Material	Mild steel
Material quality	Other
Surface finishing	Powder coating
Material thickness	1.2 mm
Colour	Grey

CONSTRUCTION

RAL-number	7035
IP rating	IP66
Degree of protection (NEMA)	4
Type of lock	Other
Material lock	Other
Gland plate(s) included	No

MECHANICAL

With mounting plate	No
Mounting plate depth-adjustable	Yes
Floor standing wall model	No
Suitable for wall mounting	Yes
Connectable	No
Number of doors	1
Number of locks	0
Suitable for wall built-in	No
Suitable for outdoor set-up	No
Pitched roof	No
With glazed door	No
With ventilation door	No
With backside door	No
Impact strength	IK08

STB204012

nVent HOFFMAN STB Terminal Box Mild Steel IP66 H200 x W400 x D120mm



TERMINAL BOXES



DIMENSIONS

Width	400 mm
Height	200 mm
Depth	120 mm
Weight	3.35 kg

DIMENSIONAL DIAGRAM

Bottom view



Front view

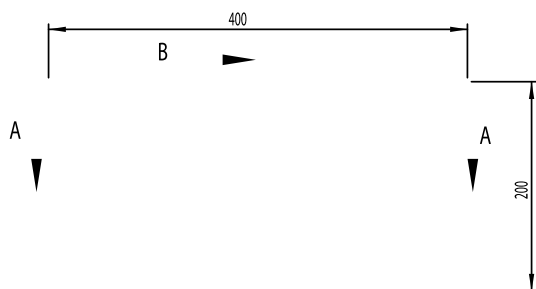

Sectional top view

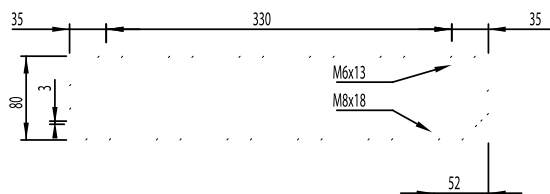

Section A-A

Sectional side view

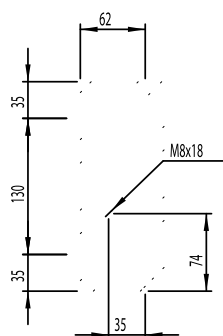

Section B-B

Rear view

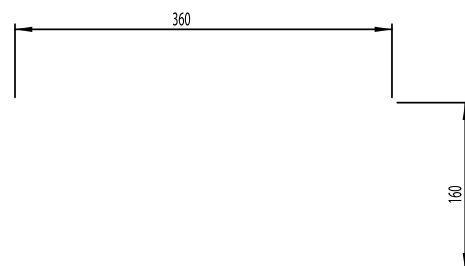

RELATED PRODUCTS

ACCESSORY



Item No: AW41

Required: No

Description: nVent HOFFMAN STB/NLS/MAS/MAD Wall Mount Brackets Zinc Steel for Qty 4



Item No: BMP2040

Required: No

Description: nVent HOFFMAN STB/SSTB Mounting Plate Steel H200 x W400mm for STB and SSTB2040

STB204012

nVent HOFFMAN STB Terminal Box Mild Steel IP66 H200 x W400 x D120mm



TERMINAL BOXES



RELATED PRODUCTS

ACCESSORY



Item No: BPP20

Required: No

Description: nVent HOFFMAN STB/SSTB DIN Profiles to suit STB and SSTB H200mm



Item No: BPP40

Required: No

Description: nVent HOFFMAN STB/SSTB DIN Profiles to suit STB and SSTB H400mm



Item No: EPF0400

Required: No

Description: nVent HOFFMAN MAS Pole Mount Kit for W400mm MAS