

1.Description:

Home automation is "The Internet of Things". It simply means the way all devices or appliances are networked together to provide customers with a seamless control over their home equipment.

This module is an affordable device that provides users with smart home control. It is a WiFi-based wireless switch that can connect to a wide range of appliances. It transmits data to a cloud platform through the WiFi router, which enables users to remotely control all the connected appliances, via the mobile application eWeLink.

This module makes all home appliances smart. As long as the mobile has a network, users can remotely control the appliances from anywhere at any time. Another feature available is to set timing schedules for the appliances, which can include, scheduled on/off, and can thus, help users maintain an easy life.

It supports to connect and control one home appliances, which can be turned on/off by app eWeLink. It works in self-locking mode. In self-locking mode, users can turn on/off the 1 connected devices independently.

2.Features:

- 1>.Remote intelligent control
- 2>.With a casing
- 3>.Support power supply output
- 4>.Support 5A high current load
- 5>.Support 8 groups control modes
- 6>.Ultra high monitoring accuracy
- 7>.Supports status tracking, home appliances status timely feedback to App
- 8>.Support share control
- 9>.Support IOS and Android
- 10>.Easy installation, easy handling and can be activated immediately and stably
- 11>.APP supports multiple languages
- 12>.Support power supply output

3.Parameters:

- 1>.Product Name:L-5A01 Wireless WIFI Intelligent Control Switch
- 2>.Product Number:L-5A01
- 3>.Working voltage: AC 85~250V
- 4>.Load voltage: AC 85-250V
- 5>.Load current:5A(max)
- 6>.Color:White
- 7>.WIFI standard:2.4GHz b/g/n
- 8>.Operating Temperature:-40℃~85℃
- 9>.Operating Humidity:0%-99.9%RH
- 10>.Size:56*40*20mm

5.Function:

1>.Smart Schedules

Users can preset repeat or single timing schedules to turn on/off devices according to your needs. Imagine that the light is off in the evening (10:00 pm) and on in the morning (7:00 am) every day automatically.

2>.Countdown Timer

A countdown timer allows users to turn on/off a device at a countdown time. This feature supports up to 24 hours countdown time. It can be widely applied to devices with battery for charging. Just imagine you have your mobile phone stopped charging after 3 hours countdown time.

3>.Loop Timer

eWeLink is the first smart home APP in domestic market to release the powerful loop timing function. A loop timer allows users to turn on/off a device at preset intervals and run for a specified time. With a loop timer, you can make a device launch every 30 minutes and last for 10 minutes each time.

4>.Grouping Function

It allows users to assign all added devices to different groups so that they can easily check and manage the devices. To use this feature, simply click the drop-down menu on the top of device list.

Create a group named 'My Study Room', and add all the home appliances in the study room into the group for convenient management.

5>.Smart Scene

The smart scene allows users to use one device to automatically trigger ON/OFF one or more devices.

So you can create two scenes named 'Return Home' and 'Leave Home'. As soon as you arrive or leave home, the door is open/closed, lights or other home appliances are automatically turned on/off.

6>.Share Control

Device owners can share control of their own devices to other eWeLink users. Invite your family members to control your smart home together!

Tap on 'SHARE' and enter the eWeLink ID you want to share with (either phone number or email address), make sure the person is also online. Once the invitation message is confirmed, he/she will have right to control your devices.

7>.Remote Control

Controlled by APP.Turn electrical devices on/off from anywhere.

6.Work mode:

It just can work on self-locking mode:

For example, if users turn on, connected device keeps on. If users turn off, connected device keeps off.

For example:Press button,relay will keep on;Press again,relay OFF.

7.Control method:

1>.APP eWeLink intelligent control in Manual mode.It need press button on APP to turn ON/OFF device.

2>.Button control mode.It no need APP at this mode.It just need press button 'SET' to turn ON/OFF device directly.

8.APP eWeLink intelligent control:

1>.Module can be control by APP intelligent control.

2>.It can Add/Sharing/delete device,setting delay,APP remote control,get work status and so on.

3>.Pairing steps:

Step 1:Install and register APP eWeLink, select the appropriate language.Use can get APP for 'APP Store' or 'Google Play' or eWeLink Official website.

Step 2:Connect AC 85~250V power supply on 'L' and 'N' at input terminal.(Note:Please don't connect to load before pairing and test.)

Step 3:Make sure module in the range of WIFI and phone connect to the same WIFI router.

Step 4:Open APP eWeLink.

Step 5:Keep press the set button on L-5A01 for more than 7 seconds.When the LED indicator starts to flash and then Click 'Add Device'.

Step 6:Select 'Touch' on APP(recommended).Users can also choose AP mode.

Step 7:Input WIFI name and password which phone is connect.

Step 8:Waiting and configuring about 3minute.

Step 9:If the pairing fails,please try it several times(remove power supply).

Step 10:Reset the module device name after connection successfully.

Step 11:Test and set module.

4>.Use steps:

Step 1:Make sure already paired successfully between module and APP.

Step 2:Make sure module in the range of WIFI which has paired.

Step 3:Make sure phone have connect to WIFI/4G/3G/2G.Any one the internet.It means phone no need connect to WIFI after paired successfully.

Step 4:Connect to Load at output terminal.

Step 6:Press button directly to turn ON/OFF.

Step 7:Selective setting Share/Schedule/Timer/Loop timer if need these functions.

Step 8:Connect AC 85~250V power supply on 'L' and 'N' at input terminal.

Step 9:Using and control module.

9.Button Control:

1>.Module can be control by button 'SET' on module without pair with WIFI.

2>.Use steps:

Step 1:Connect AC 85~250V power supply on 'L' and 'N'.(Note:Please don't connect to load before select work mode and test.)

Step 2:Test.E.g press button 'SET',then output relay will turn ON,and output LED indicator will turn ON at the same time.

Step 3:Remove power supply and then connect to Load at output terminal.

10.Application:

- 1>.Smart home control.Remote control of household appliances such as air conditioning, electric fans, rice cookers, lights, etc.;
- 2>.Automatic motor control;
- 3>.Production workshop intelligent operation;
- 4>.Intelligent farming control;

11.Note:

- 1>.It can output voltage so module can connect to load directly!
- 2>.At first time when pairing,phone must be connected to WIFI from router.It is not need connect to WIFI after pairing success.
- 3>.Its power supply is AC and can not provide voltage from DC.
- 4>.It does not support Local Area Network (LAN).

12.Frequently Asked Questions:

- 1>.Why does the relay start working automatically after the power is turned ON?
Q:Poor contact,Please remove power supply and reconnect more than once.
- 2>.Why can't pair successfully?
Q:Please make sure module in the range of WIFI from router.Phone connect to the same WIFI.Second,need try more than once.
- 3>.Can it get work status?
Q:Yes,APP can get work status.
- 4>.Why does APP display OFF and module cannot be controlled after the pairing is successful?
Q:Module need inside set after pairing successful about 1-2 minutes.Then check with 'WIFI indicator status description' to find reason.Check if your router sets the filtering MAC address.Delete device and re-pair.Use 2.4G router and don't use others.
- 5>.Why can not add device?
Q:Close WIFI on phone and waiting for more than 10minutes.Then restart module and re-connect WIFI.Keep module close to router.

13.Package:

- 1>.1pcs L-5A01 Wireless WIFI Intelligent Control Switch;

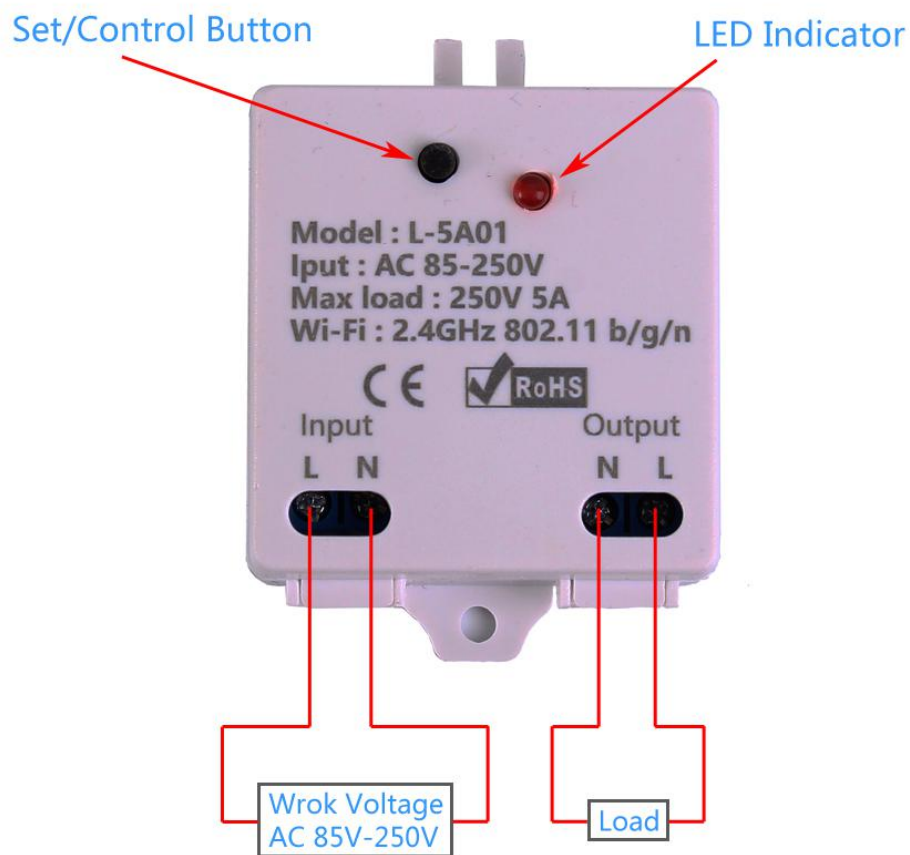

It can output voltage same to input. So it can connect to load directly.

Internal structure

LED Indicator

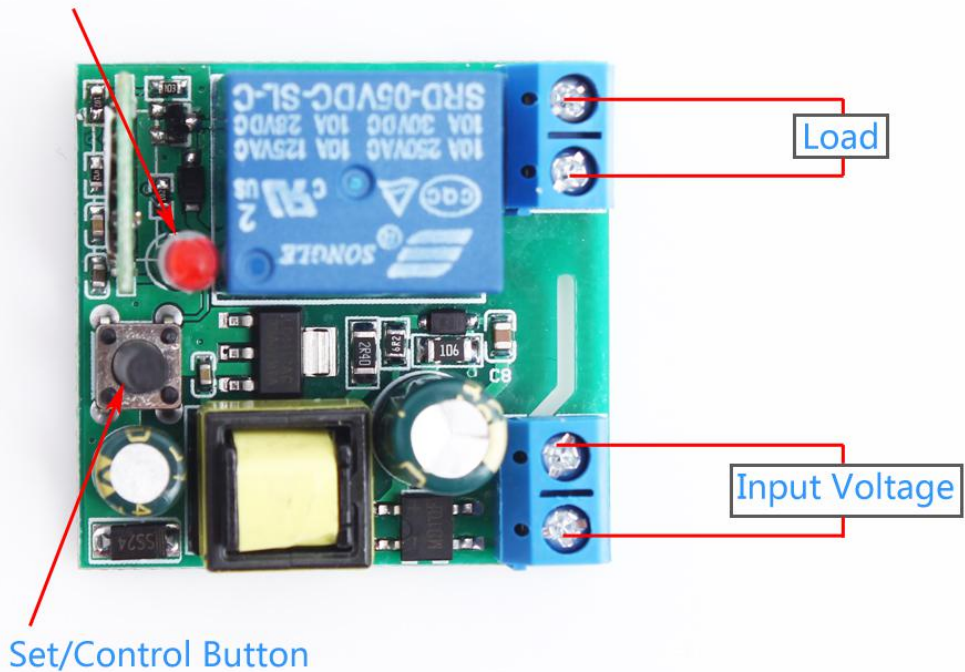



APP Control

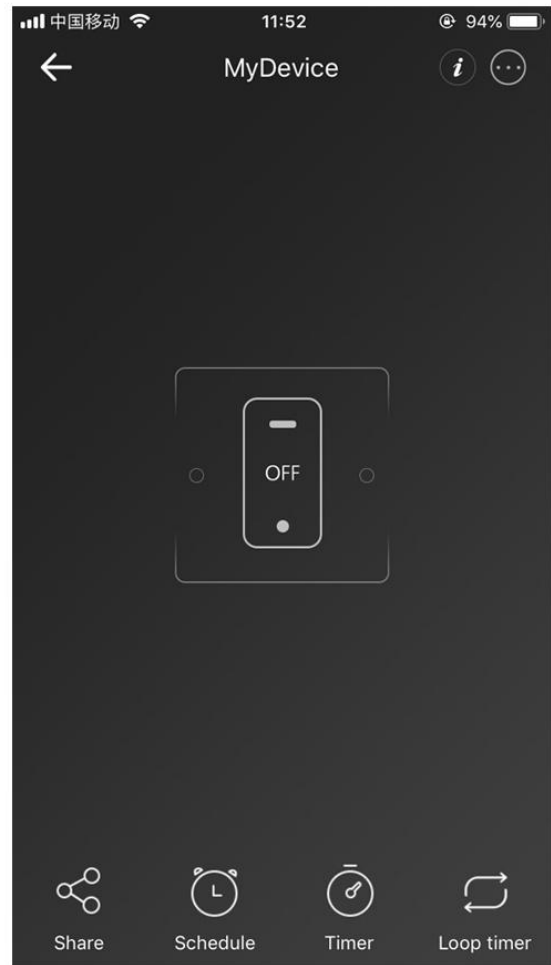
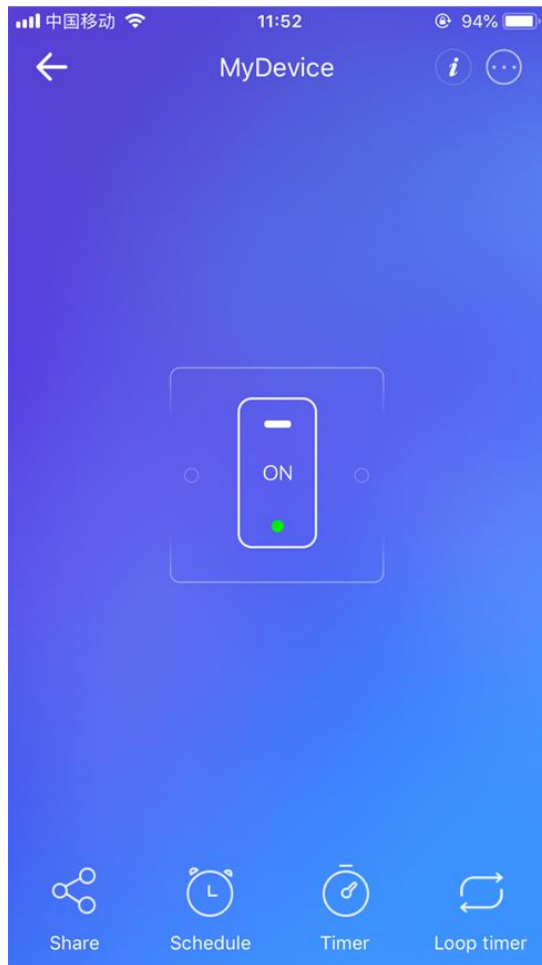

Share

中国移动 10:56 78%

Share

Share Control

China (+86) >

enter account to share with

Timer permission ^

☒ Add

☒ Edit

☒ Delete

☒ Enable/Disable

Please input note

Cancel

OK

+ Share

Set Schedule

中国移动 10:56 78%

Schedule

Date		Time	
Month	Day	Hour	Min
2	20	08	54
3	21	09	55
4	22	10	56
5	23	11	57
6	24	12	58

Year:

This year >

Repeat:

Only once >

State:

☒ ON

OFF

Cancel

Save

Set Timer

中国移动 10:56 78%

← Timer

Countdown at:2019-04-22 11:26

Timer:30Minute

Day	Hour	Minute
		28
		29
00	00	30
01	01	31
02	02	32

State:

☒ ON ☐ OFF

Cancel Save

Set Loop Timer

中国移动 10:57 77%

← Loop timer

Start time

Year	Month	Day	Hour	Min
	02	20	08	55
	03	21	09	56
2019	04	22	10	57
2020	05	23	11	58
2021	06	24	12	59

Cycle :
0 Hour 10 min

Start action: ON >

☒ After:
0 Hour 5 min

Action: OFF >

Cancel OK