

# Instruction Manual Smart Switch

Wi-Fi+RF433

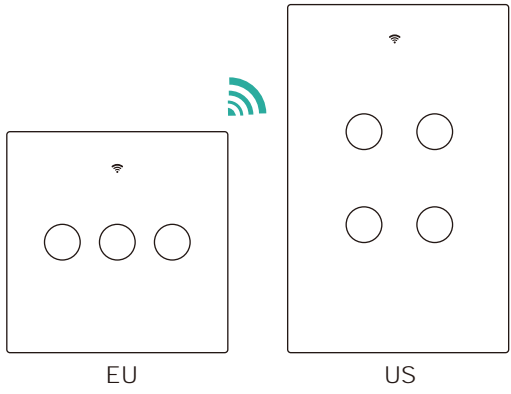

EU

US

English



## Step 5

- Remove the panel with screwdriver  
(Please don't install with electricity power on)

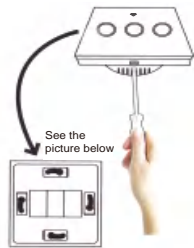

## Step 6

- Prepare to install wiring
    - A. Live wire connects "L" terminal
    - B. Neutral wire connects "N" terminal
    - C. Lamp wire connects "L1,L2,L3,L4" terminal
  - 1 Gang connects "L1" terminal
  - 2 Gang connects "L1,L2" terminal
  - 3 Gang connects "L1,L2,L3" terminal
  - 4 Gang connects "L1,L2,L3,L4" terminal
- 1 Gang L1 and N line.
  - 2 Gang L1 and N line.
  - 3 Gang L1 and N line.
  - 4 Gang L1 and N line.

- Bitte scannen Sie den QR-Code, um das deutsche Handbuch, das Installationsvideo und die Funktionseinführung zu erhalten
- Escanee el código QR para obtener el manual en español, el video de instalación y la introducción de la función
- Veillez scanner le code QR pour obtenir le manuel en français, la vidéo d'installation et l'introduction des fonctions
- Отсканируйте QR-код, чтобы получить руководство на русском языке, видео по установке и описание функций
- Scansionare il codice QR per ottenere il manuale in italiano, il video di installazione e la guida alle funzionalità. Video di installazione e funzionalità
- Leia o código QR para obter o manual em português, o vídeo de instalação e a introdução das funções
- Zeskanuj kod QR, aby uzyskać instrukcję, filmy instalacyjne i funkcje
- من فضلك قم بمسح رمز الاستجابة السريعة (QR-code) للحصول على دليل المستخدم باللغة العربية وفيديو التثبيت ووصف الوظائف



请扫描二维码获取说明书手册、安装视频和功能介绍

## Product Description

This new designed glass panel wireless touch smart switch is designed with WiFi+RF to replace traditional switches with a variety of ways to control. Now one new smart feature as multi-control association to other smart switches is added into the Smart Life/Tuya App, together with the backlight on/off and relay status. And its scratch resistance glass panel is suitable for different decoration styles with its best value.

**Note:** Button sound on and off: no button operations before operations begin within 6 seconds. Then press switch button for 4 times and long press for the fourth time until the switch beep sounds as Di-Di for 2 times for successful operation.

## Safety Information

Risk of Electric Shock: Electricity can cause personal injury and property damage if handled improperly. If you are not sure about any part of these instructions, please seek professional assistance from a qualified electrician.

### Technical Parameters:

Model: WS-EU-RF / WS-US-RF  
Voltage: 90-250V AC, 50/60Hz  
Max. Current: 10A/Gang; Total 10A  
Wireless Protocol: Wi-Fi 2.4GHz+RF433MHz

### Warnings:

Turn off the power at the circuit breaker and test that power is off before wiring.

## Installation

### Note:

- Make sure that the power at the circuit breaker is off before wiring.
- Neutral Wire is required. Confirm the wall box contains a Neutral Wire (typically white). If the wall box doesn't have a Neutral Wire, please try another location at your home or call a professional electrician to install the switch.
- The wire colors indicated in this manual are the usual colors and may differ in some houses.
- Ensure the wire conductors are securely fastened to each wire.
- Ensure the Wi-Fi signal is steady and normally working before wiring.
- If you don't have any wiring experience, please call a professional electrician.

### Step 1

- Turn off the circuit breaker and use the electrical tester to test the power.
- Ensure the circuit breaker is off before wiring.

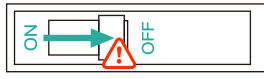

### Attention:

Please disconnect the power supply before installing or removing the device to avoid irreversible damage on the device from the electric current or some unpredictable problems such as lamp flashing.

## Step 2

- Remove the old switch

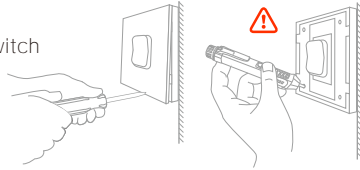

## Step 3

- Remove the switch and pull it away from the wall. Identify Line/Load Wire (Note: The color of your wire may be different from the color shown on the manual.)

### Verify power is off

- We recommend you remove the faceplate from the old switch and use an electrical tester to test all wires connected to the switch to ensure there is no voltage in the circuit.
- You may need to turn off more than one circuit breaker.

## Step 4

- Take pictures of the wiring

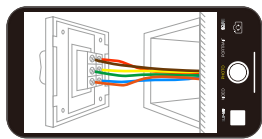

- Follow the wiring diagram to connect the switch wires to the wires in the wall box with the wire conductors.

## Add Devices

### 1 Download MOES App



MOES App is upgraded as much more compatibility than Tuya Smart/Smart Life App, functional well for scene controlled by Siri, widget and scene recommendations as the fully new customized service.  
(Note: Tuya Smart/Smart Life App still works, but MOES App is highly recommended)

### 2 Registration or Log in

- Download "MOES" Application
- Enter the Register/Login interface: tap "Register" to create an account by entering your phone number to get verification code and "Set password". Choose "Log in" if you already have a Smart Life account.

### 3 Configure the APP to the switch

- Preparation: Ensure the switch has been connected with electricity, ensure your phone has been connected to Wi-Fi and is able to connect to the Internet.

### Note:

The switch only supports 2.4G network. If you have connected 5G network, please disconnect 5G network firstly and connect 2.4G network.

## Wi-Fi link method

Complete the wiring of the switch module before pairing

### Note:

The switch only supports 2.4G network. If you have connected 5G network, please disconnect 5G network firstly and connect 2.4G network.

- Scan the QR code to configure the network guide.

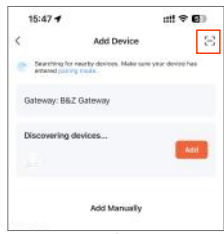
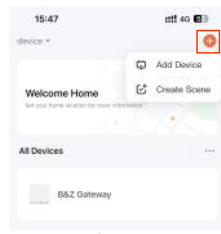

Please connect the device according to the configuration process.

- Select EZ mode, tick to confirm that the indicator flashes, and click Next

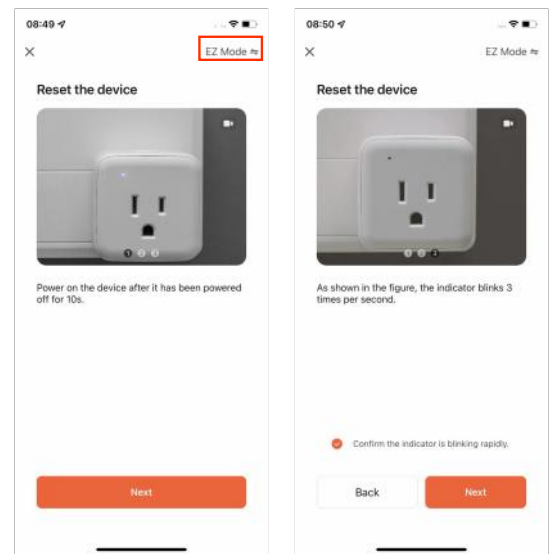

- Enter Wi-Fi Password and click "Next", waiting for completing the connection.

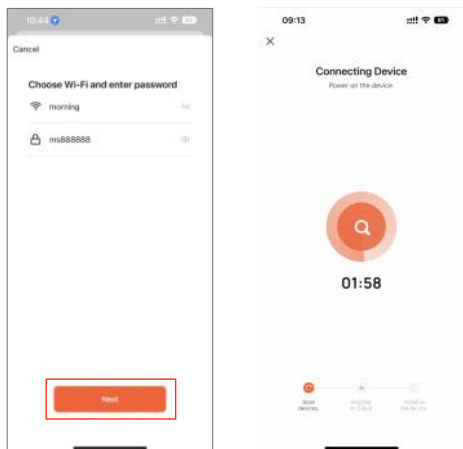

- Select the device you want to add and click "+"



## Step 7

- Put the switch into switch box in the wall
- Mount the two side screws
- Install the glass panel (install from up above)
- Finish installation

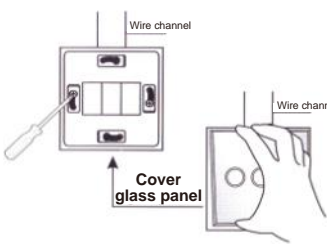

### How to reset/re-pair Wi-Fi code

Press the switch button for 6 times and hold on the 6th time, then release until you hear Di-Di-Di (3 times), and the blue indicator on the switch will flash fast after 3 seconds. Reset/re-pair is successful.

### 32 Remote radio frequency (RF) link method:

#### Pair and clear up the RF code

##### 1. How to pair the RF code

- (can be turned on and off): Confirm your switch is off before operations. Press the switch button for about 8 seconds until you hear Di-Di (2 times). Then the matching of RF code is successful. The key of the remote controller can control the switching of the state of the switch on and off corresponding to the position of the switch.
- (Open only): Confirm your switch is off before operations. Press the switch button for about 5 seconds until you hear Di (1 time). After that, release the button, press the corresponding button on the remote control to turn on. Then the matching of RF codes is successful. The key of the remote controller can control the corresponding position of the switch to be open.
- (Close only): Confirm your switch is on before operations. Press the switch button for about 5 seconds until you hear Di (1 time). After that, release the button, press the corresponding button on the remote control to turn on. Then the matching of RF codes is successful. The key of the remote controller can control the corresponding position of the switch to be closed.

##### 2. How to clear up the RF code

Confirm your switch is off before operations. Press the switch button for a long time until you hear Di-Di-Di (4 times), and then release the button. The RF code is now cleared up.

### 33 How to achieve multi-control association

Note: Please confirm you have successfully finished the Wi-Fi link method above for adding this switch to your Smart Life App before the association.

- Wi-Fi add another smart switch to the same Smart Life/Tuya App. (If there is a smart switch having been added before to the app, just go to next step.) **Note: There is no need to wire the new added switch to the light, only L and N are required for wiring.**
- Then you will see two devices in the app and click the main switch (as One gang switch as below) by entering into the next operation.

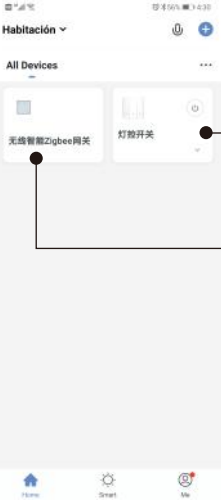

New Added Switch

Main Switch

- Click "Z" in the upper right corner and choose "Multi-Control Association", and then click "+" in the right corner

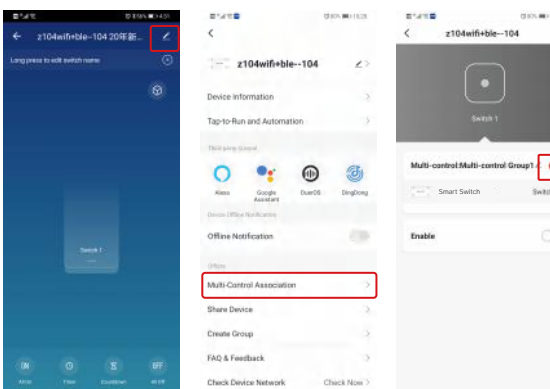

- Choose the switch that you want to associate to and then choose the switch button that you want to control the same light.

- Then go back to previous page, you will see two items in the page. One is your main switch, the other is the one you associate just now.

**Note:** Please confirm the associated switch is enabled.

- Now you are able to control your light with two switches. Do not associate another button in the same switch for multi-control.

- If you want to add another third or more smart switches to control your light, just repeat the steps above. And you will see the result as below when you associate another new switch.

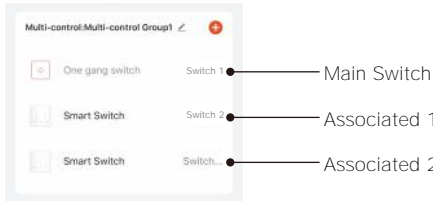

## Enter MOES Skill in Alexa APP

### 1. Complete product networking configuration in the App

Complete the device's networking configuration according to the prompts in the App.  
**Note:** In the App, change the name of the device to an easily identifiable name such as Alexa; names are usually in English, such as "bed light".

### 2. Configure the Amazon Echo device

(If you have already configured Amazon Echo, you can skip this step. The following instructions are based on the iOS client.)

- Make sure your Amazon Echo device is powered on and connected to a Wi-Fi network.
- Open the Alexa App on your phone. After successful login, tap on the menu in the upper left corner of the Home page, select "Settings" and tap "Set Up A New Device" to set up the Amazon Echo.
- Choose your Amazon Echo device type and language for connecting. Press and hold the small dot on the device until the light turns yellow. Then tap "Continue" to connect to the hotspot.
- After connecting to the Amazon Echo hotspot, return to the page. At this point, the connection is successful.

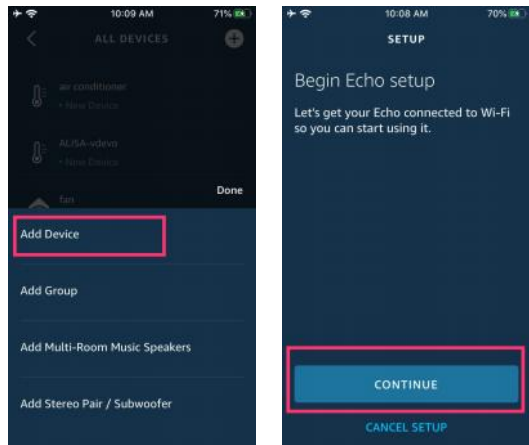

Tap "Continue" to proceed to the next step. Choose a Wi-Fi network to connect to. Amazon Echo will take a few minutes to try to connect to the network.

- After the network connection is successful, tap "Continue". An introduction video will appear. After the video ends, tap "Continue" to jump to the Alexa Home page. You have now completed the Amazon Echo's configuration process.

### 3. Key step — Link Skill

- Tap on "Skills" in the Alexa App menu.

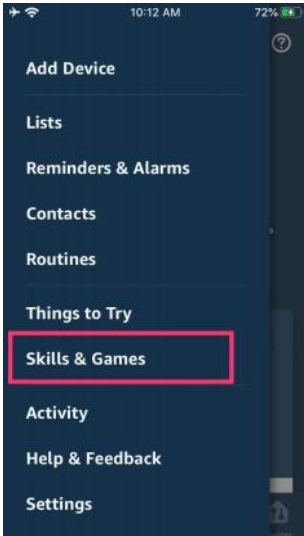

- Then search for "MOES". Tap "Enable" to enable the Skill.
- Enter the App account and password, then tap "Link Now" to link your App account to enable the Skill. Now you can start your smart home journey.

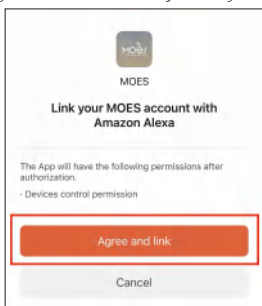

### 4. Common commands

Control the device via voice commands, now you can control your smart device with Echo. You can control your device (such as your bedroom light) with the following commands:

Alexa, turn on/off bedroom light. (Turn on/off the light)  
Alexa, set bedroom light to 50 percent. (Set the light to any brightness)  
Alexa, brighten/dim bedroom light. (Increase/weaken the brightness of the light)  
Alexa, set bedroom light to green. (Adjust the color of the light)

## SERVICE

Thank you for your trust and support to our products, we will provide you with a two-year worry-free after-sales service (freight is not included), please do not alter this warranty service card, to safeguard your legitimate rights and interests. If you need service or have any questions, please consult the distributor or contact us.

Product quality problems occur within 24 months from the date of receipt, please prepare the product and the packaging, applying for after-sales maintenance in the site or store where you purchase. If the product is damaged due to personal reasons, a certain amount of maintenance fee shall be charged for repair.

We have the right to refuse to provide warranty service if:

- Products with damaged appearance, missing LOGO or beyond the service term
- Products that are disassembled, injured, privately repaired, modified or have missing parts
- The circuit is burned or the data cable or power interface is damaged
- Products damaged by foreign matter intrusion (including but not limited to various forms of fluid, sand, dust, soot, etc.)

## RECYCLING INFORMATION

All products marked with the symbol for separate collection of waste electrical and electronic equipment (WEEE Directive 2012/19 / EU) must be disposed of separately from unsorted municipal waste. To protect your health and the environment, this equipment must be disposed of at designated collection points for electrical and electronic equipment designated by the government or local authorities. Correct disposal and recycling will help prevent potential negative consequences for the environment and human health. To find out where these collection points are and how they work, contact the installer or your local authority.

## WARRANTY CARD

### Product Information

Product Name \_\_\_\_\_  
Product Type \_\_\_\_\_  
Purchase date \_\_\_\_\_  
Warranty Period \_\_\_\_\_  
Dealer Information \_\_\_\_\_  
Customer's Name \_\_\_\_\_  
Customer Phone \_\_\_\_\_  
Customer Address \_\_\_\_\_

### Maintenance Records

Failure date	Cause Of Issue	Fault Content	Principal

Thank you for your support and purchase at we MoesGo, we are always here for your complete satisfaction, just feel free to share your great shopping experience with us.



If you have any other need, please do not hesitate to contact us first, we will try to meet your demand.

AMZLAB GmbH  
Laubenhof 23, 45326 Essen  
Made In China

EVATOST CONSULTING LTD  
Address: Suite 11, First Floor, Moy Road Business Centre, Taffs Well, Cardiff, Wales, CF15 7QR  
Tel: +44-292-188045  
Email: contact@evatmaster.com

Manufacturer:  
YUEQING NOVA ELECTRONICS CO., LTD  
Address: 3th Floor, Building 2, Power Science and Technology Innovation Center, NO. 238, Wei 11 Road, Yueqing Economic Development Zone, Wenzhou, Zhejiang, China  
Tel: +86-577-62625592  
After-sale Service: service@moesgo.com