

# Hauswirt Stand Mixer User Manual

Model: M5



Search: Hauswirt Kitchen

**facebook**

facebook.com/hauswirtkitchen

---

**Foshan Haishi Intelligent Electric Appliances Co., Ltd**

E-mail : service@hauswirus.com

No. 20230516

---

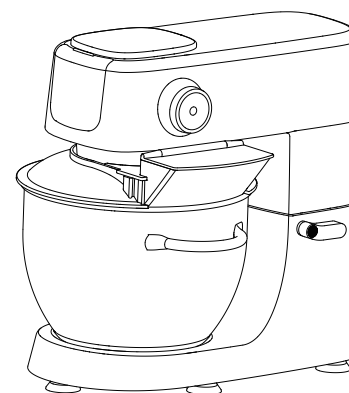

120V, 60Hz, 500W

(Product appearance depends on goods)

- Please read the user manual and the warranty card carefully before use and keep them properly.
- Parameters and appearance are subject to change without notice.
- We reserve the right to interpret the user manual.

# CATALOG

English .....	01
Français .....	23

## Table of Contents

### Important Safeguards

Prohibited, Must-do, Caution .....	2
Power Plug, Cord and Outlet .....	3
Getting Started .....	4
Using the Mixer .....	5
Proper Maintenance .....	6
When Encountering a Trouble .....	6

### How to Assemble

#### Part Names & Installation Instructions

Packing List .....	7
Part Names .....	7
Touch Control Panel .....	9
Knob Function .....	9
Assembly Instruction .....	10

### How to use the Mixer

Power on .....	11
Choosing Mixer Modes .....	12
Custom Setting Mode .....	12
Smart Menu Mode .....	13
Mixer Status on 5 Smart Menu Modes .....	14
Power off .....	14

### Overview of Optional Attachments

#### Optional Attachments (Sold Separately)

Name of Optional Attachments .....	15
Assembling .....	16

### Trouble shooting

#### Any Questions? Read the Following Tables First.

The Appliance Does Not Work .....	18
Malfunctions during Operation .....	18
Failure Codes of the LCD Display Screen .....	18

### Product Parameters

Care and Cleaning .....	19
Specifications .....	19
Standards .....	19
List of Food Contact Materials(FCMs) ..	20
Declaration of Restricted Substances ..	21

### Warranty and Services

Hauswirt Warranty Policies & Terms .....	22
--	----

## WARNING

- This appliance shall not be used by children. Keep the appliance and its cord out of reach of children.
- If the supply cord is damaged, it must be replaced by the manufacturer, its service agent or similarly qualified persons in order to avoid a hazard.
- This appliance can be used by children aged from 8 years and above and persons with reduced physical, sensory or mental capabilities or lack of experience and knowledge if they have been given supervision or instruction concerning use of the appliance in a safe way and understand the hazards involved.
- Children shall not play with the appliance.
- Cleaning and user maintenance shall not be made by children unless they are older than 8 and supervised. Keep the appliance and its cord out of reach of children less than 8 years.
- Appliances can be used by persons with reduced physical, sensory or mental capabilities or lack of experience and knowledge if they have been given supervision or instruction concerning use of the appliance in a safe way and if they understand the hazards involved.
- Switch off the appliance and disconnect from supply before changing accessories or approaching parts that move in use.
- This appliances is intended to be used in household and similar applications such as:
  - staff kitchen areas in shops, offices and others working environments;
  - farm houses;
  - by clients in hotels, motels and other residential type environments;
  - bed and breakfast type environments.

## Prohibited, Must-do, Caution

Safety precautions: Please carefully read and save these instructions for future reference. In order to prevent harm or injury to those using the appliance or to any other persons and /or property, please fully observe the following safety instructions in “DANGER”, “WARNING” and “CAUTION” categories.

Please read these instructions carefully before operating.

 **DANGER** This sign warns of highly possible death or serious injury to persons.

 **WARNING** This sign warns of possible death or serious injury to persons.

 **CAUTION** This sign warns of possible damage or injury to persons or property.



Actions prohibited



Actions causing warning and requiring your extra care



Actions you must comply with

## DANGER



Prohibited

**Do not touch parts in the mixing bowl while the mixer is running.**

Do not expose your hand, hair, cloths, etc. with functioning parts in the mixing bowl to avoid any potential damages.



Prohibited

**Do not use the meat grinder function and stirring function at the same time.**

No overload! Do not install or use more than one part at the same time..



Prohibited

**Please keep the cord away from children.**

Please keep the cord away from children, keep the cord away from children. Children must not use or stay close to the mixer.

**Children or persons with limited mental capacity are prohibited from using the mixer.**

The mixer may not be used by children, persons with mental illness, intellectual or other types of disability, or individuals unfamiliar with the mixer, unless such persons are using the mixer under the supervision of someone capable of safe operation.

## Power Plug, Cord and Outlet

### ⚠ WARNING



Must-do

#### **The voltage must be consistent with the product label.**

Please be sure to use 120V/60Hz/10A+ AC power with fuse or circuit breaker protection to avoid getting an electric shock. Never pull from the power cord.



Must-do

#### **Please use a single outlet that matches the power rating of the unit (separate outlet).**

Heat generated when plugging in multiple appliances into one outlet may result in fire.

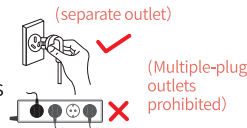

No wet hand

#### **Do not connect or disconnect the power plug with wet hands.**

This may result in an electric shock.



Grounded

#### **The cord may only be extended using power strips with grounding wire.**

Where the cord needs to be extended, please use power strips with grounding wire to avoid tripping.



Prohibited

#### **Please do not damage the power plug or cord.**

Never do anything that may damage the power plug or cord. Reduce the hazards of short circuit, electric leakage and fire resulting from bending, twisting, stretching, placing heavy objects on or bundling the cord.



Prohibited

#### **Do not use damaged or loose outlet because of the danger of shock or fire.**

In case of damaged power cord, contact the qualified repairer for replacement.

### ⚠ CAUTION



Prohibited

#### **Keep the cord or plug out of water.**

Do not clean the mixer, cord and/or plug with water or other types of liquid to avoid short circuit or electric leakage.



Remove the plug

#### **Unplug before disassembling or changing parts.**

Before such operations as disassembling, moving, repairing, and cleaning, please unplug and cut off the power.

## Getting Started

### ⚠ WARNING



Must-do

#### **Keep the mixer away from children.**

Keep the mixer away from children to avoid injuries and electric shocks.



Must-do

#### **Put the mixer in a firm, stable place.**

Please put the mixer in a firm, stable place. Otherwise, it may fall, causing personal injuries.

Do not let cord hang over edge of table or counter.

Do not use the appliance if it has fallen on the floor, if there are visible signs of damage or if it has a leak.



Disassembly is prohibited

#### **Do not remodel the mixer.**

Only qualified repairers may repair, disassemble or remodel the mixer, as inappropriate operations may result in fire hazards, electric shocks or injuries.

#### **In the event of troubles,**

Please contact Hauswirt's aftersales staff to replace or repair the mixer.

To avoid electric shocks, do not disassemble or replace the parts on your own.



Prohibited

#### **Please be sure to keep and use the mixer in a dry, indoor environment.**

Do not keep the mixer in a humid or wet environment, as doing so will lead to electric leaks or shocks due to compromised insulation.

Remove beaters from mixer before washing.



Prohibited

#### **Keep the mixer away from heat sources.**

Keep the mixer away from heat sources or sharp objects to avoid troubles arising from potential product damage.

### ⚠ CAUTION



Must-do

#### **Keep all packaging and parts of the mixer away from children.**

For safety concerns, please keep the mixer, its parts and all packaging (including the external packing, the color box packing, the PE bag, etc.) away from children.



Caution

#### **Please wear protective gloves when installing or disassembling sharp parts like blades.**

Please wear protective gloves when installing or disassembling sharp parts like the cross-shaped grinder blade to avoid injuries.

Do not use fingers to scrape food away from discharge disc while appliance is operating. Cut type injury may result.

## Using the Mixer

### WARNING



Prohibited

#### **Do not use the mixer for purposes other than household use.**

The mixer is for indoor use only. Please do not use it for commercial or industrial purposes to avoid potential product damages..



Caution

#### **The motor features overheating protection.**

When the motor overheats, it will automatically power off and restart once the temperature is down.



Caution

#### **Do not keep the mixer upside down.**

When the mixer is idle, please do not keep it upside down to avoid damage or injury as it may fall.

To reduce the risk of injury, never place cutter-assembly blades on base without jar properly attached.



Must-do

#### **Do not put foreign objects into the stirring container while it is running.**

To avoid any troubles, do not put foreign objects into the stirring container while the mixer is running.

Do not operate the appliance without any loading in jar.

Do not take the jar out body or take out the jar lid while it is operating.



Caution

#### **Following these instructions could prolong the service life of the mixer.**

To prolong its service life, please use the mixer strictly according to these instructions. For instance, do not let the mixer run for more than 20 minutes non-stop. Also, after the mixer is turned off, be sure to wait 15 minutes before turning it back on.

Always use food pusher. Never operate the appliance exceed the Max Capacity.



Caution

#### **Do not leave the product unattended while it is running.**

Do not leave the mixer unattended. If the mixer is to be left unattended, please turn off the switch or cut off the power supply to avoid any hazard.

## Proper Maintenance

### WARNING



Unplug first

#### **Clean the oven after removing its power plug.**

Please remove the power plug before cleaning. Do not use corrosive cleaning agents to avoid damaging or corroding the appliance and its parts. Clean all the parts of the product that will be in contact with food, as indicated in the cleaning section before use.



Caution

#### **The mixer in its entirety is not washable.**

Please do not wash the mixer in its entirety to avoid short circuit, electric leakage or electric shock.

## When Encountering a Trouble

### CAUTION



Must-do

#### **Press the “Pause” button immediately to terminate the use of the appliance.**

Press the “Pause” button immediately and remove the power plug to terminate the use of the appliance and avoid fire, shock or injury. Contact the qualified repairer for after-sales service in time.

This appliance has a polarized plug (one blade is wider than the other). To reduce the risk of electric shock, this plug will fit in a polarized outlet only one way. If the plug does not fit fully in the outlet, reverse the plug. If it still does not fit, contact a qualified electrician. Do not modify the plug in any way. The use of attachments not recommended or sold by the manufacturer may cause fire, electric shock or injury.

#### **Troubles:**

**The power cord and plug emit abnormal heat.**

**There is burnt smell or sparking.**

**The mixer makes abnormal sounds.**

**Get pinprick-like electric shock when touching the mixer.**



## Packing List

Packing List					
					
1 Mixer	1 Dough Hook	1 Wire Whisk	1 Flat Beater	1 Splash Guard	User Manual
✓	✓	✓	✓	✓	✓

Note: Upon opening the box, please check the availability of the above parts. The appearance, quantity, color and pattern of the parts of the mixer depend on goods.

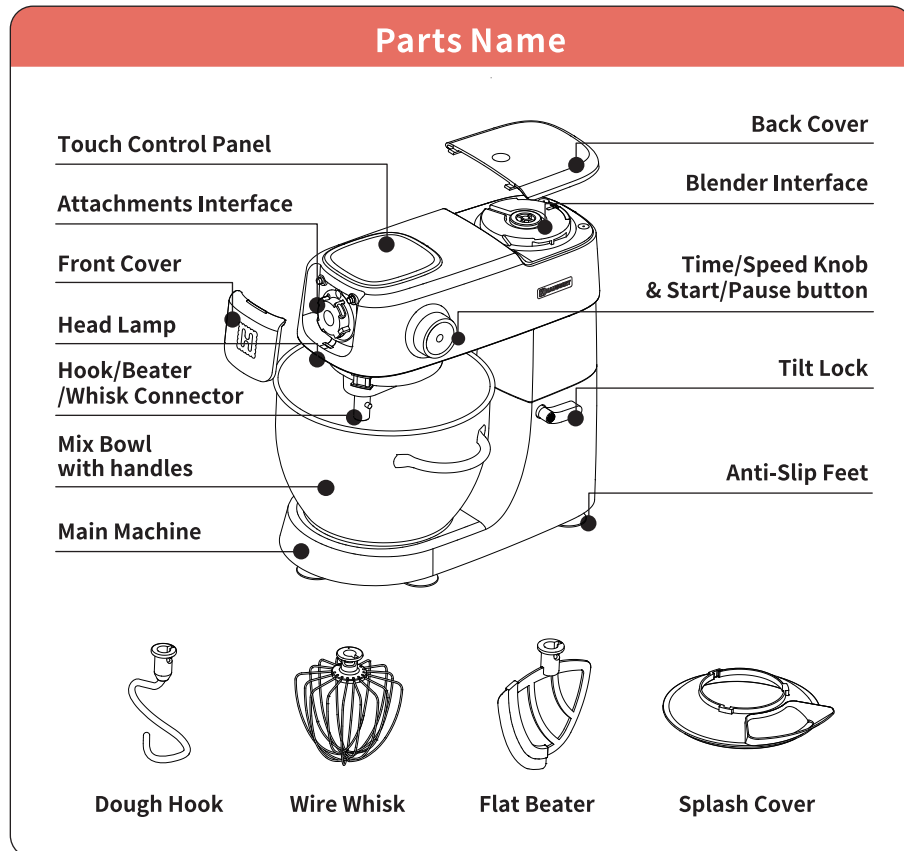
## Parts Name



Part Name	Function	Gear	Suggested Running Time	Capacity Range
 Dough Hook	For mixing and kneading bread dough	1~4	10~25 minutes	200~800 grams (flour)
 Wire Whisk	For stirring whipped cream and egg whites.	8~11	3~5 minutes	3~12 eggs 200~800 mL(cream)
 Flat Beater	Mainly for beating butter, and also used for mixing ingredients with a moderately dense texture, such as fillings.	4~7	8~13 minutes	200~800 grams (flour) 200~600 grams (butter)

Note:  
Please kindly unplug the outlet and disconnect the power for 15 minutes before use.

## Touch Control Panel

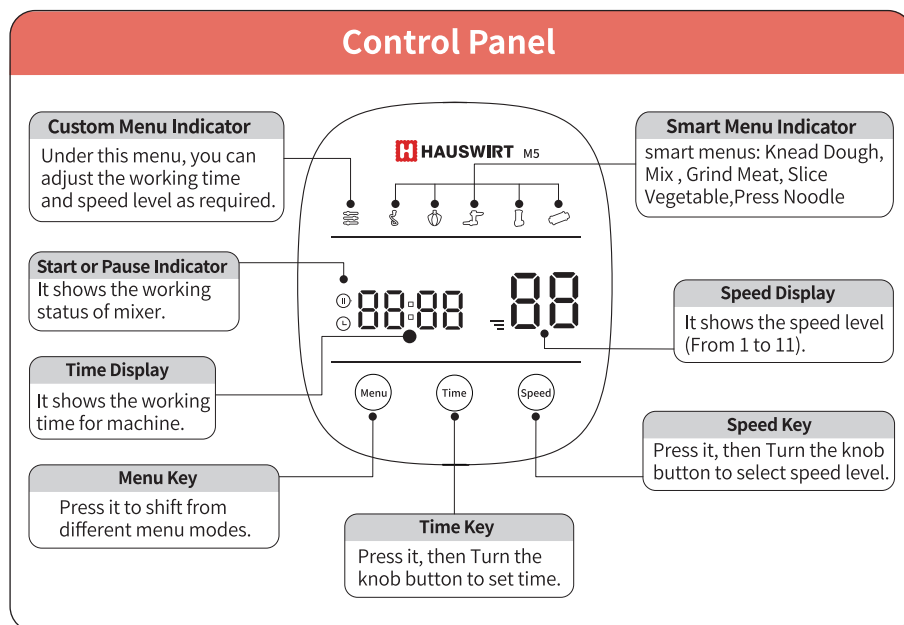

## Knob Function

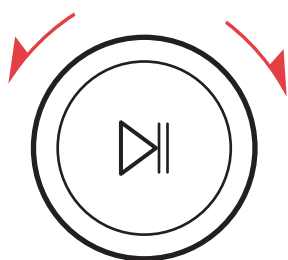

- **Time/Gear:**  
Set the Time/Gear for operation by turning the Rotary Knob.
- **Start/Pause:**  
Short Press the button for start or pause.
- **Turn the mixer ON/OFF:**  
While the mixer is on standby, press and hold the Start/Pause button for 2 seconds to turn it off; and press it once to turn it back on.
- **Exit:**  
Press the Start/Pause button once to stop the current task, then press and hold it for 2 seconds to initiate the current settings.

## Assembly Instruction

### How to Assembly

1

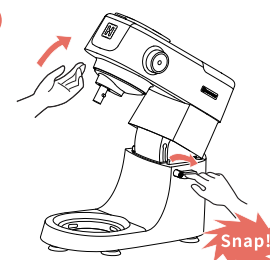

Lift the head of the mixer with your hand, and lock its position using the Tilt Lock (turned horizontal).

2

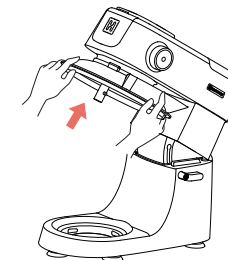

Install the splash cover to prevent the splashing of liquid or flour while the mixer is running.

3

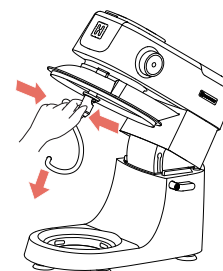

Align the stirring head with the interface, insert it on the drive shaft, and turn it counterclockwise to lock it.

4

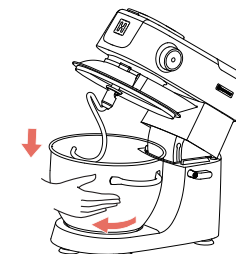

Add materials to be mixed to the mixing bowl (do not exceed the maximum carrying capacity of this product. Please refer to the table), place the mixing bowl in the designated position and turn it clockwise to lock it.

5

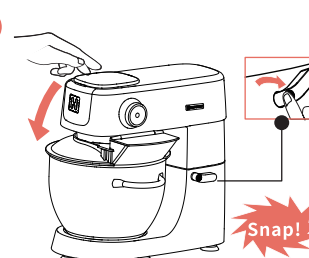

Turn the Tilt Lock clockwise and push down the head of the mixer. Its position will be locked once the head switch is turned to its original position.

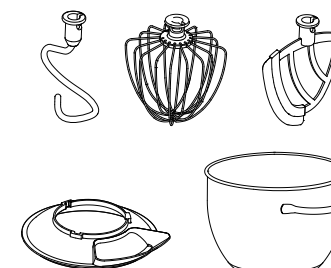

List of Standard Parts



## How to Use

### Power On

- When turning the mixer on for the first time, you will hear a long beep from the buzzer, and the display screen will light up for 1 second and remain standby.
- When the power is on, Menu, Time, and Gear buttons will remain lit.
- When the mixer is on standby and not running, the screen will be turned off if no order is given in 10 minutes, and the machine will automatically shut down if no order is given in 30 minutes. If you'd like to wake up the mixer, press the Start/Pause button.

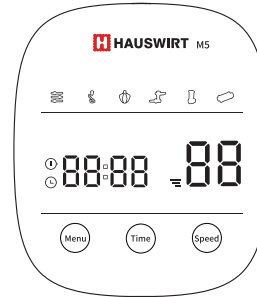

(Standby Interface)

### ! Notice

- Once the mixer is powered on, the head lamp will remain lit; if the screen is off, the Rotary Knob and the head lamp will also be off; if the screen is on, the Rotary Knob will flash, and the head lamp will remain lit.

## Choosing Mixer Modes

### Custom Setting Mode:

Under this mode, The Time/Gear can be set freely to meet a wide range of needs.

### Smart Menu Mode:

This mode features easy operation as the Gear/Time corresponding to different recipes will be set as recommended. Press the Menu button to enter to menu setting mode and switch among Dough Kneading, Whisk, Meat Grinding, slicer and pasta modes.

## Custom Setting Mode

### Gear setting (Non-designated Time)



### Gear+Time setting (Set the Time)

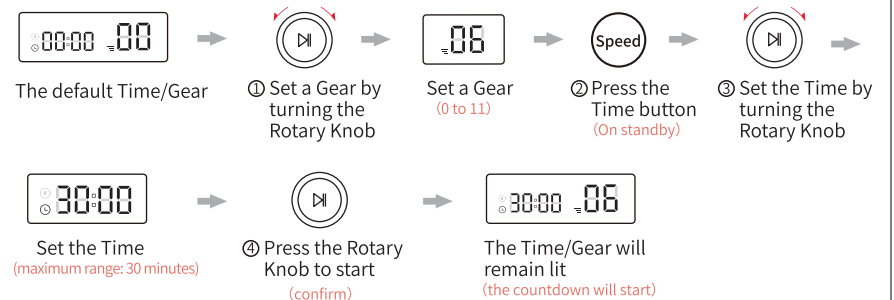

### Pause setting

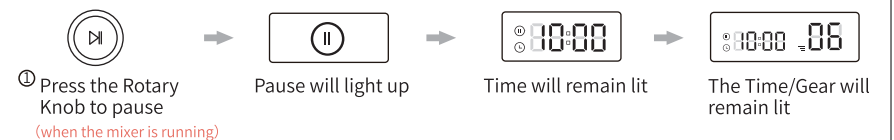



## Smart Menu Mode

### Default setting

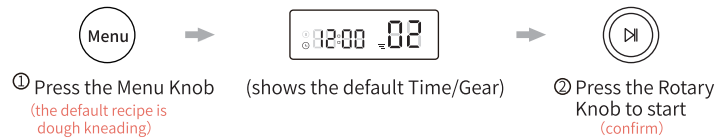

### Set the Gear (program running)

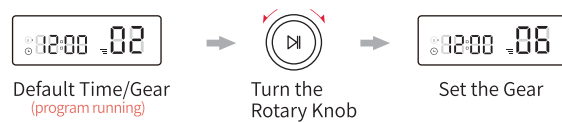

### Set the Gear (program running)

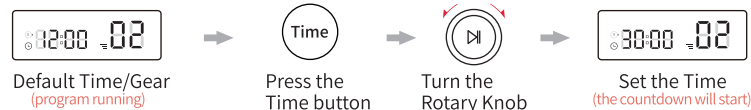

### Pause setting

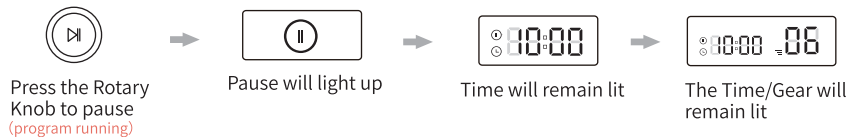

## ! Notice

- When power is on (plugged), the menu mode features a memory function, and the designated Time/Gear will remain the same.
- When adjusting the Time/Gear via the Rotary Knob, by default, the adjustment will be automatically confirmed in 3 seconds, and the Gear/Time will flash while adjusting.

## Mixer Status on 5 Smart Menu Modes

### 1 Dough Kneading Mode:

Default Time	Default Gear	Time Range	Gear Range
20min	3	1min~25min	2~4



### 2 Wire Whisk Mode:

Default Time	Default Gear	Time Range	Gear Range
3:40	11	1min~10min	9~11



### 3 Meat Grinding Mode:

Default Time	Default Gear	Time Range	Gear Range
10min	2	5min~20min	1~3



### 4 Slicer/Shredder Mode:

Default Time	Default Gear	Time Range	Gear Range
20s	11	5s~30s	9~11



### 5 Pasta Maker Mode:

Default Time	Default Gear	Time Range	Gear Range
10min	2	5min~20min	1~3



## Power off

Press the Start/Pause button to stop the operation, then press the Menu button to exit from the current menu. The machine will return to its standby mode. Press the Start/Pause button for 3 seconds to turn the screen off.

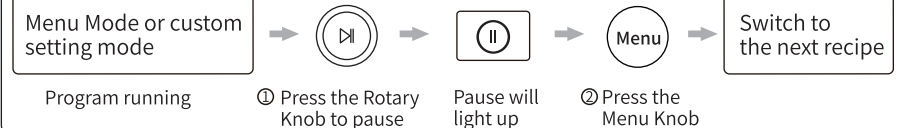

## Optional Attachments (Sold Separately)

### Name of Optional Attachments

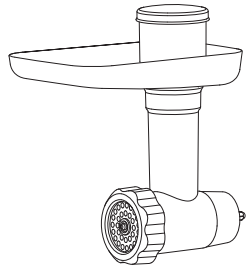

Meat Grinder

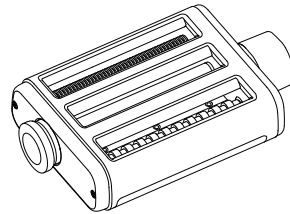

Pasta Maker

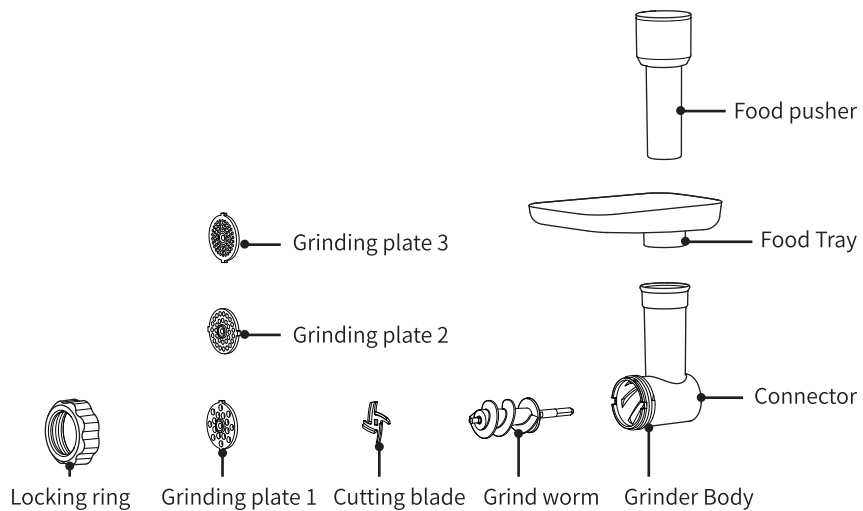

### Assembling

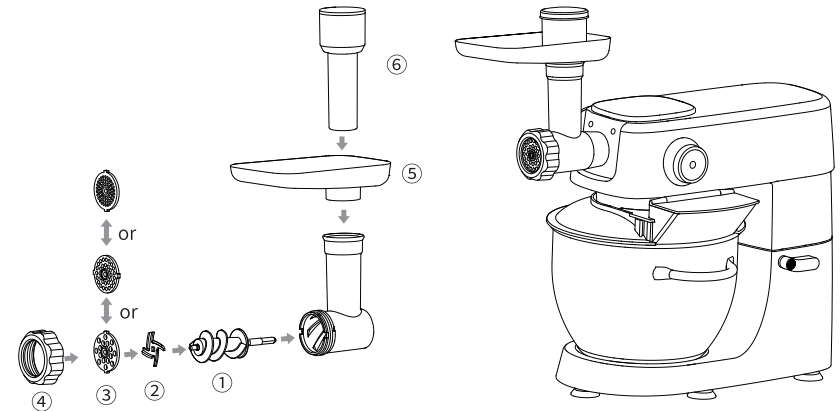

- Insert the grind worm into the grinder body.
- Install the Blade sharp side outwards
- Place the grinding plate over the blade
- Turning the locking ring until secured but not tightened
- Attach the meat grinder to the front interface of Hauswirt stand mixer

### Meat Grinding

- Power on the stand mixer and select the smart menu of Meat Grinder.
- Cut all foods into pieces (Sinewless, boneless and fatless meat is recommended, approximate size :20 mm x 20 mm x 60 mm) so that they fit easily into the hopper opening.
- Feed foods into the food tray. Use for it only the food pusher .
- After using, Press "start/pause" button to stop the appliance, then pull out the electrical plug.

## Assembling

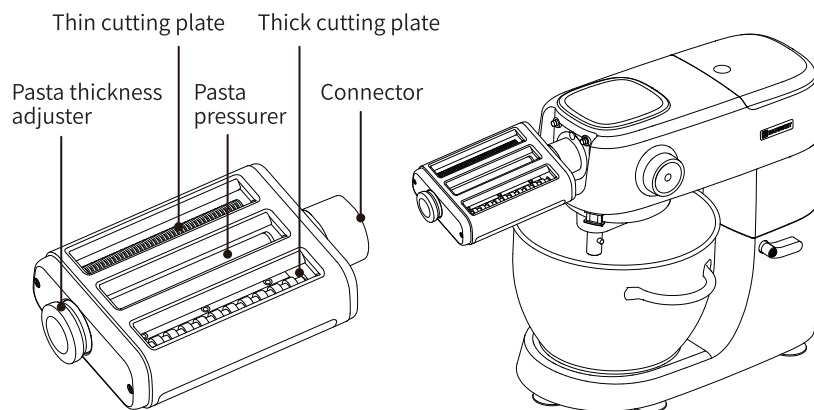

- Remove the front cover of the stand mixer, then insert the pasta maker to the interface and rotate it counterclockwise. The pasta maker is well-set when its front is aligned with the mixer.
- Power on the stand mixer, choose the smart menu of the pasta maker and set the operation speed (1-3) and time.
- Place the prepared dough in the middle of the pasta maker, then roll down it using the highest thickness setting. Repeat the process and steadily tighten the roller for your desired thickness of the dough sheet. After you get the ideal dough sheet, roll down it through the thick cutting plate to get the fettuccine or through the thin cutting plate to get spaghetti.
- After the operation, take out the pasta maker by rotating it clockwise.

Hauswirt M5 is not just a mixer but a real versatile kitchen machine! We provide a lot of optional attachments to extend its functionality. Please visit the Hauswirt Amazon Store of your country to purchase those optional attachments or send an email to [support@hauswirt.com](mailto:support@hauswirt.com) to get the purchase advices.

## Any Questions? Read the Following Tables First

### The Appliance Does Not Work

If	Possible cause	How to fix
Turn the speed control knob, click the Start button, and the machine does not run.	The power plug is not connected	Insert the plug into the right outlet.
	The outlet has no electricity.	Open the switch of the control outlet or ask a professional electrician to repair.
	Whether the head is horizontal.	Confirm that the head of the machine is back to the horizontal level.

### Malfunctions during Operation

The machine suddenly stops working during operation.	The machine runs for too long or the temperature of the surrounding operating environment is too high, causing the motor to power off to prevent overheating.	Unplug the machine, and run it after it cools down completely.
There is an abnormal sound of the machine or motor during operation.	The sound of the machine increases during high-speed operation or when the load increases.	It may be overloaded or used for too long. Please shut down the mixer.
	The lubricating oil in the machine hardens in a low temperature.	Leave the machine idling for 5 minutes to soften the lubricating oil and stabilize the speed.
The motor doesn't rotate. The motor speed drops. The motor speed is unstable.	The ingredients being stirred are too much for the motor.	Reduce the mixing amount to reduce the load. As the load (viscosity) decreases, please adjust the speed to Gear [3] or less.
The motor feels hot.	While the mixer is running, the motor area may rise in temperature as a result of the rapid increase in the working temperature of the motor, which is a normal condition.	

### Failure Codes of the LCD Display Screen

Display screen E1. (the screen flashes, and the buzzer beeps 3 times)	Check whether the upper cover/ingredient cup/mixer head is properly installed.	If the parts are not properly installed, please disconnect all loads at once. The mixer can only start running normally once the trouble is eliminated.
Display screen E2. (the screen flashes, and the motor stops running)	One possible cause is the failure to detect Hall signal while the mixer is running.	To remove the failure code, the mixer should be shut down/power off and restarted.

### NOTE:

If the above analysis of the common troubles and solutions are insufficient, please contact the aftersales staff for repairs, and do not disassemble or repair the mixer on your own. please contact [support@hauswirt.com](mailto:support@hauswirt.com) for further help.

## Care and Cleaning

- Clean after powering off and removing the power plug.
- Do not put the mixer in water or other types of liquid. Be sure to only use a soft, dry cloth or a moderately wet cloth to wipe the mixer.
- Whenever the mixer is used, please disassemble and clean the part right afterward.
- If the part is stained by foods such as carrots and oranges, remember to use a cloth dampened with cooking oil to wipe it gently, and have it cleaned to remove the stain.
- Suggested method for repair: Once the parts are fully dried, apply a small amount of cooking oil onto their surface for protection.

### Warning



Must unplug

#### Please remove the power plug before cleaning.

Do not use corrosive cleaning agents to avoid damaging or corroding the appliance and its parts.



Caution

#### Dishwasher Suggestions

The Dough Hook, Flat beater and Mixing Bowl are all dishwasher-safe. The Wire Whisk is not suggested to clean in a dishwasher.

## Specifications

Categories	Stand Mixer
Model	M5
Rated voltage	120V
Rated frequency	60Hz
Rated power	500W
Volume	5L
Net weight/Gross weight	7.28kg/8.66kg

Note: All dimensions are calculated in approximate numbers, and specifications are subject to change without notice.

## Standards

- GB 4706.1-2005 Household and Similar Electrical Appliances - Safety - Part 1: General Requirements
- GB4706.30-2008 Household and Similar Electrical Appliances - Safety - Particular Requirements for Kitchen Machines

## Food Grade Material & Parts

### Declaration of Compliance

Product name: (refer to the attached user manual for more details)

#### Declarant: This product family

Declarant: The following parts in this product family expected to contact food comply with the requirements of the Food Safety Law and GB 4806.1-2016, as well as the relevant provisions on food contact materials and products. Substances subject to limit requirement comply with the requirement and total migration volume.

Part names	Materials	Standards
Metal parts (e.g. knife cylinder, cutter shaft, stainless steel bowl, egg beater port, egg beater wire, stirring hook, stirring paddle, blade, etc.)	SUS304, SUS420, ADC3, etc.	GB 4806.9-2016
Plastic parts (e.g. rubber cover lining of the tomato juicer drum, screw connector, cover, lid of the measuring cup, cutter shaft knife block, battering rod, ingredient drum, funnel or its lid, shaper, etc.)	PP, ABS, AS, POM, LDPE, PA	GB 4806.7-2016
Rubber parts (e.g. cutter shaft seal ring, small seal ring, screw seal ring, edge cover of the stirring paddle, etc.)	Silicone rubber	GB 4806.11-2016
Stirring cup	Glass	GB 4806.5-2016

Note: The above table contains all the parts of such products produced by Hauswirt, and the specific parts of the product depends on its actual configuration.

If you have any questions, please contact Hauswirt's customer service via the telephone number provided herein.

Use conditions: (refer to the attached user manual for more details)

Disclaimer: The product should be used as per the requirements of the attached user manual; otherwise the user shall bear the legal responsibility for food contamination and personal damage arising from its incorrect use.

## Declaration of Restricted Substances

- The table is a declaration concerning the content of hazardous substances contained in this product that are subject to the limit requirements stated in SJ/T 11364 Marking for The Restriction of the Use of Hazardous Substances in Electrical and Electronic Products and GB/T 26572 Requirements on Concentration Limits for Certain Restricted Substances in Electrical and Electronic Products.



- The mark applies to electronic products sold in the People's Republic of China. The number in the center indicates the environment-friendly use period (EFUP).

Part names	Name and content of hazardous substances contained in the product					
	(Pb)	(Hg)	(Cd)	(Cr(VI))	(PBB)	(PB DE)
Plastic parts	X	O	O	O	/	/

### Note:

- The table is made according to the provisions of SJ/T 11364-2014.
- O: Indicates that said hazardous substance contained in all of the homogeneous materials for this part is below the limit requirement of GB/T 26572.
- X: Indicates that said hazardous substance contained in at least one of the homogeneous materials used for this part is above the limit requirement of GB/T 26572.



### Correct Disposal of this product

This marking indicates that this product should not be disposed with other household wastes throughout the EU. To prevent possible harm to the environment or human health from uncontrolled waste disposal, recycle it responsibly to promote the sustainable reuse of material resources. To return your used device, please use the return and collection systems or contact the retailer where the product was purchased. They can take this product for environmental safe recycling.



### Hauswirt Warranty Policies & Terms

Thanks for choosing Hauswirt and start to **INSPIRE YOUR KITCHEN** with our innovative kitchen appliances! Hauswirt promises to provide the highest quality of products as well as services. All products are eligible for a minimum 1 year warranty, starting from the date of purchase.

For customer who purchases Hauswirt products on Amazon.com or other online channels, the limited warranty is able to be **extended an extra 180 days** if products are registered on Hauswirt official page. You'll need:

- Register products within 60 days after purchase
- An order confirmation

Under the limited warranty, Hauswirt will repair, replace, or refund any parts found to be defective due to manufacturer flaws. This warranty extends only to personal use and does not extend to any product that has been used for commercial use, rental use, or any other use in which the product is not intended for.

Other situations which are **Not Covered** by the limited warranty Policy:

- Products without sufficient proof of purchase
- Purchases from unauthorized resellers.
- Improperly operated devices.
- Lost or stolen products.
- Damage from misuse of products (including, but not limited to: falls, extreme temperatures, water, using devices improperly)
- Purchases made outside of the stipulated warranty period.
- Non-quality-related issues (after 30 days of purchase).
- Free products.
- Improper maintenance.
- Improper installation.
- Aftermarket modification.

Should you have any questions on how to use products or to register an extra 180 days warranty, please write to [support@hauswirt.com](mailto:support@hauswirt.com), we will get back to you within 24 hours and provide all details!

## Interdit, Obligatoire, Attention

Précautions de sécurité : Veuillez lire attentivement et conserver ces instructions pour vous y référer ultérieurement. Pour empêcher de se blesser ou de blesser d'autres personnes utilisant l'appareil, veuillez respecter intégralement les consignes de sécurité suivantes des catégories "DANGER", "AVERTISSEMENT" et "ATTENTION".

Lorsque vous utilisez des appareils électroniques, les consignes de sécurité élémentaires doivent toujours être prises, notamment les suivantes :

- 1) Lire toutes les instructions.
- 2) Pour éviter tout risque d'électrocution, ne mettez pas le corps principal et la fiche dans l'eau ou tout autre liquide.
- 3) Cet appareil n'est pas destiné à être utilisé par des personnes (incluant des enfants) dont les capacités physiques, sensorielles ou mentales sont réduites, ou des personnes dénuées d'expérience ou de connaissance, sauf qu'elles ne soient étroitement surveillées et qu'elles reçoivent des instructions concernant l'utilisation de l'appareil par une personne responsable de leur sécurité. Lorsqu'un appareil est utilisé en présence d'enfants ou par des enfants, une surveillance étroite doit être exercée. Les jeunes enfants doivent être surveillés afin de s'assurer qu'ils ne jouent pas avec l'appareil.
- 4) Mettez l'appareil HORS tension, et débranchez-le du secteur lorsqu'il n'est pas utilisé, avant de monter ou de démonter des pièces et avant de le nettoyer. Pour débrancher l'appareil, saisissez la fiche et tirez. Ne tirez la fiche par le cordon.
- 5) Gardez les mains, les cheveux, les vêtements, ainsi que les spatules et autres ustensiles à l'écart des batteurs pendant le fonctionnement afin de réduire le risque de blessure. Ne mettez jamais les aliments dans l'entonnoir avec les mains ; utilisez le poussoir.
- 6) Ne faites pas fonctionner un appareil dont le cordon ou la fiche est endommagé ou après un dysfonctionnement de l'appareil, une chute ou un dommage quelconque. Contactez le fabricant au numéro de téléphone du service à la clientèle 400-800-0387 pour obtenir des renseignements sur l'examen, la réparation ou le réglage.  
**Mail : support@hauswirt.com**
- 7) L'utilisation d'accessoires non recommandés ou vendus par le fabricant peut provoquer un incendie, un choc électrique ou des blessures.
- 8) Il ne faut pas l'utiliser à l'extérieur. Pour un usage de référence dans la maisonnée.
- 9) Ne pas laisser le cordon pendre sur le bord d'une table ou d'un comptoir.
- 10) Ne pas laisser le cordon entrer en contact avec des surfaces très chaudes, y compris les cuisinières.
- 11) Nettoyez toutes les parties du produit qui seront en contact avec les aliments, comme indiqué dans la section de nettoyage avant l'utilisation.
- 12) Il faudrait porter une attention particulière à la manipulation, pendant les opérations de montage et de démontage ou lors de la vidange du bocal et du nettoyage.
- 13) Avant de brancher l'appareil, vérifiez que les caractéristiques électriques (tension et

fréquence) indiquées sur la plaque signalétique correspondent à celles du réseau électrique de votre résidence ; ne le branchez pas avec les mains mouillées.

- 14) N'utilisez pas l'appareil s'il est tombé ou qu'il présente des signes visibles d'endommagement ou qu'il y a une fuite.
- 15) Ne pas sortir le corps du bocal ou retirer le couvercle du bocal pendant le fonctionnement de l'appareil.
- 16) Gardez les mains et les ustensiles hors du récipient afin de réduire le risque de blessures aux personnes ou de dommages au mélangeur.
- 17) Ne jamais ajouter de produit dans le récipient pendant l'opération.
- 18) Le récipient doit être convenablement mis en place avant de faire fonctionner l'appareil.
- 19) Il faut jamais ajouter les aliments à la main. Utiliser uniquement un poussoir à aliments.
- 20) N'essayez pas d'enlever les aliments du couteau avec les doigts pendant que l'appareil fonctionne. Vous risqueriez de vous blesser en vous coupant.
- 21) Pour réduire le risque de blessure, ne placez jamais les lames de l'ensemble de coupe sur la base sans que le bocal soit correctement fixé.
- 22) Ne faites jamais fonctionner l'appareil au-delà de sa capacité maximale.
- 23) N'utilisez pas l'appareil si le bocal n'est pas chargé.
- 24) Retirez les fouets du batteur avant de les laver.
- 25) CONSERVER CES INSTRUCTIONS

Cet appareil est muni d'une fiche polarisée (une lame est plus large que l'autre). Afin de limiter tout risque de décharge électrique, cette prise ne peut s'enficher que dans un sens seulement. Si la fiche ne s'insère pas entièrement dans la prise, inversez-la. Si vous ne pouvez toujours pas l'insérer, faites installer une prise polarisée par un électricien qualifié. Ne modifiez pas la fiche d'aucune façon.

La tension doit être conforme à l'étiquette du produit.

Veillez à utiliser un courant alternatif de 120 V CA/ 60 Hz/ 10 A+ avec un fusible ou un disjoncteur pour éviter les chocs électriques.