

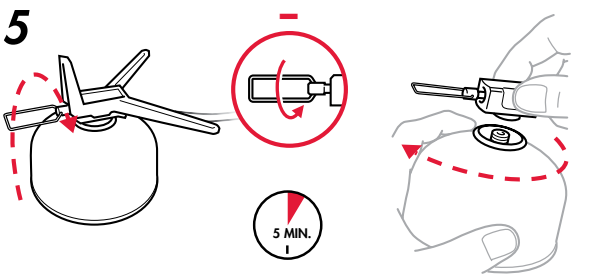

# INSTRUCTION MANUAL

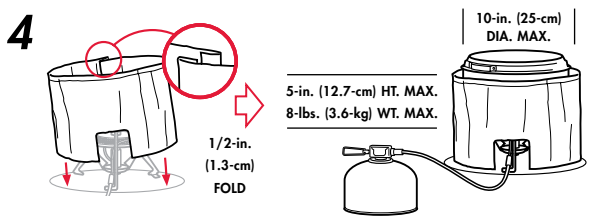
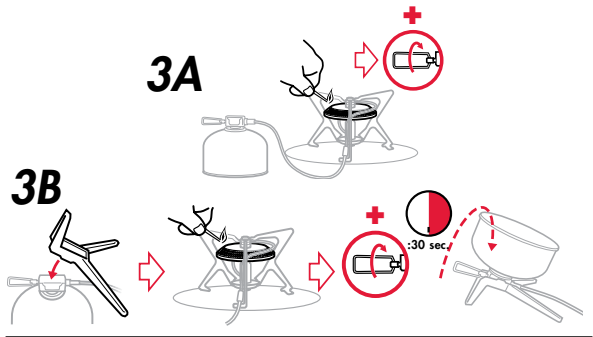
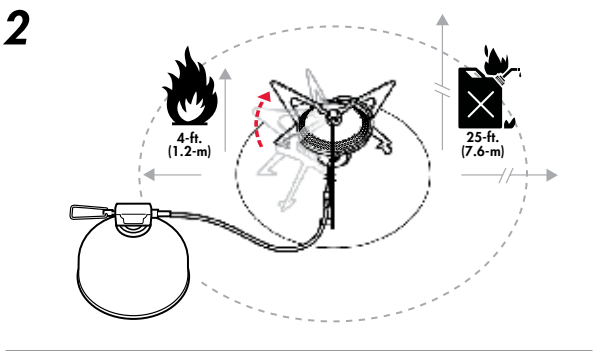
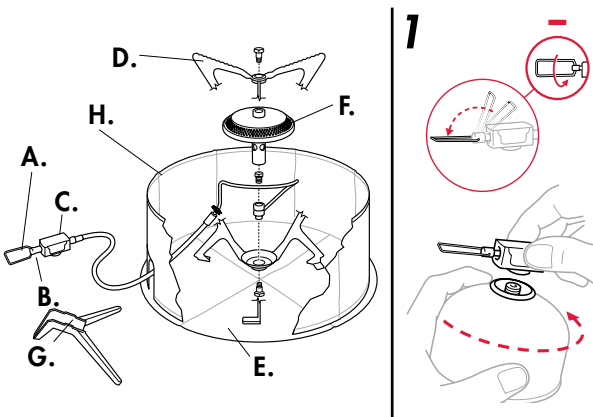

## WINDPRO™ II STOVE

Retain these instructions for future reference.



 <b>Nominal Heat Input Rate:</b> 7,450 BTU/h 10,000 BTU/h (liquid feed mode)	 2009/142/EC (51802370-2011) CATEGORY: VAPOR PRESSURE BUTANE PROPANE  <b>Nominal Heat Input Rate:</b> 3.2 kW 230 g/h
--	---

Stove Orifice Size: 0.34 mm

NOTE: Nominal Heat Input Rate varies depending on test procedures of the particular standards agency.

### DANGER



### FOR OUTDOOR USE ONLY CARBON MONOXIDE HAZARD

This stove can produce carbon monoxide, which has no odor.

Using it in an enclosed space can kill you.

Never use this stove in an enclosed space such as a camper, tent, vestibule, car, or home.

### FIRE OR EXPLOSION HAZARD

If you smell gas:

1. Do not attempt to light appliance.
2. Extinguish any open flame.
3. Disconnect from fuel supply.
4. Evacuate immediately.
5. Allow gas to dissipate 5 minutes before relighting the appliance.

Failure to follow these instructions could result in fire or explosion, which could cause property damage, personal injury or death.

### FOR YOUR SAFETY

Do not store or use gasoline or other flammable vapors and liquids in the vicinity of this or any other appliance.



### CARBON MONOXIDE, FIRE, EXPLOSION HAZARD

There are serious hazards associated with using this stove and fuel. Accidental fire, explosion, and misuse can cause death, serious burns, and property damage. You are responsible for your own safety and the safety of those in your group. Please use good judgment and read these instructions for use carefully. Familiarize yourself with the stove before connecting it to its gas canister. Keep these instructions for future reference.

This stove is a lightweight, compact device made for OUTDOOR USE ONLY to boil water or cook food. Never use it for any other purpose. Cooking outdoors is more hazardous than cooking as you normally would at home. Please consult with your local outdoor retailer to learn more about cooking outdoors. Seek qualified instruction before you venture outdoors.

This stove uses a liquid pressurized gas (LPG) canister that is highly flammable and explosive. This stove shall only be used with an 80% isobutane / 20% propane gas cartridge certified to EN 417. It may be hazardous to attempt to fit other types of gas canisters. Follow this safety information:

- Check that the seals between the stove and the gas canister are in place and in good condition before connecting the stove to the cylinder. Do not use this stove if it has damaged or worn seals.
- Listen and smell for leaking gas. Leaking gas is a serious hazard. LPG is invisible and odorless, and strong odorant additives can fade over time. Leaks are not always detectable by smell. Do not use this stove if it is leaking, damaged, or does not operate properly.
- Check that the stove and fuel canister connection is secure and tight. If the connection does not look or feel secure, or if you hear or smell leaking gas and cannot stop the flow of gas, do not use stove or fuel canister. Move it to a well-ventilated area away from any ignition source to locate and stop the leak.
- Check for leaks using soapy water. Do not try to detect leaks using a flame.
- Never use fuel canisters larger than 8 ounces (227 grams) or more than 4 inches (10 centimeters) in height, because oversized canisters decrease stove stability.
- Keep stove and fuel canister away from other heat sources. If you expose the fuel canister to high heat, it will explode or leak and you can be killed or seriously burned.
- Follow all warnings on fuel canister regarding use and storage.
- Do not store or use gasoline or other liquids with flammable vapors in the vicinity of this or any other stove.
- Do not disassemble stove beyond what is described in these instructions. DO NOT MODIFY THIS STOVE. Disassembly or modification of stove in any manner not consistent with these instructions voids warranty and can result in an unsafe situation where fire, burns, severe injury or death can occur.
- Do not use stove if parts are missing or broken, or with replacement parts not specific to your stove model. Use of stove with missing or broken parts, or with replacement parts not specific to your stove model, can result in an unsafe situation where fire, burns, severe injury or death can occur.

Cascade Designs, Inc. warrants the use of appropriately-sized MSR® brand cookware only—use of cookware other than MSR® brand cookware is at user's own risk and discretion.

## WINDPRO™ II STOVE INSTRUCTIONS

 **DANGER** Do not use this stove: (1) before reading and fully understanding this Instruction Manual; (2) if you are not prepared or comfortable attending to a burning and/or hot stove at all times; (3) if you observe leaking fuel; or (4) if you observe any condition with the stove system or in the surrounding environment that would make operation of an open flamed device dangerous. Failure to follow these directions can cause an unsafe situation leading to fire, burns, severe injury or death.

### STOVE PARTS

A. Flame Adjuster	D. Pot Supports	G. Canister Stand
B. Flame Adjuster Valve	E. Heat Reflector	H. Windscreen
C. Valve Body	F. Burner Head	

1. CONNECT STOVE AND CANISTER 1. Unfold Flame Adjuster.
2. Close Flame Adjuster Valve. 3. Finger-tighten canister onto stove Valve Body until connection is secure.

 **DANGER** Never overtighten fuel canister to stove. Overtightening can damage stove or canister and cause fuel to leak. Leaking fuel can cause fire, burns, severe injury or death. The canister must be constructed and marked in accordance with the EN 417.

Use extreme caution when using stove in temperatures below freezing. In freezing temperatures O-rings can stiffen and leak fuel. Always check for fuel leaks before and after lighting stove. Use of a leaking stove can cause fire, burns, severe injury or death.

Keep children far away from stove and fuel—Cascade Designs, Inc. recommends no less than 10 feet (3+ meters). Never leave a burning or hot stove unattended. An unattended stove can lead to fire and/or a situation where children, pets, or the unwary can be burned, injured, or killed.

2. SET UP STOVE 1. Clear cooking area of combustible materials and flammable liquids or vapors. 2. Rotate Pot Supports/Legs fully open. 3. Place stove assembly on a solid, stable, even surface to ensure stability. 4. Place stove on the center of Heat Reflector.

 **DANGER** This stove is designed for the outside (i.e., not within enclosed spaces of any kind; e.g. tents) for boiling of water or cooking of food only—never use it for any other purpose. Use of stove within any enclosure, or for a purpose other than boiling water or cooking food can cause fire, burns, severe injury or death.

Keep combustibles at least 4 feet (1.2 meters) away from the top and sides of a burning stove, or a stove that you are in the process of lighting. Keep flammable liquids and vapors at least 25 feet (7.6 meters) away from the top and sides of a burning stove, or a stove that you are in the process of lighting. This stove can ignite combustible materials, flammable liquids and vapors and create a situation where fire, burns, severe injury or death can result.

Keep fuel canister away from the stove burner and other heat sources. Position connected fuel canister so that it is as far away from the burner as possible. Use of canister near burner or other heat sources can result in the canister exploding and causing fire, burns, severe injury or death.

Never attempt to light stove if Flame Adjuster Valve is left open. If Flame Adjuster Valve is left open, close it immediately and thoroughly ventilate area before lighting stove. Failure to ventilate area can result in an explosion that can cause fire, burns, severe injury or death.

3. TURN STOVE ON IMPORTANT: Always start stove with fuel canister in upright position to prevent a large flare-up. A proper flame will appear blue.  
A. VAPOR FEED MODE (most conditions, best simmering) 1. Hold a lit match or lighter over the edge of Burner Head. 2. Open Flame Adjuster Valve (3/4 turn) to release and ignite fuel. 3. Turn Flame Adjuster Valve to produce and maintain steady flame. B. LIQUID FEED MODE (very cold conditions or higher output/faster boiling) 1. Attach Canister Stand onto top of Valve Body. 2. Hold a lit match or lighter over the edge of Burner Head. 3. Open Flame Adjuster Valve (3/4 turn) to release and ignite fuel. Allow fuel to burn for 30 seconds to ensure stove is properly primed. 4. Invert Fuel Canister, using Canister Stand to support it. 5. Turn Flame Adjuster Valve to produce and maintain steady flame. If stove flares after inverting canister, turn canister upright for an additional 30 seconds, then invert.

 **DANGER** Never place your head or body above the stove while lighting or cooking. Because stove maintains an open flame, placement of head or body above stove is an unsafe practice that can cause fire, burns, severe injury or death.

4. USE STOVE TO COOK 1. Set up Windscreen. Fold ends of Windscreen together. Leave a 1-inch (2.5 cm) gap between Windscreen and cookware for optimal performance. Ensure that combustion flow and ventilation air are free of any obstruction. Use Windscreen to improve performance in all conditions. 2. Add appropriate food or liquid to cookware. 3. Place cookware onto the center of the stove. 4. Turn Flame Adjuster Valve to adjust heat.

 **DANGER** Never move a burning or hot stove. Always extinguish stove and cool for at least 5 minutes before moving. Moving a burning or hot stove can cause fire, burns, severe injury or death. Never use cookware with a diameter greater than 10 inches (25 centimeters). Never place and operate two or more stoves together. Never operate stove with empty or dry cookware. Never use a non-MSR® reflector or diffuser. Use of stove in any of the preceding manners can result in the fuel canister exploding and causing fire, burns, severe injury or death. Never use cookware of any size that is ill-suited or inappropriate for use with stove or stove pot supports (e.g., cookware with a convex or concave bottom, some enameled cookware, etc.). Use of stove with ill-suited and/or inappropriate cookware can result in cookware and/or stove instability and a situation where hot cookware and/or cookware contents can spill and cause fire, burns, severe injury or death.

5. TURN STOVE OFF 1. Place the fuel canister in an upright position if inverted. 2. Close Flame Adjuster Valve when cooking is done. Residual fuel will continue to burn with a small flame. 3. After flames are out, wait 5 minutes for stove to cool. Remove Canister Stand if attached. Fold Flame Adjuster. 4. Ensure that flames are extinguished. Fold Pot Supports. 5. Move stove assembly away from any ignition sources and unscrew canister. A small amount of gas may escape when unscrewing canister. NOTE: If canister is completely empty of fuel, follow proper disposal requirements in your local area.

 **DANGER** Always disconnect stove from canister before storing it. Failure to disconnect stove from canister before storing may cause fuel to leak and cause fire, burns, severe injury or death. Always store fuel canisters in a well-ventilated location away from any possible heat or ignition source, such as water heaters, stoves, pilot lights, or furnaces, or where temperatures exceed 120 F (49 C). Storing fuel canisters near any heat or ignition source or where temperatures exceed 120 F (49 C) can result in the canister exploding and causing fire, burns, severe injury or death.



MOUNTAIN SAFETY RESEARCH®

©2018 Cascade Designs, Inc.

4000 First Avenue South | Seattle, WA 98134 USA  
Cascade Designs, Inc., USA - 1-800-531-9531 or 206-505-9500  
Cascade Designs, Ltd., Ireland - (+353) 21-4621400  
www.msrgear.com | info@cascaadedesigns.com

Limited Warranty details at [msrgear.com/warranty](https://www.msrgear.com/warranty)

For Troubleshooting Solutions, visit: [www.msrgear.com/windpro-ii](https://www.msrgear.com/windpro-ii)