

CTC-7 QUICK SET-UP GUIDE: KNEE

This guide is intended as a quick reference once the user manual has been read in-full

© 2023 Medi-Rent Pty Limited

Medi-Rent Pty Limited
ABN: 37 603 454 360
info@medirent.com.au

AU PH: 1300 726 666

HEAD OFFICE:
Unit 1, 61 Beauchamp Rd
Matraville NSW 2036

Unit 3, 93 Riverside Avenue
Werribee VIC 3030

Unit 3,8 Emplacement Crescent
Hamilton Hill WA 6163

NZ PH: 0800 725 555

9F Lady Ruby Drive
East Tamaki
Auckland 2013
NEW ZEALAND

www.medirent.com.au
www.medirent.co.nz

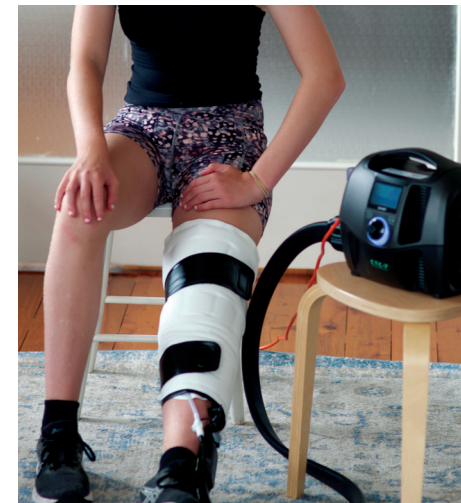

Place the device somewhere easily accessible. Leave at least 30cm clearance around the device for unrestricted air flow.

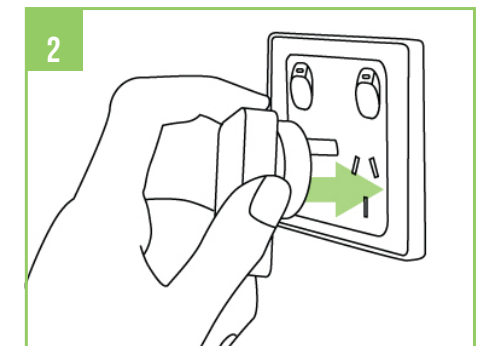

Plug your power lead in, ensuring it is not a trip hazard.

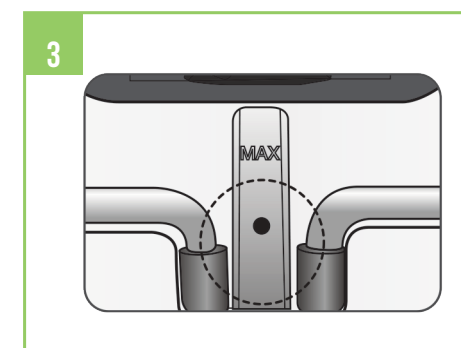

Unscrew the water tank lid and pour distilled water into the tank. Use the indicator to fill to MAX level. You will need to top the tank up once therapy begins.

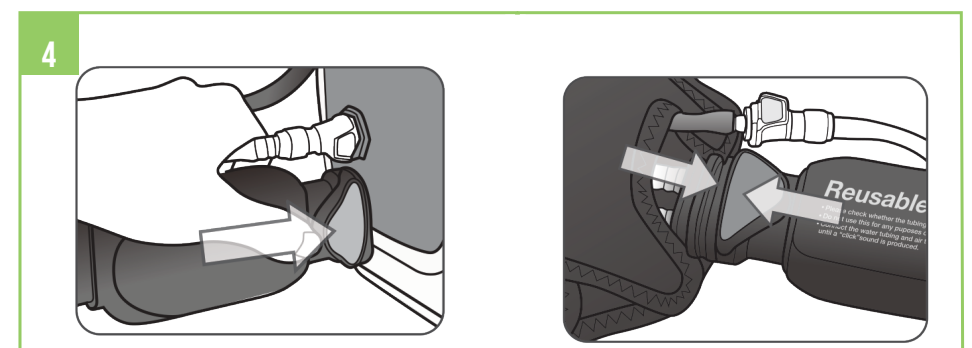

Connect air and water hosing to device and garment.

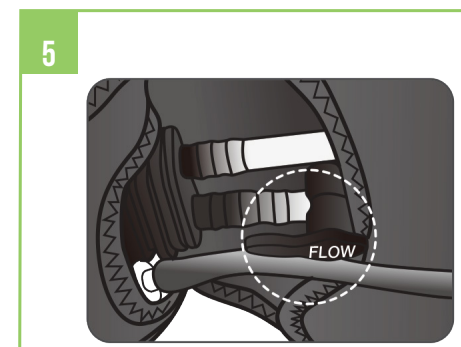

Check the garment tubing valve is open. If the valve is at 90 degrees to the tubing the water flow will be stopped.



Lay the garment flat under your knee ensuring the tubing is not kinked or twisted.

Wrap the garment around your knee. Use the adhesive strips to hold the garment in place. Additional strips can be used to increase firmness of the garment.

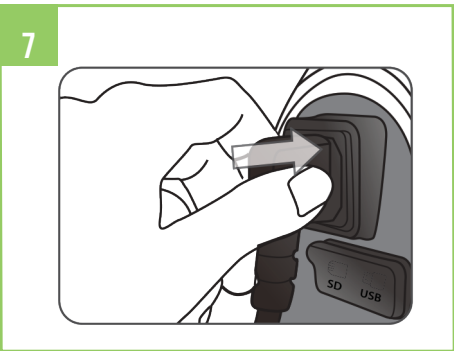

Plug the power lead in and turn the device on.

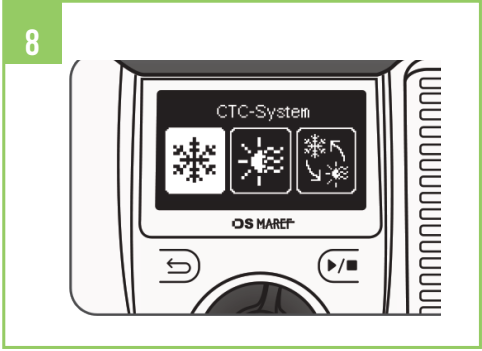

The screen will display CTC-7 modes of therapy.

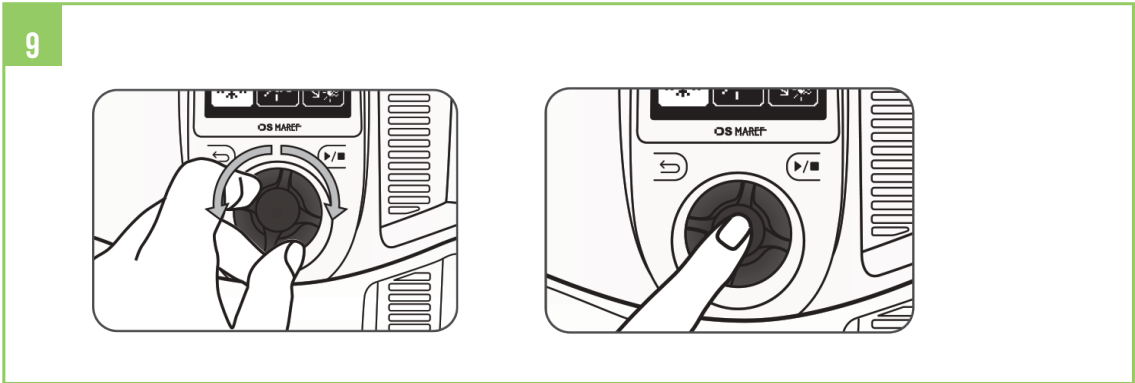

Turn the dial to highlight selection. Press the dial to select COLD therapy.

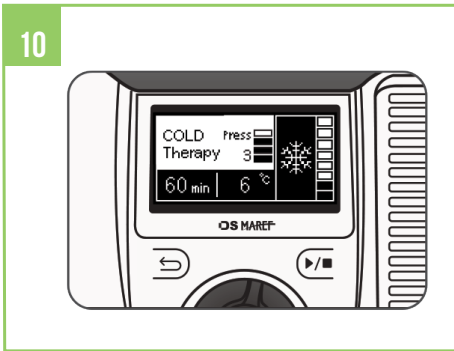

To commence treatment on standard settings, press play button (top right of the dial).

Standard settings for COLD therapy:
Time: 30min
Temperature: 6°C
Pressure: 4

CAUTION

Please seek advice from your treating health professional as to whether this device is suitable for use in consideration of your specific and full medical history.

Please refer to the owner manual for Contraindications for COLD therapy and HEAT therapy and CONTRAST therapy.



To change COLD therapy settings:

Time: Rotate the dial to highlight the time setting, press the dial. The menu will allow you to choose between Manual time and Preset time. Manual time range 5 - 60min. Preset time options Run/Rest 20/20, 20/40, 30/30, 30/60.

Press back arrow to return to settings. Press play button to start therapy.

Temperature and Compression: Select setting to adjust. Rotate the dial to adjust the value and press the dial to save the setting.

Press the back arrow to return to settings. Press play button to start therapy.



Once you have pressed the play button the garment will fill with water. You may need to top the water container up whilst the device is running.

For best performance top the tank up to Max. For a swifter cooling effect, use refrigerated distilled water.

To stop therapy press the play/stop button and turn the device off.

**** SEE BELOW FOR STORING YOUR GARMENT BETWEEN USES TO AVOID LEAKAGE****

Please refer to the user manual for how to adjust settings for heat or contrast therapy.

WARNING - WATER LEAK *Potential slip hazard or damage to personal effects*

- To avoid water leakage from unit:**
- * When your therapy session is complete please disconnect the hosing from the unit.
 - * Store the garment, bladder, and hosing in bag provided.
 - * Keep the device in an **upright position at all times** during use, transport, and when it is switched off.

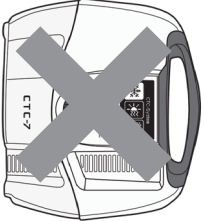
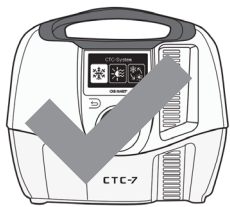
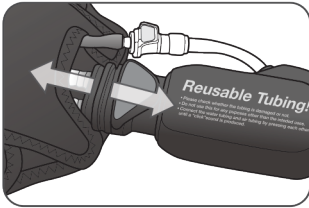

HAVE QUESTIONS?

Call us on **AU PH 1300 726 666** or **NZ PH 0800 725 555**