

# Smart Eaves String Light

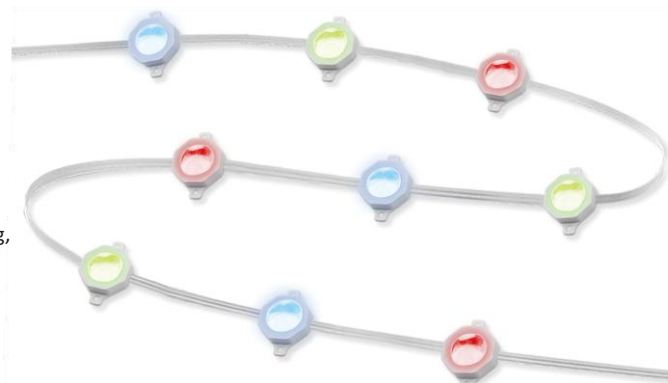

## Features

1. 16 million colors static color adjustment, brightness adjustment
2. Timer switch & countdown function
3. Built-in 6 local music rhythm modes, support built-in micro-phone and mobile phone microphone music, support speed and sensitivity adjustment in music mode
4. Built-in 15 dynamic scene modes, rainbow, flowing water, horse racing, etc.; and any DIY dynamic scene
5. Support 12-key multi-function infrared remote control



## Application



Product application: villas, buildings, home depot, scenic spots, parks, and other outdoor places.

## Product Size

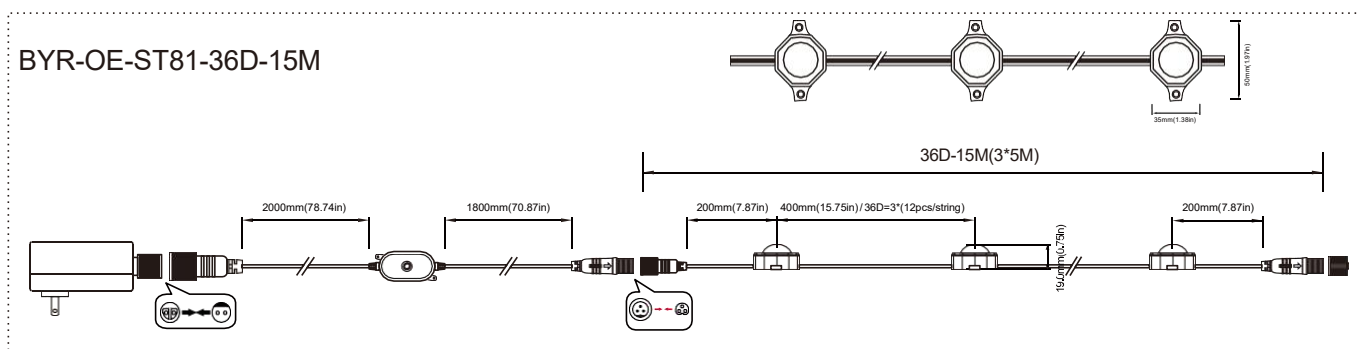

BYR-OE-ST81-72D-30M

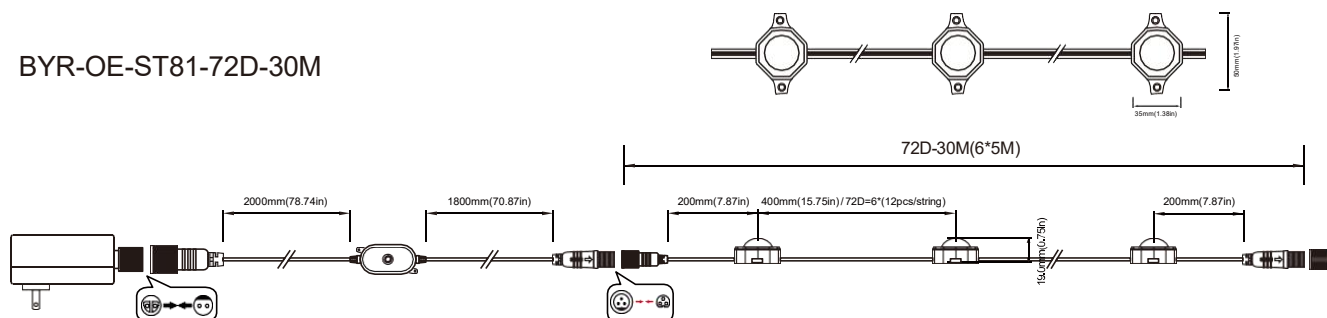

BYR-OE-ST81-108D-45M

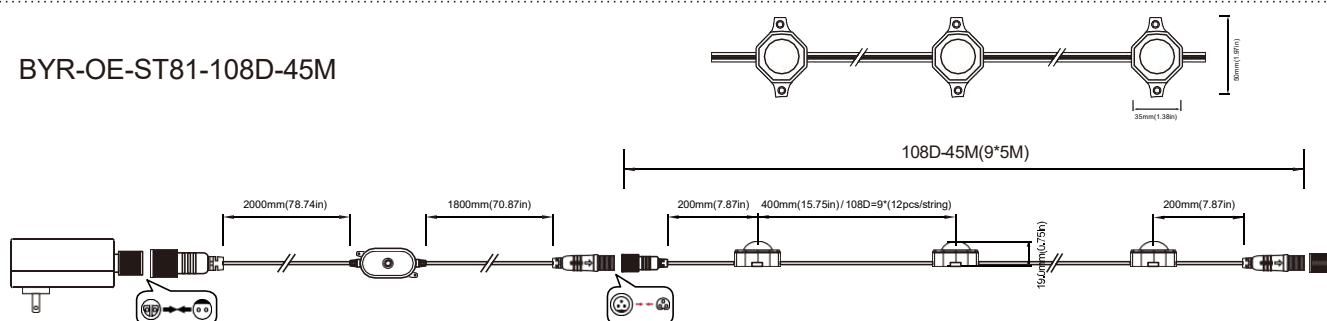

## Technical Details

Model	BYR-OE-ST81-36D-15M	BYR-OE-ST81-72D-30M	BYR-OE-ST81-108D-45M
Power	Power/pc: 0.6W Power/string(12pcs): 7.5W Power/set(36pcs): 21W	Power/pc: 0.6W Power/string(12pcs): 7.5W Power/set(72pcs): 32W	Power/pc: 0.6W Power/string(12pcs): 7.5W Power/set(108pcs): 46W
Power supply	24W / DC24V 1A	36W / DC24V 1.5A	60W / DC24V 2.5A
Input Voltage	DC220-240V & AC120V		
Output Voltage	DC24V		
Led type	5054+2835		
Led Qty	Single quantity: 1pc 5054RGB +3pcs 2835 6500K+3pcs 2835 2200K Total: 36pcs 5054RGB +108pcs 2835 6500K+108pcs 2835 2200K	Single quantity: 1pc 5054RGB +3pcs 2835 6500K+3pcs 2835 2200K Total: 72pcs 5054RGB +216pcs 2835 6500K+216pcs 2835 2200K	Single quantity: 1pc 5054RGB +3pcs 2835 6500K+3pcs 2835 2200K Total: 108pcs 5054RGB +324pcs 2835 6500K+324pcs 2835 2200K
Color temperature	RGB/2200K-6500K		
Beam angle	100°		
Lumens	R: 15±5% lm G: 26 ±5% lm B: 4±5% lm 6500K: 26 ±5% lm 2200K: 22±5% lm		
CRI	>80		
Appearance color	White		
Material	PC+ABS		
Connection	2.4GHz Wifi		
Operating temperature	-20°C ~ +45°C		
Storage temperature	-25°C ~ +55°C (25°C is best-fit)		

## Installation

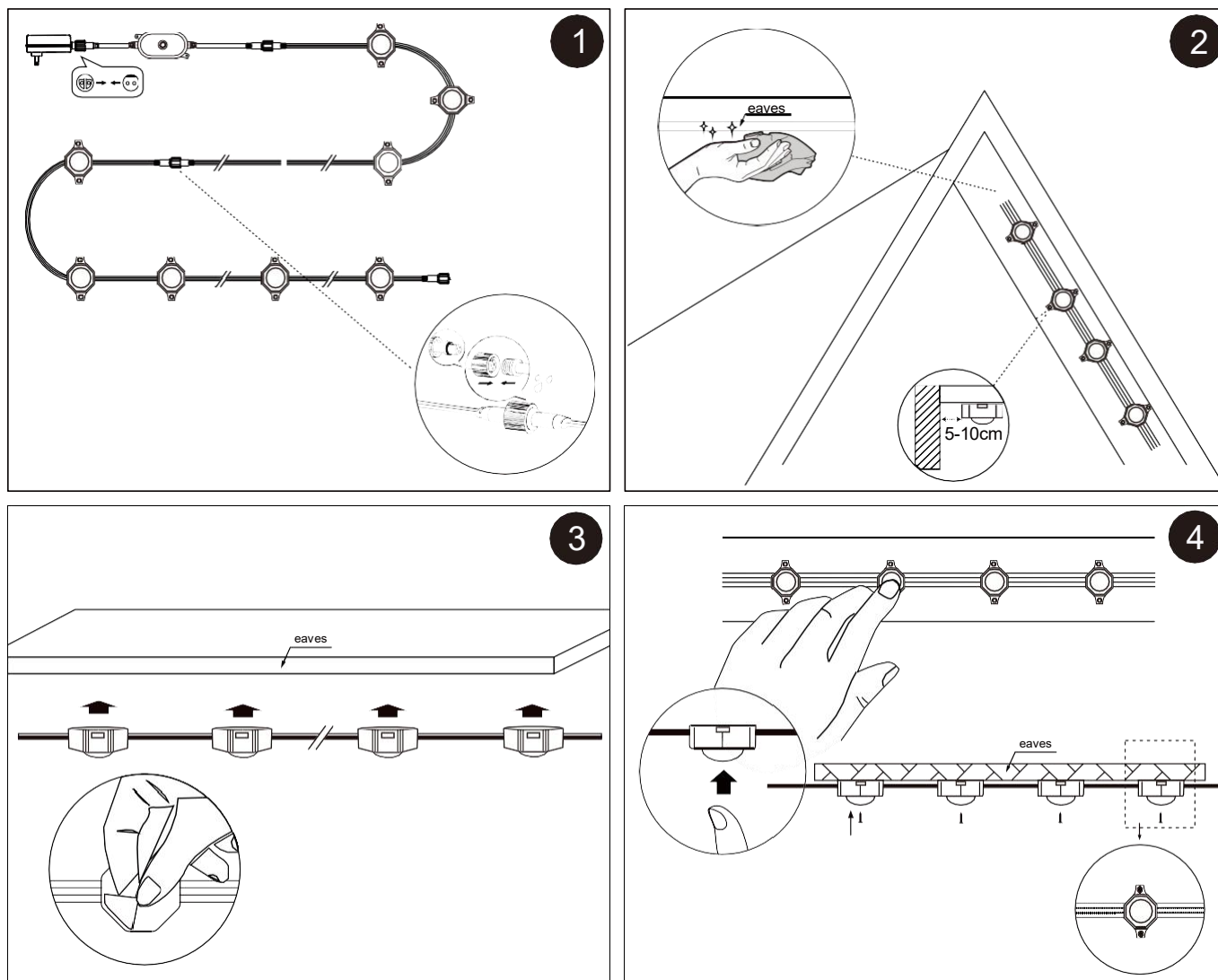

1. Before installing the permanent lights, please connect each segment of the lights and then power on to confirm if all devices are functioning properly. Note: Connect first, then power on. Do not connect after powering on to avoid a sudden surge of current that may damage the devices.
2. Clean the surface of the planned installation area with a cloth or tissue, ensuring it is dry and free from debris. It is recommended to install under the soffit, keeping 5-10cm from the wall.
3. Peel off the 3M adhesive on the back of the permanent lights. If the eaves are positioned at a right angle to the wall, use equally spaced fixtures to align the lights tightly against the edge of the fixture, and then press it upwards firmly.
4. After installation, use the steel nail cable clips and back adhesive cable clips provided in the accessory kit for securing. It is recommended to use one steel nail cable clip and one back adhesive cable clip to reinforce every two lights.

## Packing

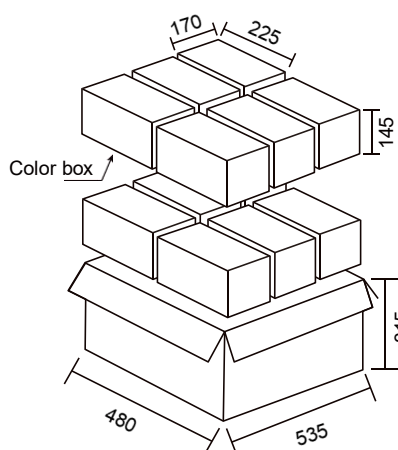
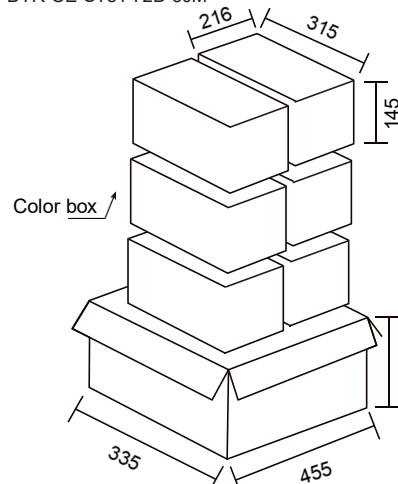
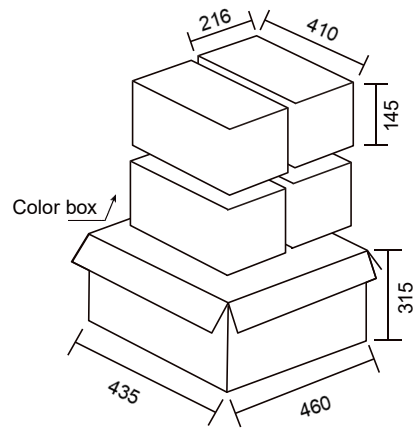
<p>BYR-OE-ST81-36D-15M</p>  <p>Color box</p> <p>12 Color Boxes/Carton</p> <p>G.W.: 20.63KG N.W.: 19.68KG</p>	<p>BYR-OE-ST81-72D-30M</p>  <p>Color box</p> <p>6 Color Boxes/Carton</p> <p>G.W.: 17.83KG N.W.: 17.16KG</p>	<p>BYR-OE-ST81-108D-45M</p>  <p>Color box</p> <p>4 Color Boxes/Carton</p> <p>G.W.: 16.32KG N.W.: 15.60KG</p>
---	--	---

Model	Color Box	N.W./Box	Boxes/Carton	Carton	N.W./Carton
BYR-OE-ST81-36D-15M	225*170*145mm	1.64Kg	12 pcs	480*535*315mm	19.68Kg
BYR-OE-ST81-72D-30M	315*216*145mm	2.86Kg	6pcs	335*455*465mm	17.16kg
BYR-OE-ST81-108D-45M	410*216*145mm	3.9Kg	4 pcs	435*460*315mm	15.60Kg

## Packing List



Controller\*1



Remote control\*1



Power supply\*1



LED string lights\*3/6/9



Spares:3M adhesive\*6/12/18



Screw\*74/146/218



Installation instruction\*1  
User manual\*1

## Remote Controller Introduction

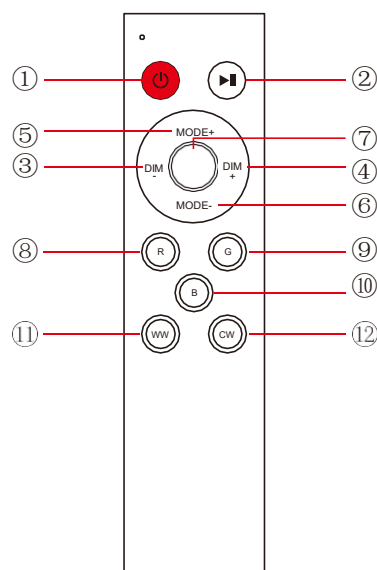

### ① ON/OFF

The remote control can control both networked and non-networked lights. When the light is not networked & networked, you need to turn off the power of the device for 5 seconds, then turn on the power of the light again and press the on/off button, the light appears to breathe or blink to complete the pairing. If the pairing is not successful, please repeat the steps.

### ② ►||

Scenes Pause/Play

### ③ DIM+

Brightness+ & Scene Speed+

### ④ DIM-

Brightness- & Scene Speed-

### ⑤ MODE+

Previous Scene

### ⑥ MODE-

Next Scene

### ⑦ AUTO

Auto Scenes Cycle

### ⑧ R

Red

### ⑨ G

Green

### ⑩ B

Blue

### ⑪ WW

Warm White

### ⑫ CW

Cool White

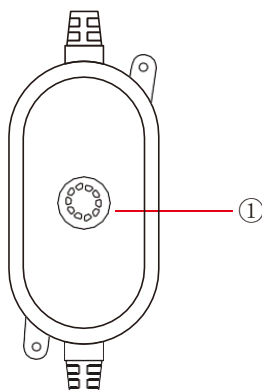

### ① ON/OFF/MODE

Long press 3-5 seconds-Network Double click-OFF Short press-ON  
Switch scenes in order: RGB/WW/CW/Christmas/Thanksgiving/Halloween/Football Day /Wind Chime/Games/Holidays/Fantasy Meteor/Colorful Pinball/Neon World

## App Functions

### Connect The Device Via The "tuya" App

1. First, search for the "Tuya" APP in the Apple Store or App Market, download and install it, or scan the QR code below to download and install



Supported device types



ipad



IOS



Android



2. Product distribution network (please confirm that the mobile phone is connected to WI-FI and Bluetooth is on):

- ① After the product is properly connected to the lamp, turn on the power. To enter the distribution network, it is necessary to repeatedly turn on and off the power 3 times, or press and hold the switch button for 5 seconds until the light flashes to enter the distribution network mode;
- ② Open the "Tuya" APP, and turn on the Bluetooth and WiFi of the mobile phone. Select "Add Device", add the screenbar to the APP according to the on-screen prompts, and you can start using Notice

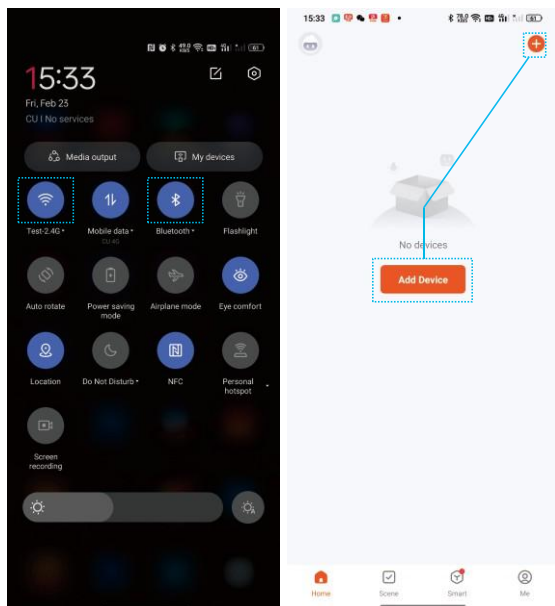

#### Notice

- The first time you open the APP, if there is an option to allow permissions, please select "Allow".
- If the android phone cannot search for bluetooth, please check whether to open the position!

3. Device connection: ① Add device ② Enter WiFi password ③ Connection succeeded

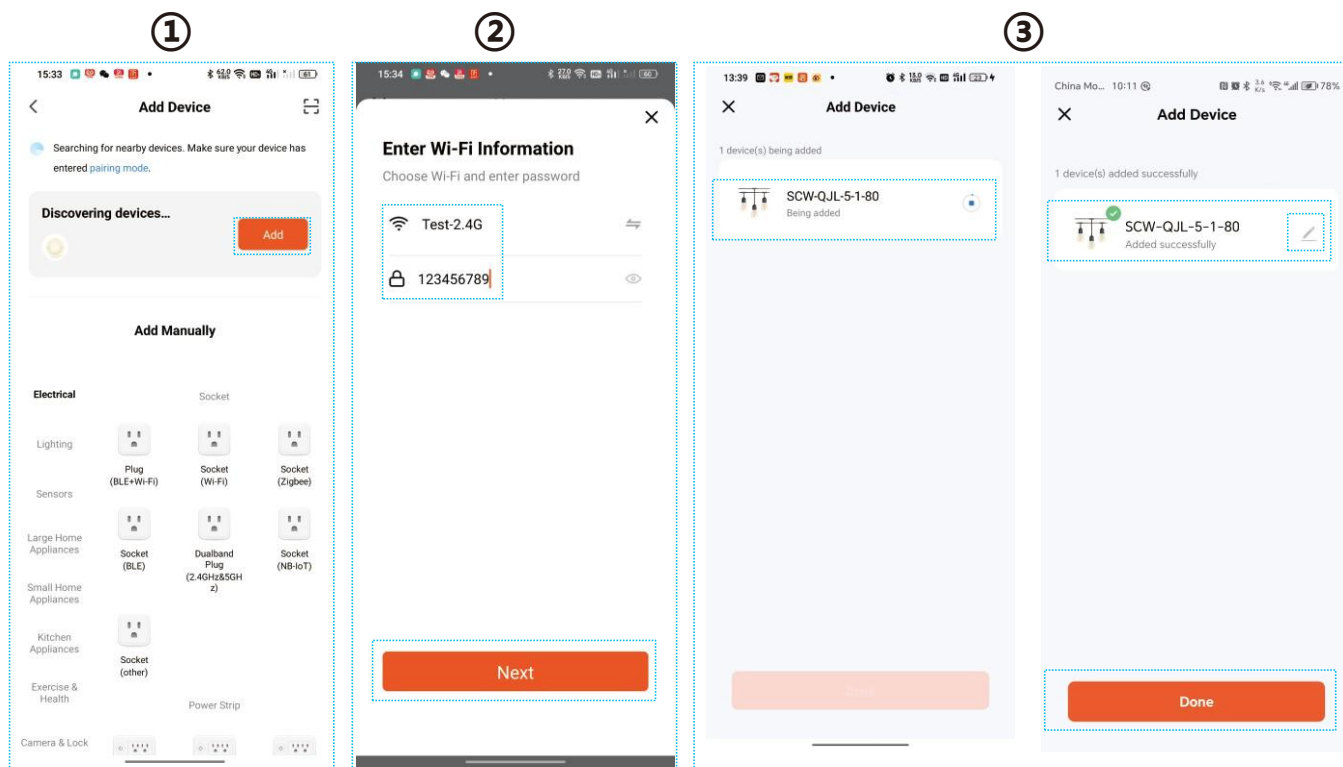

Tip: The bluetooth function in WiFi+Bluetooth dual mode is bluetooth distribution network, automatic identification of the device, after the WiFi and bluetooth is connected to the device, if the WiFi is disconnected or there is no WiFi, the mobile phone 4G or 5G signal can be used, and the bluetooth connection can be used.

## “Tuya”app Introduction

4. Please set the number of bulbs according to the actual number of bulbs in the lamp string

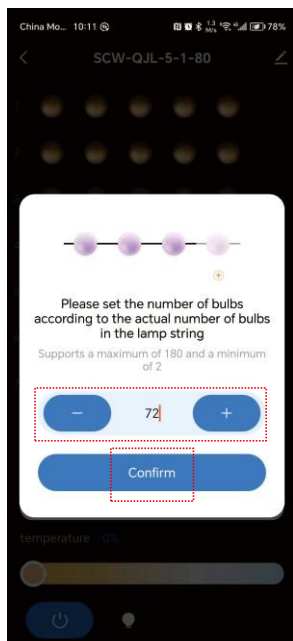

## Light Color Setting Mode

5. ① ② : When you enter the App, you can see five sections: On/Off, Colour, Scene, Music, Plan. Detailed function description please check below:  
③ : Color Card ④ : Single light control color ⑤ : All light control color ⑥ : Individual light control turn off

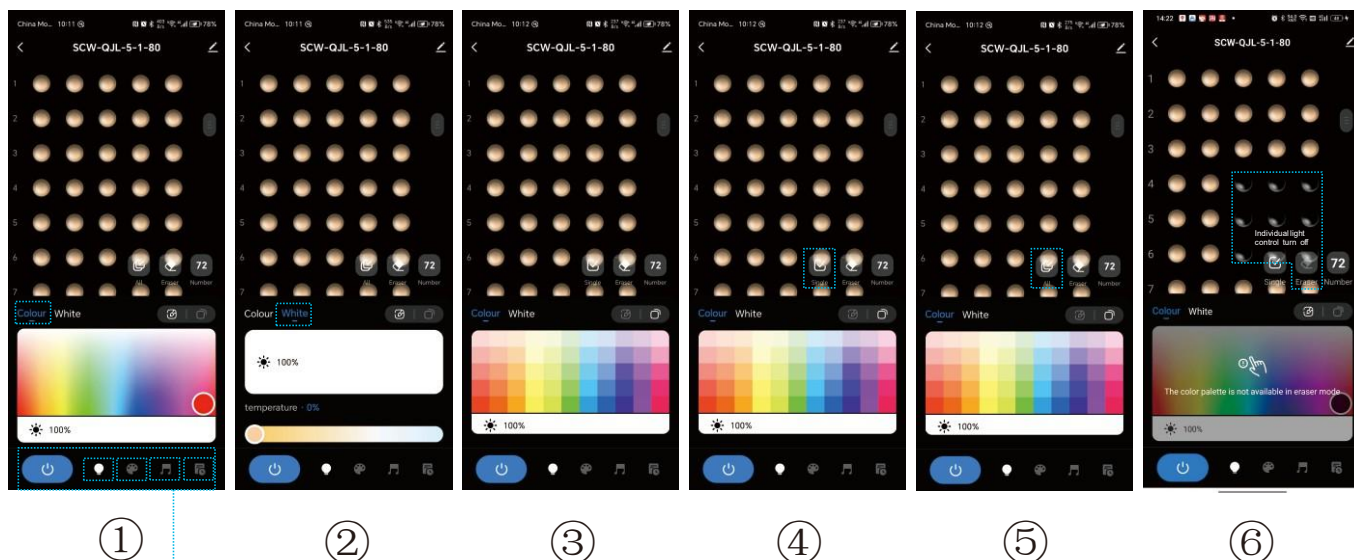

① On/Off, Colour, Scene, Music, Plan

6. On/Off: Analog key switch, control the switch of the whole set of Eaves lights.

7. Colour: After the successful connection, enter this Colour UI page by default. This UI page is with 3 icons and 1 digital display.

## Scene Mode

8. Scene: It has 44 different scene mode. Supports DIY 50+ scenes, edit your favorite scenes .

(Note: When you're done editing, be sure to preview and click Save. Next time you open this page, the DIY scene will also be saved.)

Scene Mode: ① DIY ② Scenery ③ Life ④ Festival ⑤ Mood ⑥ Add+

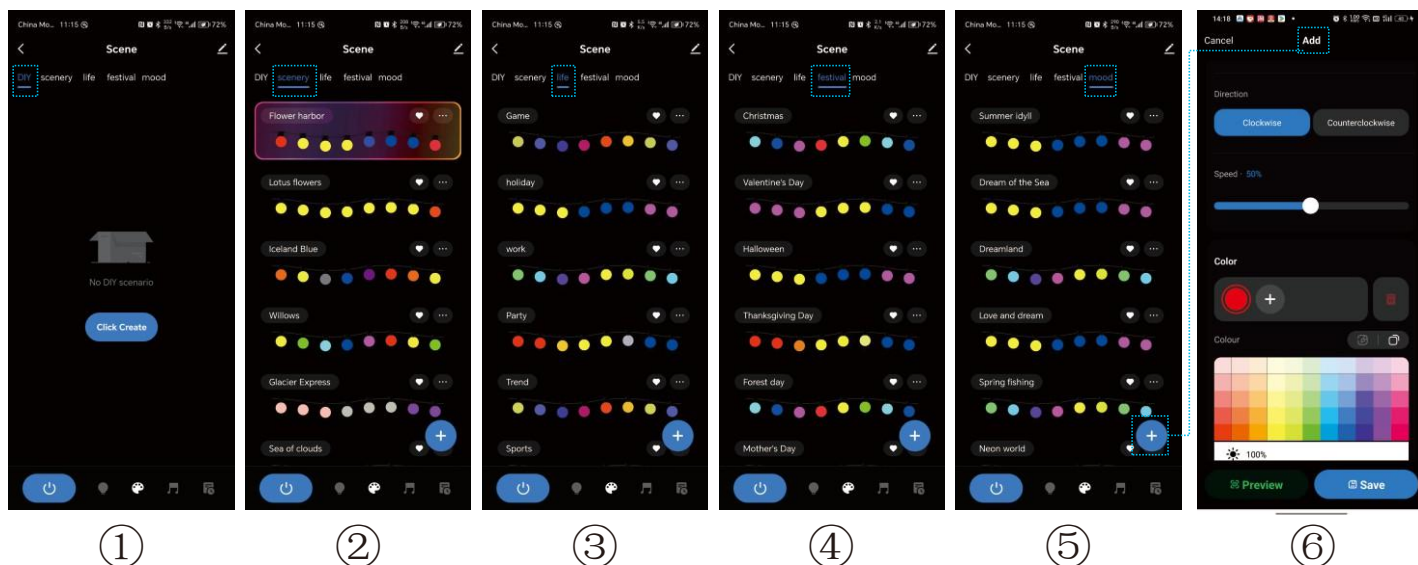

## Music Mode

9. Music: The music function requires access to the music UI, which recognises external sounds through the phone's MIC, and realises that the rhythm of the light changes along with the sound through the app's algorithm.

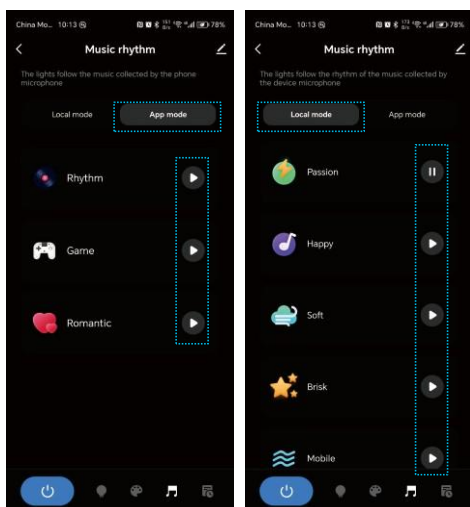

Tip: If you leave the music rhythm mode, the rhythm will stop. If the phone rests on the screen, the lights will stop. In order not to violate the privacy issue.

## Plan

10. The owner can freely set the countdown and shutdown time for the string of lights every day.

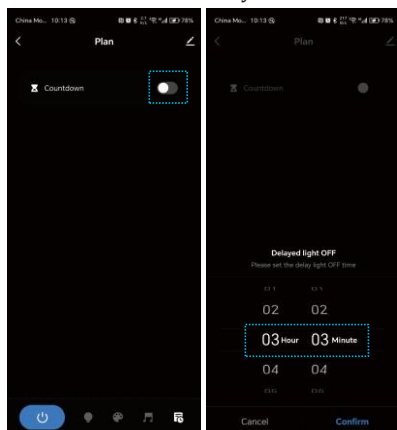



#### FCC Statement

This equipment has been tested and found to comply with the limits for a Class B digital device, pursuant to part 15 of the FCC Rules. These limits are designed to provide reasonable protection against harmful interference in a residential installation. This equipment generates, uses and can radiate radio frequency energy and, if not installed and used in accordance with the instructions, may cause harmful interference to radio communications. However, there is no guarantee that interference will not occur in a particular installation. If this equipment does cause harmful interference to radio or television reception, which can be determined by turning the equipment off and on, the user is encouraged to try to correct the interference by one or more of the following measures:

Reorient or relocate the receiving antenna.

Increase the separation between the equipment and receiver.

Connect the equipment into an outlet on a circuit different from that to which the receiver is connected.

Consult the dealer or an experienced radio/TV technician for help.

Caution: Any changes or modifications to this device not explicitly approved by manufacturer could void your authority to operate this equipment.

This device complies with part 15 of the FCC Rules. Operation is subject to the following two conditions: (1) This device may not cause harmful interference, and (2) this device must accept any interference received, including interference that may cause undesired operation.

#### RF Exposure Information

This equipment complies with FCC radiation exposure limits set forth for an uncontrolled environment. This equipment should be installed and operated with minimum distance 20cm between the radiator and your body.