

CINOTON

LED WALL PACK User Manual

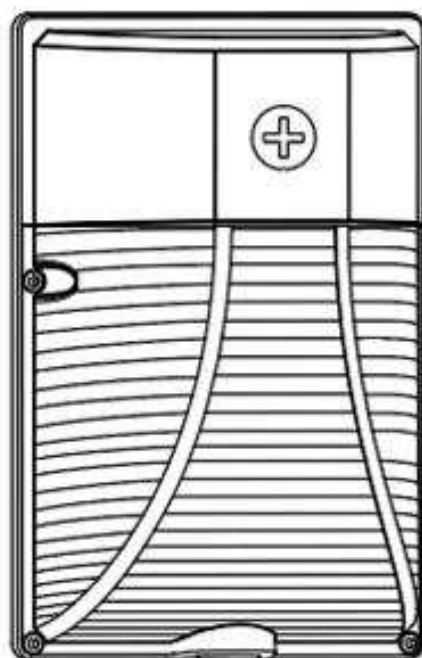

CINOTON Lighting is committed to creating high-quality, affordable, well-designed and energy-efficient LED lighting that make it easy for electricians to install and help users to save energy.

cinoton.service@gmail.com



SAFETY INFORMATION

1. Please ensure that there are no obstacles in front of the sensor light, and avoid installing it in a narrow corner or under a roof with obstructions. Reflected light can affect the light sensor's incorrect judgment (as shown in Figure 1).
2. Before connecting the wiring device to a power source, turn off the power at the fuse or circuit breaker box.
3. Please confirm whether the power supply voltage is correct. Connect the fixture to an AC power source of 100-277V~50/60HZ.
4. Please ensure that all electrical and grounding connections comply with national electrical codes and any applicable local regulations.
5. The product is suitable for use in damp environments, with an ambient temperature not exceeding 104°F.
6. Please ensure that the fixture is securely mounted on the wall and apply some adhesive to seal the gap between the light and the wall after installation.
7. Min 90 °C SUPPLY CONDUCTORS.

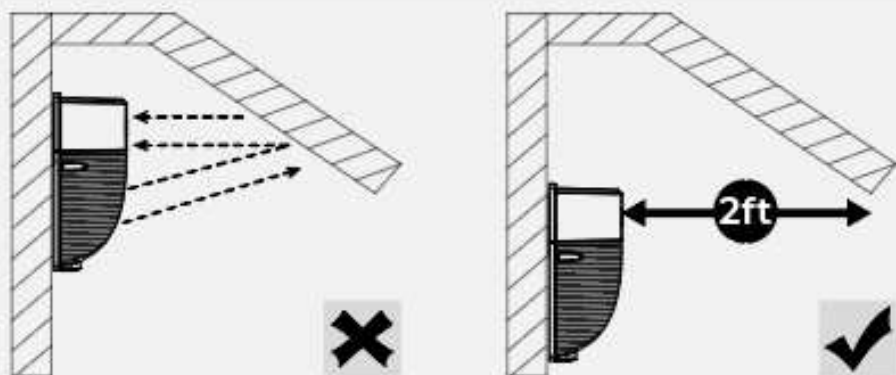

(Figure 1)

Please ensure that there are no obstacles in front of the sensor light, and avoid installing it in a narrow corner or under a roof with obstructions. Reflected light can affect the light sensor's incorrect judgment

SAFETY INFORMATION

- 1 Remove the lens by removing the 2 screws securing it to the rear housing and set aside.
- 2 Loosen two screws enough to allow reflector to slide upward until keyhole in reflector releases from two screws. Remove reflector.
- 3 Knock out appropriate holes around outlet hole in rear housing and apply the gasket to the back surface of housing and fasten the rear housing to the outlet box using the screws supplied with the outlet box.
- 4 Complete the wiring to the power source and ground. Using customer supplied 90°C minimum rated wire connectors, make the following electrical connections in the mounting box or junction box:
 - a. Connect the black fixture lead to the voltage supply lead
 - b. Connect the white fixture lead to the neutral supply lead
 - c. Connect the ground lead to the supply ground lead.
- 5 Replace reflector. Replace front housing by reversing procedure used to remove it.
- 6 For a better seal against rain, it is suggested to apply silicone caulk around back edges of fixture.

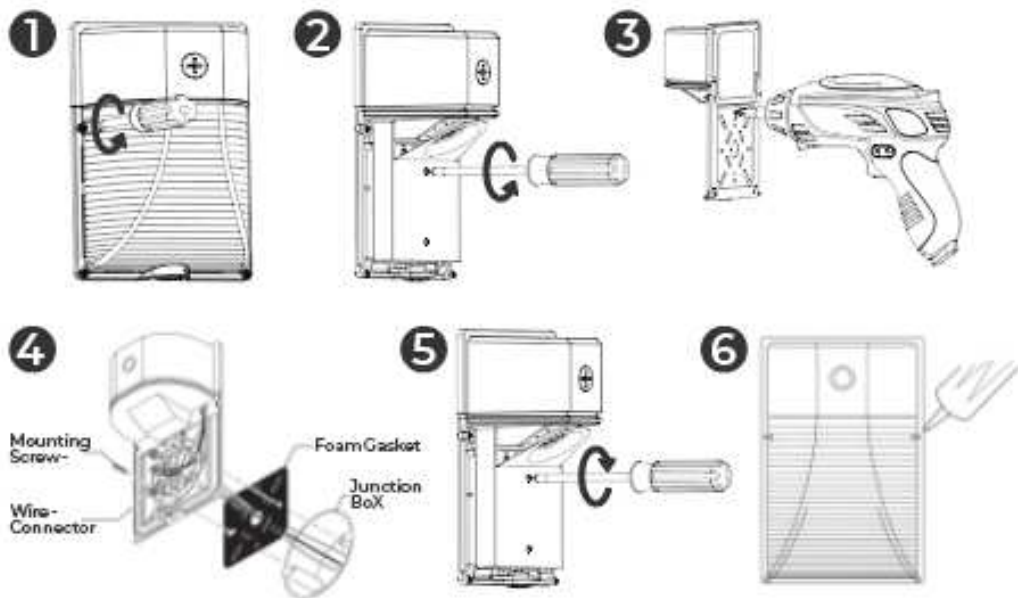

IF YOU HAVE PURCHASED A LIGHT FIXTURE WITH ADJUSTABLE OPTIONS, PLEASE FOLLOW THE STEPS BELOW TO SET IT UP

1

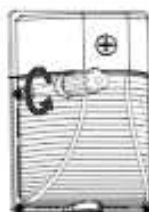

◆ Remove the lens by removing

2



Power Dial Switch

CCT Dial Switch

- ◆ Please dial power switch to choose the wattage you need
- ◆ Please dial CCT switch to choose the CCT you need.

WIRE CONNECTION

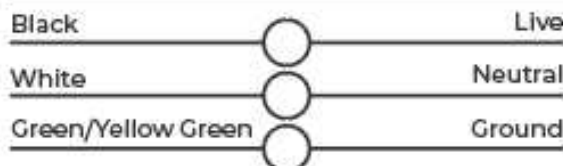

Universal voltage driver permits operation at 100V to 277V, 50 or 60 Hz.

CLEANING & MAINTENANCE

1. Clean polycarbonate lens with non-abrasive glass cleaning solution.
2. Do not open the fixture to clean the LED. Do not touch the LED.
3. It is recommended to wear gloves to avoid injury during installation.
4. If any smoke or spark, please turn off the power immediately.

TROUBLE SHOOTING

Q: Why my lights flashes on and off repeatedly?

A: Avoiding to install it in a narrow corner or under a roof with obstructions. Reflected light can affect the light sensor's incorrect judgment.

Q: Nice light, but photocell doesn't work? light stays on all the time.

A: The sensitivity would be affected by temperature, weather, surroundings Lights source.

Q: If the lights stop working when the return window closes.

A: Please feel free to contact us. 24hours-customer service team will help you solve the problems. cinoton.service@gmail.com