

3" LED Selectable Slim Downlight

Installation Manual

COMPONENTS

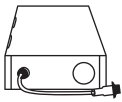

x1
Junction Box



x2
Wire Nuts

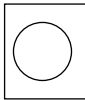

x1
Installation Template

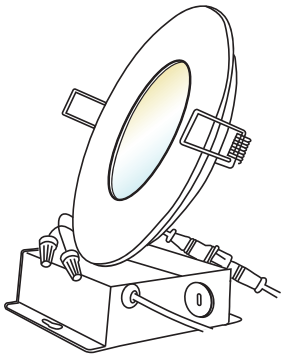

EASY INSTALLATION

CANLESS RECESSED MOUNT

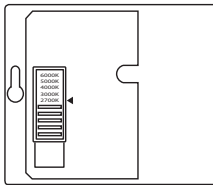

1. Turn off circuit breaker before installation.
2. Set preferred temperature using CCT switch on back of fixture.

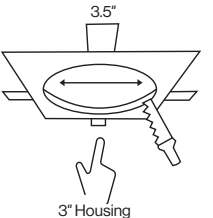

3. Cut out Installation Template according to housing size, then tape onto ceiling in desired location.
4. Cut ceiling hole using Installation Template as a guide.

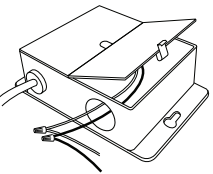

5. Open junction box and remove appropriate knockout.
6. Connect supply and junction wires using wire nuts:
 - Black to Black (Live)
 - White to White (Neutral)
 - Tuck connected wires inside junction box and close cover.

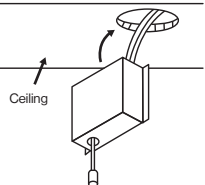

7. Insert junction box through ceiling hole.
 - **New Construction Applications:** Junction box should be secured to studs, joists, or similar fixed structural units.
 - **Remodel Applications:** Does not require junction box to be secured to studs, joists, or structural units.

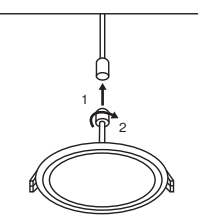

8. Attach fixture to junction box using connector as shown on image (1).
 - Tighten connector by hand (2).

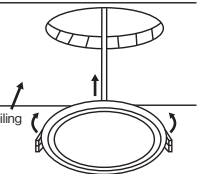

9. Push up spring clips and insert fixture into ceiling.
10. Turn on circuit breaker and test light.

WARNING

- To reduce the risk of fire, electric shock, or injury:
- Turn off circuit breaker before installing this fixture.
 - This product should be installed by a person familiar with the construction and operation of the product and hazards involved. Safety eyeglasses and gloves are recommended.
 - Abide by regional and local laws or regulations.
 - Proper grounding is required to ensure safety.
 - Do not alter, relocate, or remove wiring during installation.
 - Do not make or alter any open holes in wiring enclosure or electrical components during installation.
 - Check for shipping damage before installing. If the product is damaged, do not use it.
 - Keep fixture away from corrosive substances.
 - Suitable for damp locations at temperatures ranging from 4°F to 113°F. Not for use where directly exposed to water.
 - Clean fixture regularly to ensure proper operation. Do not clean with harsh solvents.
 - Use safety precautions and abide by regional and local laws or regulations.
 - This product is not compatible with 3rd party sensors.
 - This product is not compatible with photo controls.
 - This product is not compatible with occupancy sensors.
 - This product is not compatible with timing devices.

SPECIFICATIONS

Voltage	120V
Wattage	8W
Weight	0.35 lbs
Housing Material	Plastic
Moisture Rating	Damp
Warranty	7 years