

# Hisense

life reimagined

## USER'S OPERATION MANUAL

Before operating this unit, please read this manual thoroughly, and retain for future reference.

**HWF3S7514W2**

**EN**

**English**

Thank you very much for choosing our product.

- Please install and operate this product correctly. Do not use it for any laundry labelled as not suitable for machine washing.
- The pictures shown in the manual are for illustrative purposes only. Appearance, printing and other details are subject to actual product.
- We prioritize technological innovation. To improve its overall performance, the appliance is subject to technical changes without notice.
- This product is intended solely for household use.

The following symbols used in this manual are defined below:



Information, advice, tip, or recommendation



WARNING - General Danger



WARNING - Danger of Electric Shock



WARNING - Danger of Hot Surface



WARNING - Danger of Fire



Please read this manual thoroughly.

# 目录

<b>4 SAFETY PRECAUTIONS</b> .....	<b>INTRODUCTION</b>
<b>10 PRODUCT DESCRIPTION</b> 11 Specifications	
<b>12 INSTALLATION AND CONNECTION</b> 12 Packing/Packaging 14 Remove the transport screws 15 Installation location 15 Adjustable feet 15 Installation clearance 16 Connecting to water supply 19 Connecting and securing the water discharge 20 Connecting to power mains 21 Transportation after installation .....	<b>PREPARATION BEFORE FIRST USE</b>
<b>22 BEFORE USING THE APPLIANCE FOR THE FIRST TIME</b>	
<b>26 PROGRAMS AND FUNCTIONS</b> 27 Program table 29 Additional settings and functions 33 Start the program 33 End of the program .....	<b>WASHING STEPS</b>
<b>34 INTERRUPTIONS AND CHANGING THE PROGRAM</b> .....	
<b>36 MAINTENANCE AND CLEANING</b> 36 Cleaning the detergent drawer 37 Cleaning the water supply hose, detergent dispenser housing, and rubber door gasket 38 Cleaning the pump filter 39 Cleaning the inlet filter 39 Cleaning the exterior	<b>CLEANING AND MAINTENANCE</b>
<b>40 TROUBLESHOOTING</b> <b>43 FAULT CODES AND TROUBLESHOOTING</b> <b>44 SERVICING</b> .....	<b>TROUBLESHOOTING</b>
<b>44 USAGE RECOMMENDATIONS</b> <b>45 STAIN REMOVAL TIPS</b> <b>47 DISPOSAL</b>	<b>MISCELLANEOUS</b>

# SAFETY PRECAUTIONS



Please read this manual carefully before operating the appliance.

**Do not operate the appliance without understanding or reading this manual.**

**This manual applies to multiple models. Therefore, it may include features not applicable to your model.**

**Failure to follow the instructions or improper operation may cause damage to laundry or equipment, or result in personal injury. Please keep the manual near the appliance for easy access.**

**This appliance is intended to be used in household.** If the appliance is used for professional, for-profit purpose or purpose exceeding normal use in a household, or if the appliance is used by a person who is not a consumer, the warranty period shall be equal to the shortest warranty period required by relevant legislation.

This appliance is not intended for use by persons (including children) with reduced physical, sensory or mental capabilities, or lack of experience and knowledge, unless they have been given supervision or instruction concerning use of the appliance by a person responsible for their safety.

Children should be supervised to ensure that they do not play with the appliance.

**Children of less than 3 years should be kept away unless continuously supervised.**

This appliance can be used by children aged from 8 years and above and persons with reduced physical, sensory or mental capabilities or lack of experience and knowledge if they have been given supervision or instruction concerning use of the appliance in a safe way and understand the hazards involved.

Children shall not play with the appliance. Cleaning and user maintenance shall not be made by children without supervision.

The maximum capacity in some cycles for dry clothes to be used is Wash (7.5kg) .

The recommended maximum capacity for each program may vary. For optimal results, see "PROGRAM TABLE".

**To connect the appliance to water supply**, make sure to use the supplied water supply hose and gaskets. Water pressure has to be between 0.1-1 MPa (1-10 bar; 1-10 kp/cm<sup>2</sup>; 10-100 N/cm<sup>2</sup>) .

Always use a new water supply hose to connect the appliance to water supply, do not reuse an old water supply hose.

For appliances with ventilation openings in the base, the ventilation openings must not be obstructed by a carpet.

If the supply cord is damaged, it must be replaced by the manufacturer, its service agent or similarly qualified persons in order to avoid a hazard.

## **ELECTRICAL SAFETY**

**This appliance complies with relevant safety standards.**

**Before connecting the appliance to the power mains, wait for at least 2 hours until it reaches room temperature.**

**This appliance must be repaired by an authorised service center, using only spare parts approved by authorised manufacturers. Any repairs or maintenance related to safety or performance should be conducted by trained professionals.**

**Do not attempt to repair the appliance by yourself. Repairs performed by unqualified personnel may result in personal injury or more serious error. Please consult your local service center and always insist on genuine spare parts.**

Do not attempt to operate the appliance if it is damaged, defective, partially disassembled, or has missing or damaged parts, including damaged wires or plugs.

Do not excessively bend the power cord or place heavy objects on it.

Do not clean the inside or outside the appliance with spray water.

In case of flooding, please disconnect the power plug and contact the after-sales service center.

Models with a drying function enable automatic shutdown of the heater to prevent overheating. The heater automatically shuts off when the temperature exceeds the safety threshold and restarts when the temperature drops below the threshold.

Do not connect multiple power sockets, extension cords or dual adapters to the appliance. Do not connect the appliance to the power mains using an extension cord.

Do not connect the appliance to a power socket intended for an electric shaver or hair dryer.

Do not connect the appliance to a power socket intended for small loads.

Before connecting the appliance to the power supply, ensure that the electric voltage specified on the rating plate matches the Voltage of your socket.

The power socket must be securely grounded and the water supply must be unobstructed.

Do not connect the appliance to power mains using an external switching device such as a program timer, or connect it to power mains that is regularly switched on and off by the power supply provider.

Exhaust air must not be discharged into a flue designed to discharge combustion gases or other fuel exhaust gases.

## INSTALLATION

Before using the appliance, be sure to remove the packaging (sponge, polystyrene foam, etc.) attached to the bottom of the appliance.

Please install the appliance correctly according to the instructions and connect it to the water and electricity supply (see "INSTALLATION AND CONNECTION").

Water piping and electrical wiring should be carried out by a fully trained technician or professional.

Do not install the appliance in a location where the door opening is restricted.

**Do not install the appliance where the temperature may drop below 5°C**, as it parts may be damaged in case of water freezing.

Place the appliance on a solid and level floor. If installed on a high platform, the appliance must be reinforced to prevent it from tipping over.

The end of the water discharge hose should reach into a water drain line.

This appliance should not be stored or used outdoors.

Avoid lint accumulation near the appliance.

Do not install the appliance near heaters or flammable materials.

Do not install the appliance in an area where gas leaks may occur.

Ensure good ventilation to prevent the gases generated by the appliance from flowing back into the room and causing a fire.

## **USAGE**

**Remove the transport screws/rods before first use**, otherwise serious damage may occur when starting the appliance (see chapter "INSTALLATION AND CONNECTION/Remove transport screws/rods"). Such damage is not covered by the warranty.

**Check the appliance for damage during transportation. Never operate the appliance if it is damaged.**

Use detergents suitable for the appliance and laundry care. We shall not be responsible for any damage or discoloration of gaskets and plastic parts resulting from incorrect use of bleaching or colouring agents.

Do not attempt to remove any panels or disassemble the appliance.

Do not press buttons with sharp objects such as pins, knives, or nails.

Do not touch the power plug or operate the appliance with wet hands.

This appliance is only suitable for regular washing or drying (for tumble dryer models). It cannot be used for dry cleaning.

Attempting to lift the heavy appliance may cause you to get injured. Do not attempt to lift the appliance yourself as your hands may be cut by its sharp edges.

Do not use protruding parts to move the appliance. Protruding parts on the appliance may be broken when lifting or pushing the appliance.

Do not wash laundry with large buttons or other heavy metal objects, and ensure that all pockets of the laundry are empty. To prevent odours and mildew, open the door at the end of the washing cycle to allow the drum to dry.

Do not leave metal objects in the drum for extended periods.

The door glass may be cracked by strong impacts. Handle with care.

Place laundry completely into the drum to prevent it from getting caught in the door.

Cut off the water supply and unplug the power cord when the appliance is not in use.

Do not place any animals (such as pets) into the appliance.

## **TRANSPORT/TRANSPORT AFTER INSTALLATION**

**Assemble the transport screws/rods if you need to move the installed appliance** (see chapter "INSTALLATION AND CONNECTION/Moving and Transporting After Installation"). Unplug the power cord before assembling the transport screws/rods!

**Turn off the tap and unplug the appliance at the end of the washing cycle.** Never unplug the appliance by pulling on the power cord. Always hold the power plug firmly and pull it straight out of the socket.

 Do not use detergents that contain solvents as this could lead to release of poisonous gases, damage to the appliance, and cause the risk of fire and explosion.

Do not open the appliance door by force while it is operating (High-temperature washing/drying).

Do not use the appliance after cleaning with industrial chemicals.

 Water drained during a high-temperature washing cycle is hot. Do not touch the water to prevent burns.

Laundry contaminated with edible oils, acetone, alcohol, petrol, kerosene, detergents, turpentine, wax and wax removers should be pre-washed with hot water and plenty of detergent before placing in the drum.

Use softener or similar products according to the manufacturer's instructions.



Remove all items such as cigarette lighters or matches from pockets.

### **DANGER OF HOT SURFACE**

At higher washing or drying temperatures, the door glass will heat up. Be careful to avoid burns. Make sure children do not play near the door glass. Do not touch the door glass during operation.

### **WATER OVERFLOW PROTECTION (WITH APPLIANCE SWITCHED ON)**

If the water level in the appliance rises above normal level, then the excess water level protection will be activated. It will shut off the water supply and start pumping out the water. The program is interrupted and an error is reported.

Do not wash or dry laundry made of foam rubber (latex foam), shower caps, waterproof fabrics, rubber products, or clothing or pillows containing foam rubber pads in the drum.

### **WARNING**

If your appliance has a drying function, do not interrupt the program until the drying cycle is complete. If you need to interrupt it for any reason, carefully remove laundry to avoid burns. Quickly remove laundry and spread it out so that the heat is dissipated.

## **CHILD SAFETY**

Before closing the appliance door and running the program, make sure there is nothing except laundry in the drum. Make sure no child climbed into the appliance drum and closed the door from the inside.

Do not leave the door open. Children may hang on the door or climb into the appliance, causing damage or injury.

Keep all packaging materials out of the reach of children, as they may pose a danger.

Keep detergent and softener out of reach of children.

## **SERVICING**

Repair costs resulting from damage caused by incorrect connections, improper installation and use, or repairs made by unauthorised personnel are the responsibility of the user and are not covered by the warranty.

**The warranty does not cover** consumables, minor colour deviations, increased noise due to appliance age that does not affect the functionality of the appliance, and aesthetic defects on components that do not affect the functionality and safety of the appliance.

# PRODUCT DESCRIPTION

## FRONT

- 1 Control unit
- 2 Program selector knob
- 3 Detergent drawer
- 4 Door
- 5 Pump filter cover

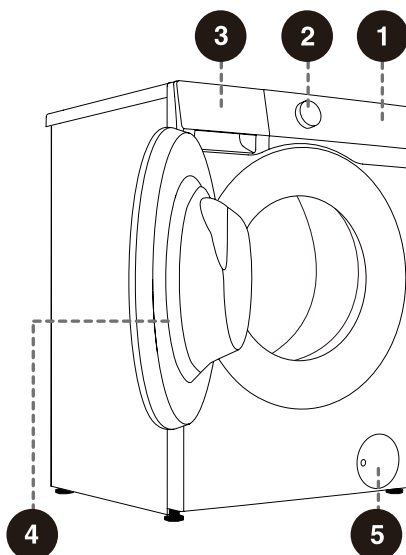

## BACK

- 1 Water supply hose
- 2 Power cord
- 3 Water discharge hose
- 4 Adjustable feet
- 5 Transport screws/rods

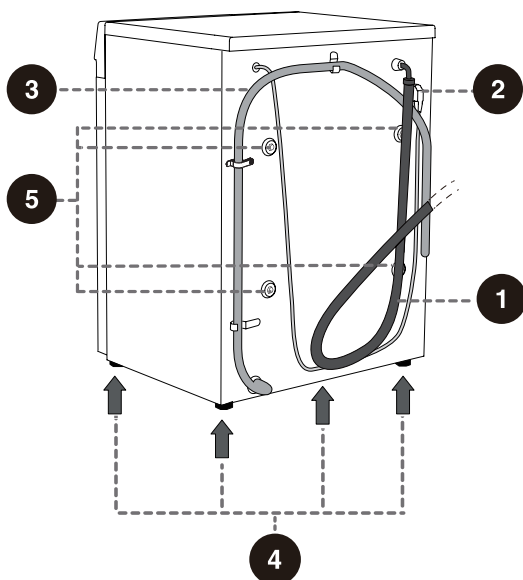

 The illustrations in this manual are for illustrative purposes only. Due to product improvements and series expansion, the appearance, color, and functional components of the product you receive may differ from those shown in this manual. Please refer to the actual product.

# SPECIFICATIONS

(DEPENDING ON THE MODEL)

Max. load	7.5 kg
Net Weight	59 kg
Rated Voltage	220-240 V~
Frequency	50 Hz
Rated Power	1600 W

## DIMENSIONS (MM)

Index	Dimensions (mm)
A	595
B	845
C	385
D	435
E	470
F	960

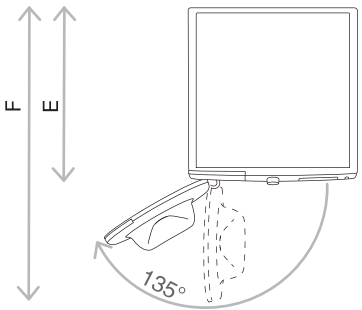
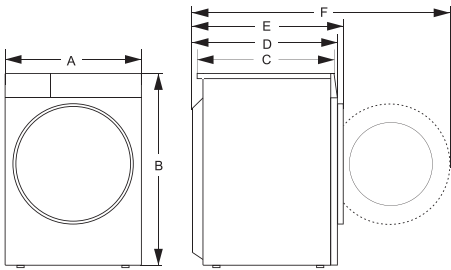

E = appliance depth  
F = Depth with door open

# INSTALLATION AND CONNECTION

## Packing/Packaging

💡 Please first remove all packaging and foam, especially the foam base. When unpacking the device, please do not use sharp objects to damage it. Keep packaging materials (plastic bags, other plastic parts, etc.) out of reach of children.

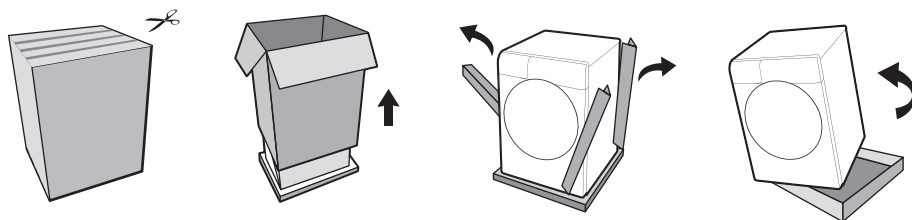

💡 The process of packing the machine is just the opposite of unpacking above.

💡 Please check the device for any damage. If damaged, do not use it, and contact the after-sales service immediately.

The accessories included with this device include one or more of the following:

- User manual;
- 4 plastic plugs;
- Supply hose;
- Drain hose holder;
- Wrench;
- Noise reduction board/sponge strips/none (depending on the model).

Different models have different configurations, and the accessories included with this device are subject to the actual configuration of the model.

## HOW TO INSTALL THE NOISE REDUCTION BOARD:

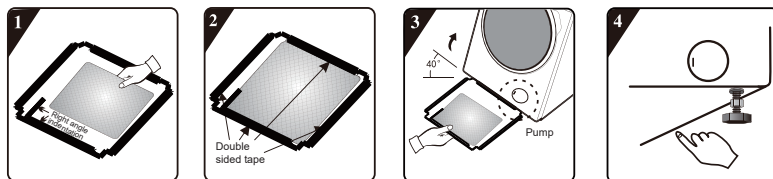

**1** Before installing the noise reduction board align and paste the acoustic absorption wool with and along the right-angle impression on noise reduction board (this procedure is unnecessary for some of the models without acoustic absorption wool).

**3** Incline the appliance to an angle of  $40^\circ$  and let the side with right-angle notch face towards front of the appliance, as shown in the figure. Insert the side with oblique-angle notch between two foot screws at back of the appliance completely in place. Then, install the noise reduction board and ensure that it contacts with bottom of the appliance closely.

**2** Remove surface paper on double sided tape at four sides of the noise reduction board.

**4** Press the double sided tape on four sides manually to secure the noise reduction board to the appliance firmly.

## HOW TO INSTALL THE SPONGE STRIPS:

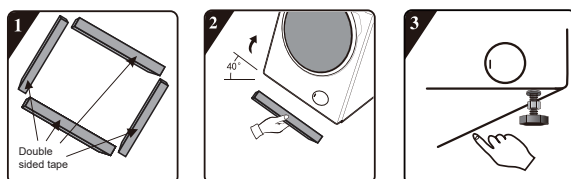

**1** Remove surface paper on double sided tape on the sponge strips.

**3** Press down to secure the sponge strips firmly.

**2** Incline the appliance to an angle of  $40^\circ$  and attach sponge strips on the bottom of the appliance with the two long sponge strips at the front and rear support positions, and the two short sponge strips at the left and right support positions.

## REMOVING THE TRANSPORT SCREWS/RODS

 Disassemble the transport screws/rods once all packaging has been removed. A blocked appliance may be damaged when it is switched on for operation. Such damage is not covered by the warranty.

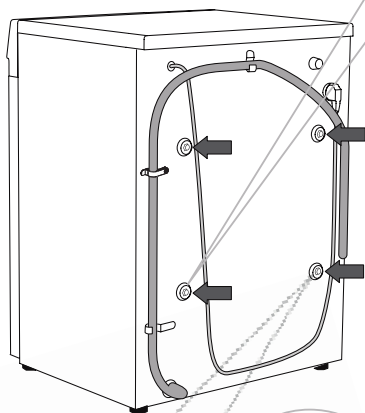

Remove the power cord clip located here as well.

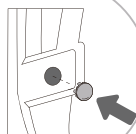
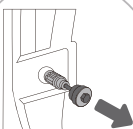
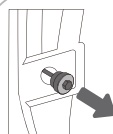

**1** Move aside the water discharge hoses and use an appropriate wrench to loosen the four screws on the back in the counterclockwise direction as indicated by the arrows. Loosen the screws approximately 30 mm.

**2** Pull all 4 transport screws/rods horizontally.

**3** Pull out the transport screws/rods along with the rubber and the plastic parts.

**4** Cover the screw holes with plastic plugs. The plastic plugs are supplied in the bag with the appliance user manual (the support set).

 Save the transport screws/rods in case you have to transport the appliance again later (to reinstall the transport screws/rods, follow the above procedure in reverse order).

# INSTALLATION LOCATION

💡 Place the appliance on a solid and level floor to keep it stable. The floor should be clean and dry; otherwise, the appliance may slide. Also, clean the bottom surface of adjustable feet.

## ADJUSTABLE FEET

Use a spirit level and a suitable wrench.

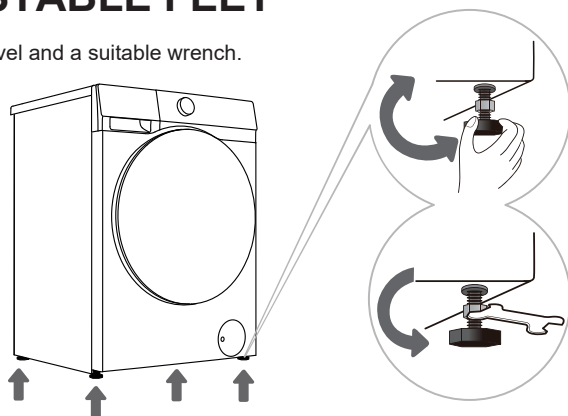

**1** Adjust the level by rotating the adjustable foot. The adjustable foot allows for 2 cm of level adjustment.

**2** After adjusting the height, tighten the lock nut anticlockwise using a suitable wrench (see the figure).

- 💡 Incorrect levelling of the appliance may cause vibration, appliance sliding across the room, and loud operation. Incorrect levelling of the appliance is not subject to warranty.
- 💡 Sometimes, unusual or louder noise may appear during appliance operation. These are mostly the result of improper installation.

## INSTALLATION CLEARANCE

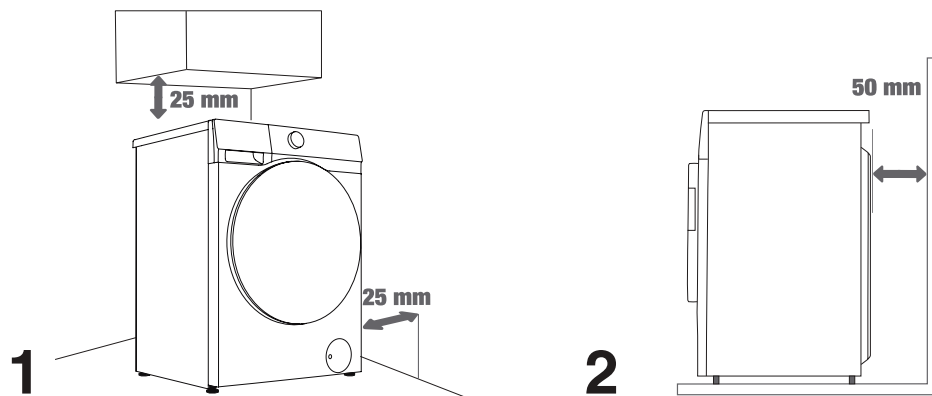

💡 The appliance may not be in contact with a wall or adjacent furniture. For optimum appliance operation, we recommend observing the clearances from the walls as indicated in the figure. In case of failure to observe the minimum required clearances, safe and correct appliance operation cannot be ensured. Moreover, overheating can also occur (Figures 1 and 2).

# CONNECTING TO WATER SUPPLY

The supplied water supply hose varies by model. Please choose the appropriate connection method based on the actual water supply hose.

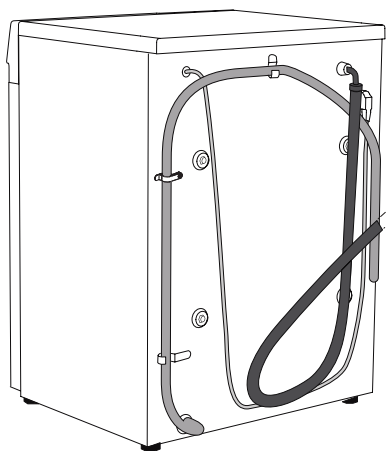

**A** EUROPEAN  
WATER SUPPLY  
HOSE CONNECTION

**B** AQUA STOP  
CONNECTION

**C** CHINESE WATER  
SUPPLY HOSE  
CONNECTION

💡 For normal appliance operation, the pressure in the water mains should be between 0.1-1MPa (1-10 bar; 1-10 kp/cm<sup>2</sup>; 10-100 N/cm<sup>2</sup>). Minimum dynamic water pressure can be determined by measuring the water flow. In 15 seconds, 3 litres of water should flow from a fully open tap.

💡 Only use the water supply hose supplied with the appliance. Do not use any used or other hoses.

💡 Make sure the hose is not damaged. If the hose is degraded, brittle, or cracked, it has to be replaced.

💡 This appliance is designed for cold water only. Do not connect it to hot water.

## EUROPEAN WATER SUPPLY HOSE CONNECTION

Tighten the water supply hose by hand to ensure proper sealing (maximum torque: 2 Nm). Check the sealing for leaks.

Do not use pliers or similar tools as they may damage the nut threads.

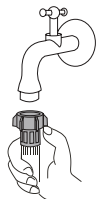





## AQUASTOP CONNECTION

If an internal tube or hose is damaged, a shut-off system is activated that cuts the water supply to the appliance. In such case, the control glass (a) will turn red. Replace the water supply hose.



 Do not dip the water supply hose with the AquaStop system in water as it contains an electric valve.

 The water supply hose can be connected without a non-return valve.

## CHINESE WATER SUPPLY HOSE CONNECTION

1. Select a suitable tap with a tip length greater than 10 mm. The outlet end must be flat. If it is uneven, smooth it out with a file to prevent leakage after installation (see Figure 1).
2. Push the slider down to disconnect the water supply hose connector from the inlet assembly (see Figure 2).
3. Loosen the four screws on the water supply hose connector, then attach the hose to the tap. If the tap diameter is too large for the connector, loosen the screws and remove the sleeve (see Figure 3).
4. Evenly tighten the four screws on the water supply hose connector and secure the nuts (see Figure 4).
5. If the appliance is to be used once or several times in a week, push the slider down without disconnecting the water supply hose connector to avoid damaging the fixing screws.

 NOTE: The exposed thread length before tightening the nut is approximately 4 mm and less than 2 mm after tightening (Figure 4).

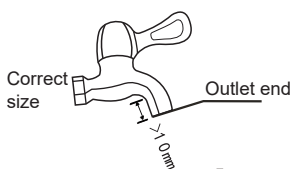

1

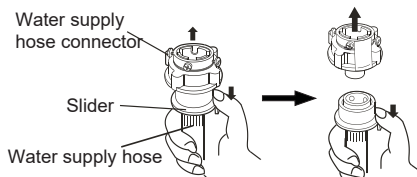

2

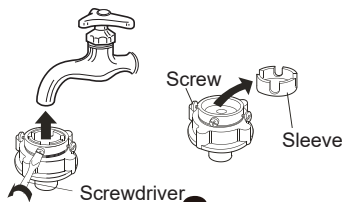

3

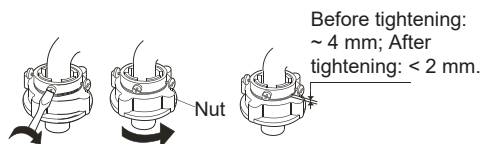

4

## CHECKING THE CONNECTION BETWEEN THE WATER SUPPLY HOSE AND THE TAP

1. Gently pull the water supply hose to check if the connection is secure.
2. Open the tap to check for leaks.
3. The water supply hose should not be twisted or bent.
4. Check the water supply hose before each use to prevent incorrect connection.



## CONNECTING THE WATER SUPPLY HOSE TO THE APPLIANCE

Connect the water supply hose nut to the water supply hose connector of the appliance. Tighten the nut and shake it gently to check that it is firmly secured, as shown in the right figure.

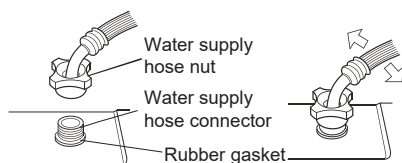

### NOTE:

1. Tighten the nut evenly. Avoid rotating the water supply hose, as this may cause damage.
2. Do not remove the rubber gasket. Before each use, check that the gasket is not detached or damaged. If damaged, please contact after-sales service immediately.

## CONNECTING AND SECURING THE WATER DISCHARGE HOSE

Feed the water discharge hose into a washbasin or a bathtub, or connect it directly to a drain (discharge hose minimum diameter 4 cm). The vertical distance from the floor to the end of the discharge hose may be 70 to 100 cm. It can be attached in three ways (A, B, C).

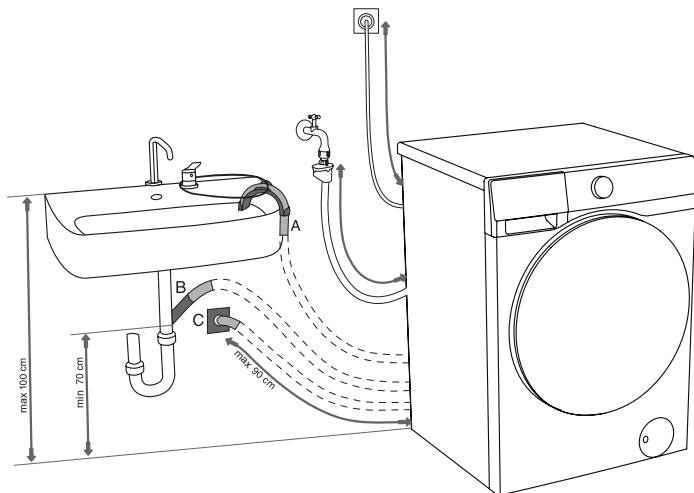

**A** The discharge hose end may be placed over a sink or a bathtub. Use a string fed through the opening in the elbow support to attach the hose and prevent it from slipping to the floor.

**B** The discharge hose may also be attached directly to the sink drain. A sink that is too small is not acceptable. Be careful as the drained water may be hot.

**C** The discharge hose can also be attached to a wall drain with a trap. Such trap should be properly installed to allow cleaning.

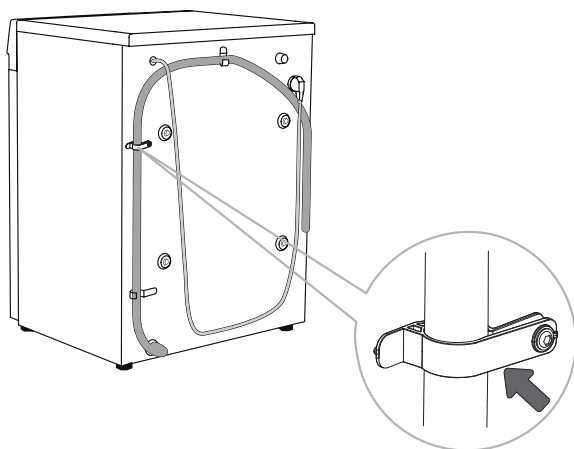

**D** The discharge hose has to be attached to the clips on the back of the appliance, as shown in the figure.

**!** These clips must not be removed as this may prevent normal washing.

**💡** Make sure the drain hose is not damaged.

**💡** If the discharge hose is not correctly attached, safe and correct appliance operation cannot be ensured.



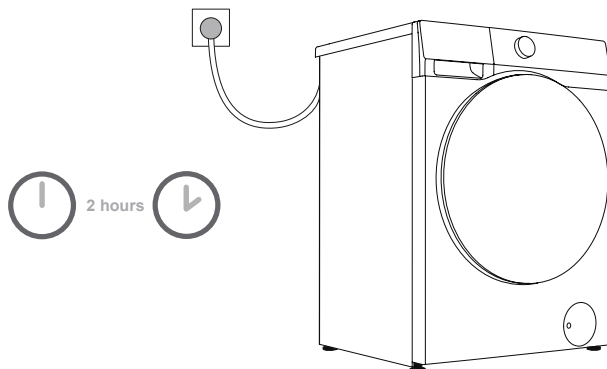

# CONNECTING TO POWER MAINS



 **Before connecting the appliance to the power mains, wait for at least 2 hours until it reaches room temperature.**

Connect the appliance to a grounded power socket. After installation, the socket should be freely accessible. The socket should be provided with grounding protection. Information on your appliance is indicated on the rating plate.

 **We recommend using over-voltage protection to protect the appliance in case of a lightning strike.**

-  The appliance may not be connected to the power mains using an extension cord.
-  Do not connect the appliance to a power socket intended for small loads.
-  Do not plug or unplug the appliance when your hands are wet.
-  Any repair and maintenance of the appliance should be performed by trained experts.
-  A damaged power cord may only be replaced by a person authorized by the manufacturer.

# Transportation after installation

 If you need to transport an installed device, first unplug the power plug, turn off the tap, remove the water inlet and drain hoses, and make sure the detergent box and door are closed.

Be sure to reinstall the transport bolts to prevent vibrations during transport from damaging the device (see "Installation and connection/removal of transport bolts"). If you accidentally lose the transport bolts, you can order them from the manufacturer.

Pack all packaging materials (plastic bags, other plastic parts, etc.).

 The device is heavy. Please use at least two people to move it. When transporting, do not hold protruding parts such as the door, top cover, etc., to prevent them from falling off or being damaged.

 After transport, let the device sit for at least 2 hours before connecting it to the power supply. The device should be installed and connected by trained technicians.

 Read the instructions carefully before connecting the device again. Damage caused by improper connection or use is not covered by the warranty.

## Transport and Handling Method

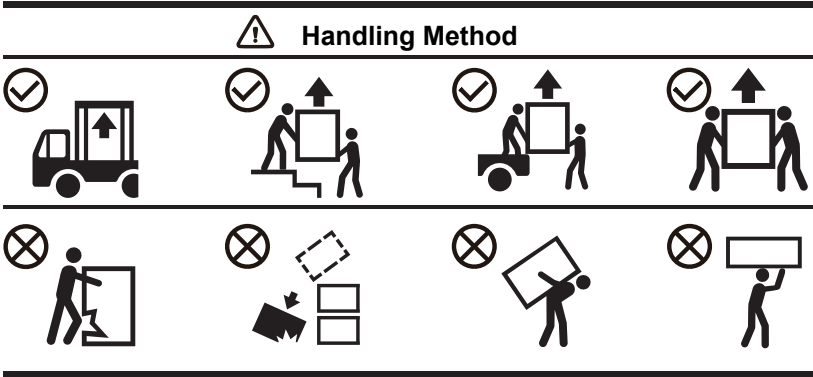

# BEFORE USING THE APPLIANCE FOR THE FIRST TIME



























## FIRST USE

This appliance has been tested at the factory and may contain a small amount of water residue. It is recommended to run a “Drum Clean” (or other high-temperature) program to remove any residual water from the drum.

● Connect the appliance to the power mains and open the water tap. There should not be any laundry in the drum. Select and start the program.

⚠ Do not use any solvents or cleaning agents that could damage the appliance (please observe the recommendations and warnings provided by the cleaning agent manufacturers).

## HEED THE LABELS ON THE LAUNDRY



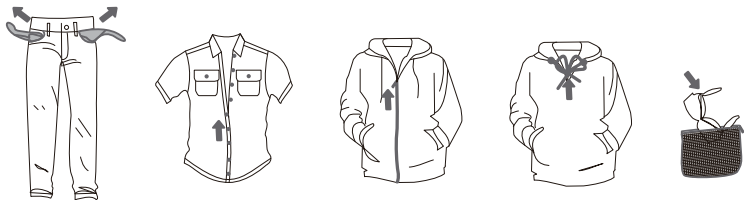

Washing	Max. washing temp. 95°C  	Max. washing temp. 60°C  	Max. washing temp. 40°C  	Max. washing temp. 30°C  	Hand wash only 	Do not wash 
Bleaching	Bleaching in cool water 			Bleaching not allowed 		
Dry cleaning	Dry cleaning with all agents 	Petroleum solvent R11, R113 	Dry cleaning in kerosene, pure alcohol, and R113 	Dry cleaning not allowed 		
Ironing	Hot ironing, max. 200°C 	Hot ironing, max. 150°C 	Hot ironing, max. 110°C 	Ironing not allowed 		
Drying	Dry flat (place on a flat surface) 	Drip dry  Line dry 	High temperature  Low temperature 	Do not tumble dry 		

## PREPARING THE WASHING PROCESS





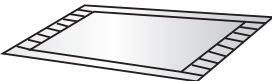



- Sort the laundry by type of fabric (cotton, blends, silk, wool, etc.), care label instructions, colour (white, coloured), and soiling.
- Empty pockets; remove metal items that may damage the laundry or appliance; fasten buttons and turn clothing with buttons or embroidery inside out; close all zippers; tie strings on clothing with drawstrings.
- Place sensitive clothes and small or lightweight items in a special-purpose laundry washing bag and wash them together with other laundry.
- Turn items prone to pilling or long-pile fabrics inside out before washing.
- Stains that are left for too long can be difficult to remove. Treat soiled areas such as cuffs and collars before washing (see chapter “Stain Removal Tips”).
- Do not wash heavy comforters, plush toys, or items in laundry washing bags separately in the drum to avoid imbalance alarms.





# NON-WASHABLE AND NON-DRYABLE LAUNDRY

 <p>Leather and fur products (risk of deformation)</p>	 <p>Rayon and its blended products (risk of discolouration or deformation)</p>	 <p>Large thick rubber cushions (risk of damage or malfunction)</p>
 <p>Hats with hard materials (risk of appliance damage and malfunction)</p>	 <p>Cushions, pillows, articles with cotton wadding, foam and other sponge materials, carpet covers (risk of damage or malfunction)</p>	<p>Others: Wrinkled or embossed clothes; coated down jackets; crepe fabrics; easily deformed clothes (suits, jackets, ties, dresses, etc.); easily fluffing clothes (velvet, cotton flannel).</p>

# NON-DRYABLE LAUNDRY (FOR TUMBLE DRYER MODELS)

 <p>Any laundry marked by graphic (risk of laundry damage)</p>	 <p>Wool clothes (risk of shrinkage or fur loss)</p>	 <p>Tights and stockings (risk of damage or deformation)</p>	 <p>Sizing clothes</p>
 <p>Cushions or clothes with furs (risk of damage or malfunction)</p>	 <p>Comforters (risk of damage or malfunction)</p>	 <p>Clothes with lace or embroidery, and new synthetic fibers (very fine fibers) (risk of deformation)</p>	 <p>Silk</p>

-  Non-washable and non-dryable laundry includes but is not limited to the above items.
-  Wet items that are still dripping are not suitable for tumble drying and may trigger an alarm.

# ADDING DETERGENT/SOFTENER

## DETERGENT DRAWER

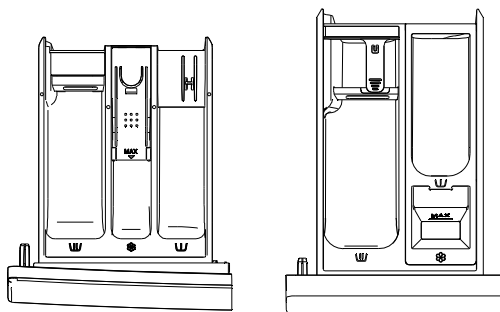

Type 1

Type 2

(The type of detergent drawer varies depending on the model.)

Detergent drawer	
	Prewash dispenser compartment
	Wash dispenser compartment
	Softener dispenser compartment

## PRECAUTIONS FOR USE

1. Always use a high-efficiency, neutral, low-foaming detergent suitable for this appliance. The amount of detergent depends on the type, soil level, laundry colour, and washing temperature. Please add the appropriate amount according to the detergent manufacturer's dosage instructions.
2. Excessive amount of detergent may result in foaming that in turn impairs washing efficiency. If excessive foam is detected, the appliance may pause the program for defoaming.
3. Using insufficient detergent may result in poor washing effect and could lead to scale buildup in the drum and water pipes.
4. We recommend adding powder detergent right before the wash cycle starts. If added in advance, ensure the detergent dispenser compartment is completely dry; otherwise, the powder detergent may harden and clump before the wash cycle starts.
5. Do not use liquid detergent when selecting the "Delay" or "Prewash" function (if available) as it will be dispensed immediately and may become sticky in the dispenser compartment or drum.
6. Do not allow detergent to harden, as this may lead to blockages, poor rinsing, or unpleasant odours.
7. Pour softener into the compartment marked with " and follow the usage recommendations on the softener packaging. Do not exceed the MAX line in the softener compartment, as this may cause premature release of softener, resulting in poor washing effect.
8. Keep detergent and softener out of reach of children.
9. Corrosive descaling agents may damage the appliance. Do not use solvents. Do not wash the laundry that was cleaned with solvents or flammable substances.
10. White residues (streaks etc.) on black laundry may appear if you are using modern phosphate-free detergents. In such case, brush the streaks and use a liquid detergent.
11. Before starting the program, gently close the detergent drawer. Forceful closing may cause detergent to spill into other dispenser compartments or to be dispensed too early into the drum. Be careful not to pinch your fingers when closing the drawer.
12. A small amount of water may remain in the dispenser compartment at the end of the program cycle.



## LOADING THE APPLIANCE

Open the appliance door, and insert the laundry loosely into the drum after making sure the drum is empty.

Close the appliance door. The door is closed when you here a click.

💡 Do not overload the drum! For maximum load, see "PROGRAM TABLE". If the appliance drum is too full, the laundry will not be washed as thoroughly.

💡 Ensure the laundry is completely placed into the drum to prevent it from getting caught in the door.

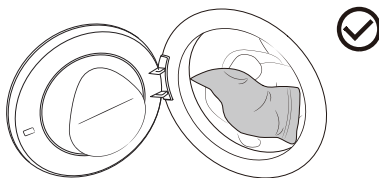
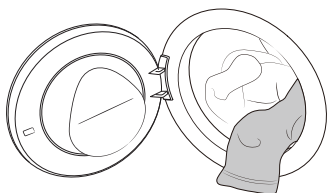

## CONTROL UNIT

[illegible]

Rotate the knob to select a programme.

Switch on/off the appliance.

Start/pause the programme.

Select the washing temperature.

This function can adjust the program's spin speed before the program starts.

This function allows you to favourite the current program. The favourite program can be prioritized for selection the next time you use it.

Press this button to select additional functions.

This function allows you to schedule laundry at your convenience.

Press both buttons simultaneously to enable/disable the child lock.

Press and hold these two buttons simultaneously to turn on/off the mute function.

# PROGRAM TABLE

Turn the main knob to select the appropriate program (According to the type of material and the degree of soiling ). During operation, the main knob will not turn automatically.

Program	Maximum load (kg)	Maximum speed (rpm)	Program description
<b>Cotton</b> (-- , 20°C, 30°C, 40°C, 60°C, 90°C)	7.5	1400	It is suitable for washing moderately or heavily soiled cotton or linen fabrics.
 <b>Cotton Eco</b> —	7.5	1400	It is suitable for washing cotton clothes with a normal degree of soiling.
<b>Delicates</b> (-- , 20°C, 30°C, 40°C)	2	600	It is suitable for machine-washable silk fabrics (see care label instructions). Softener is not recommended for this programme.
<b>Mixed</b> (-- , 20°C, 30°C, 40°C)	3	1400	It is suitable for washing lightly or medium soiled cotton or synthetic laundry.
<b>Wool</b> (-- , 20°C, 30°C, 40°C)	2	600	It is suitable for washing machine washable woolen clothes (refer to the laundry label requirements).
<b>Quick 15'</b> (-- ; 20°C, 30°C, 40°C)	1	800	It is suitable for washing a small amount of laundry or lightly soiled laundry. If you change the default setting, the washing time will be longer.
<b>Rinse+Spin</b> —	7.5	1400	This program is defaulted to two rinses and spin.
<b>Spin</b> —	7.5	1400	In this program, you can select the duration and spinning rate manually.
<b>Drum Clean</b> (90°C)	/	800	The program is used for cleaning the drum and removing any residues of detergent and bacteria that can accumulate and develop especially when you use programmes with low washing temperatures. The drum has to be empty.Run this programme at least once a month.
<b>Bedding</b> (-- , 20°C, 30°C, 40°C, 60°C)	2	1400	It is suitable for washing large-sized clothes, such as curtains, sheets, quilt covers, etc.
<b>Downwear</b> (-- , 20°C, 30°C, 40°C)	2	600	Machine-washable items stuffed with synthetic fibres, such as pillows, quilts and bedspreads; also suitable for items stuffed with down.

Program	Maximum load (kg)	Maximum speed (rpm)	Program description
<b>Sportswear</b> (--, 20°C, 30°C, 40°C)	2.5	1000	It is suitable for washing sportswear and casual clothes made of microfiber fabrics.
<b>Dark Garment</b> (--, 20°C, 30°C, 40°C, 60°C)	3.5	1000	This program is suitable for washing machine-washable dark clothing.
<b>Baby Care Steam</b> (40°C, 60°C, 90°C)	2	1400	It is suitable for baby clothes and underwear, etc., sterilised and disinfected through high temperature steam. Softener is not recommended for this programme.
<b>Allergy Steam</b> (60°C)	2	1400	It is suitable for washing high-temperature-resistant and colorfast fabrics, especially for removing allergens such as pollen, dust mites, and parasites at high temperatures.

#### Australian performance testing procedure::

The program "' Cotton',Temp:40°C,Spin speed:1400rpm" is recommended for a normally soiled load equal to the rated load capacity.

#### NOTE

- 1) Water Temperature: Select the appropriate water temperature for chosen washing program. Always follow garment manufacturer's care label or instructions when washing to avoid damage to clothes.
- 2) Actual water temperature may differ from the declared cycle temperature.
- 3) The test results depend on water pressure, water hardness, water inlet temperature, room temperature, laundry type and amount of load, degree of soiling, utilized detergent, fluctuations in the power supply and chosen additional options.
- 4) Overloading the laundry during the washing cycle may reduce washing efficiency, as the appliance initially detects a lower weight and uses less water. Insufficient water may also cause damage to the laundry and extend the washing time.
- 5) Drum Clean (if available): Make sure the drum is empty before using the Drum Clean program. It is recommended to run this program at least once a month.
- 6) When descaling, only use descaling agents with added anti-corrosion protection. (Only use non-corrosive descaling agents. Follow the manufacturer's instructions.) Finish the descaling process by running "Drum Clean" (or other high-temperature) programs several times in order to remove any residual descaling agent. It is recommended to descale at least once every six months.

 The maximum or nominal load applies to laundry prepared pursuant to the IEC 60456 standard.

 For better washing effect, we recommend loading the drum to 2/3 when using the cotton programs.

## OTHER SETTINGS AND FUNCTIONS

Most programmes feature basic settings, but these settings can be changed. Adjust the settings by pressing the relevant function button (before pressing the START/PAUSE button).

Certain settings cannot be selected with some programmes. Such settings will not be lit, and when the corresponding button is pressed, an acoustic signal will be emitted (see FUNCTION TABLE).

The additional settings and functions can only be set in the standby mode, that is, before the programme starts running, and cannot be selected after the programme runs.

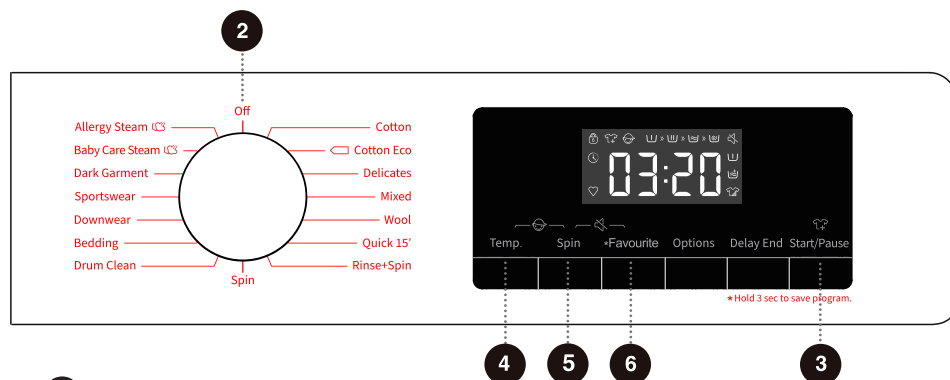

### 2 Power

Switch on/off the appliance.

If you need to switch off the appliance during the programme operation, rotate the programme selector knob to "Off" switch it off.

In the standby state or after the programme ends, the appliance will automatically shut down if no operations are performed for a period of time.

### 3 Start/Pause

Start/pause the programme.

If the door is not closed or locked, an alarm will be displayed on the screen after pressing "Start".

### 4 Temp.

Change the temperature for the selected programme.

Each programme has a preset temperature. Press this button before starting the programme to display the current set temperature. Press it again to scroll through the preset temperature values (--indicates cold wash).

The heating temperature can vary by programme.

### 5 Spin

This function can adjust the program's spin speed before the program starts. Press this button to display the current spin speed for the first time. Continue pressing to make a selection in the cycle of the set modes.

### 6 \*Favourite ♥

This function can favourite the current program. When used for the first time, it will default to the "Cotton" program and its default parameters.

After selecting a program and setting various parameters to start it, press and hold this button to favourite the current program. The favoured and saved parameters can be memorized, and at this time, the function icon "♥" lights up.

When the icon "♥" is not lit up, press this button, and the program will switch to the last memorized program, and the parameters will automatically switch to the last memorized program parameters. If you switch programs or press other buttons, the screen will show the new program and parameters, and the "♥" icon will turn off.

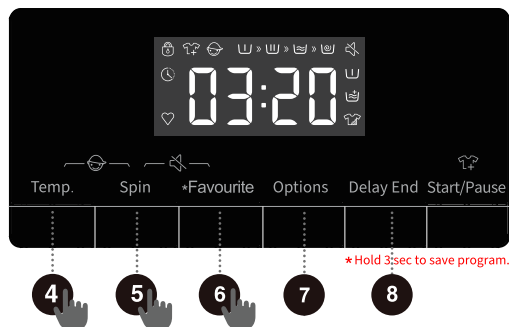

## 7 Options

Press this button to select additional functions of the current program. Each press can only set one function. After the function is selected, the corresponding icon lights up or flashes.

### Pre-wash

This function can add a prewash process before the main wash phase to enhance the washing effect. When you select the prewash function, please add detergent to the prewash compartment of the detergent box.

### Extra Rinse

This function can add an extra rinse time to a program.

### Intensive

This function can increase the washing time and enhance the washing intensity.

## 8 Delay

Schedule washing at a convenient time.

After selecting the program and function, make a delay end schedule. Press this button to start the delay end schedule, and press it again to make a selection in the cycle of the set time gears. Each time you press it, the time changes by 1 hour. The longest time you can select is 24:00.

The Delay time is the end time of the programme, that is, it includes the entire programme running time. So, the Delay time must be greater than the programme running time.

When the Delay function is activated, the "  " icon on the screen flashes. Once the Delay function is finished, the icon goes out.

If the Delay function is selected before the programme starts, it can be disabled by choosing a different programme or function.

To disable the Delay function after the programme starts, the appliance must be switched off and restarted.

## 4 + 5 Child Lock

The appliance features a child lock to prevent accidental operation by children and ensure their safety.

Press and hold the "Temp.+Water Level" buttons simultaneously to activate the Child Lock, indicated by the illuminated child lock icon "  ". Repeat the same operation to deactivate the child lock.

When the Child Lock is set, all buttons except the power button are locked.

After completing programme, the child lock will be automatically released.

## 5 + 6 Mute

This function shields other sounds except the alarm sound and reduces noise.

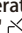
When the device is in standby, pause, or operating state, press and hold the "Spin+\*Favourite" buttons simultaneously, and the mute icon "  " lights up, and the mute function is turned on.

The same operation can be used to turn off the mute function, and all sounds will be turned back on.

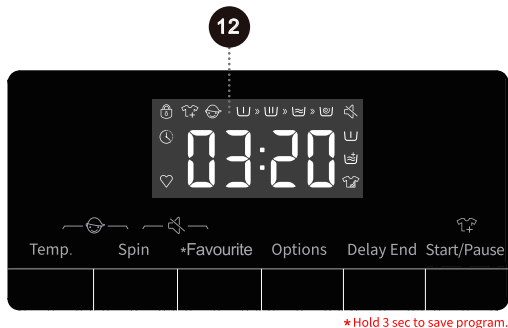



★ Hold 3 sec to save program.

12

## Display

It is used to display the remaining time, delay end time, fault code, and other related information of the program.

### Icon description

	It is an icon for the door lock indicator. When this icon lights up, the device door is locked. Do not force the door open at this time to avoid causing injury.
	It is an icon for adding clothes midway. When this icon lights up, it indicates that you can open the door to add clothes.

# FUNCTION TABLE

Program	Temp.	Spin	*Favourite	Pre-wash	Extra Rinse	Intensive	Delay End	Child Lock	Mute
Cotton	•	•	•	•	•	•	•	•	•
◁ Cotton Eco	-	•	•	-	-	-	•	•	•
Delicates	•	•	•	-	•	-	•	•	•
Mixed	•	•	•	•	•	•	•	•	•
Wool	•	•	•	-	•	-	•	•	•
Quick 15'	•	•	•	-	•	-	•	•	•
Rinse+Spin	-	•	•	-	•	-	•	•	•
Spin	-	•	•	-	-	-	•	•	•
Drum Clean	-	-	•	-	-	-	•	•	•
Bedding	•	•	•	•	•	•	•	•	•
Downwear	•	•	•	-	•	-	•	•	•
Sportswear	•	•	•	•	•	•	•	•	•
Dark Garment	•	•	•	•	•	•	•	•	•
Baby Care Steam	•	•	•	•	•	•	•	•	•
Allergy Steam	-	•	•	•	•	•	•	•	•

- Optional functions
- Non-optional functions



## STARTING PROGRAMME

Once you have selected the programme and extra functions, and added the detergent into the detergent drawer, press the "Start/Pause" button to start the programme.

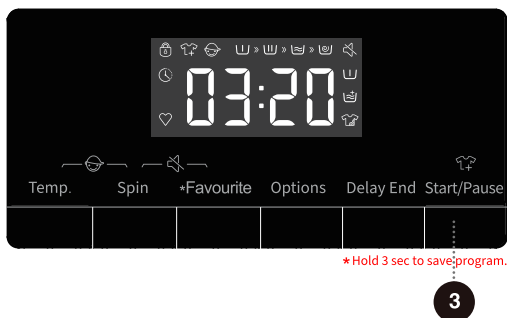

Once you have pressed the Start/Pause button, you cannot change any settings except to enable/disable Child Lock and Mute (if available) and adjust the Water Level (if available).

When the programme starts, "----" appears on the screen to indicate that the laundry is being weighed. After the start of the programme has started, the icon "🔒" is lit on the screen. When the programme is completed, the icon disappears. If you press the "Start/Pause" button during the programme operation, and all conditions are met for you to open the door, the icon "🔒" will go out as well.

If this icon does not disappear, this means that the door cannot be opened. In such case, do not attempt to open the door by force.

💡 If the time on the screen flashes when the programme is paused, check to ensure the door is properly closed, and press the "Start/Pause" button to resume the programme.

## ENDING PROGRAMME

An acoustic signal will indicate the end of the programme. The display will read "End". The appliance will automatically shut down if no operations are performed for a period of time.

1. Switch off the appliance.
2. Close the water tap.
3. Unplug the power cord from the socket.
4. Close the appliance door.
5. Take the laundry from the drum.

💡 Some programs automatically detect the laundry weight before washing and adjust the program duration accordingly.

# INTERRUPTIONS AND CHANGING THE PROGRAM

## INTERRUPTION THE PROGRAM

To stop or cancel the program during operation, you must switch off the appliance.

## CHANGING THE PROGRAM

To change the program during operation, switch the appliance off and on again, select the desired program and extra functions, then press the **"Start/Pause"** button to start the new program.

## PAUSE THE PROGRAM

The program can be paused at any time during program operation by pressing the **"Start/Pause"** button. When the program is paused/flashing for the rest of the time on the display, the program is paused. If the following conditions are met, the door lock will be automatically unlocked and the door can be opened.

1. The temperature in the drum must be lower than the set safety value;
2. The water level in the drum must be lower than the set safety value.

To resume the program, please close the door first, and then press the **"Start/Pause"** button. The washing/drying program is paused, and when it is restarted, the program will continue to run from where it was interrupted. The spin program is paused, and when it is restarted, the program will start from the beginning of the spin cycle.

## ADD CLOTHES

If you need to add clothes during program operation, press the **"Start/Pause"** button, the program will be paused, and the program on the display will pause/flash for the rest of the time. If the safety conditions are met, the door lock will be automatically unlocked, and the door lock icon will go out (the **"Add Clothes"** icon "🔒" will light up for some models), you can open the door to add clothes. If the door lock icon does not go out, the door opening conditions are not met and you cannot add clothes midway.

 If a significant amount of extra laundry is added during washing and the water level is insufficient, the cleaning effectiveness may decrease, as the appliance calculates water intake based on the initial weight of the laundry. Insufficient water may also cause damage to the laundry due to friction, and the washing time will be extended.

## FAULT

In case of a fault, the program will be interrupted.

Flashing signal lights and an acoustic signal will warn about such occurrence (see chapter **FAULT CODES AND TROUBLESHOOTING**), and the fault code (F: XX) will be indicated on the screen.

## POWER SUPPLY FAILURE

In case of a power supply failure (power outage), the washing program is interrupted. When power supply is restored, the program is resumed from the point where it was interrupted.

 **If there is still water in the appliance after a power outage, do not open the door until you have manually drained the water using the pump filter.**

# EMERGENCY DOOR OPENING

In case of failure to open the door due to power outage or other special circumstances, the door lock lever at the pump cover can be used for emergency opening.

## ⚠ NOTE:

1. Do not use this function when the appliance is working normal
2. Before use, ensure that the inner drum has stopped spinning, the temperature is safe, and the water level is below the laundry inlet. If the water level exceeds the laundry inlet, drain off water through the drain hose (if fitted) or by slowly unscrewing the pump filter.
3. Operation method: Open the pump cover and use a tool to pull down the door lock lever. The door can then be opened (as shown in the figure). Return the door lock lever to its original position after opening the door.

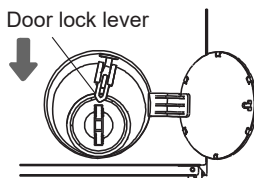

# MAINTENANCE AND CLEANING

 Regular maintenance can extend the service life of the appliance. Before maintenance, unplug the appliance from the power mains and close the water tap.

 Children should not clean the appliance or perform maintenance tasks without proper supervision.

## CLEANING THE DETERGENT DRAWER

 Clean the detergent drawer regularly.

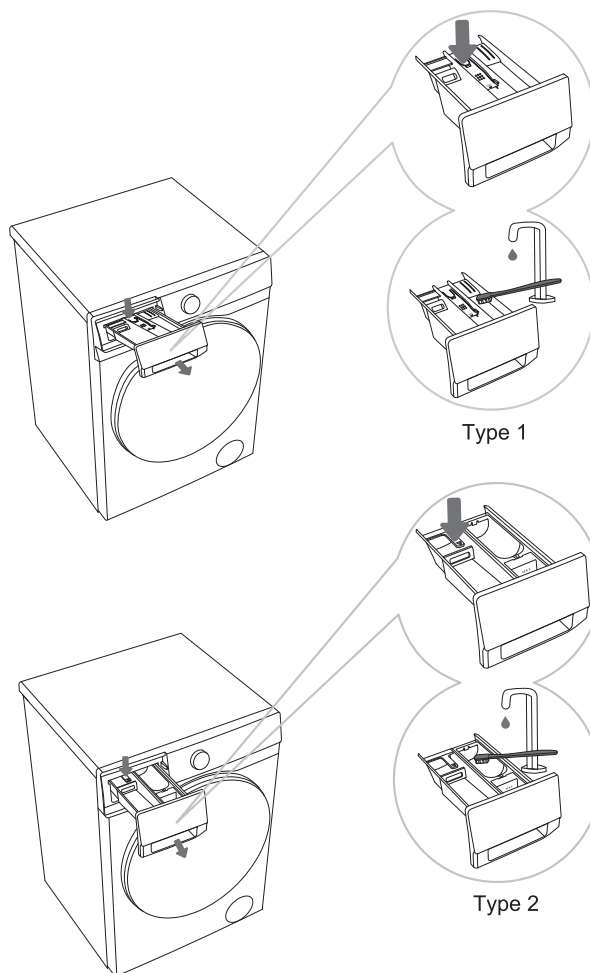

**1** Pull out the detergent box. Press the small tab in the detergent box to pull out the detergent box. (Refer to the position indicated by the arrow in the left figure.)

**2** Gently bend the main wash compartment of the detergent box by hand to slightly deform it, and remove the baffle and roller.

 When installing the roller, please ensure that the positioning posts at both ends of the roller match the positioning holes of the detergent box.

 Do not place the detergent box in the dishwasher for washing.

## CLEANING THE WATER SUPPLY HOSE, DETERGENT DISPENSER HOUSING, AND RUBBER DOOR GASKET

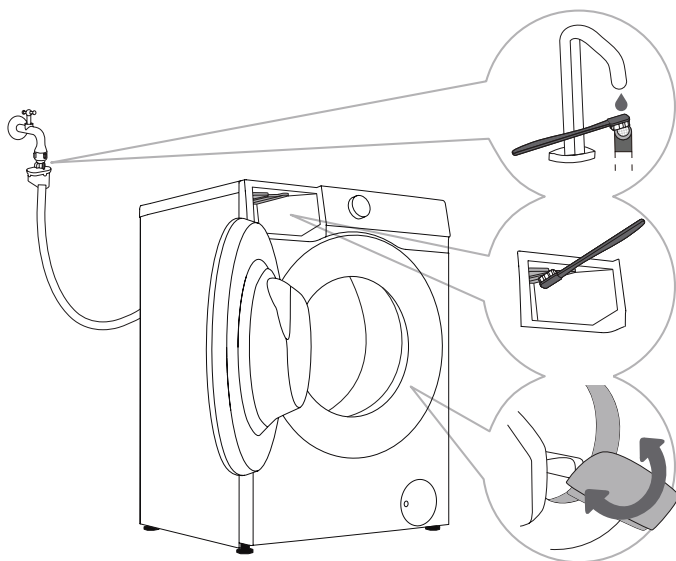

**1** Clean the water supply hose filter regularly.

**2** Use a brush to clean the entire detergent dispenser housing, especially the nozzles on the top.

**3** After every wash, wipe the rubber door seal to extend its life cycle. To prevent mould growth on the seal, leave the door slightly open after washing to allow moisture to evaporate before closing the door.

# CLEANING THE PUMP FILTER

 Water may be spilled when cleaning the pump filter. It is therefore recommended to place an absorbent cloth on the floor.

Make sure the water has cooled down before you release it from the appliance.

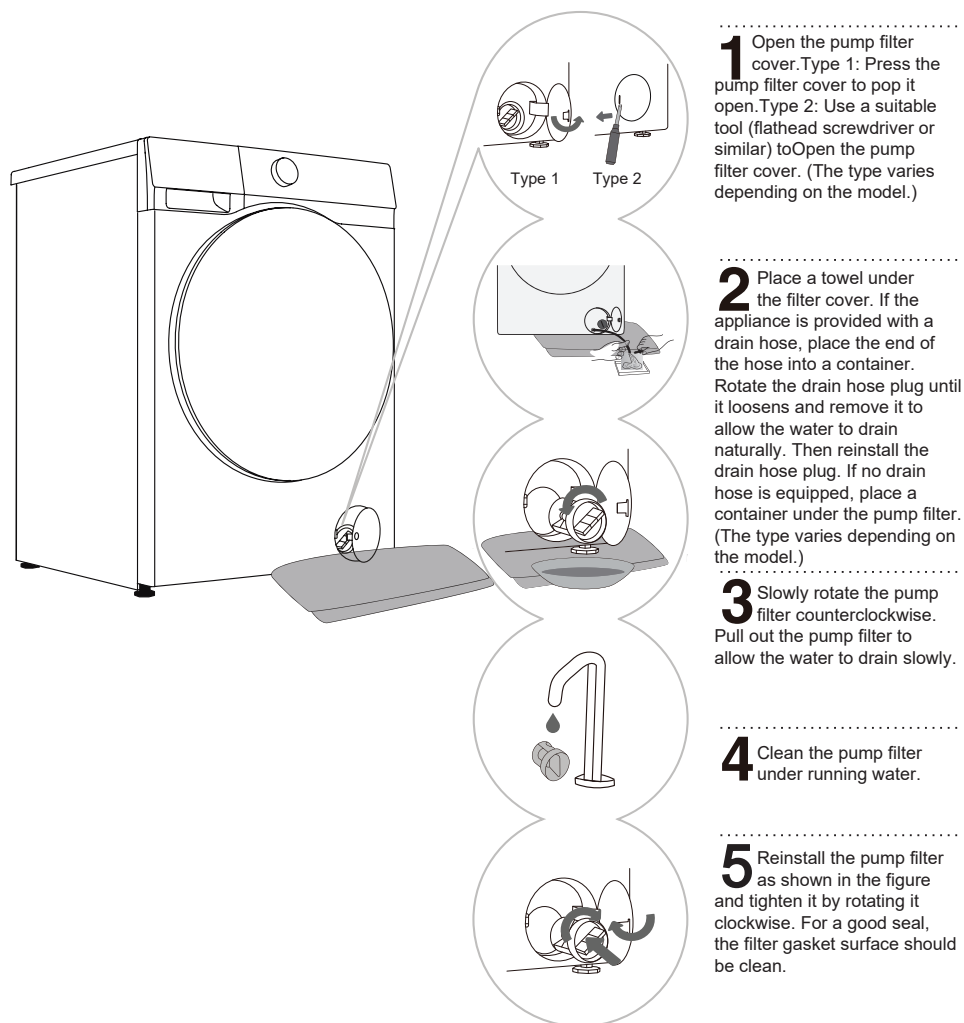

 The pump filter must be timely cleaned, especially after washing very fleecy, woolly, or very old laundry.

 Also clean the pump filter if the appliance cannot start the spinning cycle or when there is debris in the pump (buttons, coins, hair pins or clips etc.).

 Do not open the pump filter while the appliance is running. Do not operate the appliance until the pump filter is securely installed to avoid leaks or malfunctions.

## CLEANING THE INLET FILTER

Check and clean the inlet filter regularly.  
Clean the inlet filter immediately if water supply is slow.  
Operation procedures are as follows:

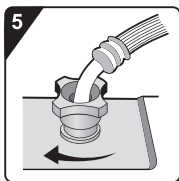
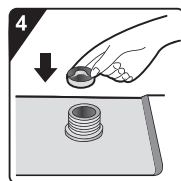
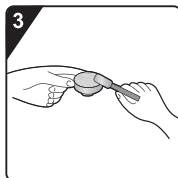
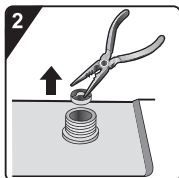
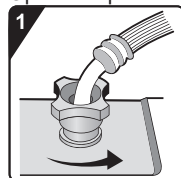

**1** Close the water tap and unscrew the water supply hose.

**2** Remove the inlet filter.

**3** Clean the inlet filter.

**4** Reinstall the inlet filter.

**5** Connect the water supply hose. Open the water tap and ensure there are no leaks at the connection.

 The inlet filter collects impurities and sediment from the water supply. It is recommended to clean it at least every six months, or more frequently if you have hard water or notice scale buildup.

## CLEANING THE EXTERIOR

 **Always disconnect the appliance from the power mains before cleaning.**

Clean the appliance exterior and display unit using a soft, damp cotton cloth and water. Then, use a soft, dry cloth to wipe the appliance dry.

 Do not use any solvents or cleaning agents that could damage the appliance (please observe the recommendations and warnings provided by the cleaning agent manufacturers).

Clean the appliance door with a damp cloth, and then wipe it dry with a soft, dry cloth.

 Do not use excessive water to clean the appliance.

# TROUBLESHOOTING

The appliance is equipped with a number of automatic safety features to detect faults and take effective safety measures in a timely manner.

These faults are usually minor and can be rectified quickly.

If the appliance cannot operate normally, a fault message will appear on the screen. Please refer to the warning message for the appropriate action.

**If the recommended troubleshooting methods do not resolve the problem, please contact after-sales service.**

The user will assume all liability for any consequences arising from repairs carried out by themselves or unauthorised personnel.

Fault phenomenon	Recommended countermeasures
<b>Machine fails to start</b>	<ul style="list-style-type: none"> <li>◇ Check whether the power cord is plugged into the socket and whether the socket is working functionally (by testing it with another appliance).</li> <li>◇ Check whether the door is properly closed.</li> <li>◇ Check whether the "Start/Pause" button is pressed.</li> </ul> <p><b>Machine stops during normal operation</b></p> <ul style="list-style-type: none"> <li>◇ Check whether door is properly closed. Close the door and press the "Start/Pause" button.</li> <li>◇ Check for excessive foam. The appliance may pause the program for defoaming. After the defoaming process, the appliance will automatically resume operation.</li> <li>◇ Check whether the safety protection has been activated.</li> </ul>
<b>Time displayed at the start of the program increases or decreases</b>	<p>This is the adaptive adjustment of the appliance to the factors that influence the washing time.</p> <ul style="list-style-type: none"> <li>◇ Excessive foam.</li> <li>◇ Unbalance caused by large laundry.</li> <li>◇ Extended heating time due to low water intake temperature.</li> </ul> <p>As a result of these factors, the remaining time displayed is recalculated and updated accordingly (if the appliance is making an unbalance adjustment, the time displayed remains unchanged). In addition, the appliance detects the load during the water supply and adjusts the program time accordingly (fuzzy control).</p>
<b>Residual detergent or other additives in the detergent drawer after washing</b>	<ul style="list-style-type: none"> <li>◇ Check whether the detergent drawer is correctly installed and kept clean.</li> <li>◇ Check whether the water pressure is normal and whether the inlet filter is clogged (see chapter "MAINTENANCE AND CLEANING").</li> </ul>
<b>Odour in the machine</b>	<ul style="list-style-type: none"> <li>◇ The odour may be caused by the rubber materials inside the appliance. It is the rubber smell, which dissipates after a few uses.</li> </ul>



The warranty does not cover the faults or failures resulting from external factors (lightning strike, power grid failures, natural disasters etc.).



Fault phenomenon	Recommended countermeasures
<b>Abnormal sound/noise during washing</b>	<ul style="list-style-type: none"> <li>◇ Foreign objects such as keys, coins or pins may have fallen into the drum. Stop the appliance and check for foreign objects in the drum. If noise persists after restarting, please contact after-sales service.</li> <li>◇ Laundry may be unevenly distributed in the drum. Pause the program, unlock the door, and redistribute the laundry.</li> </ul>
<b>Intense vibrations during spinning</b>	<ul style="list-style-type: none"> <li>◇ Check whether the appliance is level and whether all four feet are firmly seated on the floor.</li> <li>◇ Check whether the transport screw/rods have been removed. Transport screw/rods must be removed before using the appliance.</li> <li>◇ Check whether all foam supports have been removed from the bottom of the appliance.</li> </ul>
<b>Poor spinning effect</b>	<p>The appliance is equipped with a balance detection and correction system. After detecting unbalance caused by heavy laundry (e.g., bathrobes) and several spinning attempts, the system automatically reduces the spinning rate or even stops the spinning process to protect the appliance.</p> <ul style="list-style-type: none"> <li>◇ If the laundry is still very wet after spinning, take the laundry out of the drum, shake it loose, and then select the spinning program again.</li> <li>◇ Excessive foam may impair the spinning effect. Make sure to use an appropriate amount of low-foaming detergent.</li> <li>◇ Check whether the spinning rate is set to "0" or "No Spin".</li> </ul>
<b>Water leakage</b>	<ul style="list-style-type: none"> <li>◇ Leak from the water supply hose. Check the connection between the tap and the water supply hose connector for leaks. If there is a leak, wrap sealing tape around the end of the tap or replace the tap. It is recommended to check the connection between the water supply hose connector and the inlet valve for tightness. Tighten the connection to eliminate leaks.</li> <li>◇ Leak from the drain hose. For top-drain models, the drain hose clips must not be removed as this will result in a continuous water discharge.</li> <li>◇ Leak from the detergent drawer. The detergent drawer is not closed tightly. Push the handle to close the detergent drawer tightly.</li> <li>◇ Leak from the door seal. Check the door seal for foreign objects and clean if necessary.</li> </ul>
<b>Wrinkled laundry</b>	<ul style="list-style-type: none"> <li>◇ The laundry is not removed promptly from the drum. After the wash cycle is completed, remove the laundry from the drum promptly.</li> <li>◇ The appliance is overloaded. The drum should not be full of laundry and the door should be easy to close.</li> <li>◇ The spinning rate is too high. Set a suitable spinning rate for the type of laundry.</li> </ul>

# DRY FAULT (FOR TUMBLE DRYER MODELS)

Fault phenomenon	Recommended countermeasures
<b>appliance does not carry out drying process</b>	<ul style="list-style-type: none"><li>◇ Check whether the drying program is set up.</li><li>◇ Check whether the water tap is unopened.</li><li>◇ Check whether the door is properly closed.</li><li>◇ Check whether the load is excessive (see PROGRAM TABLE for capacity requirements), and take out part of the laundry to dry again.</li></ul>
<b>Poor drying effect</b>	<ul style="list-style-type: none"><li>◇ Check whether the load is excessive. If so, it will cause unsatisfactory drying effect and increased wrinkling. Separate the laundry in the drum for individual drying.</li><li>◇ Check if heavier items (e.g., thick cotton) are mixed with lighter ones (e.g., synthetic fabrics).</li><li>◇ Dry laundry separately by type.</li></ul>
<b>Excessive drying time</b>	<ul style="list-style-type: none"><li>◇ Check whether the load is excessive (see PROGRAM TABLE for capacity requirements), and take out part of the laundry to dry again.</li><li>◇ Laundry is not sufficiently spun (see section "Poor spinning effect" for guidance).</li><li>◇ A large amount of thicker laundry (e.g., jeans).</li></ul>
<b>Odour during drying</b>	<ul style="list-style-type: none"><li>◇ Using detergents or softeners with strong chemical odours may cause odours during drying.</li><li>◇ If the appliance is not thoroughly cleaned, residual dirt may produce odours while drying. Clean the appliance regularly (see chapter "MAINTENANCE AND CLEANING") and promptly remove laundry after drying.</li></ul>

# FAULT CODES AND TROUBLESHOOTING

If the unit is not operating normally and the following codes are displayed, this may not indicate a fault. Please refer to the FAULT CODES for appropriate action.

Problem/Fault	Description	What to do?
<b>F01</b>	<b>Water inflow fault</b>	Check the following: 1. Is the water tap is open? Is the pressure too low? 2. Is the water supply hose pinched? 3. Is the Inlet filter clogged? 4. Is the water supply hose frozen? After troubleshooting is finished, press the "Start/Pause" button to continue operation.
<b>F03</b>	<b>Water discharge fault</b>	Check the following: 1. Is the drain hose pinched? Does the water flow through the hose? 2. Is the filter on the drain hose clogged? 3. Is the drain hose frozen? After troubleshooting is finished, press the "Start/Pause" button to continue operation.
<b>F24</b>	<b>Overflow</b>	Pause and restart the program. If the appliance continues to overflow, close the water tap and contact a service technician.
<b>F13</b>	<b>Door locking fault</b>	Door is closed, but it cannot be locked. Switch the appliance off and on again. Then restart the washing program. If the fault persists, contact a service technician.
<b>F14</b>	<b>Door unlocking fault</b>	Door is closed, but it cannot be unlocked. Switch the appliance off and then back on. If the fault persists, contact a service technician.
<b>Other</b>	<b>Electronic module fault</b>	Switch the appliance off and then back on. Restart the washing program. If the fault persists, contact a service technician.
<b>Unb</b>	<b>Unbalance alarm</b>	Unbalance alarm shall be solved by the following methods: 1. Laundry tangling If the laundry is tangled, first switch off the appliance, open the door, shake the laundry loose and put it back in the drum. Then close the door and select the spinning program again. 2. Underweighted laundry Switch off the appliance, open the door and load additional laundry (or one or two towels). Then close the door and select the spin program again.
<b>F15-F18</b>	<b>Abnormal drying (for tumble dryer models)</b>	Switch the appliance off and then back on.

# SERVICING

## BEFORE CALLING A SERVICE TECHNICIAN

When you contact the service centre, please specify your appliance model.

The model, code / ID, type and serial number are indicated on the nameplate of the appliance.



In case of a defect, only use spare parts approved by authorised manufacturers.



Repairs or warranty claims due to incorrect connections or misuse of the appliance are not covered by the warranty. In such cases, the cost of repair shall be borne by the user.

## USAGE RECOMMENDATIONS

When washing colored clothes for the first time, wash them separately by color.

Wash heavily soiled laundry in smaller amounts, with increased powder detergent or a Prewash cycle (if available). Apply a special-purpose stain remover on stubborn stains before the wash. We recommend referring to “stain removal tips”.

If you often wash laundry at low temperatures and with liquid detergents, bacteria may develop and cause odour in the appliance. To prevent such odour, we recommend running “Drum Clean” (or other high-temperature programs) from time to time.

We recommend avoiding washing very small amounts of laundry as this will lead to excessive use of energy and poor appliance performance.

Loosen any folded or tangled laundry before putting it into the drum.

Only use detergents for appliance.

If water hardness exceeds 14°dH, water softener should be used. Heater damage resulting from incorrect use of water softeners shall not be covered by the warranty. Check the information on water hardness with your local water supply company or authority.

Use of chlorine-based bleaches is not recommended as they can damage the heater.

If you use a descaling agent, bleach, or dye, only use the kind that is suitable for use in the appliance.

Do not use solvents or similar chemicals (e.g., paint thinner, turpentine, gasoline).

Do not add hardened lumps of powder detergent into the detergent dispenser as this may clog the piping in the appliance.

Powder or liquid detergent should be added according to the manufacturer's instructions, washing temperature, and selected program.

When using concentrated liquid laundry care products, we recommend diluting them with water to prevent clogging the detergent drawer drain.

Liquid detergent is suitable for washing program without a prewash cycle.

Exercise caution to avoid mixing detergent and softener.

At higher spinning rates, there will be less residual moisture in the laundry. As a result, drying in a tumble dryer will be more economical and faster.

# STAIN REMOVAL TIPS

Before using special-purpose stain removers, try using the natural methods that do not harm the environment on less stubborn stains. However, timely treatment makes stain removal easier!  
Remove stains by rinsing with cold (lukewarm) water - but never with hot water!

Stains	Stain removal
Mud	When the stain is dry, first scrape it off the laundry before washing it in the appliance. If the stain is stubborn, soak it with an enzyme-based stain remover before the wash. If the stain is not stubborn, wash the laundry with liquid or powder detergent and water before the wash.
Antiperspirant	Before washing in the appliance, apply liquid detergent onto the laundry. Apply stain removers on any stubborn stains. Alternatively, use oxygen-based bleach for the wash.
Tea	Soak or rinse the laundry in cold water and add stain remover if necessary.
Chocolate	Soak or rinse the laundry with lukewarm soapy water. Then, apply lemon juice and rinse.
Ink	Before washing in the appliance, apply stain remover on the stain. You may also use denatured alcohol. Turn the laundry inside out and place a paper towel under the stain. Use the alcohol on the back side of the stain. At the end of the process, thoroughly rinse the laundry.
Felt tip pens	Dilute some starch in water and apply it to the stain. When it dries, scrape it off with a brush. Then, put the laundry into the appliance to wash.
Baby (urine, mud, food stains)	Before washing in the appliance, soak the stains in lukewarm water for at least half an hour. For easier stain removal, add an enzyme-based stain remover.
Grass	Before washing in the appliance, soak the laundry in an enzyme-based stain remover. Grass stains can also be removed by soaking (for approx. 1 hour) in diluted lemon juice or distilled vinegar.
Egg	Soak the laundry in an enzyme-based stain remover. Soak in cold water for at least 30 minutes, or a few hours if the stains are stubborn. Then, wash in the appliance.
Coffee	Soak the laundry in salt water. If the stain is not fresh, soak it with a mixture of glycerine, ammonia and alcohol.
Shoe polish	Apply cooking oil to the stain and rinse.
Blood	Fresh stain - Rinse the laundry with cool water and wash it in the appliance. Dried stain - Soak the laundry in an enzyme-based stain remover. Then, wash in the appliance. If the stain does not vanish, try to remove it with a bleach suitable for your laundry.

Stains	Stain removal
Glue, chewing gum	Place the laundry in a bag and put it in the freezer until the stain hardens. Then remove it with a blunt knife. Dilute the stain with a prewash stain remover and rinse thoroughly. Finally, wash the laundry in the appliance.
Makeup	Use a stain remover for the prewash, then wash in the appliance.
Butter	Before washing in the appliance, apply stain remover onto the laundry. Then, rinse with hot water (as hot as the fabric allows).
Milk	Soak the laundry in an enzyme-based stain remover. Soak for at least 30 minutes, or a few hours if the stains are stubborn. Then, wash in the appliance.
Fruit juice	Apply a mixture of salt and water on the stain. Leave to take effect for a while, then rinse. You can apply sodium bicarbonate, distilled vinegar or lemon juice on the stain before washing in the appliance. For old stains, use glycerine. After 20 minutes, rinse with cold water. Finally, wash the laundry in the appliance.
Wine	Soak the laundry in cold water for at least 30 minutes. Also, use a stain remover. Then, wash in the appliance.
Wax	Put the laundry into the freezer until the wax hardens. Then, scrape it off. Remove the remaining wax by placing a paper towel onto the stain, and then heat it with an iron until the paper absorbs the wax.
Sweat	Before washing in the appliance, rub liquid detergent thoroughly into the stain.
Chewing gum	Put the laundry into the freezer until the chewing gum hardens. Then, wash in the appliance.

# DISPOSAL



Packaging is made of environmentally friendly materials that can be recycled, disposed of, or destroyed without any hazard to the environment. To this end, packaging materials are labelled appropriately.

The symbol on the product or its packaging indicates that the product should not be treated as normal household waste. Take the product to an authorised collection centre for waste electric and electronic equipment processing.

When disposing of the appliance at the end of its useful life, remove all power cords, and destroy the door latch and switch to prevent the door from locking or latching, and to prevent children or small animals from becoming trapped inside and causing a hazard.

This appliance is marked according to the European directive on waste (WEEE).

Correct disposal of the product will help prevent any negative effects on the environment and health of people, which could occur in case of incorrect product removal. For detailed information on removal and processing of the product, please contact the relevant municipal authority in charge of waste management, your household waste disposal service, or the store where you bought the product.

