

R36XLMW10



IMPORTANT!

It is essential that you read the instructions in this manual before assembling, operating, and maintaining the product.

Subject to technical modification.

Safety, performance, and dependability have been given top priority in the design of your cordless lawnmower.

INTENDED USE

The cordless lawnmower is intended for outdoor use only.

The product is designed for domestic lawn mowing. It is a pedestrian-controlled walk-behind lawnmower designed to be pushed by hand.

The product should never be operated with the wheels off the ground. It should not be pulled or ridden on.

Do not use the product for any other purpose.

GENERAL PRODUCT SAFETY WARNINGS

⚠ WARNING! Read all safety warnings, instructions, illustrations and specifications provided with this power tool. Failure to follow all instructions listed below may result in electric shock, fire and/or serious injury.

Save all warnings and instructions for future reference.

The term "power tool" in the warnings refers to your mains-operated (corded) product or battery-operated (cordless) product.

WORK AREA SAFETY

- **Keep work area clean and well lit.** Cluttered or dark areas invite accidents.
- **Do not operate power tools in explosive atmospheres, such as in the presence of flammable liquids, gases or dust.** Power tools create sparks which may ignite the dust or fumes.
- **Keep children and bystanders away while operating a power tool.** Distractions can cause you to lose control.

ELECTRICAL SAFETY

- **Power tool plugs must match the outlet. Never modify the plug in any way. Do not use any adapter plugs with earthed (grounded) power tools.** Unmodified plugs and matching outlets will reduce risk of electric shock.
- **Avoid body contact with earthed or grounded surfaces, such as pipes, radiators, ranges and refrigerators.** There is an increased risk of electric shock if your body is earthed or grounded.
- **Do not expose power tools to rain or wet conditions.** Water entering a power tool will increase the risk of electric shock.
- **Do not abuse the cord. Never use the cord for carrying, pulling or unplugging the power tool.** Keep cord away from heat, oil, sharp edges or moving parts. Damaged or entangled cords increase the risk of electric shock.
- **When operating a power tool outdoors, use an extension cord suitable for outdoor use.** Use of a

cord suitable for outdoor use reduces the risk of electric shock.

- **If operating a power tool in a damp location is unavoidable, use a residual current device (RCD) protected supply.** Use of an RCD reduces the risk of electric shock.

PERSONAL SAFETY

- **Stay alert, watch what you are doing and use common sense when operating a power tool. Do not use a power tool while you are tired or under the influence of drugs, alcohol or medication.** A moment of inattention while operating power tools may result in serious personal injury.
- **Use personal protective equipment. Always wear eye protection.** Protective equipment such as a dust mask, non-skid safety shoes, hard hat or hearing protection used for appropriate conditions will reduce personal injuries.
- **Prevent unintentional starting. Ensure the switch is in the off-position before connecting to power source and/or battery pack, picking up or carrying the tool.** Carrying power tools with your finger on the switch or energising power tools that have the switch on invites accidents.
- **Remove any adjusting key or wrench before turning the power tool on.** A wrench or a key left attached to a rotating part of the power tool may result in personal injury.
- **Do not overreach. Keep proper footing and balance at all times.** This enables better control of the power tool in unexpected situations.
- **Dress properly. Do not wear loose clothing or jewellery. Keep your hair and clothing away from moving parts.** Loose clothes, jewellery or long hair can be caught in moving parts.
- **If devices are provided for the connection of dust extraction and collection facilities, ensure these are connected and properly used.** Use of dust collection can reduce dust-related hazards.
- **Do not let familiarity gained from frequent use of tools allow you to become complacent and ignore tool safety principles.** A careless action can cause severe injury within a fraction of a second.

POWER TOOL USE AND CARE

- **Do not force the power tool. Use the correct power tool for your application.** The correct power tool will do the job better and safer at the rate for which it was designed.
- **Do not use the power tool if the switch does not turn it on and off.** Any power tool that cannot be controlled with the switch is dangerous and must be repaired.
- **Disconnect the plug from the power source and/or remove the battery pack, if detachable, from the power tool before making any adjustments, changing accessories, or storing power tools.** Such preventive safety measures reduce the risk of starting the power tool accidentally.
- **Store idle power tools out of the reach of children and do not allow persons unfamiliar with the power tool or these instructions to operate the power tool.** Power tools are dangerous in the hands of untrained users.

- **Maintain power tools and accessories.** Check for misalignment or binding of moving parts, breakage of parts and any other condition that may affect the power tool's operation. If damaged, have the power tool repaired before use. Many accidents are caused by poorly maintained power tools.
- **Keep cutting tools sharp and clean.** Properly maintained cutting tools with sharp cutting edges are less likely to bind and are easier to control.
- **Use the power tool, accessories and tool bits etc. in accordance with these instructions, taking into account the working conditions and the work to be performed.** Use of the power tool for operations different from those intended could result in a hazardous situation.
- **Keep handles and grasping surfaces dry, clean and free from oil and grease.** Slippery handles and grasping surfaces do not allow for safe handling and control of the tool in unexpected situations.

BATTERY TOOL USE AND CARE

- **Recharge only with the charger specified by the manufacturer.** A charger that is suitable for one type of battery pack may create a risk of fire when used with another battery pack.
- **Use power tools only with specifically designated battery packs.** Use of any other battery packs may create a risk of injury and fire.
- **When battery pack is not in use, keep it away from other metal objects, like paper clips, coins, keys, nails, screws or other small metal objects, that can make a connection from one terminal to another.** Shorting the battery terminals together may cause burns or a fire.
- **Under abusive conditions, liquid may be ejected from the battery; avoid contact. If contact accidentally occurs, flush with water. If liquid contacts eyes, additionally seek medical help.** Liquid ejected from the battery may cause irritation or burns.
- **Do not use a battery pack or tool that is damaged or modified.** Damaged or modified batteries may exhibit unpredictable behaviour resulting in fire, explosion or risk of injury.
- **Do not expose a battery pack or tool to fire or excessive temperature.** Exposure to fire or temperature above 130 °C may cause explosion.
- **Follow all charging instructions and do not charge the battery pack or tool outside the temperature range specified in the instructions.** Charging improperly or at temperatures outside the specified range may damage the battery and increase the risk of fire.

SERVICE

- **Have your power tool serviced by a qualified repair person using only identical replacement parts.** This will ensure that the safety of the power tool is maintained.
- **Never service damaged battery packs.** Service of battery packs should only be performed by the manufacturer or authorized service providers.

LAWNMOWER SAFETY WARNINGS

- **Do not use the lawnmower in bad weather conditions, especially when there is a risk of lightning.** This decreases the risk of being struck by lightning.
- **Thoroughly inspect the area for wildlife where the lawnmower is to be used.** Wildlife may be injured by the lawnmower during operation.
- **Thoroughly inspect the area where the lawnmower is to be used and remove all stones, sticks, wires, bones, and other foreign objects.** Thrown objects can cause personal injury.
- **Before using the lawnmower, always visually inspect to see that the blade and the blade assembly are not worn or damaged.** Worn or damaged parts increase the risk of injury.
- **Check the grass catcher frequently for wear or deterioration.** A worn or damaged grass catcher may increase the risk of personal injury.
- **Keep guards in place. Guards must be in working order and be properly mounted.** A guard that is loose, damaged, or is not functioning correctly may result in personal injury.
- **Keep all cooling air inlets clear of debris.** Blocked air inlets and debris may result in overheating or risk of fire.
- **While operating the lawnmower, always wear non-slip and protective footwear. Do not operate the lawnmower when barefoot or wearing open sandals.** This reduces the chance of injury to the feet from contact with the moving blade.
- **While operating the lawnmower, always wear long trousers.** Exposed skin increases the likelihood of injury from thrown objects.
- **Do not operate the lawnmower in wet grass. Walk, never run.** This reduces the risk of slipping and falling which may result in personal injury.
- **Do not operate the lawnmower on excessively steep slopes.** This reduces the risk of loss of control, slipping and falling which may result in personal injury.
- **When working on slopes, always be sure of your footing, always work across the face of slopes, never up or down and exercise extreme caution when changing direction.** This reduces the risk of loss of control, slipping and falling which may result in personal injury.
- **Use extreme caution when reversing or pulling the lawnmower towards you. Always be aware of your surroundings.** This reduces the risk of tripping during operation.
- **Do not touch blades and other hazardous moving parts while they are still in motion.** This reduces the risk of injury from moving parts.
- **When clearing jammed material or cleaning the lawnmower, make sure all power switches are off and the battery pack is disconnected.** Unexpected operation of the lawnmower may result in serious personal injury.
- **When clearing jammed material or cleaning the lawnmower, make sure all power switches are off and remove the isolator key.** Unexpected operation of the lawnmower may result in serious personal injury.

ADDITIONAL SAFETY WARNINGS

- The product must be started with the user behind the handlebars in the operator safety zone. Never start the product if:
 - The grass discharge opening is exposed and is not protected by the grass catcher or the grass discharge cover.
 - Hands and feet of all persons are not clear of the cutting enclosure.
- Avoid holes, ruts, bumps, rocks, property stakes, or other hidden objects. Uneven terrain could cause a slip-and-fall accident.
- Power off the product, remove the isolator key and the battery pack, and allow the blade to stop if the product has to be tilted for transportation, when crossing surfaces other than grass, and when transporting the product to and from the work area.
- Do not tilt the product when powering it on or while it is running. If absolutely necessary, you may raise the front of the product by no more than 5 cm to enable easier starting. Press down on the handlebar to raise the front of the product. Always return the product to its normal position with all the wheels on the ground before cutting. Tilting the product exposes the blade and increases the probability of objects being thrown and accidentally making contact with the blade.
- Power off the product, and remove the isolator key and the battery pack. Make sure that all moving parts have come to a complete stop:
 - before leaving the product unattended (including disposal of grass clippings)
 - before clearing blockages or unclogging the discharge chute
 - before checking, cleaning, or working on the product
 - before removing the grass catcher or opening the grass discharge cover
 - after striking a foreign object; inspect the product for damage and make repairs as necessary before restarting and operating the product
 - whenever the product starts to vibrate abnormally (check immediately)
 - inspect for damage, particularly the blades
 - replace or repair any damaged parts
 - check for and tighten any loose parts
- Always ensure that the motor control cable is never trapped, pinched, or otherwise damaged during assembly or when folding the handle. Never apply power to the product if this cable is damaged.
- Injuries may be caused, or aggravated, by prolonged use of the product. When using the product for prolonged periods, ensure to take regular breaks.
- Operate the product only in temperatures between 0 °C and 40 °C.

ADDITIONAL BATTERY SAFETY WARNINGS

- To reduce the risk of fire, personal injury, and product damage due to a short circuit, never immerse the product, battery pack, or charger in fluid or allow fluid to flow inside them. Corrosive or conductive fluids, such as seawater, certain industrial chemicals, and bleach or bleach-containing products, etc., can cause a short circuit.

- Charge the battery pack in a location where the ambient temperature is between 10 °C and 38 °C.
- Store the battery pack in a location where the ambient temperature is between 0 °C and 20 °C.
- Use the battery pack in a location where the ambient temperature is between 0 °C and 40 °C.

PRODUCT FEATURES

OVERLOAD AND OVERHEAT PROTECTION

The product has an overload protection device. When overloading is detected, the product automatically powers off. If the overload protector is actuated, the on/off lever must be released. Press the start button, and squeeze the on/off lever to restart the product. If the product still does not start, reinstall the battery pack.

The battery pack has overheat protection. Excessive temperatures will cause the battery to stop powering the product. If the battery pack is too warm, allow it to cool down before resuming operation. If the product still does not work, recharge the battery.

NOTE: The battery pack LED indicator will not work if the battery protection feature has caused the battery pack to stop powering the product. Power off the product or remove the battery pack from the product, and the battery pack LED indicator will resume normal function.

GENERAL MOWING TIPS

The run time of the battery depends on the condition, length, and density of the grass.

Adjust the cutting height of the lawnmower to suit the current condition of the lawn.

- For best performance, always cut off one-third or less of the total height of the grass.
- When cutting long grass, reduce walking speed to allow for more effective cutting and a proper discharge of the clippings.
- A higher cutting height extends the run time of the battery pack.

TRANSPORTATION AND STORAGE

- Power off the product, and remove the isolator key and the battery pack. Make sure that all moving parts have come to a complete stop. Allow the product to cool down before storing or transporting.
- Remove all foreign materials from the product. Store the product in a cool, dry, and well-ventilated place that is inaccessible to children. Keep the product away from corrosive agents, such as garden chemicals and de-icing salts. Do not store the product outdoors.
- Store the product in a location where the ambient temperature is between 0 °C and 40 °C.
- Use extreme caution when lifting or tilting the product for maintenance, cleaning, storage, or transportation. The blade is sharp; keep all body parts away from the blade while it is exposed.
- When transporting the product in a vehicle, remove the isolator key and the battery pack, and secure the product against movement or falling to prevent injury to persons or damage to the product.

TRANSPORTING LITHIUM BATTERIES

Transport the battery pack in accordance with local and national provisions and regulations.

Follow all special requirements on packaging and labelling when transporting batteries by a third party. Ensure that no batteries can come in contact with other batteries or conductive materials while in transport by protecting exposed connectors with insulating, non-conductive caps or tape. Do not transport batteries that are cracked or leaking. Check with the forwarding company for further advice.

MAINTENANCE

- Use only original manufacturer's replacement parts, accessories, and attachments. Failure to do so can cause possible injury, can contribute to poor performance, and may void your warranty.
- You may make adjustments and repairs described in this manual. For other repairs, contact customer service
- Turn off the product, and remove the isolator key and the battery pack. Make sure that all moving parts have come to a complete stop before any cleaning or maintenance task.
- Check all nuts, bolts, and screws at frequent intervals for proper tightness to ensure that the product is in safe working condition.
- After each use, clean the plastic parts with a soft, dry cloth. For any sign of damage, contact customer service.
- Replace damaged blades and bolts in sets to preserve balance.
- Be careful during adjustment of the product to prevent entrapment of the fingers between moving blades and fixed parts of the product.
- The blade on the product is sharp. Use extreme caution, and wear heavy-duty gloves when fitting, replacing, cleaning, or checking bolt security.
- The blade bolts must be adequately tightened. See the manufacturer's recommendations for blade bolt torque, which can be found in the product specifications table in this manual.
- Be aware that even though the power source is turned off, the blades can still be moved.

CLEARING BLOCKAGES

- Power off the product, and remove the isolator key and the battery pack. Make sure that all moving parts have come to a complete stop.
- Always wear heavy-duty gloves when checking or clearing a blockage. The blades are sharp, and the blockage itself could be a sharp object.
- Remove the grass catcher. Check and carefully clear the grass catcher for obstructions.
- Check the grass discharge chute, and carefully clear blockages.
- Turn the product on its side. Check its underside and the area around the blade. Carefully remove any blockages. Remember that the blade may move during cleaning.

SYMBOLS ON THE PRODUCT



Read and understand all instructions before operating the product. Follow all warnings and safety instructions.



Wear ear and eye protection.



Do not operate the product on inclines greater than 15°. Mow across the face of slopes, never up and down.



Do not expose the product to rain or damp conditions.



Beware of sharp blades. Blades continue to rotate after the motor is turned off. Remove the battery pack before maintenance.



Beware of thrown or flying objects. Keep all bystanders, especially children and pets, at least 15 m away from the operating area.



Remove the battery pack before starting any work on the product.



Guaranteed sound power level



Regulatory Compliance Mark (RCM). Product meets applicable regulatory requirements.



Waste electrical products should not be disposed of with household waste. Please recycle where facilities exist. Check with your local authority or retailer for recycling advice.

SYMBOLS IN THIS MANUAL



Note



Warning

LED INDICATORS

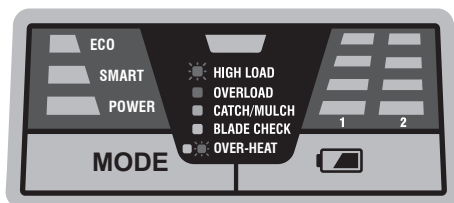

LED	Status	Solution
High load	Blinking red	<p>The product is working beyond a limit that can be maintained. The product may overload.</p> <ul style="list-style-type: none"> ■ Consider using a higher cutting height. ■ Walk slower while mowing. ■ Avoid mowing long and unruly lawns or wet grass. ■ Avoid mowing over obstacles in the grass, such as stones or sticks. ■ Empty the grass catcher more regularly.
Overload	Solid red with beep	<p>The battery pack has cut off power to protect the product's motor.</p> <ul style="list-style-type: none"> ■ Uninstall the battery pack. Reinstall the battery pack after 3 seconds, and restart the product. ■ Consider using a higher cutting height. ■ Walk slower while mowing. ■ Avoid mowing long and unruly lawns or wet grass. ■ Avoid mowing over obstacles in the grass, such as stones or sticks. ■ Empty the grass catcher more regularly.
Catch/ Mulch	Blinking yellow with beep	<p>The grass catcher or mulch plug is not installed or is not fully seated in the groove.</p> <ul style="list-style-type: none"> ■ Install a grass catcher / mulch plug. ■ Remove dried grass or any debris that may obstruct the connection of the grass catcher / mulch plug to the product.
Blade check	Solid blue	<p>The product has been used for a total of 10 hours cutting time.</p> <ul style="list-style-type: none"> ■ Inspect the blade. If there are signs of chips or rust, or if the cut quality has deteriorated, replace the blade. Refer to the specifications section of this manual for the replacement blade model number. ■ Press and hold down the battery fuel gauge button on the dashboard to reset the blade check timer.
Motor over temperature - medium heat	Blinking red and blue	<p>The product is overheated and cannot restart until it cools down to a safe temperature.</p> <ul style="list-style-type: none"> ■ Uninstall the battery pack. Store the product and the battery pack in a cool, dry place until they cool down before resuming operation.
Motor over temperature - high heat	Solid red	<p>The product is overheated and cannot restart until it cools down to a safe temperature.</p> <ul style="list-style-type: none"> ■ Uninstall the battery pack. Store the product and the battery pack in a cool, dry place until they cool down before resuming operation.

R36XLMW10

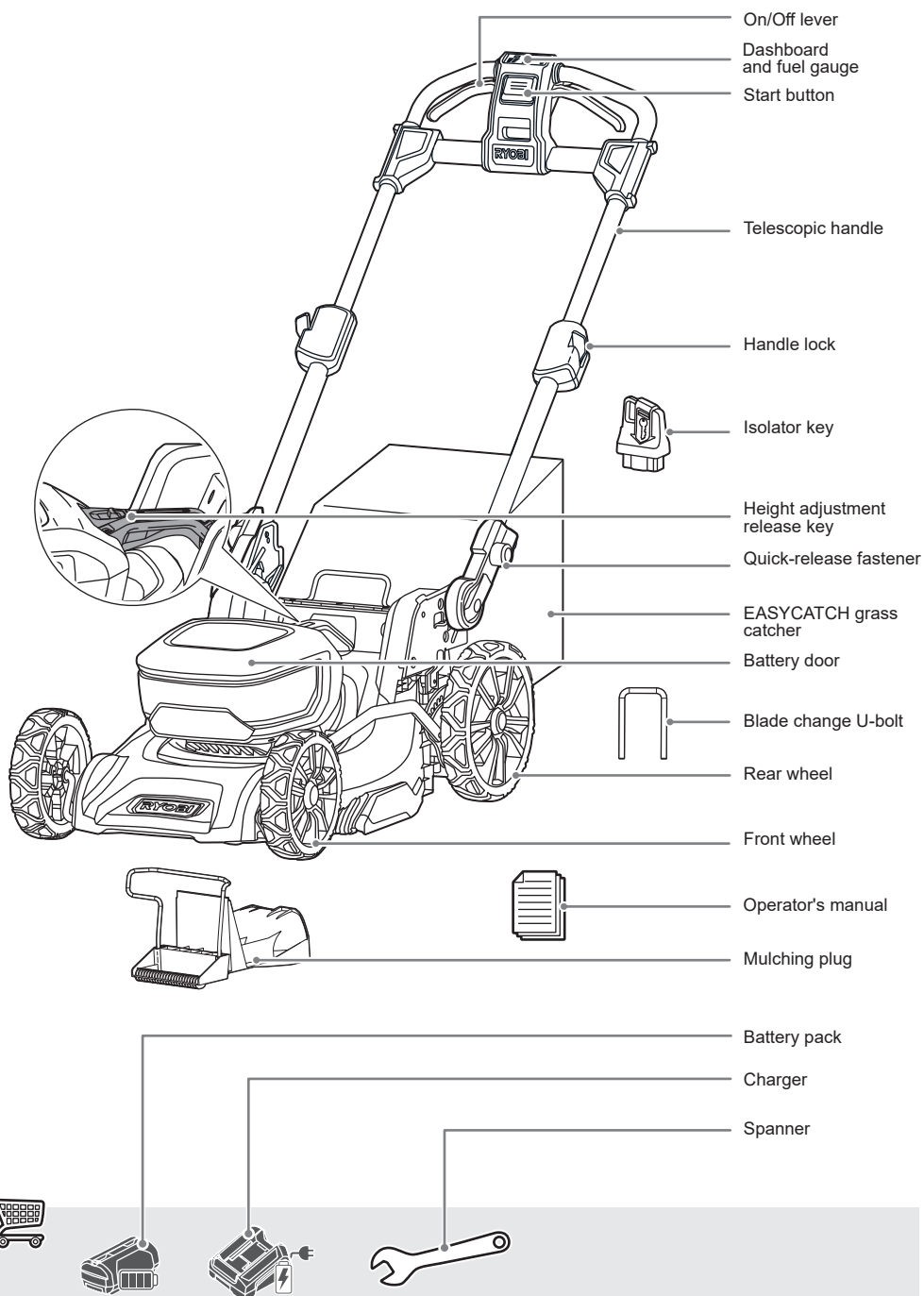

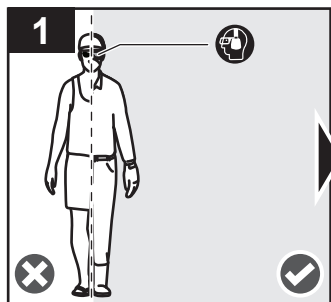

Wear full eye protection, ear protection, non-slip heavy-duty gloves, substantial footwear, and long trousers at all times while operating the product. Do not operate the product when barefoot or wearing open sandals.

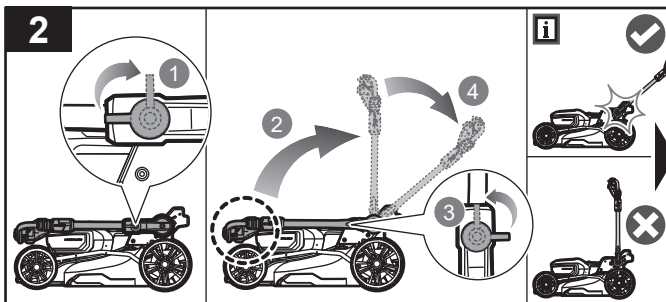

Adjust the operating angle of the handle to your preference. Turn the quick-release fastener 90° clockwise. Set the handle to the operating position. Turn the fastener 90° counterclockwise, and ensure that the fastener is secured.

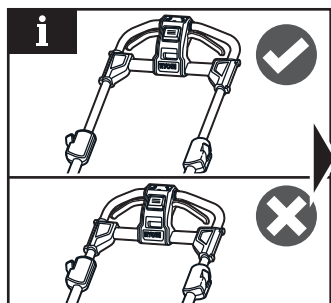

NOTE: Make sure that the upper handle is fully extended.

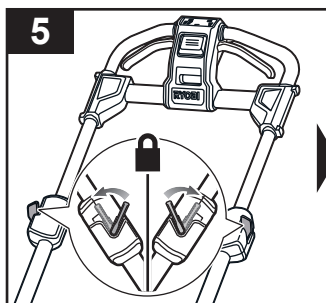

Rotate the handle lock levers clockwise to lock and secure the upper handle.

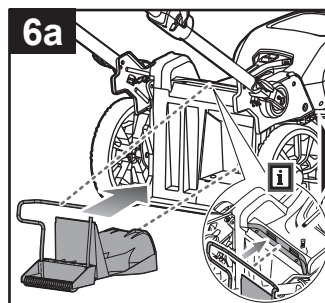

For mulching operation, insert the metal frame of the mulching plug into the magnetic slot on the mower, and insert the mulching plug into the rear discharge opening.

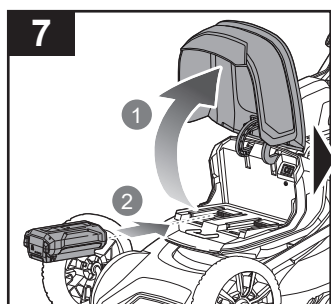

Open the battery door. Install one or two battery packs. Make sure that the latch snaps into place and that the battery pack is secured to the product before operating.

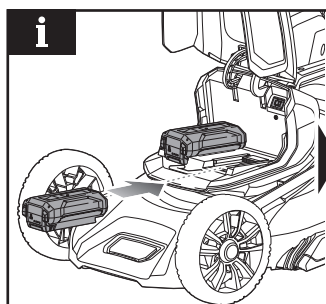

NOTE: Both battery ports are active. The product can function using one or two battery packs. SMART BOOST performance can be achieved when two battery packs are inserted to discharge a higher current and provide higher power.

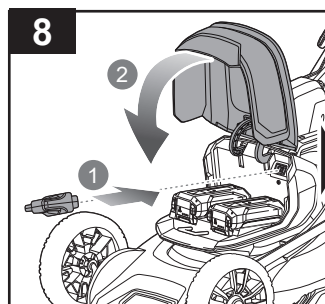

Insert the isolator key, and close the battery door.

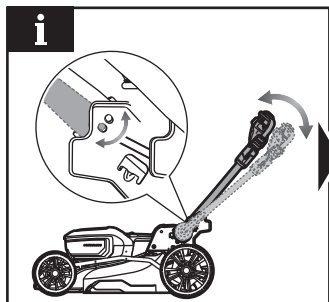

NOTE: Align and secure the handle to the preferred locking slot.

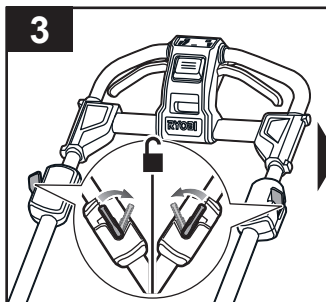

Rotate the handle lock levers counterclockwise to unlock the upper handle.

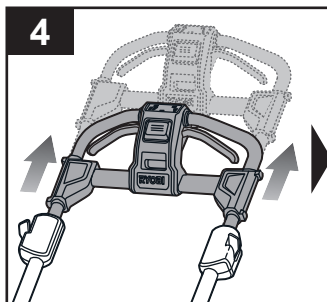

Fully extend the upper handle.

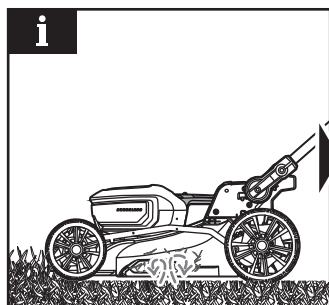

NOTE: The mulching plug covers the rear discharge opening to allow the blade to cut and recut for finer clippings. The product will not start without a grass catcher or mulching plug securely installed.

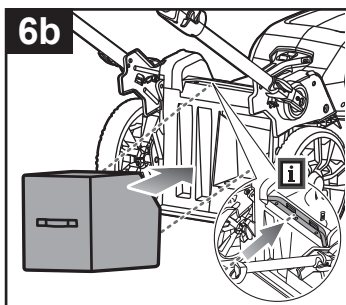

For bagging operation, insert the metal frame of the grass catcher into the magnetic slot on the mower, and make sure that the grass catcher fully covers and aligns with the rear discharge opening.

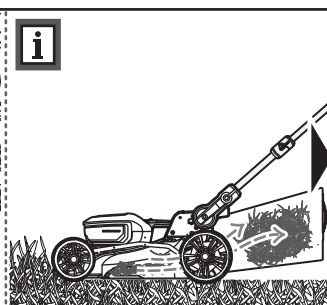

NOTE: The grass catcher collects grass clippings, preventing them from being discharged across the lawn while mowing. The product will not start without a grass catcher or mulching plug securely installed.

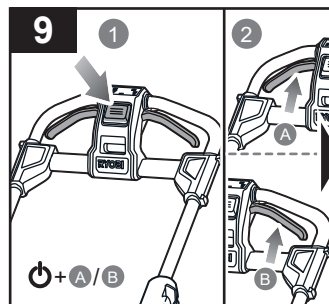

Press the start button, then squeeze and hold either side of the on/off lever to start the product. Never start the product on grass. Alternatively, start the product with the front wheels in the air or on a hard surface. The product will take 1–2 seconds to hit top speed and be ready for use.

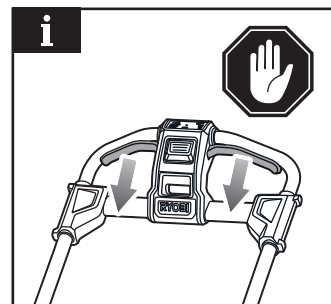

NOTE: The on/off lever must be continuously held during use. To turn the product off, release the on/off lever.

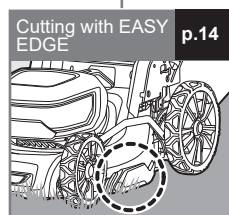
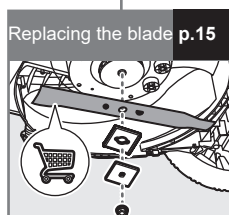
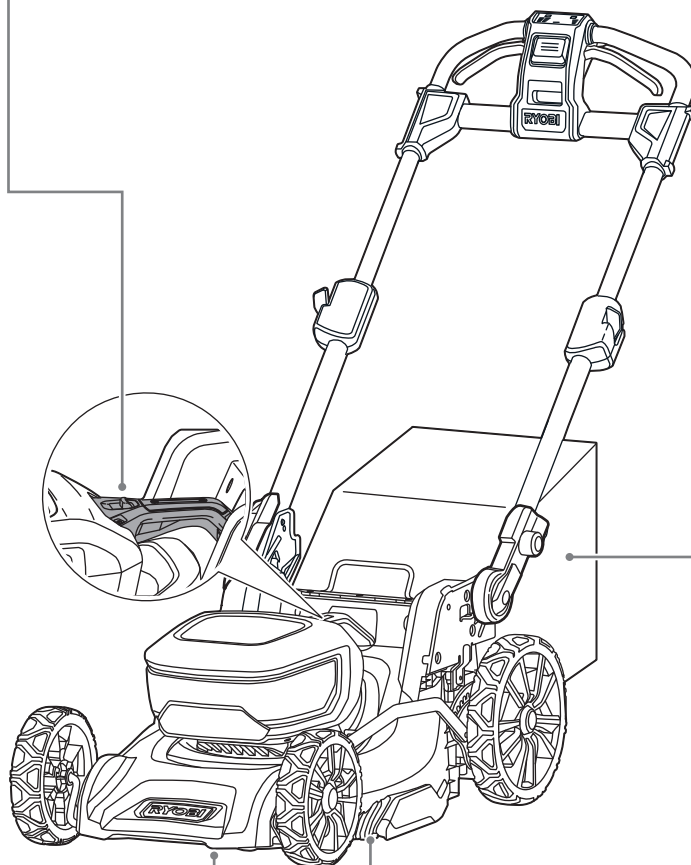
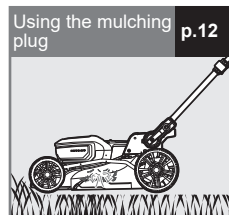
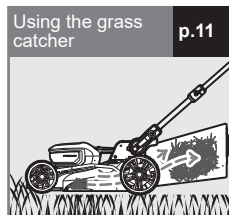
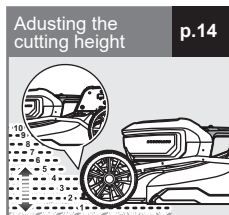

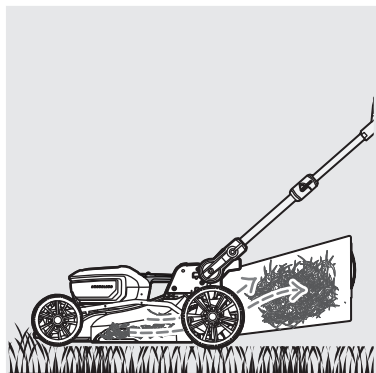

USING THE GRASS CATCHER

WARNING: Avoid holes, ruts, bumps, rocks, property stakes, or other hidden objects.

WARNING: Do not operate the product on inclines greater than 15°. Mow across the face of slopes, never up and down.

1. Remove the mulching plug.
2. Insert the metal frame of the grass catcher into the magnetic slot on the mower, and make sure that the grass catcher fully covers and aligns with the rear discharge opening. EASYCATCH allows for the grass catcher to easily pass through the handles.

NOTE: The grass catcher collects grass clippings, preventing them from being discharged across the lawn while mowing. The product will not start without the grass catcher securely installed.

3. Open the battery door. Insert one or two battery packs into the product. Make sure that the latch on the battery pack snaps into place and that the battery pack is secured before operating the product. Insert the isolator key. Close the battery door.

NOTE: The product does not start without the isolator key. Ensure that the isolator key is installed in the product.

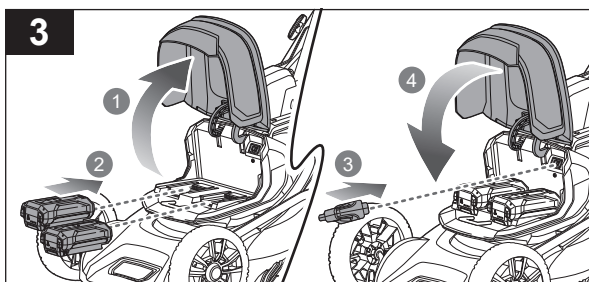
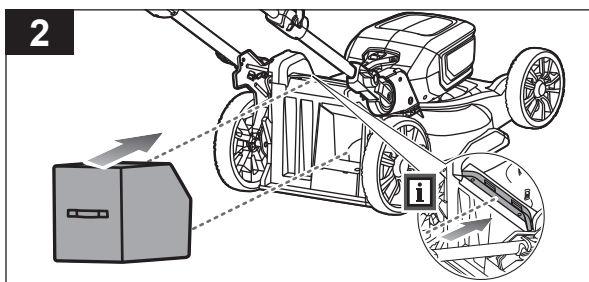
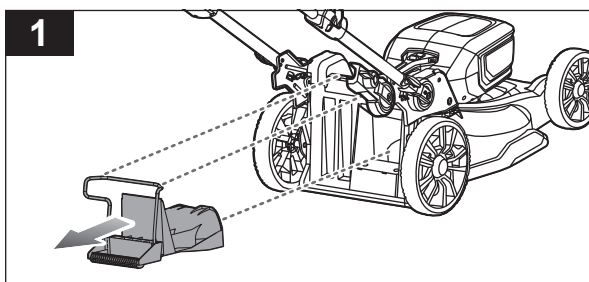
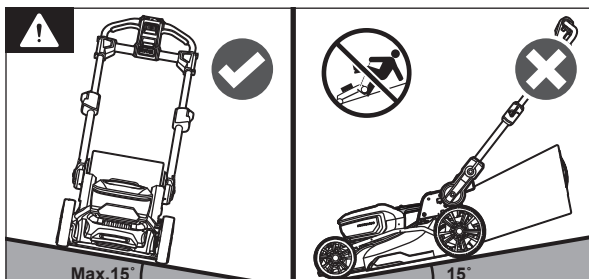
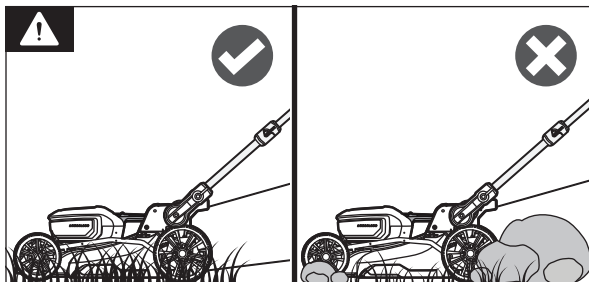

4. Press the start button, then squeeze and hold either side of the on/off lever to start the product. Keep holding the on/off lever to keep using the product.
5. Release the on/off lever to stop the product.

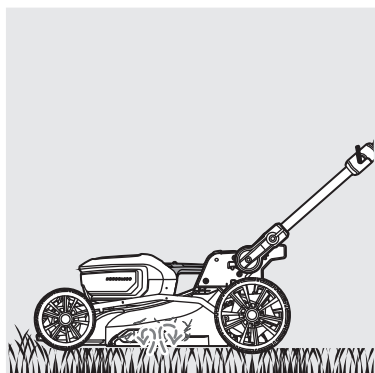
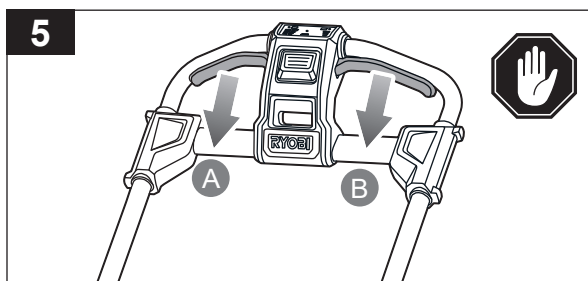
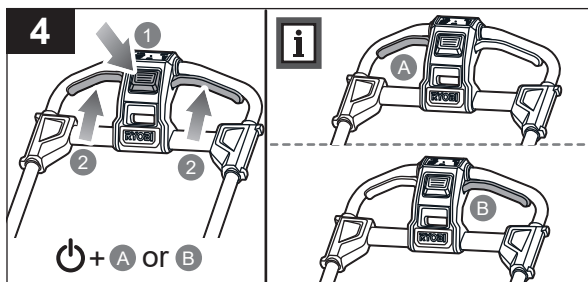

USING THE MULCHING PLUG

WARNING: Avoid holes, ruts, bumps, rocks, property stakes, or other hidden objects.

WARNING: Do not operate the product on inclines greater than 15°. Mow across the face of slopes, never up and down.

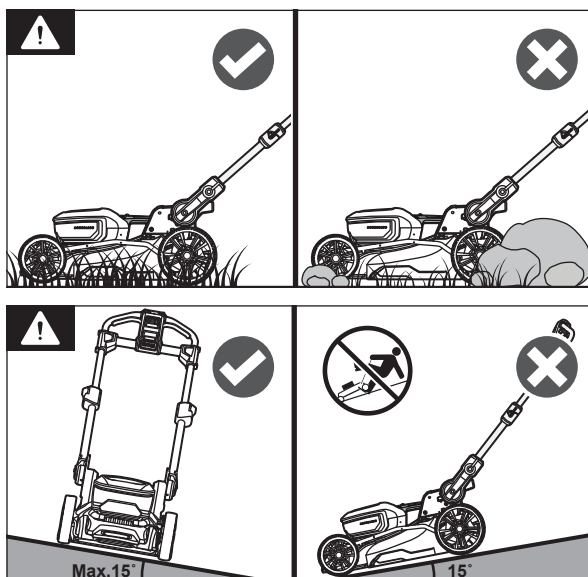

1. Remove the grass catcher.
2. Insert the metal frame of the mulching plug into the magnetic slot on the mower, and insert the mulching plug into the rear discharge opening.

NOTE: The mulching plug covers the rear discharge opening to allow the blade to cut and recut for finer clippings.

3. Open the battery door. Insert one or two battery packs into the product. Make sure that the latch on the battery pack snaps into place and that the battery pack is secured before operating the product. Insert the isolator key. Close the battery door.

NOTE: The product does not start without the isolator key. Ensure that the isolator key is installed in the product.

4. Press the start button, then squeeze and hold either side of the on/off lever to start the product. Keep holding the on/off lever to keep using the product.
5. Release the on/off lever to stop the product.

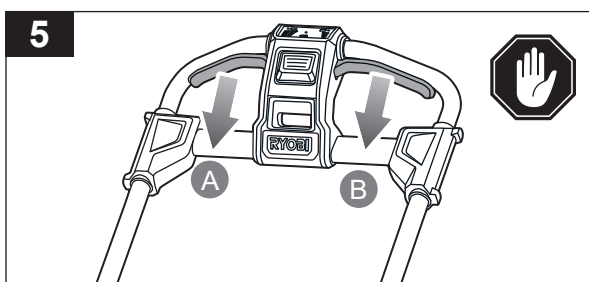
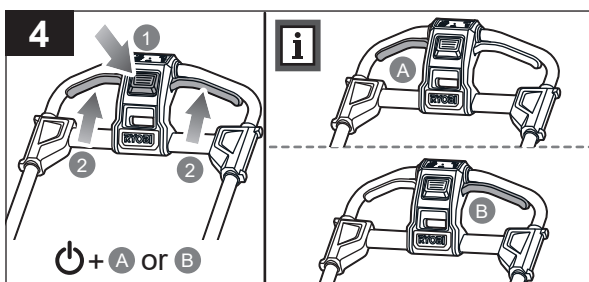
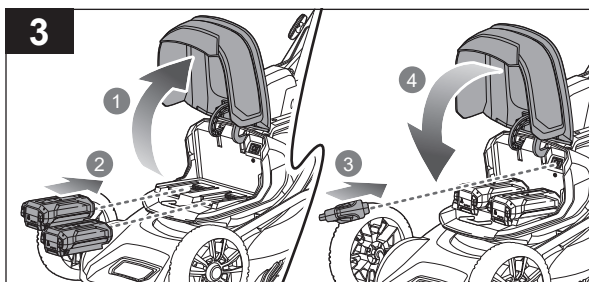
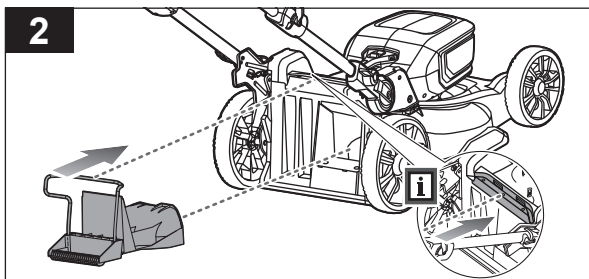
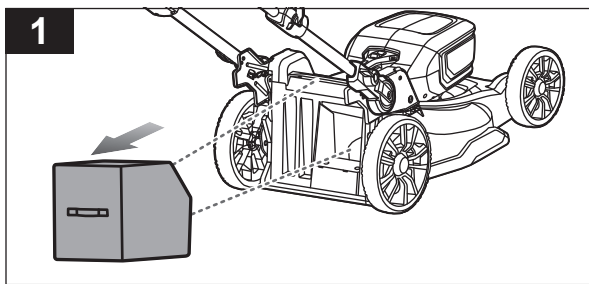

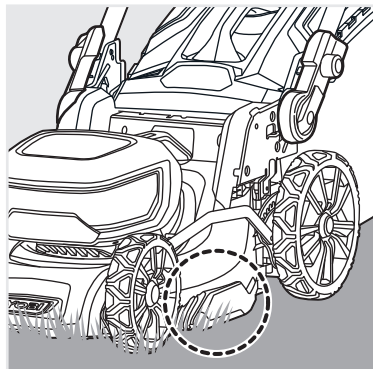

CUTTING WITH EASY EDGE

EASY EDGE allows the product to easily cut the grass along walls or the edge of the lawn.

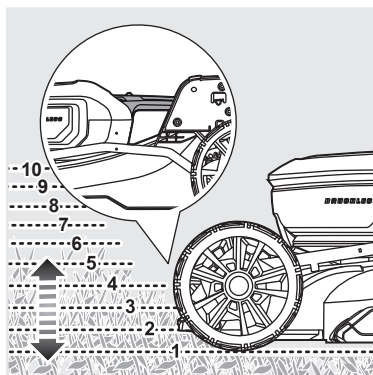
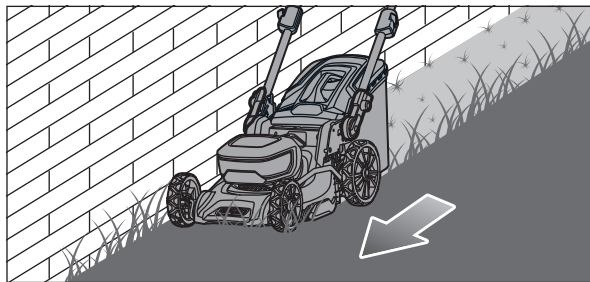

ADJUSTING THE CUTTING HEIGHT

NOTE: Properly hold the carry handle while adjusting the cutting height.

1. Slide forward the height adjustment release key to unlock the cutting deck.

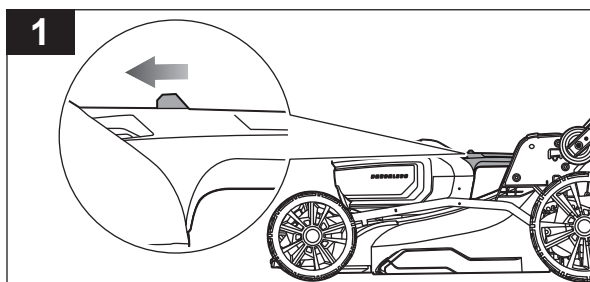
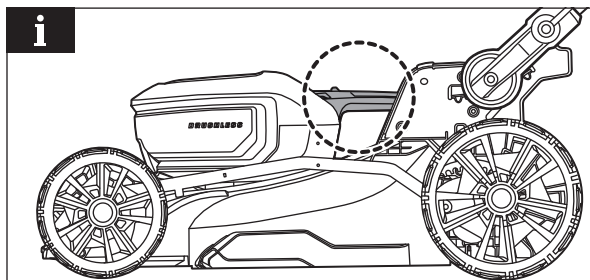

2. Pull up or push down the deck to the preferred cutting height. Refer to the height label and indicator. Make sure that the cutting height is securely locked into position before mowing.

NOTE: The cutting height can be adjusted to 10 positions. Cutting heights may vary in particular products. Start the mower at the highest position, before cutting the grass. If the height adjustment release key is difficult to slide forward, try lifting up the handle slightly and then sliding it forward to set your preferred height adjustment.

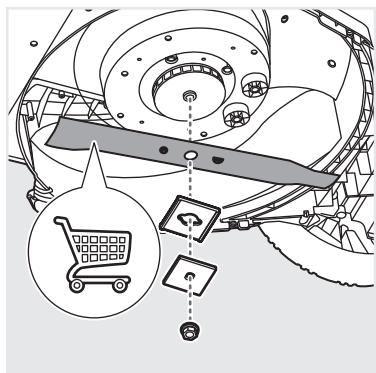
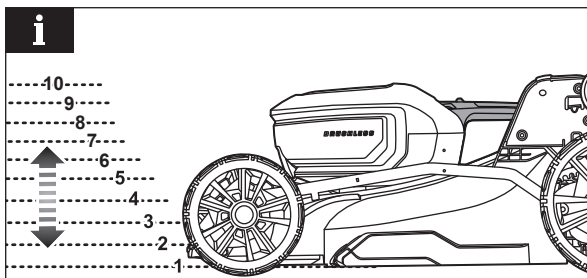
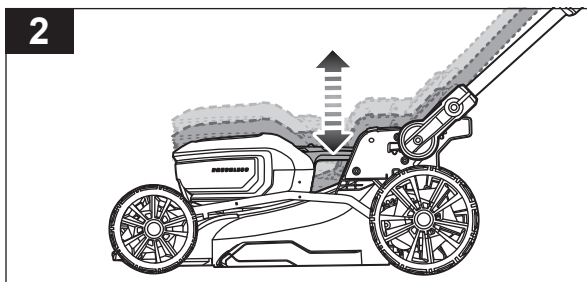

REPLACING THE BLADE

NOTE: When the blue blade check light is on, press and hold the battery button on the dashboard for 5 seconds to reset.

1. Open the battery door. Remove the battery packs. Remove the isolator key, and close the battery door.

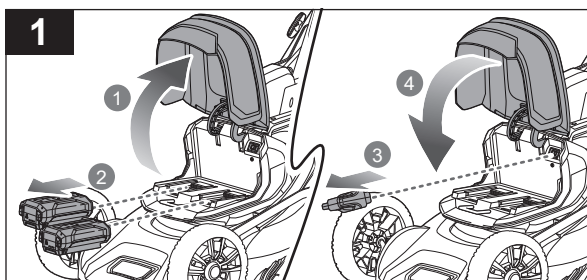
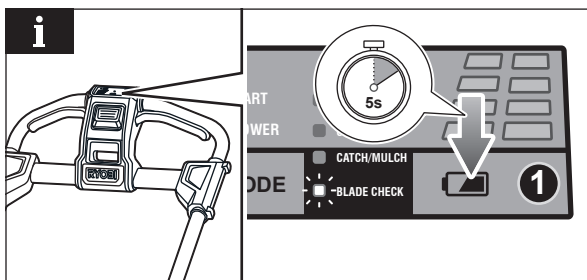

2. Remove the blade change U-bolt from its compartment.
3. Tilt the product on its side.

WARNING: The blade on the product is sharp. Use extreme caution, and wear heavy-duty gloves when fitting, replacing, cleaning, or checking bolt security.

4. Remove all grass clippings and debris from the cutting deck and blade.
5. Insert the blade change U-bolt into the cutting deck holes to prevent the blade from spinning during loosening of the blade nut. Loosen the blade nut.

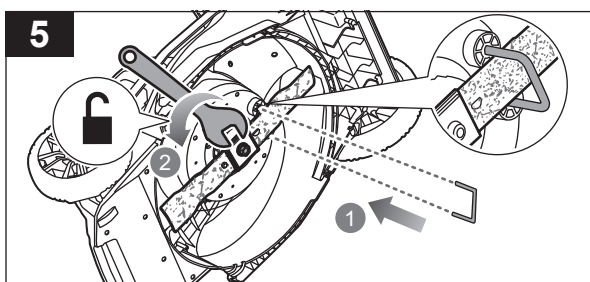
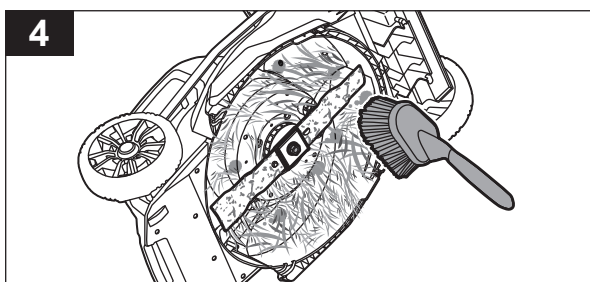
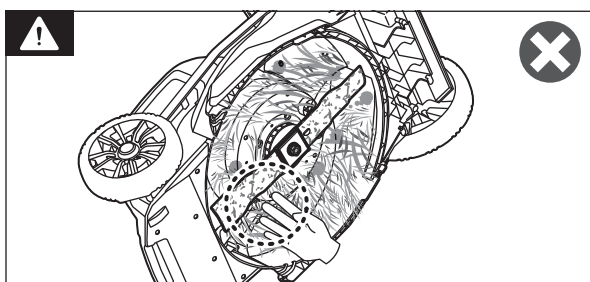
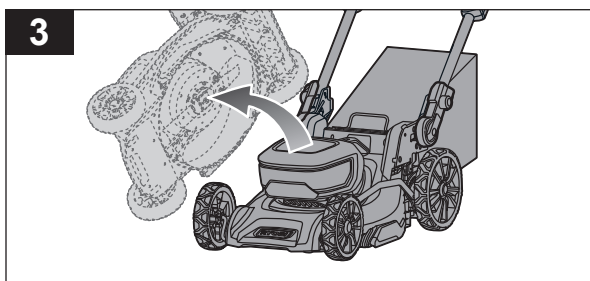
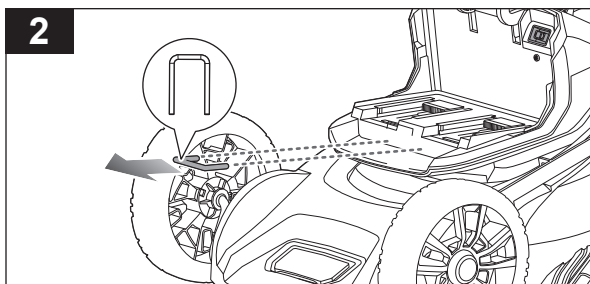

6. Remove the blade change U-bolt.
7. Remove the blade nut, spacer, and washer. Remove and properly dispose of the old blade.
8. Install the new blade, washer, spacer, and nut.
9. Insert the blade change U-bolt into the cutting deck holes to prevent the blade from spinning during tightening of the blade nut. Hand-tighten the nut until the blade is secured and does not shake, then use a spanner to further tighten the nut to 35 to 40 Nm torque.

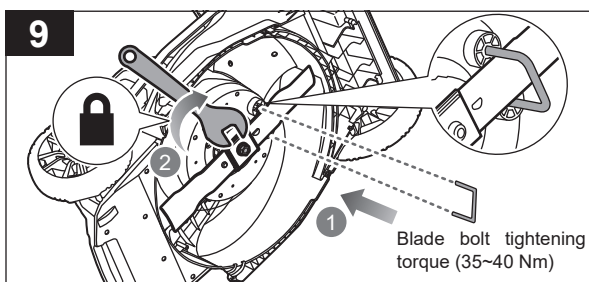
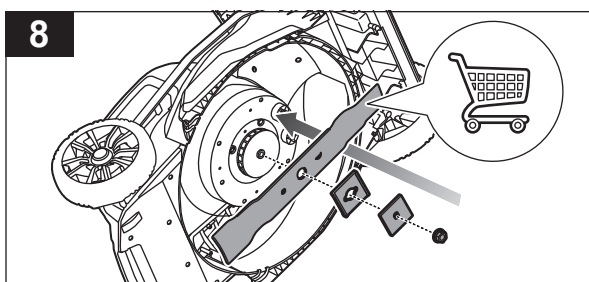
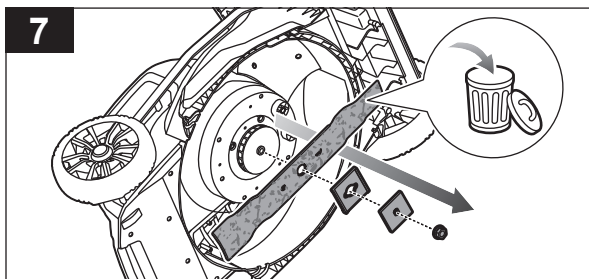
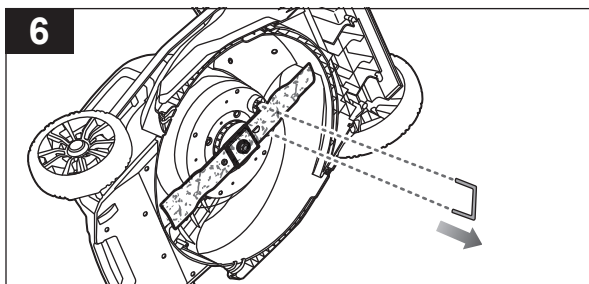

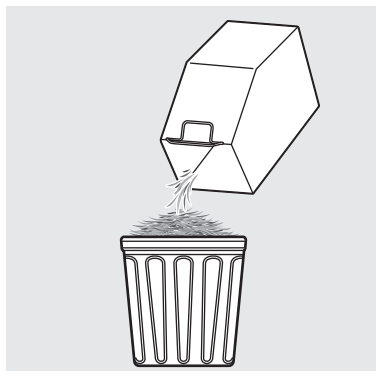

EMPTYING THE GRASS CATCHER

NOTE: Stop mowing when the grass catcher is full. Empty the grass catcher before resuming operation.

1. Release the on/off lever to turn off the product.
2. Remove the grass catcher.
3. Remove the grass clippings from the grass catcher into a bin.

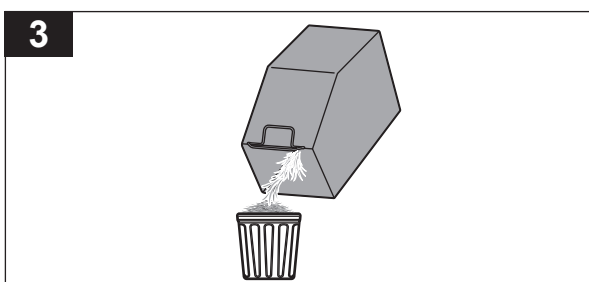
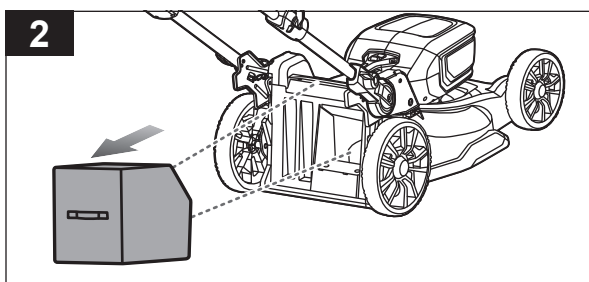
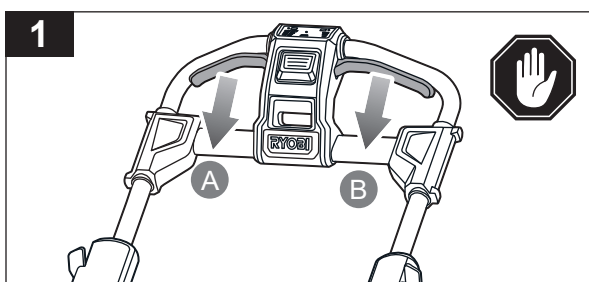
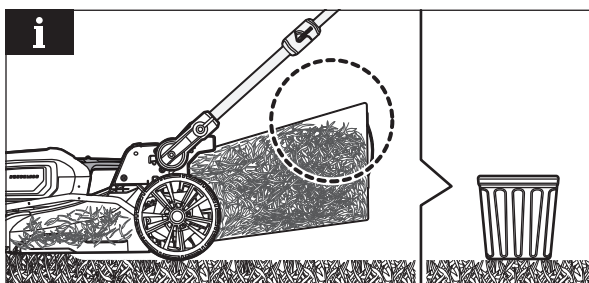
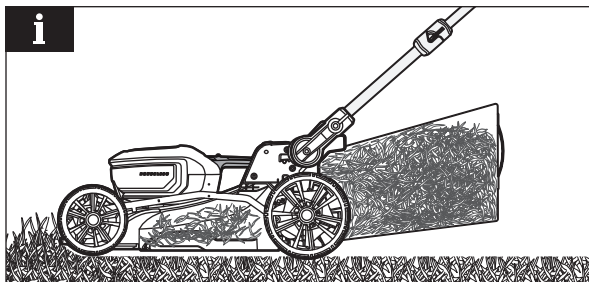

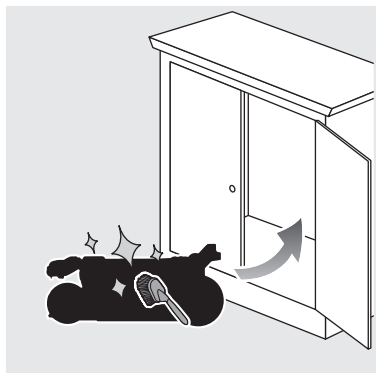

CLEANING AND STORING THE PRODUCT

1. Release the on/off lever to turn off the product.
2. Open the battery door. Remove the battery packs. Remove the isolator key, and close the battery door.
3. Remove all foreign materials from the product. Clean the product with a soft, dry cloth or cleaning brush.

WARNING: Do not use water to clean the product.

4. Remove the grass catcher.

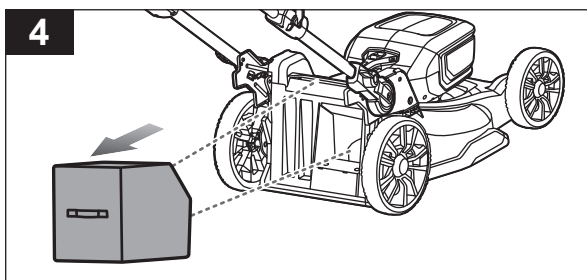
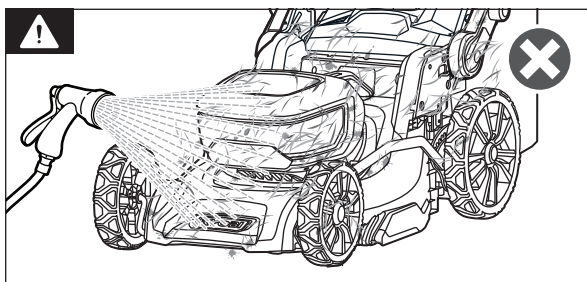
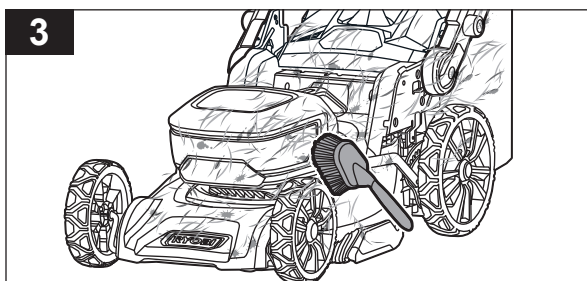
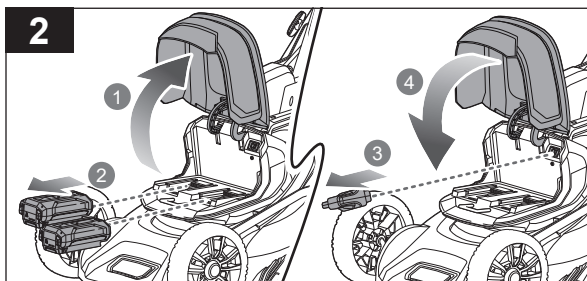
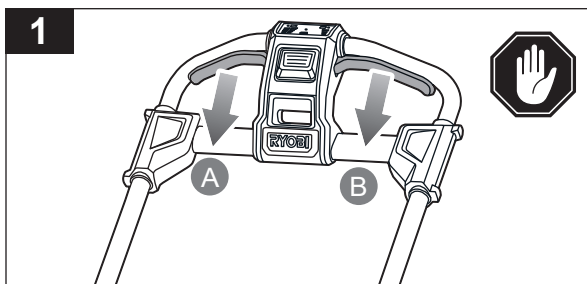

5. Open the handle locks. Push the upper handle into the lower handle until the upper handle is fully retracted.
6. Close the handle locks to secure the handle.
7. Turn the quick-release fastener 90° counterclockwise. Push the handle forwards until it is perpendicular to the floor, then turn back the quick-release fastener to align with the handle. Fold down the lower handle, resting it on top of the product.
8. Fold the grass catcher and place it on top of the product.
9. Store the product in a cool, dry, and well-ventilated place that is inaccessible to children. Keep the product away from corrosive agents, such as garden chemicals and de-icing salts. Do not store the product outdoors.

NOTE: The product may be stored vertically. There is a latch on the back of the user interface panel to hang the grass catcher. Ensure that the battery packs are removed and that all the handles are securely locked before storing the product in a vertical position.

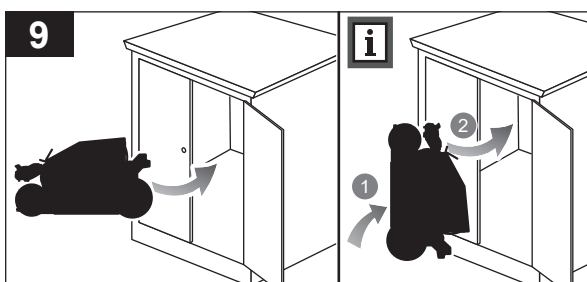
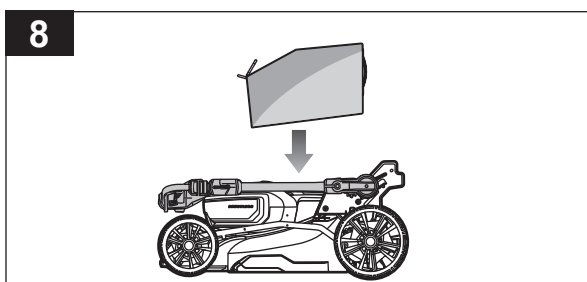
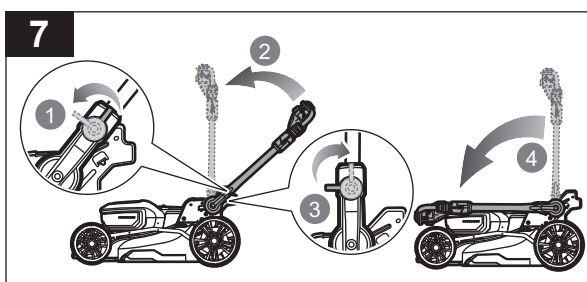
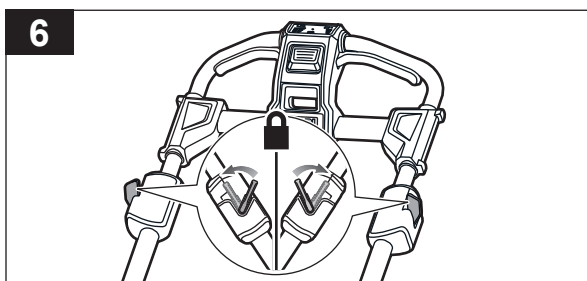
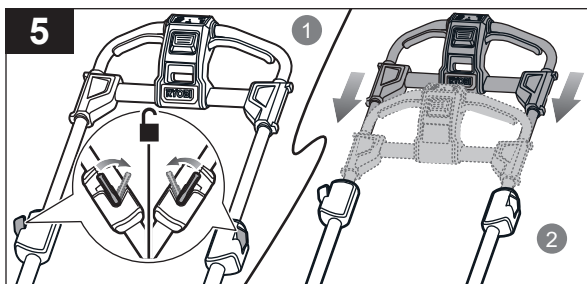

20240502/641

PRODUCT SPECIFICATIONS

Cordless lawnmower

Model R36XLMW10

Rated voltage 36 V d.c.

Width of cut 46 cm

Height of cut 25–100 mm

No-load speed 3600/min max

Maximum cutting speed 3600/min

Weight (without battery pack) 22.7 kg

Grass catcher capacity 55 L

Blade bolt torque 35–40 Nm

Vibration level (in accordance with AS/NZS 62841.4.3) $a_h = 1.0 \text{ m/s}^2$

Uncertainty $K_h = 1.5 \text{ m/s}^2$

Noise emission level for 3600/min rated speed (in accordance with AS/NZS 62841.4.3)

A-weighted sound pressure level at operator's position $L_{pA} = 88.3 \text{ dB(A)}$

Uncertainty of measurement $K_{pA} = 3.0 \text{ dB}$

A-weighted sound power level $L_{WA} = 95.9 \text{ dB(A)}$

Uncertainty $K_{WA} = 3.0 \text{ dB}$

$L_{WA} + K_{WA}$ 99 dB(A)

Compatible battery packs BPL3620D, BPL3660D, BPL3690D, BPL3626D2, BPL3640D2, BPL3650D2, BPL3612D, R36BTY2, R36BTY4, R36BTY5, R36BTY6

REPLACEMENT PARTS

Blade RLMB1

Grass catcher 317048001

⚠ WARNING! The declared vibration total values and the declared noise emission values given in this instruction manual have been measured in accordance with a standardised test and may be used to compare one tool with another. They may be used for a preliminary assessment of exposure.

The declared vibration and noise emission values represent the main applications of the tool. However, if the tool is used for different applications, used with different accessories, or poorly maintained, the vibration and noise emission may differ. These conditions may significantly increase the exposure levels over the total working period. An estimation of the level of exposure to vibration and noise should take into account the times when the tool is turned off or when it is running idle. These conditions may significantly reduce the exposure level over the total working period.

Identify additional safety measures to protect the operator from the effects of vibration and noise, such as maintaining the tool and the accessories, keeping the hands warm (in case of vibration), and organising work patterns.



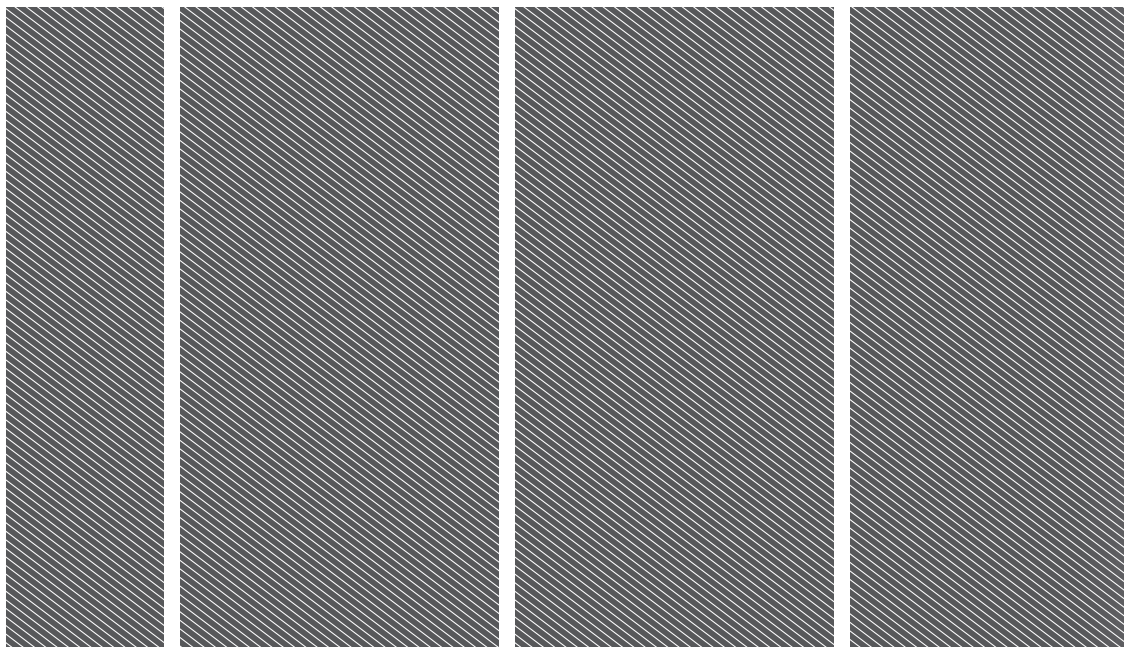

Imported by:

Techtronic Industries Australia Pty Ltd

31 Gilby Road, Mount Waverley, VIC 3149

Melbourne, Australia

Techtronic Industries N.Z. Limited

Unit C, 70 Business Parade South,

Highbrook, Auckland 2013, New Zealand

RYOBI is a trade mark of Ryobi Limited, and is used under license.

EASYCATCH is a trade mark of Techtronic Cordless GP.

SMART BOOST is a trade mark of Techtronic Cordless GP.

961478331-03

