

Quick Guide Wireless Mic System (DR7)

■ Start to work

⚠ The system is PAIRED already in the factory.

The whole system will be linked automatically every time when they are powered on. No need to pair again until new microphone is needed.

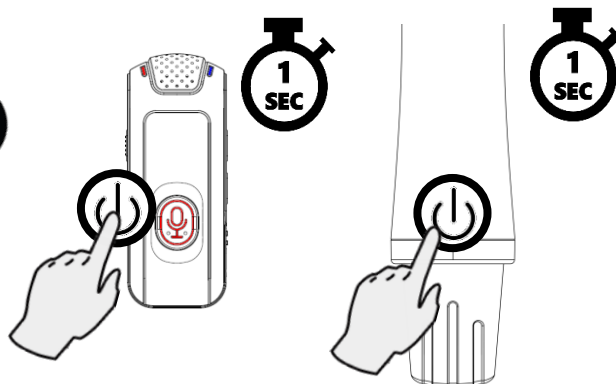
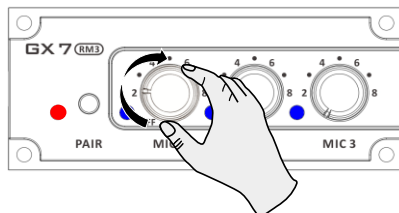

■ Adjust mic gain

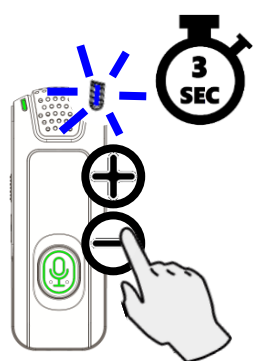

Press and hold **+** or **-** for 3 seconds. Power indicator will flash to increase or decrease gain level.

- Level 1: Flash one (1) time
- Level 2: Flash two (2) times
- Level **3 (default)**: Flash three (3) times
- Level 4: Flash four (4) times
- Level 5: Flash five (5) times

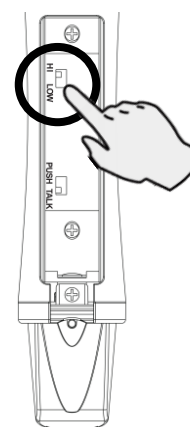

Remove GX 5 H battery cover and tune the gain level (H, L) on indicated location.

■ Interface

GX 5 RM3

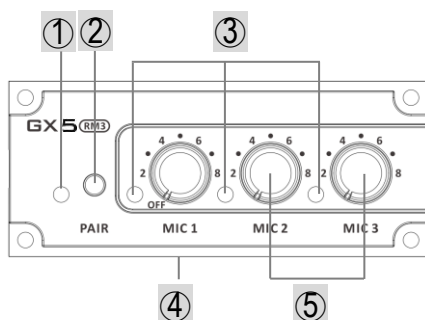

GX 5 H

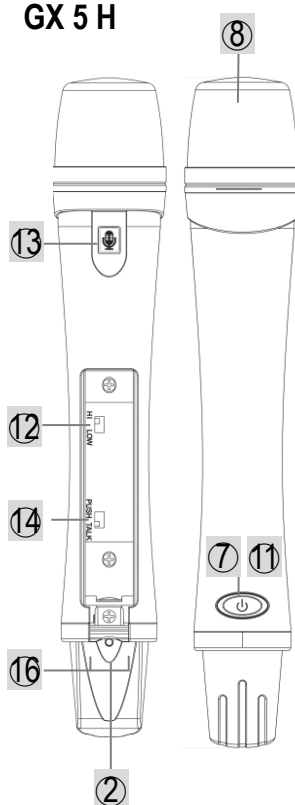

GX 5 T

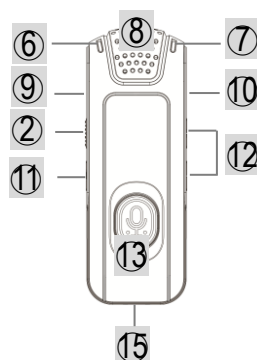

- ① Pairing indicator (red)
- ② Pairing button
- ③ Mic indicator (blue | red)
- ④ Power | Volume knob
- ⑤ Volume knob
- ⑥ Talk | Mute indicator (green | red)
- ⑦ Power | Pairing indicator (blue | red)
- ⑧ Inbuilt mic
- ⑨ Mic input (3.5 mm, TS)
- ⑩ Audio input (3.5 mm, TRS)
- ⑪ Power button
- ⑫ Gain switch
 - GX 5 T: 1, 2, 3, 4, 5
 - GX 5 H: L, H
- ⑬ Backlit talk | mute button (green | red)
- ⑭ Mic switch (talk | push)
- ⑮ USB-C charging port
- ⑯ Charging contacts (proprietary charger required)

Quick Guide Wireless Mic System (DR7)

■ Indicators

Mic indicator

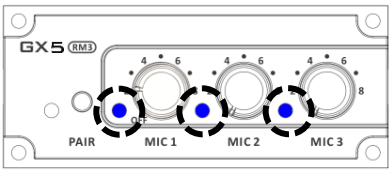

Status	Meaning
Blue	Mic is full power
Red	Mic is low power
Steady	Mic is on
Blue flash	Mic is muted
Red flash	Pairing under process

Power | Pairing indicator

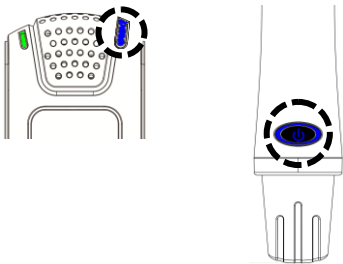

Status	Meaning
Blue	Full power
Red	Low power
Steady	Linked
Flash quickly	Pairing under process
Flash slowly	Not linked

Talk | Mute indicator

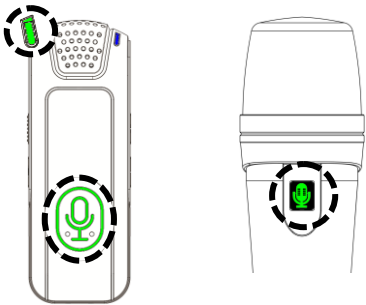

Status	Meaning
Green	Mic is on
Red	Mic is muted
Flash	No talk right

Quick Guide Wireless Mic System (DR7)

■ Pair the system

STEP 1. Ensure GX 5 RM3 is powered on.
Pairing indicator stays on.

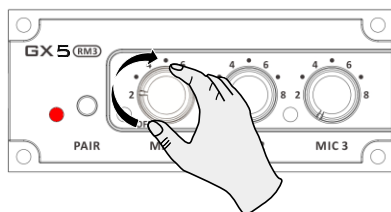

STEP 2. Press and hold the pairing button for 5 seconds until mic indicator starts to flash.

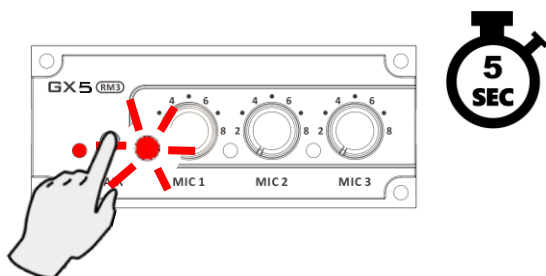

STEP 5. Press and hold GX 5 H pairing button to power on (⏻) within 1 minute.

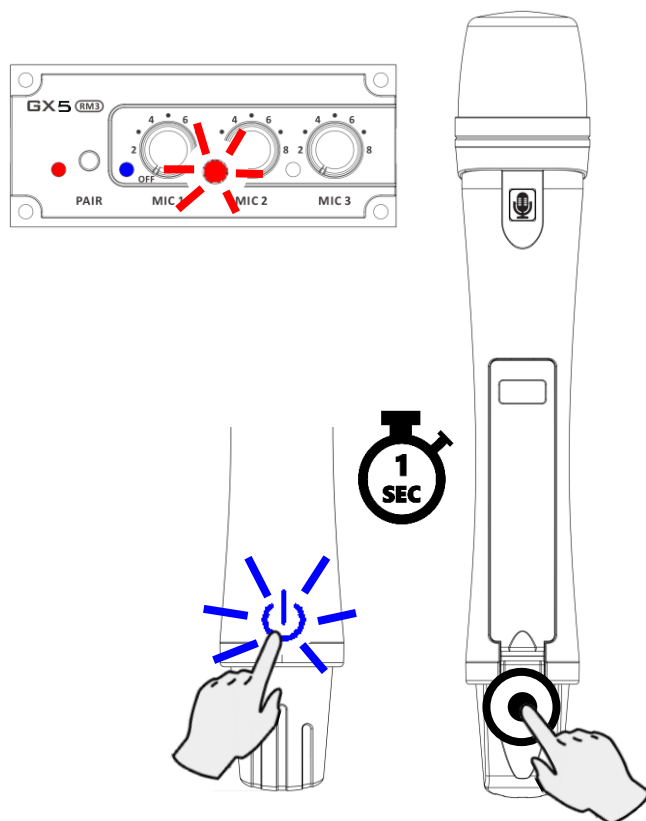

STEP 3. Press and hold GX 5 T pairing button (⏻) to power on (⏻) within 1 minute.

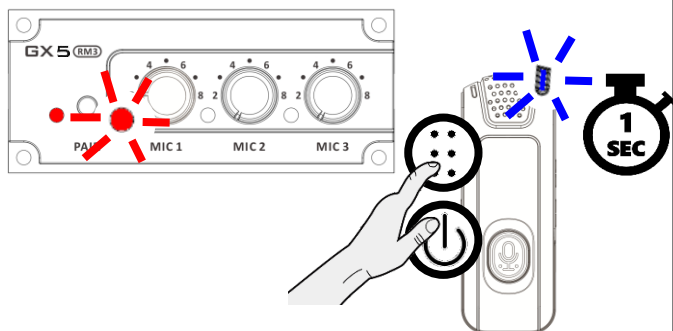

STEP 6. Pairing completes again when steady indicators light up on both units.

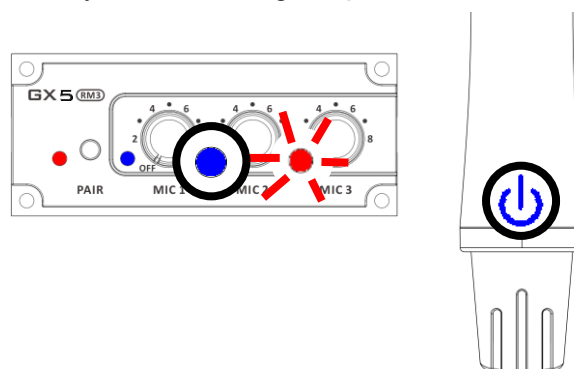

STEP 4. Pairing completes when steady indicators light up on both units.

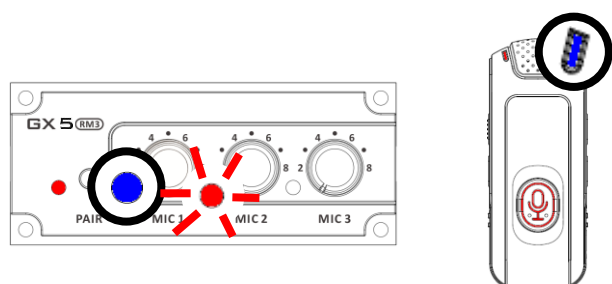

STEP 7. Pair 3rd mic when needed.
Microphones are linked successfully when all mic indicators light on in blue.

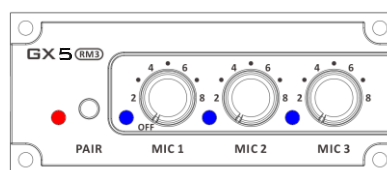

Quick Guide Wireless Mic System (DR7)

■ Pair a new microphone

STEP 1. Press and hold the pairing button for 5 seconds until signal indicator starts to flash.

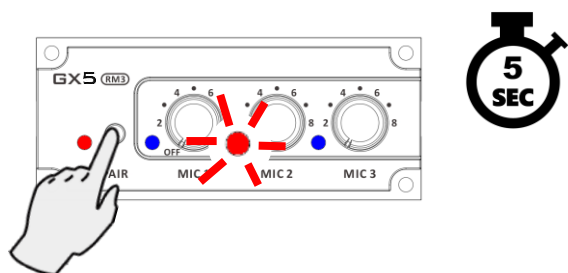

STEP 3. New microphone is linked successfully when steady indicators show up on both units.

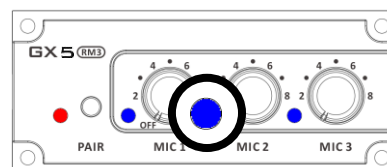

STEP 2. Power new microphone on and enter its pairing mode.

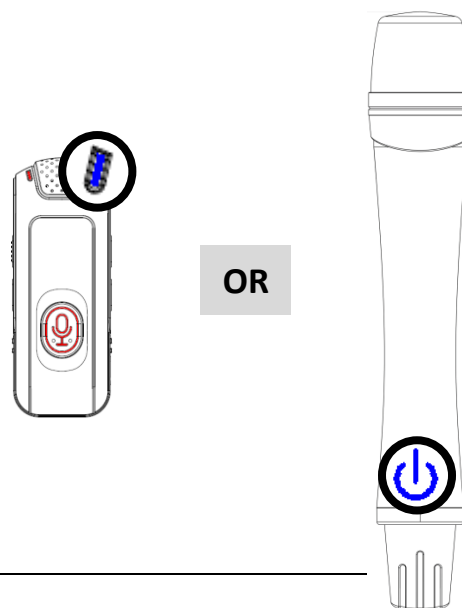
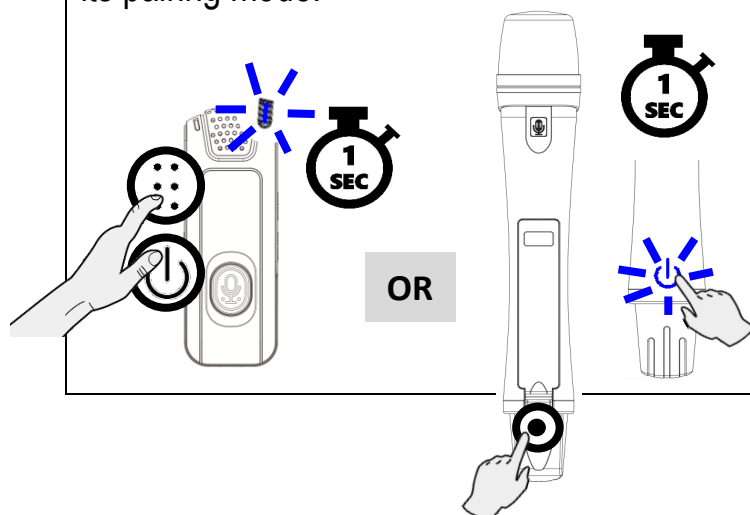

■ Power the system off

Follow instructions below to power the system off.

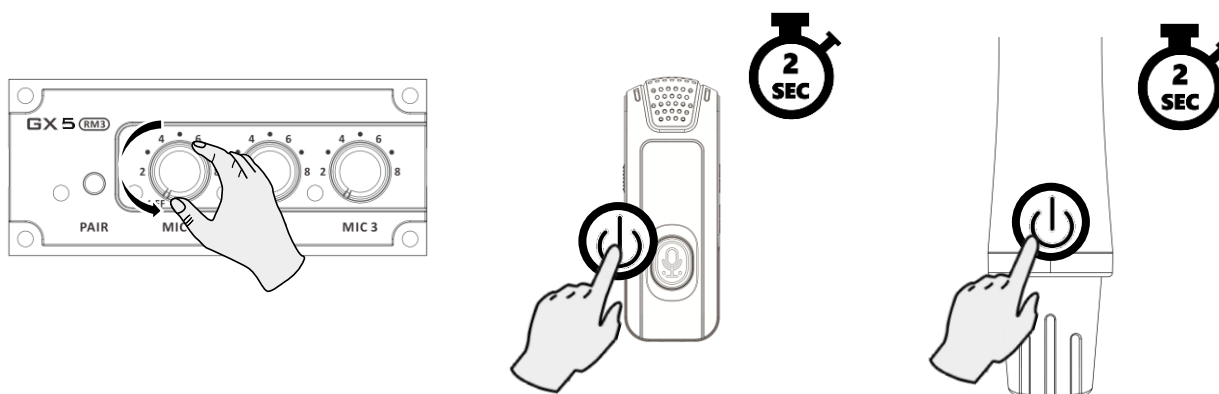

FCC Warning

This device complies with part 15 of the FCC Rules. Operation is subject to the following two conditions:
(1) This device may not cause harmful interference, and (2) this device must accept any interference received, including interference that may cause undesired operation.

Any Changes or modifications not expressly approved by the party responsible for compliance could void the user's authority to operate the equipment.

Note: This equipment has been tested and found to comply with the limits for a Class B digital device, pursuant to part 15 of the FCC Rules. These limits are designed to provide reasonable protection against harmful interference in a residential installation. This equipment generates uses and can radiate radio frequency energy and, if not installed and used in accordance with the instructions, may cause harmful interference to radio communications. However, there is no guarantee that interference will not occur in a particular installation. If this equipment does cause harmful interference to radio or television reception, which can be determined by turning the equipment off and on, the user is encouraged to try to correct the interference by one or more of the following measures:

- Reorient or relocate the receiving antenna.
- Increase the separation between the equipment and receiver.
- Connect the equipment into an outlet on a circuit different from that to which the receiver is connected.
- Consult the dealer or an experienced radio/TV technician for help.

This equipment complies with FCC radiation exposure limits set forth for an uncontrolled environment. This equipment should be installed and operated with minimum distance 20cm between the radiator & your body.

ISED Warning

This device contains licence-exempt transmitter(s)/receiver(s) that comply with Innovation, Science and Economic Development Canada's licence-exempt RsS(s). Operation is subject to the following two conditions:

1. This device may not cause interference.
2. This device must accept any interference, including interference that may cause undesired operation of the device.

This equipment complies with Innovation, Science and Economic Canada's radiation exposure limits set forth for an uncontrolled environment. This equipment should be installed and operated with minimum distance 20cm between the radiator & your body.

Cet appareil contient des émetteurs/récepteurs exemptés de licence qui sont conformes aux flux RsS exemptés de licence d'innovation, sciences et développement économique Canada. Le fonctionnement est soumis aux deux conditions suivantes:

1. Cet appareil ne peut pas causer d'interférences.
2. Ce dispositif doit accepter toute interférence, y compris celle qui peut provoquer un fonctionnement indésirable du dispositif.

Cet équipement est conforme aux limites d'exposition au rayonnement d'innovation, sciences et développement économique Canada établies pour un environnement non contrôlé. Cet équipement doit être installé et utilisé avec une distance minimale de 20cm entre le radiateur et votre corps.