

Package Includes:

- 1* Voice Amplifier
- 1* Wireless Headset Mic
- 1* Charging Cable
- 1* Waistband
- 1* Manual



After-sale service

WinBridge provide one year warranty and lifetime technical support.

Toll Free Hotline: +1 (833) 996-2881
info@wwinbridge.com
http:www.winbridgestore.com

Please be confident that seller support is just a mail away from you in case you find any difficulty, kindly do not hesitate to write back to us if you need any clarification or any kind of support.



9

However, there is no guarantee that interference will not occur in a particular installation. If this equipment does cause harmful interference to radio or television reception, which can be determined by turning the equipment off and on, the user is encouraged to try to correct the interference by one or more of the following measures:

- Reorient or relocate the receiving antenna.
- Increase the separation between the equipment and receiver.
- Connect the equipment into an outlet on a circuit different from that to which the receiver is connected.
- Consult the dealer or an experienced radio/TV technician for help.

The device has been evaluated to meet general RF exposure requirement. The device can be used in portable exposure condition without restriction.

8

FCC Warning:

Any Changes or modifications not expressly approved by the party responsible for compliance could void the user's authority to operate the equipment.

This device complies with part 15 of the FCC Rules. Operation is subject to the following two conditions:

- (1) This device may not cause harmful interference
- (2) this device must accept any interference received, including interference that may cause undesired operation.

Note:

This equipment has been tested and found to comply with the limits for a Class B digital device, pursuant to part 15 of the FCC Rules. These limits are designed to provide reasonable protection against harmful interference in a residential installation. This equipment generates uses and can radiate radio frequency energy and, if not installed and used in accordance with the instructions, may cause harmful interference to radio communications.

7

Please Noted:

1. Please use a DC 5V-2A plug to charge speaker or mic.
2. Plug adapter into 110-240 AC outlet, connect the charging cable end into DC 5V-2A power input on speaker or mic.
3. In order to extend the life of the internal battery, please charge unit regularly even if system is not being used.
4. Please DO NOT over charge the battery by leaving the system plugged in continuously. This will reduce the life of the internal rechargeable battery and cause over heating.

Technical Parameters:

Output power	15W	Charging current	110-240 AC
Battery capacity	2200mAh	Working time	8-10 hours
Mic working time	5 hours	Weight	6.07oz
Size	3.35 × 0.79 × 4.13 inches		

6



WinBridge

Voice Amplifier
User Manual

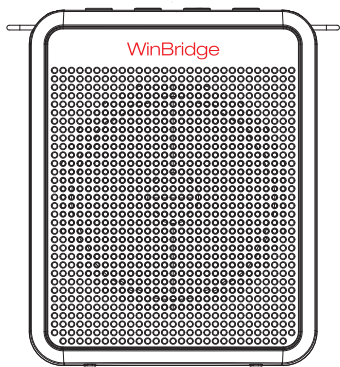

WB008U

Function Illustration

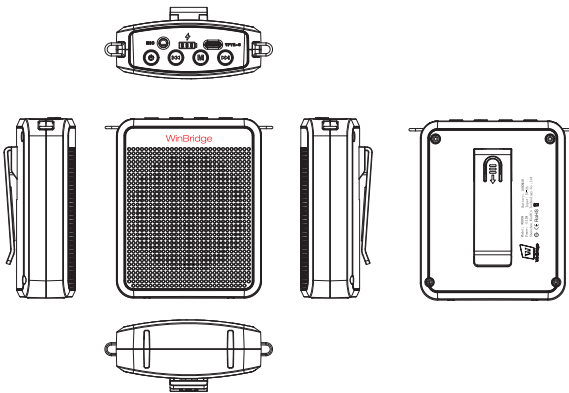

- Ⓜ: Press and hold to turn on or off. In music mode, short press to pause or resume playback.
- Ⓜ: Short press to decrease the volume. In music mode, press and hold to switch to the previous track.
- Ⓜ: Short press to increase the volume. In music mode, press and hold to switch to the next track.
- Ⓜ: Short press to switch to Bluetooth mode.
- 🔊: Microphone Jack
- 🔌: Charging Jack

1

Headset Microphone

(The wireless microphone is detachable)

Two ways of use: As a normal headset microphone, or remove the bracket to become a handheld microphone.

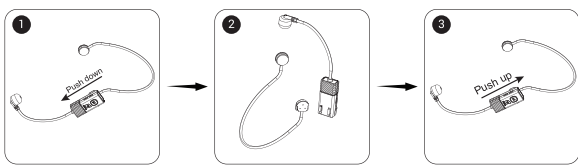

- M Long press to connect or disconnect
- + Short press to increase the volume
- Short press to decrease the volume
- ON/OFF When the microphone is turned on, the LED lights up
- Type-C Type-C charging interface

Microphone and Speaker Auto Pairing:

By default, the microphone and the speaker will automatically pair when powered on.

2

Manually Pairing Headset and Speaker

1. Turn on the speaker, short press the M key to switch to UHF mode and simultaneously voice prompt "UHF mode".
2. Press and hold the M button on the device for about 3 seconds again until you hear the voice prompt: "UHF is waiting for pairing".
3. Turn on the microphone, then press and hold the M button on the microphone until the speaker voice prompts: "UHF paired."
4. Paring is successful, and the microphone can output sound.

How to Connect Bluetooth

Long press Ⓜ to power on, then short press the M button to switch to Bluetooth model, the speaker emits a "beep" prompt. Open your Bluetooth device, such as a phone, and search for Bluetooth named WB008. Click to pair, and when the pairing is successful, the speaker will emit another "beep" prompt. In music model, short Ⓜ to switch to the previous track, short Ⓜ to switch to the next track.

3

How to Wear Voice Amplifier Unit

Take out the voice amplifier unit, fasten the strap to metal hooks on both sides, then tie it on the waist or hung on your shoulder, the strap is adjustable. You can also use the back splint to clinch the voice amplifier on the waistband or trousers.

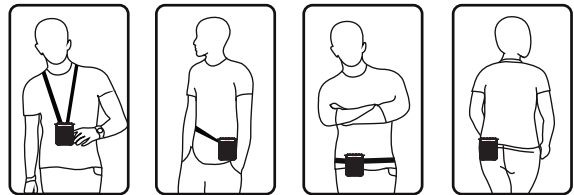
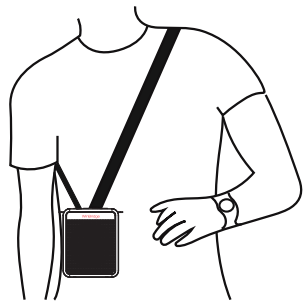

4

How to Charge the Speaker/Headset Mic

1. Connect the charging cable: Insert the Type-C end of the cable into the TYPE-C port on the speaker or headset mic.
2. Plug into a power source: Connect the USB end to a 5V DC adapter (such as a phone charger or computer USB port).
3. Charging starts: The device will begin charging automatically.

Speaker Charging Status:

The battery indicator lights flash while charging, and the indicator lights keep constantly light when fully charged.

Microphone Charging Status:

The red light stays on during charging and turns off when fully charged.

5