

Problem or Damaged Package? DO NOT RETURN TO STORE
Contact us on www.touchlesstrashcan.com/contactus or
call toll free 1-844-660-7978 for instructions.



TOUCHLESS TRASH CAN[®]

NEW DZT13 PLUS-USER MANUAL

This is an all new DZT13 Plus with the following free improvements:

- Extra-wide lid opening, accommodate larger debris
- Deodorizer Compartment with one (1) Carbon Filter pre-installed (lasts up to 3 months)
- Advanced Seal Technology: sealed away lid hinges for longer lasting and easier cleaning
- Air escape holes at the base ensures effortless bag removal
- Battery operated with 4 “D” size batteries (batteries not included)
- AC Adaptor Jack - for use with optional AC Adaptor (AC adaptor not included)

Protect your investment. Register today!
www.TouchlessTrashcan.com/register

Your Product Model No.: DZT13P



TOUCHLESS TRASH CAN[®]

Problem or Damaged Package? DO NOT RETURN TO STORE
Contact us on www.touchlesstrashcan.com/contactus
or call toll free 1-844-660-7978 for instruction.

BRIEF INTRODUCTION:

The Touchless Trashcan creates a germ and odor free automated environment, and uses patented invisible, harmless, infrared technology. There are two buttons, “OPEN” and “CLOSE”, on the front to open and close the lid manually, and an ON/OFF power switch on the back of the trash can. The infrared sensor on the lid (Sensor Zone as shown on PICTURE 1) will automatically open the lid when your hand or debris is about 6 inches/10 cm away. Lid will remain open if sensor detects any object within its radius and will automatically close 4 seconds after object is withdrawn. Touchless Trashcan is available in various sizes online at iTouchless.com

Indicator Light (LED Light)

- (1) The indicator light in the normal waiting mode flashes red once every 3 seconds.
- (2) While the lid is opened by the manual button, it flashes green once every 3 seconds.
- (3) When the batteries are nearly depleted, the indicator light flashes yellow/amber once every 3 seconds

ATTENTION:

1. Do not immerse the Lid Cover in water because it is equipped with many electronic parts. You can clean it with a slightly damp cloth.
2. Do not press or force the trashcan lid to close. Lid will close automatically after your hand or debris is removed from sensor zone.
3. Replace batteries immediately when the indication light turns to yellow/amber to prevent damage to the electronic components from chemicals leaked from old batteries.
4. Avoid direct sunlight on the infrared sensor.
5. Ensure there is enough room to operate the trash can without blocking the opening and closing of the lid.
6. Do not use a power adaptor that is not authorized by iTouchless; it may result in fire, electric shock or injury.
7. Do not use power adaptor and battery at the same time to operate the trash can. It can only be powered by one source at a time.
8. Do not overstuff trash bag. It may cause tearing or difficulty removing.
9. Automatic parts may not be suitable for small children or pets.

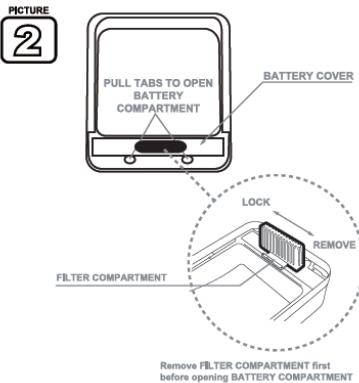
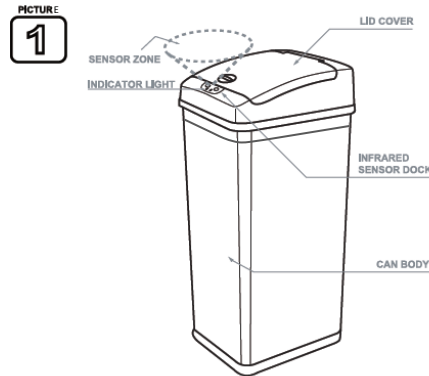

OPERATING INSTRUCTIONS:

- a. Remove Lid Unit from the trash can. Remove Filter Compartment located on the underside of Lid Unit (PICTURE 2) to insert a carbon filter (see **Instruction for using the Active Carbon Filter** on the back side of this user manual). Open battery compartment cover to insert 4 “D” size batteries according to the marks of “positive and negative pole”. Close battery compartment cover and reattach Filter Compartment.
- b. Insert one 13 gallon to 18 gallon garbage bag through Smart Retainer Ring and wrap the top part of the garbage bag over the Ring (STEP 1). Put the Ring onto the top edge of the can body (STEP 2). Video instruction at www.touchlesstrashcan.com/ring.html
- c. Place Lid Unit onto the can body and make sure it is securely attached.
- d. Turn on the power switch on the back of the Lid Unit (PICTURE 4). A red Indicator Light will turn on for 3 seconds. It will flash once every 3 seconds to show that the system is on and ready.
- e. Place your hand or any object 6 inches above the Infrared Sensor on the front of Lid Unit to open. The Lid will remain open if it detects objects within the Sensor Zone. It will close in 4 seconds after your hand or object moves away.
- f. If you press the open button manually, the lid will open, and remain open for 5 minutes before closing automatically - unless you press the close button manually. The trash can will change back to automatic mode.

HOW DOES SMART RETAINER RING WORK?



STEP 1

Place garbage bag inside trash can, then wrap the top of the bag over Ring.



STEP 2

Secure Ring onto the edge of the can body.



SMART RETAINER RING

TOP EDGE

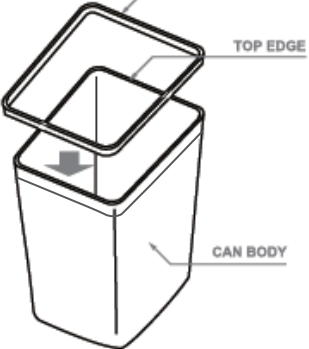

BACK POWER SWITCH

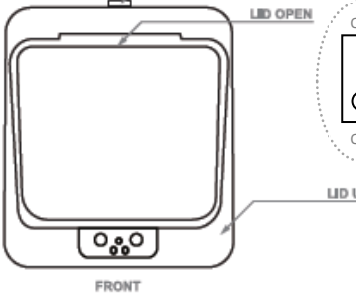

NEW DZT13 PLUS-USER MANUAL

INSTRUCTION FOR USING THE ACTIVE CARBON FILTER

The new Odorless Touchless Trash Can is equipped with a 3D Filter Compartment paired with the powerful Active Carbon Filter to eliminate odors up to 90% in the trash can. One (1) replaceable Active Carbon Filter is pre-installed inside the 3D Filter Compartment. Please follow instructions below to maximize the filter power.

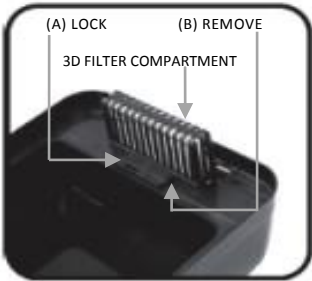

Fig. 1

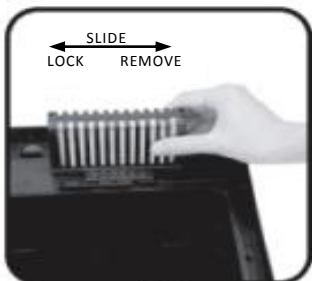

Fig. 2



Fig. 3

1. Remove and turn Lid Cover upside down with power switch turned off.
2. Slide 3D Filter Compartment (Fig.1) to the right (Fig.2) to remove the filter compartment.
3. Remove Active Carbon Filter from the filter compartment.
4. Tear open and throw away the clear plastic bag covering the Active Carbon Filter pouch (**Do NOT cut open** the filter pouch).
5. Insert the Active Carbon Filter pouch (Fig.3) back into the filter Compartment.
6. Return the 3D Filter Compartment to Lid Cover (Fig. 1) and slide to the left (Fig.2) to lock the filter Compartment.
7. Replace Active Carbon Filter every 3 months or when the odor becomes too strong.
8. Order the most updated version of Active Carbon Filter online at www.trashcanparts.com.

Cleaning Tips:

- 3D filter Compartment can be washed if it gets dirty
- Used Active Carbon Filter pouch should be disposed in a trash can

iTouchless® ©2011 iTouchless Housewares & Products, Inc. All Rights Reserved.

WARNING: Since this product opens automatically, it may not be suitable for small children or pets.

MADE IN CHINA

TOUCHLESS TRASH CAN®

TROUBLESHOOTING Q & A

Problem	Solution
1. The trash can is brand new, and only works occasionally	Peel off the thin, transparent protector/sticker on top of the sensor eye. If the lid still doesn't work regularly, try a new set of batteries. Then follow the General Troubleshooting Steps below.
2. The lid stays open or lid opens and closes continuously	The sensor eye may be affected by dirt, stain, dust, moisture or reflection. Move the trash can to a different location or turn the trash can slightly so that the sensor faces another direction, and follow the General Troubleshooting Steps below.
3. Grinding noise when the lid opens/closes	This can be caused by broken gears, lid hinge <ul style="list-style-type: none">• Check the hinges that connect the lid if it is broken• Follow the General Troubleshooting Steps below• Visit Trashcanparts.com to order a new lid unit• Contact us through TouchlessTrashcan.com for warranty service
4. The lid does not open/close	If you are using Batteries: <ul style="list-style-type: none">• Make sure batteries are inserted correctly and close the battery cover firmly• Turn power switch to "ON" position to see if there's any indication light If you are using AC Power Adaptor: <ul style="list-style-type: none">• Unplug the adaptor and insert new alkaline batteries to see if the lid works on battery• If the trashcan works with batteries, the AC adaptor may be broken
5. I wave my hand over the sensor eye, but the lid does not open	It is not a motion sensor, you should hold your hand or object steadily (do not wave your hand) within 4-6 inches on top of the sensor eye for it to detect and open.
6. Why is the indicator light flashing in yellow/amber color?	The battery power is low. Replace all batteries with a new set of alkaline batteries. Do not use rechargeable batteries or mix old batteries.

General Troubleshooting Steps:

- (1) Turn off power switch, remove battery or AC power adaptor, then rub and wipe clean the sensor area with a soft damp cloth and dry it immediately with a soft dry cloth. Re-insert batteries or plug in AC adaptor (**DO NOT USE** battery and AC adaptor at the same time).
- (2) Place trash can in an open area where nothing is blocking or within 10 inches of the sensor eye. Make sure no sunlight or spotlight shines on the sensor. Turn on the power and try opening lid again.
- (3) If trash can is still not working correctly, remove the batteries or AC adaptor. Let trash can sit for at least 2 hours to reset. Try opening lid after reset.

If your trash can is still not working after trying these troubleshooting steps, please contact us through TouchlessTrashcan.com for warranty service.

Problem or Damaged Package? DO NOT RETURN TO STORE
Contact us on www.iTouchless.com/contacts/ or
call toll free 1-844-660-7978 for instruction.

ORDER ACCESSORIES AND PARTS:

To order accessories and parts, please visit website www.trashcanparts.com

- Official AC Power Adaptor
- Trash Bag Retainer Ring
- Battery Compartment Cover
- Stainless Steel Cleaner
- Premium Trash Bags
- Carbon Filter Refills and more...

For other iTouchless innovative sensor products, please visit us at www.iTouchless.com

ONE (1) YEAR LIMITED WARRANTY

Touchless Trashcan is distributed by iTouchless Housewares & Products, Inc. (iTouchless) with the highest quality components and most advanced technologies available. The trash can is warranted to be free from defects in material and workmanship, given normal use and care, for 365 days from the date of the original purchase with proof of purchase within the United States and Canada. iTouchless will only honor warranty requests from orders placed with our authorized dealers. Items sold as used, floor sample or refinished are sold solely under the terms and conditions of the selling party; iTouchless will not warrant such purchase. iTouchless will repair or replace a working condition Trash Can thereof which fails as the result of such a defect during the warranty period.

The warranty is the customers' exclusive remedy for product defect and does not apply to:

- User modification
- Attachments to product by user that causes damage
- Any product, on which the seals and/or serial numbers have been broken, removed, tampered with, defaced or altered in any manner
- Damage caused by abuse, misuse, accident, water or theft

Except as stated above, iTouchless makes no express or implied warranties as to any product, in particular, makes no warranty of merchantability or of fitness for any particular purpose. iTouchless shall not be liable for consequential or incidental damages arising from any product defect. Our Liability is limited to the replacement of any defective product. iTouchless expressly disclaims all warranties not satisfied in this limited warranty. Any implied warranties that may be imposed by law are limited to the terms of this limited warranty. The Plastic Bucket and Battery Cover are not covered by this warranty.

If Trash Can should fail during the warranty period, contact us through <http://www.TouchlessTrashcan.com/contactus> to request a Repair # before returning to us. We WILL NOT ACCEPT packages without a Repair#. Remember to return package FREIGHT PREPAID by an insured carrier such as UPS and include a check for the return postage along with authorized repair #. Please refer to the warranty email provided by iTouchless for details. All warranty fees (including return postage) are subject to location, and fee references are as following: for Contiguous 48 U.S. States \$9.95 and up, for Alaska and Hawaii \$29.95 and up, for Canada \$19.95 and up. iTouchless will not cover any warranty service postage fee.

Return Address:
iTouchless Housewares & Products, Inc
23497 Eichler Street, Unit A, Hayward, CA 94545, USA
Attn: Product Return Repair # _____

Subject to the above conditions, we will repair or ship you a working Lid Cover within 30 working days after receipt. This warranty gives you specific legal rights, and you may also have other rights that vary from state to state and province to province. For more information, please visit our website at www.TouchlessTrashcan.com

Thank you for purchasing the Touchless Trashcan@!