

KLITE

## LED Lamp User Manual



### LED Lamp User Manual (EN)

1. Search "Smart Life" or "Tuya Smart" in the Apple Store and major application markets to download the APP.
- \* The Smart Life APP is compatible with Android 4.0 and iOS 8.1 and higher version. The Tuya Smart APP is compatible with Android 4.4 and iOS 9.0 and higher version. Smart Life and Tuya Smart are 3.17.0 and higher version.



2. The device distribution network only supports 2.4GHz Wi-Fi and Bluetooth connection. Please turn on the mobile phone Bluetooth and connect 2.4GHz Wi-Fi before adding the device.

3. Open the APP to register or log in to your account.  
**Registration:** You can complete the registration by mobile phone number or email. The country area will follow the settings of the mobile phone system, you can also manually change the country area (the country area cannot be changed after the registration is completed).

**Login:** If you already have an App account, click "Log in with an existing account" under "Create a new account", enter the mobile phone number or email you used to register, enter the password to log in to the system, and the iOS system can use Apple ID login.

4. Click the "Add Device" button in the center on the device list page or click the "+" button on the upper right. If the phone's Bluetooth is turned on, the device information will automatically pop up. You can select "Go to Add" device to jump directly to the Wi-Fi password to complete the network connection. If the device information is not popped up, you can select "Add Manually" or "Auto Scan" to add.

#### 1. Add Manually-Lighting-Lighting (BLE+Wi-Fi)

A. EZ Mode(Default) or Bluetooth Mode: on-off-on-off-on (Interval 2 Seconds not too short), when the light flashes rapidly for 3.5 seconds, the light flashes quickly (0.5 seconds) and then start to connect network process.

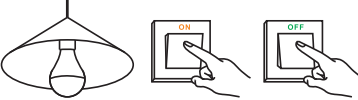

B. AP Mode: If the home network is 2.4GHz and 5GHz mixed, it is recommended that you use this connection method: on-off-on-off-on (Interval 2 Seconds not too short), when the light flashes rapidly for 3.5 seconds, then off-on-off-on-off (Interval 2 Seconds not too short). After waiting for 3.5 seconds, the light flashes slowly for 2 seconds stable, found in the "Wi-Fi" settings of the phone, Wi-Fi has started with "Smart Life" and click to link, after linking successfully, return to the APP and start to connect network process.

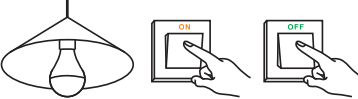

2. "Auto Scan" mode when the light flashes rapidly for 0.5 seconds or the light flashes slowly for 2 seconds, select "Auto Scan" to search for device automatically and start to connect network process.

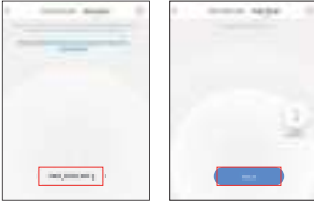

5. On the last flashing or slow flashing state, you need to enter the Wi-Fi password to complete the network connection. (Only supports 2.4GHz Wi-Fi network).

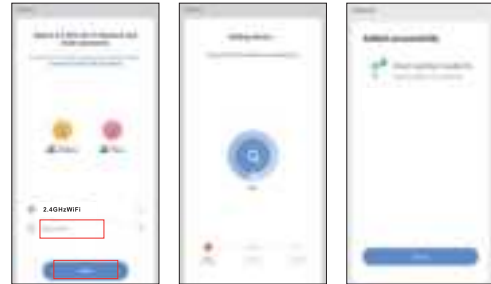

Note: The network connection time of the device within 3 minutes. If the network hasn't connected successfully within 3 minutes, and the light bulb is always on. Please re-connect according to steps 4 and 5 for re-connection.

6. After connect with the network successfully, the light are always on, the scene, mode, timing and other functions can be freely selected in the APP.



7. Find more services in the APP "Me" menu, connect to Alexa, Google Assistant can use voice control services, click on the service you need, and connect to a third-party device according to the operation guide.

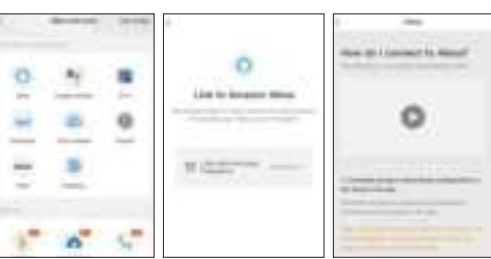

8. Share device: After the device is successfully connected, you can add the account to share the device to achieve multi-user control of the device.

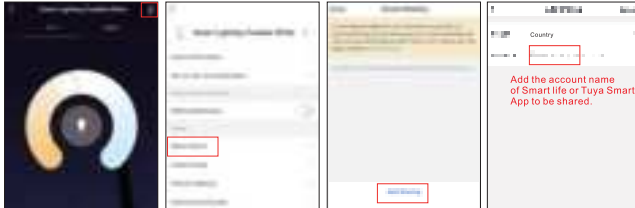

9. In the APP "Me" menu, you can learn about common problems and feedback.

#### FCC WARNING

Any Changes expressly or modifications not approved by the party responsible for compliance could void the user's authority to operate the equipment. This device complies with part 15 of the FCC Rules. Operation is subject to the following two conditions: (1) The device may not cause harmful interference and (2) the device must accept any interference received, including interference that may cause undesired operation.

FCC Radiation Exposure Statement:

This equipment complies with FCC radiation exposure limits set forth for an uncontrolled environment.

This transmitter must not be co-located or operating in conjunction with any other antenna or transmitter.

This equipment must be installed and operated with minimum distance 20cm between the radiator and your body.

Note: This equipment has been tested and found to comply with the limits for a Class B digital device pursuant to part 15 of the FCC Rules. These limits are designed to provide reasonable protection against harmful interference in a residential installation. This equipment generates, uses and can radiate radio frequency energy and, if not installed and used in accordance with the instructions, may cause harmful interference to radio communications. However, there is no guarantee that interference will not occur in a particular installation. If this equipment does cause harmful interference to radio or television reception, which can be determined by turning the equipment off and on, the user is encouraged to try to correct the interference by one or more of the following measures:

- Reorient or relocate the receiving antenna.
- Increase the separation between the equipment and receiver.
- Connect the equipment into an outlet on a circuit different from that to which the receiver is connected.
- Consult the dealer or an experienced radio/TV technician for help.

#### Precautions of the lamp

—Please read the lamp or push against it.

—Please don't disassemble the lamp, don't make alterations.

—Please don't use for dimming.

—All models don't use for dimming.

—Not suitable for electronic switch or remote control.

—Don't use fan without ventilation openings.

—Use only in indoor areas.

—Don't use as emergency lighting.

—To avoid electrical shock, don't install in damp or wet locations.

—Don't touch the lamp when it is hot.

—If the lamp is damaged, replace by a new one and don't try to repair it in other places.

—For lamps with a weight significantly higher than that of the lamp for which they are intended, attention should be given to the fact that the increased weight may reduce the mechanical stability of certain luminaires and luminaires and may impair correct working and fire protection.

—Make sure the available voltage is kept within the rated range.

#### Symbols

—This lamp is not suitable for operation in wet environment.

—This lamp is not suitable for operation in dimming circuits.

—This marking indicates that this product should not be disposed with other household waste throughout the EU. To prevent possible harm to the environment or human health from uncontrolled waste disposal, please follow the instructions for disposal of waste.

—This marking indicates that this product should not be disposed with other household waste throughout the EU. To prevent possible harm to the environment or human health from uncontrolled waste disposal, please follow the instructions for disposal of waste.

—This marking indicates that this product should not be disposed with other household waste throughout the EU. To prevent possible harm to the environment or human health from uncontrolled waste disposal, please follow the instructions for disposal of waste.

—This marking indicates that this product should not be disposed with other household waste throughout the EU. To prevent possible harm to the environment or human health from uncontrolled waste disposal, please follow the instructions for disposal of waste.

—This marking indicates that this product should not be disposed with other household waste throughout the EU. To prevent possible harm to the environment or human health from uncontrolled waste disposal, please follow the instructions for disposal of waste.

—This marking indicates that this product should not be disposed with other household waste throughout the EU. To prevent possible harm to the environment or human health from uncontrolled waste disposal, please follow the instructions for disposal of waste.

—This marking indicates that this product should not be disposed with other household waste throughout the EU. To prevent possible harm to the environment or human health from uncontrolled waste disposal, please follow the instructions for disposal of waste.

—This marking indicates that this product should not be disposed with other household waste throughout the EU. To prevent possible harm to the environment or human health from uncontrolled waste disposal, please follow the instructions for disposal of waste.

—This marking indicates that this product should not be disposed with other household waste throughout the EU. To prevent possible harm to the environment or human health from uncontrolled waste disposal, please follow the instructions for disposal of waste.

—This marking indicates that this product should not be disposed with other household waste throughout the EU. To prevent possible harm to the environment or human health from uncontrolled waste disposal, please follow the instructions for disposal of waste.

—This marking indicates that this product should not be disposed with other household waste throughout the EU. To prevent possible harm to the environment or human health from uncontrolled waste disposal, please follow the instructions for disposal of waste.

—This marking indicates that this product should not be disposed with other household waste throughout the EU. To prevent possible harm to the environment or human health from uncontrolled waste disposal, please follow the instructions for disposal of waste.

—This marking indicates that this product should not be disposed with other household waste throughout the EU. To prevent possible harm to the environment or human health from uncontrolled waste disposal, please follow the instructions for disposal of waste.

—This marking indicates that this product should not be disposed with other household waste throughout the EU. To prevent possible harm to the environment or human health from uncontrolled waste disposal, please follow the instructions for disposal of waste.

—This marking indicates that this product should not be disposed with other household waste throughout the EU. To prevent possible harm to the environment or human health from uncontrolled waste disposal, please follow the instructions for disposal of waste.

—This marking indicates that this product should not be disposed with other household waste throughout the EU. To prevent possible harm to the environment or human health from uncontrolled waste disposal, please follow the instructions for disposal of waste.

—This marking indicates that this product should not be disposed with other household waste throughout the EU. To prevent possible harm to the environment or human health from uncontrolled waste disposal, please follow the instructions for disposal of waste.

—This marking indicates that this product should not be disposed with other household waste throughout the EU. To prevent possible harm to the environment or human health from uncontrolled waste disposal, please follow the instructions for disposal of waste.

—This marking indicates that this product should not be disposed with other household waste throughout the EU. To prevent possible harm to the environment or human health from uncontrolled waste disposal, please follow the instructions for disposal of waste.

—This marking indicates that this product should not be disposed with other household waste throughout the EU. To prevent possible harm to the environment or human health from uncontrolled waste disposal, please follow the instructions for disposal of waste.

—This marking indicates that this product should not be disposed with other household waste throughout the EU. To prevent possible harm to the environment or human health from uncontrolled waste disposal, please follow the instructions for disposal of waste.

—This marking indicates that this product should not be disposed with other household waste throughout the EU. To prevent possible harm to the environment or human health from uncontrolled waste disposal, please follow the instructions for disposal of waste.

—This marking indicates that this product should not be disposed with other household waste throughout the EU. To prevent possible harm to the environment or human health from uncontrolled waste disposal, please follow the instructions for disposal of waste.

—This marking indicates that this product should not be disposed with other household waste throughout the EU. To prevent possible harm to the environment or human health from uncontrolled waste disposal, please follow the instructions for disposal of waste.

—This marking indicates that this product should not be disposed with other household waste throughout the EU. To prevent possible harm to the environment or human health from uncontrolled waste disposal, please follow the instructions for disposal of waste.

—This marking indicates that this product should not be disposed with other household waste throughout the EU. To prevent possible harm to the environment or human health from uncontrolled waste disposal, please follow the instructions for disposal of waste.

—This marking indicates that this product should not be disposed with other household waste throughout the EU. To prevent possible harm to the environment or human health from uncontrolled waste disposal, please follow the instructions for disposal of waste.

—This marking indicates that this product should not be disposed with other household waste throughout the EU. To prevent possible harm to the environment or human health from uncontrolled waste disposal, please follow the instructions for disposal of waste.

—This marking indicates that this product should not be disposed with other household waste throughout the EU. To prevent possible harm to the environment or human health from uncontrolled waste disposal, please follow the instructions for disposal of waste.

—This marking indicates that this product should not be disposed with other household waste throughout the EU. To prevent possible harm to the environment or human health from uncontrolled waste disposal, please follow the instructions for disposal of waste.

—This marking indicates that this product should not be disposed with other household waste throughout the EU. To prevent possible harm to the environment or human health from uncontrolled waste disposal, please follow the instructions for disposal of waste.

—This marking indicates that this product should not be disposed with other household waste throughout the EU. To prevent possible harm to the environment or human health from uncontrolled waste disposal, please follow the instructions for disposal of waste.

—This marking indicates that this product should not be disposed with other household waste throughout the EU. To prevent possible harm to the environment or human health from uncontrolled waste disposal, please follow the instructions for disposal of waste.

—This marking indicates that this product should not be disposed with other household waste throughout the EU. To prevent possible harm to the environment or human health from uncontrolled waste disposal, please follow the instructions for disposal of waste.

—This marking indicates that this product should not be disposed with other household waste throughout the EU. To prevent possible harm to the environment or human health from uncontrolled waste disposal, please follow the instructions for disposal of waste.

—This marking indicates that this product should not be disposed with other household waste throughout the EU. To prevent possible harm to the environment or human health from uncontrolled waste disposal, please follow the instructions for disposal of waste.

—This marking indicates that this product should not be disposed with other household waste throughout the EU. To prevent possible harm to the environment or human health from uncontrolled waste disposal, please follow the instructions for disposal of waste.

—This marking indicates that this product should not be disposed with other household waste throughout the EU. To prevent possible harm to the environment or human health from uncontrolled waste disposal, please follow the instructions for disposal of waste.

—This marking indicates that this product should not be disposed with other household waste throughout the EU. To prevent possible harm to the environment or human health from uncontrolled waste disposal, please follow the instructions for disposal of waste.

—This marking indicates that this product should not be disposed with other household waste throughout the EU. To prevent possible harm to the environment or human health from uncontrolled waste disposal, please follow the instructions for disposal of waste.

—This marking indicates that this product should not be disposed with other household waste throughout the EU. To prevent possible harm to the environment or human health from uncontrolled waste disposal, please follow the instructions for disposal of waste.

—This marking indicates that this product should not be disposed with other household waste throughout the EU. To prevent possible harm to the environment or human health from uncontrolled waste disposal, please follow the instructions for disposal of waste.

—This marking indicates that this product should not be disposed with other household waste throughout the EU. To prevent possible harm to the environment or human health from uncontrolled waste disposal, please follow the instructions for disposal of waste.

—This marking indicates that this product should not be disposed with other household waste throughout the EU. To prevent possible harm to the environment or human health from uncontrolled waste disposal, please follow the instructions for disposal of waste.

—This marking indicates that this product should not be disposed with other household waste throughout the EU. To prevent possible harm to the environment or human health from uncontrolled waste disposal, please follow the instructions for disposal of waste.

—This marking indicates that this product should not be disposed with other household waste throughout the EU. To prevent possible harm to the environment or human health from uncontrolled waste disposal, please follow the instructions for disposal of waste.

—This marking indicates that this product should not be disposed with other household waste throughout the EU. To prevent possible harm to the environment or human health from uncontrolled waste disposal, please follow the instructions for disposal of waste.

—This marking indicates that this product should not be disposed with other household waste throughout the EU. To prevent possible harm to the environment or human health from uncontrolled waste disposal, please follow the instructions for disposal of waste.