



# YOSHIMURA

RESEARCH&DEVELOPMENT OF AMERICA, INC.

5420 DANIELS STREET STE A, CHINO CA., 91710 · (800) 634-9166 · (909) 628-4722 · FAX (909) 591-2198

[www.yoshimura-rd.com](http://www.yoshimura-rd.com)

## FRONT TURN SIGNAL ADAPTER PLATES

### **Honda CRF300L Rally** **074BG123410**

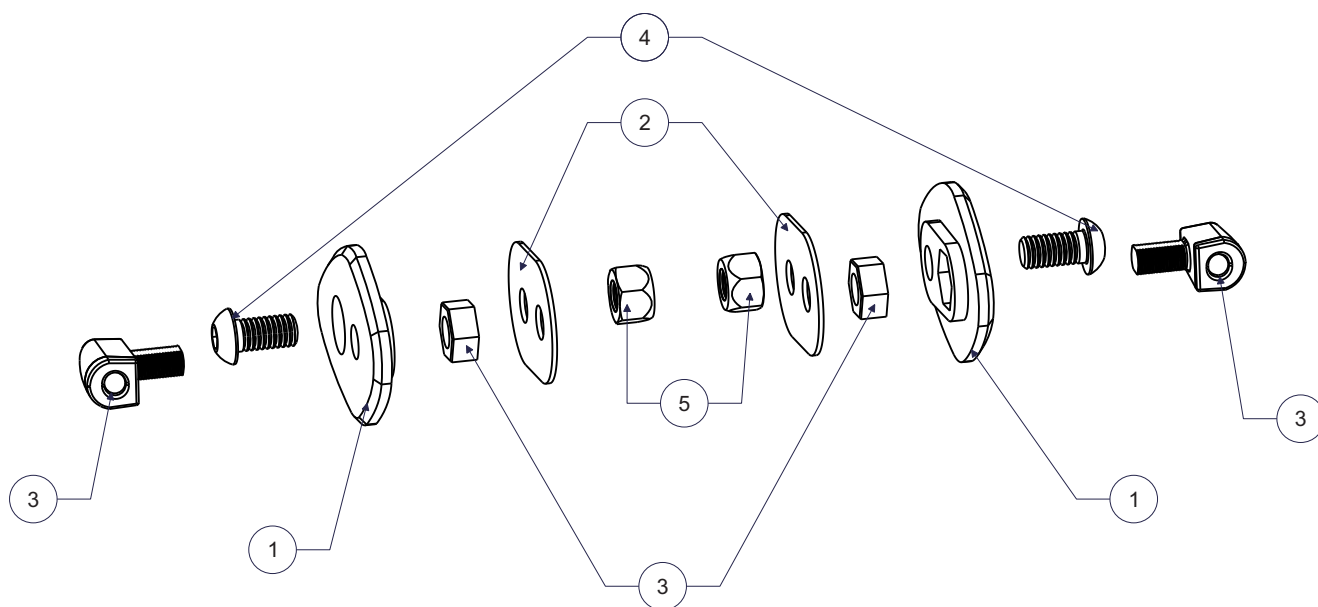

No.	Item	Description	Qty.
1	074BG123410-F	Front Turn Signal Plate	2
2	074BG121220-B	Turn Signal Backing Plate	2
3	072BGMICRTSR	Micro LED Turn Signal Kit	1
4	M6X12BHS	6mm x 12mm Button Head Cap Screw	2
5	6MMLN	M6 X 1.0 Nylon Lock Nut	2

## Removal

1. Follow steps in factory service / owners manual to remove the windscreen and headlight assembly.
2. Locate, identify, and disconnect the turn signal connectors from the harness.
3. Remove left and right turn signals from the turn signal holders.
4. Cut the turn signal wires 4" from the male connector and strip the ends.

Note: Daytime Running Light functionality will be lost with the micro turn signals. Factory Daytime Running Light wires have a white stripe along with the color corresponding to the side they're on.

## Installation

1. Place the micro turn signal in the front hole and plastic hex nut in the inside pocket of *074BG123410-F*, front turn signal plate.

Note: Proper positioning of the micro turn signal in the adapter plate is dependent on the orientation of the plastic nut. If the turn signal is not facing forwards, remove and rotate the plastic nut in the adapter plate pocket and re-install the turn signal. Repeat until turn signal is facing forward.

Rear of bike

Front of bike

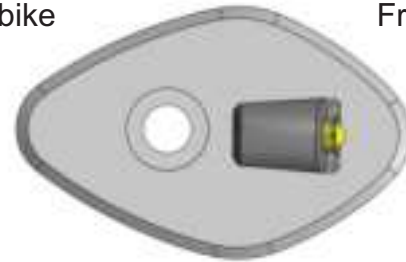

### Right Side Example Shown

2. Insert the turn signal adapter plate into the turn signal holder from the outside.
3. Insert *074BG121220-B* metal plate on the inside of the turn signal holder and route the turn signal wires through the corresponding hole. Secure the metal plate with the *6MMLN* locking nut.

Note: Inserting the *M6X12BHS* screw into the adapter plate's first may assist with the aligning and mounting of the metal inner plate.

4. Using the solder shrink connectors supplied in the micro turn signal kit, connect turn signal wires to micro light wires as follows:

Right (Blue Connector):  
Green (Harness) - Black  
Blue (Harness) - Blue

Left (Orange Connector):  
Green (Harness) - Black  
Orange (Harness) - Blue

- a) Strip the stock turn signal wire ends 1/4" - 1/2" and insert into *BN-SSS-22-18*, solder shrink connectors provided in the kit.
- b) Center the spliced wire ends in the middle and using a heat gun or lighter, apply heat evenly on the outer edges of the solder shrink connector to shrink and hold wires in place.
- c) Making sure that the stripped ends are centered, heat the center of the solder shrink connector evenly until the solder begins to liquify.
- d) Allow to cool completely and tug both ends of the wires to verify that connection is secured.

Scan for link to solder shrink connector instruction video.



Scan QR code on micro turn signal packaging for wiring diagram.

Note<sup>1</sup>: The white running light wire and red brake light wire on the micro signals will not be used. Bundle back up and tuck away.

Note<sup>2</sup>: A red front light is prohibited in most states. Check with local laws and regulations prior to installation.

5. Repeat steps for opposite side.
6. Check for proper function of turn signals and that all components are secure prior to riding.
7. Re-install the headlight assembly and windscreen using the reverse steps of removal.