



PRODUCT #FD60-U1

24 HOUR MECHANICAL TIMER



ENERGY
SAVING

Please keep this handbook

www.bn-link.com

PRODUCTS VIEW

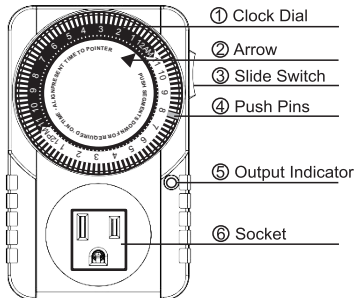

- ① **Clock Dial:** Black Part=12AM-12PM Hours; White Part=12PM-12AM Hours.
- ② **Arrow:** Indicates the current time of day.
- ③ **Slide Switch:** Slide the switch up to ON position; Slide the switch down to Timer position.
- ④ **Push Pins:** Each pin represents 15 minutes. Pins down = ON; Pins up = OFF.
- ⑤ **Output Indicator:** Indicator illuminates when there is power output in the socket.
- ⑥ **Socket:** Only intended to be used with a grounded device.

RATINGS

Rated Voltage:

125V, 60Hz

Max.Loading:

1875W, 15A Tungsten &Resistive, 1/2HP

WARNING

- Electrical shock hazard
- Use a grounded outlet
- Follow local electrical codes
- For indoor use only
- Keep children away
- Unplug timer before cleaning
- Fully insert plug
- Do not use in wet locations
- Do not exceed electrical ratings

APPLICATIONS

- | | |
|-------------------|---------------------|
| • Lighting | • Cooling systems |
| • Heating systems | • Indoor sprinklers |
| • Humidifiers | • Aquariums |
| • Nebulizers | • Ventilators |

OPERATING INSTRUCTIONS

Step1. Set a period of time for the unit to be “ON”

Make sure all pins are in the UP position before beginning.

Locate the black pins and push them down at the marked times when the attached device is to be “ON”. Each pin represents a 15-minute time interval.

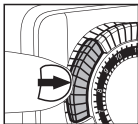

Example: “ON” time is 7:00AM, “OFF” time is 9:30AM. Push down all of the pins between 7:00AM and 9:30AM.

Note: Pins are black slices around the dial.

Step2. Set the “CURRENT TIME”

Rotate the entire black push-pin dial clockwise until the arrow aligns with the current time of day on the dial.

Example: It is 12:00AM, please rotate the dial clockwise until the arrow aligns 12AM on the dial.

Note: Please pay attention to AM/PM.

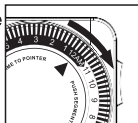

Step3. Set “BYPASS SWITCH”

When the switch is in the “TIMER ” position, the unit will automatically turn your attached device ON and OFF according to the programmed time. When the switch is in the “ON” position, the unit will bypass the programming and your attached device will remain ON.

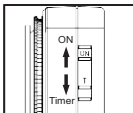

Step4. Plug the unit into an electrical outlet

The unit will rest against the outlet.

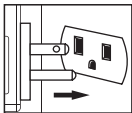

Step5. Attach one device to the unit

Plug a device into the outlet in the front of the unit. Make sure the attached device is switched ON.

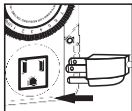

HELPFUL TIPS

1. This timer repeats the settings daily.
2. To push down or pull up the black pins, use your finger or the tip of a small instrument such as a pen or pencil.

3. You can set up to 48 different “ON” and “OFF” times in a 24-hour period. Pins pressed down represent the “ON” time, pins in the up position represent the “OFF” time.
4. Switching the unit to “ON” will bypass programming, however, the timer dial will continue to rotate and maintain the current time.
5. Unit will stop operating if the power goes out. Once power is resumed, reset the time of day as explained in Step 2 of the instructions.

TROUBLESHOOTING

● **PROBLEM:**

Appliances do not turn on as programmed.

○ **POSSIBLE CAUSE:**

Connected appliances are not in “ON” position; they are not functioning; timer is not receiving power, or “BYPASS SWITCH” is in the “ON” position.

○ **CORRECTIVE ACTION:**

Ensure the connected appliances are functional by plugging them directly into the outlet. Be sure the connected appliances are in the “ON” position if they have their own switch. Make sure the power outlet which the timer is plugged into is active. Check that the “BYPASS SWITCH” is in the “TIMER” position.

- **PROBLEM:**

Appliances come on before the actual time.

- **POSSIBLE CAUSE:**

“CURRENT TIME” was not set properly.

- **CORRECTIVE ACTION:**

Refer to step 2 of this manual. Be sure “CURRENT TIME” is set in the black section on the timer dial if the “CURRENT TIME” is in the “AM”. The “CURRENT TIME” should be set in the white section on the timer dial if the “CURRENT TIME” is in the “PM”.

BN-LINK INC.

12991 Leffingwell Avenue, Santa Fe Springs
Customer Service Assistance: 1.909.592.1881

E-mail: support@bn-link.com

[Http://www.bn-link.com](http://www.bn-link.com)

Hours: 9AM - 5PM PST, Mon - Fri

Designed in California Made in China