



Meaningful Innovation.

WEEE Number: 80133970

## INSTALLATION INSTRUCTION

### WIFI MINI SMART SOCKET-USB

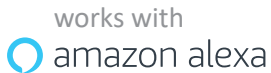

**02** YEAR  
**WARRANTY\***

#### INTRODUCTION & WARRANTY

Thank you for selecting and buying V-TAC Product. V-TAC will serve you the best. Please read these instructions carefully before starting the installation and keep this manual handy for future reference. If you have any other query, please contact our dealer or local vendor from whom you have purchased the product. They are trained and ready to serve you at the best. The warranty is valid for 2 years from the date of purchase. The warranty does not apply to damage caused by incorrect installation or abnormal wear and tear. The company gives no warranty against damage to any surface due to incorrect removal and installation of the product.

**Note:**

1. This device requires Wi-Fi Frequency 2.4Ghz
2. Indoor use only
3. Working Condition: -20°C to 60°C
4. Store Humidity: RH10% - RH80%
5. Operating frequency (maximum transmitted power) 2400MHz -2483.5MHz (20dBm)

## SPECIFICATIONS

Model Number	SKU	Input Voltage	Max Current	Wireless Standard	Material	Max Watt
VT-5002	8416	AC:90-250V, 50/60Hz	10A	Wi-Fi 2.4Ghz	PC	2200
VT-5002-BS	8428	AC:90-250V, 50/60Hz	10A	Wi-Fi 2.4Ghz	PC	2200

## APP INSTALLATION

Download eWeLink APP by via APP Store Google Play Store (OR) Scan the below QR code to download the eWeLink APP, FAQ



GOOGLE PLAY

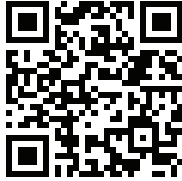

IOS



FAQ



MULTI-LANGUAGE  
MANUAL

## WARNING

1. Please make sure to turn off the power before starting the installation.
2. Must be installed by professional electrician.
3. Plug in fully to the wall outlet while using
4. Do not insert a conductor or other tools to the socket hole
5. Do not use in bathroom and other damp locations
6. Please ensure the security of the electricity, resistive load current cannot be higher than 10A
7. Please keep the device out of the reach of children to avoid danger



This marking indicates that this product should not be disposed of with other household wastes.



Caution, risk of electric shock.

## INSTALLATION

1. Switch OFF the power.
2. Plug in the smart plug, and switch ON The power.
3. If the indicator light blinks on the smart plug, it indicates the smart plug is working properly.

**Step 1: Open the eWeLink App and register. If you already have an existing account with eWeLink, please proceed to logging in.**

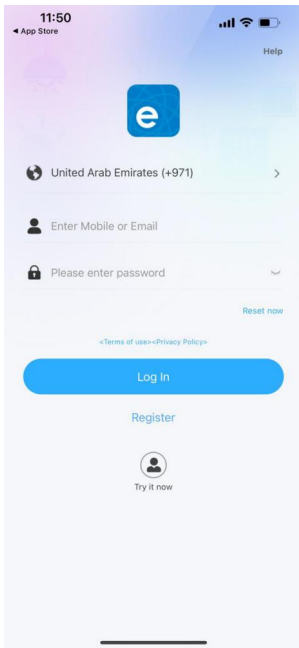

**Step 2: To Add A New device tap on the “+” sign(as shown)**

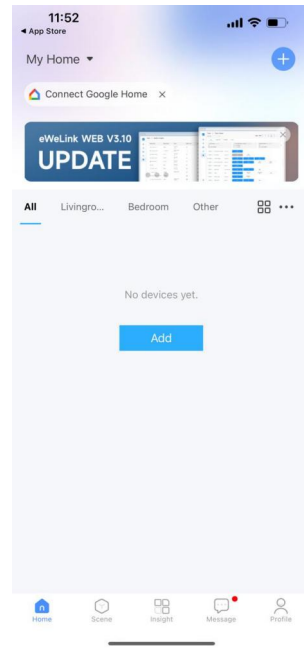

**Step 3: Make sure your Smart device is powered ON**

- 1) Tap and hold on the power button for 5 seconds to make the device available in pairing mode. Once in pairing mode the LED will start blinking 3 times repeatedly.
- 2) Tap on Next to start the pairing of device with the app. (Shown in the image)

**Note: If you are facing any trouble while pairing in Quick Pairing mode please try to pair the device in Compatible Pairing Mode (Click on the link as shown on the image).**

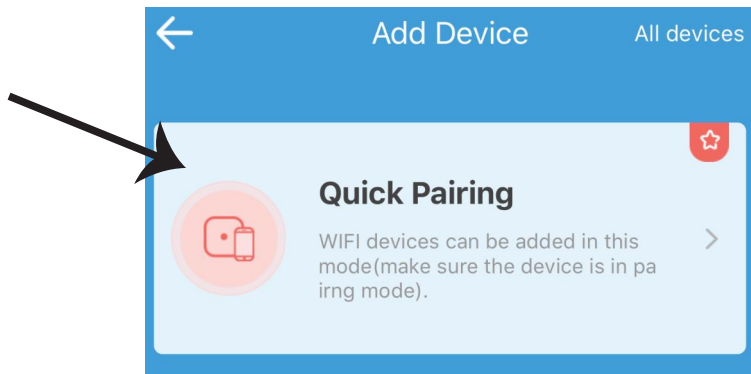

**Step 4: Select your Wifi name and enter the password and tap on Next.**

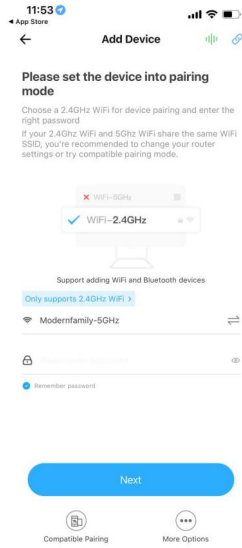

**Step 5: Give a name to your device (Ex: Smart Plug/ smart switch) & tap on complete.**

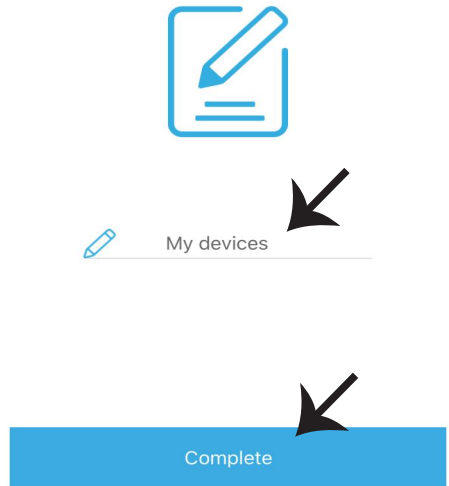

**Step 6: Your device is now paired and will appear (Ex: as shown in the below image).**

**a) To turn the device ON /OFF tap on the ON/OFF icon(as shown in the below image).**

**b) To enter more settings of the Smart device tap on the Name(Ex: Smart Plug as shown below)**

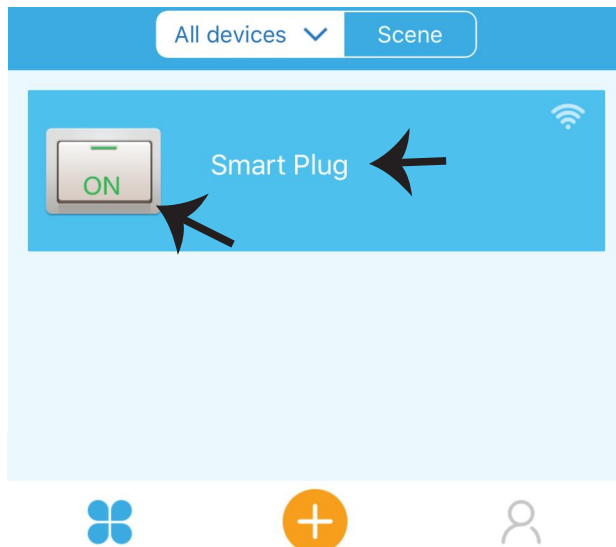

---

**Step 7: eWeLink offers multiple features such as;**

**a) Share - This function allows you to share the access with another user.**

**b) Schedule: Schedule timer allows you to turn the device ON/OFF with flexibility of choosing date and time. This feature also allows Repeat mode using which you can set the desired configuration to daily OR any day of the week.**

**c) Timer : Timer function allows you to set “day-hour-minute” using which you can schedule the device to Turn ON/OFF**

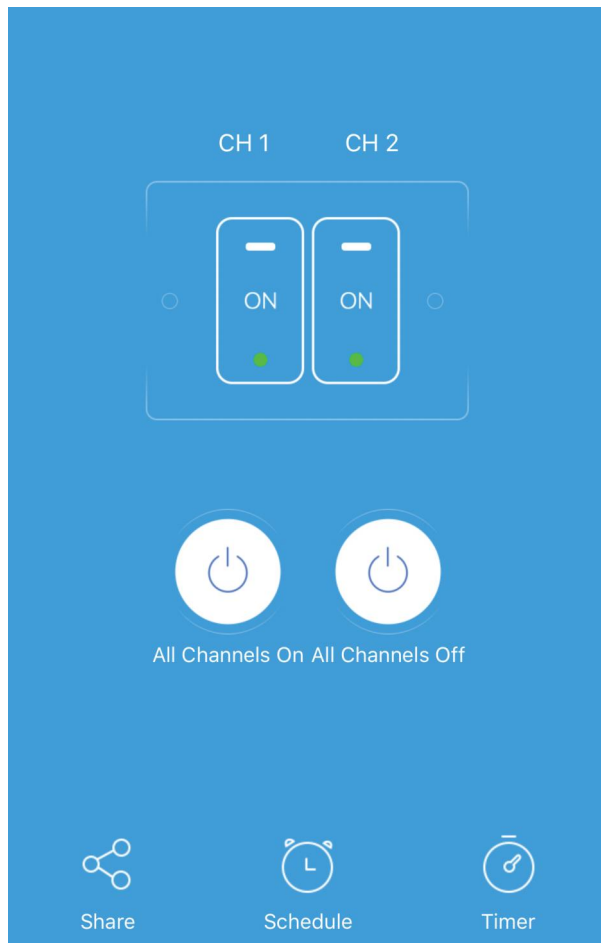

## ALEXA SETTINGS

**Step 1:** Install the Amazon Alexa app via the App Store (iOS) or the Play Store (Android) and register. If you already have an existing account with Amazon Alexa, please proceed to logging in.

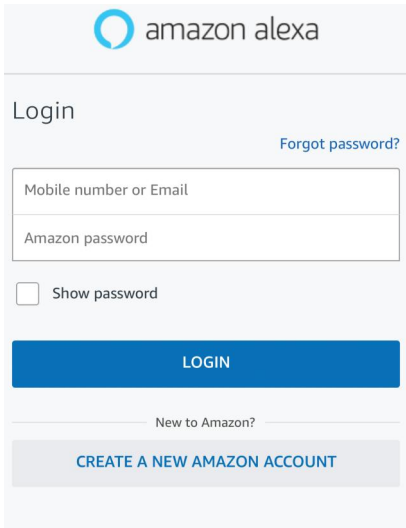

The image shows the login screen of the Amazon Alexa app. At the top is the Amazon Alexa logo. Below it is the word "Login". To the right of "Login" is a link that says "Forgot password?". There are two input fields: "Mobile number or Email" and "Amazon password". Below the "Amazon password" field is a checkbox labeled "Show password". At the bottom is a blue button labeled "LOGIN". Below the "LOGIN" button is a link that says "New to Amazon?". At the very bottom is a button labeled "CREATE A NEW AMAZON ACCOUNT".

**Step 3:** On the Home page of Amazon Alexa App, Tap on the icon as shown on the image below.



**Step 2:** Once you are on the Amazon Alexa home page, tap on the lower right icon — where the arrow is pointed — to add a new device and Enable Skills.

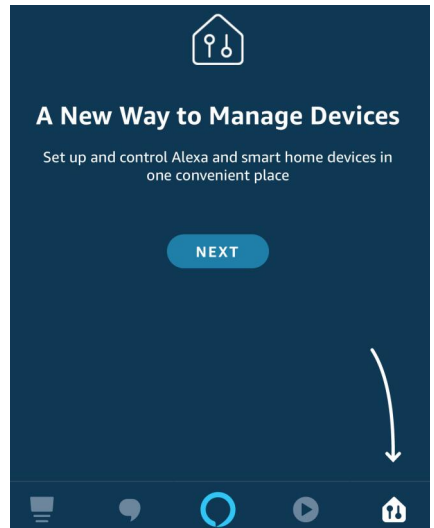

**Step 4:** Tap on “Skills & Games” as show below

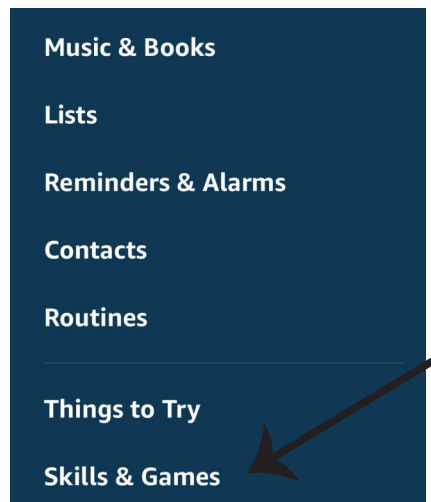

**Step 5: On the Search bar as shown type "eWeLink" and tap on the eWeLink skill as shown on the below image.**

## Search

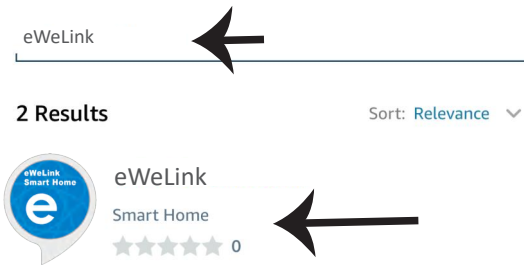

**Step 7: Enter Login credentials of eWeLink and then tap on Log In. If you do not have a existing account please register by tapping on the register.**

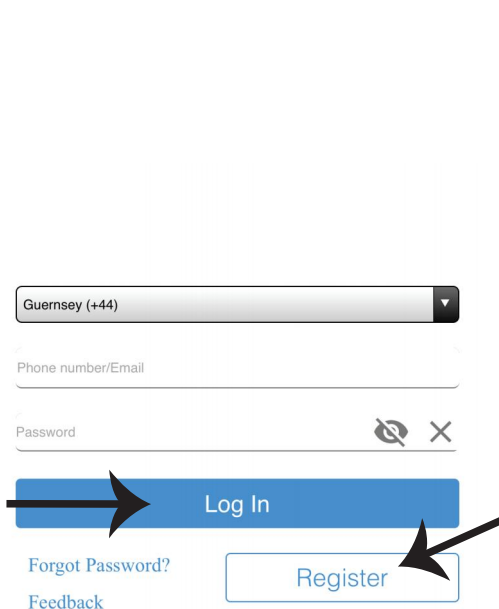

**Step 6: Tap on "ENABLE TO USE" to link eWeLink skill with Amazon Alexa app.**

## V-TAC Smart Home

eWeLink  
Rated: Guidance Suggested  
★★★★★ 0

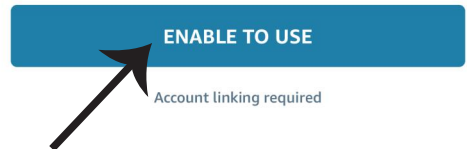

**Step 8: a) Once you have successfully linked V-TAC Skill close the window & (b) tap on Discover device. Make sure Smart device is paired with eWeLink app.**

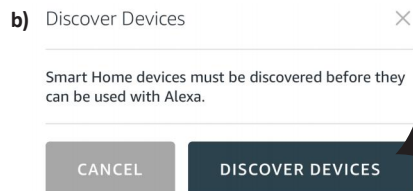
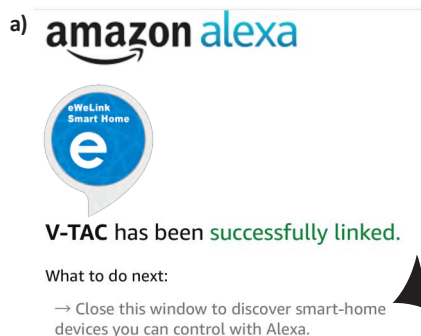

---

**Step 9: Discover your smart device on Alexa. Once you have enabled the skill**

**A) You can use voice command "Alexa discover devices" to the Alexa device which you have.**

**B) To add device manually on home page tap on  and tap on Add device , select the device which you are adding and tap on discover device. (Ref Image B)**

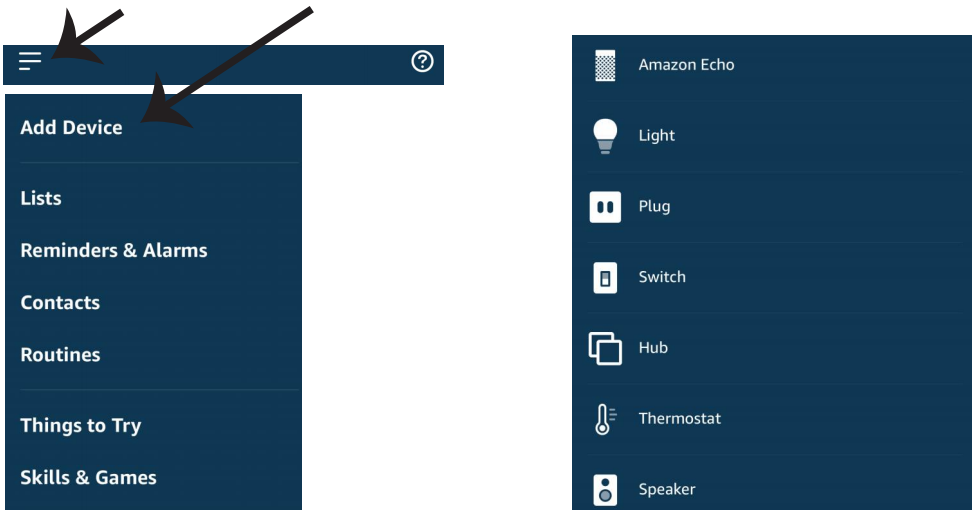

*Note: Discovering the device must be done every time the device's name is changed on the app.*

## **ALEXA Commands**

Now, you can control your smart device using voice commands on Alexa. Below are few example commands on how to use Alexa device:

➤! Alexa, turn ON Smart Plug

➤! Alexa, turn OFF Smart Plug

## **THINGS TO REMEMBER BEFORE STARTING INSTALLATION:**

1. eWeLink App & Amazon Alexa App
  2. Make sure you have Amazon Alexa Device(including Echo, Echo Tap, or Echo Dot)
  3. Smart Home Device
  4. Stable Wifi network
-



## GOOGLE HOME SETTINGS

### Step 1:

- a&b)** Install the Google Home app via the App Store (iOS) or the Play Store (Android) and register. If you already have an existing account with Google Home, please proceed to logging in.
- c)** Create a New Home/choose from the existing home if any.
- d)** Power ON the Google Home device and connect it to the App. (Then Proceed to step 2)

**a. Welcome home**

Your content and devices all in one place



**b. Choose account**

This account will be used to personalize your experience

**d. Plug in your device**

Make sure your device is nearby and connected to power, then try again



**c. Choose a home**

You will be able to control the devices and services in this home.

[GET STARTED >](#)



Create another home

**Step 2:** Once you are on the Google home page, tap on the Add “+” icon– to add a new device and skill. And then tap on set up device as shown in below image.

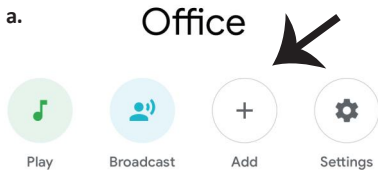

Office  
1 device



Office Speaker

[Pause](#)

**b.** [Add to Home](#)

- 
- Set up device
  - Add home member
  - Create speaker group
  - Create new home

[Add services](#)

- Music and audio
- Videos and photos

**Step 3: Make sure the Smart device is paired with eWeLink app before starting step 3. Tap on the arrow section as highlighted in the below image.**

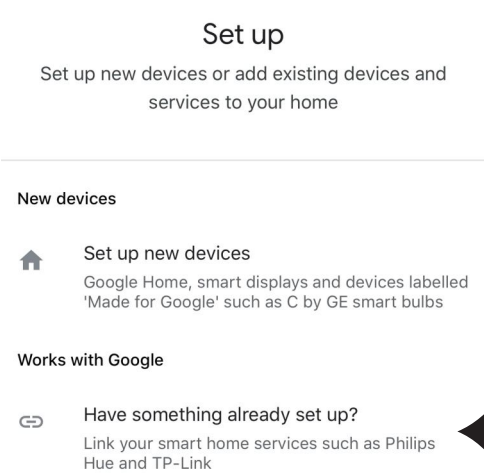

**Step 4: Type “eWeLink” on the search bar and tap on eWeLink icon from the drop down options as shown below.**

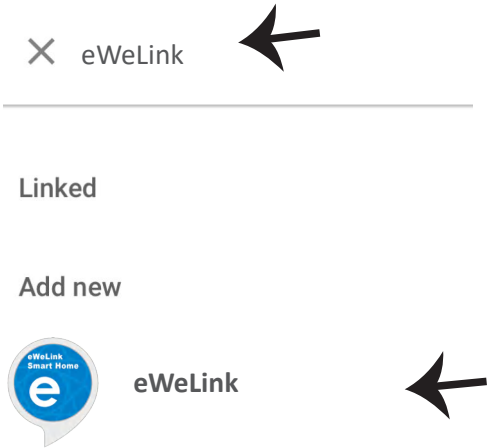

**Step 5: Sign In with your eWeLink Login credentials to Link the Smart Home device**

United Kingdom (+44)

Phone number/Email

Password

Log In

**Step 6:**

a. Account will now be linked, please stay on the page you will be redirected in few seconds to select the device to add to your home.

b. Select the device and tap on Next as show in image(b)

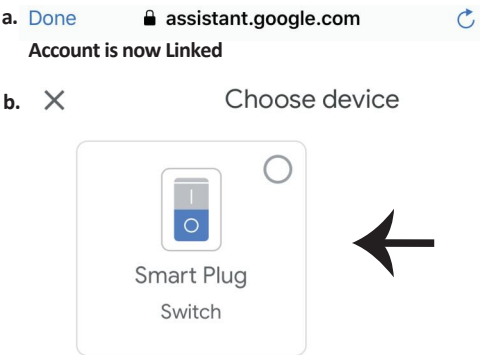

**Step 7: Select the Home where you would like to add the Smart Device under. (Or) you can create a New home in order to add the Smart Device to it.**

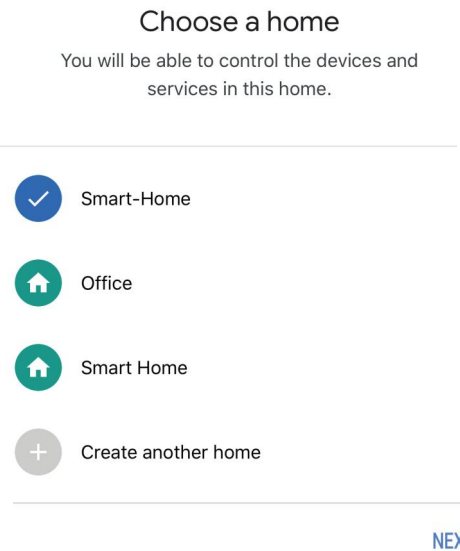

**Step 8: You have successfully added V-TAC Smart device to your Google home App.**

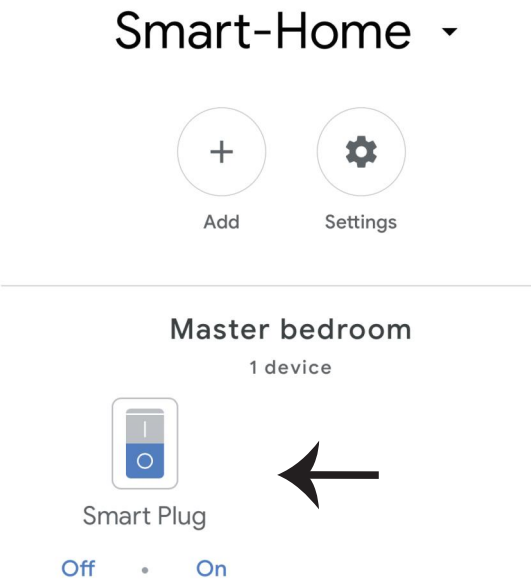

**Step 9: You can turn the device On/OFF by tapping On/Off options as shown below. (OR) You can tap on the name(Ex:Smart Plug as shown below) to redirect to new page.**

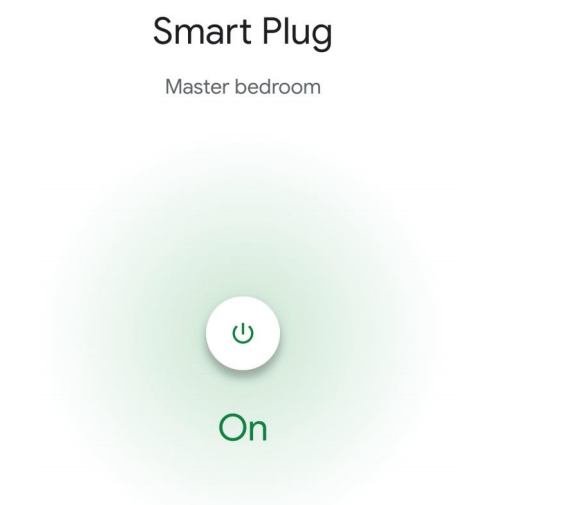
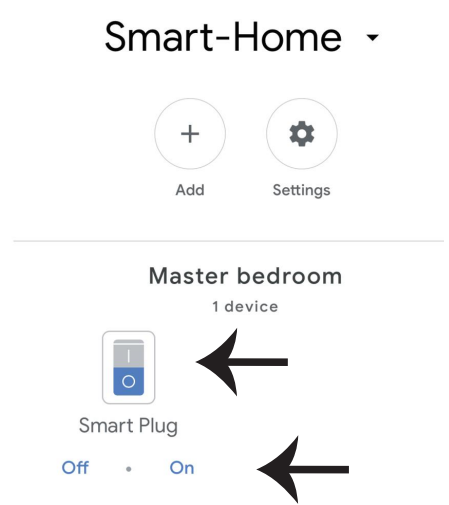

---

## Google Commands:

Now, you can control your smart device using voice commands on Google Home. Below are a few example voice commands on how to use Google Home device:

- ! *OK Google, turn ON Smart Plug*
- ! *OK Google, turn OFF Smart Plug*

## THINGS TO REMEMBER BEFORE STARTING INSTALLATION:

1. *eWeLink App & Google Home App*
2. *Make sure you have Google Home Device*
3. *Smart Home Device*
4. *Stable Wifi network*

In case of any query/issue with the product please reach out to us at [support@vtacexports.com](mailto:support@vtacexports.com)  
V-TAC EUROPE LTD, Bulgaria, Plovdiv 4000, bul.L.Karavelov 9B

---